

STATE OF ILLINOIS
DEPARTMENT OF TRANSPORTATION

| F.A.P. RTE. | SECTION | COUNTY | TOTAL SHEETS | SHEET NO. |
|-------------|---------------------|----------|--------------------|-----------|
| 785 | (137-2,138,139)RS-4 | MADISON | 14 | 1 |
| | | ILLINOIS | CONTRACT NO. 76M85 | |

D-98-012-20

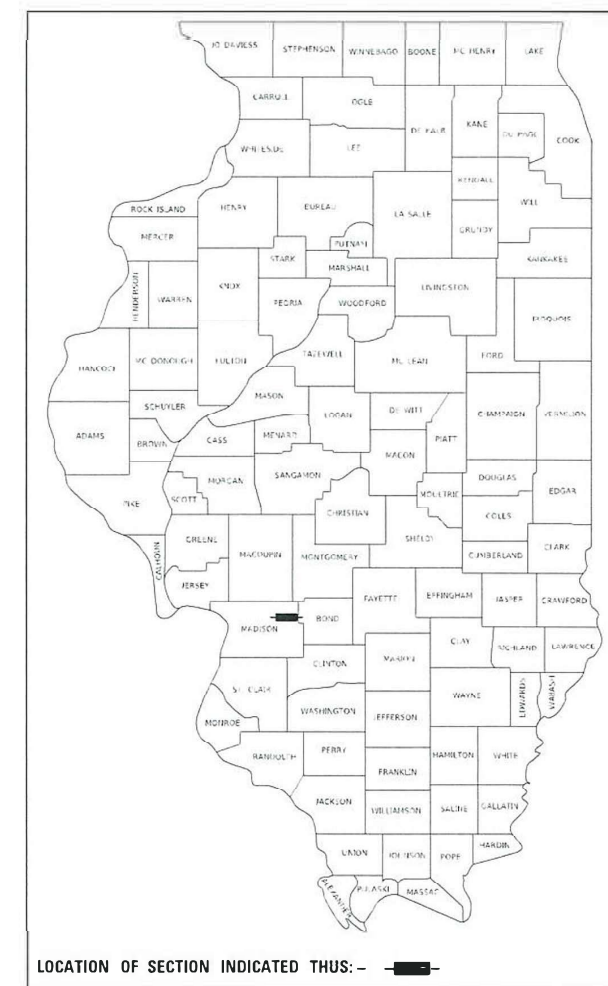

PROPOSED HIGHWAY PLANS

FAP ROUTE 785 (IL 140)
SECTION (137-2,138,139)RS-4
PROJECT STP-2J8R(731)
RESURFACING - DESIGNED OVERLAY
MADISON COUNTY

C-98-026-20

FOR INDEX OF SHEETS, SEE SHEET NO. 2

TRAFFIC DATA

| LOCATION | IL 140 FROM IL 160 TO BOND CO. LINE |
|----------|-------------------------------------|
| 2020 ADT | 1850 (ESTIMATED) |
| 2040 ADT | 2300 (ESTIMATED) |
| MU% | 10.0 |
| SU% | 7.2 |

BRIDGE OMISSION: SN. 060-2047
STA. 1368+09.00 - STA. 1369+77.00

BEGIN PROJECT:
STA. 1348+46
LAT: 38.888491
LONG: -89.669909

CULVERT REPLACEMENT
STA. 1393+26

END PROJECT:
STA. 1441+83
LAT: 38.88881
LONG: -89.63714

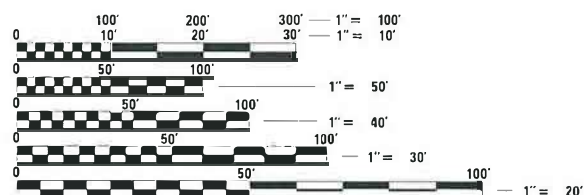

FULL SIZE PLANS HAVE BEEN PREPARED USING STANDARD ENGINEERING SCALES. REDUCED SIZED PLANS WILL NOT CONFORM TO STANDARD SCALES. IN MAKING MEASUREMENTS ON REDUCED PLANS, THE ABOVE SCALES MAY BE USED.

J.U.L.I.E.
JOINT UTILITY LOCATION INFORMATION FOR EXCAVATORS
1-800-892-0123
OR 811

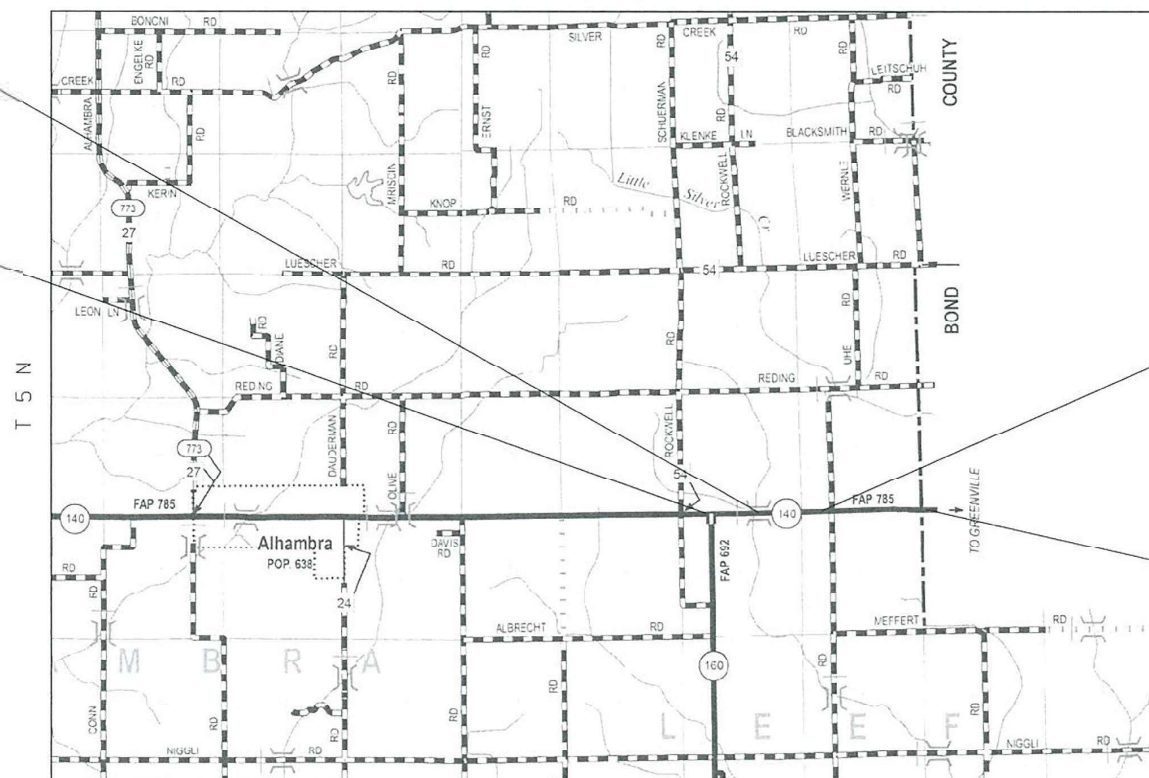

GROSS LENGTH = 9337.0 FT. = 1.768 MILE
NET LENGTH = 9225.5 FT. = 1.747 MILE

PROJECT ENGINEER: TIFFANY BRASE 618-346-3175
PROJECT MANAGER: RAHSHUN J. MILLER 618-346-3196

CONTRACT NO. 76M85

STATE OF ILLINOIS
DEPARTMENT OF TRANSPORTATION

SUBMITTED *October 8, 2020*
K Roberts REGIONAL ENGINEER

December 4, 2020
Scott A. Elk
ENGINEER OF DESIGN AND ENVIRONMENT

December 4, 2020
James J. Gu
DIRECTOR OF HIGHWAYS PROJECT IMPLEMENTATION

PRINTED BY THE AUTHORITY
OF THE STATE OF ILLINOIS

| CONSTR. CODE | |
|--------------|--|
| 80% FED | |
| 20% STATE | |
| ROADWAY | |
| 0005 | |
| RURAL | |

| CODE NO. | ITEM | UNIT | TOTAL QUANTITY | CONSTR. CODE |
|----------|--|-------|----------------|--------------|
| 20200100 | EARTH EXCAVATION | CU YD | 143 | 143 |
| 20200600 | EXCAVATING AND GRADING EXISTING SHOULDER | UNIT | 213 | 213 |
| 40600290 | BITUMINOUS MATERIALS (TACK COAT) | POUND | 38467 | 38467 |
| 40600990 | TEMPORARY RAMP | SQ YD | 299 | 299 |
| 40603085 | HOT-MIX ASPHALT BINDER COURSE, 1L-19.0, N70 | TON | 3081 | 3081 |
| 40604052 | HOT-MIX ASPHALT SURFACE COURSE, 1L-9.5, MIX "C", N70 | TON | 2054 | 2054 |
| 44000164 | HOT-MIX ASPHALT SURFACE REMOVAL, 3 3/4" | SQ YD | 24451 | 24451 |
| 44200168 | PAVEMENT PATCHING, TYPE II, 14 INCH | SQ YD | 98 | 98 |
| 44200174 | PAVEMENT PATCHING, TYPE IV, 14 INCH | SQ YD | 108 | 108 |
| 44201299 | DOWEL BARS 1 1/2" | EACH | 40 | 40 |
| 44201821 | CLASS D PATCHES, TYPE IV, 14 INCH | SQ YD | 54 | 54 |
| 44213200 | SAW CUTS | FOOT | 136 | 136 |
| 44213204 | TIE BARS 3/4" | EACH | 10 | 10 |
| 48100100 | AGGREGATE SHOULDERS, TYPE A | TON | 11 | 11 |

| CONSTR. CODE | |
|--------------|--|
| 80% FED | |
| 20% STATE | |
| ROADWAY | |
| 0005 | |
| RURAL | |

| CODE NO. | ITEM | UNIT | TOTAL QUANTITY | CONSTR. CODE |
|----------|---|--------|----------------|--------------|
| 48102100 | AGGREGATE WEDGE SHOULDER, TYPE B | TON | 482 | 482 |
| 48203029 | HOT-MIX ASPHALT SHOULDERS, 8" | SQ YD | 8122 | 8122 |
| 50100100 | REMOVAL OF EXISTING STRUCTURES | EACH | 1 | 1 |
| 50800205 | REINFORCEMENT BARS, EPOXY COATED | POUND | 3790 | 3790 |
| 50800515 | BAR SPLICERS | EACH | 30 | 30 |
| 52200010 | TEMPORARY SHEET PILING | SQ FT | 151 | 151 |
| 54003000 | CONCRETE BOX CULVERTS | SQ YD | 43.4 | 43.4 |
| 59100100 | GEOCOMPOSITE WALL DRAIN | CU YD | 20.8 | 20.8 |
| 64200108 | SHOULDER RUMBLE STRIPS, 8 INCH | FOOT | 18043 | 18043 |
| 67000400 | ENGINEER'S FIELD OFFICE, TYPE A | CAL MO | 3 | 3 |
| 67100100 | MOBILIZATION | L SUM | 1 | 1 |
| 70100405 | TRAFFIC CONTROL AND PROTECTION, STANDARD 701321 | EACH | 1 | 1 |
| 70100450 | TRAFFIC CONTROL AND PROTECTION, STANDARD 701201 | L SUM | 1 | 1 |
| 70100460 | TRAFFIC CONTROL AND PROTECTION, STANDARD 701306 | L SUM | 1 | 1 |
| 70100500 | TRAFFIC CONTROL AND PROTECTION, STANDARD 701326 | L SUM | 1 | 1 |

MODEL: Default
 FILE NAME: P:\p1g1ncom.dct\illinois.gov-PWD\DOT\Documents\DOT Offices\District B\Project\076M85\CADD\DATA\CAD\Sheet\076M85-Sht-Cover.dgn

| | | |
|------------------------------|------------|-----------|
| USER NAME = millerraj | DESIGNED - | REVISED - |
| | DRAWN - | REVISED - |
| PLOT SCALE = 100.0000' / in. | CHECKED - | REVISED - |
| PLOT DATE = 10/6/2020 | DATE - | REVISED - |

**STATE OF ILLINOIS
DEPARTMENT OF TRANSPORTATION**

SUMMARY OF QUANTITIES

SCALE: SHEET 1 OF 1 SHEETS STA. TO STA.

| F.A.P. RTE. | SECTION | COUNTY | TOTAL SHEETS | SHEET NO. |
|---------------------------|---------------------|---------|--------------------|-----------|
| 785 | (137-2,138,139)RS-4 | MADISON | 14 | 3 |
| ILLINOIS FED. AID PROJECT | | | CONTRACT NO. 76M85 | |

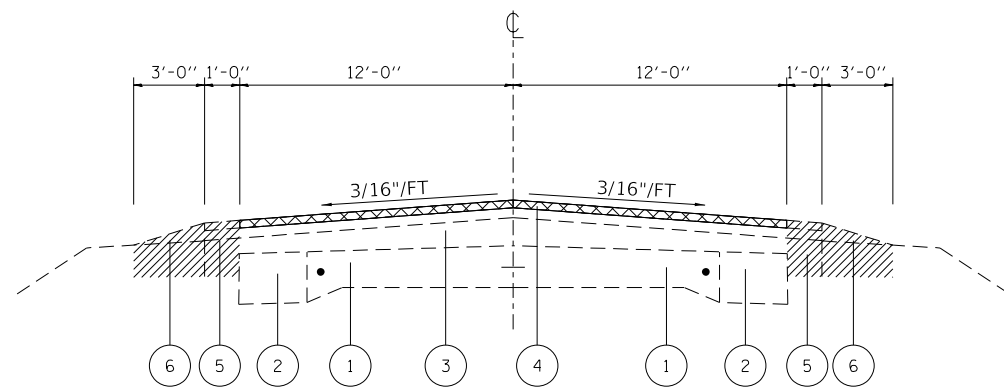

EXISTING TYPICAL SECTION

STA. 1348+46 TO STA. 1368+46
 STA. 1369+57.50 TO STA. 1441+83

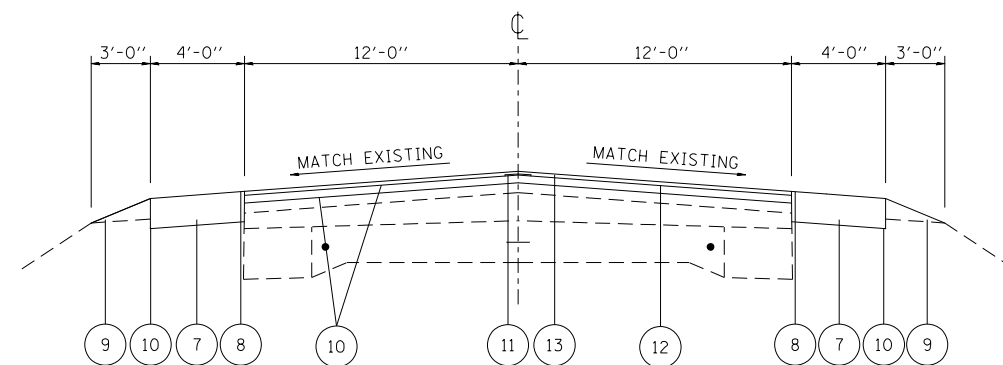

PROPOSED TYPICAL SECTION

STA. 1348+46 TO STA. 1368+46
 STA. 1369+57.50 TO STA. 1441+83

LEGEND

- ① EXISTING PCC PAVEMENT, 9"-6"-9"
- ② EXISTING PCC WIDENING, 9"
- ③ EXISTING BITUMINOUS SURFACING, (3 1/2"±)
- ④ EXISTING BITUMINOUS CONCRETE SURFACE COURSE, SUPERPAVE MIX 'D', N-70 1 1/2"
- ⑤ EXISTING SAFETY SHOULDER 1'
- ⑥ EXISTING AGGREGATE SHOULDER
- ⑦ PROPOSED HMA SHOULDERS 8"
- ⑧ PROPOSED SHOULDER RUMBLE, STRIPS 8"
- ⑨ PROPOSED AGGREGATE WEDGE SHOULDER, TYPE B
- ⑩ PROPOSED BITUMINOUS MATERIALS (TACK COAT)
- ⑪ PROPOSED LONGITUDINAL JOINT SEALANT
- ⑫ PROPOSED HOT-MIX ASPHALT BINDER COURSE, IL-19.0, N70, 2.25"
- ⑬ PROPOSED HOT-MIX ASPHALT SURFACE COURSE, MIX "C", N70, 1.5"

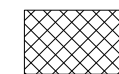

HMA SURFACE REMOVAL 3 3/4"



EXCAVATING AND GRADING EXISTING SHOULDER

MODEL: Default
 FILE: Model1.dwg
 PROJECT: \\p1\lanroom\da\illinois.gov\PHWDOT\Documents\DOT_Offices\District 8\Projects\ID776M85\CADD\Drawings\ID776M85-shc-cover.dgn

| | | |
|------------------------------|------------|-----------|
| USER NAME = millerraj | DESIGNED - | REVISED - |
| | DRAWN - | REVISED - |
| PLOT SCALE = 100.0000' / in. | CHECKED - | REVISED - |
| PLOT DATE = 10/1/2020 | DATE - | REVISED - |

**STATE OF ILLINOIS
 DEPARTMENT OF TRANSPORTATION**

TYPICAL SECTION

SCALE: SHEET 1 OF 1 SHEETS STA. TO STA.

| F.A.P. RTE. | SECTION | COUNTY | TOTAL SHEETS | SHEET NO. |
|--------------------|---------------------|---------|---------------------------|-----------|
| 785 | (137-2,138,139)RS-4 | MADISON | 14 | 5 |
| CONTRACT NO. 76M85 | | | ILLINOIS FED. AID PROJECT | |

SHOULDER SCHEDULE

| SHOULDER LOCATION | STA. | TO | STA. | LENGTH | EXCAVATING AND GRADING EXISTING SHOULDER | HMA SHOULDERS 8" | AGGREGATE WEDGE SHOULDER, TYPE B | SHOULDER RUMBLE STRIPS, 8" | BITUMINOUS MATERIAL (TACK COAT) | | |
|-------------------|---------|----|---------|--|--|------------------|----------------------------------|----------------------------|---------------------------------|--|--|
| | | | | FOOT | UNIT | SQYD | TON | FOOT | POUND | | |
| LT SIDE | 1348+46 | TO | 1368+09 | 1963.0 | 19.6 | 872.4 | 52.5 | 1963.0 | 392.6 | | |
| | 1368+09 | TO | 1369+77 | RESURFACING OMISSION FOR SHOULDER AT SN 060-2047 | | | | | | | |
| | 1369+77 | TO | 1401+83 | 3206.0 | 32.1 | 1424.9 | 85.7 | 3206.0 | 641.2 | | |
| | 1401+83 | TO | 1402+43 | OMISSION FOR LUDWIG RD | | | | | | | |
| | 1402+43 | TO | 1441+83 | 3940.0 | 39.4 | 1751.1 | 105.3 | 3940.0 | 788.0 | | |
| RT SIDE | 1348+46 | TO | 1350+21 | OMISSION FOR IL 160 | | | | | | | |
| | 1350+21 | TO | 1368+09 | 1788.0 | 17.9 | 794.7 | 47.8 | 1788.0 | 357.6 | | |
| | 1368+09 | TO | 1369+77 | RESURFACING OMISSION FOR SHOULDER AT SN 060-2047 | | | | | | | |
| | 1369+77 | TO | 1401+83 | 3206.0 | 64.1 | 1424.9 | 85.7 | 3206.0 | 641.2 | | |
| | 1401+83 | TO | 1402+43 | OMISSION FOR LUDWIG RD | | | | | | | |
| | 1402+43 | TO | 1441+83 | 3940.0 | 39.4 | 1751.1 | 105.3 | 3940.0 | 788.0 | | |
| TOTAL : | | | | | 213 | 8019 | 482 | 18043 | 3609 | | |

MAINLINE RESURFACING SCHEDULE

| LOCATION | | | HMA SURFACE REMOVAL 3.75" | HMA BINDER COURSE 1L-19.0, MIX "B" N70, 2.25" | BITUMINOUS MATERIALS (TACK COAT) | HMA SURFACE COURSE, MIX C, N70, 1.5" | LONGITUDINAL JOINT SEALANT | |
|----------|----|---------|-------------------------------------|---|----------------------------------|--------------------------------------|----------------------------|--|
| STA. | TO | STA. | (SQ YD) | (TON) | (POUND) | (TON) | (FT) | |
| 1348+46 | TO | 1368+09 | 5234.7 | 659.6 | 3533.4 | 439.7 | 1963.0 | |
| 1368+09 | TO | 1369+77 | RESURFACING OMISSION AT SN 060-2047 | | | | | |
| 1369+77 | TO | 1441+83 | 19216.0 | 2421.2 | 12970.8 | 1614.1 | 7206.0 | |
| TOTAL | | | 24451 | 3081 | 16504 | 2054 | 9169 | |

PAVEMENT MARKING SCHEDULE

| LOCATION | | | THERMOPLASTIC LINE - 4" | PAINT LINE - 4" | TEMPORARY LINE - 4" | TEMPORARY PAVEMENT MARKING REMOVAL | SHORT TERM PAVEMENT MARKING | SHORT TERM PAVEMENT MARKING REMOVAL | RAISED REFLECTIVE PAVEMENT MARKER | RAISED REFLECTIVE PAVEMENT MARKER REMOVAL |
|------------|----|---------|-------------------------|------------------|---------------------|------------------------------------|-----------------------------|-------------------------------------|-----------------------------------|---|
| | | | SKIP-DASH YELLOW | SKIP-DASH YELLOW | SKIP-DASH YELLOW | | SKIP-DASH YELLOW | | | |
| STA. | TO | STA. | (FT) | (FT) | (FT) | (SQ FT) | (FT) | (SQ FT) | (EACH) | (EACH) |
| 1348+46 | TO | 1368+09 | 490.8 | | 490.8 | 163.6 | 490.8 | 163.6 | 25 | 25 |
| 1368+09 | TO | 1369+77 | | 42.0 | | | | | | |
| 1369+77 | TO | 1441+85 | 1802.0 | | 1802.0 | 600.7 | 1802.0 | 600.7 | 90 | 90 |
| SUBTOTAL : | | | 2292.8 | 42.0 | 2292.8 | | 2292.8 | | | |
| TOTAL | | | 2293 | 42 | 2293 | 764 | 2293 | 764 | 115 | 115 |

MODEL: Default
 FILE: \\nrcs-pix\pub\room\dat\illinois\pwr\DOT\Documents\DOT_Offices\Illintct @Project\0676M85\CADD\Drawn\CAD\Drawn\0676M85-shc-cover.dgn

| | | |
|------------------------------|------------|-----------|
| USER NAME = millerraj | DESIGNED - | REVISED - |
| | DRAWN - | REVISED - |
| PLOT SCALE = 100.0000' / in. | CHECKED - | REVISED - |
| PLOT DATE = 10/1/2020 | DATE - | REVISED - |

**STATE OF ILLINOIS
DEPARTMENT OF TRANSPORTATION**

| SCHEDULE OF QUANTITIES | | | |
|------------------------|---------|---------|--------|
| SCALE: | SHEET 1 | OF 1 | SHEETS |
| | STA. | TO STA. | |

| F.A.P. RTE. | SECTION | COUNTY | TOTAL SHEETS | SHEET NO. |
|--------------------|---------------------|------------------|--------------|-----------|
| 785 | (137-2,138,139)RS-4 | MADISON | 14 | 6 |
| CONTRACT NO. 76M85 | | | | |
| ILLINOIS | | FED. AID PROJECT | | |

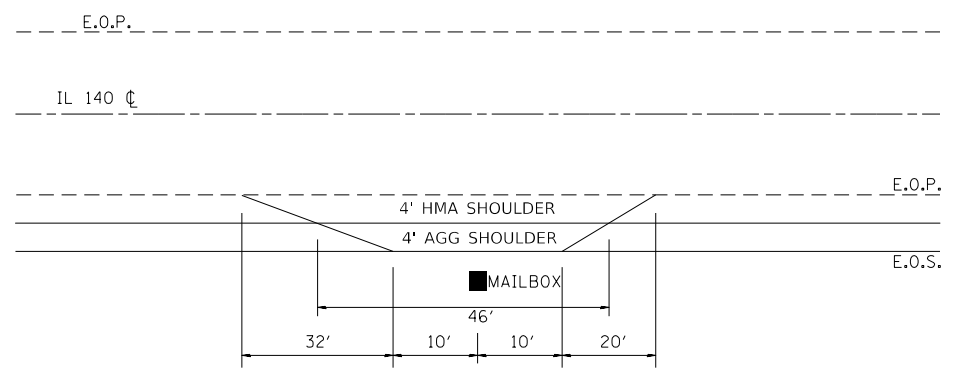
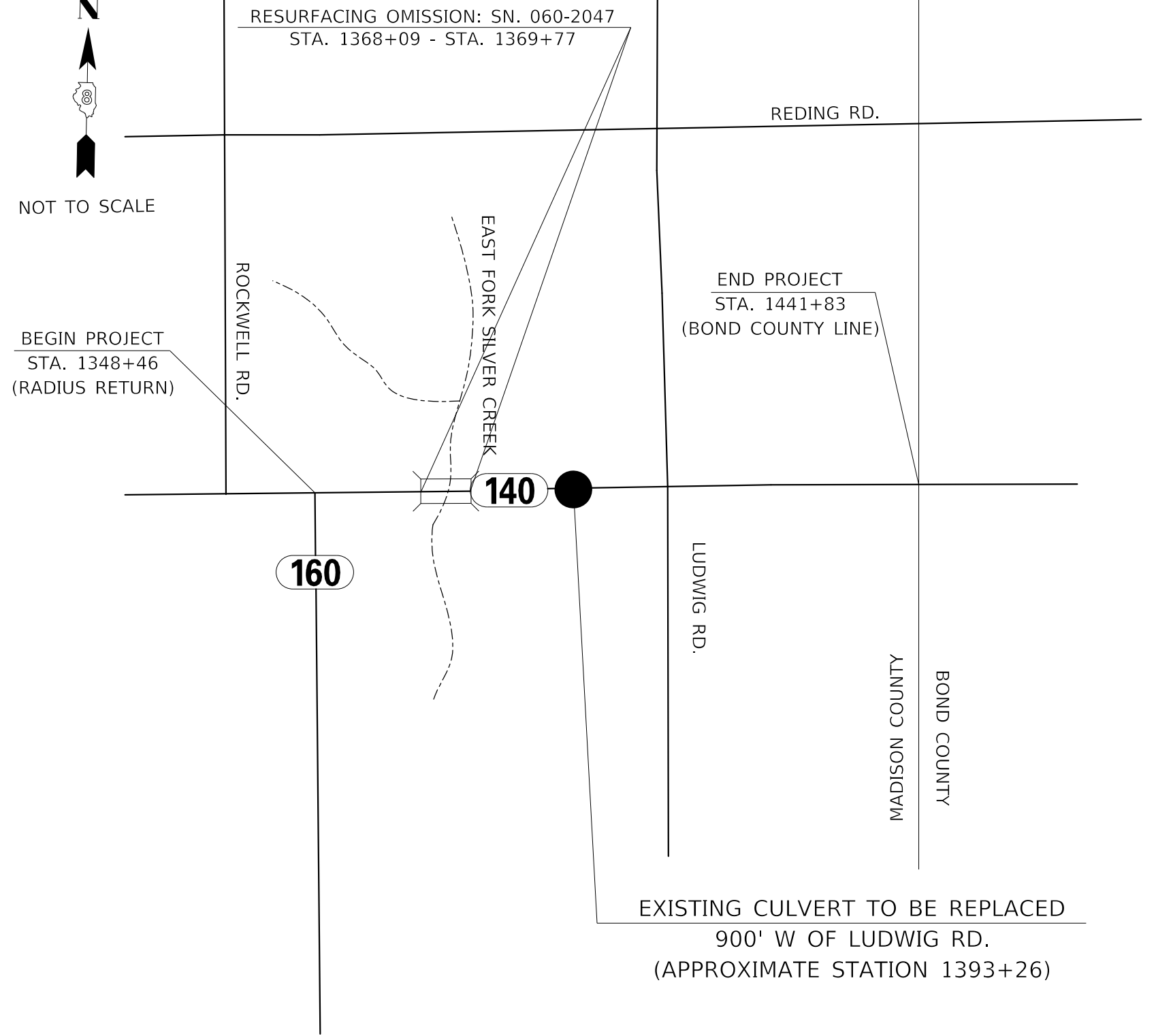
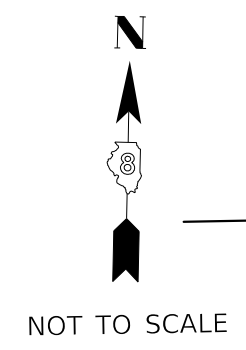

MAILBOX TURNOUT DETAIL

MODEL: Default
 FILE: Mailbox_Plan\planroom.dwg
 PROJECT: \Projects\10776M85\CADD\Drawings\10776M85-shc-cover.dgn
 OFFICE: \Projects\10776M85\CADD\Drawings\10776M85-shc-cover.dgn

| | | |
|------------------------------|------------|-----------|
| USER NAME = millerraj | DESIGNED - | REVISED - |
| | DRAWN - | REVISED - |
| PLOT SCALE = 100.0000' / in. | CHECKED - | REVISED - |
| PLOT DATE = 10/1/2020 | DATE - | REVISED - |

**STATE OF ILLINOIS
DEPARTMENT OF TRANSPORTATION**

| | |
|-----------------------------|----------------------------------|
| LOCATION MAP, DETAIL | |
| SCALE: | SHEET 1 OF 1 SHEETS STA. TO STA. |

| F.A.P. RTE. | SECTION | COUNTY | TOTAL SHEETS | SHEET NO. |
|--------------------|---------------------|---------|---------------------------|-----------|
| 785 | (137-2,138,139)RS-4 | MADISON | 14 | 8 |
| CONTRACT NO. 76M85 | | | ILLINOIS FED. AID PROJECT | |

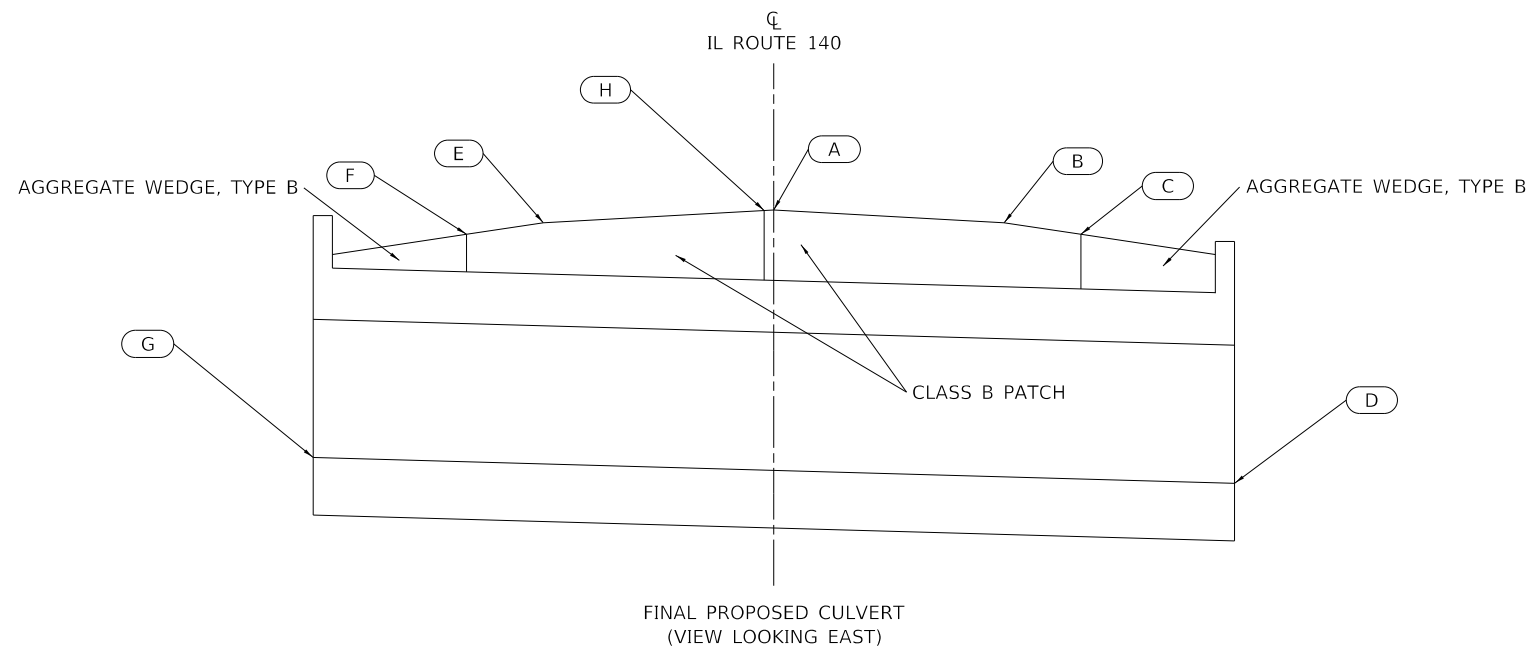

| POINT | ELEVATION | COMMENTS |
|-------|-----------|---|
| A | 100.00' | CENTERLINE OF THE EXISTING ROADWAY: ASSUMED ELEV. 100.00 |
| B | 98.81' | RT EDGE OF PAVEMENT |
| C | 98.65' | RT EDGE OF SHOULDER |
| D | 96.04' | RT. FLOWLINE (BOX CULVERT) |
| E | 98.81' | LT EDGE OF PAVEMENT |
| F | 98.65' | LT EDGE OF SHOULDER |
| G | 96.42' | LT FLOWLINE (BOX CULVERT) |
| H | 99.99' | LT AT STAGE CONSTRUCTION JOINT (6" OFFSEFT FROM CENTERLINE) |

| CULVERT SCHEDULE OF QUANTITIES (STA. 1393+26) | | |
|---|-------|----------|
| PAY ITEM | UNIT | QUANTITY |
| CONCRETE BOX CULVERTS | CU YD | 20.8 |
| REINFORCEMENT BARS | POUND | 3790 |
| BAR SPLICERS | EACH | 30 |
| WATERPROOFING MEMBRANE SYSTEM | SQ YD | 43.4 |
| GEOCOMPOSITE WALL DRAIN | SQ YD | 43.4 |
| CLASS B PATCHING, TYPE IV, 12 INCH, SPECIAL | SQ YD | 71.1 |
| SAW CUTS | FOOT | 136 |
| TIE BARS 3/4" | EACH | 10 |
| DOWEL BARS 1 1/2" | EACH | 40 |
| TEMPORARY SHEET PILING | SQ FT | 151 |
| REMOVAL OF EXISTING STRUCTURES* | EACH | 1 |
| PORUS GRANUAL EMBANKMENT | CU YD | 55.7 |

*REMOVAL OF EXISTING STRUCTURES INCLUDES THE REMOVAL OF THE EXISTING 41'-6" 4'X1'-6" BOX CULVERT, THE 6'-0" CULVERT EXTENSIONS, AND ANY APPERTURES. THE TOTAL LENGTH OF THE EXISTING BOX CULVERT IS 53'-6".

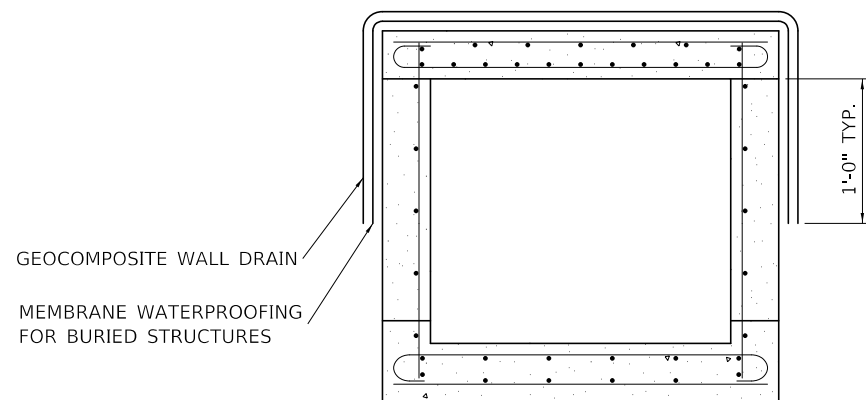

MEMBRANE WATERPROOFING /GEOCOMPOSITE WALL DRAIN

| TEMPORARY TRAFFIC CONTROL SCHEDULE (CULVERT REPLACEMENT) | | | | | | | | |
|--|----|------------|----------------------------|-------------------------------------|------------------------------------|---|---|----------------------------------|
| STATION | TO | STATION | TEMPORARY CONCRETE BARRIER | RELOCATE TEMPORARY CONCRETE BARRIER | PINNING TEMPORARY CONCRETE BARRIER | IMPACT ATTENUATORS, TEMPORARY (NON-REDIRECTIVE), TEST LEVEL 3 | IMPACT ATTENUATORS, RELOCATE (NON-REDIRECTIVE, TEST LEVEL 3 | TEMPORARY BRIDGE TRAFFIC SIGNALS |
| | | | FOOT | FOOT | EACH | FACH | FACH | FACH |
| 1392+59.50 | TO | 1393+92.50 | 137.5 | 137.5 | 54 | 2 | 2 | 1 |

MODEL: Default
FILE: \\nrc\c:\p\uplanroom\dtd\illinois.gov\PIWIDOT\Documents\DOT_Offices\I111111.ctb @Project\1076485\CADD\Drawings\1076485-shc-rd-10.dgn

| | | |
|------------------------------|------------|-----------|
| USER NAME = ruholids | DESIGNED - | REVISED - |
| | DRAWN - | REVISED - |
| PLOT SCALE = 100.0000' / in. | CHECKED - | REVISED - |
| PLOT DATE = 11/30/2020 | DATE - | REVISED - |

**STATE OF ILLINOIS
DEPARTMENT OF TRANSPORTATION**

STAGING DETAILS
SCALE: N.T.S. SHEET 2 OF 3 SHEETS STA. TO STA.

| F.A.P. RTE. | SECTION | COUNTY | TOTAL SHEETS | SHEET NO. |
|---------------------------|---------------------|---------|--------------------|-----------|
| 785 | (137-2,138,139)RS-4 | MADISON | 14 | 12 |
| ILLINOIS FED. AID PROJECT | | | CONTRACT NO. 76M85 | |

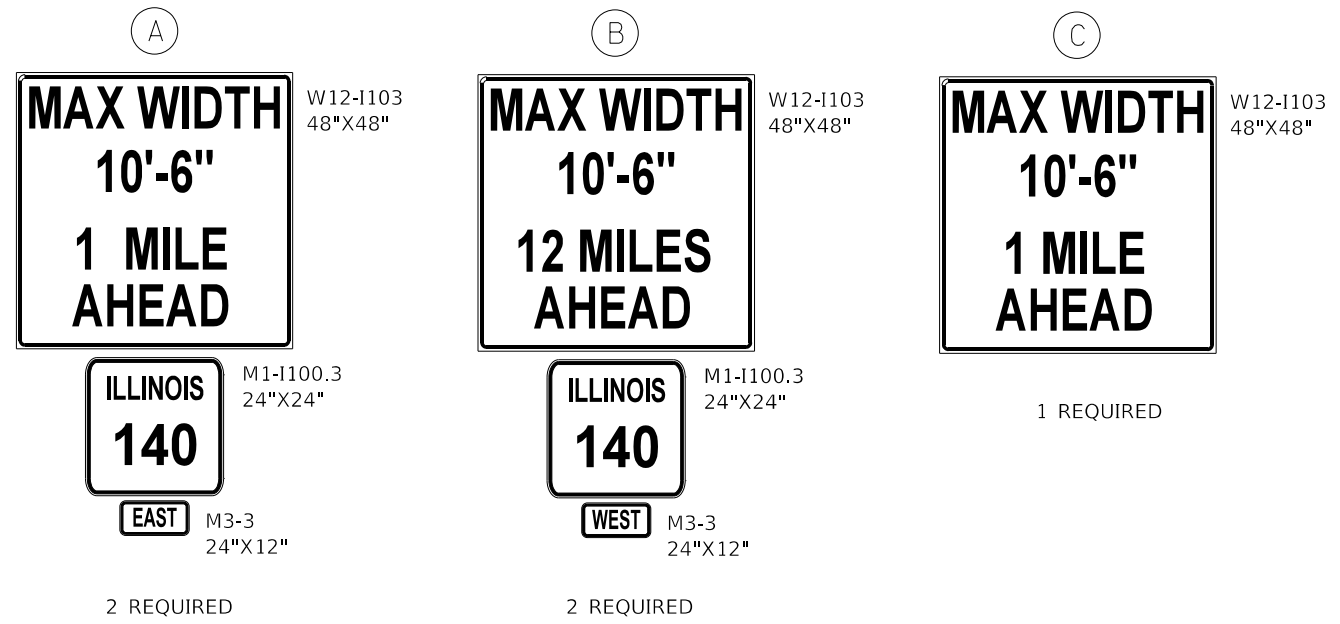

NOTES

1. ALL SIGNS REQUIRED WILL BE SUPPLIED TO THE CONTRACTOR BY I.D.O.T.
2. THE CONTRACTOR SHALL FURNISH THE POSTS AND ERECT SIGNS AT THE LOCATIONS SHOWN ON THIS SHEET, AS DIRECTED BY THE R.E./R.T.. THE POSTS SHALL REMAIN PROPERTY OF THE CONTRACTOR.
3. THE CONTRACTOR SHALL GIVE THE ILLINOIS DEPARTMENT OF TRANSPORTATION, BUREAU OF OPERATIONS TWO WEEKS NOTICE FOR SIGNS. THE CONTRACTOR SHALL PICK UP THE SIGNS AT THE T.M. BUILDING IN FAIRVIEW HEIGHTS, AND RETURN THEM UPON COMPLETION OF THE CONTRACT. CONTACT JEAN SLAPE AT 618-346-2189
4. SIGN SPACING WILL BE 400' OR TO FIT FIELD CONDITIONS
5. THE HEIGHT TO THE BOTTOM OF THE LOWEST SIGN SHALL NOT BE LESS THAN 6FT.

MODEL: Default
 FILE: \\nashville.pva\pub\haronom.d\at\illinois.gov\PIWDOT\Documents\DOT_Offices\Illintct @ Projects\0776M85\CADD\Drawings\0776M85-shc-rd-143.dgn

| | | |
|------------------------------|------------|-----------|
| USER NAME = ruholids | DESIGNED - | REVISED - |
| | DRAWN - | REVISED - |
| PLOT SCALE = 100,0000' / in. | CHECKED - | REVISED - |
| PLOT DATE = 9/30/2020 | DATE - | REVISED - |

STATE OF ILLINOIS
DEPARTMENT OF TRANSPORTATION

WIDE LOAD SIGNING PLAN
 SCALE: N.T.S. SHEET 1 OF 1 SHEETS STA. TO STA.

| F.A.P. RTE. | SECTION | COUNTY | TOTAL SHEETS | SHEET NO. |
|---------------------------|---------------------|---------|--------------------|-----------|
| 785 | (137-2,138,139)RS-4 | MADISON | 14 | 14 |
| ILLINOIS FED. AID PROJECT | | | CONTRACT NO. 76M85 | |