

STATE OF ILLINOIS
DEPARTMENT OF TRANSPORTATION

F.A.U. RTE.	SECTION	COUNTY	TOTAL SHEETS	SHEET NO.
7706	(22) BDR	LOGAN	24	1
		ILLINOIS	CONTRACT NO. 72L96	

FOR INDEX OF SHEETS, SEE SHEET NO. 2

HIGHWAY CLASSIFICATION

A.D.T. (2016)	-6,450	PV = 92.25%
PROJECTED ADT (2036)	-7,070	SU = 4.26%
DESIGN SPEED	-55	MU = 3.49%
POSTED SPEED	-50	
CLASSIFICATION: MINOR ARTERIAL		

PROPOSED HIGHWAY PLANS

FAU ROUTE 7706 (LINCOLN PARKWAY)
SECTION (22) BDR
PROJECT STP-5UU5(557)
BRIDGE DECK OVERLAY
LOGAN COUNTY

C-96-094-20

PROJECT BEGINS
WB STA 80+00.00
EB STA 80+20.00

PROJECT ENDS
WB STA 83+84.00
EB STA 84+14.00

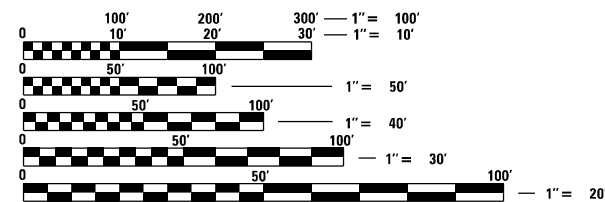
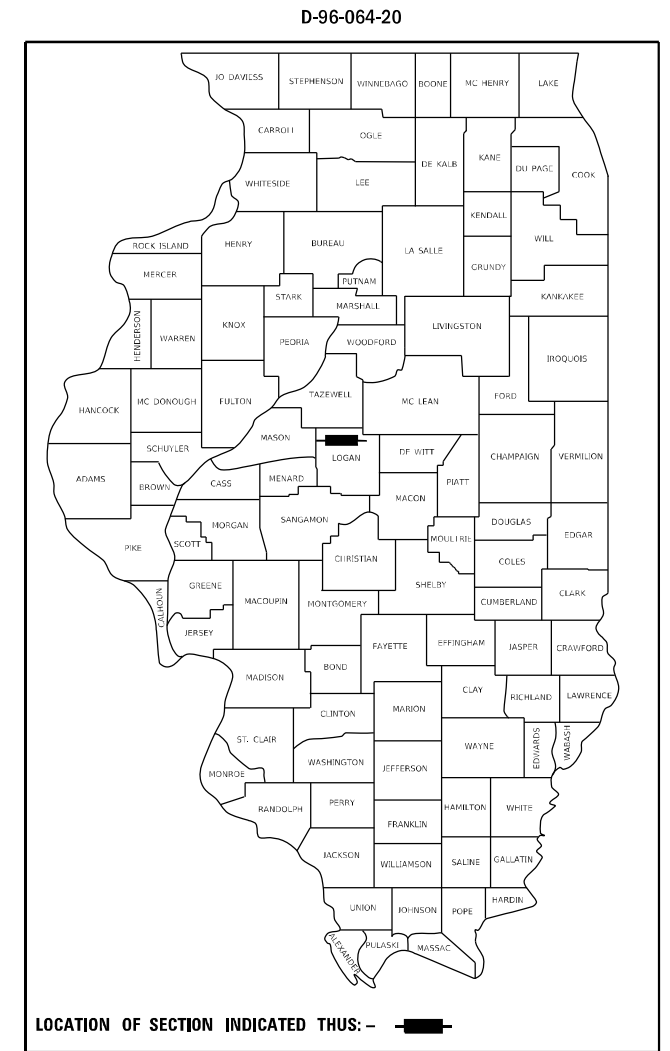

FULL SIZE PLANS HAVE BEEN PREPARED USING STANDARD ENGINEERING SCALES. REDUCED SIZED PLANS WILL NOT CONFORM TO STANDARD SCALES. IN MAKING MEASUREMENTS ON REDUCED PLANS, THE ABOVE SCALES MAY BE USED.

J.U.L.I.E.
JOINT UTILITY LOCATION INFORMATION FOR EXCAVATORS
1-800-892-0123
OR 811

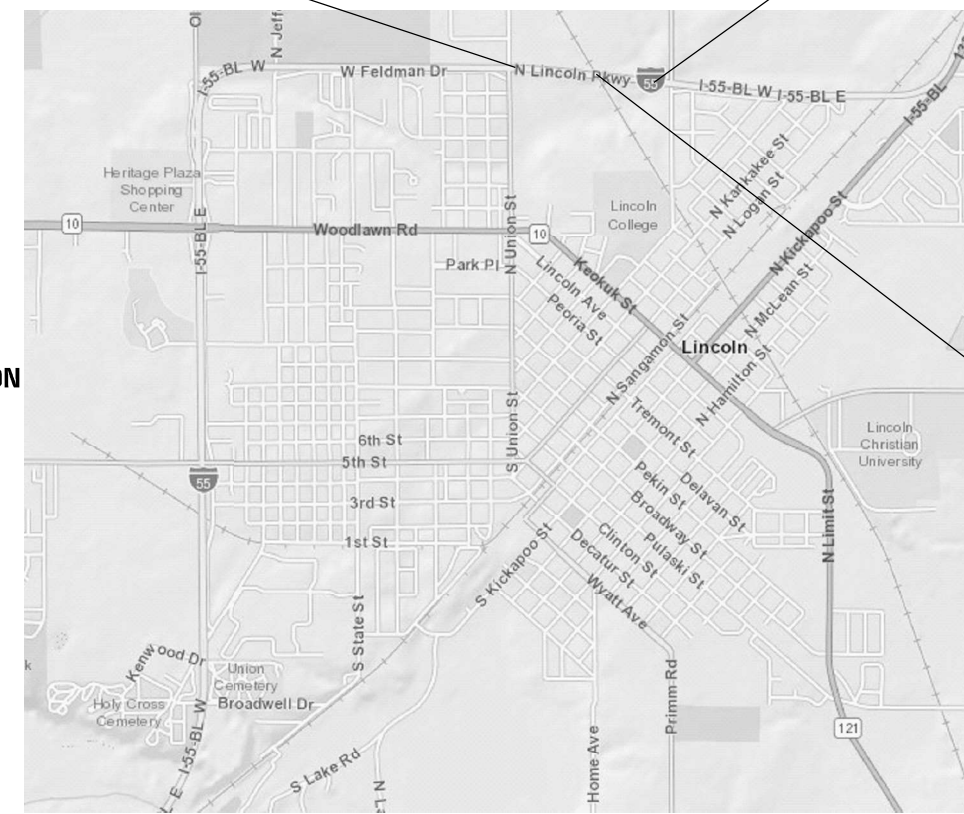

EXISTING STRUCTURE
SN 054-0104-STA 82+14.51
BRIDGE DECK OVERLAY

PROJECT ENGINEER: JAY EDWARDS (217) 785-0597
TEAM MANAGER: JONATHAN COX (217) 782-1378

GROSS LENGTH = 414 FT. = 0.078 MILE
NET LENGTH = 344 FT. = 0.065 MILE

CONTRACT NO. 72L96

STATE OF ILLINOIS
DEPARTMENT OF TRANSPORTATION

SUBMITTED October 16 2020

Jeffrey P. Myers REGIONAL ENGINEER
December 4, 2020

Scott A. Elk ENGINEER OF DESIGN AND ENVIRONMENT
December 4, 2020

James J. Gu DIRECTOR OF HIGHWAYS PROJECT IMPLEMENTATION 13

PRINTED BY THE AUTHORITY
OF THE STATE OF ILLINOIS

STANDARDS

- 000001-08 STANDARD SYMBOLS, ABBREVIATIONS, AND PATTERNS
- 610001-09 SHOULDER INLET WITH CURB
- 701101-05 OFF ROADS OPERATIONS , MULTILANE , MORE THAN 15' AWAY FROM PAVEMENT EDGE
- 701106-02 OFF ROADS OPERATIONS , MULTILANE, 15'-24" FROM PAVEMENT EDGE
- 701421-08 LANE CLOSURE MULTILANE, DAY OPERATIONS ONLY, FOR SPEEDS ≥ 45 MPH TO 55 MPH
- 701423-10 LANE CLOSURE MULTILANE, WITH BARRIER, FOR SPEEDS ≥ 45 MPH TO 55 MPH
- 701426-09 LANE CLOSURE MULTILANE, INTERMITTENT OR MOVING OPER., FOR SPEEDS ≥ 45 MPH
- 701901-08 TRAFFIC CONTROL DEVICES
- 780001-05 TYPICAL PAVEMENT MARKINGS

INDEX OF SHEETS

- 1 COVER SHEET
- 2 INDEX OF SHEETS, LISTS OF STANDARDS, GENERAL NOTES AND COMMITMENTS
- 3 SUMMARY OF QUANTITIES
- 4 SCHEDULE OF QUANTITIES
- 5 ROADWAY TYPICAL SECTION
- 6-8 ROADWAY PLAN SHEET (3)
- 9 STAGING TYPICAL SECTIONS
- 10-14 TRAFFIC CONTROL PLANS-STAGE 1 (5)
- 15-19 TRAFFIC CONTROL PLANS-STAGE 1 (5)
- 20 WIDTH RESTRICTION SIGNING
- 21-24 STRUCTURE PLANS (4)

GENERAL NOTES

- 1 THE FOLLOWING MIXTURE REQUIREMENTS ARE APPLICABLE

LOCATIONS:	LINCOLN PARKWAY	LINCOLN PARKWAY	LINCOLN PARKWAY
MIXTURE USE(S):	HMA SURF CSE	HMA BASE COURSE	HMA SHOULDERS (TOP LIFT)
AC/PG:	PG 64-22	PG 64-22	PG 64-22
DESIGN AIR VOIDS	4.0% @ N DESIGN = 50	4.0% @ N DESIGN = 50	4.0% @ N DESIGN = 50
MIXTURE COMPOSITION (GRADATION MIXTURE)	IL 9.5	IL-19.0	IL 9.5
FRICTION AGGREGATE	MIX "D"	N/A	MIX "C"
QUALITY MANAGEMENT	QC/QA	QC/QA	QC/QA
SUBLOT SIZE	N/A	N/A	N/A

- 2 CHANGEABLE MESSAGE SIGNS SHALL BE SET UP 2 WEEKS PRIOR TO THE BEGINNING OF CONSTRUCTION AND CAN BE TAKEN DOWN ONCE CONSTRUCTION BEGINS.

RATE TABLE

THE FOLLOWING RATES OF APPLICATION HAVE BEEN ASSUMED IN CALCULATING PLAN QUANTITIES.

BITUMINOUS MATERIALS (TACK COAT):	0.05 LBS/SQ FT (MILLING)
	0.025 LBS/SQ FT (HMA LIFTS)
HMA SURFACE MIX "D":	0.056 TONS/SQ YD
AGGREGATE SHOULDERS:	1.60 TONS/CU YD

COMMITMENTS

NONE

STATE OF ILLINOIS DEPARTMENT OF TRANSPORTATION DIVISION OF HIGHWAYS DISTRICT 6	
EXAMINED	September 30 20 20 <i>[Signature]</i> ENGINEER OF OPERATIONS
EXAMINED	September 30 20 20 <i>[Signature]</i> ENGINEER OF PROJECT IMPLEMENTATION
EXAMINED	October 13 20 20 <i>[Signature]</i> ENGINEER OF PROGRAM DEVELOPMENT

MODEL: Default
 FILE NAME: p:\p1planroom.dct\illinois.gov\p1\DOT\Documents\DOT - Offices\District 6\Projects\072196\CAD\Drawings\072196-ah-gennos.dgn

REV. - MS

USER NAME = coxjw	DESIGNED -	REVISED -	STATE OF ILLINOIS DEPARTMENT OF TRANSPORTATION	HIGHWAY STANDARDS, INDEX OF SHEETS, GENERAL NOTES, RATE TABLE, & COMMITMENTS	F.A.U. RTE.	SECTION	COUNTY	TOTAL SHEETS	SHEET NO.	
PLOT SCALE = 100.0000' / in.	DRAWN -	REVISED -			7706	(22) BDR	LOGAN	24	2	
PLOT DATE = 10/16/2020	CHECKED -	REVISED -			CONTRACT NO. 72L96					
	DATE -	REVISED -			ILLINOIS FED. AID PROJECT					

RIPRAP SCHEDULE			28100205
LOCATION	LENGTH (FOOT)	WIDTH (FOOT)	STONE RIPRAP, CLASS A3 (TON)
FAU 7706 (LINCOLN PARKWAY)			
83+00.00 NE QUADRANT	180	SQ FT	20.00
TOTAL			20

TEMPORARY RAMP				40600982
LOCATION	LENGTH (FOOT)	WIDTH (FOOT)	HMA SURF REM BJ (SQ YD)	
FAU 7706 (LINCOLN PARKWAY)				
83+91.00 TO 83+86.00 WB	5.0	31.0	17.22	
83+70.00 TO 83+65.00 EB	5.0	31.0	17.22	
80+48.00 TO 80+43.00 WB	5.0	31.0	17.22	
80+30.00 TO 80+25.00 EB	5.0	31.0	17.22	
TOTAL			69	

HMA SURFACE					40600982	40604060	40600985
LOCATION	LENGTH	WIDTH	HMA	HMA SURF	PCC		
			SURF REM BJ (SQ YD)	CSE IL-9.5 MIX D N50 (TON)	SURF. REM. BJ (SQ YD)		
FAU 7706 (LINCOLN PARKWAY)							
83+91.00 TO 83+56.00 WB	917.0		101.89	9.99	7.78		
83+70.00 TO 83+35.00 EB	1,257.6		139.73	13.69	7.78		
80+78.00 TO 80+43.00 WB	1,307.2		145.24	14.23	7.78		
80+60.00 TO 80+25.00 EB	1,279.7		142.18	13.93	7.78		
TOTAL			529	52	31		

MODIFIED URETHANE PAVEMENT MARKING LINE				78009005
LOCATION	PAVT MK (YELLOW) SKIP-DASH (FOOT)	PAVT MK (WHITE) SOLID (FOOT)	5"	
			FAU 7706 (LINCOLN PARKWAY)	
94+28.00 TO 88+28.00 EB	150.00	600.00		
88+28.00 TO 85+28.00 EB	75.00	300.00		
85+28.00 TO 84+03.00 EB	31.25	125.00		
84+03.00 TO 83+49.00 EB	13.50	54.00		
83+49.00 TO 79+81.00 EB	92.00	736.00		
79+81.00 TO 77+47.00 EB	58.50	234.00		
86+62.00 TO 84+24.00 WB	59.50	238.00		
84+24.00 TO 80+55.00 WB	92.25	738.00		
80+55.00 TO 80+12.00 WB	10.75	43.00		
80+12.00 TO 78+87.00 WB	31.25	125.00		
78+87.00 TO 76+37.00 WB	62.50	250.00		
76+37.00 TO 70+37.00 WB	150.00	600.00		
SUB TOTAL	827	4043		
TOTAL			4876	

HMA SHOULDERS				48203100	44004250	35501314
LOCATION	SHLD THICK (INCHES)	LENGTH (FOOT)	WIDTH (FOOT)	HMA SHLDS (TONS)	PVD SHLD REM (SQ YD)	HMA BASE CSE.7 1/2" (SQ YD)
FAU 7706 (LINCOLN PARKWAY)						
83+91.00 TO 83+56.00 WB	8.00	35.00	7.00	2.29	27.22	27.22
80+92.00 TO 78+75.00 WB	8.00	217.00	7.00	14.18	168.78	168.78
TOTAL				16.5	196.00	196.00

BITUMINOUS MATERIALS TACK COAT					40600290
LOCATION	LENGTH (FOOT)	WIDTH (FOOT)	AREA (SQ FT)	BIT MAT TC MILLING (POUND)	
FAU 7706 (LINCOLN PARKWAY)					
83+91.00 TO 83+56.00 WB	35.0	31.0	1,085.00	54.25	
83+70.00 TO 83+35.00 EB	35.0	31.0	1,085.00	54.25	
80+78.00 TO 80+43.00 WB	35.0	31.0	1,085.00	54.25	
80+60.00 TO 80+25.00 EB	35.0	31.0	1,085.00	54.25	
TOTAL				217	

PAVEMENT MARKING REMOVAL WATER BLASTING			X0327980
LOCATION	PVT MK REM WATER BLASTING (SQ FT)	PVT MK REM WATER BLASTING (SQ FT)	
FAU 7706 (LINCOLN PKWY)			
83+50.00 TO 79+00.00 WB	46.88	187.50	
85+00.00 TO 80+50.00 EB	46.88	187.50	
SUB TOTAL	94	375	
TOTAL		469	

MODEL: Default
 FILE: Model: Pavement.dwg
 PROJECT: 0672196-CADDData-CAD: sheets: 0672196-sh-sched.tbl.dgn
 OFFICE: 0672196-CADDData-CAD: sheets: 0672196-sh-sched.tbl.dgn

USER NAME = coxjw	DESIGNED -	REVISED -
	DRAWN -	REVISED -
PLOT SCALE = 100.0000 ' / in.	CHECKED -	REVISED -
PLOT DATE = 10/16/2020	DATE -	REVISED -

**STATE OF ILLINOIS
DEPARTMENT OF TRANSPORTATION**

**SCHEDULE OF QUANTITIES
FAU 7706 (LINCOLN PKWY)**

F.A.U. RTE.	SECTION	COUNTY	TOTAL SHEETS	SHEET NO.
7706	(22)BBB	LOGAN	24	4
CONTRACT NO. 72L96				
ILLINOIS FED. AID PROJECT				

SCALE: SHEET OF SHEETS STA. TO STA.

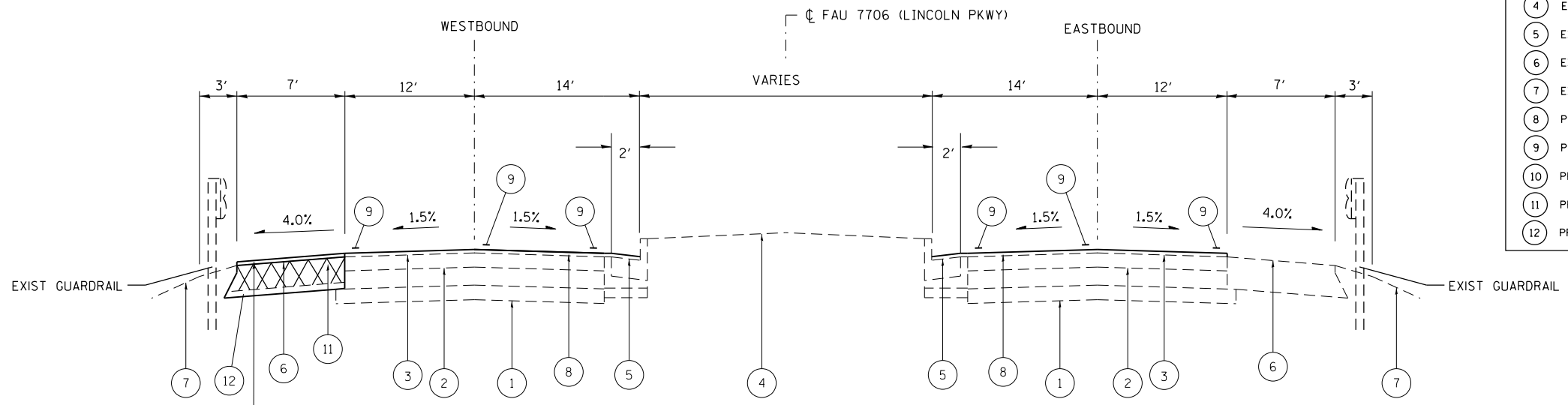

LEGEND

1	EX. SUBBASE
2	EX. BASE
3	EX. HMA OVERLAY
4	EX. RAISED MEDIAN (PCC OR EARTH)
5	EX. CONC CURB & GUTTER
6	EX. HMA SHOULDER
7	EX. AGG. SHOULDER
8	PR. HOT-MIX ASPHALT CONCRETE SURFACE COURSE, MIX D, N70
9	PR. PAINT PAVEMENT MARKING - LINE 5"
10	PR. HOT-MIX ASPHALT SHOULDER 1 1/2"
11	PR. PAVED SHOULDER REMOVAL
12	PR. HOT-MIX ASPHALT BASE COURSE 7 1/2"

TYPICAL SECTION
 WB-STA 78+75.00 TO STA 80+92.00
 EB-STA 80+25.00 TO STA 80+60.00
 WB-STA 83+35.00 TO STA 83+70.00
 EB-STA 83+56.00 TO STA 85+91.00

NOTE:
 PAVED SHLDR REM, HMA BSE CRSE, & HMA SHLDS:
 WB - STA 78+75.00 TO STA 80+92.00
 WB - STA 83+56.00 TO STA 83+91.00

BRIDGE OMISSION - SN 054-0104
 WB STA 80+78.00 TO STA 83+56.00
 EB STA 80+60.00 TO STA 83+35.00

MODEL: Default
 FILE: h:\mfc\p\suplanroom.d\illinois.gov\PWIDOT\Documents\DOT_Offices\District_6\Projects\0672196\CADD\data\CAD\sheet\0672196-ht-typical.dgn

USER NAME = ccoxjw	DESIGNED -	REVISED -
	DRAWN -	REVISED -
PLOT SCALE = 40.0000' / in.	CHECKED -	REVISED -
PLOT DATE = 10/16/2020	DATE -	REVISED -

**STATE OF ILLINOIS
 DEPARTMENT OF TRANSPORTATION**

ROADWAY TYPICAL SECTION

SCALE: SHEET 1 OF 1 SHEETS STA. TO STA.

F.A.U. RTE.	SECTION	COUNTY	TOTAL SHEETS	SHEET NO.
7706	(22) BDR	LOGAN	24	5
CONTRACT NO. 72L96			ILLINOIS FED. AID PROJECT	

MODEL: Default
 FILE: h:\a\c\p\suplanroom\fa\illinois.gov\PWIDOT\Documents\DOT_Offices\District_6\Projects\0672L96\CADD\data\CAD\sheet\0672L96-sh1b.dgn

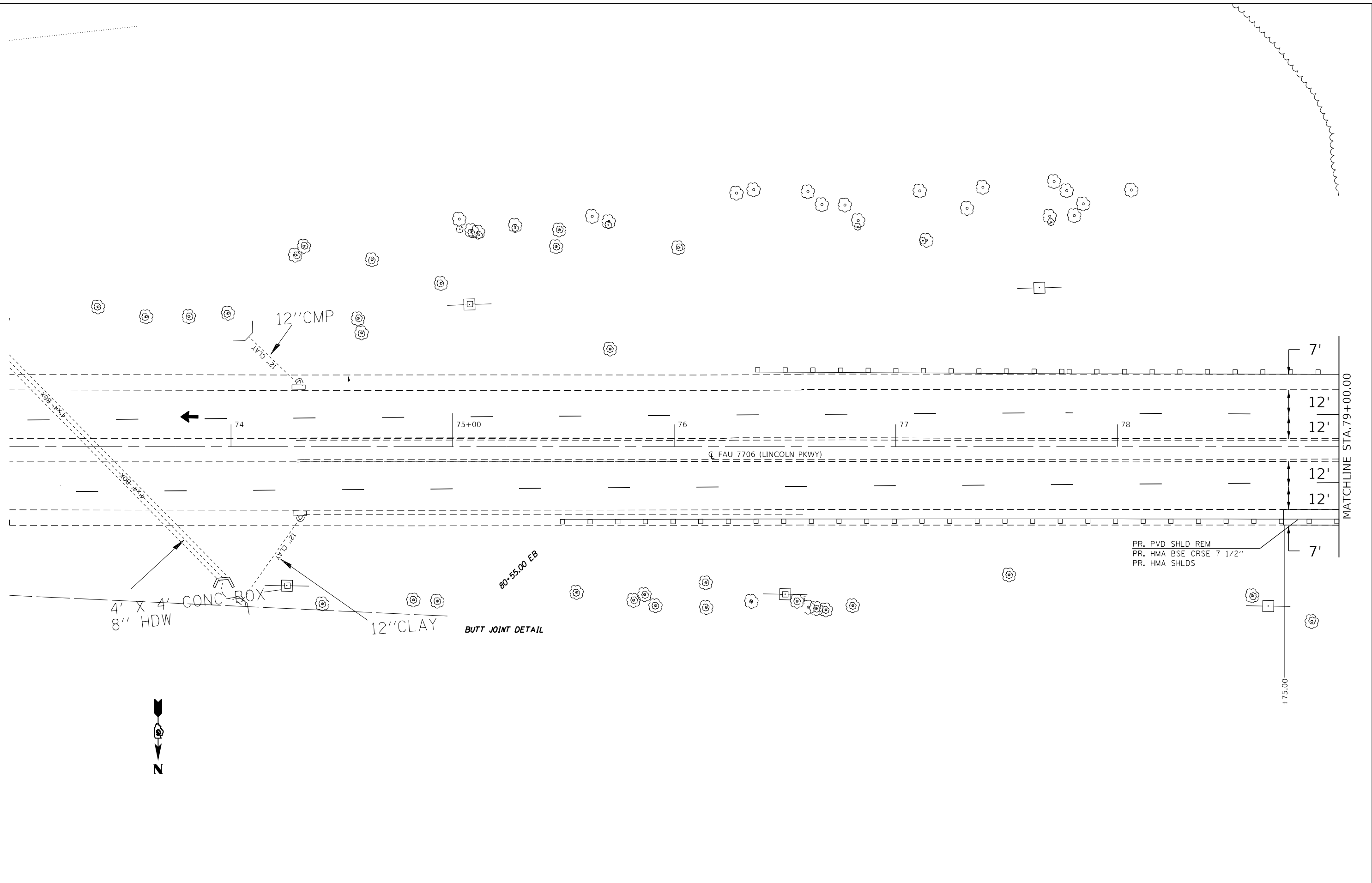

PR. PVD SHLD REM
 PR. HMA BSE CRSE 7 1/2"
 PR. HMA SHLDS

4' X 4' CONC BOX
 8" HDW

12" CLAY
 BUTT JOINT DETAIL

80+55.00 EB

CL FAU 7706 (LINCOLN PKWY)

MATCHLINE STA. 79+00.00



USER NAME = coxjw	DESIGNED -	REVISED -
	DRAWN -	REVISED -
PLOT SCALE = 40.0000 ' / in.	CHECKED -	REVISED -
PLOT DATE = 10/16/2020	DATE -	REVISED -

STATE OF ILLINOIS
DEPARTMENT OF TRANSPORTATION

PLAN SHEET
FAU 7706 (LINCOLN PARKWAY)

SCALE: 20 SHEET 1 OF 3 SHEETS STA. 73+00.00 TO STA. 79+00.00

F.A.U. RTE.	SECTION	COUNTY	TOTAL SHEETS	SHEET NO.
7706	(22)BDR	LINCOLN	24	6
CONTRACT NO. 72L96				
ILLINOIS FED. AID PROJECT				

BUTT JOINT DETAIL

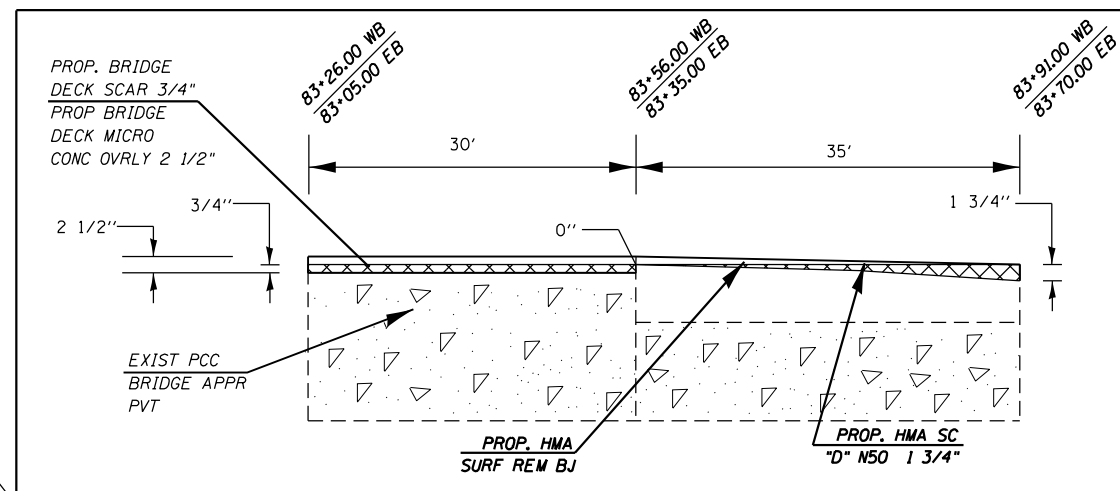

PR HMA SURF
REM BJ
PR HMA SC "D"
N50

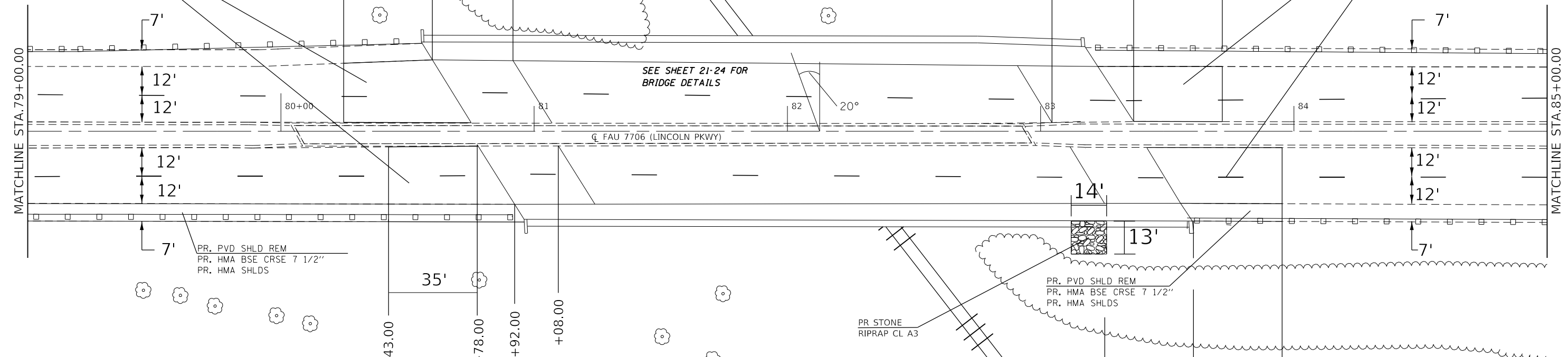

SEE SHEET 21-24 FOR
BRIDGE DETAILS

FAU 7706 (LINCOLN PKWY)

BUTT JOINT DETAIL

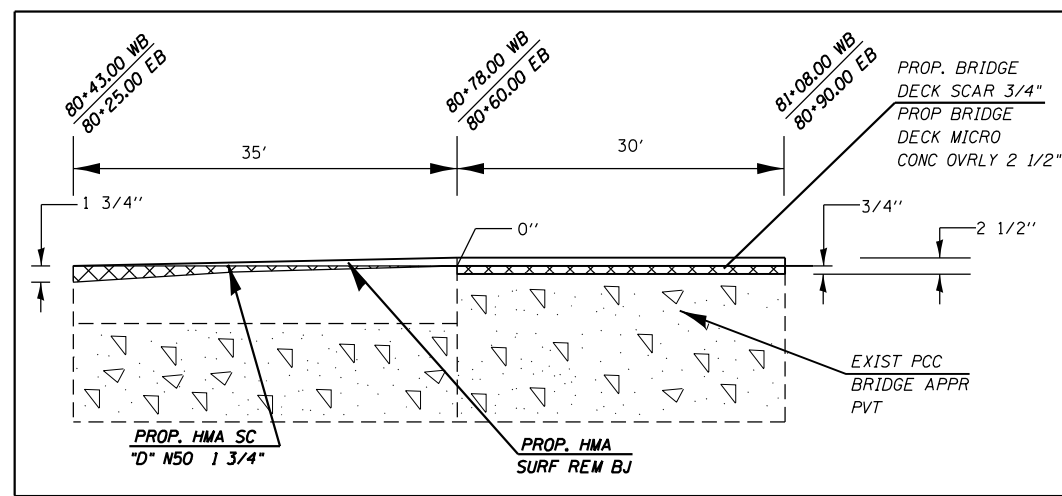

PR. PVD SHLD REM
PR. HMA BSE CRSE 7 1/2"
PR. HMA SHLDS

PR STONE
RIPRAP CL A3

PRE-STAGE I:
HMA BSE CRSE 7 1/2", HMA SHOULDERS & PVD SHLD REM
WB STA 78+75.00 TO STA 80+92.00 & STA 83+56.00 TO STA 83+91.00

MODEL: Default
FILE: hma16c_pvauplanroom.dwg
PROJECT: 0672196_CADDData\CADDsheets\0672196-sha16b.dwg

USER NAME = coxjw	DESIGNED -	REVISED -
	DRAWN -	REVISED -
PLOT SCALE = 40.0000' / in.	CHECKED -	REVISED -
PLOT DATE = 10/16/2020	DATE -	REVISED -

STATE OF ILLINOIS
DEPARTMENT OF TRANSPORTATION

PLAN SHEET
FAU 7706 (LINCOLN PARKWAY)

SCALE: 20 SHEET 2 OF 3 SHEETS STA. 79+00.00 TO STA. 85+00.00

F.A.U. RTE. 7706	SECTION (22)BDR	COUNTY LINCOLN	TOTAL SHEETS 24	SHEET NO. 7
				CONTRACT NO. 72L96
ILLINOIS FED. AID PROJECT				

MODEL: Default
 FILE: \\nlsdpc-pub\pub\room\dat\illinois.gov\PWIDOT\Documents\IDOT_Offices\District_6\Projects\0672196\CADD\data\CAD\sheet\0672196-sh-1b1n.dgn

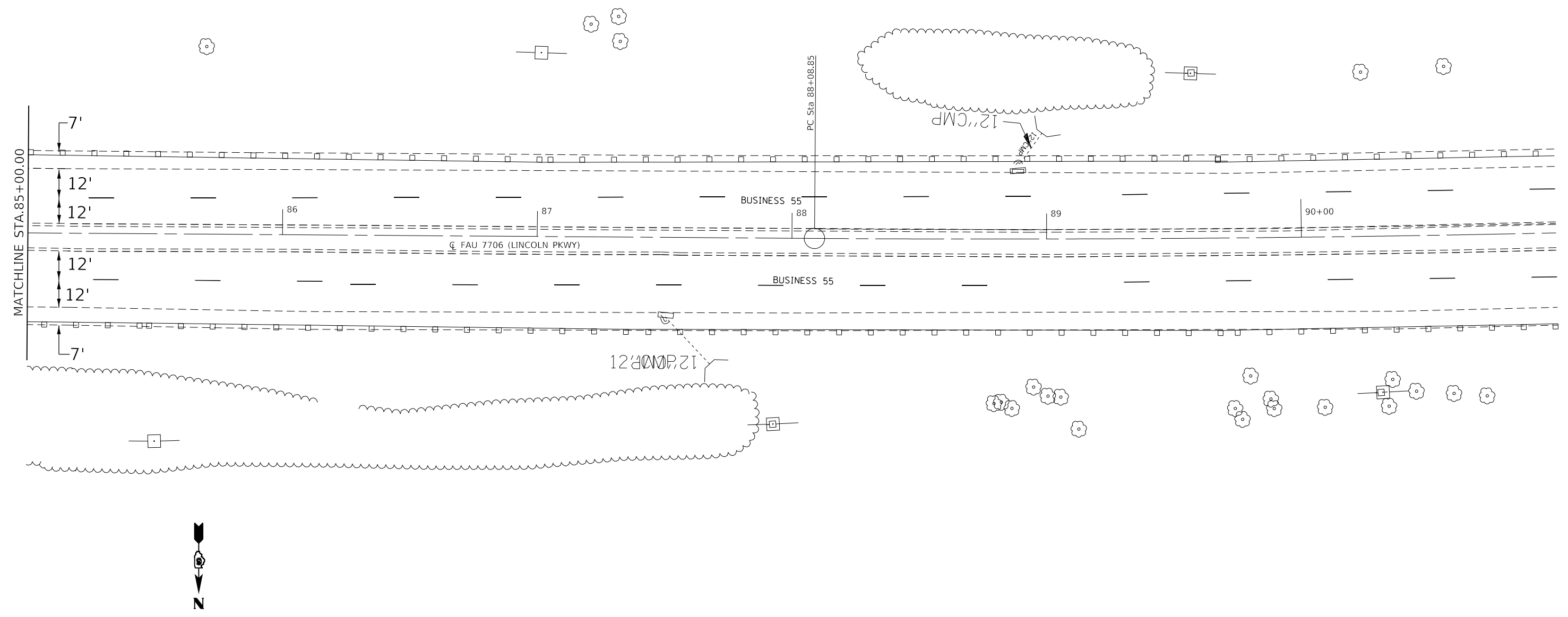

USER NAME = coxjw	DESIGNED -	REVISED -
	DRAWN -	REVISED -
PLOT SCALE = 40,0000 ' / in.	CHECKED -	REVISED -
PLOT DATE = 10/16/2020	DATE -	REVISED -

**STATE OF ILLINOIS
 DEPARTMENT OF TRANSPORTATION**

**PLAN SHEET
 FAU 7706 (LINCOLN PARKWAY)**

SCALE: 20 SHEET 3 OF 3 SHEETS STA. 85+00.00 TO STA. 91+00.00

F.A.U. RTE.	SECTION	COUNTY	TOTAL SHEETS	SHEET NO.
7706	(22)BDR	LINCOLN	24	8
ILLINOIS FED. AID PROJECT			CONTRACT NO. 72L96	

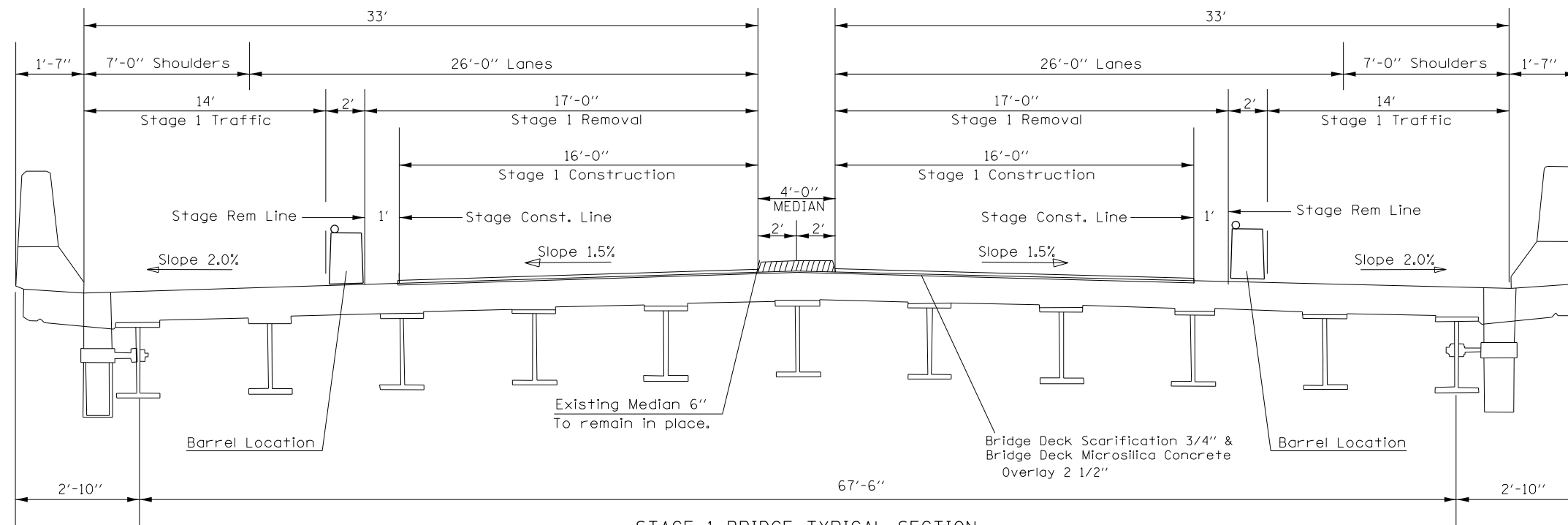

STAGE 1 BRIDGE TYPICAL SECTION

WB - STA 83+56.00 TO STA 80+78.00
 EB - STA 83+35.00 TO STA 80+60.00

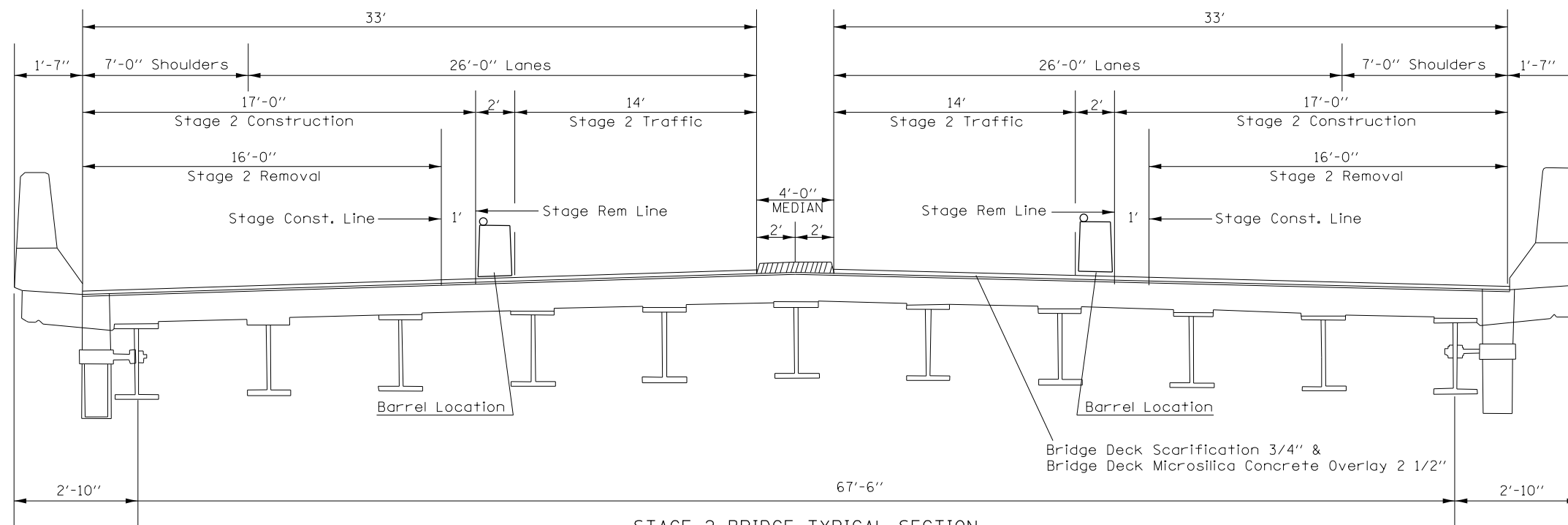

STAGE 2 BRIDGE TYPICAL SECTION

WB - STA 83+56.00 TO STA 80+78.00
 EB - STA 83+35.00 TO STA 80+60.00

MODEL: Default
 FILE: h:\mhc\p\suplanroom.d\at\illinois.gov\PIWDOT\Documents\DOT_Offices\District_6\Projects\0672196\ht-staging\stg.dgn

USER NAME = ccoxjw	DESIGNED -	REVISED -
	DRAWN -	REVISED -
PLOT SCALE = 40.0000' / in.	CHECKED -	REVISED -
PLOT DATE = 10/16/2020	DATE -	REVISED -



**STATE OF ILLINOIS
 DEPARTMENT OF TRANSPORTATION**

**STAGING TYPICAL SECTIONS
 FAU 7706 (LINCOLN PKWY)**

SCALE: SHEET 1 OF 1 SHEETS STA. TO STA.

F.A.U. RTE.	SECTION	COUNTY	TOTAL SHEETS	SHEET NO.
7706	22(BDR)	LOGAN	24	9
CONTRACT NO. 72L96				
ILLINOIS FED. AID PROJECT				

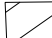
LEGEND

-  DRUM WITH STEADY BURNING LIGHTS
-  WORK AREA
-  DIRECTION OF TRAFFIC
-  SIGN

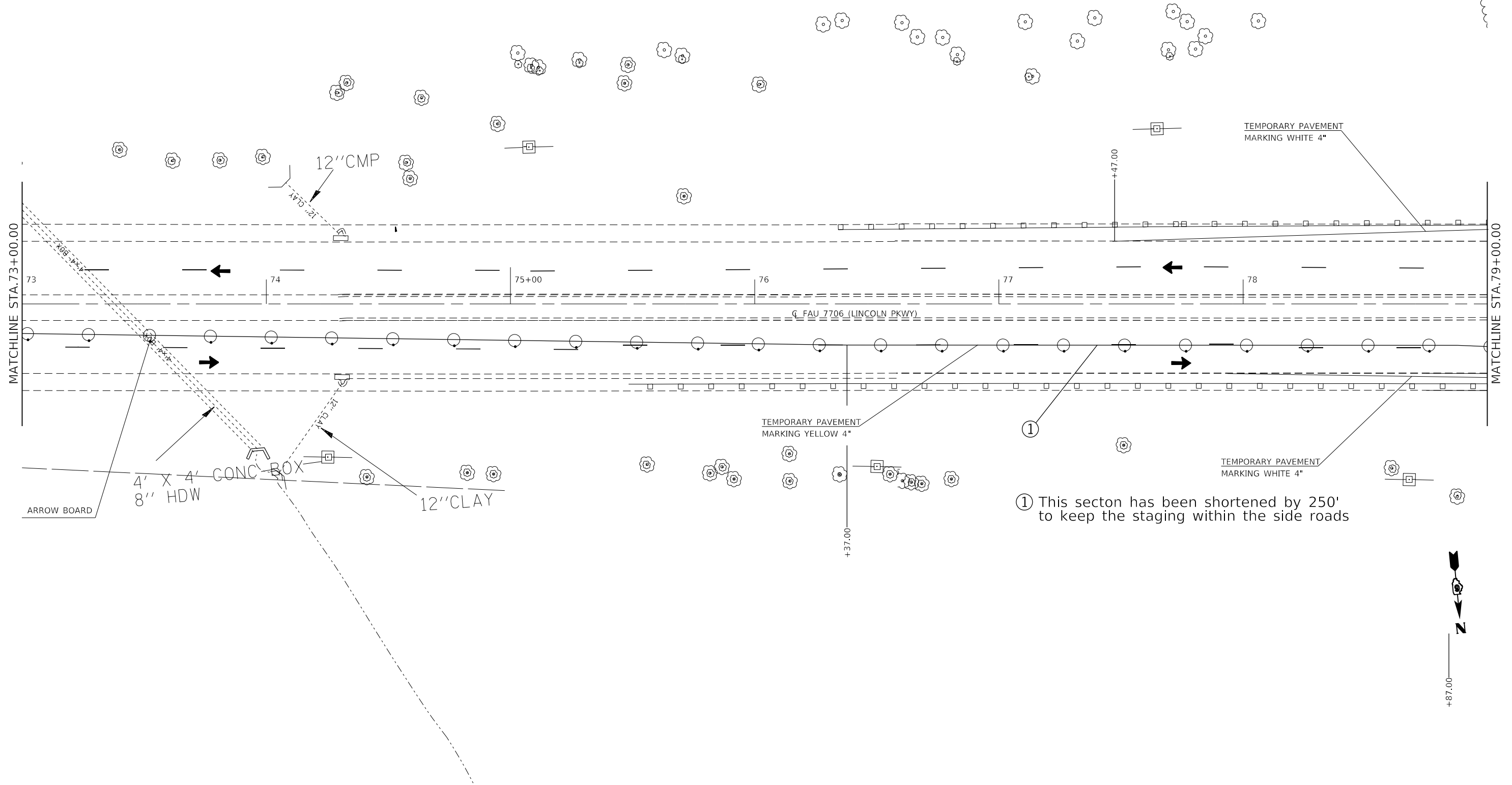

① This section has been shortened by 250' to keep the staging within the side roads

MODEL: Default
 FILE: h:\mhc\p\suplanroom.dwg
 PROJECT: 72L96
 OFFICE: IDOT
 DATE: 10/16/2020





USER NAME = coxjw	DESIGNED -	REVISED -
DRAWN -	REVISED -	
PLOT SCALE = 40.0000 ' / in.	CHECKED -	REVISED -
PLOT DATE = 10/16/2020	DATE -	REVISED -

**STATE OF ILLINOIS
DEPARTMENT OF TRANSPORTATION**

TRAFFIC CONTROL PLAN - STAGE 1			
FAU 7706 (LINCOLN PARKWAY)			
SCALE: 20	SHEET 3	OF 6 SHEETS	STA. 73+00.00 TO STA. 79+00.00

F.A.U. RTE.	SECTION	COUNTY	TOTAL SHEETS	SHEET NO.
7706	(22)BDR	LINCOLN	24	11
CONTRACT NO. 72L96				
ILLINOIS FED. AID PROJECT				

LEGEND

-  DRUM WITH STEADY BURNING LIGHTS
-  WORK AREA
-  DIRECTION OF TRAFFIC
-  SIGN

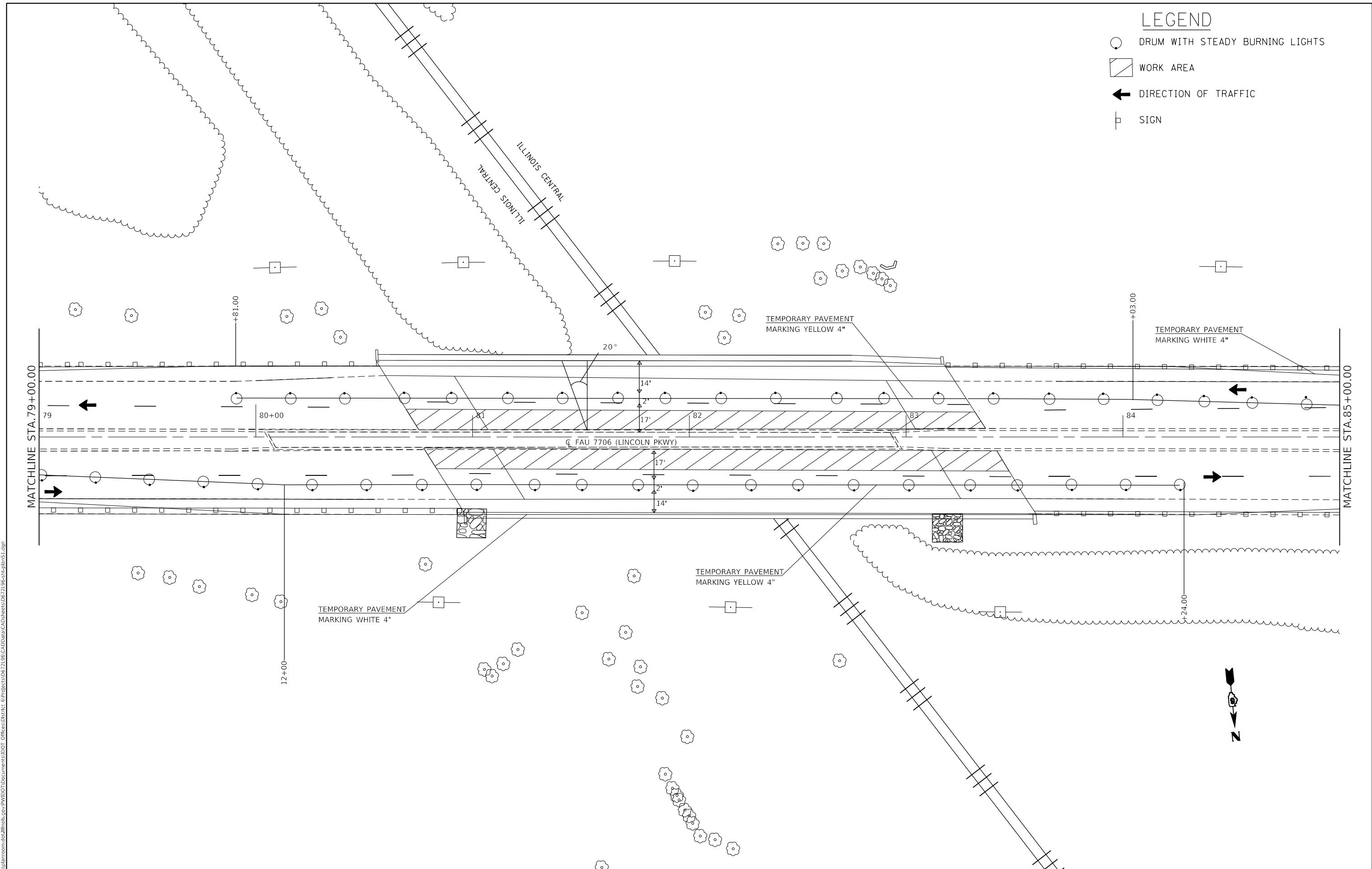

MODEL: Default
 FILE: \\nlsr01\pub\baronm.dwg
 PROJECT: \\nlsr01\pub\baronm.dwg
 OFFICE: \\nlsr01\pub\baronm.dwg
 DATE: 10/16/2020

USER NAME = coxjw	DESIGNED -	REVISED -
PLOT SCALE = 40.0000 ' / in.	DRAWN -	REVISED -
PLOT DATE = 10/16/2020	CHECKED -	REVISED -
	DATE -	REVISED -





STATE OF ILLINOIS
DEPARTMENT OF TRANSPORTATION

TRAFFIC CONTROL PLAN - STAGE 1
FAU 7706 (LINCOLN PARKWAY)

SCALE: 20 SHEET 4 OF 6 SHEETS STA. 79+00.00 TO STA. 85+00.00

F.A.U. RTE.	SECTION	COUNTY	TOTAL SHEETS	SHEET NO.
7706	(22)BDR	LINCOLN	24	12
CONTRACT NO. 72L96				
ILLINOIS FED. AID PROJECT				

LEGEND

-  DRUM WITH STEADY BURNING LIGHTS
-  WORK AREA
-  DIRECTION OF TRAFFIC
-  SIGN

② This section has been shortened by 200' to keep the staging within the side roads

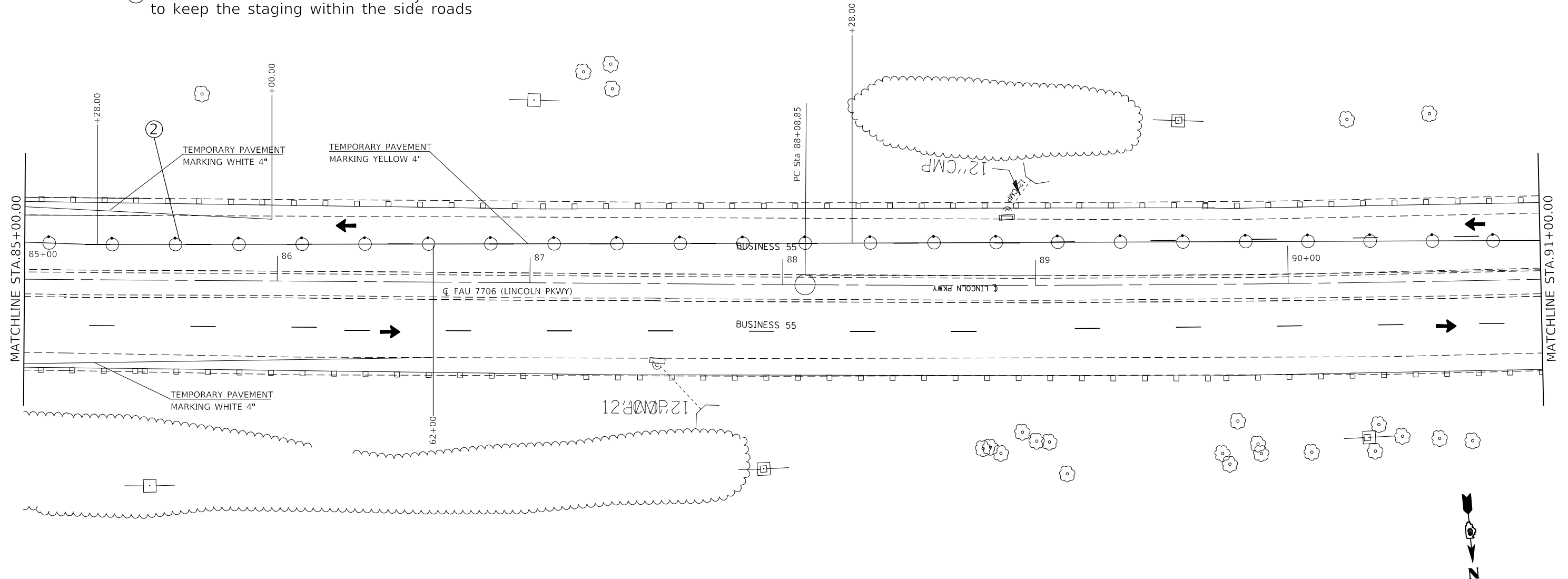

MODEL: Default
 FILE: h:\m\c:\pub\planroom\dat\illinois.gov\p\w\DOT\Documents\DOT_Offices\Director @Projects\0672196\CADD\data\CAD\sheet\0672196-sh1-bn51.dgn

USER NAME = coxjw	DESIGNED -	REVISED -
	DRAWN -	REVISED -
PLOT SCALE = 40.0000 ' / in.	CHECKED -	REVISED -
PLOT DATE = 10/16/2020	DATE -	REVISED -



**STATE OF ILLINOIS
 DEPARTMENT OF TRANSPORTATION**

**TRAFFIC CONTROL PLAN - STAGE 1
 FAU7706 (LINCOLN PARKWAY)**

SCALE: 20 SHEET 5 OF 6 SHEETS STA. 85+00.00 TO STA. 91+00.00

F.A.U. RTE.	SECTION	COUNTY	TOTAL SHEETS	SHEET NO.
7706	(22)BDR	LINCOLN	24	13
CONTRACT NO. 72L96				
ILLINOIS FED. AID PROJECT				

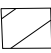
LEGEND

-  DRUM WITH STEADY BURNING LIGHTS
-  WORK AREA
-  DIRECTION OF TRAFFIC
-  SIGN

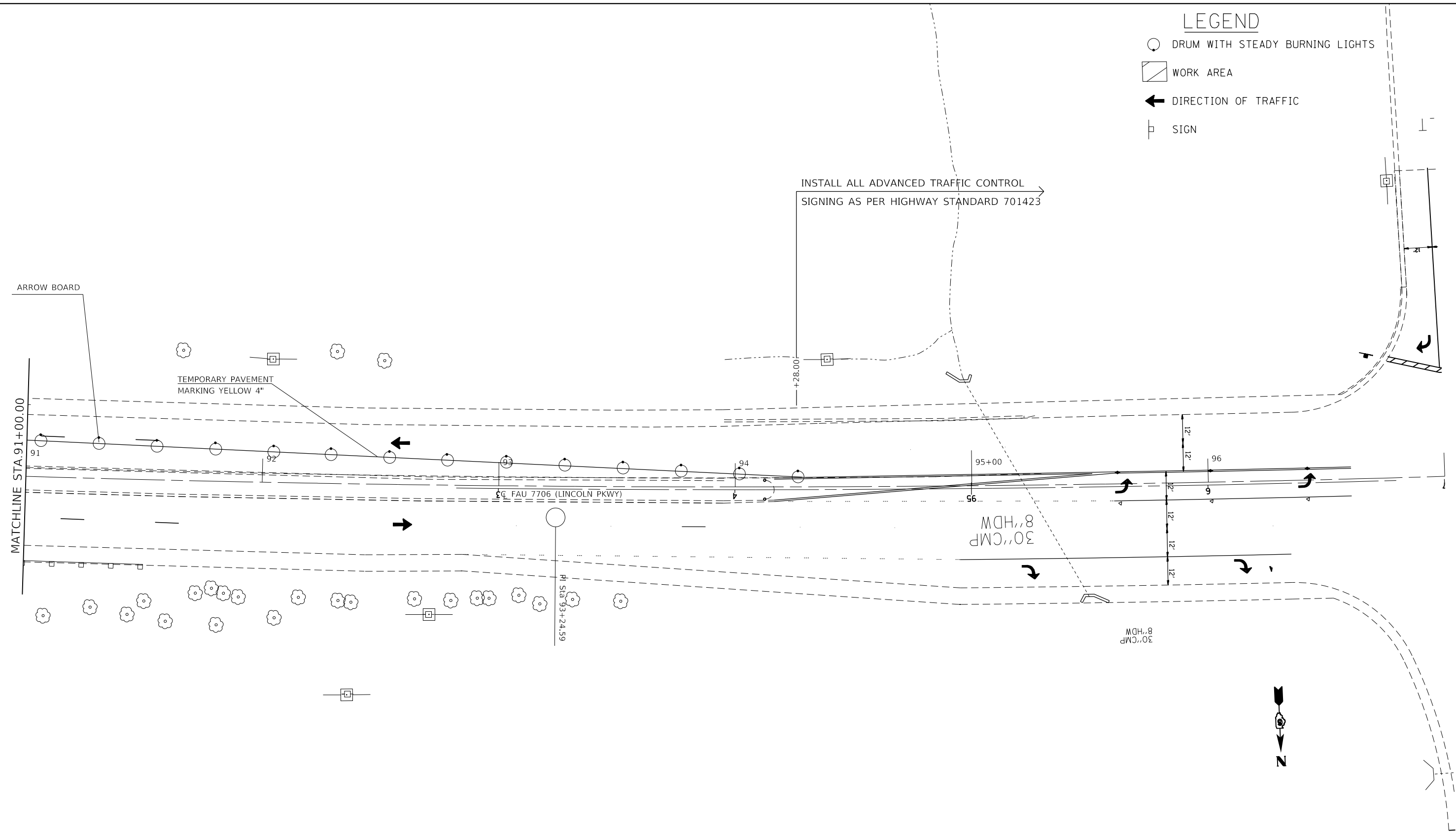

MODEL: Default
 FILE: h:\m\c\p\suplanroom.dwg
 PROJECT: RWIDOT\Documents\DOT_Offices\District_6\Projects\7706\7706-01\7706-01.dwg





USER NAME = coxjw	DESIGNED -	REVISED -
	DRAWN -	REVISED -
PLOT SCALE = 40.0000 ' / in.	CHECKED -	REVISED -
PLOT DATE = 10/16/2020	DATE -	REVISED -

STATE OF ILLINOIS
DEPARTMENT OF TRANSPORTATION

TRAFFIC CONTROL PLAN - STAGE 1 FAU 7706 (LINCOLN PARKWAY)			
SCALE: 20	SHEET 6 OF 6 SHEETS	STA. 91+00.00 TO STA. 97+00.00	

F.A.U. RTE. 7706	SECTION (22)BDR	COUNTY LINCOLN	TOTAL SHEETS 24	SHEET NO. 14
CONTRACT NO. 72L96				
ILLINOIS FED. AID PROJECT				

LEGEND

-  DRUM WITH STEADY BURNING LIGHTS
-  WORK AREA
-  DIRECTION OF TRAFFIC
-  SIGN

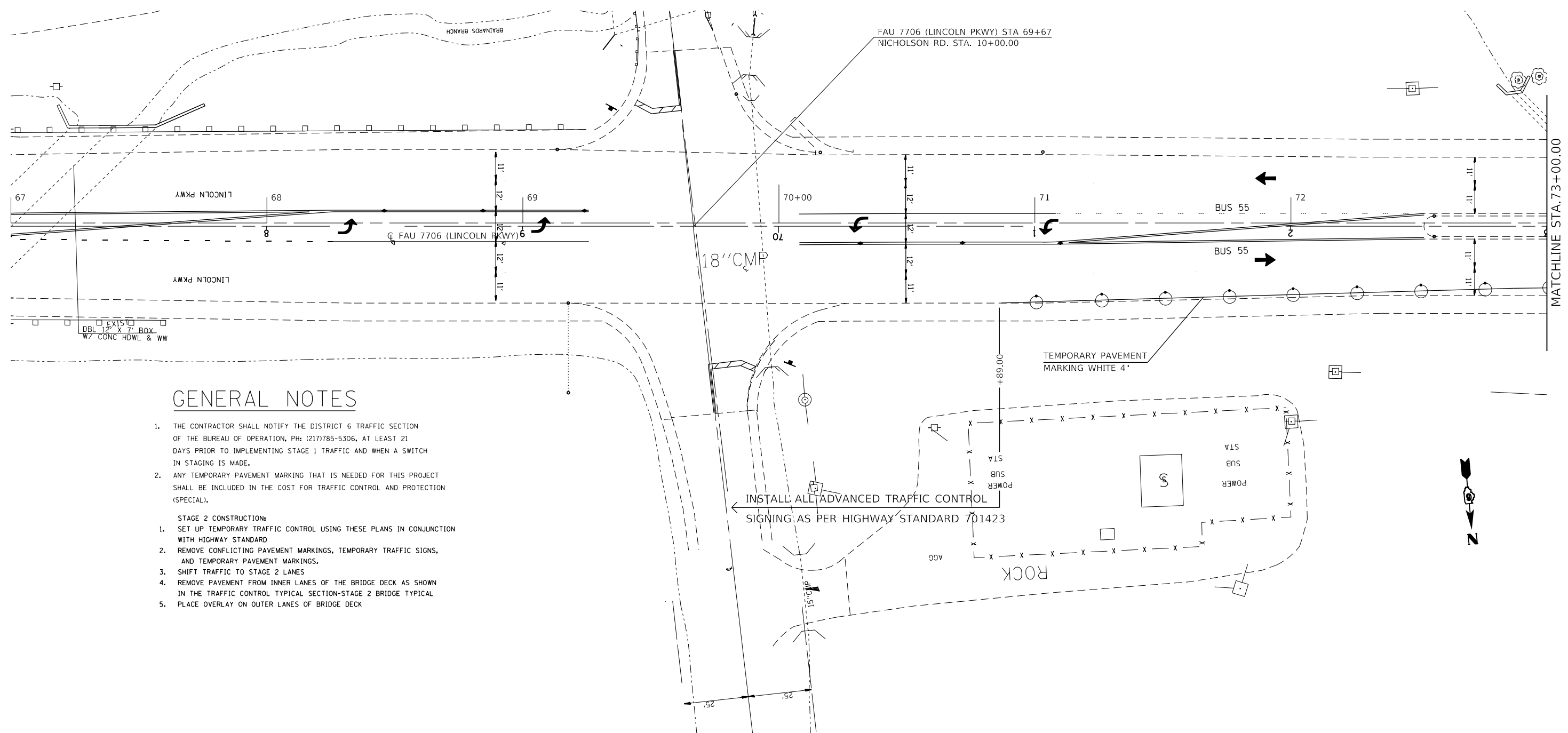

GENERAL NOTES

1. THE CONTRACTOR SHALL NOTIFY THE DISTRICT 6 TRAFFIC SECTION OF THE BUREAU OF OPERATION, PH: (217)785-5306, AT LEAST 21 DAYS PRIOR TO IMPLEMENTING STAGE 1 TRAFFIC AND WHEN A SWITCH IN STAGING IS MADE.
 2. ANY TEMPORARY PAVEMENT MARKING THAT IS NEEDED FOR THIS PROJECT SHALL BE INCLUDED IN THE COST FOR TRAFFIC CONTROL AND PROTECTION (SPECIAL).
- STAGE 2 CONSTRUCTION:**
1. SET UP TEMPORARY TRAFFIC CONTROL USING THESE PLANS IN CONJUNCTION WITH HIGHWAY STANDARD
 2. REMOVE CONFLICTING PAVEMENT MARKINGS, TEMPORARY TRAFFIC SIGNS, AND TEMPORARY PAVEMENT MARKINGS.
 3. SHIFT TRAFFIC TO STAGE 2 LANES.
 4. REMOVE PAVEMENT FROM INNER LANES OF THE BRIDGE DECK AS SHOWN IN THE TRAFFIC CONTROL TYPICAL SECTION-STAGE 2 BRIDGE TYPICAL
 5. PLACE OVERLAY ON OUTER LANES OF BRIDGE DECK

MODEL: Default
 FILE: h:\m\c\p\pub\barroom.dwg
 PROJECT: 7706
 OFFICE: DISTRICT 6
 DATE: 10/16/2020





USER NAME = coxjw	DESIGNED -	REVISED -
PLOT SCALE = 40.0000 ' / in.	DRAWN -	REVISED -
PLOT DATE = 10/16/2020	CHECKED -	REVISED -
	DATE -	REVISED -

STATE OF ILLINOIS
DEPARTMENT OF TRANSPORTATION

TRAFFIC CONTROL PLAN - STAGE 2			
FAU 7706 (LINCOLN PARKWAY)			
SCALE:	SHEET	OF SHEETS	STA. TO STA.

F.A.P. RTE.	SECTION	COUNTY	TOTAL SHEETS	SHEET NO.
7706	(22)BDR	LOGAN	24	15
CONTRACT NO. 72L96				
ILLINOIS FED. AID PROJECT				

LEGEND

-  DRUM WITH STEADY BURNING LIGHTS
-  WORK AREA
-  DIRECTION OF TRAFFIC
-  SIGN

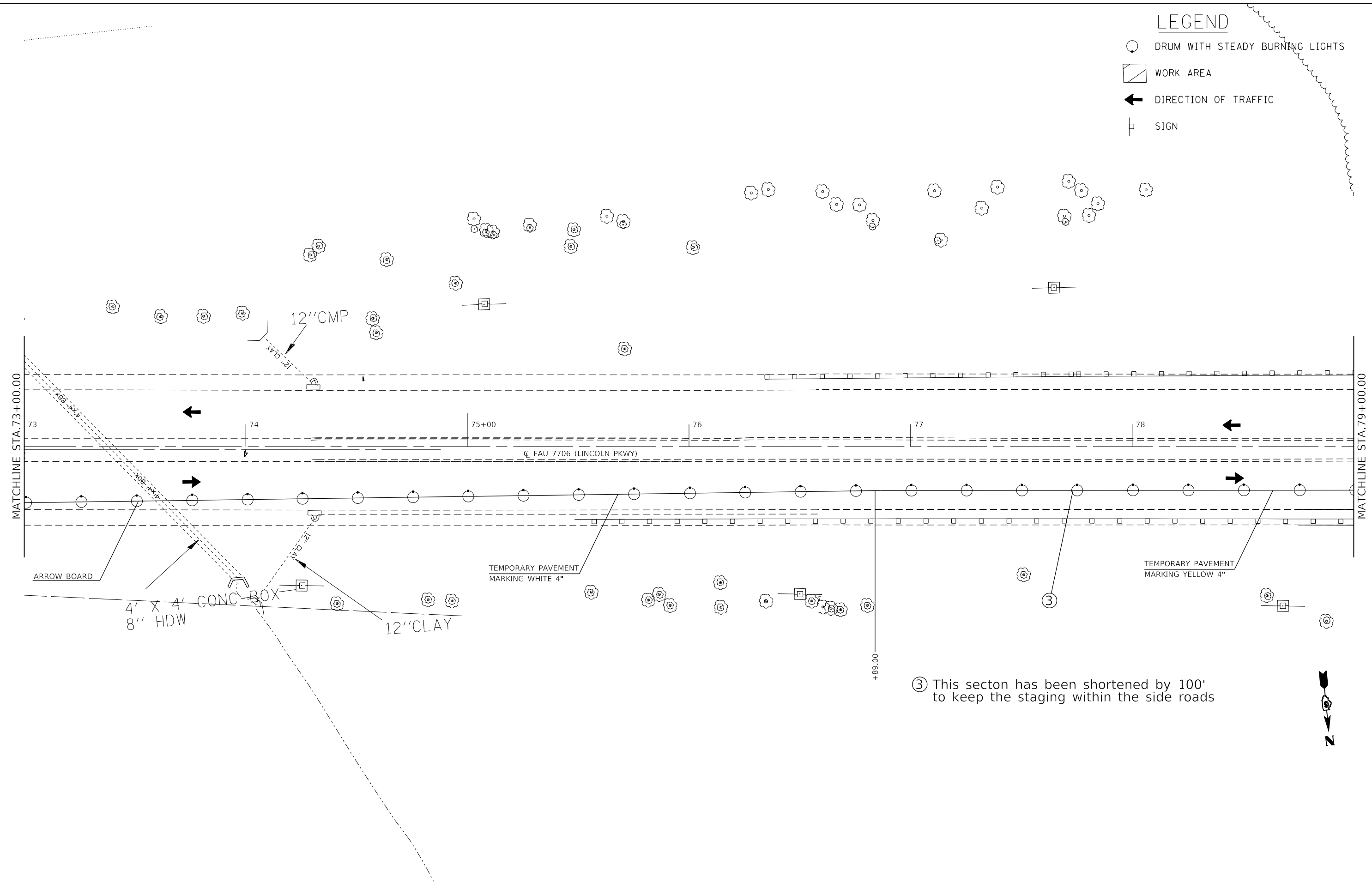

MODEL: Default
 FILE: h:\m\c\p\suplanroom.d\illinois.gov\PWIDOT\Documents\DOT_Offices\District_6\Projects\7706\7706-06-01-01-01.dwg

USER NAME = coxjw	DESIGNED -	REVISED -
DRAWN -	REVISED -	
PLOT SCALE = 40.0000' / in.	CHECKED -	REVISED -
PLOT DATE = 10/16/2020	DATE -	REVISED -



**STATE OF ILLINOIS
DEPARTMENT OF TRANSPORTATION**

**TRAFFIC CONTROL PLAN - STAGE 2
FAU 7706 (LINCOLN PARKWAY)**

SCALE: SHEET OF SHEETS STA. TO STA.

F.A.P. RTE.	SECTION	COUNTY	TOTAL SHEETS	SHEET NO.
7706	(22)BDR	LOGAN	24	16
CONTRACT NO. 72L96				
ILLINOIS FED. AID PROJECT				

LEGEND

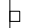
-  DRUM WITH STEADY BURNING LIGHTS
-  WORK AREA
-  DIRECTION OF TRAFFIC
-  SIGN

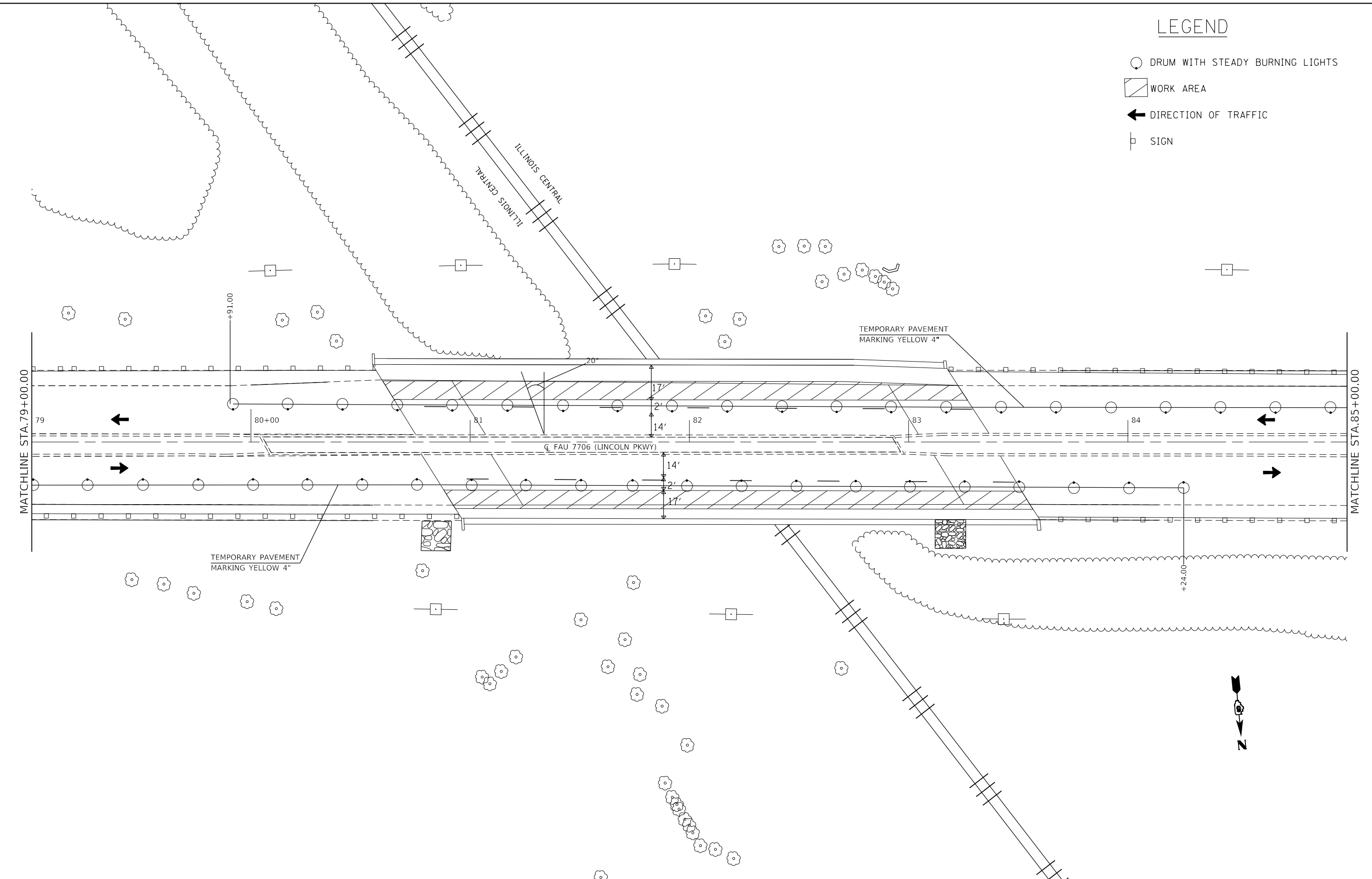

MODEL: Default
 FILE: \\nashville.pva\pub\baronum.dwg
 PROJECT: \\nashville.pva\pub\baronum.dwg
 OFFICE: \\nashville.pva\pub\baronum.dwg
 DATE: 10/16/2020

USER NAME = coxjw	DESIGNED -	REVISED -
PLOT SCALE = 40.0000 ' / in.	DRAWN -	REVISED -
PLOT DATE = 10/16/2020	CHECKED -	REVISED -
	DATE -	REVISED -





STATE OF ILLINOIS
DEPARTMENT OF TRANSPORTATION

TRAFFIC CONTROL PLAN - STAGE 2
FAU 7706 (LINCOLN PARKWAY)

SCALE: SHEET OF SHEETS STA. TO STA.

F.A.P. RTE.	SECTION	COUNTY	TOTAL SHEETS	SHEET NO.
7706	(22) BDR	LOGAN	24	17
CONTRACT NO. 72L96				
ILLINOIS FED. AID PROJECT				

LEGEND

-  DRUM WITH STEADY BURNING LIGHTS
-  WORK AREA
-  DIRECTION OF TRAFFIC
-  SIGN

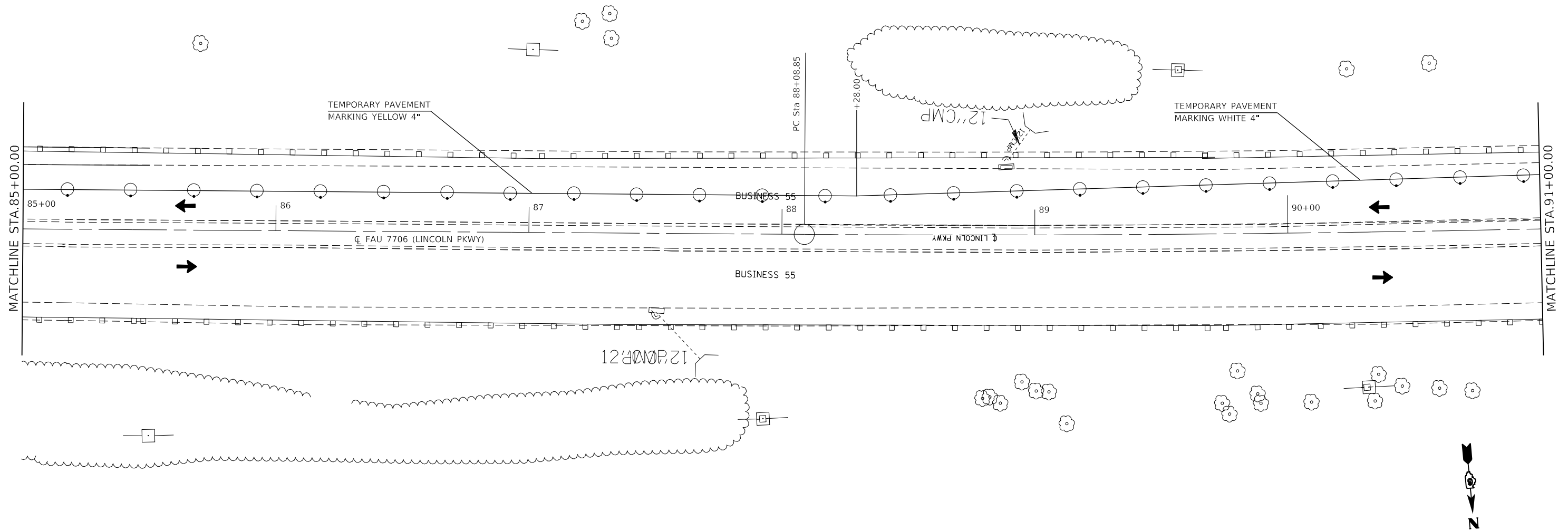

MODEL: Default
 FILE: h:\mhc\p\suplanroom\dat\illinois.gov\PWIDOT\Documents\DOT_Offices\District_6\Projects\0672L96\CADD\data\CAD\sheet\0672L96-sh2-blan52.dgn

USER NAME = coxjw	DESIGNED -	REVISED -
	DRAWN -	REVISED -
PLOT SCALE = 40,0000 ' / in.	CHECKED -	REVISED -
PLOT DATE = 10/16/2020	DATE -	REVISED -

**STATE OF ILLINOIS
DEPARTMENT OF TRANSPORTATION**

**TRAFFIC CONTROL PLAN - STAGE 2
FAU 7706 (LINCOLN PARKWAY)**

SCALE: SHEET OF SHEETS STA. TO STA.

F.A.P. RTE.	SECTION	COUNTY	TOTAL SHEETS	SHEET NO.
7706	(22)BDR	LOGAN	24	18
CONTRACT NO. 72L96				
		ILLINOIS	FED. AID PROJECT	

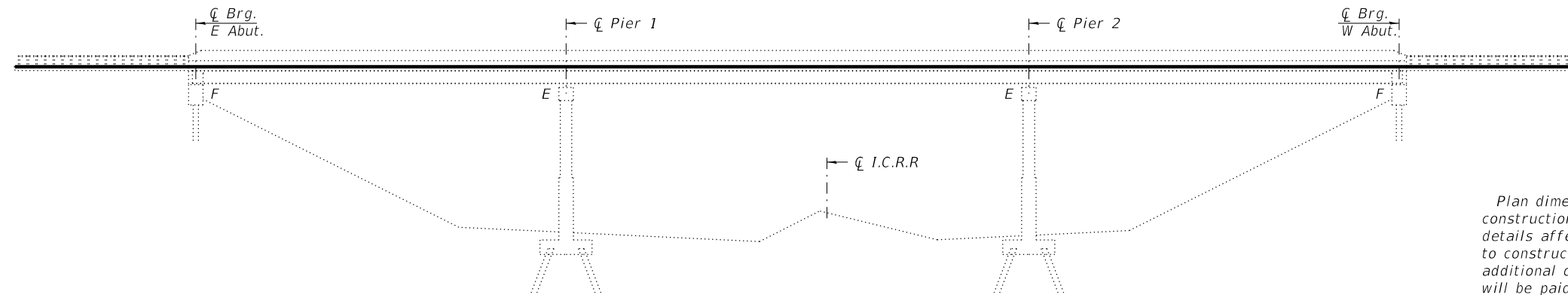

ELEVATION

GENERAL NOTES

Plan dimensions and details relative to existing plans are subject to nominal construction variations. The Contractor shall field verify existing dimensions and details affecting new construction and make necessary approved adjustments prior to construction or ordering of materials. Such variations shall not be cause for additional compensation for a change in scope of the work, however, the Contractor will be paid for the quantity actually furnished at the unit price bid for the work. Synthetic fibers shall be added to the bridge deck microsilica concrete overlay. See Special provisions.

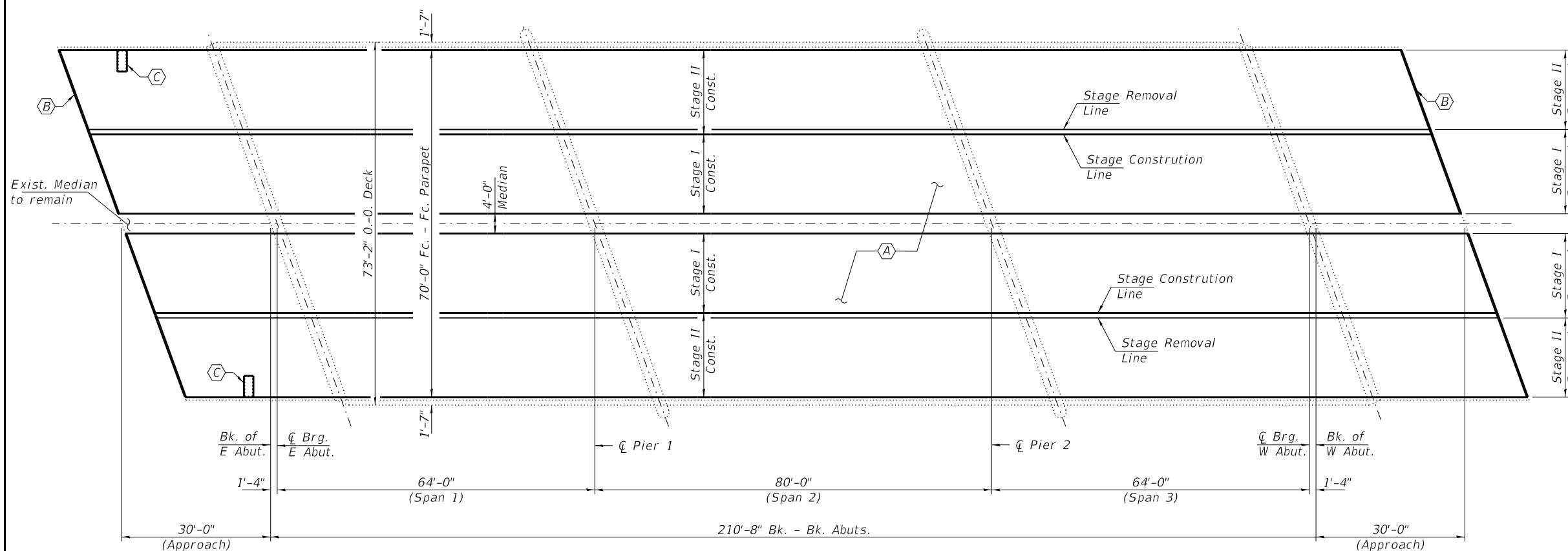

PLAN

- (A) - Bridge Deck Scarification $\frac{3}{4}$ " and $2\frac{1}{2}$ " Microsilica Concrete Overlay
- (B) - Polymer Concrete Nosing (See Detail B)
- (C) - Scupper Adjustment



Expires 11/30/2022

TOTAL BILL OF MATERIAL

ITEM	UNIT	QUANTITY
Bridge Deck Microsilica Concrete Overlay, $2\frac{1}{2}$ "	Sq. Yd.	1545
Bridge Deck Scarification, $\frac{3}{4}$ "	Sq. Yd.	1545
Polymer Concrete	Cu. Ft.	8.5
Protective Coat	Sq. Yd.	1545
Bridge Deck Grooving	Sq. Yd.	1451
* Deck Slab Repair (Full Depth, Type I)	Sq. Yd.	10
Drainage Scuppers to be Adjusted	Each	2

* No full depth patches are identified. Nominal quantity included

DESIGNED - Victor H. Veliz	EXAMINED - <i>Tim A. Beck</i>	DATE - NOVEMBER 25, 2020
CHECKED - Jeffrey Burke	ENGINEER OF STRUCTURAL SERVICES	
DRAWN - Venkat Reddy	PASSED - <i>David Carl Puzey</i>	REVISD -
CHECKED - VHV JSB	ENGINEER OF BRIDGES AND STRUCTURES	REVISD -

**STATE OF ILLINOIS
DEPARTMENT OF TRANSPORTATION**

**GENERAL PLAN AND ELEVATION
OLD US 66 OVER I.C.R.R.
SN 054 - 0104**

F.A.U. RTE.	SECTION	COUNTY	TOTAL SHEETS	SHEET NO.
7706	(22 BDR)	LOGAN	24	21
CONTRACT NO. 72L96				

SHEET NO. 1 OF 4 SHEETS

ILLINOIS FED. AID PROJECT

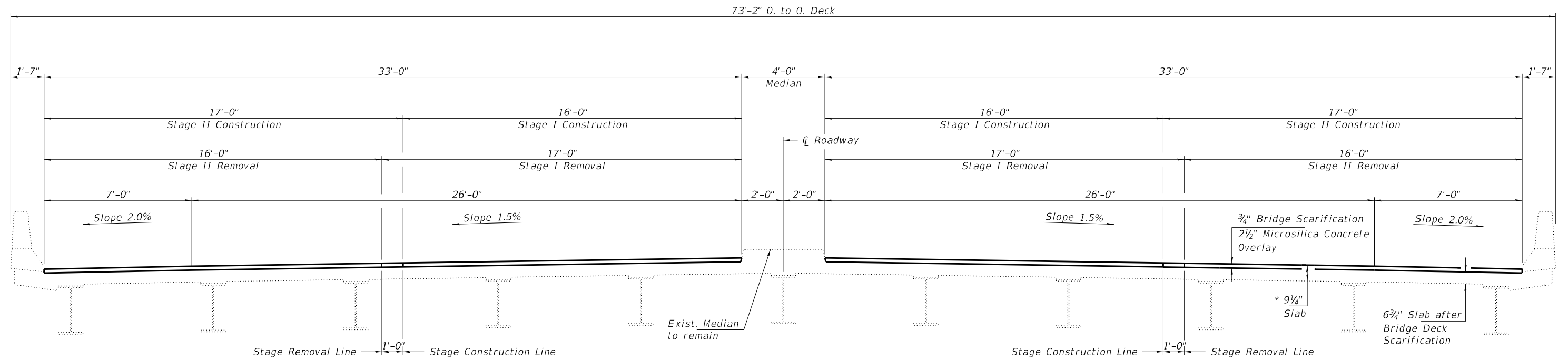

CROSS SECTION
(Looking West)

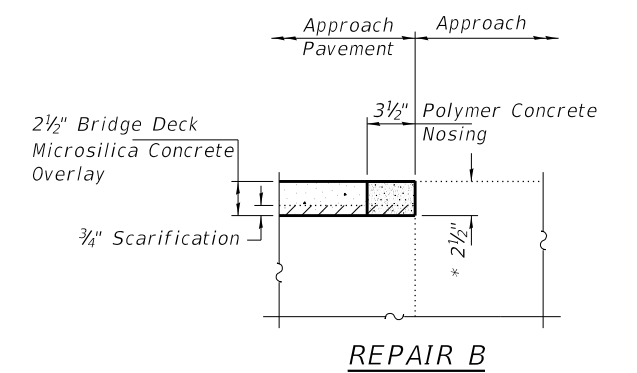
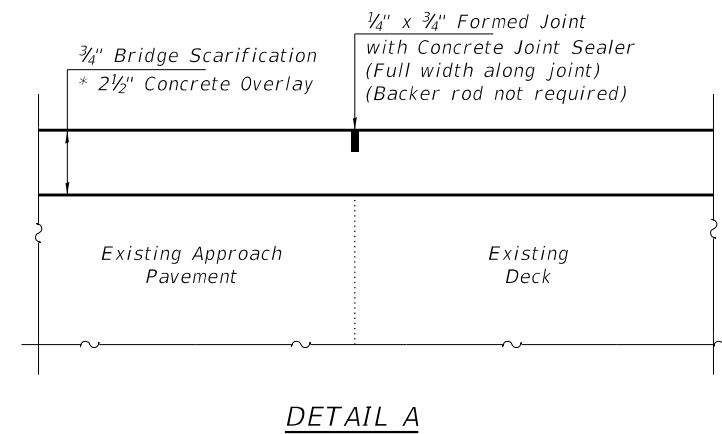
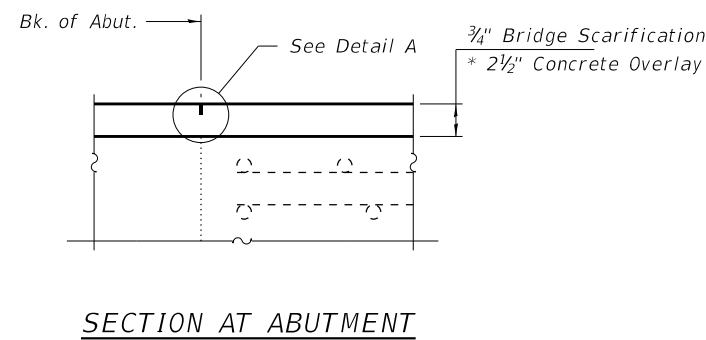
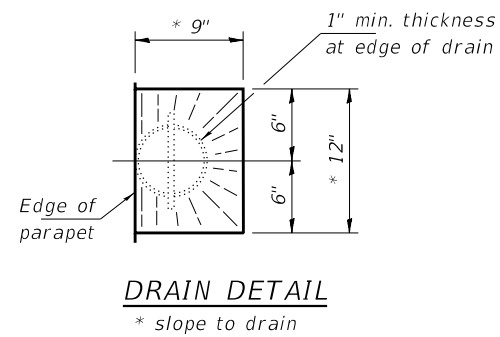

DESIGNED - VHV	EXAMINED - <i>Timothy A. Daulton</i>	DATE - NOVEMBER 25, 2020
CHECKED - JSB	ENGINEER OF STRUCTURAL SERVICES	
DRAWN - Venkat Reddy	PASSED - <i>Carl Ringer</i>	REVISED -
CHECKED - VHV JSB	ENGINEER OF BRIDGES AND STRUCTURES	REVISED -

STATE OF ILLINOIS
DEPARTMENT OF TRANSPORTATION

CROSS SECTIONS & STAGING DETAILS
SN 054 - 0104

SHEET NO. 2 OF 4 SHEETS

F.A.U. RTE.	SECTION	COUNTY	TOTAL SHEETS	SHEET NO.
7706	(22 BDR)	LOGAN	24	22
CONTRACT NO. 72L96				
ILLINOIS FED. AID PROJECT				

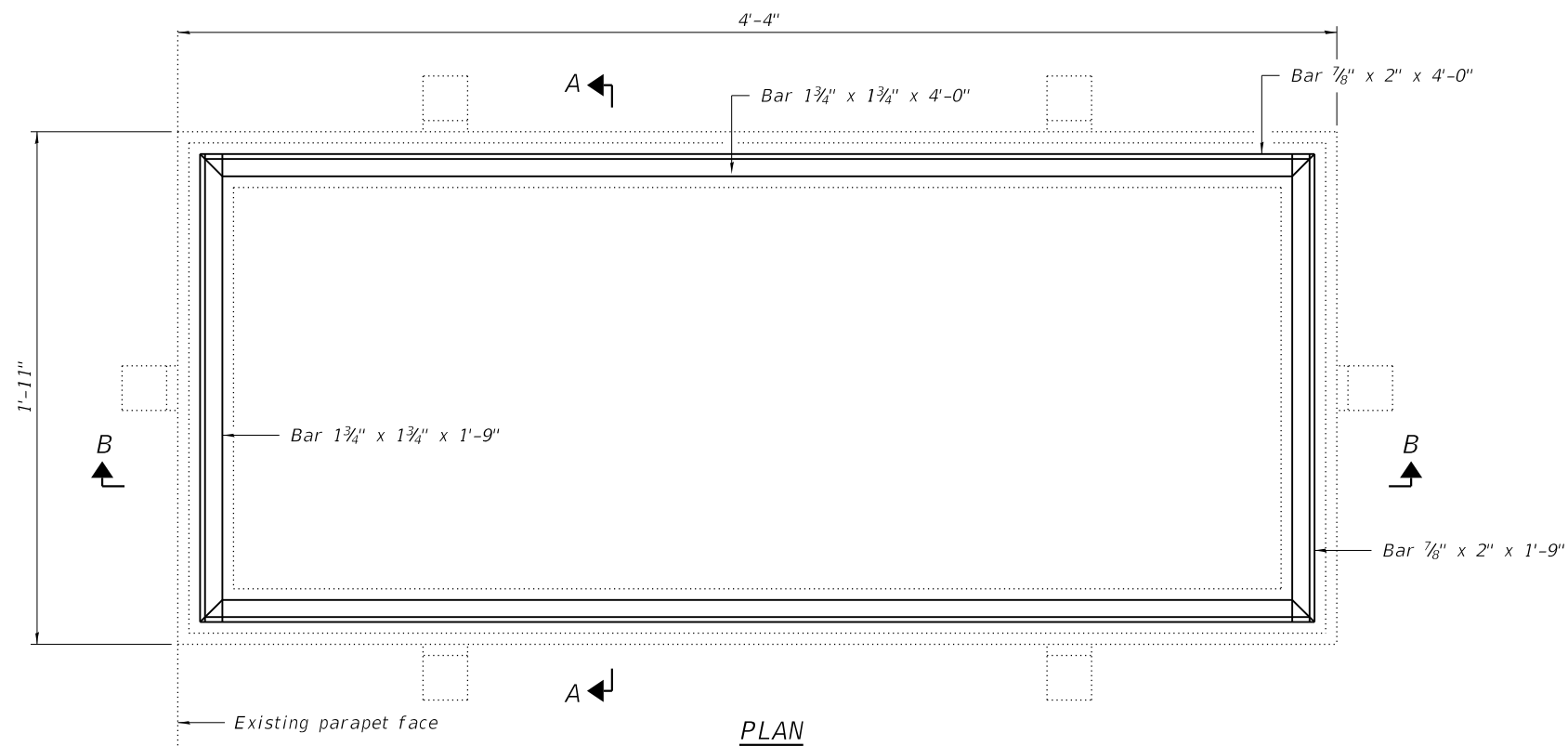

Notes:
 The contractor shall ensure that no damage is done to existing grates to be reused.
 Shop plans for proposed adjusting scupper ring shall be submitted for approval prior to fabrication.
 Cost of all labor and materials necessary to remove existing grates, clean existing scuppers, install adjusting scupper rings and reinstalling grates is included in the cost per unit each for Drainage Scuppers to be Adjusted.
 All structural steel shall conform to AASHTO Classification M-270 Gr. 36.
 The adjusting scupper ring shall be galvanized.
 Bolts shall be 1/2"Ø, AASHTO M164 Type I, mechanically galvanized.

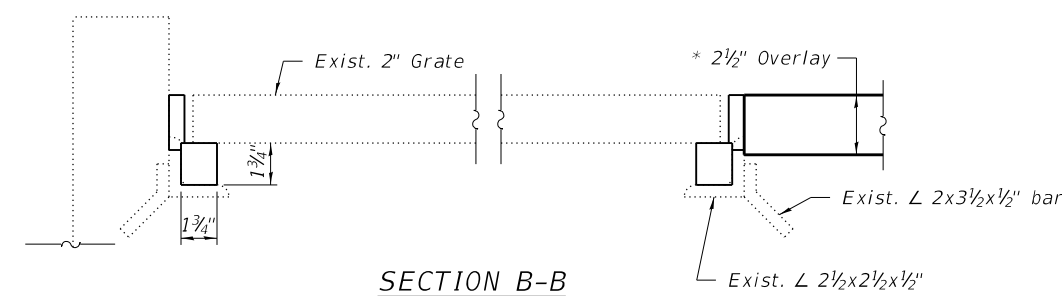
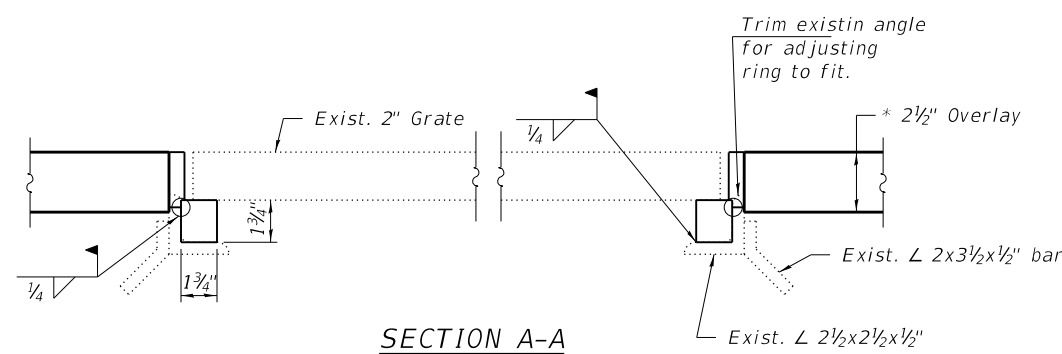

BILL OF MATERIAL

Item	Unit	Total
Drainage Scuppers to be Adjusted	Each	2

DESIGNED - VHV	EXAMINED - <i>Timothy A. Daulton</i> ENGINEER OF STRUCTURAL SERVICES	DATE - NOVEMBER 25, 2020
CHECKED - JSB	PASSED - <i>Carl Ringer</i> ENGINEER OF BRIDGES AND STRUCTURES	REVISED -
DRAWN - Venkat Reddy		REVISED -
CHECKED - VHV JSB		

**STATE OF ILLINOIS
 DEPARTMENT OF TRANSPORTATION**

**SCUPPER ADJUSTMENT
 SN 054 - 0104**

SHEET NO. 3 OF 4 SHEETS

F.A.U. RTE.	SECTION	COUNTY	TOTAL SHEETS	SHEET NO.
7706	(22 BDR)	LOGAN	24	23
CONTRACT NO. 72L96				
ILLINOIS		FED. AID PROJECT		

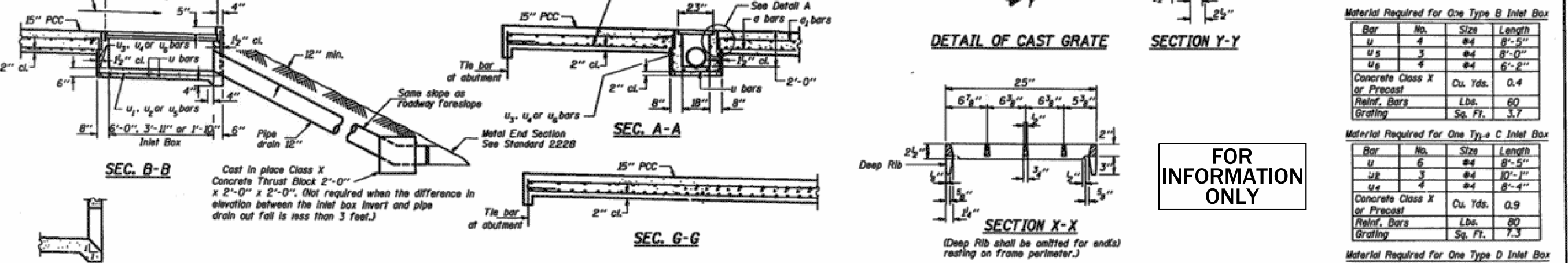
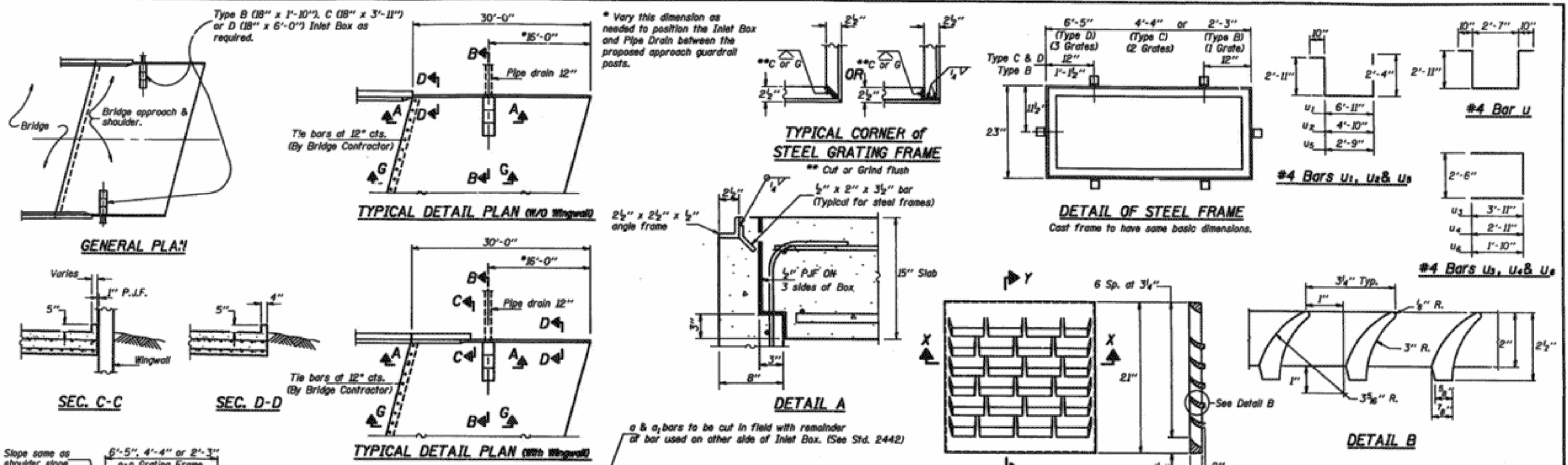

Material Required for One Type B Inlet Box

Bar	No.	Size	Length
u	4	#4	8'-5"
u ₅	3	#4	8'-0"
u ₆	4	#4	6'-2"
Concrete Class X or Precast		Cu. Yds.	0.4
Reinf. Bars		Lbs.	60
Grating		Sq. Ft.	3.7

Material Required for One Type C Inlet Box

Bar	No.	Size	Length
u	6	#4	8'-5"
u ₂	3	#4	10'-1"
u ₄	4	#4	8'-4"
Concrete Class X or Precast		Cu. Yds.	0.9
Reinf. Bars		Lbs.	80
Grating		Sq. Ft.	7.3

Material Required for One Type D Inlet Box

Bar	No.	Size	Length
u	8	#4	8'-5"
u ₁	3	#4	12'-2"
u ₃	4	#4	10'-4"
Concrete Class X or Precast		Cu. Yds.	1.2
Reinf. Bars		Lbs.	100
Grating		Sq. Ft.	11.0

FOR INFORMATION ONLY

GENERAL NOTES

See Type C Inlet Box for 5' and 6' shoulder widths, use Type D Inlet Box for 7' and wider shoulder widths, use Type B Inlet Box for shoulders less than 5' wide.

The material for 12" Pipe Drains shall be either corrugated steel, aluminum alloy or polyethylene (P.E.) pipe with UV protection.

Corrugated steel and aluminum alloy pipe shall have 2" coupling bands. All pipe connections shall be water tight.

Class X concrete or precast concrete shall be used for the Inlet Box.

Precast concrete shall be in accordance with Sections 505.01 thru 505.05 of the Standard Specifications except that the concrete strength shall be 4000 p.s.i. after 28 days.

All exposed edges of the Inlet, except the upper perimeter, shall be beveled 3/4".

Shop drawings will not be required for precast Inlet Boxes.

A 3" deep CA12 bedding conforming to Article 704.01, D Quality or better shall be provided under full length and width of precast units, and all voids around the pipe drain entrance, both inside and outside, shall be sealed with mortar.

The grating shall seat firmly in the frame.

Steel frames shall conform to Article 710.04 of the Standard Specifications and shall be galvanized to AASHTO M111 after fabrication.

Cast grating and frames shall conform to Article 710.17 of the Standard Specifications. Cast grating and frames shall not be galvanized.

Pipe drains shall be installed, measured and paid for in accordance with Section 607 of the Standard Specifications, except sand bedding will not be required.

Metal End Sections shall be installed, measured and paid for in accordance with Section 511 of the Standard Specifications.

The contract unit price each for TYPE (B, C or D) INLET BOX STANDARD 2443, in place, shall include the frame and grating, class X or precast concrete, reinforcement bars, excavation, bedding when required, and compacted backfill.

The contract unit price each for CONCRETE THRUST BLOCKS, in place shall include excavation and compacted backfilling.

DESIGN NOTES

All installations which also require the placement of approach guardrail should be checked to see whether special Approach Shoulder Pavement or Guardrail details will be required.

Design Notes will not appear in the Contract Plans.

BOX OUTLET WHEN PRECAST

Illinois Department of Transportation

APPROVED JAN. 2, 1992

Richard E. Anderson
Engineer of Bridges and Structures

APPROVED JAN. 2, 1992

Raymond
Engineer of Design

DESIGNED - VHV
CHECKED - JSB
DRAWN - Venkat Reddy
CHECKED - VHV JSB

EXAMINED

Timothy A. Daulton
ENGINEER OF STRUCTURAL SERVICES

PASSED

Carl Ringer
ENGINEER OF BRIDGES AND STRUCTURES

DATE - NOVEMBER 25, 2020

REVISED -

REVISED -

STATE OF ILLINOIS
DEPARTMENT OF TRANSPORTATION

EXISTING PLAN SHEET - FOR INFORMATION ONLY
SN 054-0104

F.A.U. RTE.	SECTION	COUNTY	TOTAL SHEETS	SHEET NO.
7706	(22 BDR)	LOGAN	24	24
CONTRACT NO. 72L96				
ILLINOIS FED. AID PROJECT				

STANDARD 2443

601-B