

PLAN

Notes:
 See Sheet 8 of 21 for superstructure details and Bill of Material.
 Bars indicated thus 20 x 3-#5 etc. indicates 20 lines of bars with 3 lengths per line.
 See Sheet 9 of 21 for Section A-A & Diaphragm Details.

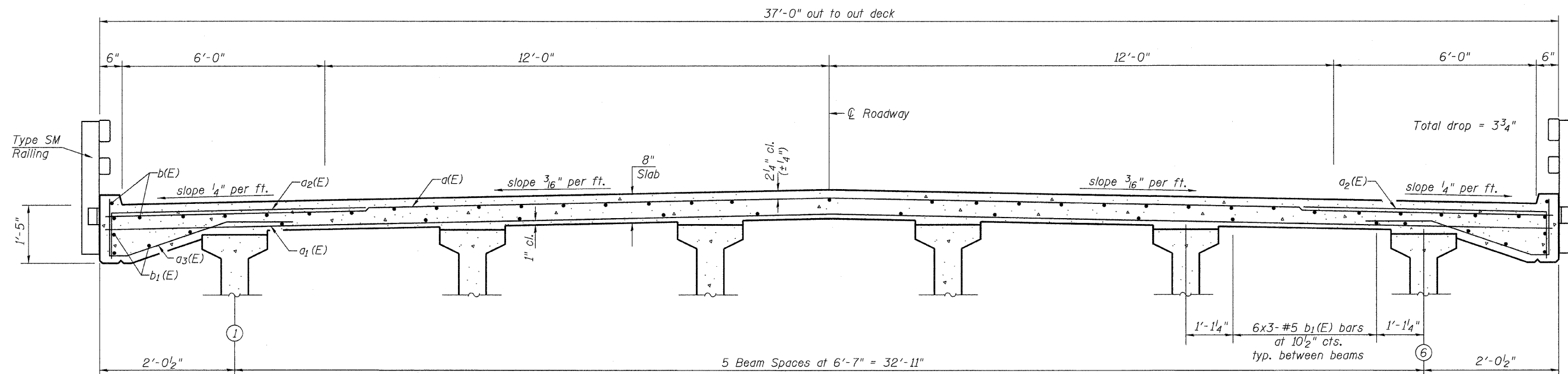

CROSS SECTION
 (Looking North)

SUPERSTRUCTURE

SHEET NO. 7 21 SHEETS	ROUTE NO.	SECTION	COUNTY	TOTAL SHEETS	SHEET NO.
	CH 29	10-00649-00-BR	LASALLE	43	14
S.N. 050-3593			CONTRACT NO. 87430		
FED. ROAD DIST. NO. 7 ILLINOIS			FED. AID PROJECT BRS-0099(043)		