

F.A.P. RTE.	SECTION	COUNTY	TOTAL SHEETS	SHEET NO.
697	46BR	Vermilion	31	1
		ILLINOIS	CONTRACT NO. 70594	

STATE OF ILLINOIS
DEPARTMENT OF TRANSPORTATION
DIVISION OF HIGHWAYS

**PROPOSED
HIGHWAY PLANS**

F.A.P. ROUTE 697 (IL 9)
SECTION 46BR
PROJECT ACF-0697(032)
VERMILION COUNTY

C-95-104-06

BOX CULVERT REPLACEMENT
DITCH 1.8 MILES EAST OF HOOPESTON

FOR INDEX OF SHEETS, SEE SHEET NO. 2
FOR SUMMARY OF QUANTITIES, SEE SHEET NO. 4-5

CURRENT ADT (2009):
LEG "A" (ECL HOOPESTON TO CH3): 1,650

- STRUCTURE REPLACEMENT: S.N. 092-8027 (EX); S.N. 092-2042 (PR)
STA. 1304+66.00

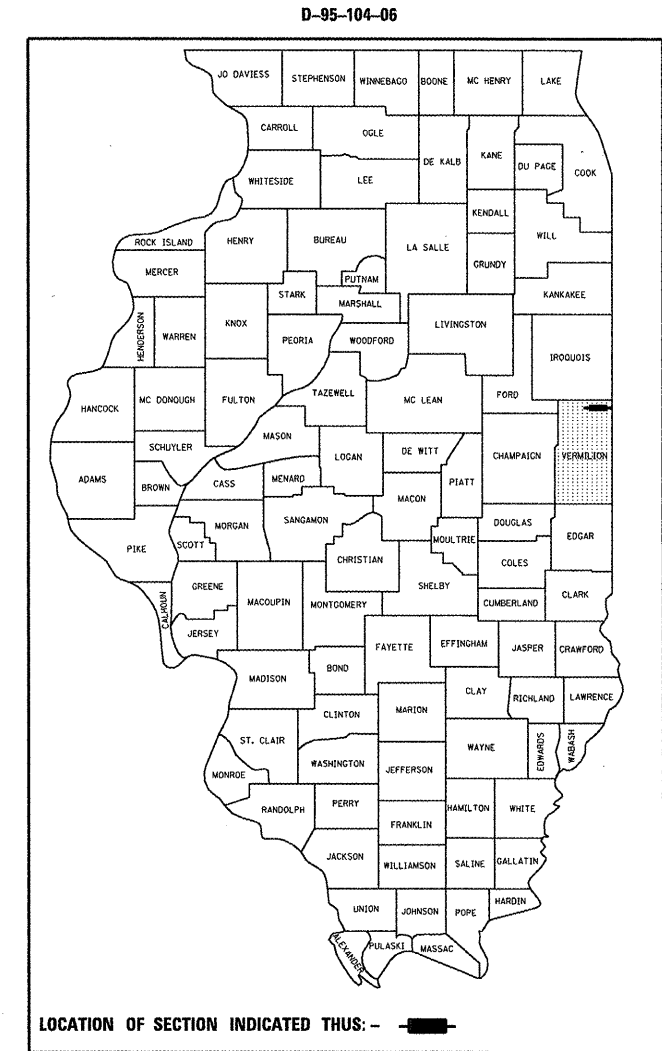

SECTION 46BR
BEGIN STATION 1304+13.46

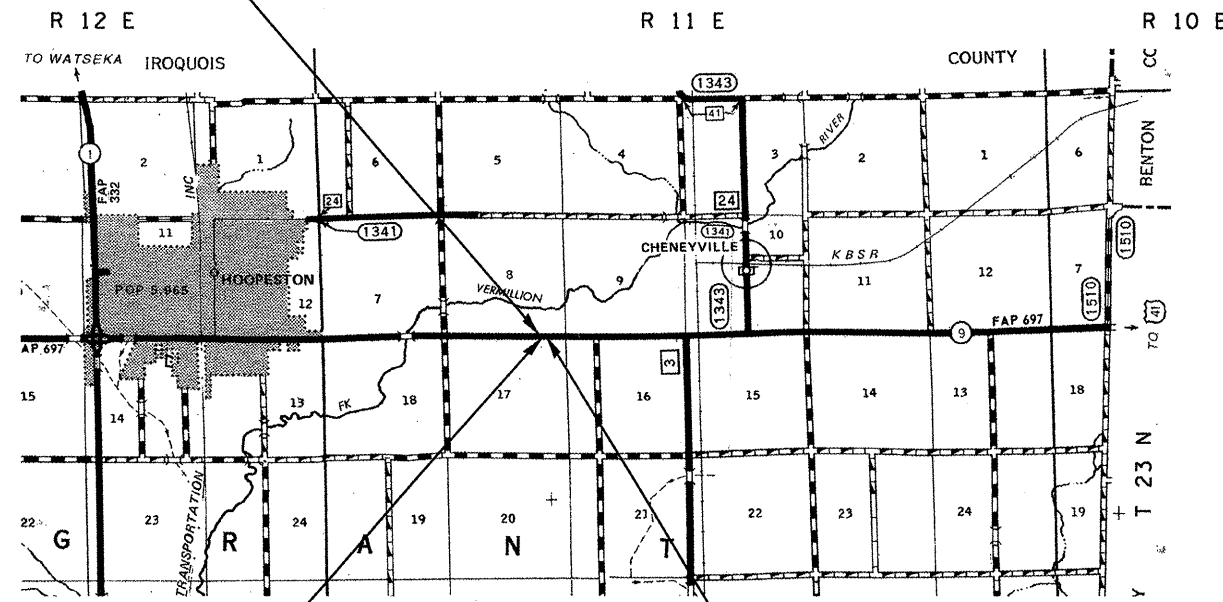

- S.N. 092-8027 (EX)
- S.N. 092-2042 (PR)
- STA. 1304+66.00

SECTION 46BR
END STATION 1305+18.54

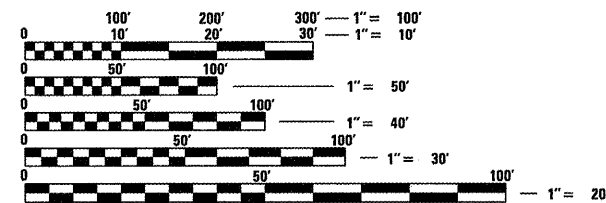

FULL SIZE PLANS HAVE BEEN PREPARED USING STANDARD ENGINEERING SCALES. REDUCED SIZED PLANS WILL NOT CONFORM TO STANDARD SCALES. IN MAKING MEASUREMENTS ON REDUCED PLANS, THE ABOVE SCALES MAY BE USED.

J.U.L.I.E.
JOINT UTILITY LOCATION INFORMATION FOR EXCAVATION
1-800-892-0123
OR 811

PROJECT ENGINEER: KEVIN TRAPP (217-465-4181)
PROJECT MANAGER: DANA HENNESS
SQUAD LEADER: MICHAEL LEROY
CONTRACT NO. 70594

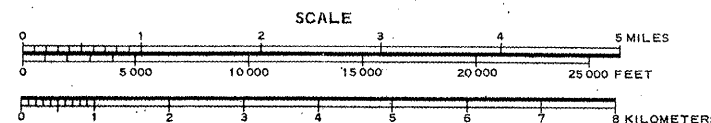

GROSS LENGTH = 105.08 FT. = 0.020 MILE
NET LENGTH = 105.08 FT. = 0.020 MILE

STATE OF ILLINOIS
DEPARTMENT OF TRANSPORTATION
DIVISION OF HIGHWAYS

SUBMITTED 10/20 20 09

Joseph E. Rowan
DEPUTY DIRECTOR OF HIGHWAYS, REGION ENGINEER

December 4, 2009
Charles G. Ingersoll
ENGINEER OF DESIGN AND ENVIRONMENT

December 4, 2009
Christine M. Reed
DIRECTOR OF HIGHWAYS, CHIEF ENGINEER

PRINTED BY THE AUTHORITY
OF THE STATE OF ILLINOIS

PLOT DATE = 10/19/2009
FILE NAME = G:\pwworkspace\pwworkspace\10132042\0570594-sht1-cover.dgn
PLOT SCALE = 400.0000 1/ IN.
USER NAME = c69r0ck3g