

LEGEND

	WORK AREA
	SIGN ON PORTABLE OR PERMANENT SUPPORT
	DRUM WITH BI-DIRECTIONAL STEADY BURNING LIGHT
	TYPE III BARRICADE
	TEMPORARY PAVEMENT MARKING
	VERTICAL PANEL

- STAGE II NOTES**
1. ERECT SIGNS, TRAFFIC SIGNALS, BARRICADES UTILIZING THE APPLICABLE DETAILS OF TRAFFIC CONTROL STANDARD 701316.
 2. PLACE TEMPORARY PAVEMENT MARKING AND MOVE TRAFFIC TO THE TEMPORARY RUNAROUND DETOUR. REMOVE CONFLICTING MARKING AS NEEDED.
 3. REMOVE THE EXISTING BRIDGE, CONSTRUCT THE PROPOSED TRIPLE BARREL CULVERT, AND CONSTRUCT THE WEST WINGWALLS.
 4. REALIGN CHANNEL THROUGH BOX CULVERT AND CONSTRUCT EAST WINGWALLS AND EMBANKMENT. DIRECT FLOW THROUGH TEMPORARY CULVERTS.
 5. CONSTRUCT NEW PAVEMENT TO THE PROPOSED GRADELINE, AS SHOWN ON THE PLAN.
 6. ALL TRAFFIC CONTROL ITEMS DESCRIBED FOR STAGE II CONSTRUCTION, WILL BE PAID FOR AS TRAFFIC CONTROL & PROTECTION STANDARD 701316 (SPECIAL).

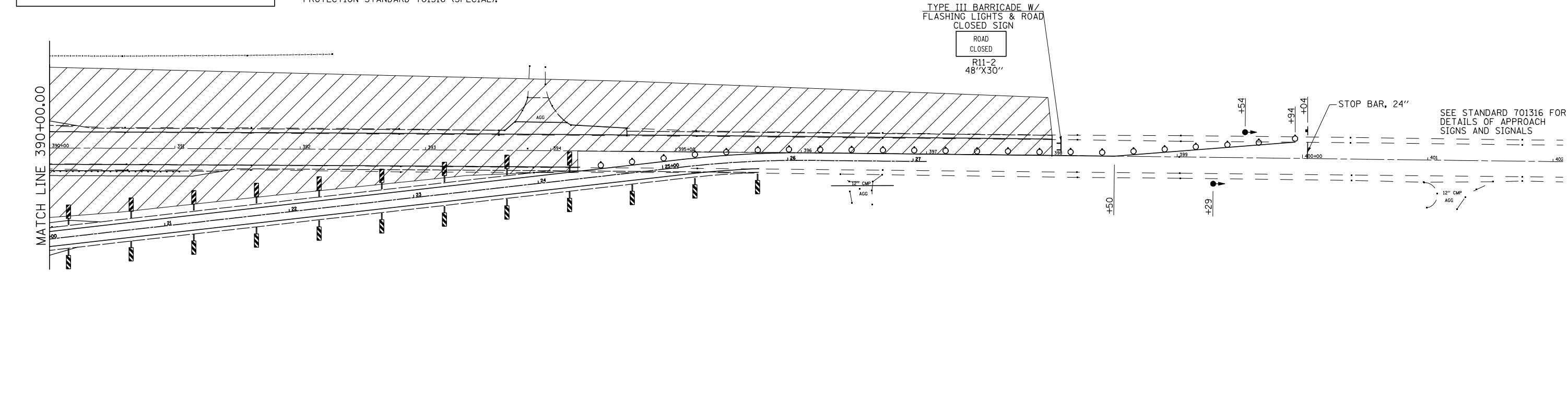

FILE NAME =	USER NAME = rook	DESIGNED -	REVISED -
P:\0340802.01 Mud Creek\CADD Sheets\0570528-sht-staging.dgn		DRAWN -	REVISED -
PLOT SCALE = 80.0000' / IN.		CHECKED -	REVISED -
PLOT DATE = 10/20/2009		DATE -	REVISED -

**STATE OF ILLINOIS
DEPARTMENT OF TRANSPORTATION**

STAGE II CONSTRUCTION

SCALE: SHEET NO. 2 OF 3 SHEETS STA. TO STA.

F.A.P. RTE.	SECTION	COUNTY	TOTAL SHEETS	SHEET NO.
315	121-BR-1	MCLEAN	67	19
CONTRACT NO. 70528				
FED. ROAD DIST. NO. ILLINOIS FED. AID PROJECT				