

TYPICAL SECTIONS

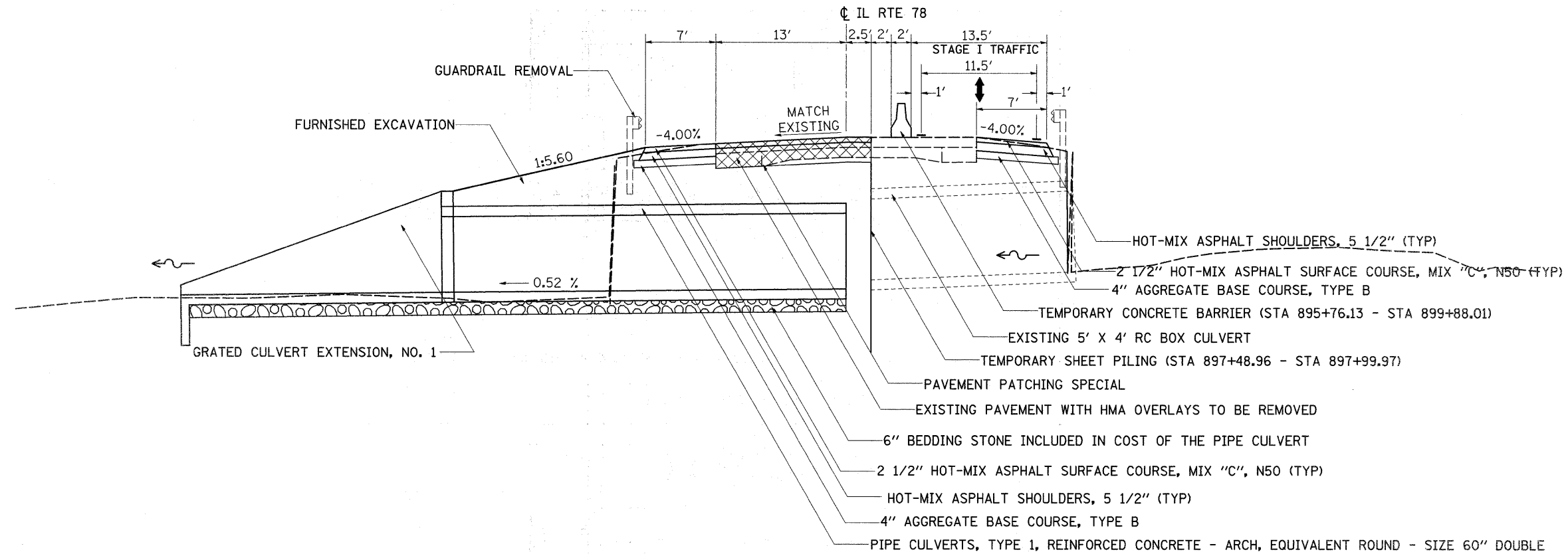

STAGE I CULVERT TYPICAL SECTION - IL RTE 78
STA 897+77.46

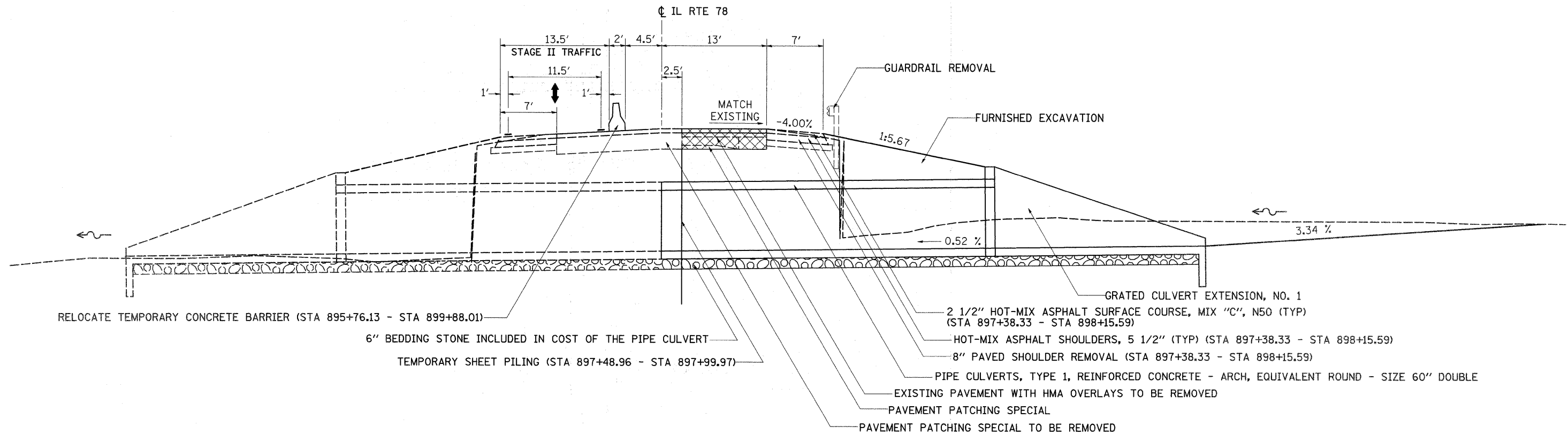

STAGE II CULVERT TYPICAL SECTION - IL RTE 78
STA 897+77.46

* DRUMS, BARRELS, & SIGNING TO BE SET UP ACCORDING TO TRAFFIC CONTROL STANDARD 701321

FILE NAME =	USER NAME = goffjl	DESIGNED -	REVISED -	STATE OF ILLINOIS DEPARTMENT OF TRANSPORTATION	TYPICAL SECTIONS			F.A.P. RTE.	SECTION	COUNTY	TOTAL SHEETS	SHEET NO.
ca:\pw\work\FWIDOT\GOFFJL\dms37299\d01107.tpd.dgn	DRAWN -	REVISED -	650					104T-2	JO DAVIESS	53	10	
PLOT SCALE = 50.0000' / IN.	CHECKED -	REVISED -	CONTRACT NO. 64C79									
PLOT DATE = Mon Sep 21 07:55:26 2009	DATE -	REVISED -	SCALE:		SHEET NO. 5 OF 6 SHEETS	STA. 897+77.46 TO STA. 897+77.46	FED. ROAD DIST. NO.	ILLINOIS FED. AID PROJECT				