

FOR INDEX OF SHEETS, SEE SHEET NO. 2

STATE OF ILLINOIS  
DEPARTMENT OF TRANSPORTATION  
DIVISION OF HIGHWAYS

# PLANS FOR PROPOSED FEDERAL AID HIGHWAY

163rd STREET (FAU 290) & BRUCE ROAD (FAU 293)  
2009 FEDERAL STIMULUS ARRA FUND RESURFACING PROJECT  
163rd STREET (FAU 290), FARRELL ROAD (FAU 366) TO I-355  
& BRUCE ROAD (FAU 293), FARRELL ROAD (FAU 366) TO GOUGAR ROAD (FAU 367)  
SECTION: 09-00065-00-RS  
PROJECT: ARA-9003(408)  
CITY OF LOCKPORT  
WILL COUNTY  
JOB NO.: C-91-799-09



PROJECT LOCATED IN  
CITY OF LOCKPORT

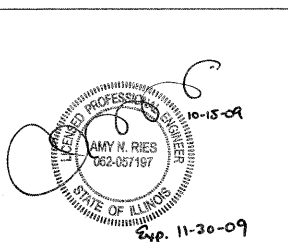

Amy N. Ries, P.E.  
Date: 10-15-2009  
License no.: 062-057197  
Expiration Date: 11-30-2009

**DESIGN DESIGNATION**  
163RD STREET : COLLECTOR  
POSTED SPEED: 30 MPH  
DESIGN SPEED: 35 MPH

ADT - 8000 (2030)

**DESIGN DESIGNATION**  
BRUCE ROAD : COLLECTOR  
POSTED SPEED: 35 MPH  
DESIGN SPEED: 40 MPH

ADT - 15000 (2030)

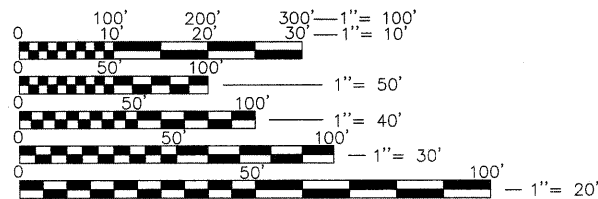

FULL SIZE PLANS HAVE BEEN PREPARED USING STANDARD ENGINEERING SCALES. REDUCED SIZED PLANS WILL NOT CONFORM TO STANDARD SCALES. IN MAKING MEASUREMENTS ON REDUCED PLANS, THE ABOVE SCALES MAY BE USED.

CONTRACT NO. 63352

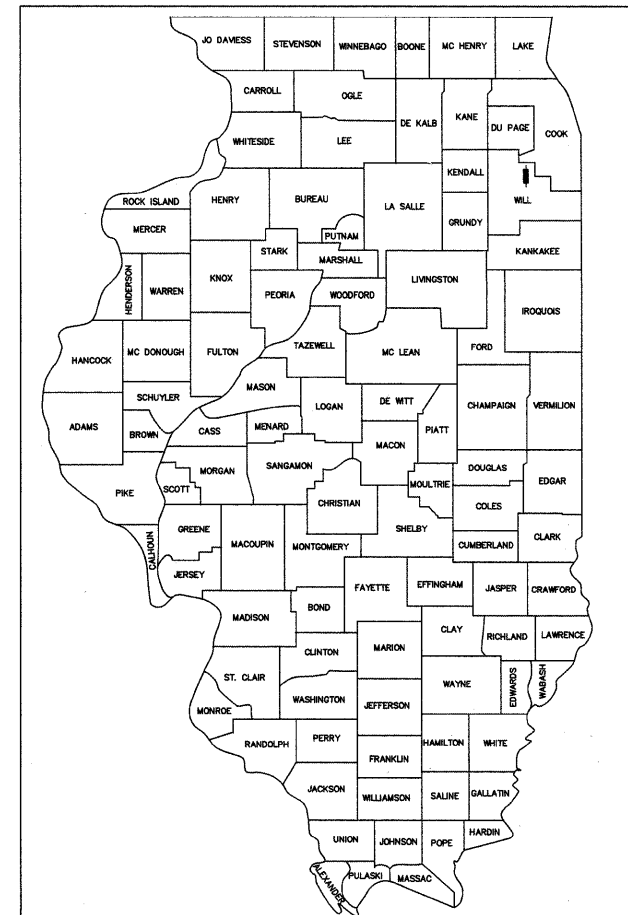

LOCATION OF SECTION INDICATED THUS: - [black rectangle] -

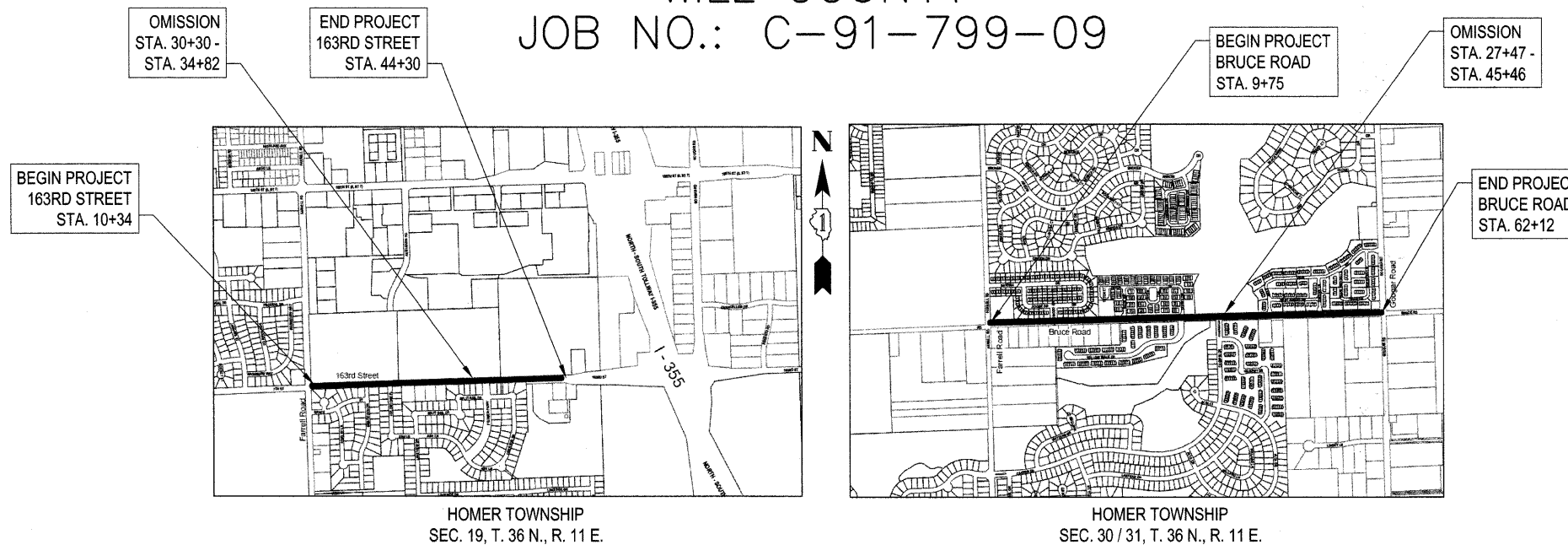

163RD STREET (FAU 290)  
GROSS LENGTH OF PROJECT = 3396' (0.643 MILES)  
NET LENGTH OF PROJECT = 2944' (0.558 MILES)  
BRUCE ROAD (FAU 293)  
GROSS LENGTH OF PROJECT = 5237' (0.99 MILES)  
NET LENGTH OF PROJECT = 3438' (0.65 MILES)  
NOT TO SCALE

STATE OF ILLINOIS DEPARTMENT OF TRANSPORTATION  
DIVISION OF HIGHWAYS

Approved: Dev Trivedi  
*Dennis J. Trivedi*  
MAYOR, CITY OF LOCKPORT

Passed: OCTOBER 27, 2009  
*Cheryl Heston*  
District 1 Engineer of Local Roads & Streets

Releasing for Bid Based on Limited Review: OCTOBER 29, 2009  
*Diana M. O'Keefe*  
Deputy Director of Highways, Region 1 Engineer



The City of Lockport

Engineering Department  
17112 S. Prime Blvd., Lockport, IL 60441  
815-838-0549 815-838-6580 (fax)

PRINTED BY THE AUTHORITY OF THE STATE OF ILLINOIS

FIELD ENGINEER: MELCHOR MANGOBA (847) 705-4408

# GENERAL NOTES

1. The latest editions of the "Standard Specifications for Road and Bridge Construction" and "Supplemental Specifications and Recurring Special Provisions" as prepared by the Illinois Department of Transportation (IDOT) shall govern all work associated with this project.

2. The latest edition of the "Manual on Uniform Traffic Control Devices" shall also govern the project. Barricades and warning signs shall be provided in accordance with the standard specifications and as designated by the engineer.

3. The contractor shall dispose of all surplus excavated material off the site as work progresses with no additional compensation allowed. The temporary stockpiling of this material on the project site will not be allowed.

4. The contractor shall submit in writing a "schedule of operations" showing approximate dates for commencing and completing various phases of construction included in the contract prior to commencing any construction under this contract. The schedule shall have the approval of the engineer and the date for starting shall be mutually agreed upon between the contractor and the engineer.

5. All permanent type pavements or other permanent improvements which abut the proposed improvement and must be removed shall be sawed prior to removal. Payment for sawing shall be included in the cost for the removal of each item.

6. Prior to starting construction, the contractor shall notify J.U.L.I.E. and all other public and private utilities so that arrangements can be made to locate their various facilities within the limits of construction under this contract, as well as to provide adequate protection and inspection thereto. It shall be the contractor's responsibility to determine the actual location of all such facilities in the field.

7. All traffic signs, street signs, etc., that interfere with the construction operations shall be removed and placed at new locations as designated by the engineer. This work shall be included in the cost of HOT-MIX ASPHALT PAVEMENT REMOVAL with no additional compensation allowed. In addition, all mail boxes that interfere with construction shall be similarly relocated with no additional compensation allowed.

8. The contract shall have a competent superintendent on the project site at all times, irrespective of the amount of work sublet. The superintendent shall be capable of reading and understanding the plans and specifications, shall have full authority to execute orders to expedite the project and shall be responsible for scheduling and having control of all the work as the agent of the general contractor. Failure to comply with this provision will result in a suspension of work as provided in the standard specifications.

9. Where overhanging branches interfere with operations of construction, said branches shall be trimmed and sealed in accordance with the standard specifications and the cost of same shall be included in the cost of BITUMINOUS PAVEMENT REMOVAL.

10. Traffic control provisions will be strictly enforced. The contractor shall be alert to post all necessary signage, have flaggers at locations of restricted lane operations, and take down the signage when the work is completed.

11. Where the proposed work abuts existing pavement to remain in place, the existing pavement shall be sawcut to provide a neat vertical face between the proposed and existing surfaces.

13. All LA-15's, bills of lading, product certifications, shipping tickets, seed analysis, etc. must be submitted directly to the City Engineer at time of delivery and/or installation or with requests for payment as necessary. No pay requests will be processed without the certifications as required by IDOT.

SHEET NO.	INDEX OF SHEETS
1	COVER SHEET
2	INDEX OF SHEETS / STANDARDS / GENERAL NOTES
3	SUMMARY OF QUANTITIES
4	TYPICAL SECTIONS
5-11	PLAN SHEETS
12-13	PAVEMENT MARKING PLANS
14-20	DISTRICT ONE DETAILS

## STANDARDS

442201-03	CLASS C AND CLASS D PATCHES
606001-04	CONCRETE CURB TYPE B AND COMBINATION CONCRETE CURB & GUTTER
701301-03	LANE CLOSURE, 2L, 2W, SHORT TIME OPERATIONS
701311-03	LANE CLOSURE 2L, 2W, MOVING OPERATIONS - DAY ONLY
701501-05	URBAN LANE CLOSURE, 2L, 2W, UNDIVIDED
701701-06	URBAN LANE CLOSURE, MULTILANE INTERSECTION
701801-04	LANE CLOSURE 1W OR 2W CROSSWALK OR SIDEWALK CLOSURE
701901-01	TRAFFIC CONTROL DEVICES
780001-02	TYPICAL PAVEMENT MARKINGS

FIELD ENGINEER: MELCHOR MANGOBA (847) 705-4408

FILE NAME =	USER NAME = Amy Wagner	DESIGNED -- A. Wagner	REVISED -- A. Wagner 10/14/2009	<b>STATE OF ILLINOIS DEPARTMENT OF TRANSPORTATION</b>	<b>GENERAL NOTES, INDEX OF SHEETS AND STANDARDS</b>	F.A.U. RTE.	SECTION	COUNTY	TOTAL SHEETS	SHEET NO.
R:\Engineering\City Projects\2009 Roadway Program\2009 ARRA\drawings\090006500RS.dwg	PLOT SCALE = None	DRAWN -- A. Wagner	REVISED -- A. Wagner 10/24/2009			290/293	09-00065-00-RS	WILL	20	02
PLOT DATE = 10/14/2009	DATE -- 8/27/2009	CHECKED -- A. Ries	REVISED --			CONTRACT NO. 63352				
						SCALE: None	SHEET NO. 02 OF 20 SHEETS	STA. _____ TO STA. _____	ILLINOIS FED. AID PROJECT ARA-9003(408)	

FIELD ENGINEER: MELCHOR MANGOBA (847) 705-4408

SUMMARY OF QUANTITIES					PAVEMENT	MARKINGS	LANDSCAPE	DRAINAGE
					CONSTRUCTION TYPE CODE			
S.I.	CODE NO.	PAY ITEM	UNIT	TOTAL	I000	SFTY	Y003	Y007
	25200700	SODDING, SPECIAL	SQ YD	1500			1500	
	40300100	BITUMINOUS MATERIALS (PRIME COAT)	GAL	1050	1050			
	40600300	AGGREGATE (PRIME COAT)	TON	16	16			
	40600982	HOT-MIX ASPHALT SURFACE REMOVAL - BUTT JOINT	SQ YD	300	300			
	40603310	HOT-MIX ASPHALT SURFACE COURSE, MIX "C", N50	TON	2430	2430			
	42300200	PORTLAND CEMENT CONCRETE DRIVEWAY PAVEMENT, 6 INCH	SQ YD	200	200			
	44000157	HOT-MIX ASPHALT SURFACE REMOVAL, 2"	SQ YD	10500	10500			
	44000196	HOT-MIX ASPHALT SURFACE REMOVAL, SPECIAL	SQ YD	9000	9000			
	44000200	DRIVEWAY PAVEMENT REMOVAL	SQ YD	400	400			
	44000500	COMBINATION CONCRETE CURB AND GUTTER, REMOVAL	FOOT	150				150
	44004610	SIDEWALK REMOVAL AND REPLACEMENT (SPECIAL)	SQ FT	125	125			
	44201701	CLASS D PATCHES, TYPE I, 5 INCH	SQ YD	100	100			
	44201705	CLASS D PATCHES, TYPE II, 5 INCH	SQ YD	200	200			
	44201709	CLASS D PATCHES, TYPE III, 5 INCH	SQ YD	900	900			
	44201711	CLASS D PATCHES, TYPE IV, 5 INCH	SQ YD	1000	1000			
	48101400	AGGREGATE SHOULDERS, TYPE B	FOOT	9000	9000			
	60604200	COMBINATION CONCRETE CURB AND GUTTER, TYPE B-6.12 (SPECIAL)	FOOT	150				150
	67100100	MOBILIZATION	LSUM	1	1			
	70102620	TRAFFIC CONTROL AND PROTECTION, STANDARD 701501	LSUM	1		1		
	70102635	TRAFFIC CONTROL AND PROTECTION, STANDARD 701701	LSUM	1		1		
	70102640	TRAFFIC CONTROL AND PROTECTION, STANDARD 701801	LSUM	1		1		
*	78000100	THERMOPLASTIC PAVEMENT MARKING - LETTERS AND SYMBOLS	SQ FT	450		450		
*	78000200	THERMOPLASTIC PAVEMENT MARKING - LINE 4"	FOOT	12000		12000		
*	78000400	THERMOPLASTIC PAVEMENT MARKING - LINE 6"	FOOT	1345		1345		
*	78000650	THERMOPLASTIC PAVEMENT MARKING - LINE 24"	FOOT	60		60		
*	88600600	DETECTOR LOOP REPLACEMENT	FOOT	144		144		
	X0323017	TEMPORARY INFORMATIONAL SIGNS	EACH	2		1		
	X0326125	POLYMERIZED LEVELING BINDER (MACHINE METHOD), IL-4.75, N70	TON	665	665			
	XX000648	SEEDING, SPECIAL	SQ YD	500			500	
	XX007567	HOT-MIX ASPHALT DRIVEWAY PAVEMENT 4"	SQ YD	200	200			
	XX007729	DETECTABLE WARNINGS, SPECIAL	SQ FT	100	100			
	Z0017400	DRAINAGE & UTILITY STRUCTURE TO BE ADJUSTED	EACH	8				8
	Z0017500	DRAINAGE & UTILITY STRUCTURE ADJUSTMENT (SPECIAL)	EACH	2				2
	Z0017700	DRAINAGE & UTILITY STRUCTURE TO BE RECONSTRUCTED	EACH	2				2
	Z0017800	DRAINAGE & UTILITY STRUCTURE TO BE RECONSTRUCTED (SPECIAL)	EACH	1				1
* DENOTES A SPECIALTY ITEM								

FILE NAME =	USER NAME = Amy Wagner	DESIGNED -- A. Wagner	REVISED -- A. Wagner 10/14/2009
		DRAWN -- A. Wagner	REVISED -- A. Wagner 10/21/2009
	PLOT SCALE = None	CHECKED -- A. Ries	REVISED --
	PLOT DATE = 10/14/2009	DATE -- 8/27/2009	REVISED --

**STATE OF ILLINOIS  
DEPARTMENT OF TRANSPORTATION**

SCHEDULE OF QUANTITIES	
SCALE: None	SHEET NO. 03 OF 20 SHEETS
STA. _____	TO STA. _____

F.A.U. RTE.	SECTION	COUNTY	TOTAL SHEETS	SHEET NO.
290/293	09-00065-00-RS	WILL	20	03
ILLINOIS FED. AID PROJECT			CONTRACT NO. 63352	
			ARA-9003(408)	

CITY OF LOCKPORT  
 2009 FEDERAL STIMULUS ARRA FUND  
 RESURFACING PROJECT  
 163rd Street (STA. 10+34 - STA. 25+05)  
 Bruce Road  
 (STA. 17+80 - STA. 20+20,  
 STA. 27+20 - STA. 27+47,  
 STA. 46+35 - STA. 48+70,  
 STA. 52+90 - STA. 55+25)

\*A 2% CROSS SLOPE IS TYPICAL FOR MOST AREAS.

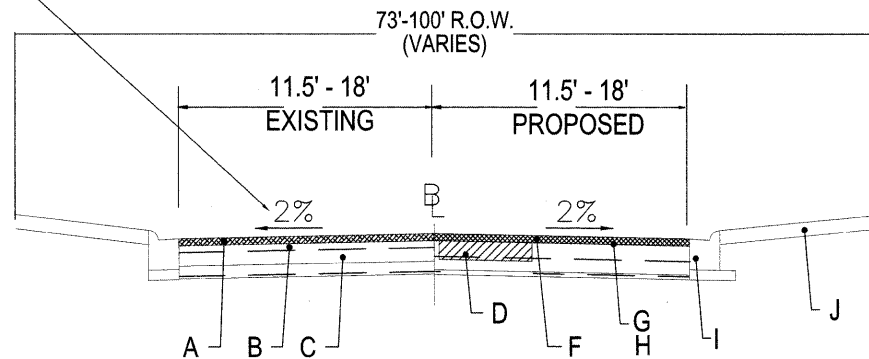

- A EXISTING HOT-MIX ASPHALT SURFACE COURSE (2" REMOVAL)
- B EXISTING HOT-MIX ASPHALT BINDER COURSE (THICKNESS VARIES)
- C EXISTING AGGREGATE SUB-BASE (THICKNESS VARIES)
- D CLASS D PATCH, 4", SPECIAL (AS DIRECTED BY ENGINEER)
- F HOT-MIX ASPHALT SURFACE COURSE, MIX C, IL-9.5mm,N50, 2"
- G BITUMINOUS MATERIALS (PRIME COAT)
- H AGGREGATE (PRIME COAT)
- I EXISTING COMBINATION CONCRETE CURB AND GUTTER
- J SODDING, SPECIAL OR DRIVEWAY PAVEMENT TO REMAIN (UNLESS OTHERWISE DIRECTED BY ENGINEER)

\*THE UNIT WEIGHT USED TO CALCULATE ALL HMA SURFACE MIXTURE QUANTITIES IS 112 LB/SQ YD/IN.

\*\*THE "AC TYPE" FOR POLYMERIZEDHMA MIXES SHALL BE "SBS/SBR PG 70-22" AND FOR NON-POLYMERIZED HMA THE "AC TYPE" SHALL BE "PG 64-22" UNLESS MODIFIED BY DISTRICT ONE SPECIAL PROVISIONS. FOR "PERCENT RAP" SEE DISTRICT ONE SPECIAL PROVISIONS.

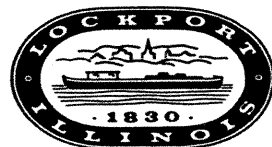

TITLE: TYPICAL SECTION  
 SCALE: NTS DATE: 27 AUG 07

CITY OF LOCKPORT  
 2009 FEDERAL STIMULUS ARRA FUND  
 RESURFACING PROJECT  
 163rd Street (STA. 24+50 - STA. 30+30,  
 STA. 34+82 - STA. 44+30)  
 Bruce Road  
 (STA. 9+75 - STA. 27+47,  
 STA. 45+46 - STA. 62+12)

\*A 2% CROSS SLOPE IS TYPICAL FOR MOST AREAS.

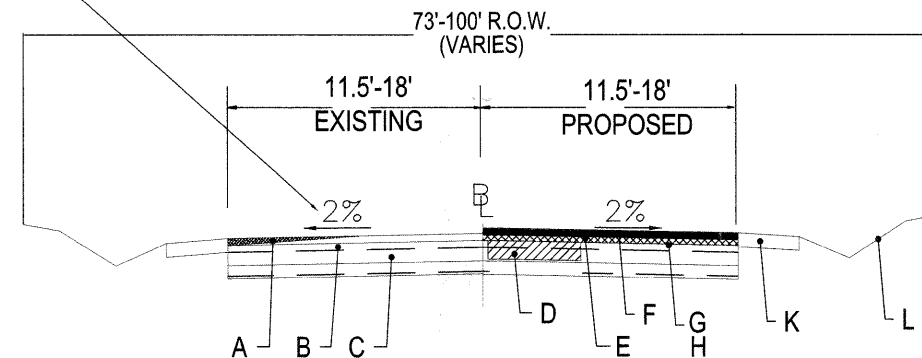

**\*CONTRACTOR SHALL MILL BEFORE PATCHING**

HOT-MIX ASPHALT MIXTURE REQUIREMENTS	
MIXTURE TYPE	AIR VOIDS @ Ndes
ROADWAY HOT-MIX ASPHALT SURFACE CSE, MIX C, IL-9.5mm,N50, 2"	4% @ 50 Gyr
POLYMERIZED LEVELING BINDER (MM), IL4.75, N70, 3/4"	4% @ 50 Gyr
CLASS D PATCHES HOT-MIX ASPHALT BINDER COURSE, IL-19.0, N70, 4"	4% @ 70 Gyr
DRIVEWAY REPLACEMENT HOT-MIX ASPHALT SURFACE CSE, MIX C, IL-9.5mm,N50, 1 3/4"	4% @ 50 Gyr
HOT-MIX ASPHALT BINDER COURSE, IL-19.0,N50, 2 1/4"	4% @ 50 Gyr

- A EXISTING HOT-MIX ASPHALT SURFACE COURSE (2" EDGE MILL ONLY, 6')
- B EXISTING HOT-MIX ASPHALT BINDER COURSE (THICKNESS VARIES)
- C EXISTING AGGREGATE SUB-BASE (THICKNESS VARIES)
- D CLASS D PATCHES, 4", SPECIAL (AS DIRECTED BY THE ENGINEER)
- E POLYMERIZED LEVELING BINDER (MACHINE METHOD), IL4.75, N70 , 3/4"
- F HOT-MIX ASPHALT SURFACE COURSE, MIX C, IL-9.5mm,N50, 2"
- G BITUMINOUS MATERIALS (PRIME COAT)
- H AGGREGATE (PRIME COAT)
- K AGGREGATE SHOULDERS, TYPE B, 2', SPECIAL OR DRIVEWAY PAVEMENT REMOVAL/REPLACEMENT (BIT. OR P.C.C.) (AS DIRECTED BY ENGINEER)
- L SEEDING, SPECIAL (AS DIRECTED BY ENGINEER)

\*THE UNIT WEIGHT USED TO CALCULATE ALL HMA SURFACE MIXTURE QUANTITIES IS 112 LB/SQ YD/IN.

\*\*THE "AC TYPE" FOR POLYMERIZEDHMA MIXES SHALL BE "SBS/SBR PG 70-22" AND FOR NON-POLYMERIZED HMA THE "AC TYPE" SHALL BE "PG 64-22" UNLESS MODIFIED BY DISTRICT ONE SPECIAL PROVISIONS. FOR "PERCENT RAP" SEE DISTRICT ONE SPECIAL PROVISIONS.

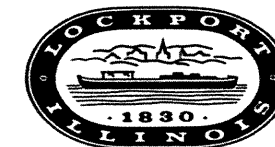

TITLE: TYPICAL SECTION  
 SCALE: NTS DATE: 27 AUG 07

FIELD ENGINEER: MELCHOR MANGOBA (847) 705-4408

FILE NAME =	USER NAME = Amy Wagner	DESIGNED -- A. Wagner	REVISED -- A. Wagner 10/14/2009
		DRAWN -- A. Wagner	REVISED --
	PLOT SCALE = None	CHECKED -- A. Ries	REVISED --
	PLOT DATE = 10/14/2009	DATE -- 8/27/2009	REVISED --

STATE OF ILLINOIS  
 DEPARTMENT OF TRANSPORTATION

TYPICAL SECTIONS	
SCALE: None	SHEET NO. 04 OF 27 SHEETS
STA. _____ TO STA. _____	

F.A.U. RTE.	SECTION	COUNTY	TOTAL SHEETS	SHEET NO.
290/293	09-00065-00-RS	WILL	27	04
CONTRACT NO. 63352			ILLINOIS FED. AID PROJECT ARA-9003(408)	

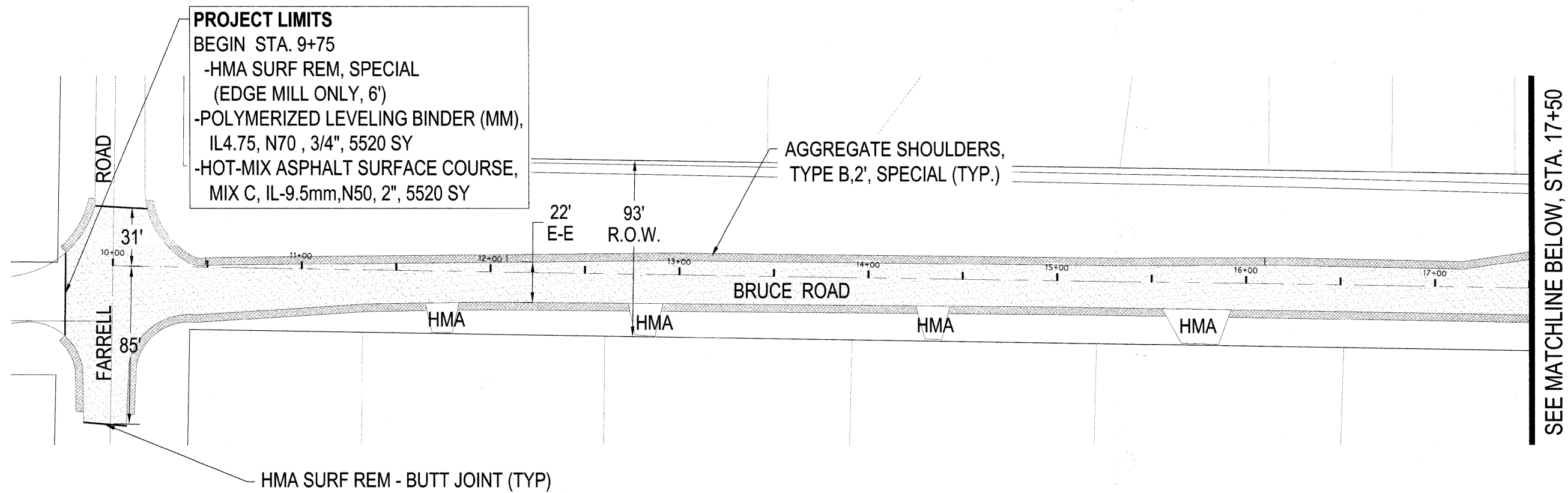
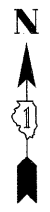

SEE MATCHLINE BELOW, STA. 17+50

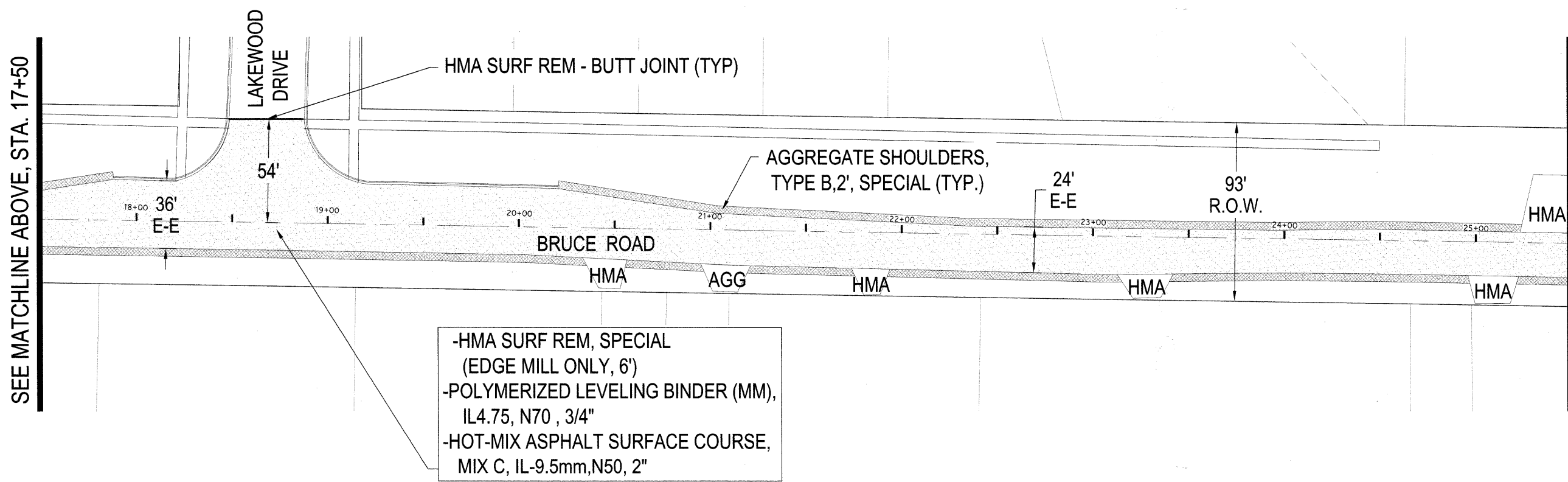

SEE MATCHLINE SHEET 6, STA. 25+50

-HMA SURF REM, SPECIAL  
(EDGE MILL ONLY, 6')  
-POLYMERIZED LEVELING BINDER (MM),  
IL4.75, N70, 3/4"  
-HOT-MIX ASPHALT SURFACE COURSE,  
MIX C, IL-9.5mm, N50, 2"

FIELD ENGINEER: MELCHOR MANGOBA (847) 705-4408

FILE NAME = <small>R:\Engineering\City Projects\2009 Roadway Program\2009 ARRA\drawings\090006500RS.dwg</small>	USER NAME = Amy Wagner	DESIGNED - A. Wagner	REVISED - A. Wagner 10/14/2009	<b>STATE OF ILLINOIS DEPARTMENT OF TRANSPORTATION</b>	<b>BRUCE ROAD PLAN SHEET STA. 10+00 - 25+50</b>		F.A.U. R.T.E. 290/293	SECTION 09-00065-00-RS	COUNTY WILL	TOTAL SHEETS 20	SHEET NO. 05
	PLOT SCALE = None	CHECKED - A. Ries	REVISED -		SCALE: None	SHEET NO. 05 OF 20 SHEETS	STA. 10+00 TO STA. 25+50	CONTRACT NO. 63352		ILLINOIS FED. AID PROJECT	ARA-9003(408)
	PLOT DATE = 10/14/2009	DATE = 8/27/2009	REVISED -								

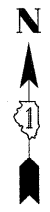

END STA. 27+47  
 -HMA SURF REM, SPECIAL  
 (EDGE MILL ONLY, 6')  
 -POLYMERIZED LEVELING BINDER (MM),  
 IL4.75, N70 , 3/4", 5520 SY  
 -HOT-MIX ASPHALT SURFACE COURSE,  
 MIX C, IL-9.5mm,N50, 2" 5520 SY

SEE MATCHLINE SHEET 5, STA. 17+50

SEE MATCHLINE BELOW, STA. 33+50

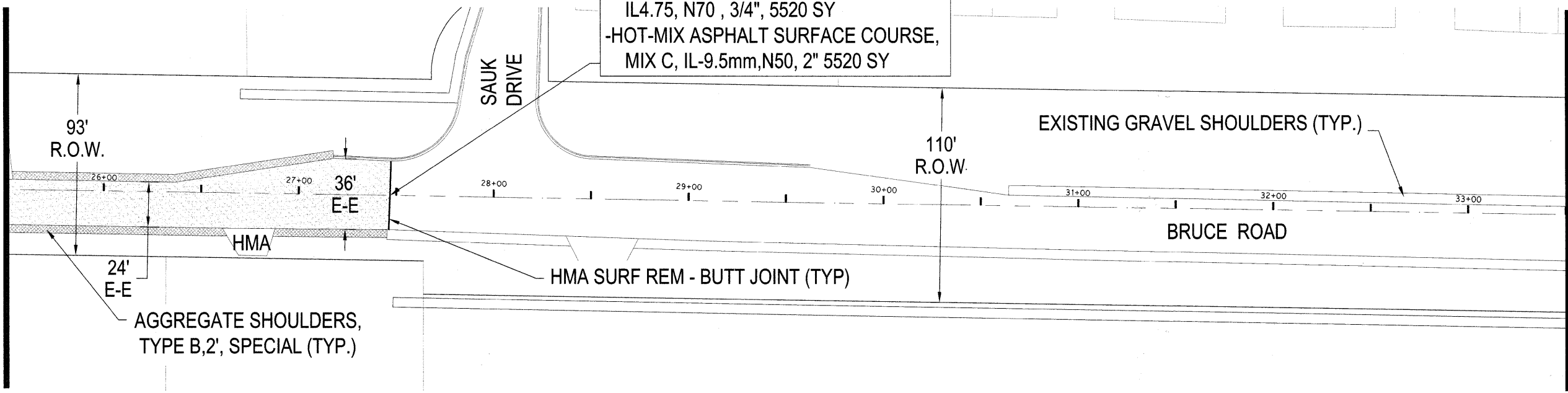

SEE MATCHLINE ABOVE, STA. 33+50

SEE MATCHLINE SHEET 7, STA. 41+50

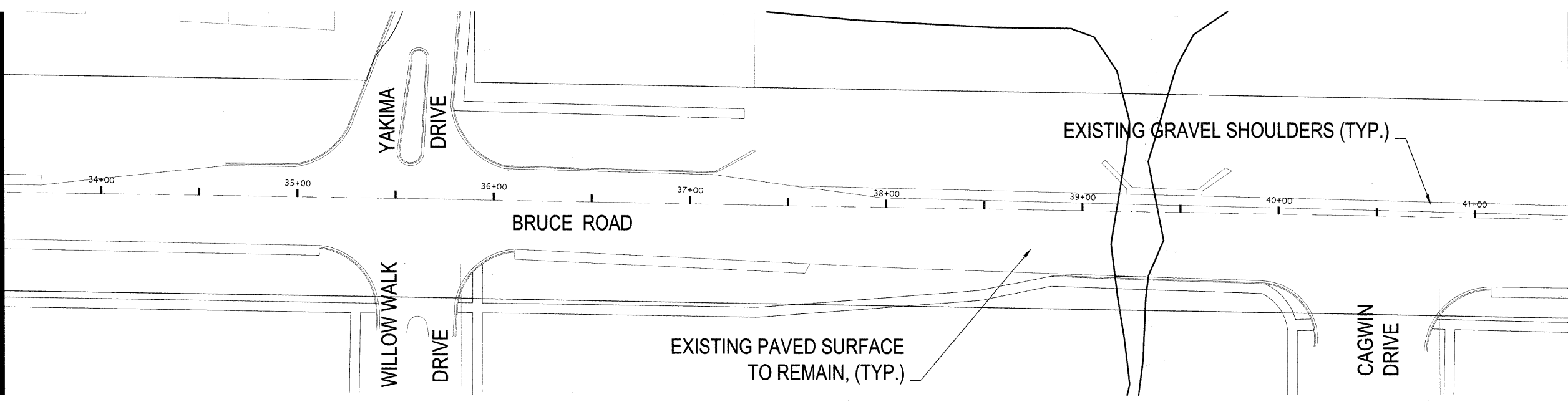

FIELD ENGINEER: MELCHOR MANGOBA (847) 705-4408

FILE NAME =	USER NAME = Amy Wagner	DESIGNED -- A. Wagner	REVISED -- A. Wagner 10/14/2009
		DRAWN -- A. Wagner	REVISED --
	PLOT SCALE = None	CHECKED -- A. Ries	REVISED --
	PLOT DATE = 10/14/2009	DATE -- 8/27/2009	REVISED --

STATE OF ILLINOIS  
 DEPARTMENT OF TRANSPORTATION

BRUCE ROAD PLAN SHEET  
 STA. 10+00 - 41+00

SCALE: None    SHEET NO. 06 OF 20 SHEETS    STA. 10+00 TO STA. 41+00

F.A.U. RTE.	SECTION	COUNTY	TOTAL SHEETS	SHEET NO.
290/293	09-00065-00-RS	WILL	20	06
CONTRACT NO. 63352			ILLINOIS FED. AID PROJECT ARA-9003(408)	



SEE MATCHLINE SHEET 6, STA. 41+50

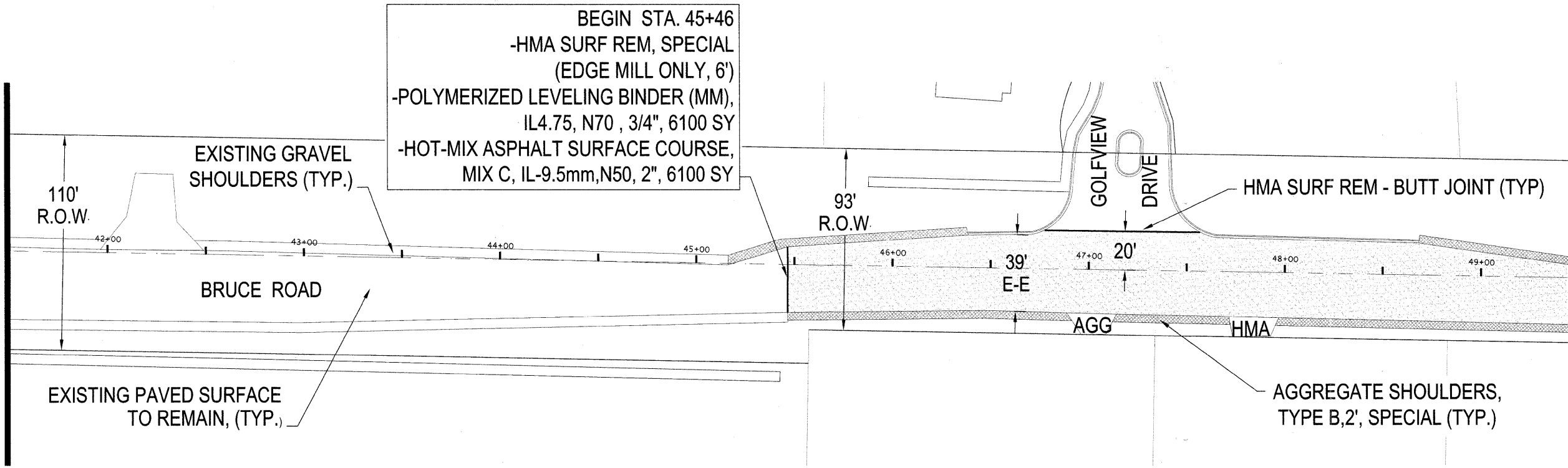

SEE MATCHLINE BELOW, STA. 49+50

SEE MATCHLINE ABOVE, STA. 49+50

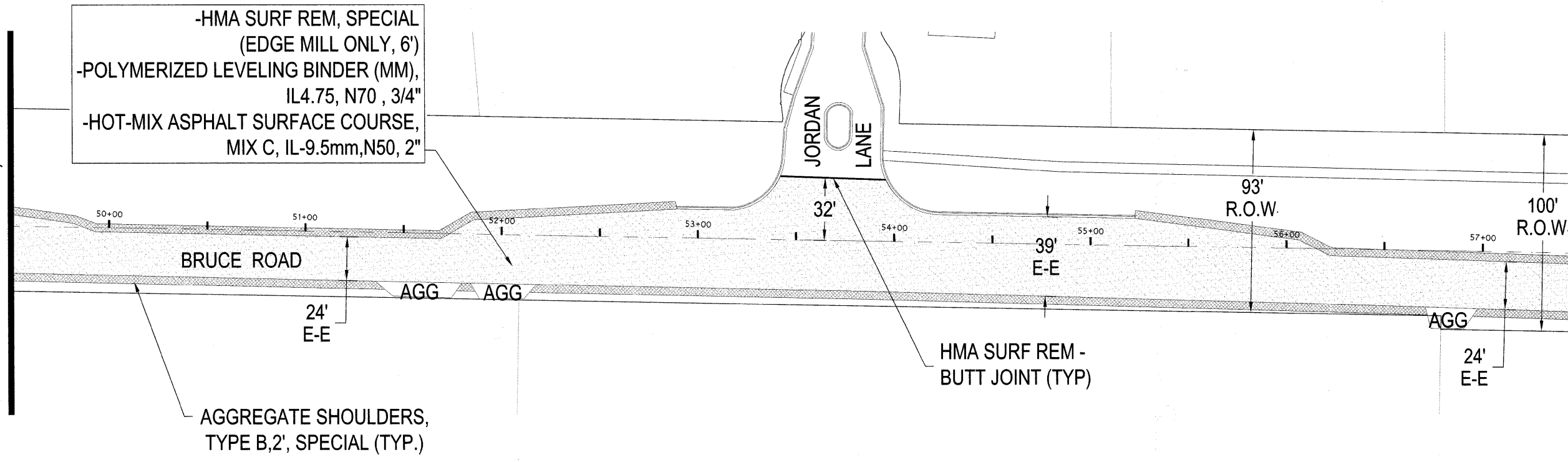

SEE MATCHLINE SHEET 8, STA. 57+50



FIELD ENGINEER: MELCHOR MANGOBA (847) 705-4408

FILE NAME =	USER NAME = Amy Wagner	DESIGNED - A. Wagner	REVISED - A. Wagner 10/14/2009
R:\Engineering\City Projects\2009 Roadway Program\2009 ARRA\drawings\090006500RS.dwg	DRAWN - A. Wagner	CHECKED - A. Ries	REVISED -
	PLOT SCALE = None	DATE - 8/27/2009	REVISED -
	PLOT DATE = 10/14/2009		

**STATE OF ILLINOIS  
DEPARTMENT OF TRANSPORTATION**

<b>BRUCE ROAD PLAN SHEET STA. 41+50 - 57+50</b>		
SCALE: None	SHEET NO. 07 OF 20 SHEETS	STA. 41+50 TO STA. 57+50

F.A.U. RTE.	SECTION	COUNTY	TOTAL SHEETS	SHEET NO.
290/293	09-00065-00-RS	WILL	20	07
CONTRACT NO. 63352			ILLINOIS FED. AID PROJECT ARA-9003(408)	



**PROJECT LIMITS**  
 END STA. 62+12  
 -HMA SURF REM, SPECIAL  
 (EDGE MILL ONLY, 6')  
 -POLYMERIZED LEVELING BINDER (MM),  
 IL4.75, N70, 3/4", 6100 SY  
 -HOT-MIX ASPHALT SURFACE COURSE,  
 MIX C, IL-9.5mm, N50, 2", 6100 SY

SEE MATCHLINE SHEET 7, STA. 57+50

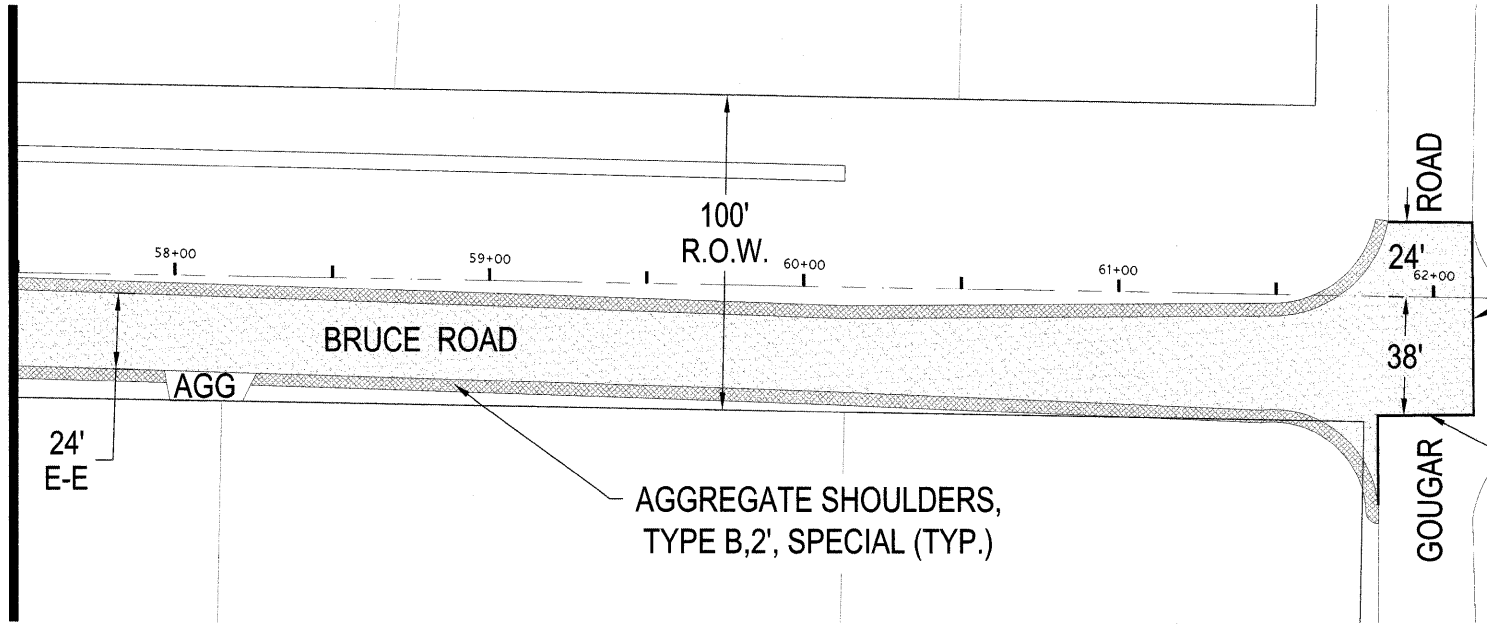

24'  
E-E

AGG

BRUCE ROAD

100'  
R.O.W.

AGGREGATE SHOULDERS,  
TYPE B, 2', SPECIAL (TYP.)

ROAD

GOUGAR

HMA SURF REM -  
BUTT JOINT (TYP)

FIELD ENGINEER: MELCHOR MANGOBA (847) 705-4408

FILE NAME =	USER NAME = Amy Wagner	DESIGNED - A. Wagner	REVISED - A. Wagner 10/14/2009
		DRAWN - A. Wagner	REVISED -
	PLOT SCALE = None	CHECKED - A. Ries	REVISED -
	PLOT DATE = 10/14/2009	DATE - 8/27/2009	REVISED -

STATE OF ILLINOIS  
DEPARTMENT OF TRANSPORTATION

BRUCE ROAD PLAN SHEET  
STA. 57+50 - 62+12

SCALE: None SHEET NO. 08 OF 20 SHEETS STA. 57+50 TO STA. 62+12

F.A.U. RTE.	SECTION	COUNTY	TOTAL SHEETS	SHEET NO.
290/293	09-0065-00-RS	WILL	20	08
CONTRACT NO. 63352			ILLINOIS FED. AID PROJECT ARA-9003(408)	





**PROJECT LIMITS**  
 BEGIN STA. 10+34'  
 -HOT-MIX ASPHALT SURFACE REMOVAL, 2", 5900 SY  
 -HOT-MIX ASPHALT SURFACE COURSE,  
 MIX C, IL-9.5mm,N50, 2" 5900 SY

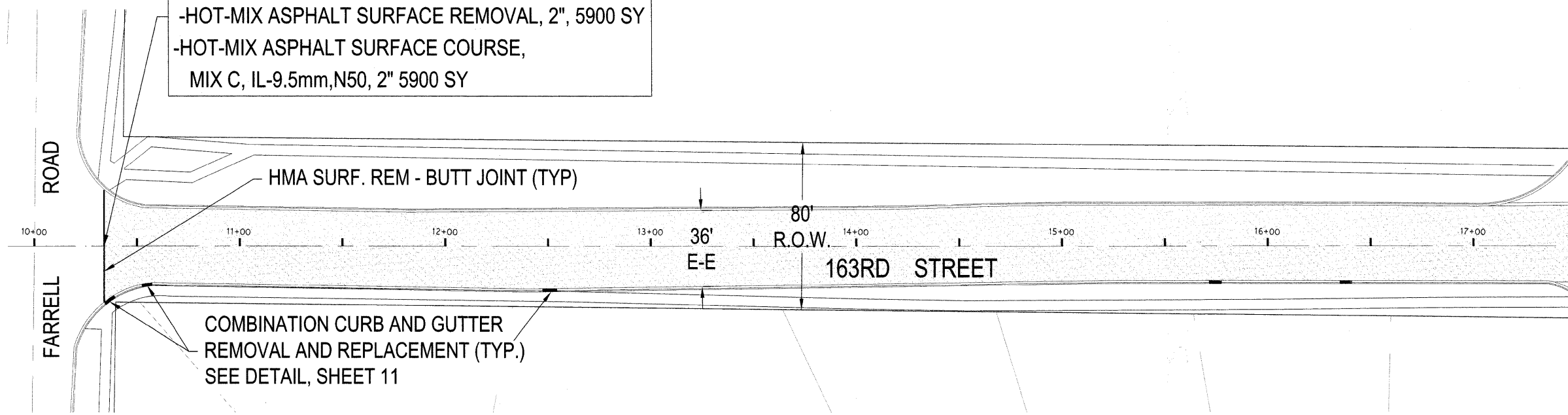

SEE MATCHLINE BELOW, STA. 17+50

STA. 25+05 END  
 -HMA SURF REMOVAL, 2", 5900 SY  
 -HOT-MIX ASPHALT SURFACE COURSE,  
 MIX C, IL-9.5mm,N50, 2", 5900 SY  
 BEGIN  
 -HMA SURF REMOVAL,  
 SPECIAL (EDGE MILL ONLY, 6")  
 -POLYMERIZED LEVELING BINDER (MM),  
 IL4.75, N70, 3/4", 1500 SY  
 -HOT-MIX ASPHALT SURFACE COURSE,  
 MIX C, IL-9.5mm,N50, 2", 1500 SY

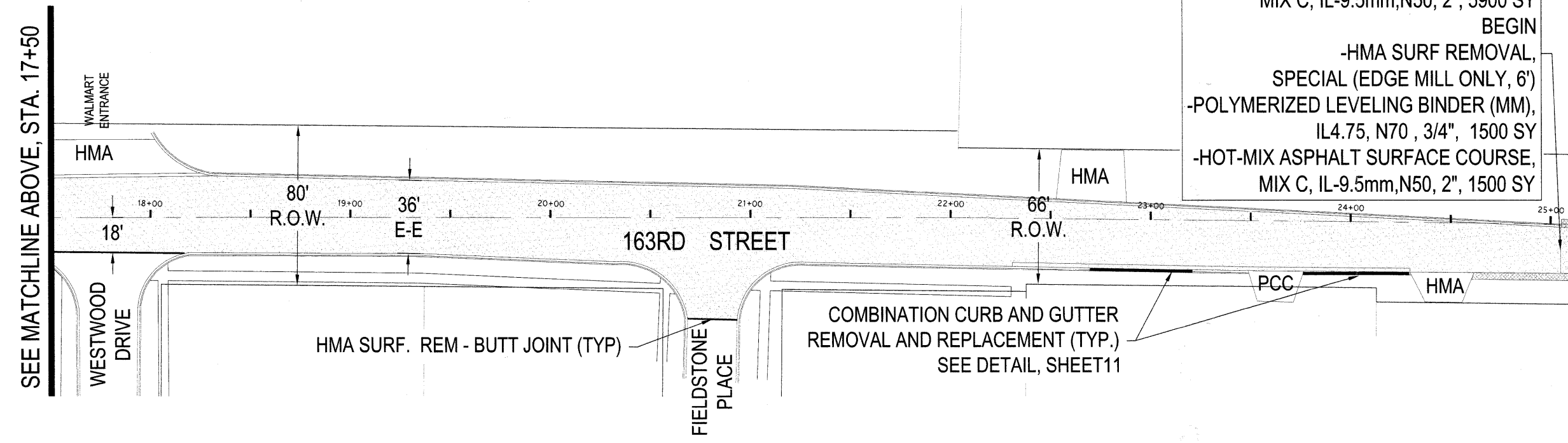

SEE MATCHLINE ABOVE, STA. 17+50

SEE MATCHLINE SHEET 10, STA. 25+50

FIELD ENGINEER: MELCHOR MANGOBA (847) 705-4408

FILE NAME =	USER NAME = Amy Wagner	DESIGNED -- A. Wagner	REVISED -- A. Wagner 10/14/2009
R:\Engineering\City Projects\2009 Roadway Program\2009 ARRA\drawings\09000600RS.dwg	PLOT SCALE = None	DRAWN -- A. Wagner	REVISED --
	PLOT DATE = 10/14/2009	CHECKED -- A. Ries	REVISED --
		DATE -- 8/27/2009	REVISED --

STATE OF ILLINOIS  
 DEPARTMENT OF TRANSPORTATION

163RD STREET PLAN SHEET  
 STA. 10+00 - 25+50  
 SCALE: None SHEET NO. 09 OF 20 SHEETS STA. 10+00 TO STA. 25+50

F.A.U. RTE.	SECTION	COUNTY	TOTAL SHEETS	SHEET NO.
290/293	09-00065-00-RS	WILL	20	09
CONTRACT NO. 63352			ILLINOIS FED. AID PROJECT ARA-9003(408)	



SEE MATCHLINE SHEET 9, STA. 25+50

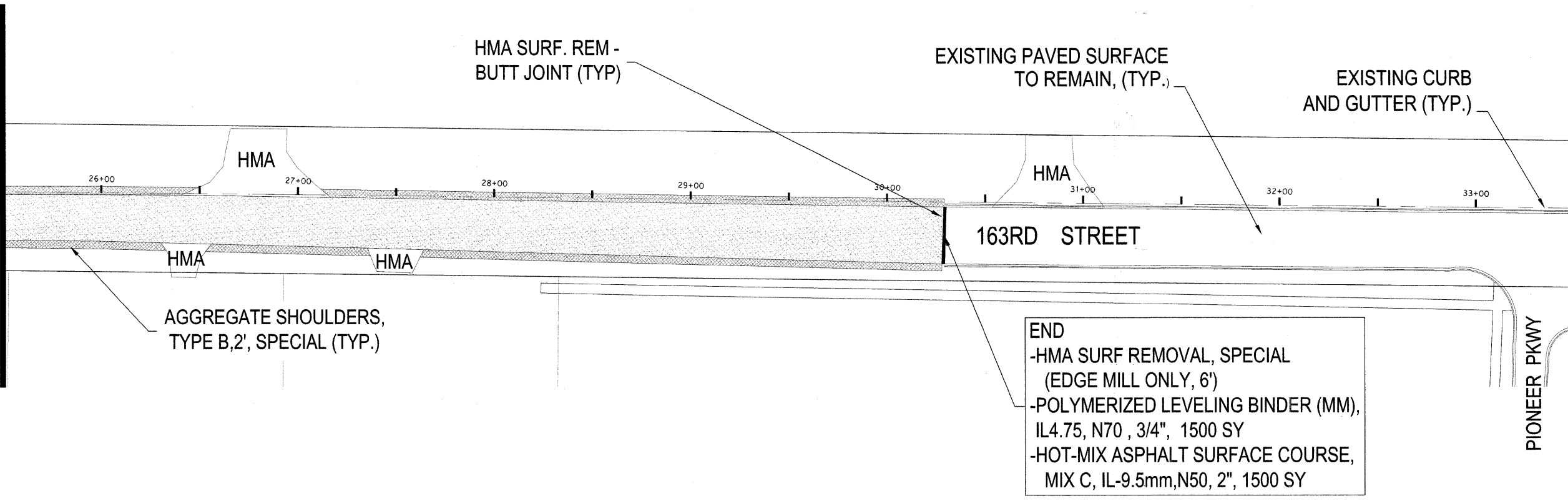

SEE MATCHLINE BELOW, STA. 33+50

SEE MATCHLINE ABOVE, STA. 33+50

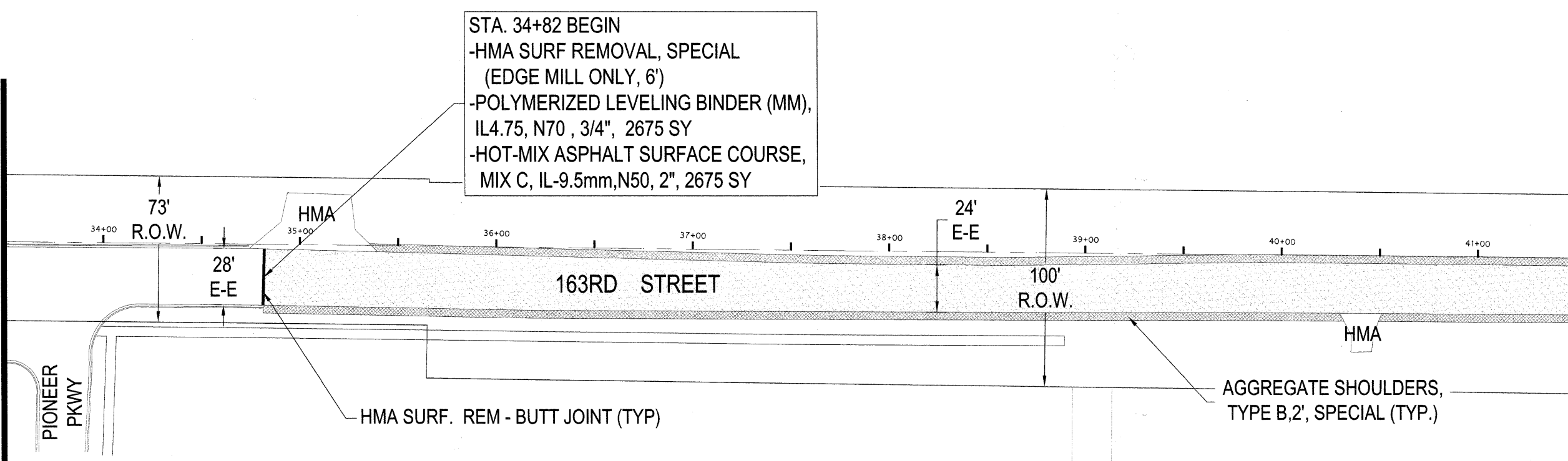

SEE MATCHLINE SHEET 11, STA. 41+50

FIELD ENGINEER: MELCHOR MANGOBA (847) 705-4408

FILE NAME =	USER NAME = Amy Wagner	DESIGNED -- A. Wagner	REVISED -- A. Wagner 10/14/2009
		DRAWN -- A. Wagner	REVISED --
	PLOT SCALE = None	CHECKED -- A. Ries	REVISED --
	PLOT DATE = 10/14/2009	DATE -- 8/27/2009	REVISED --

STATE OF ILLINOIS  
DEPARTMENT OF TRANSPORTATION

163RD STREET PLAN SHEET  
STA. 10+00 - 25+50

SCALE: None    SHEET NO. 10 OF 20 SHEETS    STA. 25+50 TO STA. 41+50

F.A.U. RTE.	SECTION	COUNTY	TOTAL SHEETS	SHEET NO.
290/293	09-00065-00-RS	WILL	20	10
CONTRACT NO. 63352			ILLINOIS FED. AID PROJECT ARA-9003(408)	

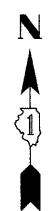

SEE MATCHLINE SHEET 10, STA. 41+50

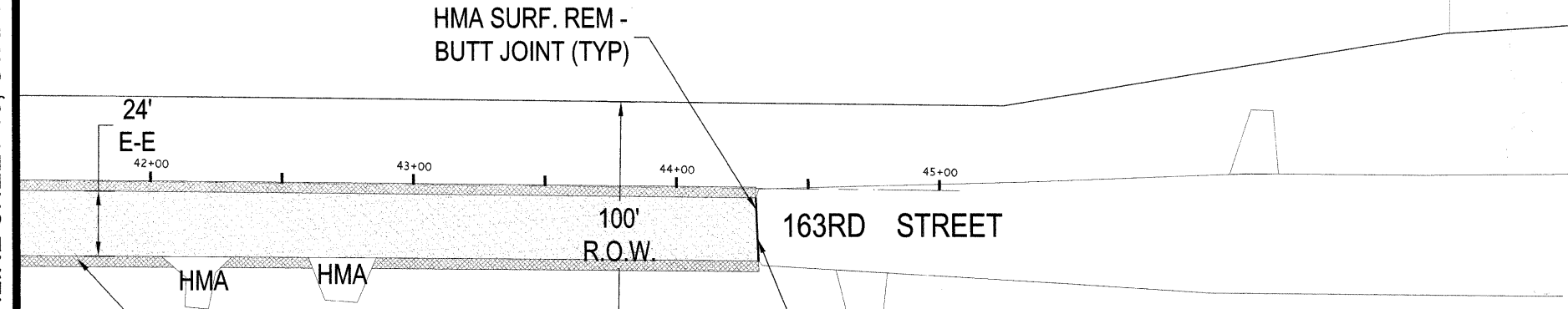

AGGREGATE SHOULDERS, TYPE B,2', SPECIAL (TYP.)

**PROJECT LIMITS**  
 STA. 44+30 END  
 -HMA SURF REMOVAL, SPECIAL (EDGE MILL ONLY, 6')  
 -POLYMERIZED LEVELING BINDER (MM), IL4.75, N70, 3/4", 2675 SY  
 -HOT-MIX ASPHALT SURFACE COURSE, MIX C, IL-9.5mm,N50, 2", 2675 SY

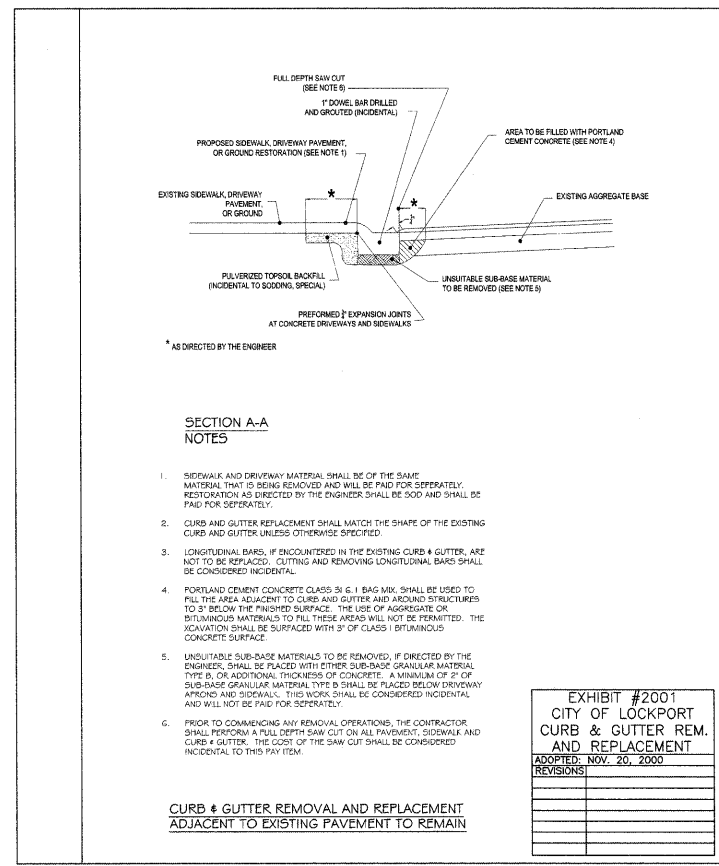

- SECTION A-A NOTES**
- SIDEWALK AND DRIVEWAY MATERIAL SHALL BE OF THE SAME MATERIAL THAT IS BEING REMOVED AND WILL BE PAID FOR SEPARATELY. RESTORATION AS DIRECTED BY THE ENGINEER SHALL BE PAID FOR SEPARATELY.
  - CURB AND GUTTER REPLACEMENT SHALL MATCH THE SHAPE OF THE EXISTING CURB AND GUTTER UNLESS OTHERWISE SPECIFIED.
  - LONGITUDINAL BARS, IF ENCOUNTERED IN THE EXISTING CURB & GUTTER, ARE NOT TO BE REPLACED. CUTTING AND REMOVING LONGITUDINAL BARS SHALL BE CONSIDERED INCIDENTAL.
  - PORTLAND CEMENT CONCRETE CLASS 36 & 1 BAG MIX SHALL BE USED TO FILL THE AREA ADJACENT TO CURB AND GUTTER AND AROUND STRUCTURES TO 3\"/>

**EXHIBIT #2001  
CITY OF LOCKPORT  
CURB & GUTTER REM.  
AND REPLACEMENT**

ADOPTED: NOV. 20, 2000
REVISIONS

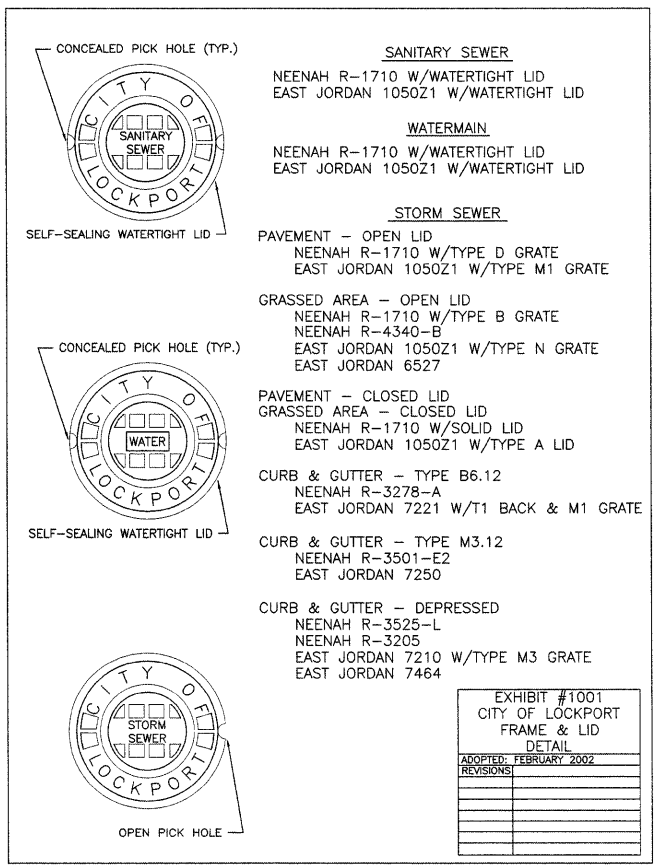

- SANITARY SEWER**  
 NEENAH R-1710 W/WATERTIGHT LID  
 EAST JORDAN 1050Z1 W/WATERTIGHT LID
- WATERMAIN**  
 NEENAH R-1710 W/WATERTIGHT LID  
 EAST JORDAN 1050Z1 W/WATERTIGHT LID
- STORM SEWER**
- PAVEMENT - OPEN LID  
 NEENAH R-1710 W/TYP D GRATE  
 EAST JORDAN 1050Z1 W/TYP M1 GRATE
- GRASSED AREA - OPEN LID  
 NEENAH R-1710 W/TYP B GRATE  
 NEENAH R-4340-B  
 EAST JORDAN 1050Z1 W/TYP N GRATE  
 EAST JORDAN 6527
- PAVEMENT - CLOSED LID  
 GRASSED AREA - CLOSED LID  
 NEENAH R-1710 W/SOLID LID  
 EAST JORDAN 1050Z1 W/TYP A LID
- CURB & GUTTER - TYPE B6.12  
 NEENAH R-3278-A  
 EAST JORDAN 7221 W/T1 BACK & M1 GRATE
- CURB & GUTTER - TYPE M3.12  
 NEENAH R-3501-E2  
 EAST JORDAN 7250
- CURB & GUTTER - DEPRESSED  
 NEENAH R-3525-L  
 NEENAH R-3205  
 EAST JORDAN 7210 W/TYP M3 GRATE  
 EAST JORDAN 7464

**EXHIBIT #1001  
CITY OF LOCKPORT  
FRAME & LID  
DETAIL**

ADOPTED: FEBRUARY 2002
REVISIONS

FIELD ENGINEER: MELCHOR MANGOBA (847) 705-4408

FILE NAME =	USER NAME = Amy Wagner	DESIGNED -- A. Wagner	REVISED -- A.Wagner 10/14/2009
R:\Engineering\City Projects\2009 Roadway Program\2009 ARRA\Drawings\09000650RS.dwg	PLOT SCALE = None	DRAWN -- A. Wagner	REVISED --
	PLOT DATE = 10/14/2009	CHECKED -- A. Ries	REVISED --
		DATE -- 8/27/2009	REVISED --

STATE OF ILLINOIS  
DEPARTMENT OF TRANSPORTATION

163RD STREET PLAN SHEET  
STA. 10+00 - 25+50

SCALE: None	SHEET NO. 11 OF 20 SHEETS	STA. 41+50 TO STA. 44+30
-------------	---------------------------	--------------------------

F.A.U. RTE. 290/293	SECTION 09-00065-00-RS	COUNTY WILL	TOTAL SHEETS 20	SHEET NO. 11
CONTRACT NO. 63352				ILLINOIS FED. AID PROJECT ARA-9003(408)

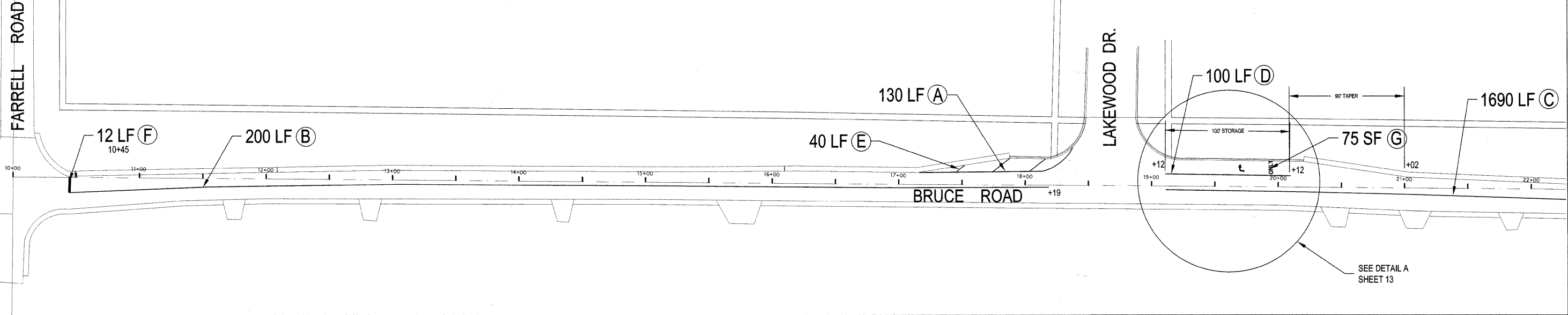

**PAVEMENT MARKING PLAN**

SCALE: 1" = 80'

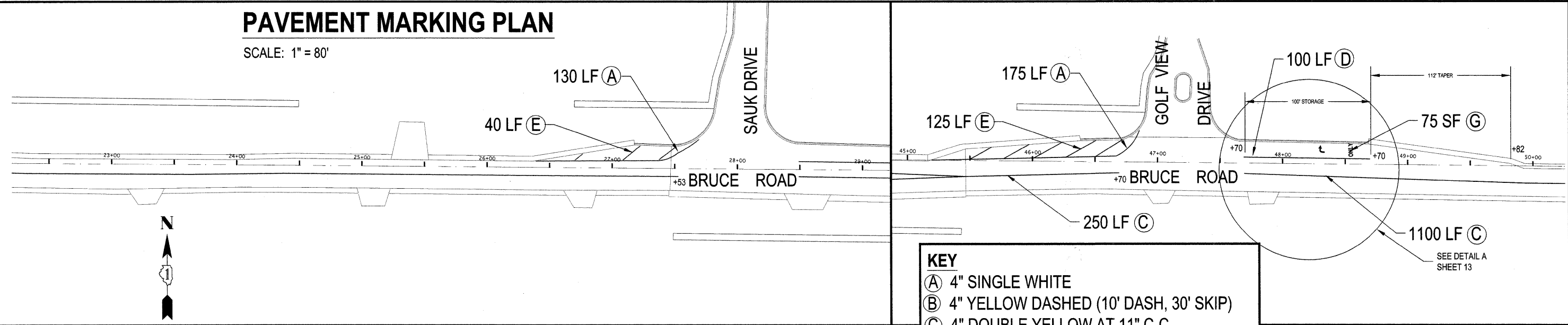

**KEY**

- (A) 4" SINGLE WHITE
- (B) 4" YELLOW DASHED (10' DASH, 30' SKIP)
- (C) 4" DOUBLE YELLOW AT 11" C-C
- (D) 6" WHITE SOLID
- (E) 6" WHITE DIAGONAL AT 45° AT 20' C-C
- (F) 24" WHITE SOLID
- (G) LETTERS & SYMBOLS

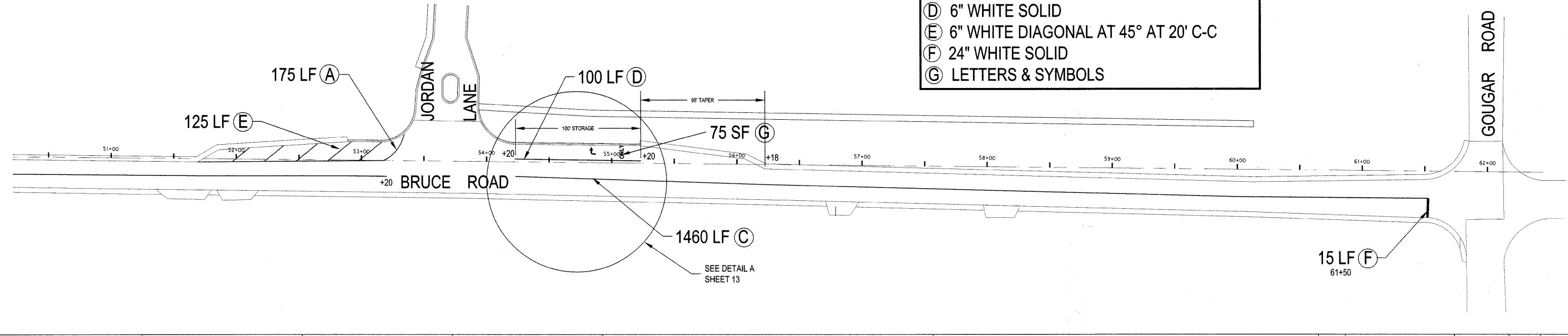

FIELD ENGINEER: MELCHOR MANGOBA (847) 705-4408

FILE NAME =	USER NAME = Amy Wagner	DESIGNED - A. Wagner	REVISED - A. Wagner 10/14/2009
R:\Engineering\City Projects\2009 Roadway Program\2009 ARRA\drawings\090006500RS.dwg		DRAWN - A. Wagner	REVISED -
	PLOT SCALE = None	CHECKED - A. Ries	REVISED -
	PLOT DATE = 10/14/2009	DATE - 8/27/2009	REVISED -

STATE OF ILLINOIS  
DEPARTMENT OF TRANSPORTATION

BRUCE ROAD PAVEMENT MARKING PLAN		
SCALE: None	SHEET NO. 12 OF 20 SHEETS	STA. 10+00 TO STA. 62+12

F.A.U. RTE. 290/293	SECTION 09-00065-00-RS	COUNTY WILL	TOTAL SHEETS 20	SHEET NO. 12
CONTRACT NO. 63352			ILLINOIS FED. AID PROJECT ARA-9003(408)	

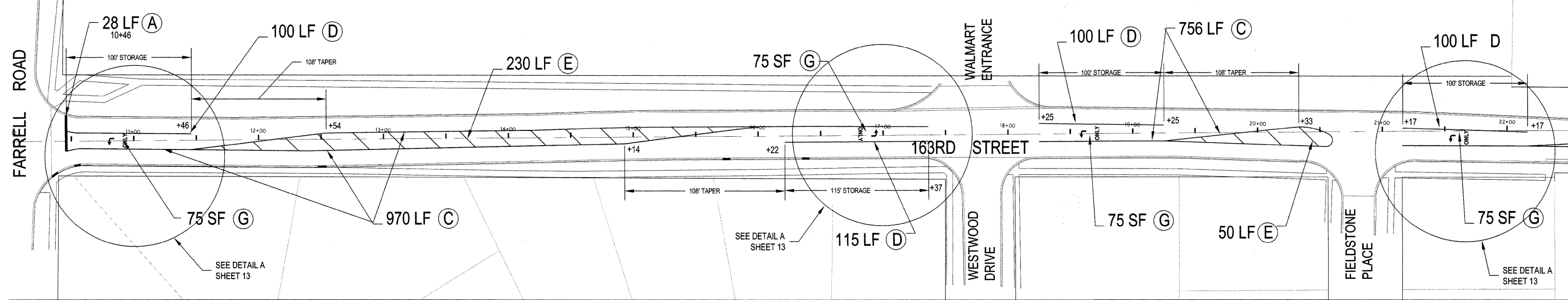

**PAVEMENT MARKING PLAN**

SCALE: 1" = 80'

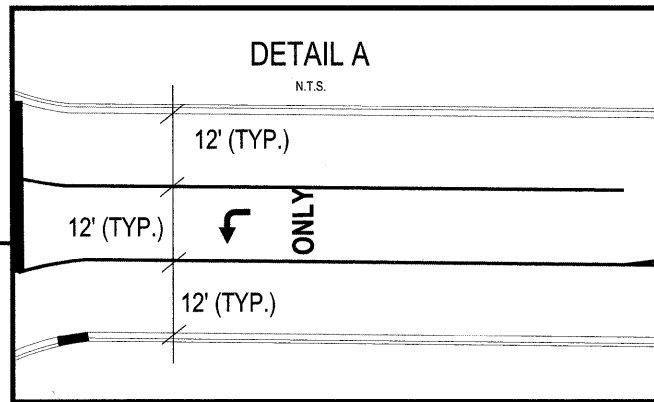
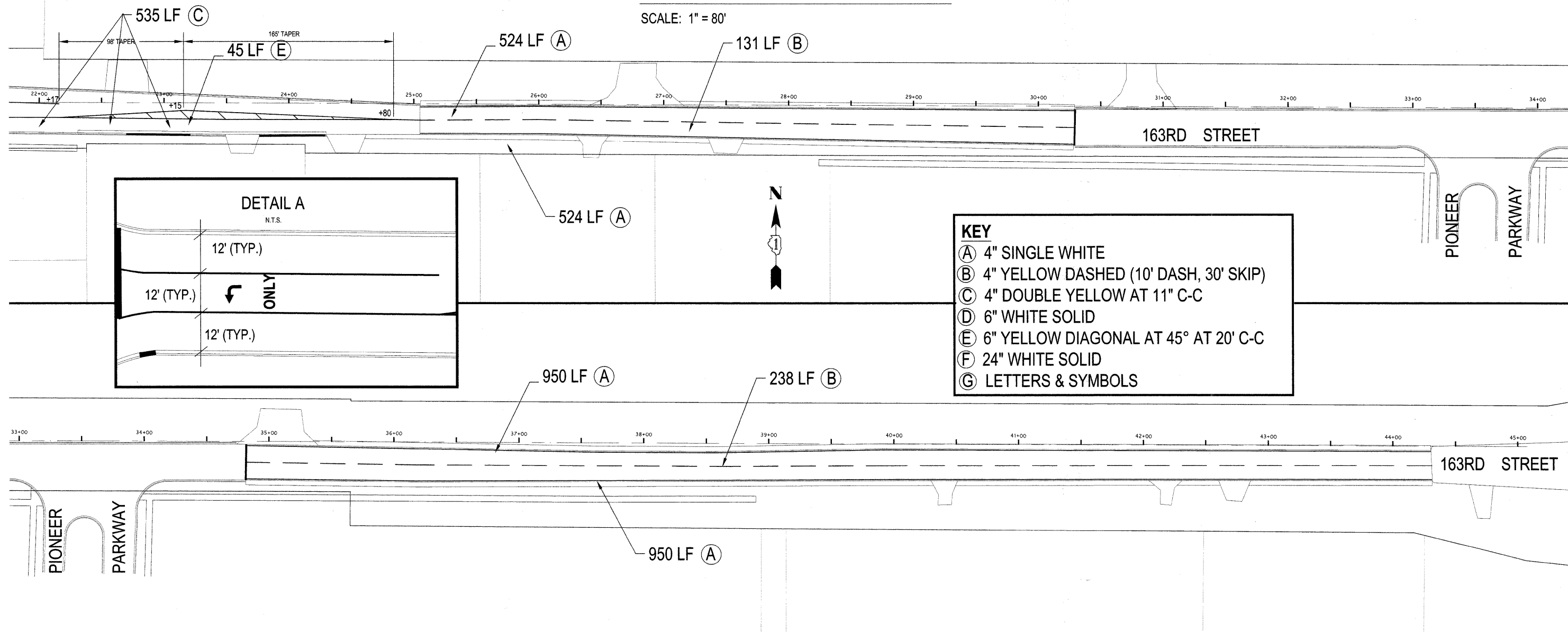

**KEY**

- (A) 4" SINGLE WHITE
- (B) 4" YELLOW DASHED (10' DASH, 30' SKIP)
- (C) 4" DOUBLE YELLOW AT 11" C-C
- (D) 6" WHITE SOLID
- (E) 6" YELLOW DIAGONAL AT 45° AT 20' C-C
- (F) 24" WHITE SOLID
- (G) LETTERS & SYMBOLS

FIELD ENGINEER: MELCHOR MANGOBA (847) 705-4408

FILE NAME =	USER NAME = Army Wagner	DESIGNED — A. Wagner	REVISED — A. Wagner 10/14/2009
R:\Engineering\City\Project\2009 Roadway Program\2009 ARRA\drawings\090006500RS.dwg	PLOT SCALE = None	DRAWN — A. Wagner	REVISED —
	PLOT DATE = 10/14/2009	CHECKED — A. Ries	REVISED —
		DATE — 8/27/2009	REVISED —

STATE OF ILLINOIS  
DEPARTMENT OF TRANSPORTATION

163RD STREET PAVEMENT MARKING PLAN		
SCALE: None	SHEET NO. 13 OF 20 SHEETS	STA. 10+00 TO STA. 43+30

F.A.U. RTE.	SECTION	COUNTY	TOTAL SHEETS	SHEET NO.
290/293	09-00065-00-RS	WILL	20	13
CONTRACT NO. 63352			ILLINOIS FED. AID PROJECT ARA-9003(408)	

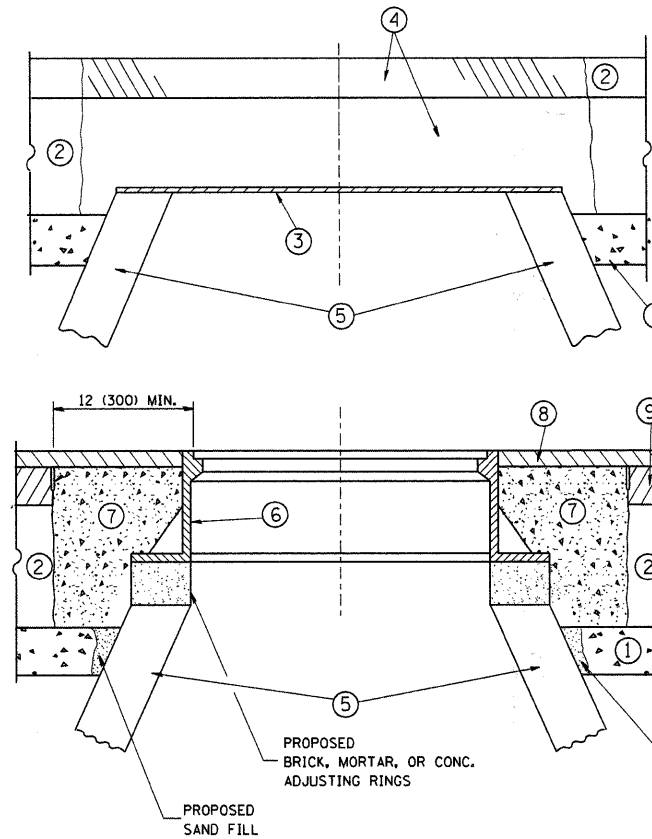

**CONSTRUCTION PROCEDURES**

**STAGE 1 (BEFORE PAVEMENT MILLING)**

- A) REMOVE A MINIMUM OF 12 (300) OF THE PAVEMENT FROM AROUND THE STRUCTURE.
- B) REMOVE THE EXISTING FRAME AND LID FROM THE STRUCTURE.
- C) COVER THE STRUCTURE OPENING WITH A 36 (900) DIAMETER METAL PLATE.
- D) BACKFILL WITH CRUSHED STONE AND A MINIMUM 1 1/2 (40) THICK HMA SURFACE MIX APPROVED BY THE ENGINEER.

**STAGE 2 (AFTER PAVEMENT MILLING)**

- A) REMOVE THE HMA SURFACE MIX AND CRUSHED STONE.
- B) INSTALL THE FRAME AND LID; ADJUST THE FRAME TO ITS FINAL SURFACE ELEVATION.
- C) THE SURROUNDING SPACE SHALL BE FILLED WITH CLASS SI CONCRETE, OR HMA SURFACE COURSE OR HMA BINDER COURSE TO THE ELEVATION OF THE SURFACE OF THE EXISTING BASE COURSE OR THE BINDER COURSE.

THE PROCEDURE EXPLAINED ABOVE SHALL CONFORM TO THE APPLICABLE PORTIONS OF SECTIONS 353, 406, 602, AND 603 OF THE STANDARD SPECIFICATIONS.

**LEGEND**

- ① SUB-BASE GRANULAR MATERIAL
- ② EXISTING PAVEMENT
- ③ 36 (900) DIAMETER METAL PLATE
- ④ PROPOSED CRUSHED STONE AND HMA SURFACE MIX
- ⑤ EXISTING STRUCTURE
- ⑥ FRAME AND LID (SEE NOTES)
- ⑦ CLASS SI CONCRETE, HMA SURFACE COURSE OR HMA BINDER COURSE
- ⑧ PROPOSED HMA SURFACE COURSE
- ⑨ PROPOSED HMA BINDER COURSE

**NOTES:**

EXISTING BROKEN FRAMES AND LIDS SHALL BE REMOVED AND DISPOSED OF BY THE CONTRACTOR AND SHALL BE REPLACED AS DIRECTED BY THE ENGINEER. REPLACEMENT FRAMES AND LIDS WILL BE PAID FOR IN ACCORDANCE WITH ARTICLE 109.04 OF THE STANDARD SPECIFICATIONS UNLESS A SEPARATE PAY ITEM HAS BEEN PROVIDED.

IF THE EXISTING LIDS ARE OPEN, THE FRAME WILL BE ADJUSTED TO THE ELEVATION OF THE MILLED PAVEMENT SURFACE PRIOR TO THE MILLING OPERATION. THE FRAME WILL NOT BE REMOVED AND COVERED BY THE METAL PLATE.

CITY OF CHICAGO CASTINGS ARE THE PROPERTY OF THE CITY AND THE CONTRACTOR SHALL NOTIFY THE CITY FOR REMOVAL AND DISPOSITION OF THE CASTINGS.

THE METAL PLATE USED TO COVER THE STRUCTURE SHALL REMAIN THE PROPERTY OF THE CONTRACTOR.

WHEN STRUCTURES ARE TO BE ADJUSTED OR RECONSTRUCTED, THE LOWERING AND RAISING OF THE FRAMES AND LIDS WILL NOT BE PAID FOR SEPARATELY BUT WILL BE INCLUDED IN THE COST OF THE CORRESPONDING PAY ITEM.

**LOCATION OF STRUCTURES:**

THE CONTRACTOR WILL BE REQUIRED TO KEEP A RECORD OF THE LOCATIONS OF THE BURIED STRUCTURES ACCORDING TO THE STATION AND DISTANCE LEFT OR RIGHT OF THE CENTERLINE OF PAVEMENT. UPON COMPLETION OF THE WORK, THE CONTRACTOR WILL DELIVER THE RECORD TO THE ENGINEER.

**BASIS OF PAYMENT:** THIS WORK WILL BE PAID FOR AT THE CONTRACT UNIT PRICE PER EACH FOR "FRAMES AND LIDS TO BE ADJUSTED, SPECIAL" NEW FRAMES AND LIDS, WHEN SPECIFIED, WILL BE PAID FOR SEPARATELY.

**DETAILS FOR FRAMES AND LIDS ADJUSTMENT WITH MILLING**

ALL DIMENSIONS ARE IN INCHES (MILLIMETERS) UNLESS OTHERWISE SHOWN

FILE NAME = W:\diststd\22x34\bd06.dgn	USER NAME = geglianobt	DESIGNED - R. SHAH	REVISED - R. SHAH 03-10-95	<b>STATE OF ILLINOIS DEPARTMENT OF TRANSPORTATION</b>	<b>DETAILS FOR FRAMES AND LIDS ADJUSTMENT WITH MILLING</b>	F.A. RTE. 290/	SECTION 09-00065-00-RS	COUNTY WILL	TOTAL SHEETS 20	SHEET NO. 14	
	PLOT SCALE = 50.0000' / IN.	CHECKED -	REVISED - A. ABBAS 03-21-97			293	<b>BD600-03 (BD-8)</b>	CONTRACT NO. 63352			
	PLOT DATE = 1/4/2008	DATE - 10-25-94	REVISED - R. WIEDEMAN 05-14-04			SCALE: NONE	SHEET NO. 1 OF 1 SHEETS	STA. TO STA.	FED. ROAD DIST. NO. 1 ILLINOIS FED. AID PROJECT ARA-9003(408)		
			REVISED - R. BORO 01-01-07								

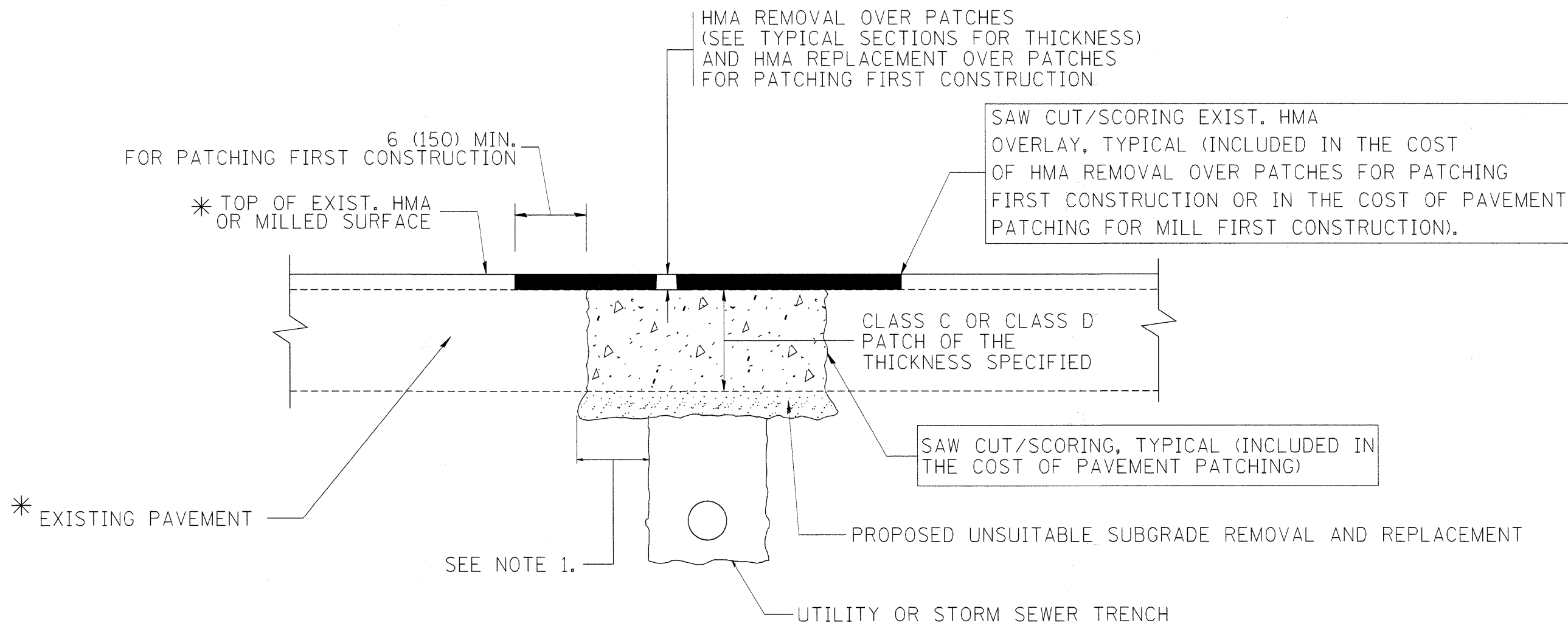

\* SEE TYPICAL SECTIONS FOR THICKNESS AND MATERIALS

**NOTES:**

1. THE WIDTH OF THE FULL DEPTH PATCH OVER A TRENCH SHALL BE 12 (300) WIDER ON EACH SIDE OF THE TRENCH.
2. FOR METHOD OF MEASUREMENT AND BASIS OF PAYMENT, SEE RECURRING SPECIAL PROVISION "PATCHING WITH HOT-MIX ASPHALT OVERLAY REMOVAL".

**SEQUENCE OF CONSTRUCTION (PATCHING FIRST)**

1. REMOVE THE EXISTING HMA MATERIAL OVER THE AREA TO BE PATCHED.
2. REMOVE AND REPLACE WITH CLASS C OR D PATCH.
3. REPLACE HMA MATERIAL OVER THE AREA TO BE PATCHED.

**SEQUENCE OF CONSTRUCTION (MILLING FIRST)**

1. MILL HMA FIRST IF THERE IS AT LEAST 4 1/2 INCHES OR MORE OF HMA MATERIAL ON TOP OF THE EXISTING PAVEMENT OR IF THE PAVEMENT IS FULL DEPTH HMA. A MINIMUM OF 2 INCHES OF HMA MATERIAL SHALL BE IN PLACE AFTER MILLING.
2. REMOVE AND REPLACE WITH FULL DEPTH CLASS D PATCHES TO TOP OF MILLED SURFACE.

ALL DIMENSIONS ARE IN INCHES (MILLIMETERS) UNLESS OTHERWISE SHOWN.

FILE NAME = c:\projects\diststd22x34\bd22.dgn	USER NAME = bwardl	DESIGNED - R. SHAH	REVISED - A. ABBAS 04-27-98	<b>STATE OF ILLINOIS DEPARTMENT OF TRANSPORTATION</b>	<b>PAVEMENT PATCHING FOR HMA SURFACED PAVEMENT</b>	F.A. RTE.	SECTION	COUNTY	TOTAL SHEETS	SHEET NO.	
		DRAWN -	REVISED - R. BORO 01-01-07			290/	09-00065-00-RS	WILL	20	15	
	PLOT SCALE = 50.000 "/ IN.	CHECKED -	REVISED - R. BORO 09-04-07			293	<b>BD400-04 (BD-22)</b>		CONTRACT NO. 63352		
	PLOT DATE = 10/27/2008	DATE - 10-25-94	REVISED - K. ENG 10-27-08			SCALE: NONE		SHEET NO. 1 OF 1 SHEETS	STA. TO STA.	FED. ROAD DIST. NO. 1 ILLINOIS FED. AID PROJECT ARA-9003(408)	

VARIABLE - TO MEET EXISTING DIMENSIONS AND FIELD CONDITIONS (SEE NOTE ②)

PROP. CONC. CURB OR CURB AND GUTTER REPLACEMENT IN ACCORDANCE WITH STATE STANDARD 606001. (SEE NOTE ②)

SAW CUT FULL DEPTH - INCLUDED IN THE COST OF SIDEWALK, DRIVEWAY OR MEDIAN SURFACE REMOVAL PAY ITEM.

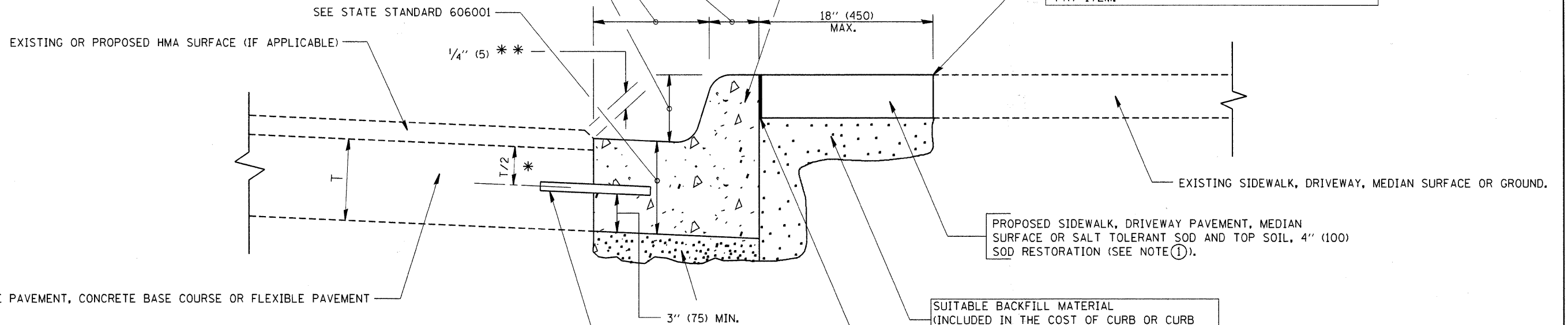

EXISTING CONCRETE PAVEMENT, CONCRETE BASE COURSE OR FLEXIBLE PAVEMENT

\* 3" (75) MINIMUM FROM TOP AND BOTTOM OF THE CONCRETE PAVEMENT OR BASE COURSE.

\*\* IF THE FINAL SURFACE OF THE PAVEMENT IS CONCRETE, THE GUTTER IS TO BE FLUSH WITH THE PAVEMENT.

NOTE: ① SIDEWALK, DRIVEWAY PAVEMENT OR MEDIAN SURFACE SHALL BE SIMILAR TO THE MATERIAL BEING REMOVED AND WILL BE PAID FOR SEPARATELY.

SALT TOLERANT SOD AND TOP SOIL, 4" (100) RESTORATION WILL NOT BE PAID FOR SEPARATELY, BUT SHALL BE INCLUDED IN THE COST OF CURB OR CURB AND GUTTER REMOVAL AND REPLACEMENT.

② CURB OR CURB AND GUTTER REPLACEMENT SHALL MATCH THE SHAPE OF THE EXISTING CURB OR CURB AND GUTTER UNLESS OTHERWISE SPECIFIED.

③ FOR CURB OR CURB AND GUTTER REMOVAL AND REPLACEMENT ADJACENT TO FLEXIBLE PAVEMENT DELETE EPOXY COATED TIE BARS.

④ LONGITUDINAL BARS, IF ENCOUNTERED IN THE EXISTING CURB OR CURB AND GUTTER, ARE NOT TO BE REPLACED. CUTTING AND REMOVING LONGITUDINAL BARS SHALL BE INCLUDED IN THE COST OF CURB OR CURB AND GUTTER REMOVAL AND REPLACEMENT.

⑤ THE COST OF HMA SURFACE REMOVAL IN THE EXISTING GUTTER FLAG SHALL BE INCLUDED IN THE COST OF THE CURB AND GUTTER REMOVAL AND REPLACEMENT.

⑥ THE REMOVAL AND REPLACEMENT OF THE EXISTING CURB OR CURB AND GUTTER SHALL BE DONE IN ACCORDANCE WITH THE APPLICABLE PORTIONS OF SECTION 440 AND 606 OF THE STANDARD SPECIFICATIONS.

⑦ THE LOCATIONS OF REMOVAL AND REPLACEMENT OF EXISTING CURB OR CURB AND GUTTER SHALL BE DETERMINED BY THE RESIDENT ENGINEER AT THE TIME OF CONSTRUCTION.

SUITABLE BACKFILL MATERIAL (INCLUDED IN THE COST OF CURB OR CURB AND GUTTER REMOVAL AND REPLACEMENT)

PROPOSED 3/4" (20) PREFORMED EXPANSION JOINT AT CONCRETE SIDEWALKS, DRIVEWAYS, AND MEDIANS. (INCLUDED IN THE COST OF CURB OR CURB AND GUTTER REMOVAL AND REPLACEMENT.)

UNSUITABLE SUB-BASE MATERIAL TO BE REMOVED, IF DIRECTED BY THE ENGINEER, SHALL BE REPLACED WITH EITHER SUB-BASE GRANULAR MATERIAL, TYPE B OR ADDITIONAL THICKNESS OF CONCRETE.

REMOVAL AND REPLACEMENT 4" (100) OR LESS IS INCLUDED IN THE COST OF CURB OR CURB AND GUTTER REMOVAL AND REPLACEMENT.

REMOVAL AND REPLACEMENT IN EXCESS OF 4" (100) WILL BE PAID FOR IN ACCORDANCE WITH ARTICLE 109.04 OF THE STANDARD SPECIFICATIONS.

PROPOSED #6 (20) EPOXY COATED TIE BARS 24" (600) LONG AT 24" (600) CENTERS WILL NOT BE PAID FOR SEPARATELY. DELETE EPOXY COATED TIE BARS IF EXISTING TIE BARS ARE USUABLE AS DETERMINED BY THE ENGINEER. (SEE NOTE ③).

**BASIS OF PAYMENT:**

THIS WORK WILL BE PAID FOR AT THE CONTRACT UNIT PRICE PER FOOT (METER) FOR "CURB REMOVAL AND REPLACEMENT" OR "COMBINATION CONCRETE CURB AND GUTTER REMOVAL AND REPLACEMENT".

# CURB OR CURB AND GUTTER REMOVAL AND REPLACEMENT

ALL DIMENSIONS ARE IN INCHES (MILLIMETERS) UNLESS OTHERWISE SHOWN.

FILE NAME = W:\diststd\22x34\bd24.dgn	USER NAME = geglienobt	DESIGNED - A. HOUSEH	REVISED - R. SHAH 10-03-96	<b>STATE OF ILLINOIS DEPARTMENT OF TRANSPORTATION</b>	<b>CURB OR CURB AND GUTTER REMOVAL AND REPLACEMENT</b>	F.A. RTE. 290/	SECTION 09-00065-00-RS	COUNTY WILL	TOTAL SHEETS 20	SHEET NO. 16
	PLOT SCALE = 50.000' / IN.	CHECKED -	REVISED - M. GOMEZ 01-22-01			293	<b>BD600-06 (BD-24)</b>	CONTRACT NO. 63352		
	PLOT DATE = 1/4/2008	DATE - 03-11-94	REVISED - R. BORO 01-01-07			SCALE: NONE	SHEET NO. 1 OF 1 SHEETS	STA. TO STA.	FED. ROAD DIST. NO. 1   ILLINOIS FED. AID PROJECT ARA-9003 (408)	



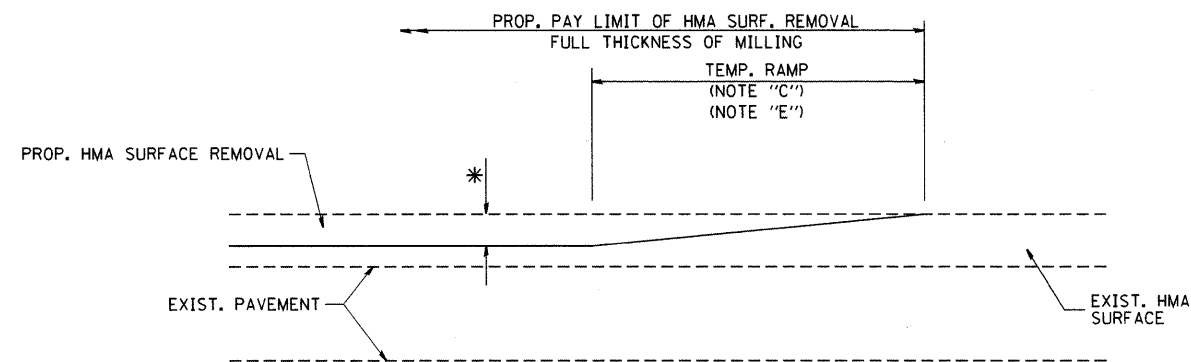

MILLED TEMPORARY RAMP  
(FOR BUTT JOINT AND HMA TAPER SEE DETAIL BELOW)

**OPTION 1**

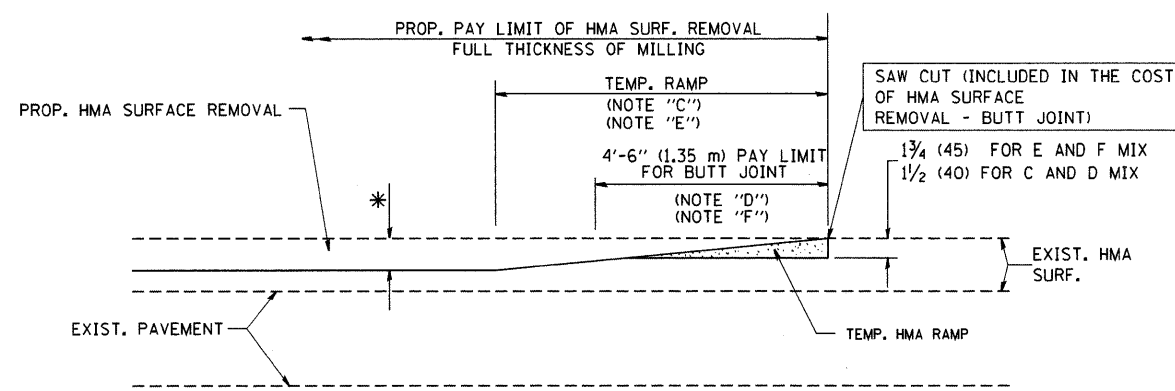

HMA CONSTRUCTED TEMPORARY RAMP  
(FOR BUTT JOINT AND HMA TAPER SEE DETAIL BELOW)

**OPTION 2**

**TYPICAL TEMPORARY RAMP**

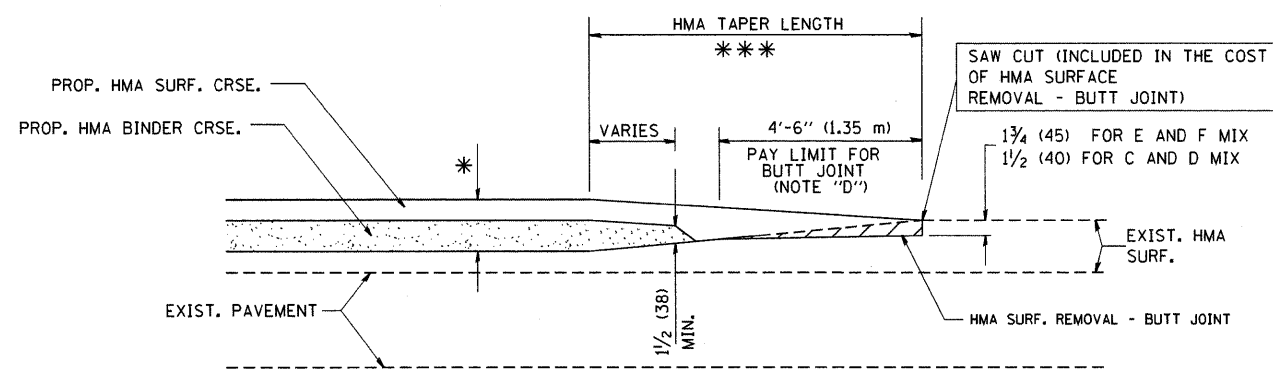

BUTT JOINT AND HMA TAPER  
**TYPICAL BUTT JOINT AND HMA TAPER FOR MILLING AND RESURFACING**

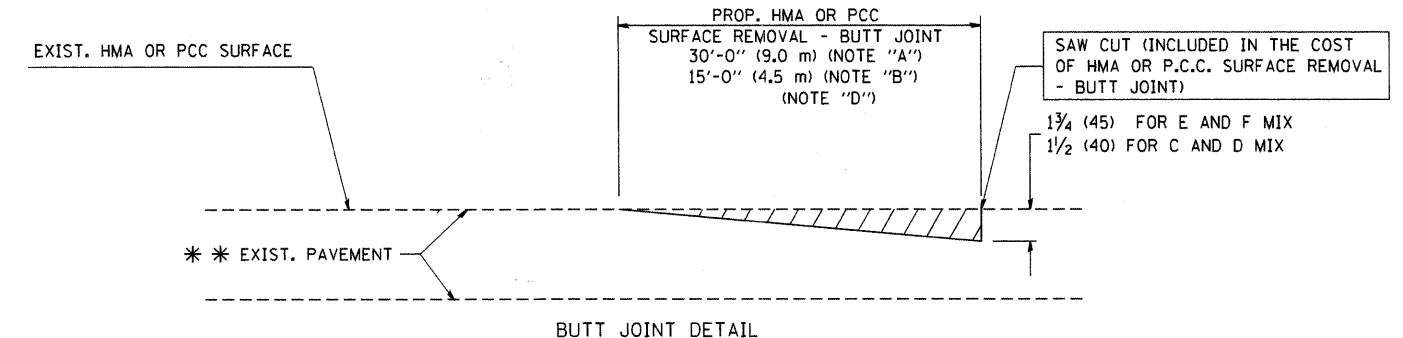

**BUTT JOINT DETAIL**

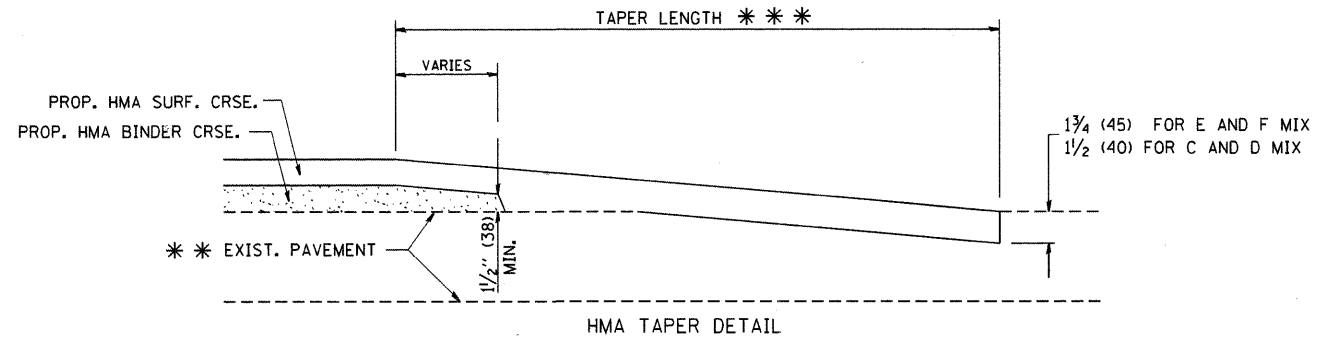

**HMA TAPER DETAIL**

**TYPICAL BUTT JOINT AND HMA TAPER FOR RESURFACING ONLY**

\*\*\* PC CONCRETE, HMA OR HMA RESURFACED PAVEMENT.

**NOTES**

- A: MAINLINE ROADWAYS AND MAJOR SIDE ROADS.
  - B: MINOR SIDE ROADS.
  - C: THE TEMP. RAMP SHALL BE CONSTRUCTED IMMEDIATELY UPON REMOVAL OF THE EXISTING HMA SURFACE.
  - D: THE BUTT JOINT SHALL BE CONSTRUCTED IMMEDIATELY PRIOR TO PLACING THE PROPOSED HMA COURSES.
  - E: TAPER THE TEMP. RAMP AT A RATE OF 3'-0" (900 mm) PER 1 INCH (25 mm) OF MILLING THICKNESS.
  - F: INSTALLATION AND REMOVAL OF THE 4'-6" (1.35 m) TEMP. RAMP IS INCLUDED IN COST OF HMA SURFACE REMOVAL - BUTT JOINT
  - G: SEE ARTICLE 406.08 AND 406.14 OF THE STANDARD SPECIFICATIONS FOR "HMA AND/OR PCC SURFACE REMOVAL, BUTT JOINT".
- \* SEE TYPICAL SECTIONS FOR MILLING THICKNESS.
- \*\*\* 20'-0" (6.1 m) PER 1 (25) RESURFACING (NOTE "A")  
10'-0" (3.0 m) PER 1 (25) RESURFACING (NOTE "B")

**BASIS OF PAYMENT:**

THE BUTT JOINT WILL BE PAID FOR AT THE CONTRACT UNIT PRICE PER SQUARE YARD (SQUARE METER) FOR "HOT-MIX ASPHALT SURFACE REMOVAL - BUTT JOINT" OR FOR "PORTLAND CEMENT CONCRETE SURFACE REMOVAL - BUTT JOINT".

ALL DIMENSIONS ARE IN INCHES (MILLIMETERS) UNLESS OTHERWISE SHOWN.

FILE NAME =	USER NAME = gegl:anobt	DESIGNED - M. DE YONG	REVISED - R. SHAH 10-25-94
W:\diststd\22x34\bd32.dgn		DRAWN -	REVISED - A. ABBAS 03-21-97
	PLOT SCALE = 50.0000' / IN.	CHECKED -	REVISED - M. GOMEZ 04-06-01
	PLOT DATE = 1/4/2008	DATE - 06-13-90	REVISED - R. BORO 01-01-07

**STATE OF ILLINOIS  
DEPARTMENT OF TRANSPORTATION**

**BUTT JOINT AND  
HMA TAPER DETAILS**

SCALE: NONE SHEET NO. 1 OF 1 SHEETS STA. TO STA.

F.A. RTE.	SECTION	COUNTY	TOTAL SHEETS	SHEET NO.
2907	09-00065-00-RS	WILL	20	17
293	<b>BD400-05 BD32</b>	<b>CONTRACT NO.</b>	63352	
FED. ROAD DIST. NO. 1 ILLINOIS FED. AID PROJECT ARA-9003 (408)				



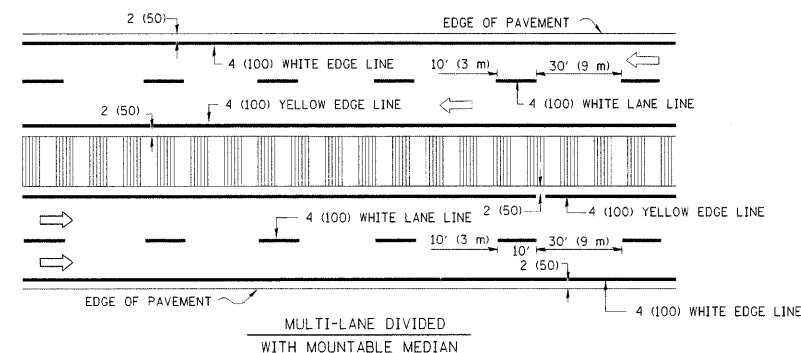
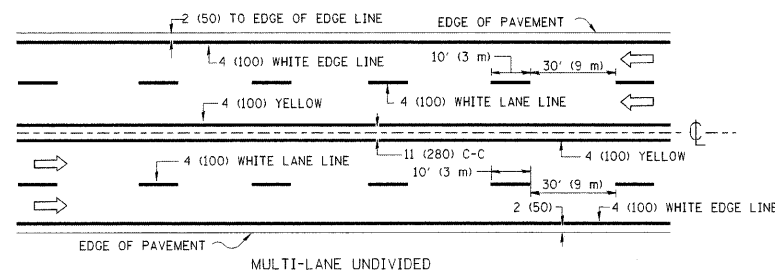
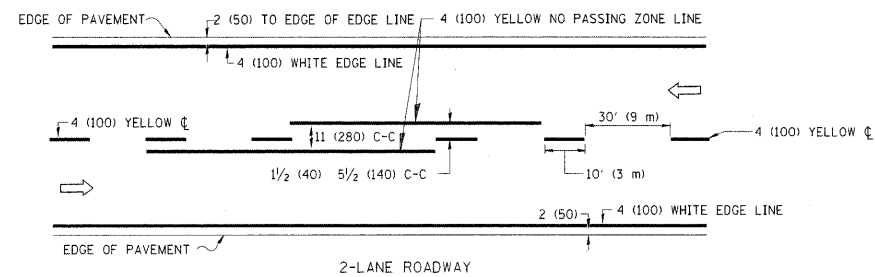

NOTE: MEDIANS WITH BARRIER CURB DO NOT REQUIRE AN EDGE LINE

### TYPICAL LANE AND EDGE LINE MARKING

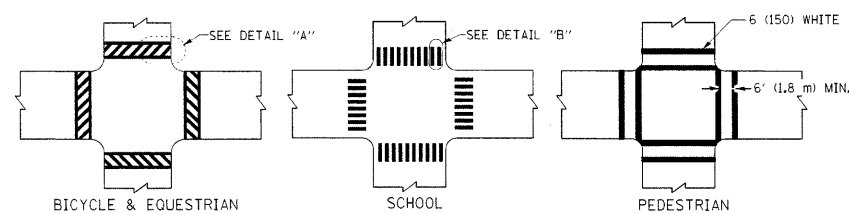

### TYPICAL CROSSWALK MARKING

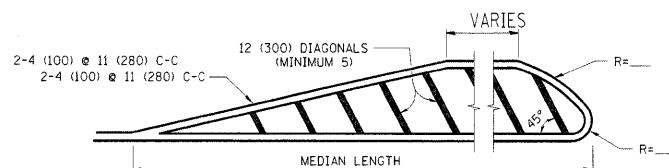
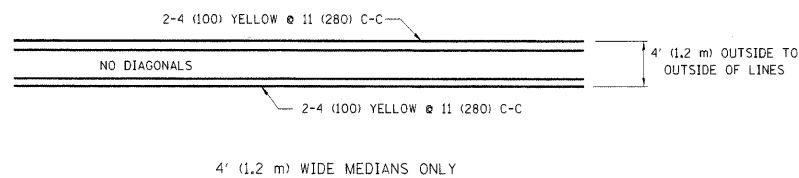

FOR MEDIAN LENGTHS WHERE DIAGONAL SPACING CANNOT BE ATTAINED, USE 5 (FIVE) EQUALLY SPACED DIAGONAL LINES.  
 DIAGONAL LINE SPACING: 50' (15 m) C-C (LESS THAN 30MPH (50 km/h))  
 75' (25 m) C-C 30MPH (50 km/h) TO 45MPH (70 km/h)  
 150' (45 m) C-C (MORE THAN 45MPH (70 km/h))

### MEDIANS OVER 4' (1.2 m) WIDE

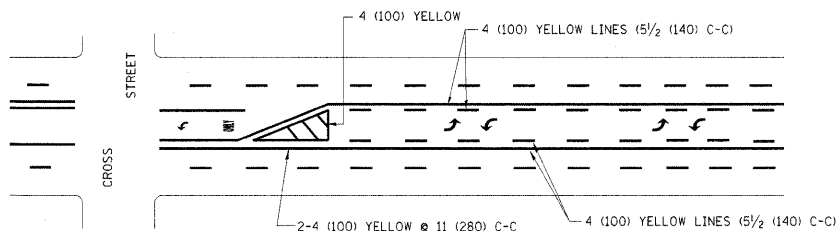

A MINIMUM OF TWO PAIRS OF TURN ARROWS SHALL BE USED, WHITE IN COLOR. ADDITIONAL PAIRS SHALL BE PLACED AT 200' (60 m) TO 300' (90 m) INTERVALS.

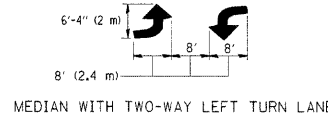

### MEDIAN WITH TWO-WAY LEFT TURN LANE

### TYPICAL PAINTED MEDIAN MARKING

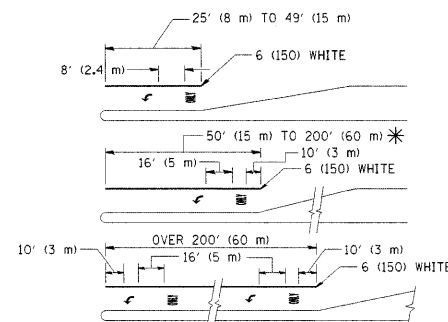

FULL SIZE LETTERS 8' (2.4 m) AND ARROWS SHALL BE USED.  
 \* AREA = 15.6 SQ. FT. (1.5 m<sup>2</sup>) ONLY AREA = 20.8 SQ. FT. (1.9 m<sup>2</sup>)

\* TURN LANES IN EXCESS OF 400' (120 m) IN LENGTH MAY HAVE AN ADDITIONAL SET OF ARROW - "ONLY" INSTALLED MIDWAY BETWEEN THE OTHER TWO SETS OF ARROW - "ONLY".

### TYPICAL LEFT (OR RIGHT) TURN LANE

### TYPICAL TURN LANE MARKING

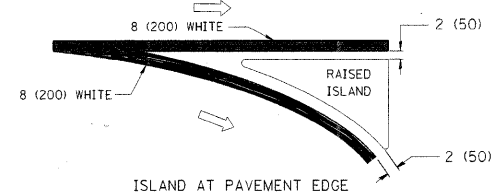
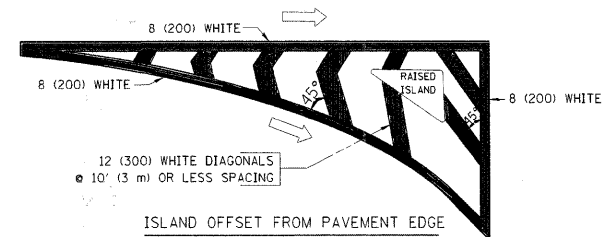

### TYPICAL ISLAND MARKING

TYPE OF MARKING	WIDTH OF LINE	PATTERN	COLOR	SPACING / REMARKS
CENTERLINE ON 2 LANE PAVEMENT	4 (100)	SKIP-DASH	YELLOW	10' (3 m) LINE WITH 30' (9 m) SPACE
CENTERLINE ON MULTI-LANE UNDIVIDED PAVEMENT	2 @ 4 (100)	SOLID	YELLOW	11 (280) C-C
NO PASSING ZONE LINES: FOR ONE DIRECTION FOR BOTH DIRECTIONS	4 (100) 2 @ 4 (100)	SOLID SOLID	YELLOW YELLOW	5 1/2 (140) C-C FROM SKIP-DASH CENTERLINE 11 (280) C-C OMIT SKIP-DASH CENTERLINE BETWEEN
LANE LINES	4 (100) 5 (125) ON FREEWAYS	SKIP-DASH SKIP-DASH	WHITE WHITE	10' (3 m) LINE WITH 30' (9 m) SPACE
DOTTED LINES (EXTENSIONS OF CENTER, LANE OR TURN LANE MARKINGS)	SAME AS LINE BEING EXTENDED	SKIP-DASH	SAME AS LINE BEING EXTENDED	2' (600) LINE WITH 6' (1.8 m) SPACE
EDGE LINES	4 (100)	SOLID	YELLOW-LEFT WHITE-RIGHT	OUTLINE MOUNTABLE MEDIANS IN YELLOW; EDGE LINES ARE NOT USED NEXT TO BARRIER CURB
TURN LANE MARKINGS	6 (150) LINE; FULL SIZE LETTERS & SYMBOLS (8' (2.4m))	SOLID	WHITE	SEE TYPICAL TURN LANE MARKING DETAIL
TWO WAY LEFT TURN MARKING	2 @ 4 (100) EACH DIRECTION 8' (2.4m) LEFT ARROW	SKIP-DASH AND SOLID IN PAIRS	YELLOW WHITE	10' (3 m) LINE WITH 30' (9 m) SPACE FOR SKIP-DASH; 5 1/2 (140) C-C BETWEEN SOLID LINE AND SKIP-DASH LINE SEE TYPICAL TWO-WAY LEFT TURN MARKING DETAIL
CROSSWALK LINES (PEDESTRIAN) A. DIAGONALS (BIKE & EQUESTRIAN) B. LONGITUDINAL BARS (SCHOOL)	2 @ 6 (150) 12 (300) @ 45° 12 (300) @ 90°	SOLID SOLID SOLID	WHITE WHITE WHITE	NOT LESS THAN 6' (1.8 m) APART 2' (600) APART 2' (600) APART SEE TYPICAL CROSSWALK MARKING DETAILS.
STOP LINES	24 (600)	SOLID	WHITE	PLACE 4' (1.2 m) IN ADVANCE OF AND PARALLEL TO CROSSWALK, IF PRESENT. OTHERWISE, PLACE AT DESIRED STOPPING POINT, PARALLEL TO CROSSROAD CENTERLINE, WHERE POSSIBLE
PAINTED MEDIANS	2 @ 4 (100) WITH 12 (300) DIAGONALS @ 45° NO DIAGONALS USED FOR 4' (1.2 m) WIDE MEDIANS	SOLID	YELLOW; TWO WAY TRAFFIC WHITE; ONE WAY TRAFFIC	11 (280) C-C FOR THE DOUBLE LINE SEE TYPICAL PAINTED MEDIAN MARKING.
GORE MARKING AND CHANNELIZING LINES	8 (200) WITH 12 (300) DIAGONALS @ 45°	SOLID	WHITE	DIAGONALS: 15' (4.5 m) C-C (LESS THAN 30MPH (50 km/h)) 20' (6 m) C-C 30MPH (50 km/h) TO 45MPH (70 km/h) 30' (9 m) C-C (OVER 45MPH (70 km/h))
RAILROAD CROSSING	24 (600) TRANSVERSE LINES; "RR" 15 6' (1.8 m) LETTERS; 16 (400) LINE FOR "X"	SOLID	WHITE	SEE STATE STANDARD 780001 AREA OF: "R"=3.6 SQ. FT. (0.33 m <sup>2</sup> ) EACH "X"=54.0 SQ. FT. (5.0 m <sup>2</sup> )
SHOULDER DIAGONALS	12 (300) @ 45°	SOLID	WHITE - RIGHT YELLOW - LEFT	50' (15 m) C-C (LESS THAN 30MPH (50 km/h)) 75' (25 m) C-C (30 MPH (50 km/h) TO 45MPH (70 km/h)) 150' (45 m) C-C (OVER 45MPH (70 km/h))

FOR FURTHER DETAILS ON PAVEMENT MARKING REFER TO STANDARD SPECIFICATIONS FOR ROAD AND BRIDGE CONSTRUCTION AND STATE STANDARD 780001.

All dimensions are in inches (millimeters) unless otherwise shown.

FILE NAME =	USER NAME = drivakosgn	DESIGNED - EVERS	REVISED - T. RAMMACHER 10-27-94
c:\pw\work\p1\dot\drivakosgn\d0109315\to	3.dgn	DRAWN -	REVISED - C. JUCIUS 09-09-09
	PLOT SCALE = 50.000 ' / IN.	CHECKED -	REVISED -
	PLOT DATE = 9/9/2009	DATE - 03-19-90	REVISED -

## STATE OF ILLINOIS DEPARTMENT OF TRANSPORTATION

### DISTRICT ONE TYPICAL PAVEMENT MARKINGS

SCALE: NONE SHEET NO. 1 OF 1 SHEETS STA. TO STA.

F.A. RTE.	SECTION	COUNTY	TOTAL SHEETS	SHEET NO.
2907	09-00065-00-RS	WILL	20	19
293	TC-13	CONTRACT NO.	63352	
FED. ROAD DIST. NO. 1   ILLINOIS FED. AID PROJECT ARA-9003 (408)				

**LOOPS NEXT TO SHOULDERS**

PROVIDE A PAVEMENT REPLACEMENT NOTE WHICH SHOULD EQUAL 3' (900 mm) X WIDTH OF PAVED SHOULDER.

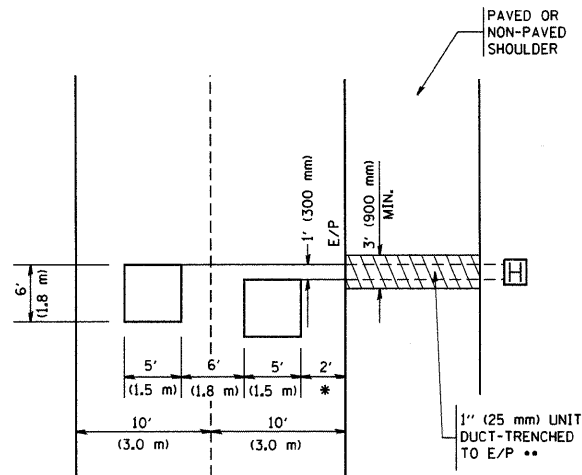

\* = (600 mm)

\*\* UNIT DUCT IS TO BE SHOWN ON PLAN SHEETS BUT SHALL NOT BE INCLUDED IN THE PAY ITEMS.

**LEFT TURN LANES WITH MEDIANS**  
VOLUME DENSITY ("FAR OUT" DETECTION)  
ON SAME APPROACH  
(PROTECTED / PERMITTED LEFT TURN PHASING)

HANDHOLE LOCATION MAY VARY DEPENDING ON GEOMETRICS AND DESIGN OF TRAFFIC SIGNALS. HEAVY-DUTY HANDHOLES TO BE USED WHEN THE MEDIAN IS MOUNTABLE. REFER TO STANDARD 814001 TO ENSURE THAT HANDHOLE FITS IN MEDIAN.

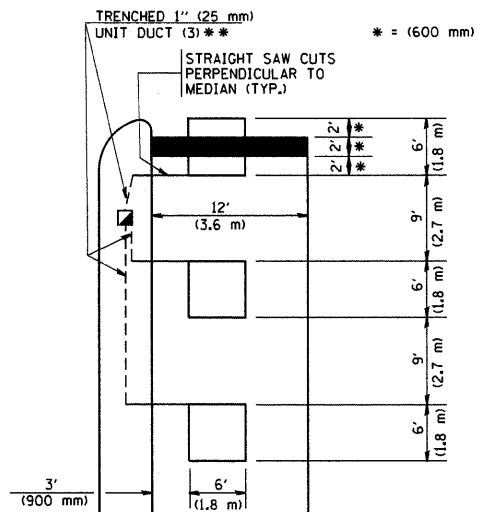

\*\* UNIT DUCT IS TO BE SHOWN ON PLAN SHEETS BUT SHALL NOT BE INCLUDED IN THE PAY ITEMS.

NOTE: DUAL LEFT TURNS NOT SHOWN REFER TO PLAN SHEET FOR DETECTOR LOOP REPLACEMENT

**LEFT TURN LANES WITHOUT MEDIANS**  
VOLUME DENSITY ("FAR OUT" DETECTION)  
ON SAME APPROACH  
(PROTECTED / PERMITTED LEFT TURN PHASING)

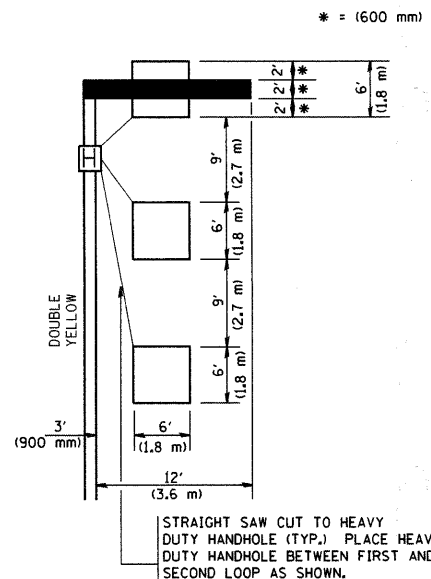

NOTE: DUAL LEFT TURNS NOT SHOWN REFER TO PLAN SHEET FOR DETECTOR LOOP REPLACEMENT

**ARTERIAL-VOLUME DENSITY ("FAR OUT" DETECTION)**  
CROSS STREET-VOLUME DENSITY ("FAR OUT" DETECTION)

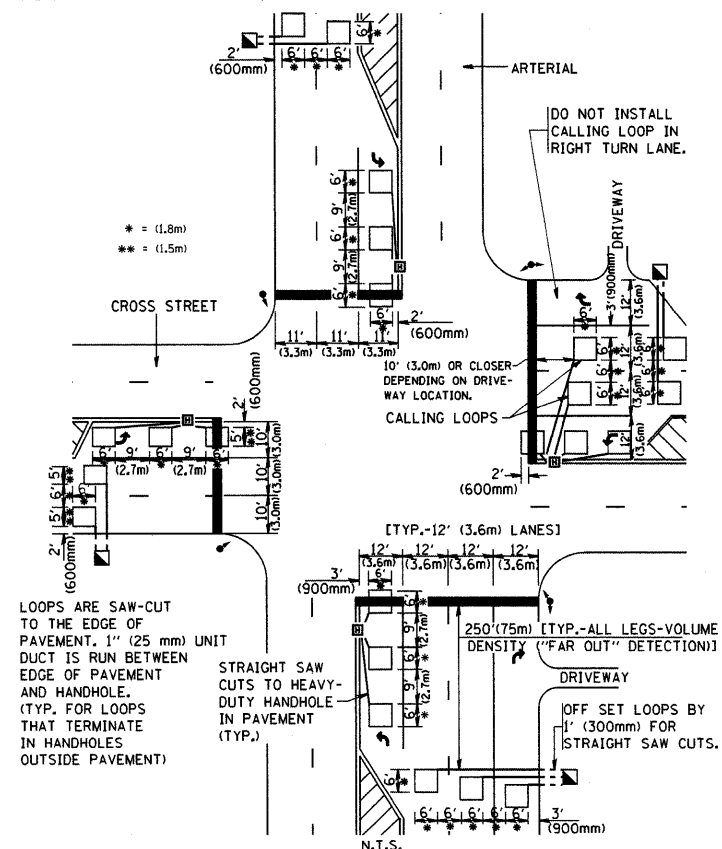

**DETAIL 1**  
N.T.S.

**ARTERIAL-VOLUME DENSITY ("FAR OUT" DETECTION)**  
CROSS STREET-NON VOLUME DENSITY ("UPTIGHT" PRESENCE DETECTION)

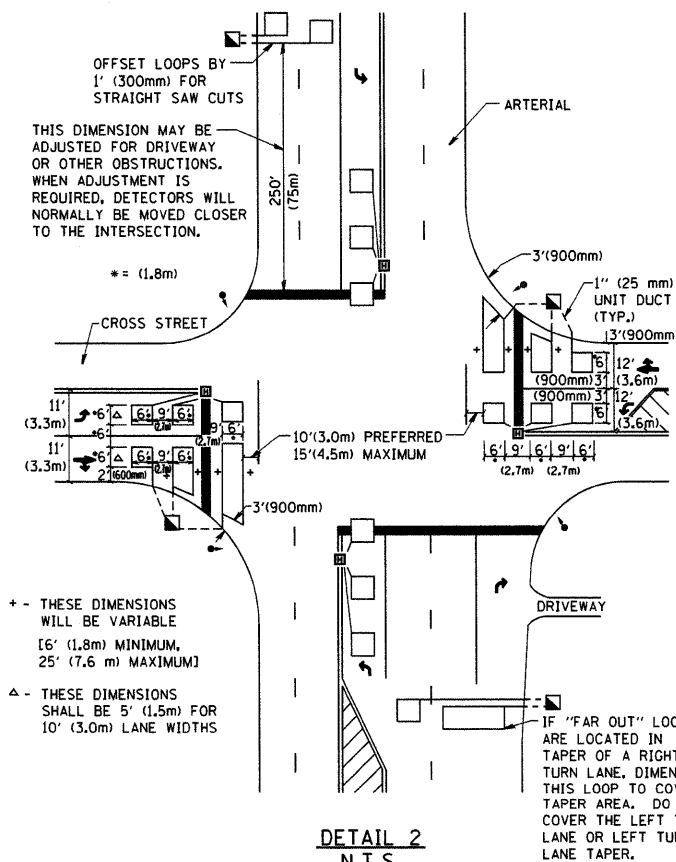

**DETAIL 2**  
N.T.S.

**NOTES:**

**VEHICLES LOOP DETECTORS**

- \* ALL LEAD IN CABLE SHALL BE TWO CONDUCTOR NO. 14 TWISTED, SHIELDED.
- \* EACH DETECTOR LOOP SHALL HAVE ITS OWN SAW CUT FROM THE LOOP TO THE EDGE OF PAVEMENT OR TO A HANDHOLE IN THE PAVEMENT.
- \* EACH DETECTOR LOOP SHALL HAVE ITS OWN ONE INCH (25 mm) UNIT DUCT BETWEEN THE EDGE OF PAVEMENT AND THE FIRST HANDHOLE OR JUNCTION BOX. EACH UNIT DUCT RUN SHALL BE SHOWN ON THE PLANS BY THE DESIGNER, BUT SHALL NOT BE PAID FOR SEPARATELY. THIS ITEM IS INCIDENTAL TO THE PAY ITEM FOR DETECTOR LOOPS.
- \* ONE DIMENSION OF ALL DETECTOR LOOPS SHALL BE SIX FEET (1.8 m)
- \* EACH LANE OF NON-LOCKING, PRESENCE DETECTION AND EACH LANE OF A DOUBLE LEFT TURN LANE REQUIRES A SEPARATE INDUCTIVE LOOP DETECTOR AND LEAD IN CABLE.
- \* WHEN NON-LOCKING, PRESENCE DETECTION IS USED, MORE THAN ONE LOOP PER LANE IS REQUIRED BEHIND THE STOP BAR (i.e. 1-1/2, 1-3/4, 2).
- \* WHEN SYSTEM LOOPS ARE REQUIRED ON AN APPROACH OF AN INTERSECTION, THE LOOPS USED FOR VOLUME DENSITY AND INTERSECTION TIMING SHALL ALSO BE USED AS SYSTEM DETECTORS. EACH ONE OF THESE TYPE OF LOOPS REQUIRES A SEPARATE TWO CONDUCTOR NO. 14 TWISTED SHIELDED CABLE AND A SEPARATE INDUCTIVE LOOP DETECTOR WHEN NEW CONTROLLERS ARE UTILIZED. THE DESIGNER SHALL LABEL THESE TYPES OF LOOPS AS "INTERSECTION AND SAMPLING (SYSTEM) DETECTORS" ON THE SIGNAL LAYOUT, THE INTERCONNECT PLAN AND THE SYSTEM CABLE PLAN. WHEN AN EXISTING CONTROLLER IS UTILIZED FOR THIS TYPE OF DETECTION, THE PAY ITEM "INDUCTIVE LOOP DETECTOR WITH SYSTEM OUTPUT" SHOULD BE USED.

**PLACEMENT OF DETECTORS**

THE FOLLOWING FIGURES REPRESENT THE MOST COMMON DETECTOR LOOP LOCATIONS AND SIZES. ADJUSTMENTS WILL BE NECESSARY FOR SPECIFIC GEOMETRIC CONSIDERATIONS.

LOCATIONS AND DEMENSIONS OF DETECTOR LOOPS ARE REQUIRED ON ALL SIGNAL LAYOUT PLAN SHEETS.

"FAR OUT" DETECTION REFERS TO LOCKING, PRESENCE TYPE DETECTION LOCATED IN THRU LANES, RIGHT TURN LANES, AND RIGHT TURN LANE TAPER AREAS (IF APPLICABLE), USUALLY 250' (75 m) IN ADVANCE OF STOP BARS. "UPTIGHT" DETECTION REFERS TO NON-LOCKING PRESENCE TYPE DETECTION LOCATED IN ALL LANES AND 10'-15' (3.0 m-4.5 m) BEHIND THE CROSSING STREET'S EDGE OF PAVEMENT EXTENDED.

**NOTE:**

ALL DETAILS AND NOTES SHOWN ARE FROM THE I.D.O.T. DISTRICT 1 TRAFFIC SIGNAL DESIGN GUIDELINES DATED JANUARY 1995

THIS DRAWING HAS BEEN PREPARED TO ASSIST THE RESIDENT ENGINEER FOR ALL ROADWAY RESURFACING OR S.M.A.R.T. PROJECTS WHERE THE DIMENSIONS ARE NOT SHOWN ON THE PLANS AND THE FINAL LOCATIONS FOR CROSSWALKS OR STOP BARS ARE NOT DETERMINED.

FILE NAME = W:\diststd\22x34\ts07.dgn

USER NAME = geglianobt	DESIGNED -	REVISED -
PLOT SCALE = 50.0000' / IN.	DRAWN -	REVISED -
PLOT DATE = 1/4/2008	CHECKED - R.K.F.	REVISED -
	DATE -	REVISED -

**STATE OF ILLINOIS**  
**DEPARTMENT OF TRANSPORTATION**

**DISTRICT 1 - DETECTOR LOOP INSTALLATION**  
**DETAILS FOR ROADWAY RESURFACING**

SCALE: NONE SHEET NO. 1 OF 1 SHEETS STA. TO STA.

F.A. RTE. 290/	SECTION 09-00065-00-RS	COUNTY WILL	TOTAL SHEETS 20	SHEET NO. 20
293	TS-07	CONTRACT NO.	63352	
FED. ROAD DIST. NO. 1 ILLINOIS FED. AID PROJECT ARA-9003(408)				