

FOXFORD HILLS GOLF CLUB

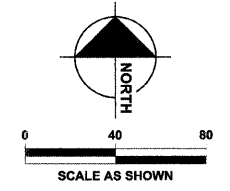

SIGNING NOTES:

- ALL PROPOSED SIGNING AND PAVEMENT MARKING SHALL BE IN ACCORDANCE WITH THE MOST CURRENT EDITION OF EACH OF THE FOLLOWING DOCUMENTS AND ANY REVISION THERETO:
 - MANUAL ON UNIFORM TRAFFIC CONTROL DEVICES
 - ILLINOIS DEPARTMENT OF TRANSPORTATION STANDARD SPECIFICATIONS FOR ROAD AND BRIDGE CONSTRUCTION
- PROPOSED SIGN LOCATIONS ARE APPROXIMATE AND SHALL BE MODIFIED IN THE FIELD TO AVOID CONFLICT WITH UNDERGROUND UTILITIES OR OTHER OBSTRUCTIONS AND TO COMPLY WITH THE STANDARDS REFERENCED IN NOTE 1 ABOVE. SIGNS SHALL BE INSTALLED ONLY AFTER APPROVAL OF FINAL LOCATIONS BY CARY PARK DISTRICT.
- CROSSWALK LONGITUDINAL LINES TO BE 6" WIDE. CROSSWALK DIAGONAL LINES TO BE 12" WIDE WITH 2' SPACING BETWEEN LINES. STOP BARS SHALL BE PLACED A MINIMUM OF 4' BEHIND CROSSWALKS.
- SIGNS LISTED AND LABELED IN THE SIGN LEGEND ARE UNIQUE TO THE ALIGNMENTS SHOWN ON THIS SHEET.
- PLACE SIGN A MINIMUM OF 3 FEET AND MAXIMUM OF 6 FEET FROM EDGE OF TRAIL.

SIGNING LEGEND



PAVEMENT MARKING LEGEND

- THERMOPLASTIC PAVEMENT MARKING, 4" (100 mm) WHITE
- THERMOPLASTIC PAVEMENT MARKING, 24" (600 mm) WHITE
- THERMOPLASTIC PAVEMENT MARKING, 6" (150 mm) WHITE
- THERMOPLASTIC PAVEMENT MARKING, 12" (300 mm) WHITE

MATCHLINE - SEE SHEET 51

MATCHLINE - SEE THIS SHEET

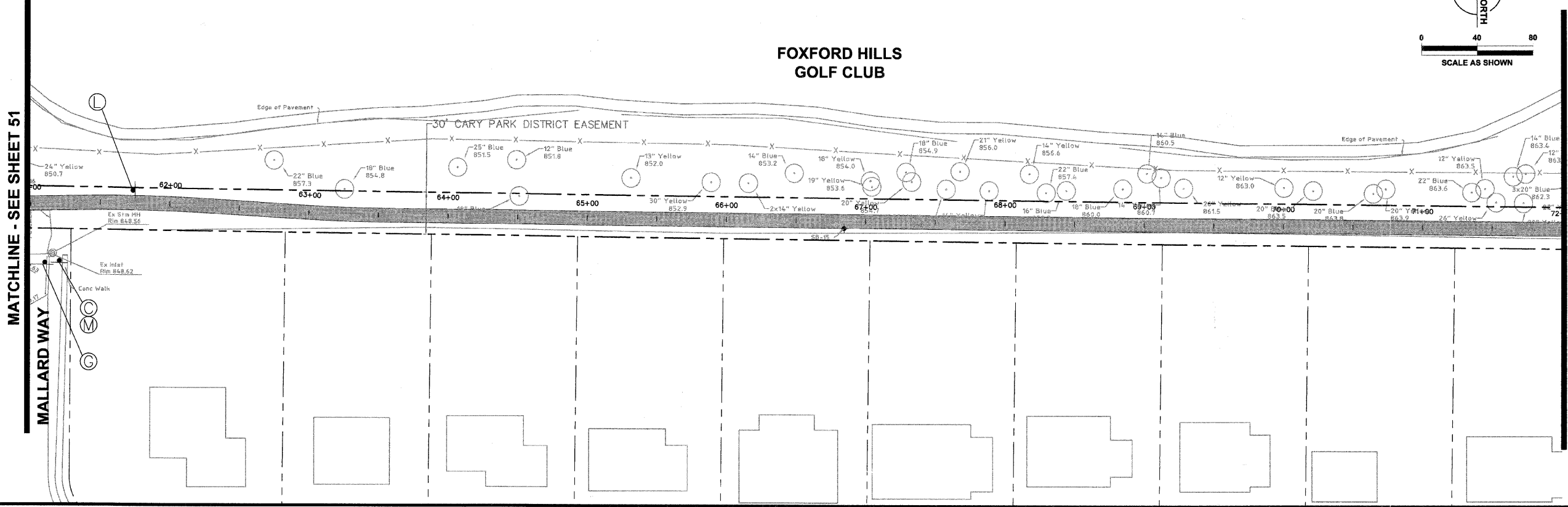

SIGN LEGEND

SIGN LETTER	(A)	(C)	(F)	(G)	(L)
SIGN					
NO.	R1-1	D11-1	R1-2	X4-11	D1-1c
SIGN DIM.	18" x 18"	24" x 18"	18" x 18" x 18"	18" x 18"	24" x 6" D4 LETTER SIZE

SIGN LETTER	(M)	(N)	(O)	(P)
SIGN				
NO.	M7-5	W11-1	W16-7	D1-1c
SIGN DIM.	12" x 9"	18" x 18"	24" x 12"	24" x 6" D4 LETTER SIZE

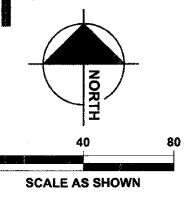

MATCHLINE - SEE SHEET 53

MATCHLINE - SEE THIS SHEET

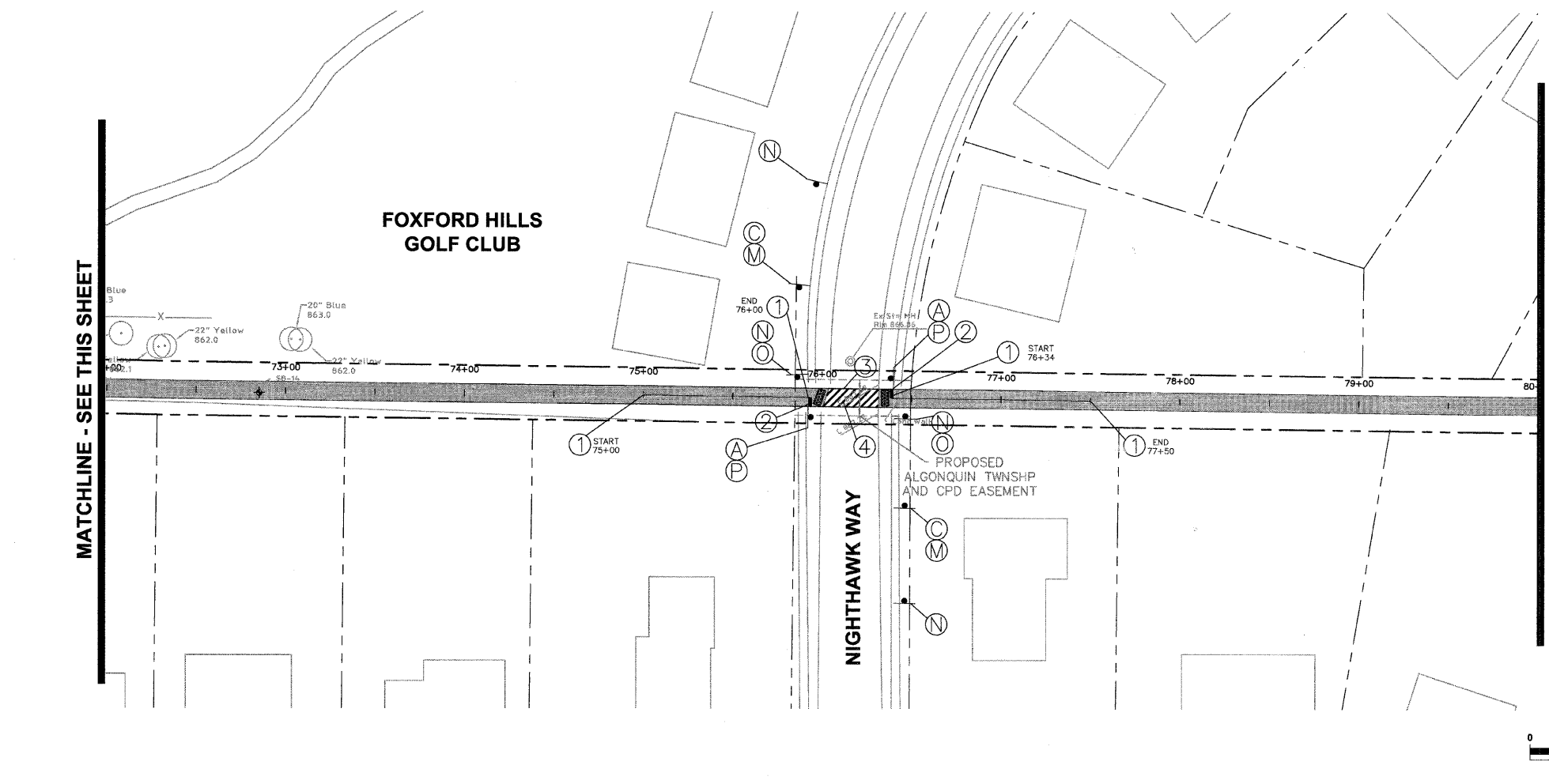

This document, together with the documents and drawings prepared hereon, is intended only for the project and site for which it was prepared. Review and approval of this document by the State of Illinois Department of Transportation and Cary Park District is required for any other use. No part of this document may be reproduced or transmitted in any form or by any means, electronic or mechanical, including photocopying, recording, or by any information storage and retrieval system, without the prior written permission of the State of Illinois Department of Transportation and Cary Park District. Date: 10/02/2009. Drawing No: N100-1001-00-BR.

DESIGNED - JWH	REVISED
DRAWN - LES	REVISED
CHECKED - JMM	REVISED
DATE - 10/02/2009	REVISED

**STATE OF ILLINOIS
DEPARTMENT OF TRANSPORTATION**

**CARY PARK DISTRICT
CARY COMMUNITY TRAIL**

**SIGNAGE AND STRIPING PLAN
STA. 61+00 TO STA. 72+00
STA. 72+00 TO STA. 80+00**

SECTION	COUNTY	TOTAL SHEETS	SHEET NO.
06-P4001-00-BR	MCHENRY	64	52
FED. ROAD DIST. NO. 1	ILLINOIS	CONTRACT NO. 63333	

