

SIGNING NOTES:

1. ALL PROPOSED SIGNING AND PAVEMENT MARKING SHALL BE IN ACCORDANCE WITH THE MOST CURRENT EDITION OF EACH OF THE FOLLOWING DOCUMENTS AND ANY REVISION THERETO:
 - A. MANUAL ON UNIFORM TRAFFIC CONTROL DEVICES
 - B. ILLINOIS DEPARTMENT OF TRANSPORTATION STANDARD SPECIFICATIONS FOR ROAD AND BRIDGE CONSTRUCTION
2. PROPOSED SIGN LOCATIONS ARE APPROXIMATE AND SHALL BE MODIFIED IN THE FIELD TO AVOID CONFLICT WITH UNDERGROUND UTILITIES OR OTHER OBSTRUCTIONS AND TO COMPLY WITH THE STANDARDS REFERENCED IN NOTE 1 ABOVE. SIGNS SHALL BE INSTALLED ONLY AFTER APPROVAL OF FINAL LOCATIONS BY CARY PARK DISTRICT.
3. CROSSWALK LONGITUDINAL LINES TO BE 6" WIDE. CROSSWALK DIAGONAL LINES TO BE 12" WIDE WITH 2' SPACING BETWEEN LINES. STOP BARS SHALL BE PLACED A MINIMUM OF 4' BEHIND CROSSWALKS.
4. SIGNS LISTED AND LABELED IN THE SIGN LEGEND ARE UNIQUE TO THE ALIGNMENTS SHOWN ON THIS SHEET.
5. PLACE SIGN A MINIMUM OF 3 FEET AND MAXIMUM OF 6 FEET FROM EDGE OF TRAIL.

SIGN LEGEND

SIGN LETTER	(A)	(B)	(C)	(D)	(E)	(F)	(H)	(I)	(J)
SIGN									
NO.	R1-1	D1 - 1b	D11-1	M4-11	W1-2	R1-2	D1 - 1b	D1 - 1b	D1-1c
SIGN DIM.	18" x 18"	24" x 12" D4 LETTER SIZE	24" x 18"	12" x 4"	18" x 18"	18" x 18" x 18"	24" x 6"	24" x 6"	24" x 18"

SIGNING LEGEND

- PLACE NEW SIGN
- DETECTABLE WARNINGS

PAVEMENT MARKING LEGEND

- ① THERMOPLASTIC PAVEMENT MARKING, 4" (100 mm) WHITE
- ② THERMOPLASTIC PAVEMENT MARKING, 24" (600 mm) WHITE
- ③ THERMOPLASTIC PAVEMENT MARKING, 6" (150 mm) WHITE
- ④ THERMOPLASTIC PAVEMENT MARKING, 12" (300 mm) WHITE

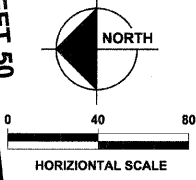
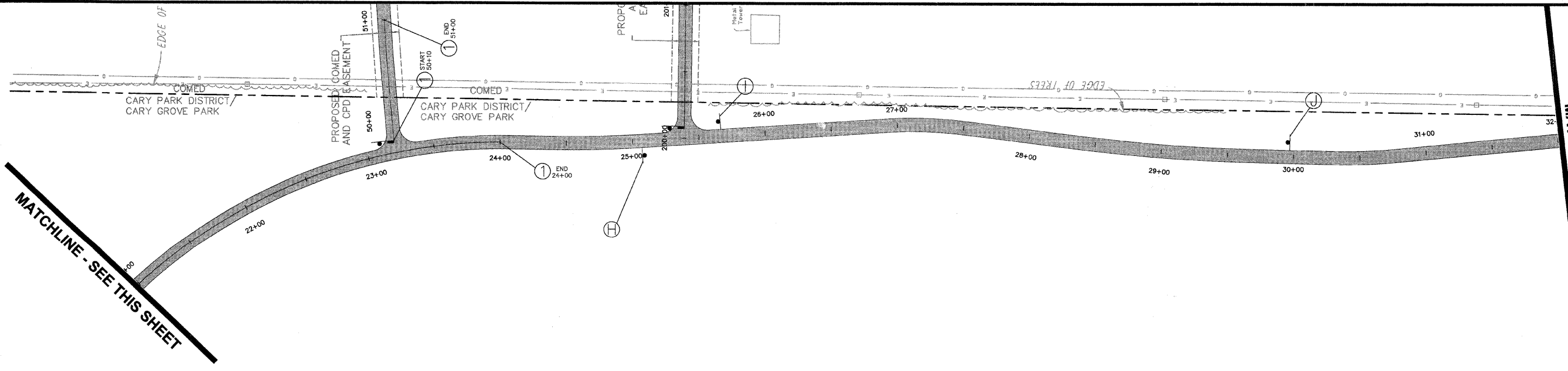

This document is the property of the State of Illinois. It is loaned to you for the specific project and shall not be reproduced, stored in a retrieval system, or transmitted in any form or by any means, electronic, mechanical, photocopying, recording, or by any information storage and retrieval system, without the prior written permission of the State of Illinois. The State of Illinois shall not be liable for any damages, including reasonable attorneys' fees, resulting from the use of this document.

DESIGNED - JWH	REVISED
DRAWN - LES	REVISED
CHECKED - JMM	REVISED
DATE - 10/02/2009	REVISED

STATE OF ILLINOIS
DEPARTMENT OF TRANSPORTATION

CARY PARK DISTRICT
CARY COMMUNITY TRAIL

SIGNAGE AND STRIPING PLAN
STA. 10+00 TO STA. 21+00
STA. 21+00 TO 32+00

SECTION	COUNTY	TOTAL SHEETS	SHEET NO.
06-P4001-00-BR	MCHENRY	64	49
FED. ROAD DIST. NO. 1	ILLINOIS	CONTRACT NO. 63333	