

PLAN LEGEND:

- PROPOSED SPOT ELEVATIONS
- PROPOSED BIKE TRAIL
- PROPOSED AGGREGATE SHOULDER
- PROPERTY LINE

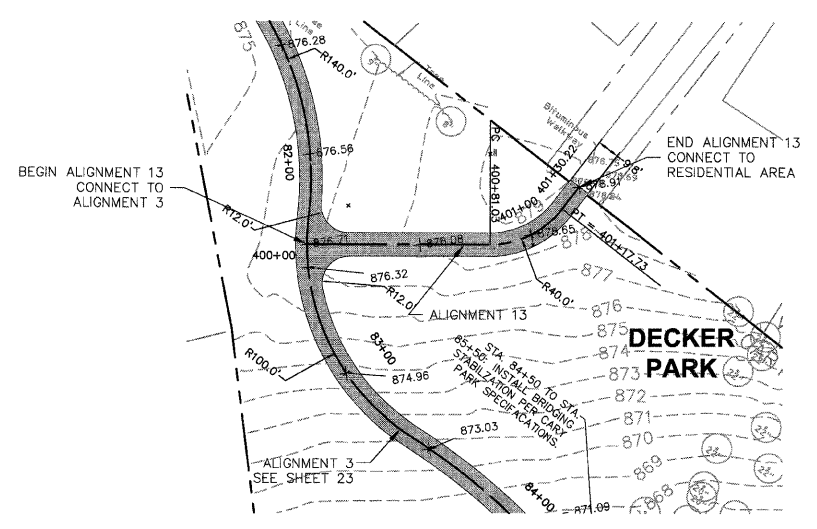

CARY COMMUNITY TRAIL ALIGNMENT 13 - STA. 400+00 TO STA. 401+30.22

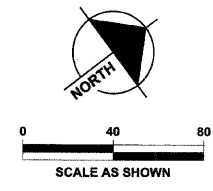
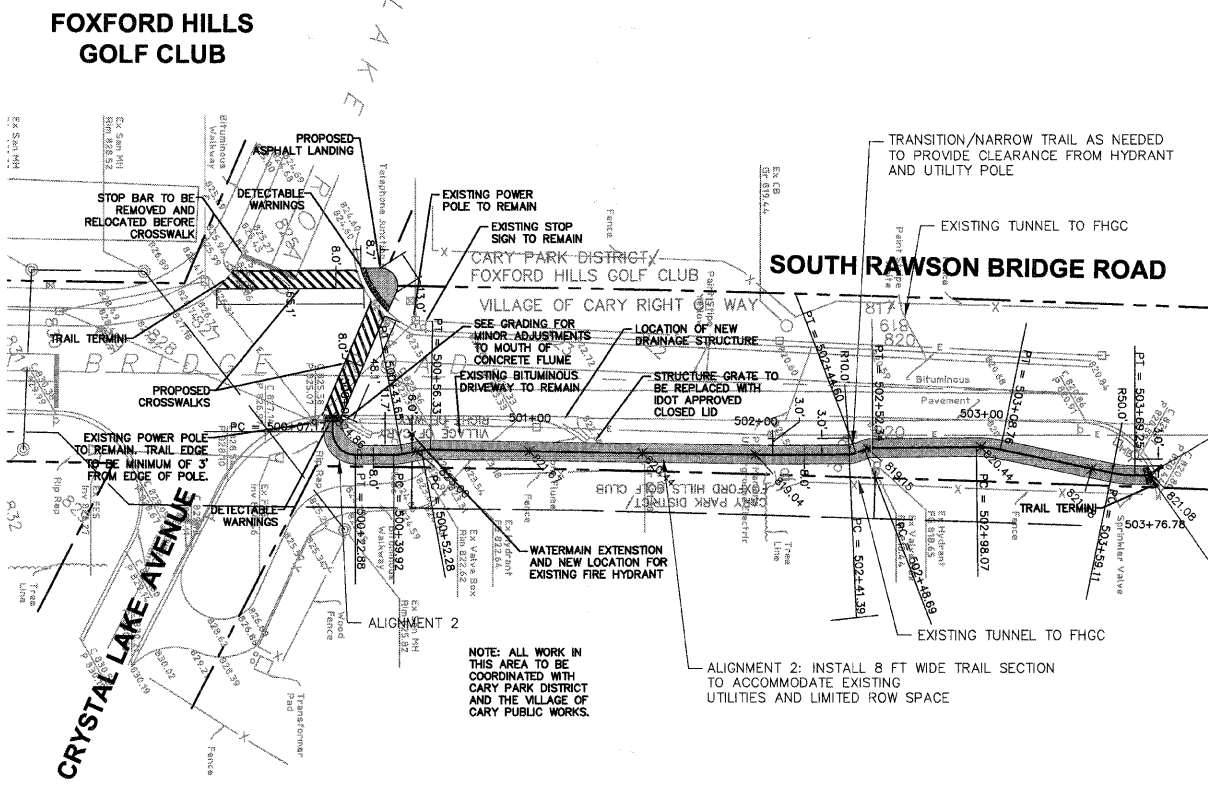

CARY COMMUNITY TRAIL ALIGNMENT 2 - STA. 500+00 TO STA. 504+20.72

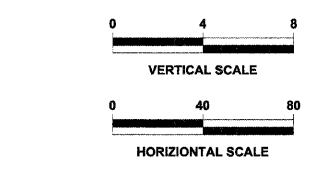
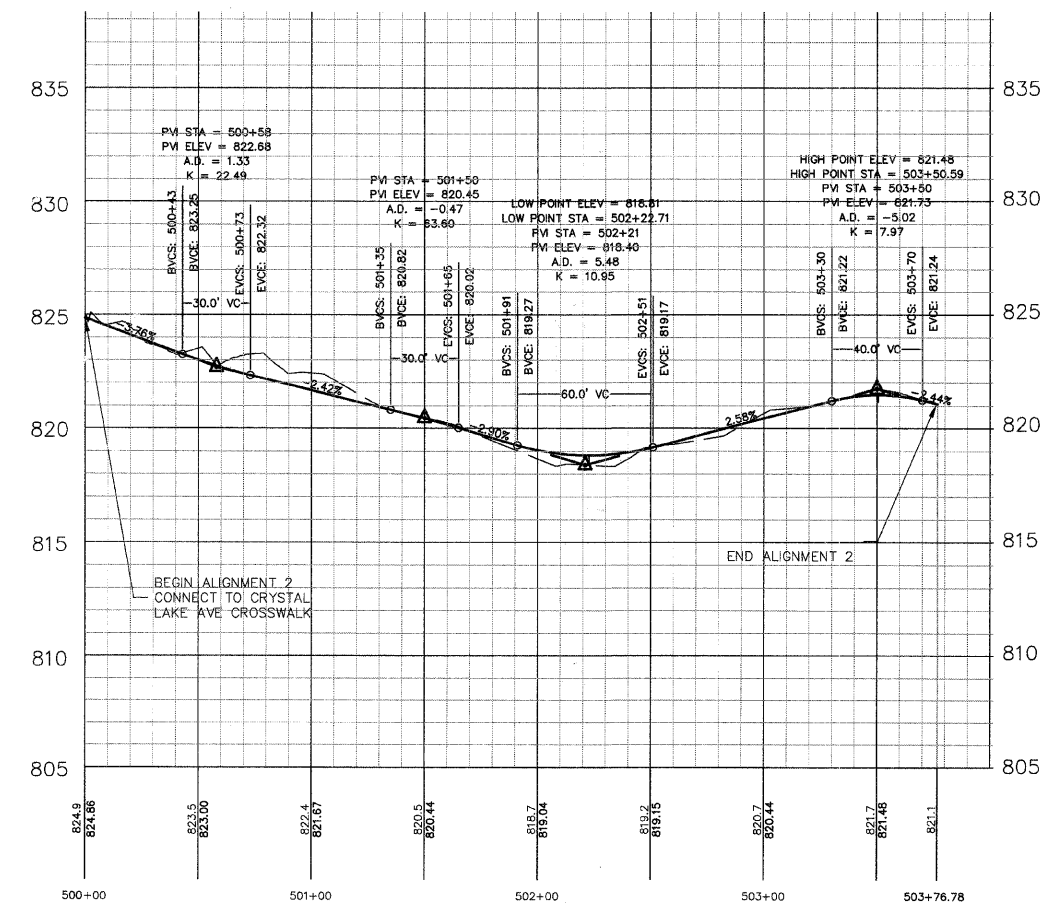
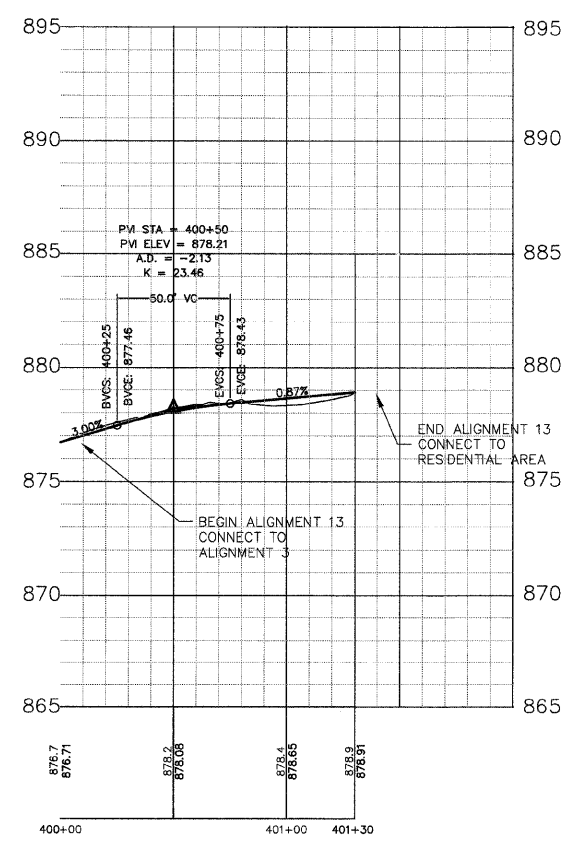
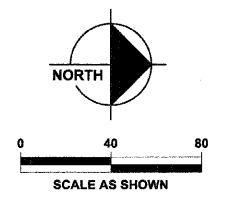

DATUM CONVERSION FOR CARY COMMUNITY BIKE TRAIL TOPOGRAPHIC SURVEY

THE DATUM USED FOR THE CARY COMMUNITY BIKE TRAIL TOPOGRAPHIC SURVEY PERFORMED BY HAEGER ENGINEERING, LLC DATED FEB. 2, 2008 ("THE TOPO") WAS BASED ON MH 46 ON PAGE 25 OF 38 ON THE MANHARD CONSULTING LTD. RECORD DRAWINGS FOR FOXFORD HILLS SUBDIVISION - PHASE 1 DATED MARCH 6, 2007. THIS DATUM WAS REQUESTED TO BE USED IN ORDER FOR THE TOPO TO STAY CONSISTENT WITH PROJECTS DONE IN THE AREA (FOXFORD HILLS). THE PUBLISHED RECORD ELEVATION FOR MH 46 WAS 861.45 FEET. THIS ELEVATION WAS USED TO ESTABLISH THE ELEVATIONS REPORTED BY THE TOPO. IT IS UNKNOWN TO HAEGER ENGINEERING, LLC AS TO THE SOURCE BENCHMARK OR PUBLISHED DATUM THAT WAS ORIGINALLY USED FOR THE RECORD DRAWINGS OF FOXFORD HILLS SUBDIVISION PROJECT. DUE TO THE FACT HAEGER ENGINEERING, LLC WAS NEVER SUPPLIED THIS INFORMATION, HOWEVER, HAEGER ENGINEERING, LLC DID CHECK INTO MH 46 ELEVATION WITH ITS RTK GPS UNIT THAT IS BASED ON KANA COMPANY'S RTK CORRS REFERENCE NETWORK USING NAVD 88 (GEOID 03) AS ITS REFERENCE DATUM. HAEGER ENGINEERING, LLC FOUND MH 46 ELEVATION (861.45) TO BE 0.11' HIGHER THAN THAT MEASURED WITH THE GPS EQUIPMENT (861.34) USING NAVD 88 (GEOID 03) AS THE REFERENCE DATUM. BASED ON THE GPS MEASURED HEIGHT, THE CONVERSION TO NAVD 88 ELEVATION FOR MH 46 USING NAD83 VERTCON WOULD BE 861.52 (0.07' HIGHER THAN PUBLISHED MH 46 ELEVATION). THEREFORE DUE TO THE VERTICAL ACCURACY OF THE GPS RTK MEASUREMENT (+/- 0.05' MINUS 0.05') IT IS UNKNOWN TO HAEGER ENGINEERING, LLC AS TO THE TRUE BENCHMARK OR CONTROL INFORMATION THE FOXFORD HILLS SUBDIVISION WAS BUILT ON. BASED ON HAEGER ENGINEERING, LLC GPS RTK MEASUREMENT OF MH 46 THE DATUM CONVERSION FOR "THE TOPO" IS AS FOLLOWS:

BENCHMARKS

SOURCE BENCHMARK
 DESCRIPTION: MANHOLE #46 FROM THE ASBUILT RECORD DRAWINGS BY MANHARD CONSULTING LTD DATED 3-6-07 FOR THE FOXFORD HILLS SUBDIVISION-PHASE 1 IN THE VILLAGE OF CARY, ILLINOIS.
 LOCATION: 120' NORTHEAST OF THE OAKMAN DRIVE AND PARKSTONE DRIVE INTERSECTION ON OAKMAN DRIVE.
 ELEVATION: 861.45

SITE BENCHMARKS
 BE CP #100
 DESCRIPTION: IRON PIPE
 LOCATION: 1000' EAST OF THE INTERSECTION OF 1ST AND THREE OAKS ROAD, 564' NORTH OF THE NORTH SIDE OF THREE OAKS ROAD, 31' NORTHEAST OF STORM MANHOLE, AND 26' NORTHWEST OF POWER POLE.
 ELEVATION: 854.94

BE CP #1
 DESCRIPTION: "PK" NAIL IN EDGE OF PAVEMENT
 LOCATION: 322' WEST OF THE INTERSECTION OF RAWSON BRIDGE ROAD AND MINK TRAIL, 45' SOUTHWEST OF TREE, 27' SOUTHWEST OF IRON ROD, AND 10' SOUTH OF CONCRETE WALK.
 ELEVATION: 860.97

BE CP #8
 DESCRIPTION: RAIL ROAD SPIKE
 LOCATION: NORTHWEST CORNER OF INTERSECTION OF CRYSTAL LAKE ROAD AND RAWSON BRIDGE ROAD, 22' SOUTHWEST OF FENCE CORNER, 15' SOUTHWEST OF POWER POLE, AND 11' NORTHWEST OF PAVEMENT.
 ELEVATION: 823.23

This document, together with the documents and designs prepared herein, is submitted only for the specific purpose and use intended. It is not to be used for any other purpose without the written consent of the engineer. The engineer shall not be responsible for any errors or omissions in this document or for any consequences arising from its use. The engineer's liability is limited to the professional services rendered. The engineer's liability shall not extend to any damages, including consequential damages, arising from the use of this document. The engineer's liability shall not extend to any damages, including consequential damages, arising from the use of this document. The engineer's liability shall not extend to any damages, including consequential damages, arising from the use of this document.

DESIGNED	JWH	REVISED
DRAWN	LES	REVISED
CHECKED	JMM	REVISED
DATE	10/02/2009	REVISED

**STATE OF ILLINOIS
 DEPARTMENT OF TRANSPORTATION**

**CARY PARK DISTRICT
 CARY COMMUNITY TRAIL**

**TRAIL ALIGNMENT
 PLAN & PROFILE
 STA. 400+00 TO STA. 401+30.22
 STA. 500+00 TO STA. 504+20.72**

SECTION	COUNTY	TOTAL SHEETS	SHEET NO.
06-P4001-00-BR	MCHENRY	64	25
FED. ROAD DIST. NO. 1	ILLINOIS	CONTRACT NO. 63333	

