

EXISTING SYMBOL LEGEND

- FIRE HYDRANT
- VALVE
- VALVE BASIN
- SIGN
- INLET
- CATCH BASIN
- MANHOLE
- ALUMINUM LIGHT POLE
- POWER POLE
- HANDHOLE / SPLICE BOX
- TREE

RESTORATION OF WORK AREA. RESTORATION OF THE TRAFFIC SIGNAL WORK AREA SHALL BE INCLUDED IN THE RELATED PAY ITEMS SUCH AS FOUNDATION, CONDUIT, HANDHOLE, TRENCH AND BACKFILL, ETC. ALL ROADWAY SURFACES SUCH AS SHOULDERS, MEDIANS, SIDEWALKS, PAVEMENT, ETC., SHALL BE REPLACED IN KIND. ALL DAMAGE TO MOWED LAWNS SHALL BE REPLACED WITH AN APPROVED SOD, AND ALL DAMAGE TO UNMOWED FIELDS SHALL BE SEED. RESTORATION OF THE WORK AREA SHALL BE INCIDENTAL TO THE CONTRACT WITHOUT ANY EXTRA COMPENSATION ALLOWED TO THE CONTRACTOR.

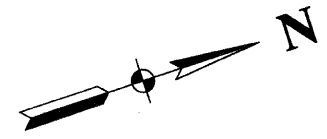

CHICAGO HEIGHTS-GLENWOOD ROAD

ROAD

HOLBROOK ROAD

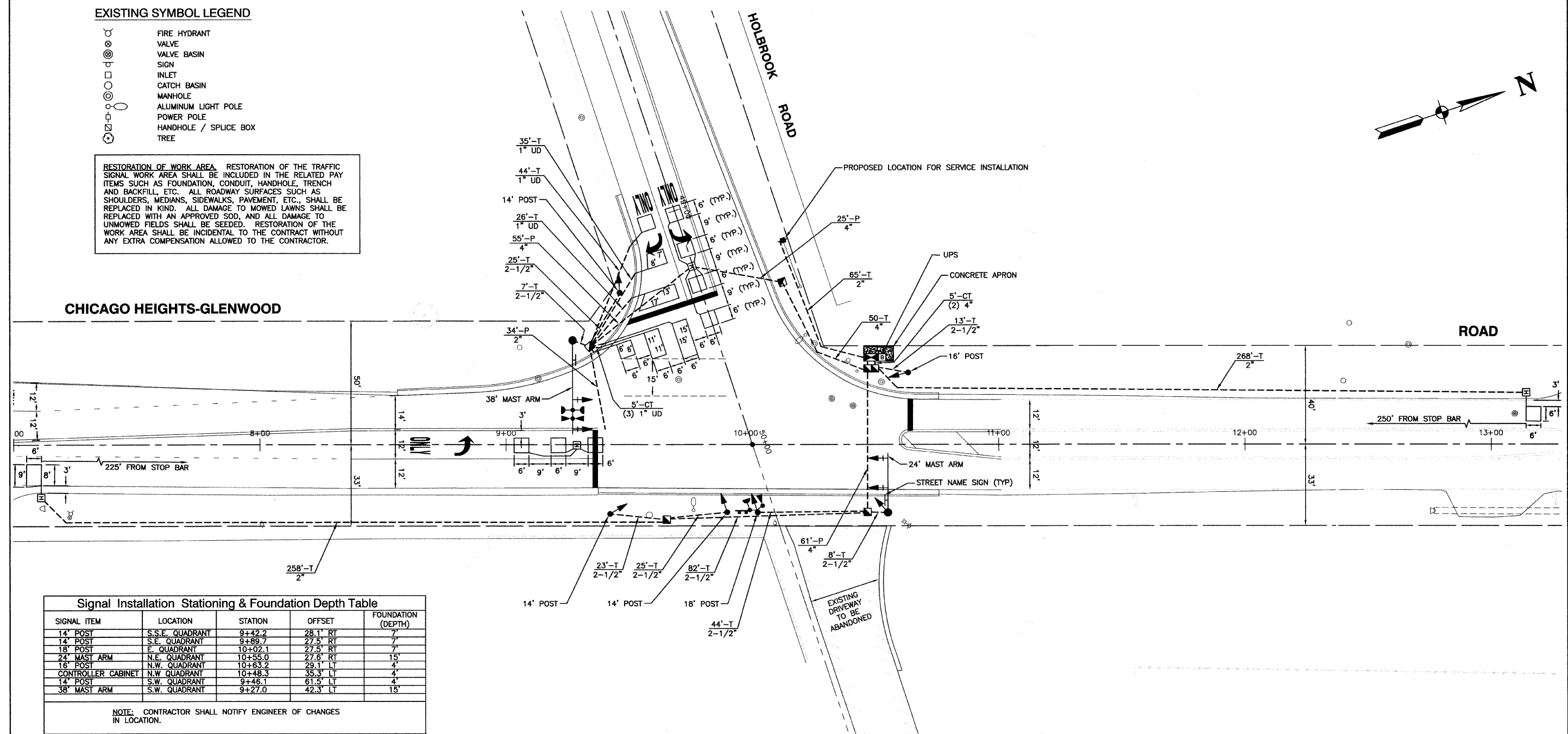

Signal Installation Stationing & Foundation Depth Table

SIGNAL ITEM	LOCATION	STATION	OFFSET	FOUNDATION (DEPTH)
14' POST	S.S.E. QUADRANT	9+42.2	28.1' RT	7'
14' POST	S.E. QUADRANT	9+89.7	27.5' RT	7'
18' POST	E. QUADRANT	10+02.1	27.5' RT	7'
24' MAST ARM	N.E. QUADRANT	10+55.0	27.8' RT	15'
16' POST	N.W. QUADRANT	10+63.2	29.1' LT	4'
CONTROLLER CABINET	N.W. QUADRANT	10+48.3	35.3' LT	4'
14' POST	S.W. QUADRANT	9+46.1	61.5' LT	4'
38' MAST ARM	S.W. QUADRANT	9+27.0	42.3' LT	15'

NOTE: CONTRACTOR SHALL NOTIFY ENGINEER OF CHANGES IN LOCATION.

TRAFFIC SIGNAL LEGEND

- |   |                                 |  |                                 |  |                                 |
|---|---------------------------------|--|---------------------------------|--|---------------------------------|
| <p>CONTROLLER</p> <p>SERVICE INSTALLATION</p> <p>SIGNAL HEAD</p> <p>SIGNAL HEAD WITH BACKPLATE</p> <p>SIGNAL HEAD, PEDESTRIAN</p> <p>SIGNAL POST</p> <p>MAST ARM ASSEMBLY AND POLE, STEEL</p> <p>MAST ARM ASSEMBLY AND POLE, ALUMINUM</p> <p>COMBINATION MAST ARM ASSEMBLY AND POLE, STEEL W/ LUMINAIRE</p> <p>UNIT DUCT</p> <p>COMMON TRENCH</p> | <p>PROPOSED</p> <p>EXISTING</p> | <p>HANDHOLE</p> <p>HEAVY DUTY HANDHOLE</p> <p>DOUBLE HANDHOLE</p> <p>G.S. CONDUIT IN GROUND</p> <p>PEDESTRIAN PUSHBUTTON DETECTOR</p> <p>DETECTOR LOOP</p> <p>CAST IRON JUNCTION BOX</p> <p>EMERGENCY VEHICLE SYSTEM DETECTOR</p> <p>CONFIRMATION BEACON</p> <p>SIGNAL HEAD OPTICALLY PROGRAMMED</p> | <p>PROPOSED</p> <p>EXISTING</p> | <p>CONDUIT SPLICE</p> <p>WOOD POLE</p> <p>RACEWAY FOR MAGNETIC DETECTOR, TYPE I OR TYPE II</p> <p>VEHICLE DETECTOR, NON COMPENSATED MAGNETIC TYPE</p> <p>RAILROAD CONTROL CABINET</p> <p>TELEPHONE CONNECTION</p> <p>ILLUMINATED SIGN, FIBER OPTIC "NO LEFT TURN"</p> <p>ILLUMINATED SIGN, FIBER OPTIC "NO RIGHT TURN"</p> <p>UNINTERRUPTIBLE POWER SUPPLY</p> | <p>PROPOSED</p> <p>EXISTING</p> |
|---|---------------------------------|--|---------------------------------|--|---------------------------------|