

PAVEMENT MARKING LEGEND

- ① DOUBLE MEDIAN OUTLINE - 4" YELLOW (11" O-C)
- ② LANE LINE - 4" WHITE (10' ON 30' OFF)
- ③ LANE LINE - 6" WHITE
- ④ LANE LINE - 6" WHITE (2' ON 6' OFF)
- ⑤ EDGE LINE - 4" WHITE
- ⑥ STOP BAR - 24" WHITE
- ⑦ LETTERS & SYMBOLS - WHITE
- ⑧ DIAGONAL - 12" YELLOW (15' CTRS)

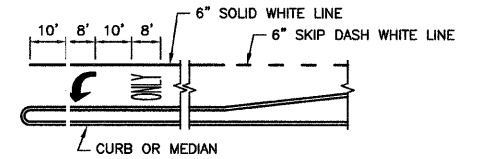

TURNLANE DETAILS



MATCH LINE STA. 8+00

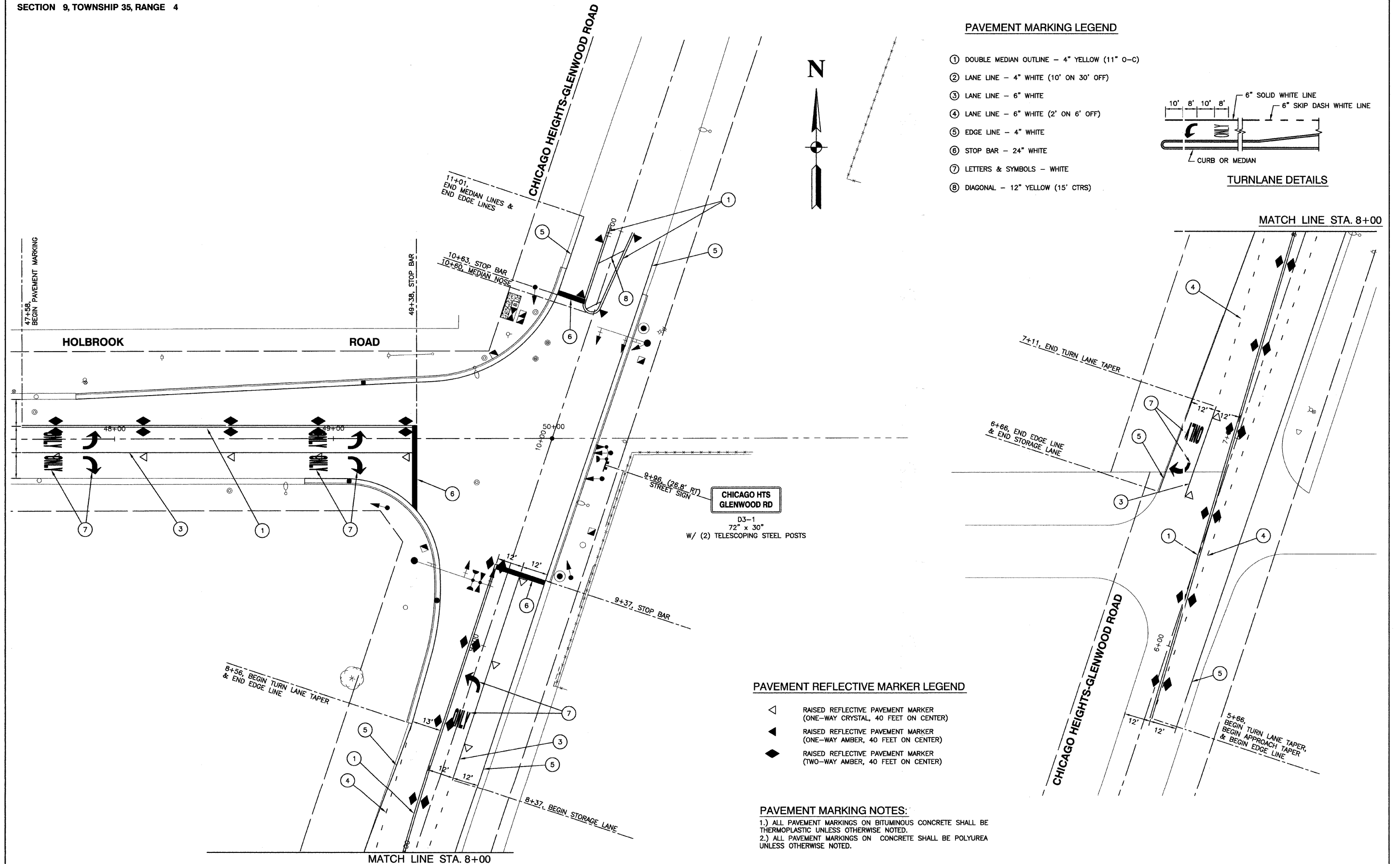

PAVEMENT REFLECTIVE MARKER LEGEND

- ◁ RAISED REFLECTIVE PAVEMENT MARKER (ONE-WAY CRYSTAL, 40 FEET ON CENTER)
- ▲ RAISED REFLECTIVE PAVEMENT MARKER (ONE-WAY AMBER, 40 FEET ON CENTER)
- ◆ RAISED REFLECTIVE PAVEMENT MARKER (TWO-WAY AMBER, 40 FEET ON CENTER)

PAVEMENT MARKING NOTES:

- 1.) ALL PAVEMENT MARKINGS ON BITUMINOUS CONCRETE SHALL BE THERMOPLASTIC UNLESS OTHERWISE NOTED.
- 2.) ALL PAVEMENT MARKINGS ON CONCRETE SHALL BE POLYUREA UNLESS OTHERWISE NOTED.

FILE NAME = 05587-PMKG-01 - PM1	USER NAME =	DESIGNED - BDB/JRA	REVISED -
		CHECKED - PKB	REVISED -
	PLOT SCALE =	DRAWN - JJB	REVISED -
	PLOT DATE = 10-29-09	CHECKED - JRA	REVISED -

STATE OF ILLINOIS
DEPARTMENT OF TRANSPORTATION

CHICAGO HEIGHTS-GLENWOOD ROAD AND HOLBROOK ROAD
INTERSECTION IMPROVEMENTS
PAVEMENT MARKING & SIGNING PLAN

SCALE: 1"=20' SHEET NO. 10 OF 31 SHEETS STA. TO STA.

F.A. J. RTE: 36C3	SECTION 09-00050-00-TL	COUNTY COOK	TOTAL SHEETS 31	SHEET NO. 10
CONTRACT NO. 63320				
FED. ROAD DIST. NO. 1 ILLINOIS FED. AID PROJECT ARA-9003 (332)				