

**REMOVAL NOTES:**

1. EXISTING CONTROLLER, POSTS AND POLES HAVE BEEN REMOVED, LEAVING FOUNDATIONS IN PLACE. REMOVE ALL REMAINING FOUNDATIONS.
2. MAINTAIN EXISTING TEMPORARY SIGNAL INSTALLATION UNTIL NEW SIGNAL IS COMPLETE, THEN REMOVE TEMPORARY INSTALLATION AND DISPOSE OF AS INDICATED BELOW.
3. REMOVE STREET NAME SIGNS AND REINSTALL ON NEW SIGNAL POLES.

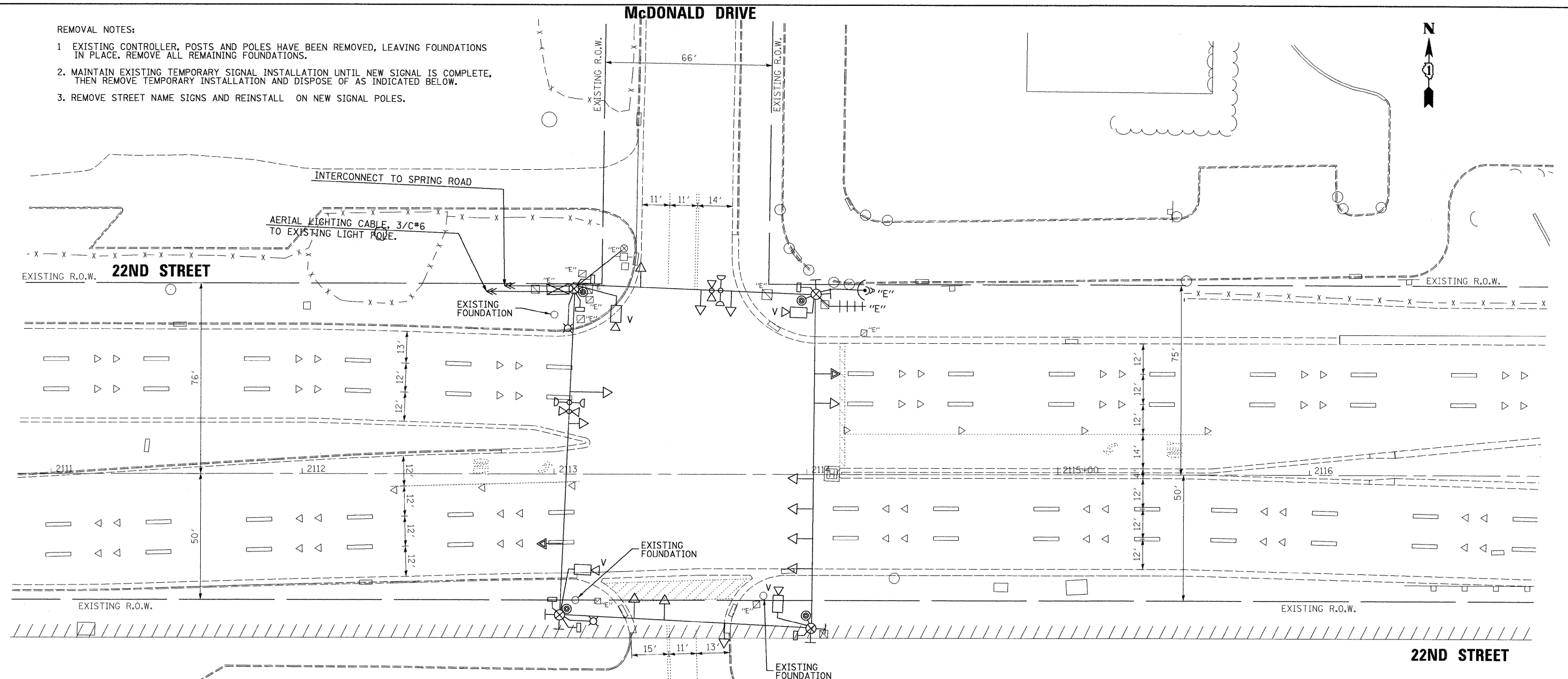

- EXISTING EQUIPMENT TO BE REMOVED LEGEND**
- 'E'-□ EXISTING SERVICE INSTALLATION TO BE REMOVED
  - EXISTING SIGNAL POST AND FOUNDATION TO BE REMOVED (SEE NOTE 1)
  - ⊃ EXISTING ALUMINUM MAST ARM POLE AND FOUNDATION TO BE REMOVED
  - 'E'-⊃ EXISTING CONTROLLER AND FOUNDATION TO BE REMOVED
  - 'E'-⊃ EXISTING HANDHOLE TO BE REMOVED
  - 'E'-⊃ EXISTING HEAVY DUTY HANDHOLE TO BE REMOVED
  - ⊃ EXISTING PEDESTRIAN SIGNAL HEAD TO BE REMOVED
  - ⊃ EXISTING PEDESTRIAN PUSH-BUTTON TO BE REMOVED
  - ⊃ EXISTING PRIORITY VEHICLE DETECTOR TO BE REMOVED
  - ⊃ EXISTING CONFIRMATION BEACON TO BE REMOVED
  - EXISTING STEEL MAST ARM POLE AND FOUNDATION TO BE REMOVED
  - ⊃ EXISTING TRAFFIC SIGNAL HEAD WITH BACKPLATE TO BE REMOVED
  - ⊃ EXISTING TRAFFIC SIGNAL HEAD TO BE REMOVED
  - 'E'-⊃ EXISTING RADIO ANTENNA TO BE REMOVED
  - 'E'-⊃ EXISTING RADIO ANTENNA TO BE REMOVED
  - ⊃ EXISTING VIDEO VEHICLE DETECTOR TO BE REMOVED
  - ⊃ EXISTING TEMPORARY WOOD POLE TO BE REMOVED

**NOTE:**  
THE TRAFFIC SIGNAL CONTROL EQUIPMENT FOR THIS PROJECT SHALL BE "ECONOLITE" TO MATCH THE EXISTING ADJACENT SYSTEM.

THE FOLLOWING EXISTING TRAFFIC SIGNAL EQUIPMENT SHALL BE REMOVED BY THE CONTRACTOR AND RETURNED TO THE VILLAGE OF OAKBROOK.

- 1 EACH LIGHT DETECTOR AMPLIFIER
- 2 EACH LIGHT DETECTOR

THE FOLLOWING EXISTING TRAFFIC SIGNAL EQUIPMENT SHALL BE REMOVED BY THE CONTRACTOR, SHALL REMAIN THE PROPERTY OF THE STATE, AND SHALL BE DELIVERED BY THE CONTRACTOR TO THE STATE'S TRAFFIC SIGNAL MAINTENANCE CONTRACTOR'S MAIN FACILITY AS PER THE TRAFFIC SIGNAL SPECIFICATIONS.

- 2 EACH RADIO ANTENNA (TRANSMITTER/RECEIVER)
- 4 EACH VIDEO VEHICLE DETECTOR
- 2 EACH WIRELESS TRANSCEIVER

THE FOLLOWING ITEMS SHALL BE REMOVED BY THE CONTRACTOR AND SHALL BE DISPOSED OF BY THEM OUTSIDE THE RIGHT-OF-WAY AT THEIR EXPENSE. THE SALVAGE VALUE OF THE REMOVED EQUIPMENT SHALL BE REFLECTED IN THE CONTRACT BID PRICE.

- 1 EACH CONTROLLER AND CABINET (COMPLETE)
- 7 EACH SIGNAL HEAD, 1-FACE, 3-SECTION
- 8 EACH SIGNAL HEAD, 1-FACE, 5-SECTION
- 2 EACH PEDESTRIAN SIGNAL HEAD, 1-FACE
- 2 EACH PEDESTRIAN SIGNAL HEAD, 2-FACE
- 4 EACH PEDESTRIAN PUSH BUTTON
- 1 EACH SERVICE INSTALLATION

FILE NAME = J:\MICROST\22ND @ McDONALDS.REM	USER NAME = RDS	DESIGNED - KK	REVISED -
		DRAWN - RDS	REVISED -
		CHECKED - BPT	REVISED -
		DATE - 09-21-09	REVISED -

**STATE OF ILLINOIS  
DEPARTMENT OF TRANSPORTATION**

EXISTING TRAFFIC SIGNAL REMOVAL PLAN				
22nd STREET AT McDONALD DRIVE /AT&T ENTRANCE				
SCALE:	SHEET NO.	OF	SHEETS	STA. TO STA.

PREPARED BY:  
**CEMCON, Ltd.**  
Consulting Engineers, Land Surveyors & Planners  
2280 White Oak Circle, Suite 100  
Aurora, Illinois 60504-9675  
Ph: 630.862.2100 Fax: 630.862.2199  
E-Mail: cedd@cemcon.com Website: www.cemcon.com

F.A.U. RTE. 1453	SECTION 2009-080 TS	COUNTY DuPAGE	TOTAL SHEETS 19	SHEET NO. 8
CONTRACT NO. 60117				
FED. ROAD DIST. NO. ILLINOIS FED. AID PROJECT				