

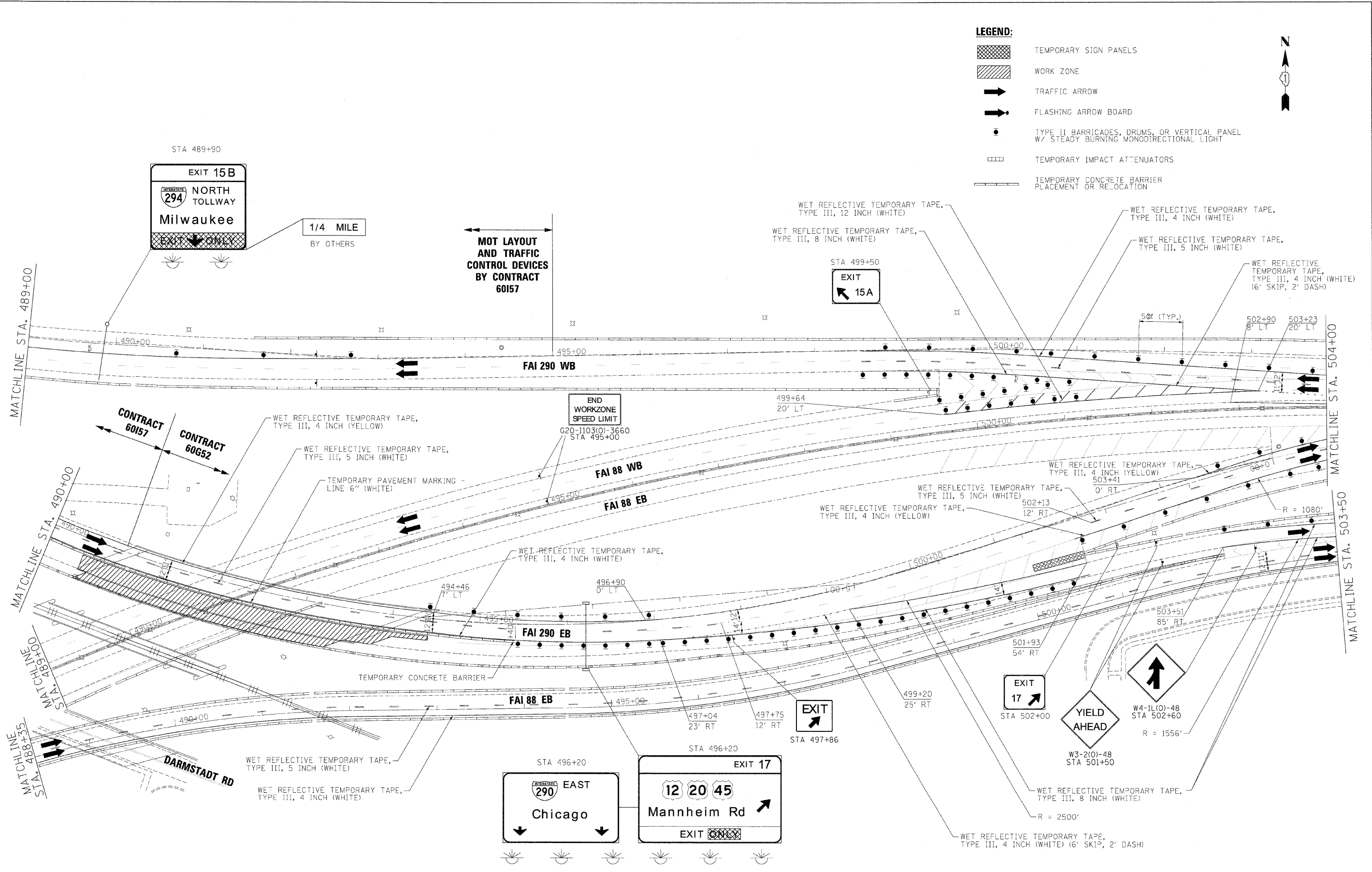

LEGEND:

- TEMPORARY SIGN PANELS
- WORK ZONE
- TRAFFIC ARROW
- FLASHING ARROW BOARD
- TYPE II BARRICADES, DRUMS, OR VERTICAL PANEL W/ STEADY BURNING MONODIRECTIONAL LIGHT
- TEMPORARY IMPACT ATTENUATORS
- TEMPORARY CONCRETE BARRIER PLACEMENT OR RELOCATION



EXIT 15B
NORTH TOLLWAY
Milwaukee

1/4 MILE
BY OTHERS

MOT LAYOUT
AND TRAFFIC
CONTROL DEVICES
BY CONTRACT
60157

EXIT
15A

END
WORKZONE
SPEED LIMIT
G20-1103(O)-3660
STA 495+00

EXIT
17
STA 497+86

EXIT 290 EAST
Chicago

EXIT 17
12 20 45
Mannheim Rd

EXIT
17
STA 502+00

YIELD
AHEAD
W4-1L(O)-48
STA 502+60
R = 1556'

W3-2(O)-48
STA 501+50

FILE NAME =	DESIGNED - AJP	REVISED -
USER NAME = tblank	DRAWN - TMB	REVISED -
PLOT DATE = 12/16/2009	CHECKED - JJT	REVISED -
	DATE - 10/16/09	REVISED -

**STATE OF ILLINOIS
DEPARTMENT OF TRANSPORTATION**

**MAINTENANCE OF TRAFFIC
PLAN - STAGE 1**

SCALE: 1"=50' SHEET NO. 15 OF 96 SHEETS STA. TO STA.

F.A.I. RTE.	SECTION	COUNTY	TOTAL SHEETS	SHEET NO.
290	(3031.1, ETC., 383BIRS-5	COOK	298	109
FED. ROAD DIST. NO.			ILLINOIS FED. AID PROJECT	

CONTRACT NO. 60652