

SCHEDULE OF QUANTITIES

QTY	UNIT	ITEM DESCRIPTION
1.0	CAL MO	ENGINEER'S FIELD OFFICE, TYPE A
0.25	L SUM	MOBILIZATION
0.25	L SUM	TRAFFIC CONTROL AND PROTECTION, STANDARD 701406
0.25	L SUM	TRAFFIC CONTROL AND PROTECTION, STANDARD 701701
3432.0	FOOT	CONDUIT IN TRENCH, 2" DIA., GALVANIZED STEEL
1771.0	FOOT	CONDUIT PUSHED, 2" DIA., GALVANIZED STEEL
7.0	EACH	HANDHOLE
3432.0	FOOT	TRENCH AND BACKFILL FOR ELECTRICAL WORK
6089.0	FOOT	ELECTRIC CABLE IN CONDUIT, TRACER, NO. 14 1C
6115.0	FOOT	FIBER OPTIC CABLE IN CONDUIT, NO. 62.5/125, MM12F & SM 12F
717.0	FOOT	CONDUIT ATTACHED TO STRUCTURE, 2" DIA., GALVANIZED STEEL
3.0	EACH	JUNCTION BOX, STAINLESS STEEL, ATTACHED TO STRUCTURE, 16"X12"X8"
1.0	EACH	OPTIMIZE TRAFFIC SIGNAL SYSTEM

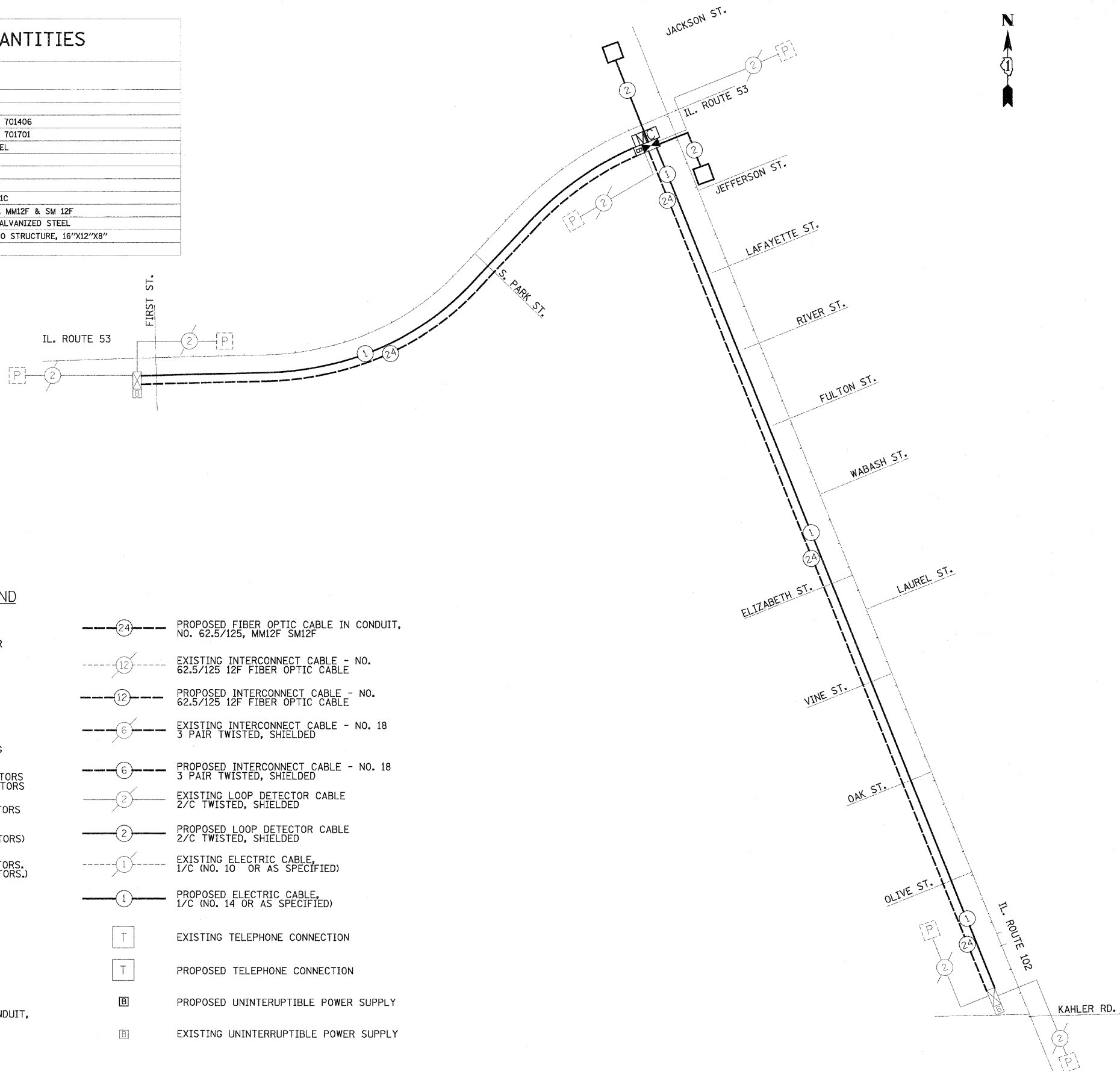

INTERCONNECT SCHEMATIC LEGEND

- | | | | |
|--|--|--|--|
| | EXISTING INTERSECTION CONTROLLER | | PROPOSED FIBER OPTIC CABLE IN CONDUIT, NO. 62.5/125, MM12F SM12F |
| | PROPOSED INTERSECTION CONTROLLER | | EXISTING INTERCONNECT CABLE - NO. 62.5/125 12F FIBER OPTIC CABLE |
| | EXISTING MASTER CONTROLLER | | PROPOSED INTERCONNECT CABLE - NO. 62.5/125 12F FIBER OPTIC CABLE |
| | PROPOSED MASTER CONTROLLER | | EXISTING INTERCONNECT CABLE - NO. 18 3 PAIR TWISTED, SHIELDED |
| | MASTER MASTER CONTROLLER | | PROPOSED INTERCONNECT CABLE - NO. 18 3 PAIR TWISTED, SHIELDED |
| | EXISTING INTERSECTION & SAMPLING (SYSTEM) DETECTORS | | EXISTING LOOP DETECTOR CABLE 2/C TWISTED, SHIELDED |
| | PROPOSED INTERSECTION & SAMPLING (SYSTEM) DETECTORS | | PROPOSED LOOP DETECTOR CABLE 2/C TWISTED, SHIELDED |
| | EXISTING INTERSECTION LOOP DETECTORS
PROPOSED SAMPLING (SYSTEM) DETECTORS | | EXISTING ELECTRIC CABLE, 1/C (NO. 10 OR AS SPECIFIED) |
| | EXISTING SAMPLING (SYSTEM) DETECTORS | | PROPOSED ELECTRIC CABLE, 1/C (NO. 14 OR AS SPECIFIED) |
| | PROPOSED SAMPLING (SYSTEM DETECTORS) | | EXISTING TELEPHONE CONNECTION |
| | EXISTING SAMPLING (SYSTEM) DETECTORS,
PROPOSED SAMPLING (SYSTEM DETECTORS.) | | PROPOSED TELEPHONE CONNECTION |
| | EXISTING PREFORMED INTERSECTION
& SAMPLING (SYSTEM) DETECTORS | | PROPOSED UNINTERRUPTIBLE POWER SUPPLY |
| | PROPOSED PREFORMED INTERSECTION
& SAMPLING (SYSTEM) DETECTORS | | EXISTING UNINTERRUPTIBLE POWER SUPPLY |
| | EXISTING SAMPLING (SYSTEM)
PREFORMED DETECTORS | | |
| | PROPOSED SAMPLING (SYSTEM)
PREFORMED DETECTORS | | |
| | EXISTING FIBER OPTIC CABLE IN CONDUIT,
NO. 62.5/125, MM12F SM12F | | |

