

PROPOSED 2" INTERCONNECT
TO IL RTE. 53

DRILL EXISTING
HANDHOLE (1)

IL. ROUTE 102
(WATER STREET)

EXISTING INTERSECTION
AND PROPOSED SAMPLING
(SYSTEM) DETECTOR

NOTE:
THE TRAFFIC SIGNAL CONTROL
EQUIPMENT FOR THIS PROJECT
SHALL BE "ECONOLITE" TO MATCH
THE EXISTING ADJACENT SYSTEM.

KANKAKEE
STREET

KAHLER ROAD

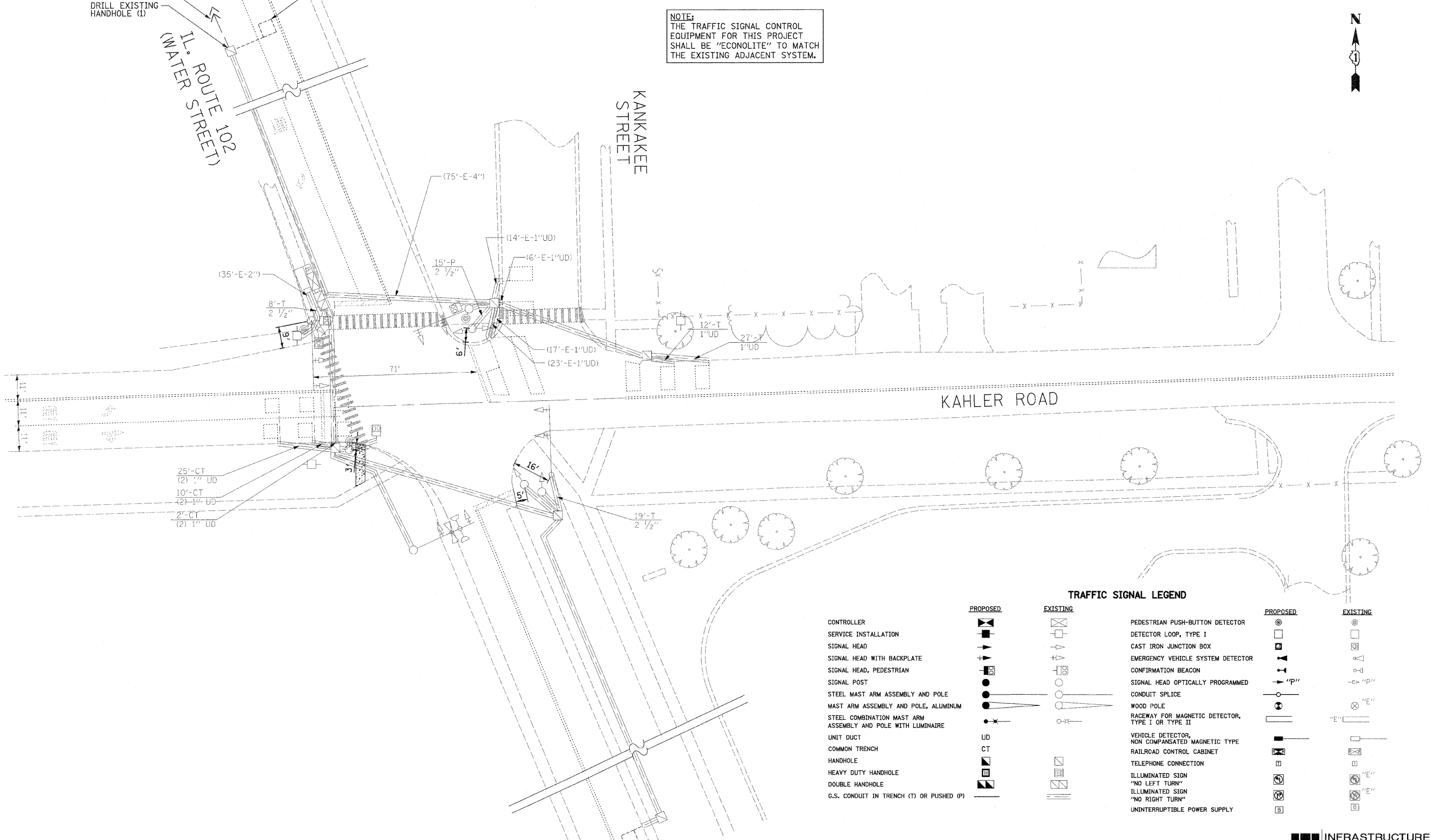

EXISTING INTERSECTION
AND PROPOSED SAMPLING
(SYSTEM) DETECTOR

TRAFFIC SIGNAL LEGEND

	PROPOSED	EXISTING		PROPOSED	EXISTING
CONTROLLER			PEDESTRIAN PUSH-BUTTON DETECTOR		
SERVICE INSTALLATION			DETECTOR LOOP, TYPE I		
SIGNAL HEAD			CAST IRON JUNCTION BOX		
SIGNAL HEAD WITH BACKPLATE			EMERGENCY VEHICLE SYSTEM DETECTOR		
SIGNAL HEAD, PEDESTRIAN			CONFIRMATION BEACON		
SIGNAL POST			SIGNAL HEAD OPTICALLY PROGRAMMED		
STEEL MAST ARM ASSEMBLY AND POLE			CONDUIT SPLICE		
MAST ARM ASSEMBLY AND POLE, ALUMINUM			WOOD POLE		
STEEL COMBINATION MAST ARM ASSEMBLY AND POLE WITH LUMINAIRE			RACEWAY FOR MAGNETIC DETECTOR, TYPE I OR TYPE II		
UNIT DUCT	UD		VEHICLE DETECTOR, NON COMPENSATED MAGNETIC TYPE		
COMMON TRENCH	CT		RAILROAD CONTROL CABINET		
HANDHOLE			TELEPHONE CONNECTION		
HEAVY DUTY HANDHOLE			ILLUMINATED SIGN "NO LEFT TURN"		
DOUBLE HANDHOLE			ILLUMINATED SIGN "NO RIGHT TURN"		
G.S. CONDUIT IN TRENCH (T) OR PUSHED (P)	T/P		UNINTERRUPTIBLE POWER SUPPLY		

FILE NAME =	USER NAME = (1224_user)	DESIGNED - LC	REVISED -
P:\P-00\1224\Task 9\DDN\Sheets\11-1224-S-T9-TSM-03.dgn		DRAWN - BID/LC	REVISED -
	PLOT SCALE = 20,000' / IN.	CHECKED - ER	REVISED -
	PLOT DATE = 10/14/2009	DATE - 9/17/2009	REVISED -

**STATE OF ILLINOIS
DEPARTMENT OF TRANSPORTATION**

**TRAFFIC SIGNAL MODIFICATION
IL ROUTE 102 AT KAHLER ROAD**

SCALE: SHEET NO. OF SHEETS STA. TO STA.

F.A.P. RTE.	SECTION	COUNTY	TOTAL SHEETS	SHEET NO.
631/846	2008-077TS	WILL	18	11
CONTRACT NO. 60F80				
FED. ROAD DIST. NO. ILLINOIS FED. AID PROJECT				

INFRASTRUCTURE ENGINEERING INCORPORATED
33 West Monroe | Suite 1540 | Chicago, IL 60603
P 312.425.9590 | F 312.425.9594 | www.infrastructure-eng.com