

F.A.P. RTE.	SECTION	COUNTY	TOTAL SHEETS	SHEET NO.
717	(111B)BR	DEWITT	53	16
STA.		TO STA.		
FED. ROAD DIST. NO.	ILLINOIS	FED. AID PROJECT		

DETOUR SIGNING DETAIL

SHEET 2 OF 4

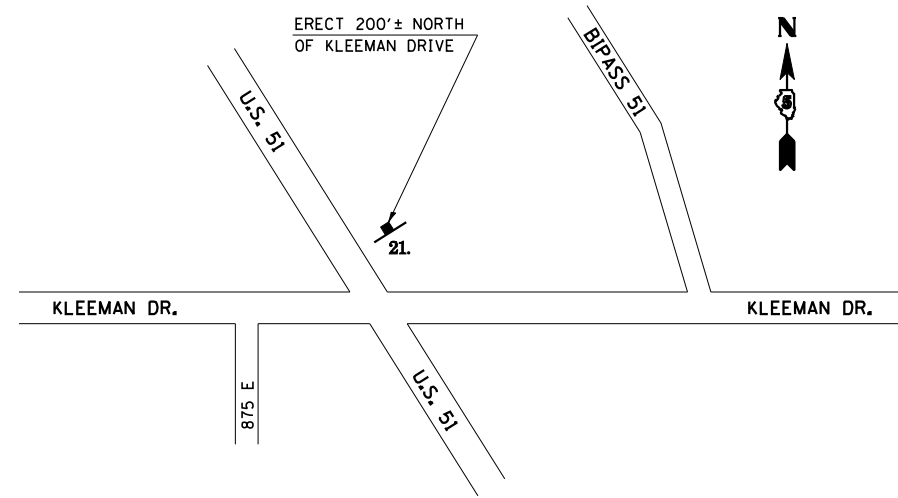

**U.S. 51 & KLEEMAN DR. INTERSECTION
AT CLINTON, IL**

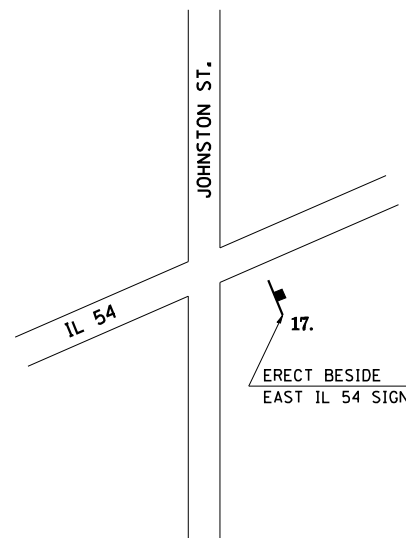

**IL 54 & JOHNSON ST. INTERSECTION
AT KENNEY, IL**

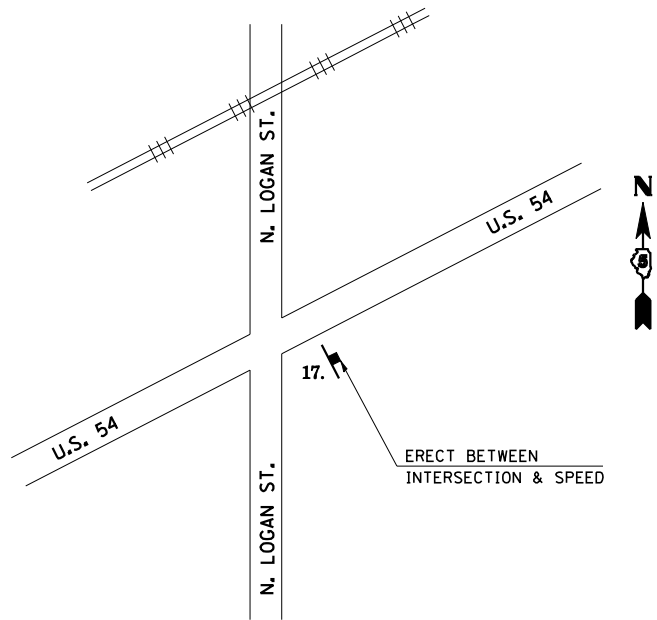

**C.H. 6 (N. LOGAN ST.) & U.S. 51 INTERSECTION
AT CHESTNUT, IL**

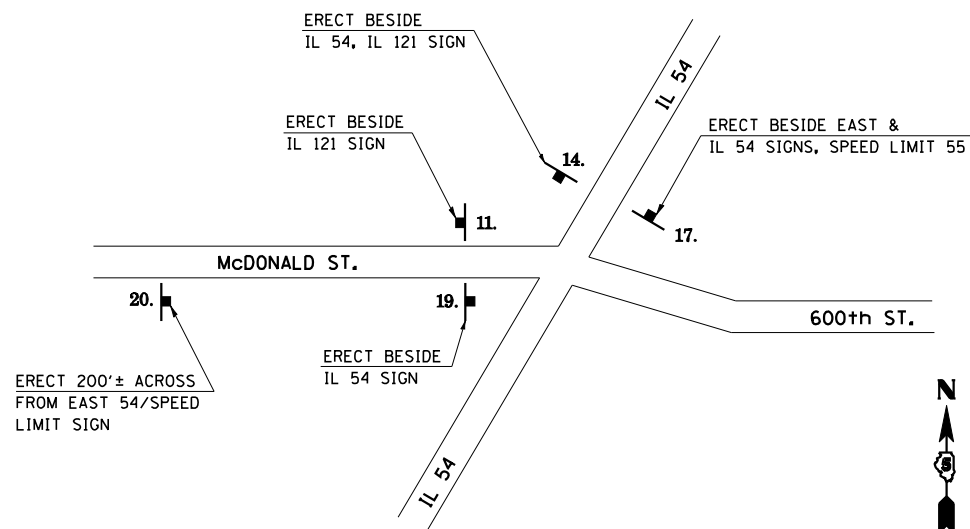

**IL 54 & McDONALD ST./600th ST. INTERSECTION
AT MOUNT PULASKI, IL**

LEGEND

- 1. ROAD CLOSED AHEAD
- 2. ROAD CLOSED AHEAD
- 3. ROAD CLOSED AHEAD
- 4. ROAD CLOSED AHEAD
- 5. ROAD CLOSED AHEAD
- 6. ROAD CLOSED AHEAD
- 7. ROAD CLOSED AHEAD
- 8. DETOUR AHEAD
- 9. BARRICADE AHEAD
- 10. END DETOUR
- 11. DETOUR WEST ILL 10
- 12. DETOUR WEST ILL 10
- 13. DETOUR WEST ILL 10
- 14. DETOUR WEST ILL 10
- 15. DETOUR WEST ILL 10
- 16. DETOUR WEST ILL 10
- 17. DETOUR EAST ILL 10
- 18. DETOUR EAST ILL 10
- 19. DETOUR EAST ILL 10
- 20. DETOUR EAST ILL 10
- 21. ILL 10 CLOSED WEST OF 51
- 22. ROAD CLOSED AHEAD LOCAL TRAFFIC ONLY
- 23. ROAD CLOSED TO THRU TRAFFIC

PLOT DATE = 8/25/2006
 FILE NAME = C:\p\projects\70387\detour\detour.dgn
 SCALE = 42.3523 / IN.
 USER NAME = pierfsonbr

ILLINOIS DEPARTMENT OF TRANSPORTATION

DETOUR SIGNING DETAIL

F.A.P. 717 (IL ROUTE 10)
 SECTION (111B)BR
 DEWITT COUNTY
 SHEET 2 OF 4

SCALE: NOT TO SCALE
 DATE: 04/27/06

DRAWN BY: B.B.P.
 CHECKED BY: M.W.M.