

Notes:  
 See Sheet 7 of 27 for Sections C-C & D-D and View E-E.  
 a<sub>1</sub>(E) and a<sub>1</sub>(E) bar spacings measured along @ Rdwy.  
 See Sheet 5 of 27 for Curb Details.  
 See Sheets 8 and 9 of 27 for Railing Details.  
 See Sheet 7 of 27 for location of Detail A.

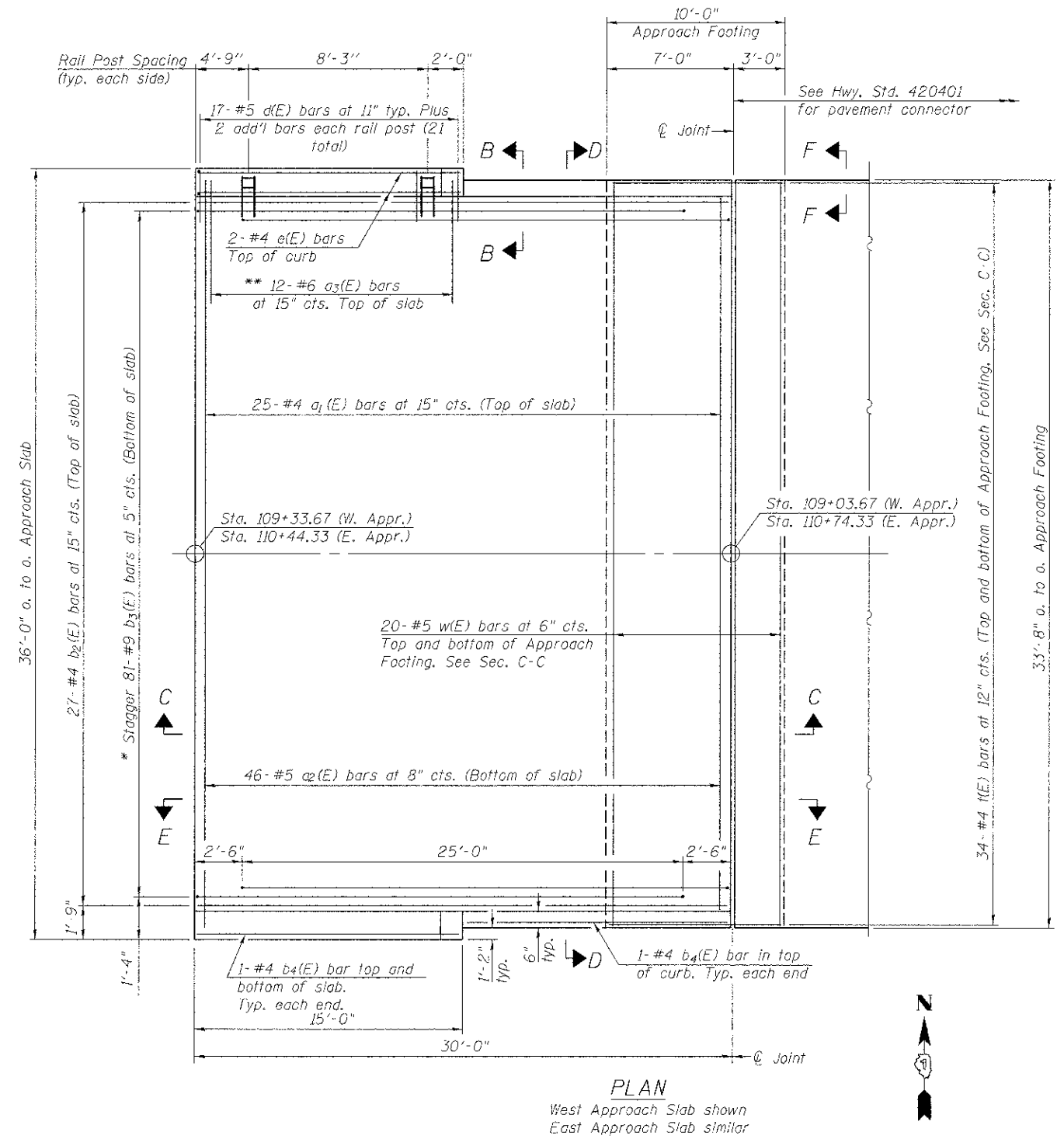

\* Tilt #9 b<sub>3</sub>(E) bars as required to maintain clearance.  
 \*\* Space between a<sub>1</sub>(E) bars, typ. ea. curb.

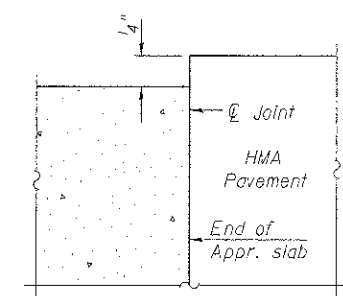

FLEXIBLE PAVEMENT  
 DETAIL A

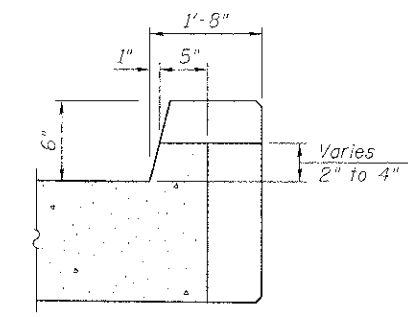

VIEW B-B

FILE NAME = s:\proj\63666-00\63666-00-01\63666-00-01.dgn

**STRAND ASSOCIATES**  
 1170 SOUTH HOOBOLT ROAD  
 JOLIET, ILLINOIS 60431  
 (815) 744-4200  
 JDFPR. NO. 184-001273

USER NAME = brianf	DESIGNED = RRD	REVISIONS
FLAT SCALE =	CHECKED = AJS	REVISIONS
FLAT DATE = 8/23/2012	DRAWN = BJF	REVISIONS
	CHECKED = RRD	REVISIONS

**MCHENRY COUNTY DIVISION OF TRANSPORTATION**  
**HILL ROAD BRIDGE OVER**  
**NORTH BRANCH NIPPERSINK CREEK**

**BRIDGE APPROACH SLAB DETAILS (1 OF 2)**  
**STRUCTURE NO. 056-3192**  
 SHEET NO. 6 OF 27 SHEETS

TR	SECTION	COUNTY	TOTAL SHEETS	SHEET NO.
21	08-00356-00-BR	MCHENRY	77	36
CONTRACT NO. 63666			ILLINOIS FED. AID PROJECT	