

Bench Mark #1 = USGS Disc on southwest wingwall, Sta. 7+12, 15' RT, El. 545.66.  
 The contractor shall hire a licensed professional surveyor to temporarily reset the benchmark during construction and reset the benchmark permanently. The surveyor shall coordinate with the USGS. The cost shall be included in the cost of Mobilization.

CONTRACT #89498

ROUTE NO.	SECTION	COUNTY	TOTAL SHEETS	SHEET NO.
FAS 447	#	Fulton	43	16
FED. ROAD DIST. NO. 7	LANE NO.	FED. AID PROJECT		
			*08-00121-01-BR	

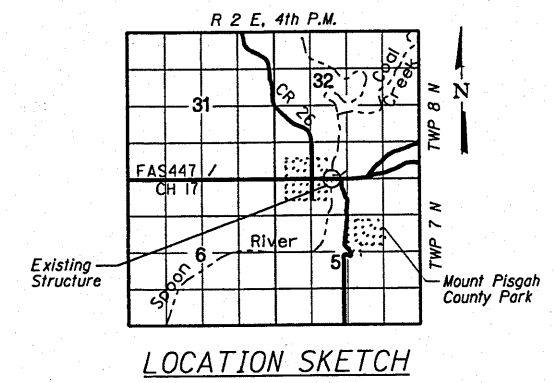
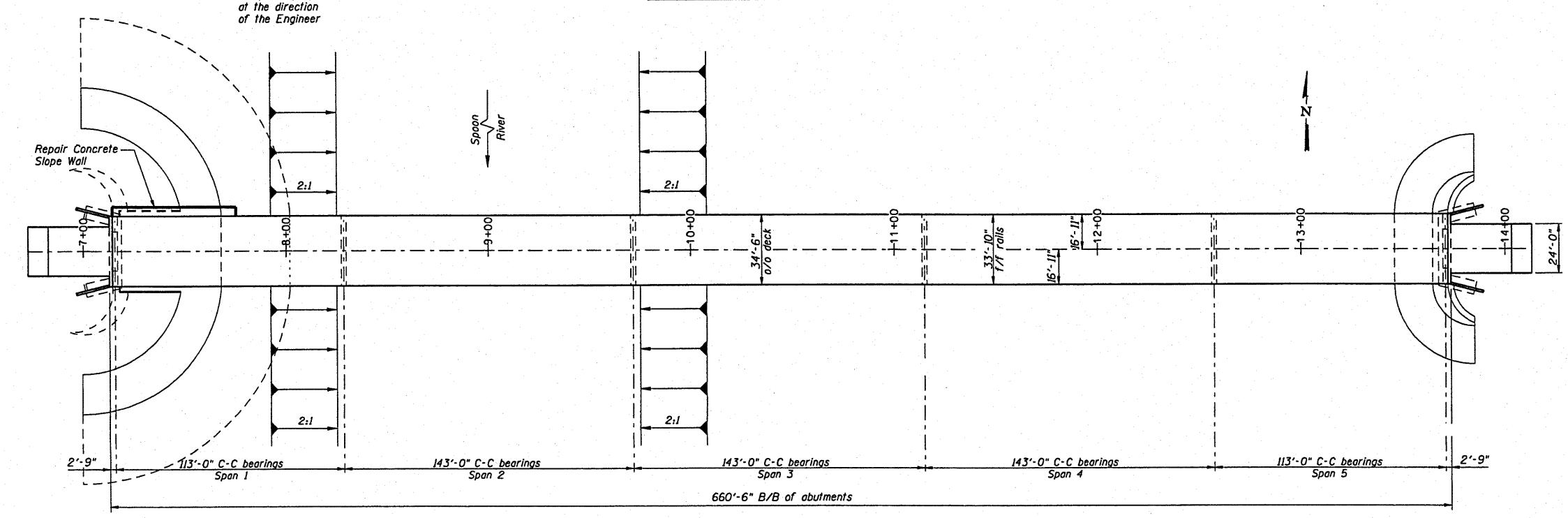
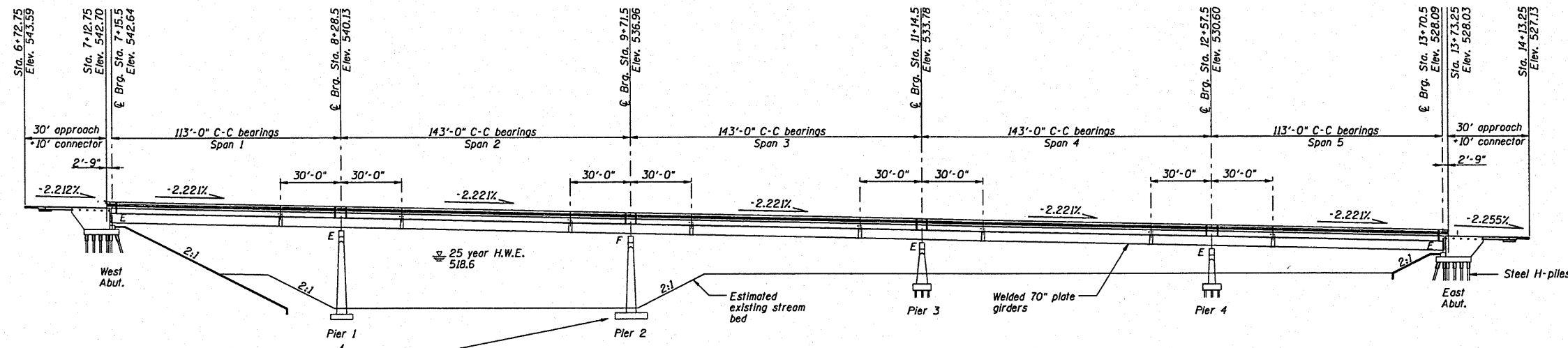

STRUCTURE NO. 029-3003  
 SEC. 08-00121-01-BR BUILT 201-  
 ELLISVILLE ROAD DISTRICT  
 FULTON COUNTY  
 LOADING HS-20-44

**NAME PLATE**  
 See Highway Standard 515001  
 Locate on the outside face of the south east wingwall.



I certify that to the best of my knowledge, information and belief, this bridge design is structurally adequate for the design loading shown on the plans. The design is an economical one for the style of structure and complies with the requirements of the current "AASHTO Standard Specifications for Highway Bridges."

*Kelly Jo Hoffmann*  
 KELLY JO HOFFMANN  
 Illinois Licensed Structural Engineer Number 6497  
 License Expires 11/30/10

DSGN	K.J. Hoffmann					<b>FRAUENHOFER</b> Fraunhofer and Associates, P.C. Consulting Engineers 3002 Crossing Court Champaign, IL 61822 217-351-6268
DR	K.J. Hoffmann					
CHK	J.A. Fraunhofer					
APVD	J.A. Fraunhofer	NO.	DATE	REVISION	BY	

GENERAL PLAN & ELEVATION		SHEET 16
FAS 447 (C.H. 17) OVER SPOON RIVER		DWG NO. 8015GPE.dgn
SECTION 08-00121-01-BR		DATE JAN 2010
FULTON COUNTY		PROJ NO. 8015