

CONTRACT NO. 60B86				
F.A.I. RTE.	SECTION	COUNTY	TOTAL SHEETS	SHEET NO.
55	2006-032 BY	WILL	505	173
STA.		TO STA.		
FED. ROAD DIST. NO.		ILLINOIS FED. AID PROJECT		

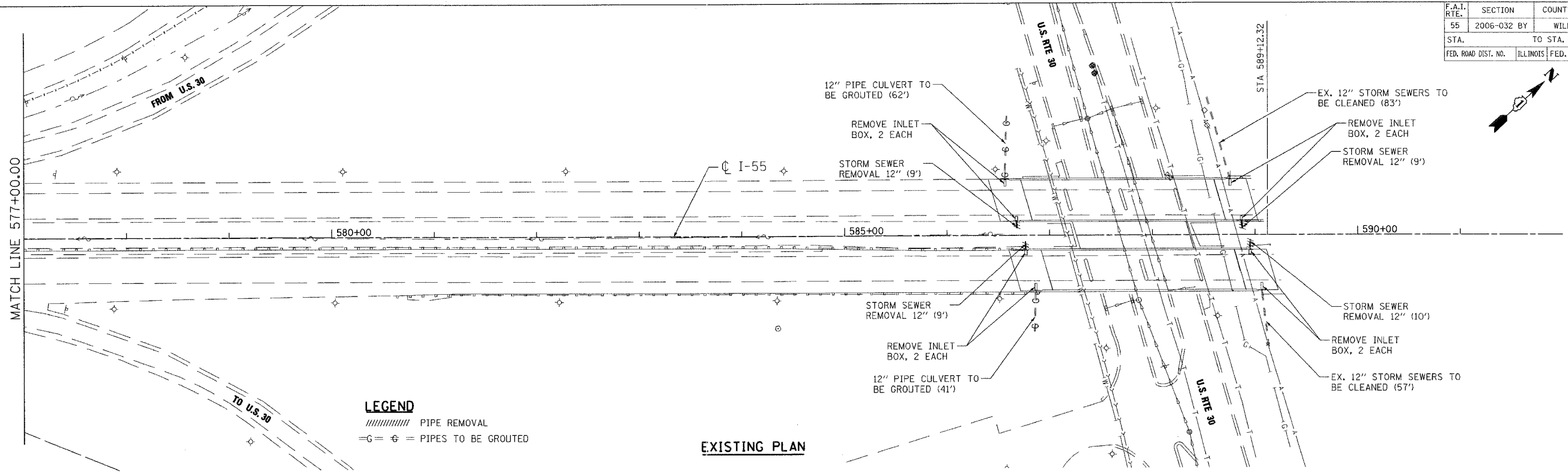

**LEGEND**  
 // // // // // PIPE REMOVAL  
 =G= PIPES TO BE GROUTED

**EXISTING PLAN**

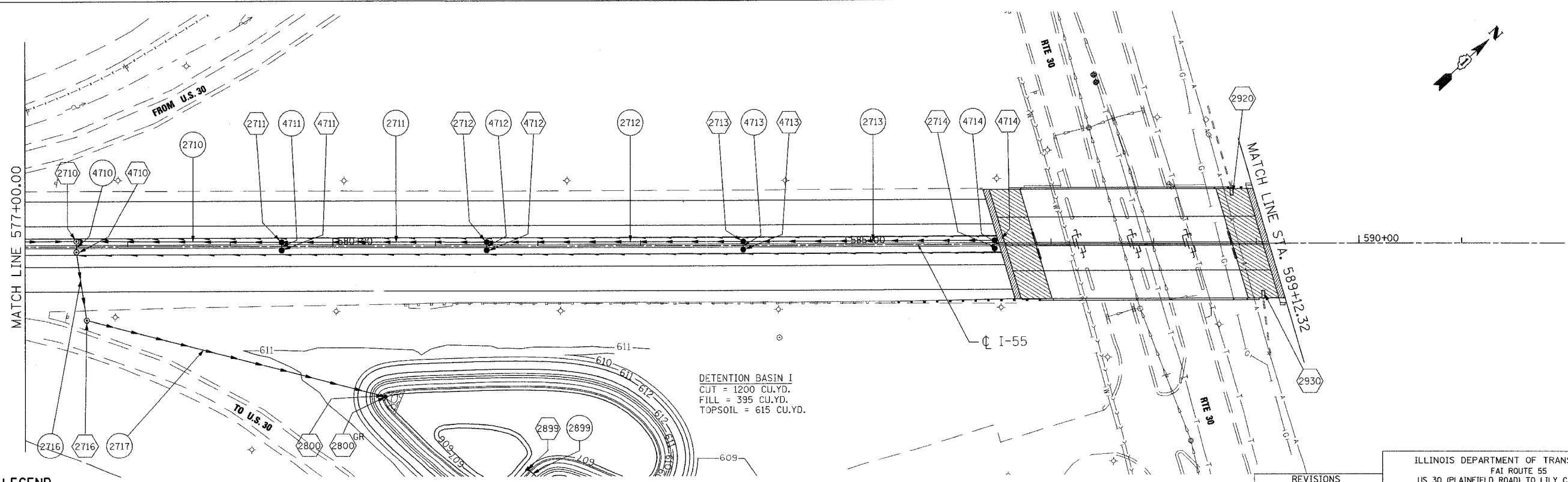

**LEGEND**  
 (1001) STRUCTURE NUMBER  
 (1001) GRATING FOR STRUCTURE  
 (1001) PIPE NUMBER  
 -> STORM SEWER  
 -> INLET  
 ● CATCH BASIN  
 ○ MANHOLE  
 ▲ FLARED END SECTION  
 ) HEADWALL  
 -> PIPE UNDERDRAINS

**NOTES**  
 1. FOR STRUCTURE AND PIPE INFORMATION SEE DRAINAGE SCHEDULE SHEETS.  
 2. PROPOSED SEWER AND CULVERT CROSSING BENEATH THE EXISTING PAVEMENT SHALL BE CONSTRUCTED DURING PRE-STAGE PER THE STAGING AND TRAFFIC CONTROL PLANS. SEE ROADWAY PLANS FOR PATCHING DETAILS.  
 3. FOR DETENTION BASIN I DETAILS SEE DRAINAGE DETAILS, DETENTION BASIN.

**PROPOSED PLAN**

REVISIONS	
NAME	DATE

ILLINOIS DEPARTMENT OF TRANSPORTATION  
 FAI ROUTE 55  
 US 30 (PLAINFIELD ROAD) TO LILY CACHE SLOUGH  
**DRAINAGE AND UTILITY PLAN**  
**FAI 55**  
**STA. 577+00.00 TO STA. 589+12.32**  
 SCALE: 1"=50'  
 DATE 07/21/06  
 DRAWN BY MRK  
 CHECKED BY TKL  
**TENG**  
 TENG & ASSOCIATES, INC.  
 ENGINEERS/ARCHITECTS/PLANNERS  
 CHICAGO, ILLINOIS

PLOT DATE: 7-19-2006 9:44:16  
 FILE: \\V:\9191\AR01.DGN  
 PLOT SCALE: 1"=50'  
 USER NAME: BJA\ZBKJ