

NORTH APPROACH

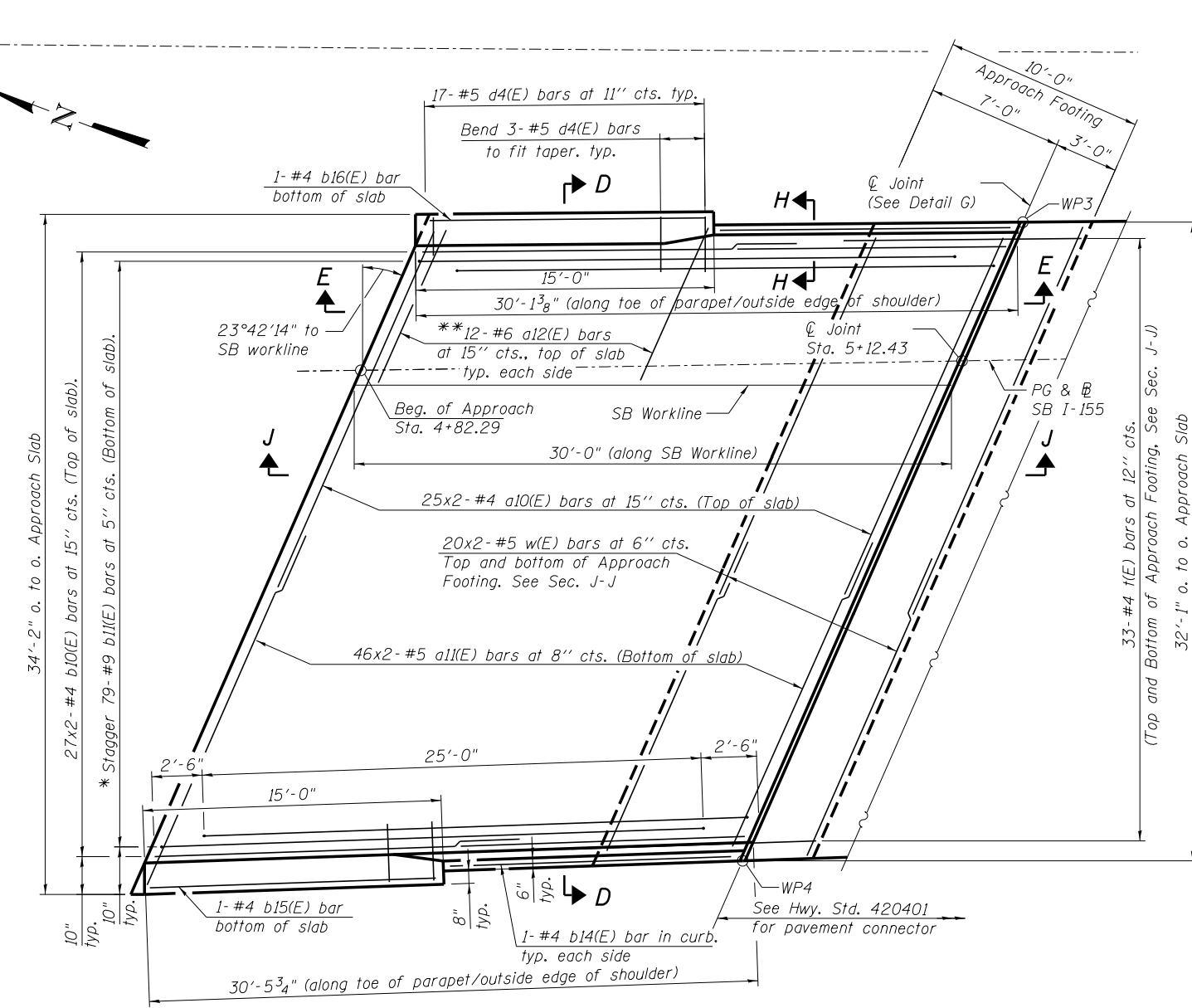

SOUTH APPROACH

PLAN

(SB Approaches)

- * Tilt #9 b1(E) bars as required to maintain clearance.
- * Space between a10(E) bars, typ. each parapet.

WORK POINTS

Point	Station	Offset
WP1	2+27.22	8.08' Rt.
WP2	2+13.38	41.11' Rt.
WP3	5+15.63	10.29' Rt.
WP4	5+00.95	42.08' Rt.

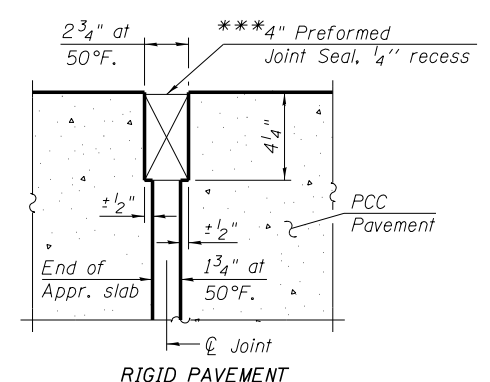

RIGID PAVEMENT

DETAIL G

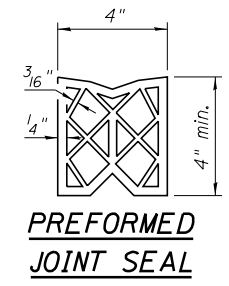

PREFORMED JOINT SEAL

MINIMUM BAR LAP

(Approach Slab)
 #4 bar = 2'-7"
 #5 bar = 3'-3"

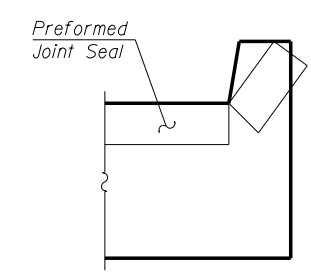

VIEW H-H

(Angle Preformed Joint Seal at 45° at curbs when req'd for drainage)

NOTES:

- See sheet SA18 for Sections and Views shown in Plan.
- a10(E) and a11(E) bar spaces are measured along SB Workline.
- b10(E) and b11(E) bar spaces are measured perpendicular to SB Workline.
- t(E) bar spaces are measured along skew of approach footing.
- Bars indicated 20x2-#5 etc. indicate 20 bars with 2 lengths per line.
- Stations and offsets are measured from C I-155 .

FILE NAME =	USER NAME = mbecker	DESIGNED - MFB/DTS	REVISED -
0900165.68620.16.epl1b1.dgn	PLOT SCALE =	CHECKED - AAY	REVISED -
	PLOT DATE = 7/16/2012	DRAWN - PRT	REVISED -
		CHECKED - AAY	REVISED -

F.A.I. RT.E.	SECTION	COUNTY	TOTAL SHEETS	SHEET NO.
74	90-[14R(14HB-4,14,14HB)BR]	TAZEWELL	2433	1880
CONTRACT NO. 68620				