

09-19-2025 LETTING ITEM 093

STATE OF ILLINOIS  
 DEPARTMENT OF TRANSPORTATION  
 PLANS FOR PROPOSED  
**SAFE ROUTES TO SCHOOL**  
 SECTION NO. 22-00042-00-SW  
 PROJECT KAQS(977)  
 CITY OF OGLESBY, ILLINOIS  
 LASALLE COUNTY  
 C-93-032-25

F.A.U. RTE.	SECTION	COUNTY	TOTAL SHEETS	SHEET NO.
--	22-00042-00-SW	LASALLE	21	1
FED. ROAD DIST. NO.	ILLINOIS CONTRACT NO 87871			

INDEX OF SHEETS

- 1 COVER SHEET
- 2 GENERAL NOTES AND TYPICAL SECTIONS
- 3 SUMMARY OF QUANTITIES
- 4 SCHEDULE OF QUANTITIES
- 5 KEY MAP
- 6-12 PLAN SHEETS
- 13-21 INTERSECTION DETAILS

HIGHWAY STANDARDS

- 000001-08 STANDARD SYMBOLS, ABBREVIATIONS AND PATTERNS
- 424001-12 PERPENDICULAR CURB RAMPS FOR SIDEWALKS
- 424021-07 DEPRESSED CORNER FOR SIDEWALKS
- 424026-04 ENTRANCE/ALLEY PEDESTRIAN CROSSINGS
- 424031-03 MEDIAN PEDESTRIAN CROSSINGS
- 602301-04 INLET, TYPE A
- 604001-05 FRAME AND LIDS, TYPE 1
- 604046-03 FRAME AND GRATE, TYPE 10
- 606001-08 CONCRETE CURB TYPE B AND COMBINATION CONCRETE CURB AND GUTTER
- 701501-06 URBAN LANE CLOSURE, 2L, 2W, UNDIVIDED
- 701801-06 SIDEWALK, CORNER OR CROSSWALK CLOSURE
- 701901-10 TRAFFIC CONTROL DEVICES

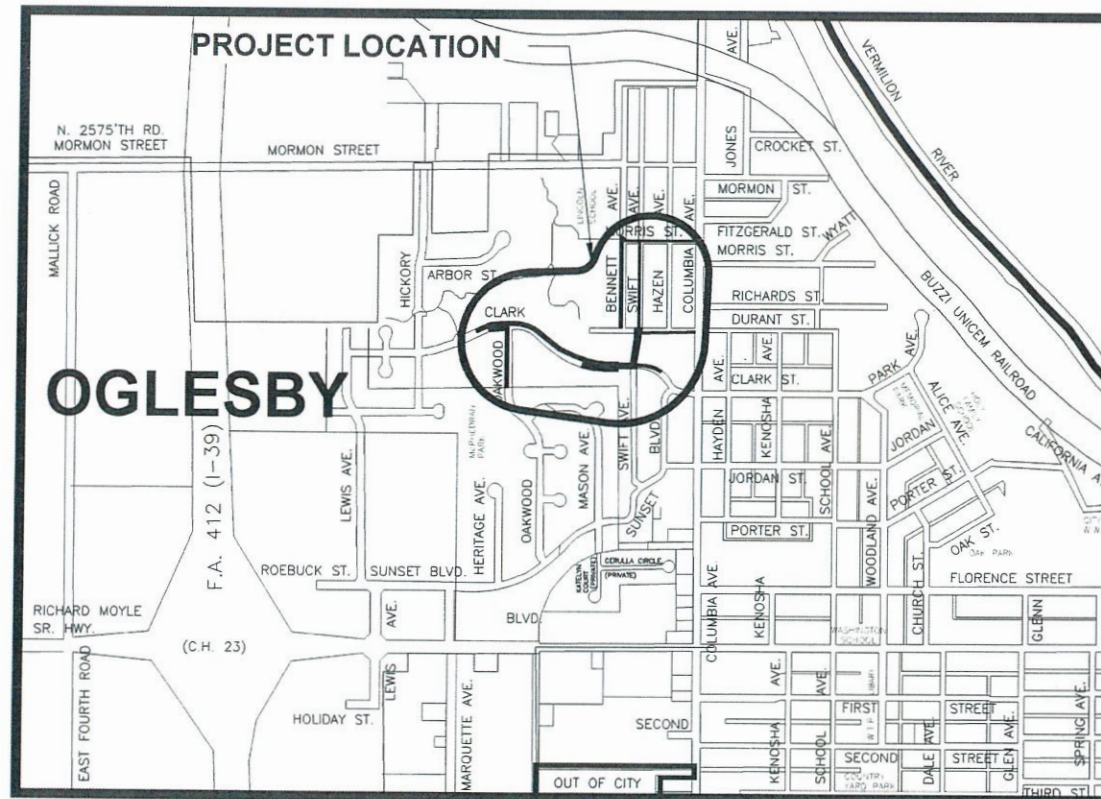

LOCATION MAP

(NOT TO SCALE)

NET LENGTH = 4712 FEET

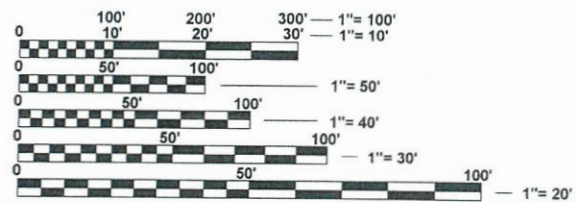

FULL SIZE PLANS HAVE BEEN PREPARED USING STANDARD ENGINEERING SCALES. REDUCED SIZED PLANS WILL NOT CONFORM TO STANDARD SCALES. IN MAKING MEASUREMENTS ON REDUCED PLANS, THE ABOVE SCALES MAY BE USED.

J.U.L.I.E.  
 JOINT UTILITY LOCATION INFORMATION FOR EXCAVATION  
 1-800-892-0123  
 OR 811

STATE OF ILLINOIS  
 DEPARTMENT OF TRANSPORTATION  
 DIVISION OF HIGHWAYS

SUBMITTED May 5 2025

*[Signature]*  
 MAYOR, CITY OF OGLESBY

PASSED May 30 2025

*[Signature]*  
 DISTRICT 3 LOCAL ROADS AND STREETS ENGINEER

5/15/25  
 date

*[Signature]*  
 RELEASED FOR BID  
 BASED ON LIMITED REVIEW  
 REGION 2 ENGINEER

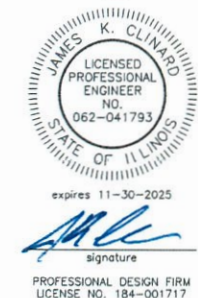

PROFESSIONAL DESIGN FIRM  
 LICENSE NO. 184-001717

PRINTED BY THE AUTHORITY  
 OF THE STATE OF ILLINOIS

"CONTRACT NO. 87871"

CHAMBER & ASSOCIATES, INC. © 2021  
 11/13/25 11:13:37 AM Printed On: Friday, May 02, 2025 12:37:46 PM By: Jani Coudas

TRANSITION WIDTH AND CROSS SLOPE TO MATCH EXISTING WHERE NEW SIDEWALK MEETS OLD.

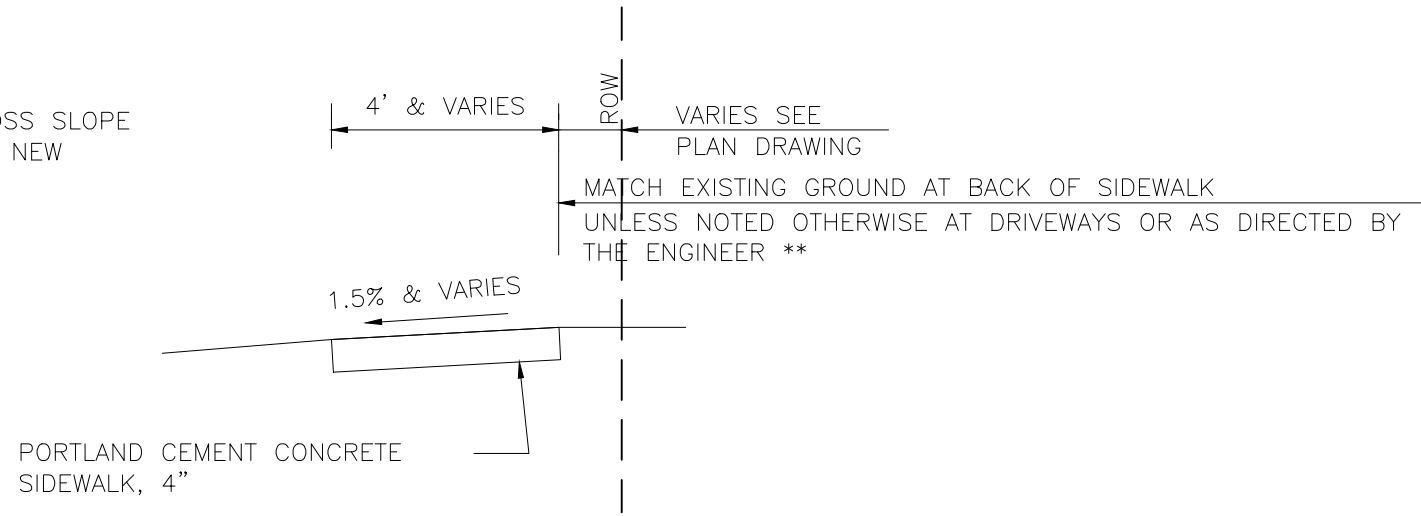

SIDEWALK TYPICAL SECTION

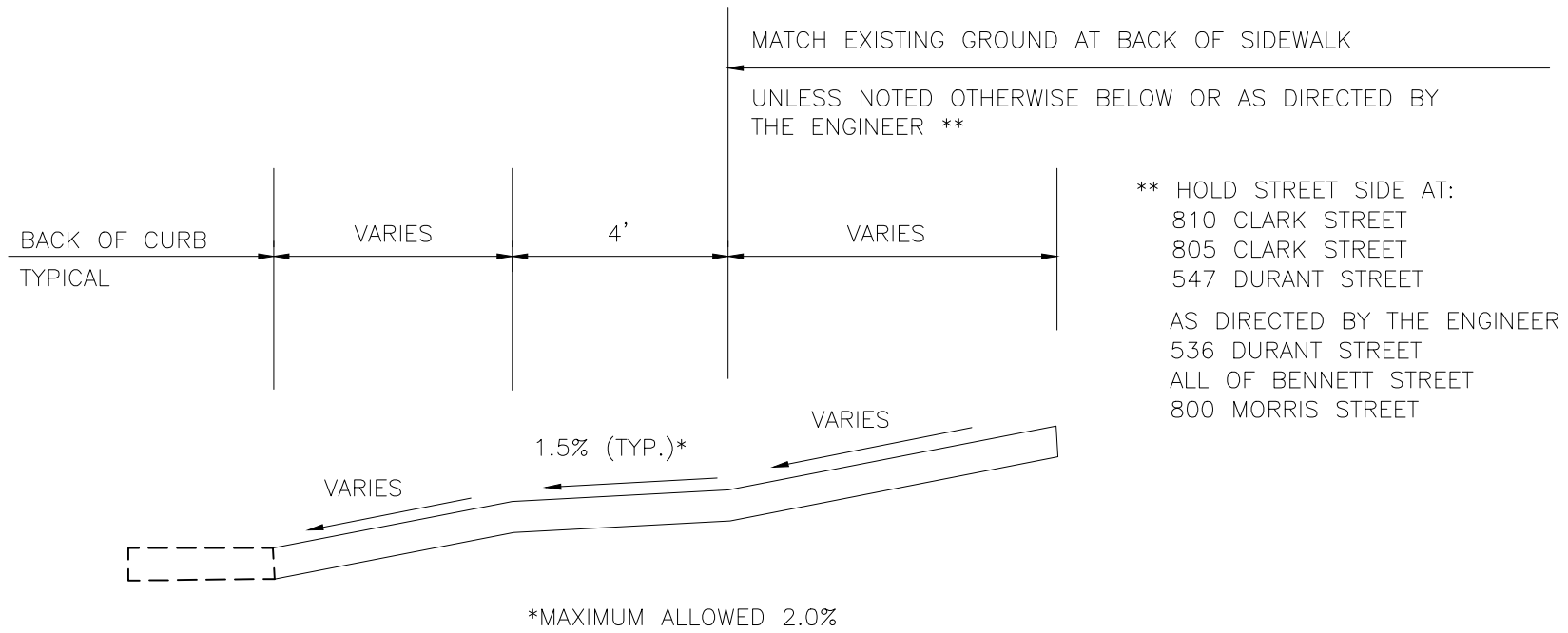

DRIVEWAY TYPICAL SECTION

**GENERAL NOTES**

FOR EXCAVATION IN AREAS WHERE SIDEWALK IS NEW OR WIDER THAN THE EXISTING SIDEWALK, THE COST OF EXCAVATION SHALL BE INCLUDED IN THE COST OF SIDEWALK.  
 LIMITS OF SIDEWALK REMOVAL IS INTENDED TO BE AT AN EXISTING JOINT IN THE SIDEWALK. A FULL DEPTH SAWCUT WILL BE REQUIRED AT ALL EDGES OF SIDEWALK OR PAVEMENT TO BE REMOVED THAT BORDERS OTHER SIDEWALKS OR PAVEMENT.

SUBGRADE PREPARATION SHALL BE IN ACCORDANCE WITH ARTICLE 424.04. THE COST OF GRADING SUBGRADE FOR SIDEWALK SHALL BE CONSIDERED INCLUDED IN THE COST OF ASSOCIATED SIDEWALK.

DETECTABLE WARNING SURFACES SHALL EXTEND 2.0 FT MINIMUM IN THE DIRECTION OF PEDESTRIAN TRAVEL. AT CURB RAMPS AND BLENDED TRANSITIONS, DETECTABLE WARNING SURFACES SHALL EXTEND THE FULL WIDTH OF THE RAMP RUN (EXCLUDING ANY FLARES) OR BLENDED TRANSITION. SOME DETECTABLE WARNING PRODUCTS REQUIRE A CONCRETE BORDER FOR PROPER INSTALLATION. THE CONCRETE BORDER SHALL NOT EXCEED 2".

ANY REFERENCE TO A STANDARD IN THESE PLANS SHALL BE INTERPRETED TO MEAN THE EDITION AS INDICATED BY THE SUBNUMBER SHOWN ON THE LIST OF STANDARDS.

THE COST OF GRADING AND COMPACTING SUBBASE FOR SIDEWALK OR DRIVEWAYS SHALL BE INCLUDED IN THE COST OF SIDEWALK OR DRIVEWAY PAVEMENT.

THE FINISHED EARTHWORK SHALL HAVE A VEGETATIVE SUSTAINING SOIL COVERING THE TOP FOUR INCHES IN AREAS TO BE SEEDED. THE VEGETATIVE SUSTAINING SOIL REQUIRED WILL NOT BE PAID FOR SEPARATELY BUT WILL BE INCLUDED IN THE COST OF THE LANDSCAPING, SPECIAL PAY ITEM.

THE COST OF EXCAVATING AND DISPOSING OF MATERIAL BELOW AND / OR OUTSIDE OF EXISTING SIDEWALKS OR CURBS OR DRIVEWAYS AS REQUIRED TO INSTALL FORMWORK SHALL BE CONSIDERED INCLUDED IN THE COST OF THE SIDEWALK, CURB, AND DRIVEWAY PAY ITEMS.

INCIDENTAL HMA 2" SHALL BE PLACED WHERE EXCAVATIONS ARE MADE OUTSIDE OF CURB AND GUTTER FOR FORMWORK.

WHERE EXCAVATIONS ARE MADE OUTSIDE OF CURB AND GUTTER TO ALLOW FORMWORK, SUCH EXCAVATIONS SHALL BE FILLED TO THE BOTTOM OF THE PROPOSED INCIDENTAL HMA USING CONTROLLED LOW STRENGTH MATERIAL OR USING CONCRETE. THIS WORK SHALL BE CONSIDERED INCLUDED IN THE COST OF THE CURB AND GUTTER PAY ITEM.

ALL ELEVATIONS REFERRING TO U.S.G.S. MEAN SEA LEVEL DATUM.

THE CONTRACTOR SHALL CONTACT J.U.L.I.E AT LEAST 48 HOURS PRIOR TO EXCAVATION.

MEMBERS OF JULIE KNOWN TO BE WITHIN THE LIMITS OF THE IMPROVEMENT ARE:

CITY OF OGLESBY  
 110 E. WALNUT STREET  
 OGLESBY, IL 61348  
 (815) 883-3639 - WATER  
 (815) 481-0046 - ELECTRIC  
 (815) 883-3639 - SEWER

COMCAST - MICHAEL OWENS  
 5N301 MEDINAH ROAD  
 ADDISON, IL 60101  
 (815) 509-7876  
 MICHAEL\_OWENS4@CABLE.COMCAST.COM

AMEREN - ANGELA HOLLOWAY  
 340 RACCUGLIA DRIVE  
 P.O. BOX 1428  
 LASALLE, IL 61301  
 (815) 224-6202  
 AHOLLOWAY@AMEREN.COM

AT&T MIDWEST - JANET AHERN  
 1000 COMMERCE DR., FLOOR 1  
 OAK BROOK, IL 60523  
 (630) 573-6414  
 JA1763@ATT.COM

ILLINOIS FIBER RESOURCES  
 3100 SYCAMORE ROAD  
 DEKALB, IL 60115  
 LANCE SANDY  
 (815) 753-6075  
 LSANDY@NIU.EDU

SEEDING WILL NOT BE PERMITTED AT ANY TIME WHEN THE GROUND IS FROZEN, WET, OR IN AN UNTILLABLE CONDITION. LOCATIONS TO BE SEEDED WILL BE DETERMINED BY THE ENGINEER.

THE CONTRACTOR SHALL PROTECT ALL TREES FROM DAMAGE DUE TO HIS OPERATIONS. THIS COST SHALL BE INCLUDED IN THE COST OF THE OVERALL PROJECT.

**"CONTRACT NO. 87871"**

CHAMLIN & ASSOCIATES, INC. © 2022. Drawing Name: G:\Users\VA65593-00-DRIVE-ak-SIDE-TYP-SECT.dwg. Last Modified: Tuesday, May 13, 2025 4:51:53 PM. Picked On: Tuesday, May 13, 2025 4:52:33 PM. by Jim Olinard

DRAWN BY: LP	LEVEL	BY	DATE	REVISIONS	DESCRIPTION
CHECKED BY: CHECKED					
DATE: 10/31/22					

PERU MORRIS  
 OTTAWA MENDOTA  
 ILLINOIS

**OGLESBY SAFE ROUTES TO SCHOOL**  
**SECTION 22-00042-00-SW**  
**OGLESBY, ILLINOIS**

**TYPICAL SECTION**

**CONSTRUCTION PLANS**

CURRENT AS OF: 03/24/2025	
SCALE: AS NOTED	SHEET 2
FILE NO.: 66393.00 Y-	OF 21



CURB & GUTTER SCHEDULE		HMA SCHEDULE*		
LOCATION	COMBINATION CURB AND GUTTER REMOVAL FOOT	COMBINATION CONCRETE CURB AND GUTTER, TYPE B-6.18 FOOT	INCIDENTAL HOT MIX ASPHALT SURFACING TON	BITUMINOUS MATERIALS (TACK COAT) POUND
CLARK ST WEST OF OAKWOOD AVE	19	19	0.2	0.7
NORTHWEST QUADRANT OF CLARK ST AND SWIFT AVE	16	16	0.1	0.6
NORTHEAST QUADRANT OF CLARK ST AND SWIFT AVE	11	11	0.1	0.4
SOUTHWEST QUADRANT OF CLARK ST AND SWIFT AVE	15	15	0.1	0.6
SOUTHEAST QUADRANT OF CLARK ST AND SWIFT AVE	15	15	0.1	0.6
NORTHWEST QUADRANT OF SWIFT AVE AND DURANT ST	11	11	--	--
NORTHEAST QUADRANT OF SWIFT AVE AND DURANT ST	25	25	--	--
SOUTHWEST QUADRANT OF SWIFT AVE AND DURANT ST	10	10	--	--
SOUTHEAST QUADRANT OF SWIFT AVE AND DURANT ST	11	11	--	--
NORTHWEST QUADRANT OF SWIFT AVE AND MORRIS ST	13	13	--	--
NORTHEAST QUADRANT OF SWIFT AVE AND MORRIS ST	17	17	--	--
SOUTHWEST QUADRANT OF SWIFT AVE AND MORRIS ST	9	9	--	--
SOUTHEAST QUADRANT OF SWIFT AVE AND MORRIS ST	15	15	--	--
BENNETT AVE AND MORRIS ST	36	36	--	--
NORTHWEST QUADRANT OF HAZEN AVE AND MORRIS ST	15	15	--	--
NORTHEAST QUADRANT OF HAZEN AVE AND MORRIS ST	16	16	--	--
<b>TOTAL</b>	<b>254</b>	<b>254</b>	<b>0.7</b>	<b>2.9</b>

\* - SEE GENERAL NOTES

DRIVEWAY SCHEDULE		
LOCATION	DRIVEWAY PAVEMENT REMOVAL SQ YD	PORTLAND CEMENT CONCRETE DRIVEWAY PAVEMENT, 6 INCH SQ YD
814 CLARK STREET	23.4	24.4
810 CLARK STREET	51.3	51.4
809 CLARK STREET	30.2	31.7
807 CLARK STREET	34.5	37.0
806 CLARK STREET (WEST)	12.9	13.7
806 CLARK STREET (EAST)	13.5	14.3
805 CLARK STREET	51.3	52.9
515 SWIFT AVENUE	9.2	9.5
523 SWIFT AVENUE	23.9	23.9
529 SWIFT AVENUE	18.7	18.6
536 SWIFT AVENUE	47.2	48.3
653 SWIFT AVENUE	18.7	18.4
659 SWIFT AVENUE	4.8	4.9
107 OAKWOOD AVENUE	39.5	40.9
105 OAKWOOD AVENUE	33.1	36.0
103 OAKWOOD AVENUE	41.2	43.4
547 COLUMBIA AVENUE	40.9	41.1
707 COLUMBIA AVENUE	28.2	30.1
621 BENNETT AVENUE	18.5	18.6
625 BENNETT AVENUE	20.3	20.9
629 BENNETT AVENUE	16.5	17.2
635 BENNETT AVENUE	25.6	26.8
639 BENNETT AVENUE	27.5	27.5
643 BENNETT AVENUE	27.8	28.7
800 MORRIS STREET	44.0	44.5
<b>TOTAL</b>	<b>703</b>	<b>725</b>

DETECTABLE WARNING SCHEDULE	
LOCATION	DETECTABLE WARNING SQ FT
CLARK ST WEST OF OAKWOOD AVE	16.8
NORTHWEST QUADRANT OF CLARK ST AND SWIFT AVE	16.8
NORTHEAST QUADRANT OF CLARK ST AND SWIFT AVE	15.0
SOUTHWEST QUADRANT OF CLARK ST AND SWIFT AVE	13.8
SOUTHEAST QUADRANT OF CLARK ST AND SWIFT AVE	15.4
NORTHWEST QUADRANT OF SWIFT AVE AND DURANT ST	9.7
NORTHEAST QUADRANT OF SWIFT AVE AND DURANT ST	19.4
SOUTHWEST QUADRANT OF SWIFT AVE AND DURANT ST	9.9
SOUTHEAST QUADRANT OF SWIFT AVE AND DURANT ST	10.4
NORTHWEST QUADRANT OF SWIFT AVE AND MORRIS ST	11.1
NORTHEAST QUADRANT OF SWIFT AVE AND MORRIS ST	18.2
SOUTHWEST QUADRANT OF SWIFT AVE AND MORRIS ST	9.9
SOUTHEAST QUADRANT OF SWIFT AVE AND MORRIS ST	14.3
BENNETT AVE AND MORRIS ST	23.9
NORTHWEST QUADRANT OF HAZEN AVE AND MORRIS ST	15.2
NORTHEAST QUADRANT OF HAZEN AVE AND MORRIS ST	16.7
<b>TOTAL</b>	<b>237</b>

DRAINAGE STRUCTURE SCHEDULE			
LOCATION	MANHOLES TO BE ADJUSTED EACH	MANHOLES TO BE ADJUSTED WITH NEW TYPE 1 FRAME, OPEN LID EACH	INLETS TO BE ADJUSTED WITH NEW TYPE 1 FRAME, OPEN LID EACH
NORTHEAST QUADRANT OF SWIFT AVE AND DURANT ST	---	---	1
BENNETT AVENUE - LINCOLN SCHOOL	1	---	---
629 BENNETT AVENUE	1	---	---
NORTHWEST QUADRANT OF SWIFT AVE AND MORRIS ST	---	---	1
NORTHEAST QUADRANT OF SWIFT AVE AND MORRIS ST	---	---	1
SOUTHEAST QUADRANT OF SWIFT AVE AND MORRIS ST	---	---	1
NORTHEAST QUADRANT OF BENNETT AVE AND MORRIS ST	1	---	---
NORTHWEST QUADRANT OF HAZEN AVE AND MORRIS ST	---	1	---
NORTHEAST QUADRANT OF HAZEN AVE AND MORRIS ST	---	---	1
<b>TOTAL</b>	<b>3</b>	<b>1</b>	<b>5</b>

SIDEWALK SCHEDULE		
LOCATION	SIDEWALK REMOVAL SQ FT	PORTLAND CEMENT CONCRETE SIDEWALK 4 INCH SQ FT
NORTH SIDE OF CLARK ST WEST OF SWIFT AVE	---	5243.5
SOUTH SIDE OF CLARK ST WEST OF OAKWOOD AVE	---	333.2
SOUTH SIDE OF CLARK ST BETWEEN OAKWOOD AVE & SWIFT AVE	51.2	1596.7
NORTH SIDE OF CLARK ST EAST OF SWIFT AVE	---	366.8
SOUTHEAST QUADRANT OF CLARK ST AND SWIFT AVE	102.8	125.4
WEST SIDE SWIFT AVE JUST NORTH OF CLARK ST	102.3	32.8
EAST SIDE SWIFT AVE JUST NORTH OF CLARK ST	---	346.8
WEST SIDE SWIFT AVE JUST SOUTH OF DURANT ST	---	415.8
NORTHWEST QUADRANT OF SWIFT AVE AND DURANT ST	50.2	54.5
NORTHEAST QUADRANT OF SWIFT AVE AND DURANT ST	103.6	170.0
WEST SIDE SWIFT AVE JUST SOUTH OF MORRIS ST	435.8	423.8
NORTHWEST QUADRANT OF SWIFT AVE AND MORRIS ST	91.2	99.6
NORTHEAST QUADRANT OF SWIFT AVE AND MORRIS ST	135.4	152.8
SOUTHEAST QUADRANT OF SWIFT AVE AND MORRIS ST	100.4	110.8
WEST SIDE OF OAKWOOD AVE SOUTH OF CLARK ST	---	1647.7
SOUTH SIDE OF DURANT ST BETWEEN SWIFT AVE AND COLUMBIA AVE	854.3	1439.3
WEST SIDE OF BENNETT AVE BETWEEN DURANT ST AND MORRIS ST	53.3	2553.3
NORTH SIDE OF MORRIS ST JUST EAST OF BENNETT AVE	209.0	183.5
NORTH SIDE OF MORRIS ST FROM JUST WEST OF HAZEN AVE TO COLUMBIA AVE	870.7	1264.4
<b>TOTAL</b>	<b>3160</b>	<b>16561</b>

PAVEMENT MARKING SCHEDULE	
LOCATION	PAINT PAVEMENT MARKING - LINE 8" FOOT
WEST LEG OF SWIFT AVE AND DURANT ST	59
EAST LEG OF SWIFT AVE AND DURANT ST	40
NORTH LEG OF SWIFT AVE AND DURANT ST	50
WEST LEG OF SWIFT AVE AND MORRIS ST	56
EAST LEG OF SWIFT AVE AND MORRIS ST	45
NORTH LEG OF SWIFT AVE AND MORRIS ST	45
NORTH LEG OF BENNETT AVE AND MORRIS ST	59
NORTH LEG OF HAZEN AVE AND MORRIS ST	44
<b>TOTAL</b>	<b>398</b>

EARTHWORK SCHEDULE				
LOCATION	EARTH EXCAVATION CU. YD.	EARTH EXCAVATION ADJUSTED FOR SHRINKAGE CU. YD.	EMBANKMENT CU. YD.	EARTHWORK BALANCE WASTE (+) OR SHORTAGE (-) CU. YD.
NORTH SIDE OF CLARK WEST OF SWIFT	16.1	12.1	3.4	8.7
NORTH SIDE OF CLARK EAST OF SWIFT	4.5	3.4	0.0	3.4
SOUTH SIDE OF CLARK WEST OF SWIFT	16.1	12.1	3.4	8.7
EAST SIDE OF SWIFT NORTH OF CLARK	4.3	3.2	0.0	3.2
WEST SIDE OF OAKWOOD	21.4	16.1	3.1	13.0
SOUTH SIDE OF DURANT	3.2	2.4	0.5	1.9
WEST SIDE OF BENNETT	27.3	20.5	3.9	16.6
NORTH SIDE OF MORRIS NEAR COLUMBIA	4.1	3.1	0.0	3.1
<b>TOTAL</b>	<b>97</b>	<b>73</b>	<b>14</b>	<b>58</b>

"CONTRACT NO. 87871"

CHAMLIN & ASSOCIATES, INC. © 2022. Drawing Name: G:\Users\A.V.66393-00-00\oglesby-2021-SRIS\CAD\04-SCHED.dwg. Last Modified: Tuesday, May 06, 2025 1:10:05 PM. Plotted On: Thursday, May 15, 2025 5:33:26 PM. by Jim Cloward

DRAWN BY: LP	REVISIONS
CHECKED BY: JKC	DESCRIPTION
DATE: 10/2022	



PERU MORRIS  
OTTAWA MENDOTA  
ILLINOIS

OGLESBY SAFE ROUTES TO SCHOOL  
SECTION 22-00042-00-SW  
OGLESBY, ILLINOIS

SCHEDULE OF QUANTITIES

CONSTRUCTION PLANS

CURRENT AS OF: 03/24/2025	
SCALE: AS NOTED	SHEET 4
FILE NO.: 66393.00 Y-	OF 21

CHAMLIN & ASSOCIATES, INC. © 2022  
 Drawing Name: G:\Users\G6593-00-Oglesby-2021-SRTS\CAD\005-SHEET-INDEX.dwg Last Modified: Tuesday, May 6, 2025 8:24:59 PM Plotted On: Thursday, May 15, 2025 6:36:06 PM by Debbie Story

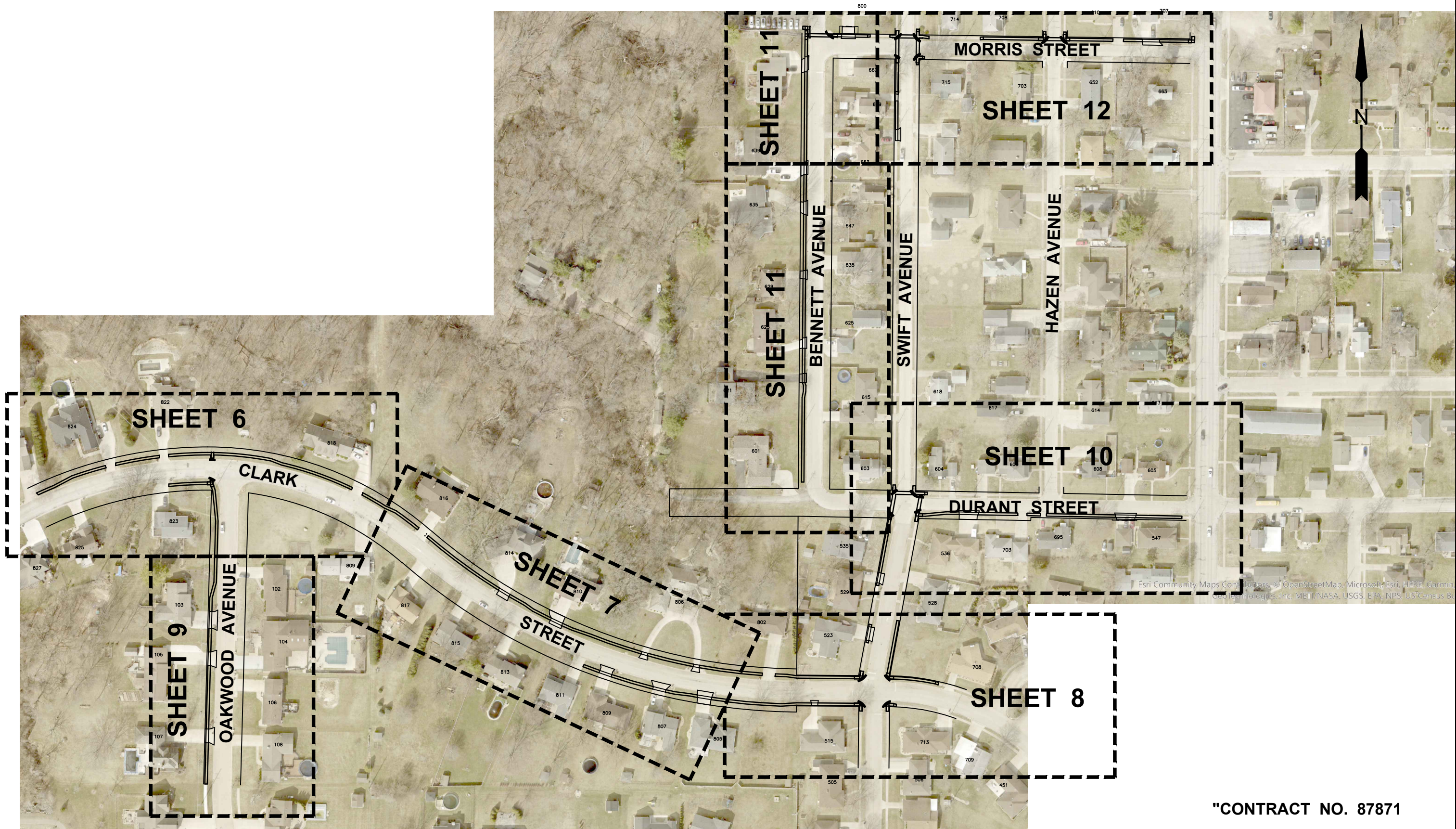

**"CONTRACT NO. 87871**

DRAWN BY: DS	LEVEL	BY	DATE	REVISIONS	DESCRIPTION
CHECKED BY: JKC					
DATE: 07/2022					

**PERU MORRIS**  
**OTTAWA MENDOTA**  
**ILLINOIS**

**OGLESBY SAFE ROUTES TO SCHOOL**  
**SECTION 22-00042-00-SW**  
**OGLESBY, ILLINOIS**

**KEY MAP**

<b>CONSTRUCTION PLANS</b>	CURRENT AS OF: 03/24/2025	
	SCALE: AS NOTED	SHEET 5
	FILE NO.: 66393.00 Y-	OF 21

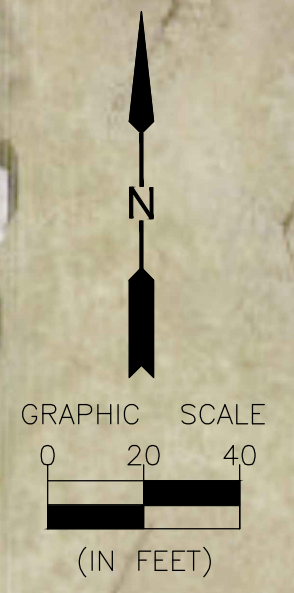
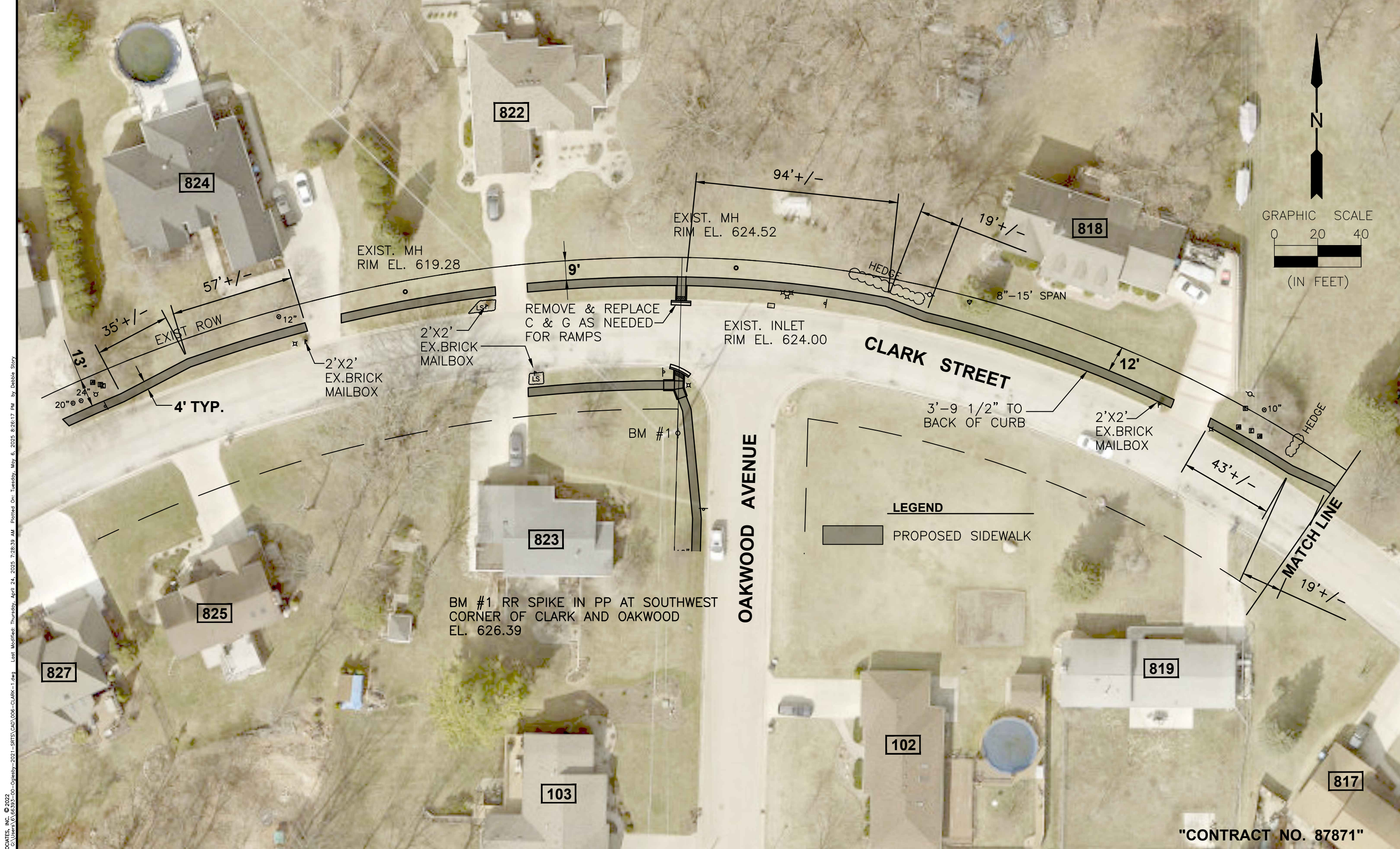

**LEGEND**  
 [Grey Box] PROPOSED SIDEWALK

CHAMLIN & ASSOCIATES, INC. © 2022  
 Drawing Name: G:\Users\G66393\OneDrive - Chamlin & Associates\Projects\2021-SRTE\CAD\06-CLARK-1.dwg  
 Last Modified: Thursday, April 24, 2025 7:28:39 AM  
 Ploited On: Tuesday, May 6, 2025 8:28:17 PM by Debbie Story

**"CONTRACT NO. 87871"**

DRAWN BY: DS	REVISIONS			
	LEVEL	BY	DATE	DESCRIPTION
CHECKED BY: JKC				
DATE: 07/2022				



PERU MORRIS  
 OTTAWA MENDOTA  
 ILLINOIS

**OGLESBY SAFE ROUTES TO SCHOOL**  
**SECTION 22-0042-00-SW**  
**OGLESBY, ILLINOIS**

**PLAN**

<b>CONSTRUCTION PLANS</b>	CURRENT AS OF: 03/24/2025	
	SCALE: AS NOTED	SHEET 6
	FILE NO.: 66393.00 Y-	OF 21



**LEGEND**

- PROPOSED SIDEWALK
- PROPOSED DRIVEWAY

CHAMLIN & ASSOCIATES, INC. © 2022  
 Drawing Name: G:\Users\G66593-00-Oglesby-2021-SRTS\CAD\007-CLARK-2.dwg  
 Last Modified: Thursday, April 24, 2025 7:35:15 AM  
 Plotted On: Tuesday, May 6, 2025 8:28:24 PM  
 by Debbie Story

**"CONTRACT NO. 87871"**

DRAWN BY: DS	REVISIONS			
CHECKED BY: JKC	LEVEL	BY	DATE	DESCRIPTION
DATE: 07/2022				



PERU MORRIS  
 OTTAWA MENDOTA  
 ILLINOIS

**OGLESBY SAFE ROUTES TO SCHOOL**  
**SECTION 22-00042-00-SW**  
**OGLESBY, ILLINOIS**

PLAN

CONSTRUCTION PLANS

CURRENT AS OF: 03/24/2025	
SCALE: AS NOTED	SHEET 7
FILE NO.: 66393.00 Y-	OF 21

806

529

528

802

523

708

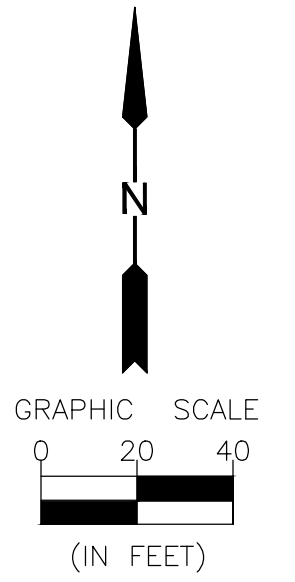
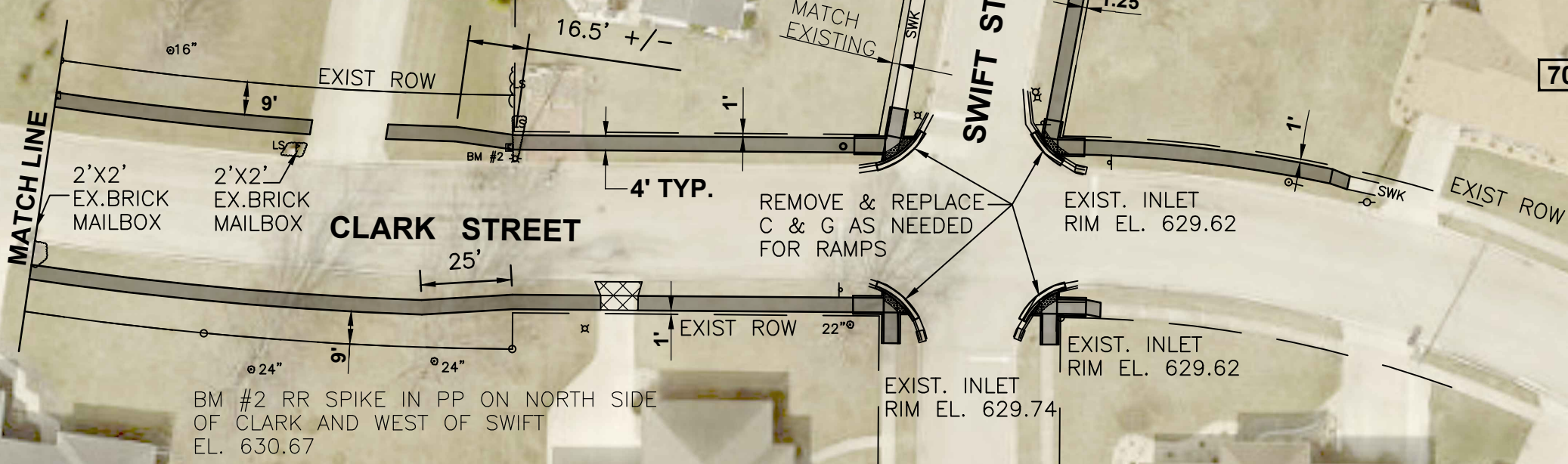

**LEGEND**

	PROPOSED SIDEWALK
	PROPOSED DRIVEWAY

CHAMLIN & ASSOCIATES, INC. © 2022  
 Drawing Name: G:\Users\G66593-00-Oglesby-2021-SRTS\CAD\008-CLARK-3.dwg  
 Last Modified: Thursday, April 24, 2025 7:36:47 AM  
 Plotted On: Tuesday, May 6, 2025 8:30:14 PM  
 by Debbie Story

807

805

515

713

709

505

506

451

"CONTRACT NO. 87871"

DRAWN BY: DS	LEVEL	BY	DATE	REVISIONS	DESCRIPTION
CHECKED BY: JKC					
DATE: 07/2022					

PERU MORRIS  
OTTAWA MENDOTA  
ILLINOIS

**OGLESBY SAFE ROUTES TO SCHOOL**  
**SECTION 22-00042-00-SW**  
**OGLESBY, ILLINOIS**

**PLAN**

**CONSTRUCTION PLANS**

CURRENT AS OF: 03/24/2025	
SCALE: AS NOTED	SHEET 8
FILE NO.: 66393.00 Y-	OF 21



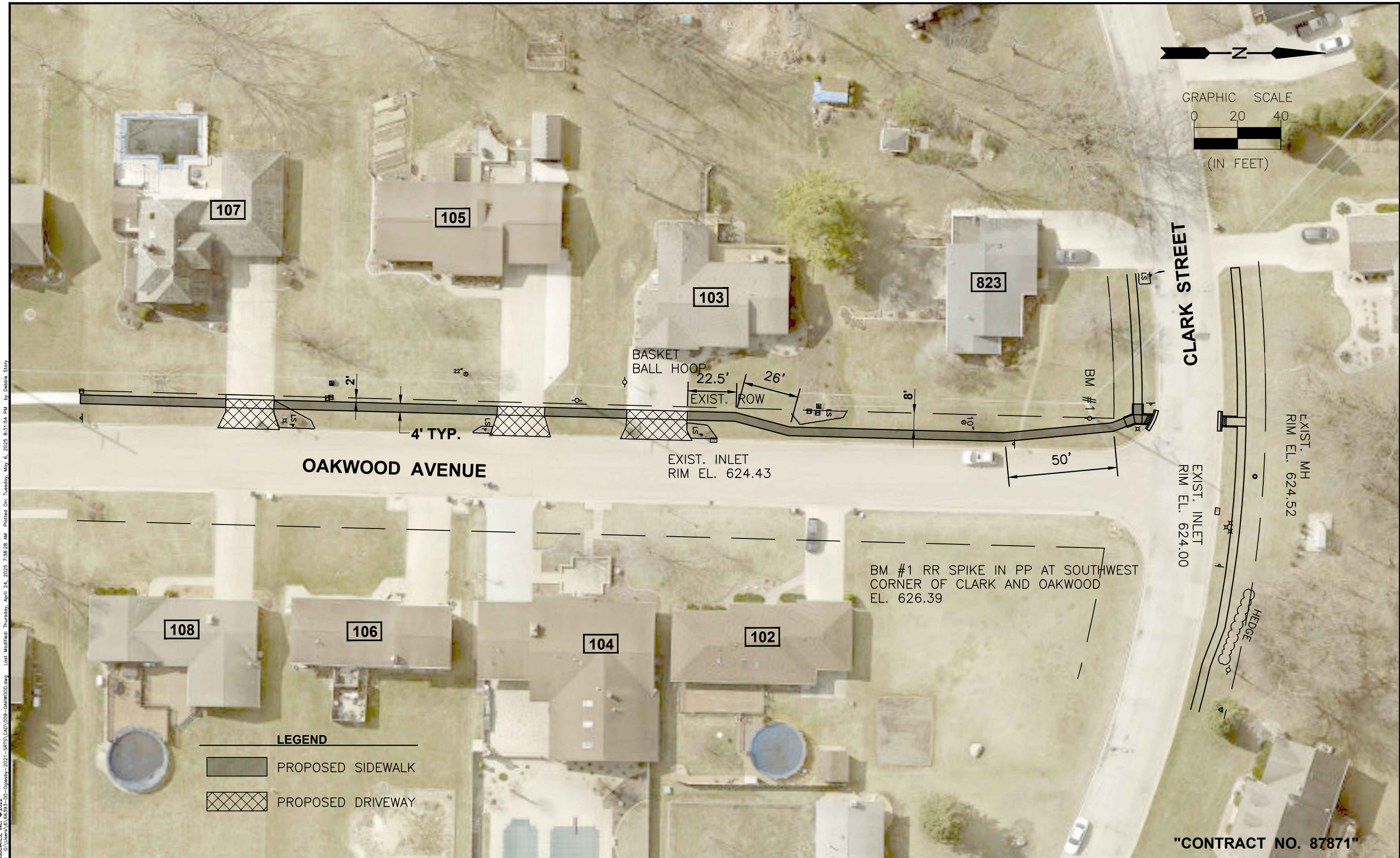
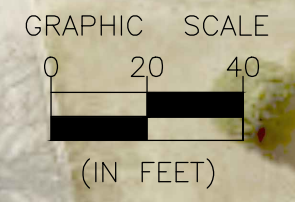
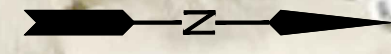

**LEGEND**

	PROPOSED SIDEWALK
	PROPOSED DRIVEWAY

CHAMLIN & ASSOCIATES, INC. © 2022  
 Drawing Name: G:\Users\jkc\OneDrive - Chamlin & Associates, Inc.\Documents\2021-2022\Oglesby-2021-SRTO\09-OAKWOOD.dwg  
 Last Modified: Thursday, April 24, 2025 7:38:28 AM  
 Plotted On: Tuesday, May 6, 2025 8:31:54 PM  
 by Debbie Story

DRAWN BY: DS	REVISIONS			
	LEVEL	BY	DATE	DESCRIPTION
CHECKED BY: JKC				
DATE: 07/2022				



**OGLESBY SAFE ROUTES TO SCHOOL**  
**SECTION 22-00042-00-SW**  
**OGLESBY, ILLINOIS**

**PLAN**

**CONSTRUCTION PLANS**

CURRENT AS OF: 03/24/2025	
SCALE: AS NOTED	SHEET 9
FILE NO.: 66393.00 Y-	OF 21

**"CONTRACT NO. 87871"**

CHAMLIN & ASSOCIATES, INC. © 2022  
 Drawing Name: G:\Users\G6593-00-Oglesby-2021-SRTS\CAD\10-DURANT.dwg Last Modified: Thursday, April 24, 2025 7:39:51 AM Plotted On: Tuesday, May 6, 2025 8:38:19 PM by Debbie Story

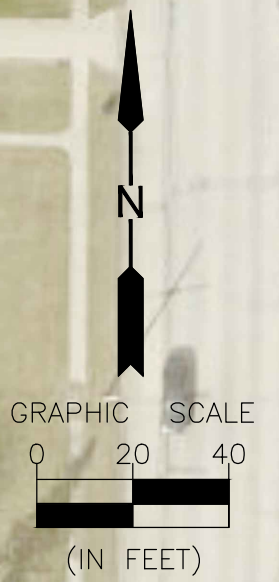
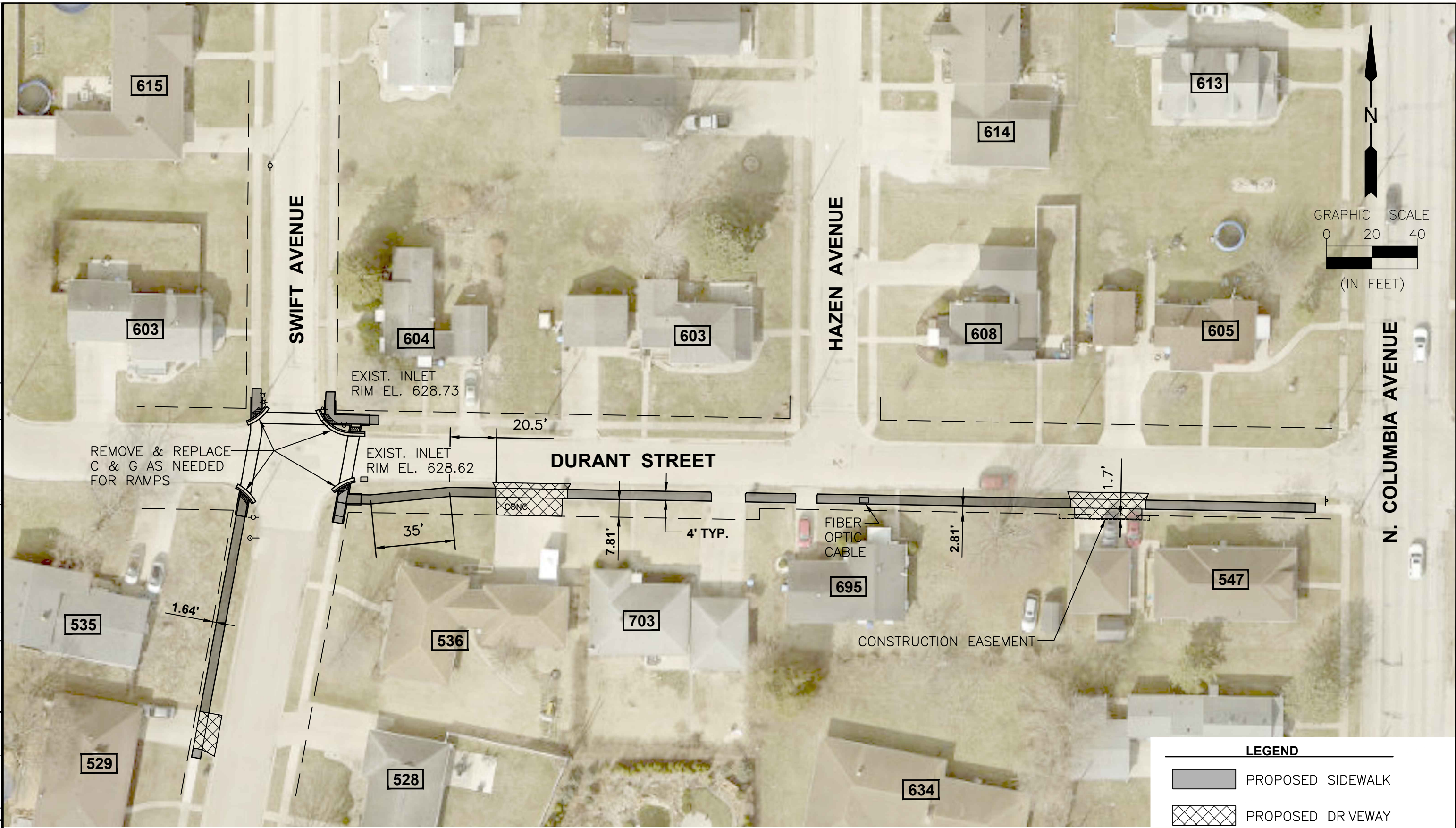

LEGEND	
	PROPOSED SIDEWALK
	PROPOSED DRIVEWAY

**"CONTRACT NO. 87871"**

LEVEL	BY	DATE	REVISIONS	DESCRIPTION

**Chamlin & Associates**  
 PERU MORRIS  
 OTTAWA MENDOTA  
 ILLINOIS

**OGLESBY SAFE ROUTES TO SCHOOL**  
**SECTION 22-00042-00-SW**  
**OGLESBY, ILLINOIS**

**PLAN**

<b>CONSTRUCTION PLANS</b>	CURRENT AS OF: 03/24/2025	
	SCALE: AS NOTED	SHEET 10
	FILE NO.: 66393.00 Y-	OF 21

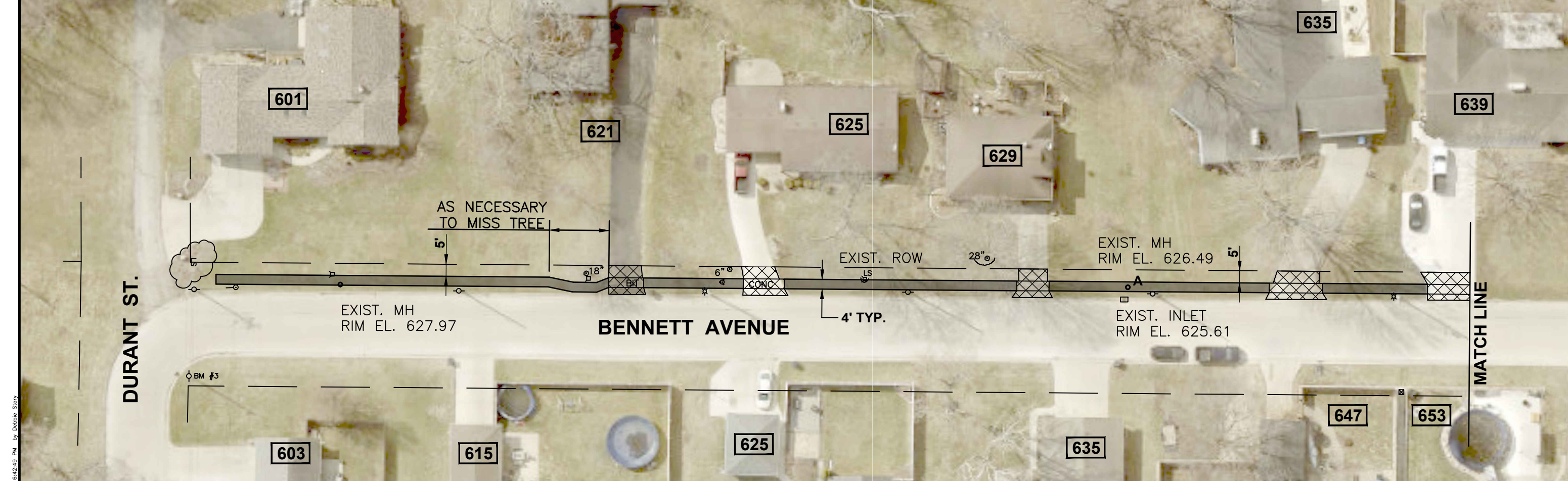

BM #3 RR SPIKE IN PP AT NORTHEAST CORNER OF DURANT AND BENNETT EL. 630.11

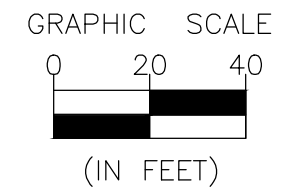
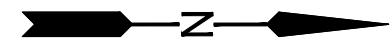
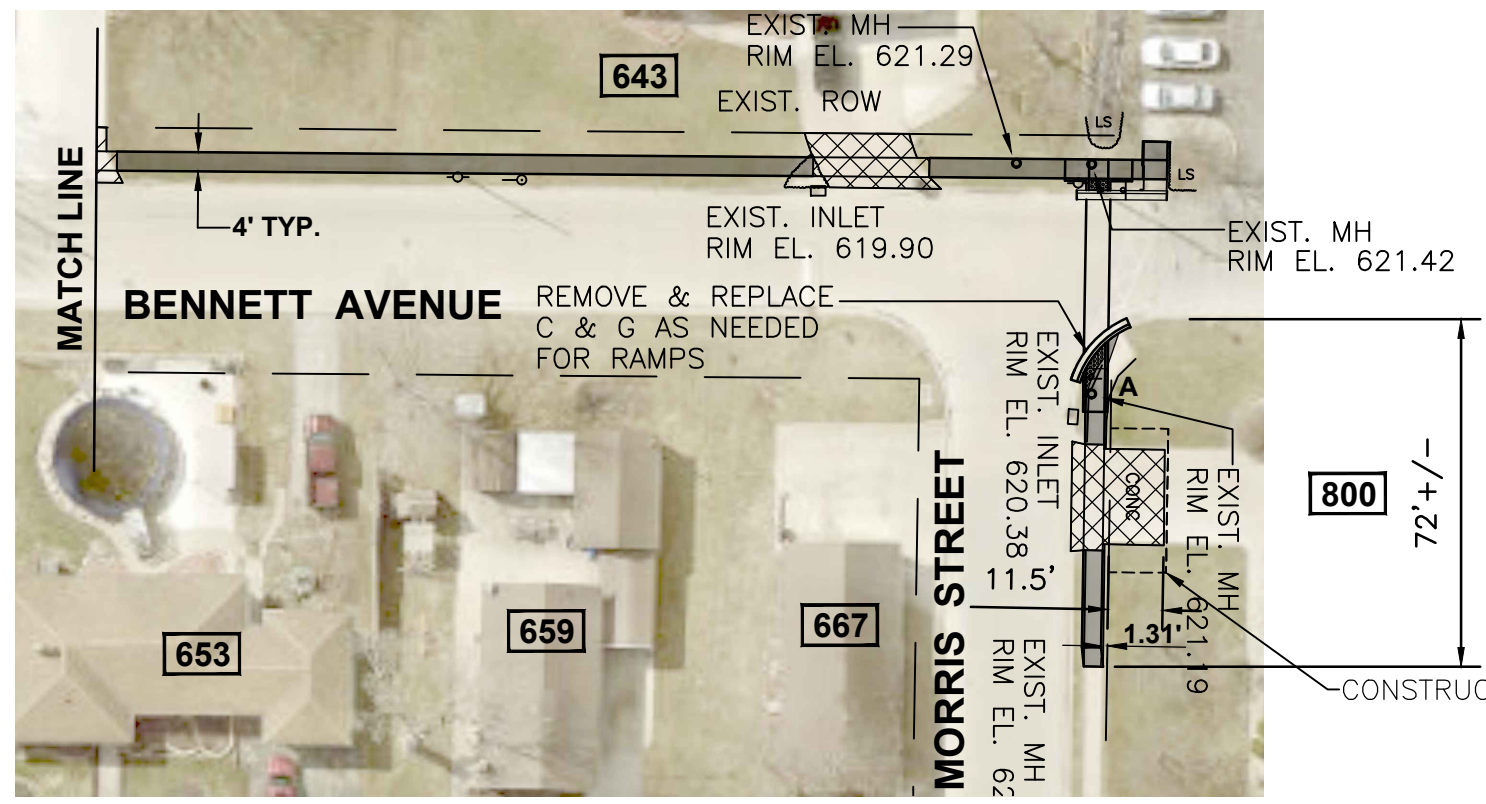

**LEGEND**

- PROPOSED SIDEWALK
- PROPOSED DRIVEWAY
- A** MANHOLE OR INLET TO BE ADJUSTED

**"CONTRACT NO. 87871"**

CHAMLIN & ASSOCIATES, INC. © 2022  
Drawing Name: G:\Users\jkc\OneDrive\Documents\2021-SRTS\CAD\011-BENNETT.dwg Last Modified: Thursday, May 15, 2025 6:39:56 PM Plotted On: Thursday, May 15, 2025 6:42:49 PM by Debbie Story

DRAWN BY: DS	REVISIONS			
	LEVEL	BY	DATE	DESCRIPTION
CHECKED BY: JKC				
DATE: 07/2022				



**OGLESBY SAFE ROUTES TO SCHOOL**  
SECTION 22-00042-00-SW  
OGLESBY, ILLINOIS

**PLAN**

<b>CONSTRUCTION PLANS</b>	CURRENT AS OF: 03/24/2025	
	SCALE: AS NOTED	SHEET 11
	FILE NO.: 66393.00 Y-	OF 21

CHAMLIN & ASSOCIATES, INC. © 2022  
 Drawing Name: G:\Users\G66393-00\OneDrive - Oglesby\2021-SRTE\CAD\012-MORRIS.dwg Last Modified: Thursday, April 24, 2025 7:41:54 AM Plotted On: Tuesday, May 6, 2025 8:53:02 PM by Debbie Story

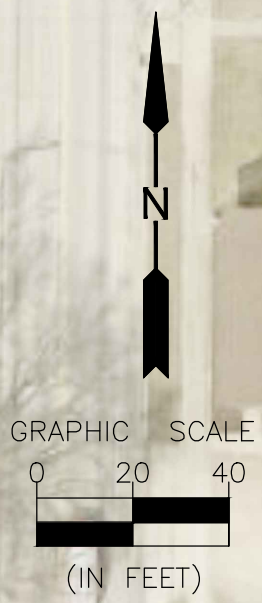
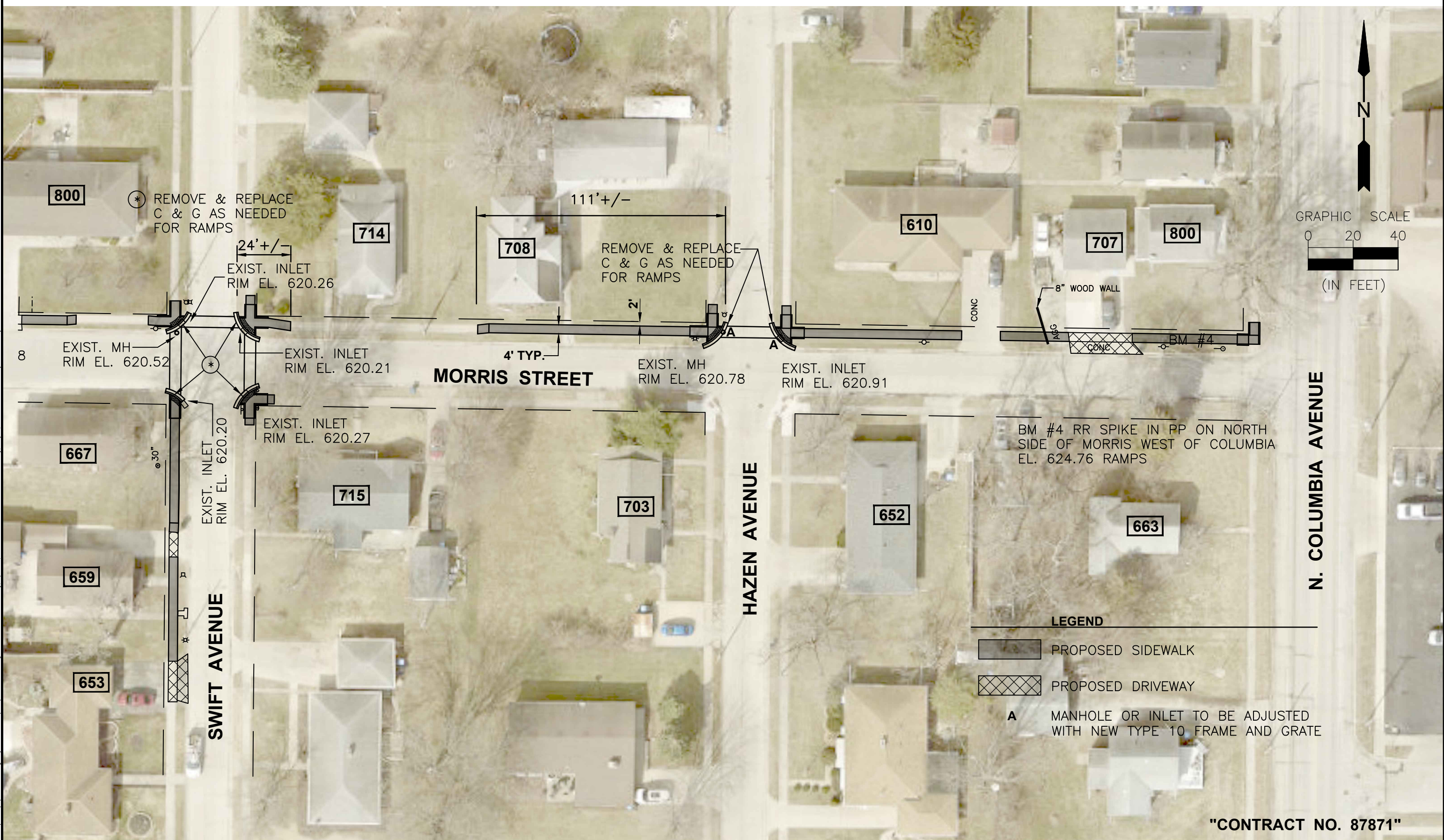

- LEGEND**
- PROPOSED SIDEWALK
  - PROPOSED DRIVEWAY
  - A** MANHOLE OR INLET TO BE ADJUSTED WITH NEW TYPE 10 FRAME AND GRATE

**"CONTRACT NO. 87871"**

DRAWN BY: DS	REVISIONS			
CHECKED BY: JKC	LEVEL	BY	DATE	DESCRIPTION
DATE: 07/2022				

PERU MORRIS  
OTTAWA MENDOTA  
ILLINOIS

**OGLESBY SAFE ROUTES TO SCHOOL  
SECTION 22-00042-00-SW  
OGLESBY, ILLINOIS**

**PLAN**

<b>CONSTRUCTION PLANS</b>	CURRENT AS OF: 03/24/2025	
	SCALE: AS NOTED	SHEET 12
	FILE NO.: 66393.00 Y-	OF 21

CHAMLIN & ASSOCIATES, INC. © 2022  
 Drawing Name: G:\Users\jg6393\OneDrive - Chamlin & Associates\Documents\2021-00-Oglesby-2021-SRTE\CAD\013-INTER-DETAIL.dwg Last Modified: Sunday, May 04, 2025 1:17:29 PM Plotted On: Sunday, May 04, 2025 4:34:20 PM by Jim Clifford

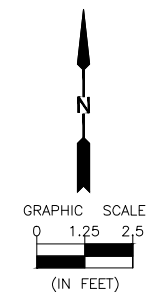

**SWIFT AVENUE**

**DURANT STREET**

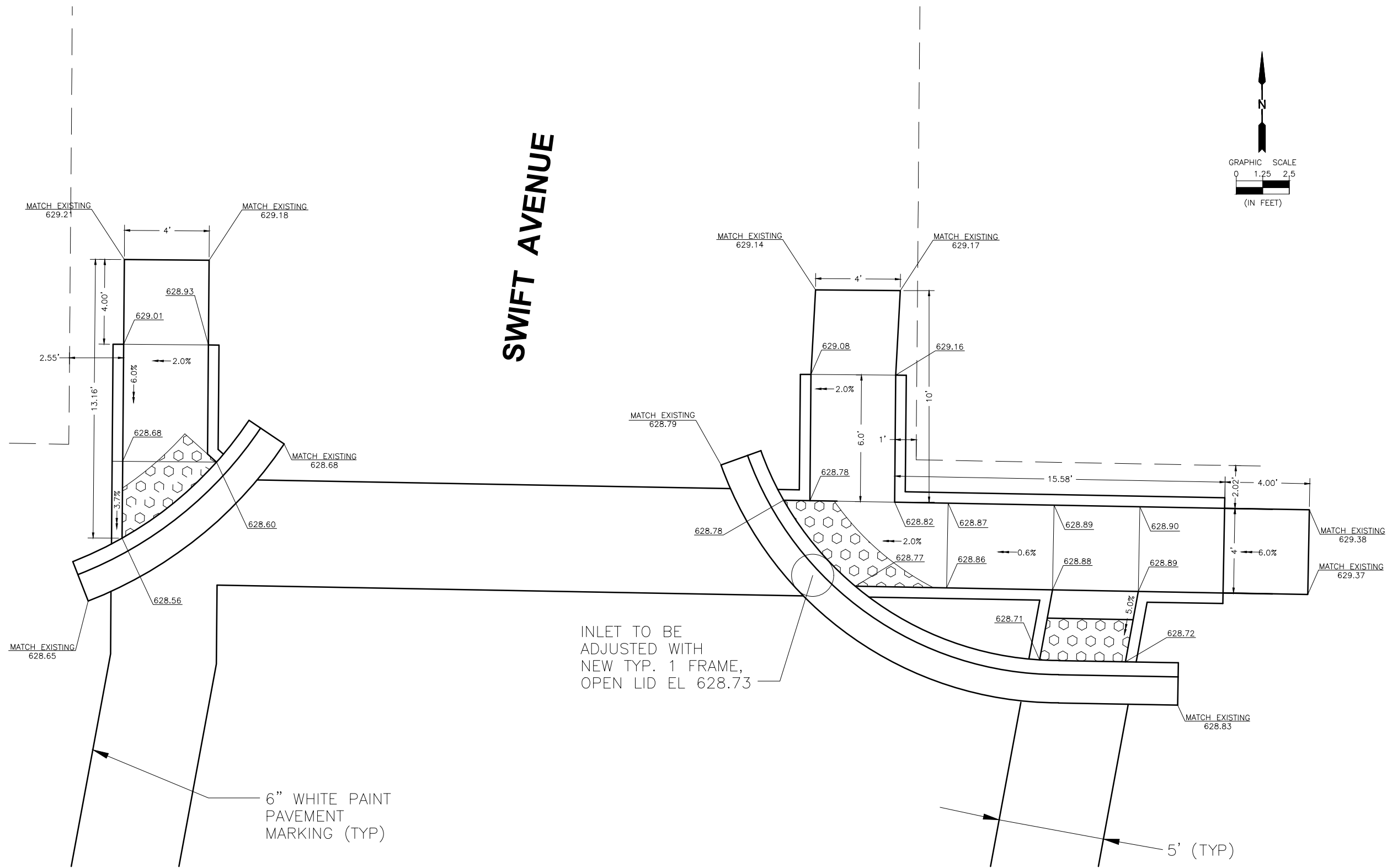

**"CONTRACT NO. 87871"**

DRAWN BY: LP	LEVEL	BY	DATE	REVISIONS	DESCRIPTION
CHECKED BY: CHECKED					
DATE: 10/31/22					

PERU MORRIS  
 OTTAWA MENDOTA  
 ILLINOIS

**OGLESBY SAFE ROUTES TO SCHOOL  
 SECTION 22-00042-00-SW  
 OGLESBY, ILLINOIS**

**INTERSECTION DETAILS**

**CONSTRUCTION PLANS**

CURRENT AS OF: 04/21/2025	
SCALE: AS NOTED	SHEET 13
FILE NO.: 66393.00 Y-	OF 21

# DURANT STREET

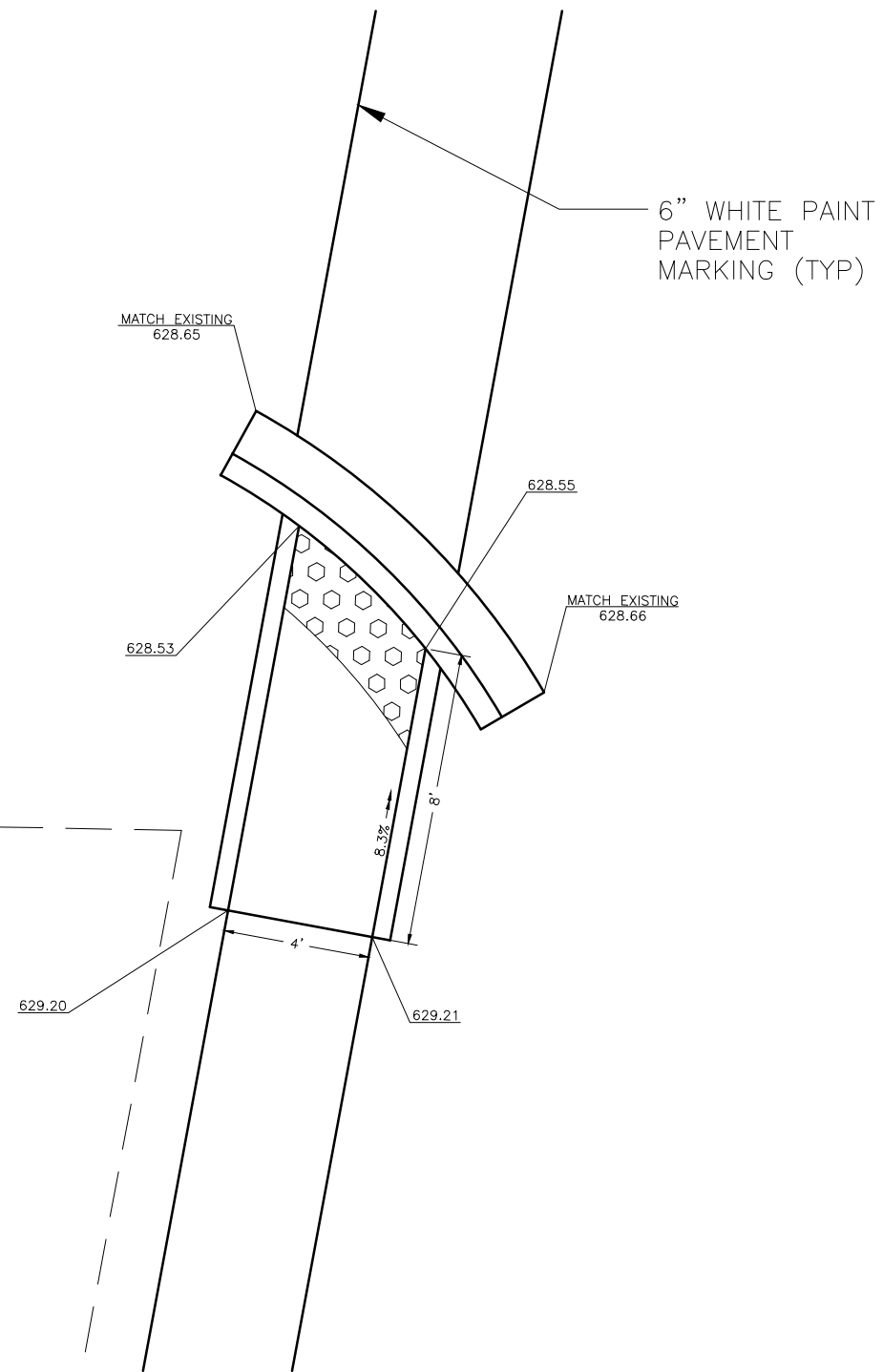

# SWIFT AVENUE

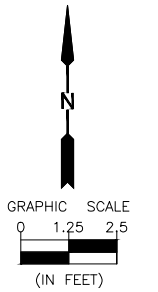
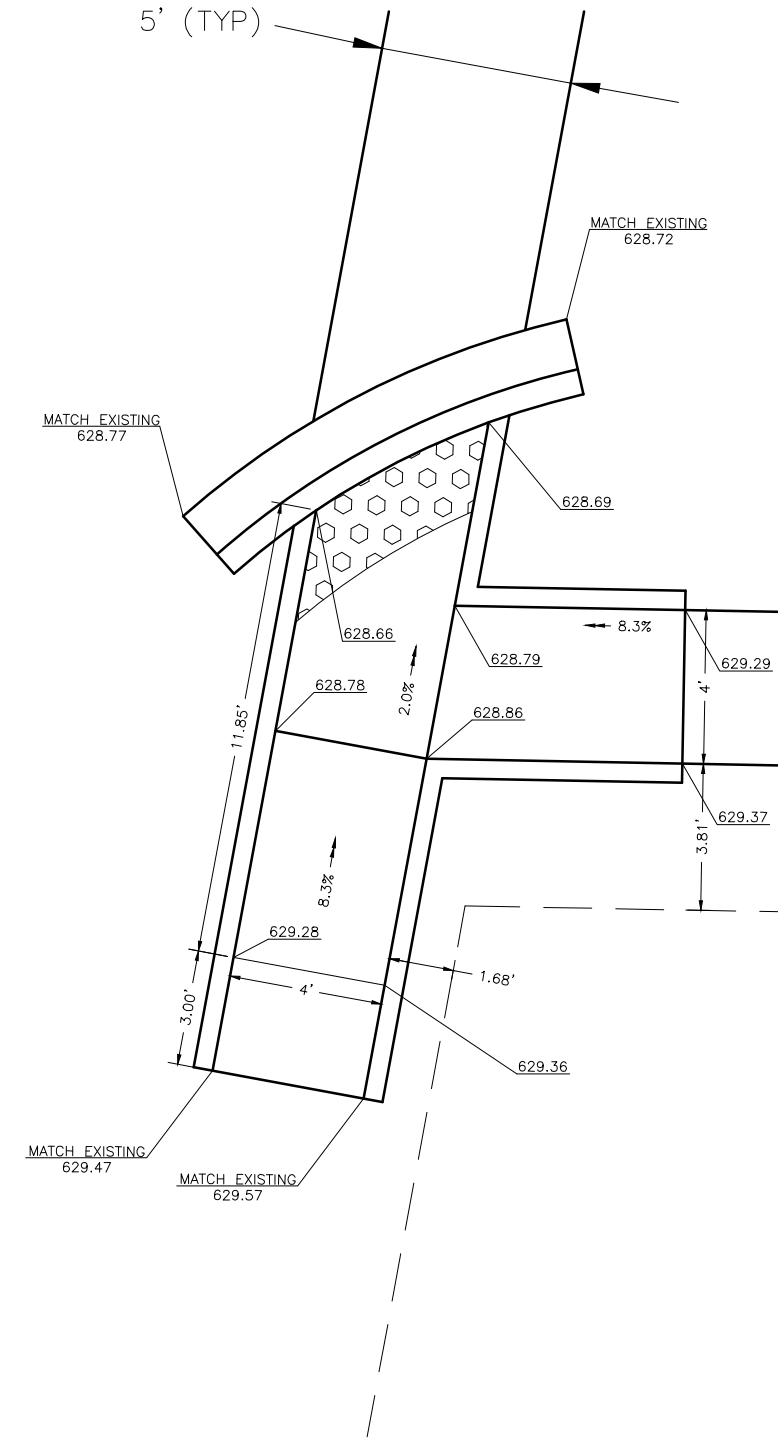

CHAMLIN & ASSOCIATES, INC. © 2022  
 Drawing Name: G:\Users\G66393-00-Oglesby-2021-SRTE\CAD\014-INTER-DETAIL.dwg Last Modified: Sunday, May 04, 2025 2:42:15 PM Plotted On: Sunday, May 04, 2025 2:43:25 PM by Jim Clifford

**"CONTRACT NO. 87871"**

LEVEL	BY	DATE	REVISIONS	DESCRIPTION

PERU MORRIS  
 OTTAWA MENDOTA  
 ILLINOIS

**OGLESBY SAFE ROUTES TO SCHOOL**  
**SECTION 22-00042-00-SW**  
**OGLESBY, ILLINOIS**

**INTERSECTION DETAILS**

<b>CONSTRUCTION PLANS</b>	CURRENT AS OF: 04/21/2025	SHEET 14
	SCALE: AS NOTED	OF 21
	FILE NO.: 66393.00 Y-	

CHAMLIN & ASSOCIATES, INC. © 2022  
 Drawing Name: G:\Users\A\66593-06-Oglesby-2021-SRTS\CAD\15-INTER-DETAIL.dwg Last Modified: Sunday, May 04, 2025 3:45:28 PM Plotted On: Sunday, May 04, 2025 4:30:20 PM by Jim Clindorf

# SWIFT AVENUE

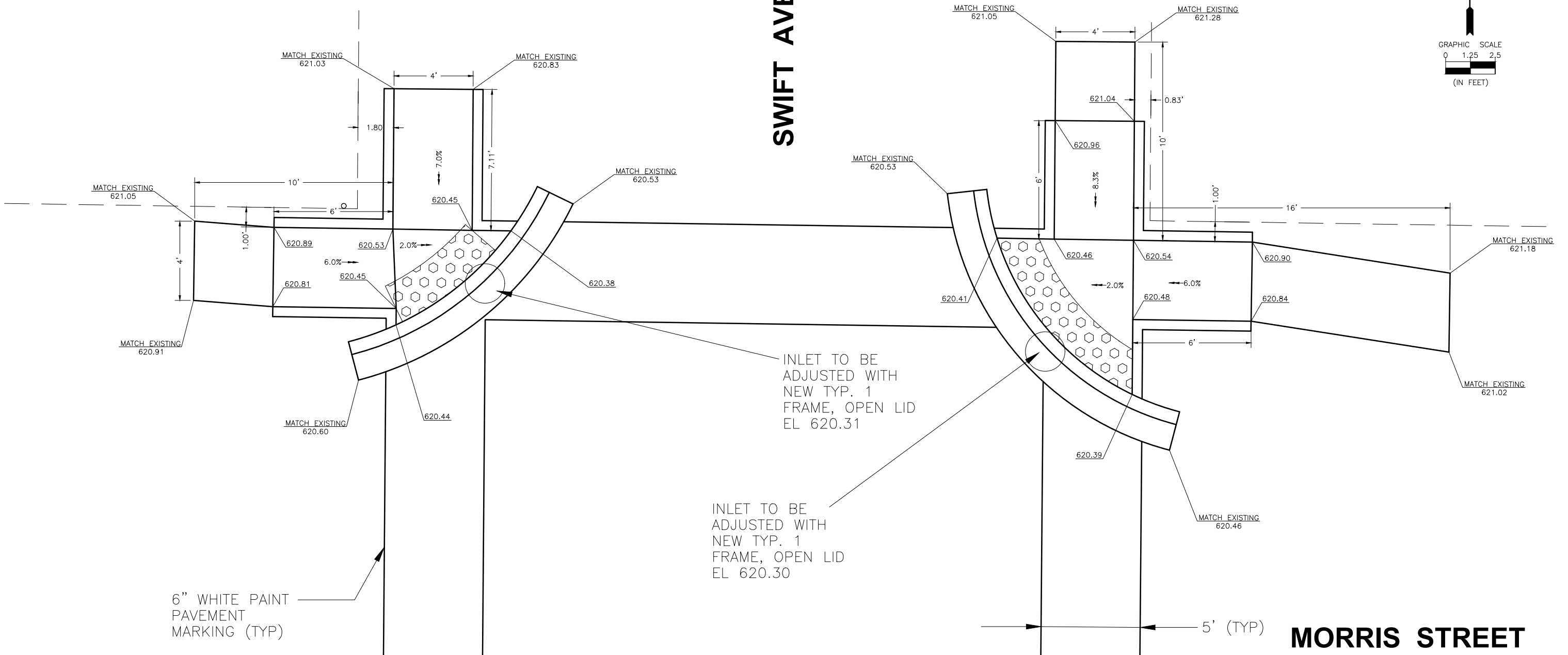
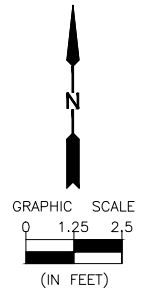

# MORRIS STREET

**"CONTRACT NO. 87871"**

DRAWN BY: LP	LEVEL	BY	DATE	REVISIONS	DESCRIPTION
CHECKED BY: CHECKED					
DATE: 10/31/22					



PERU MORRIS  
 OTTAWA MENDOTA  
 ILLINOIS

**OGLESBY SAFE ROUTES TO SCHOOL  
 SECTION 22-00042-00-SW  
 OGLESBY, ILLINOIS**

**INTERSECTION DETAILS**

<b>CONSTRUCTION PLANS</b>	CURRENT AS OF: 03/24/2025	
	SCALE: AS NOTED	SHEET 15
	FILE NO.: 66393.00 Y-	OF 21

CHAMLIN & ASSOCIATES, INC. © 2022  
 Drawing Name: G:\Users\A\66393-06-Oglesby-2021-SRTS\CAD\16-INTER-DETAIL.dwg Last Modified: Sunday, May 04, 2025 4:20:12 PM Plotted On: Sunday, May 04, 2025 4:28:14 PM by Jim Clifford

# MORRIS STREET

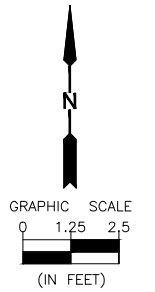

6" WHITE PAINT  
PAVEMENT  
MARKING (TYP)

MATCH EXISTING  
620.57

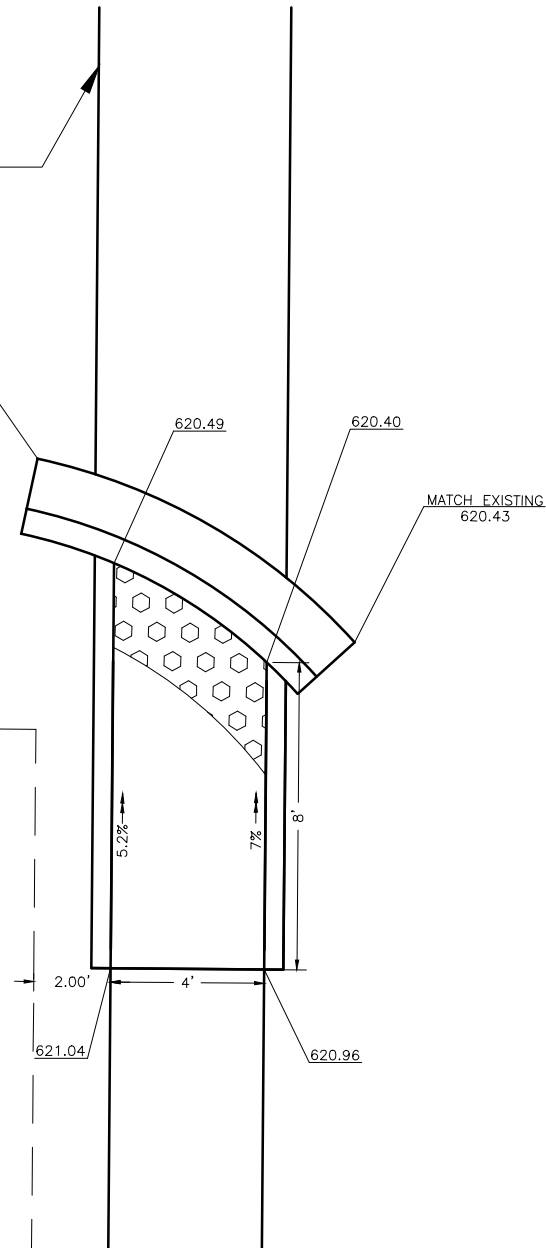

INLET TO BE  
ADJUSTED WITH  
NEW TYP. 1  
FRAME OPEN LID  
EL. 620.27

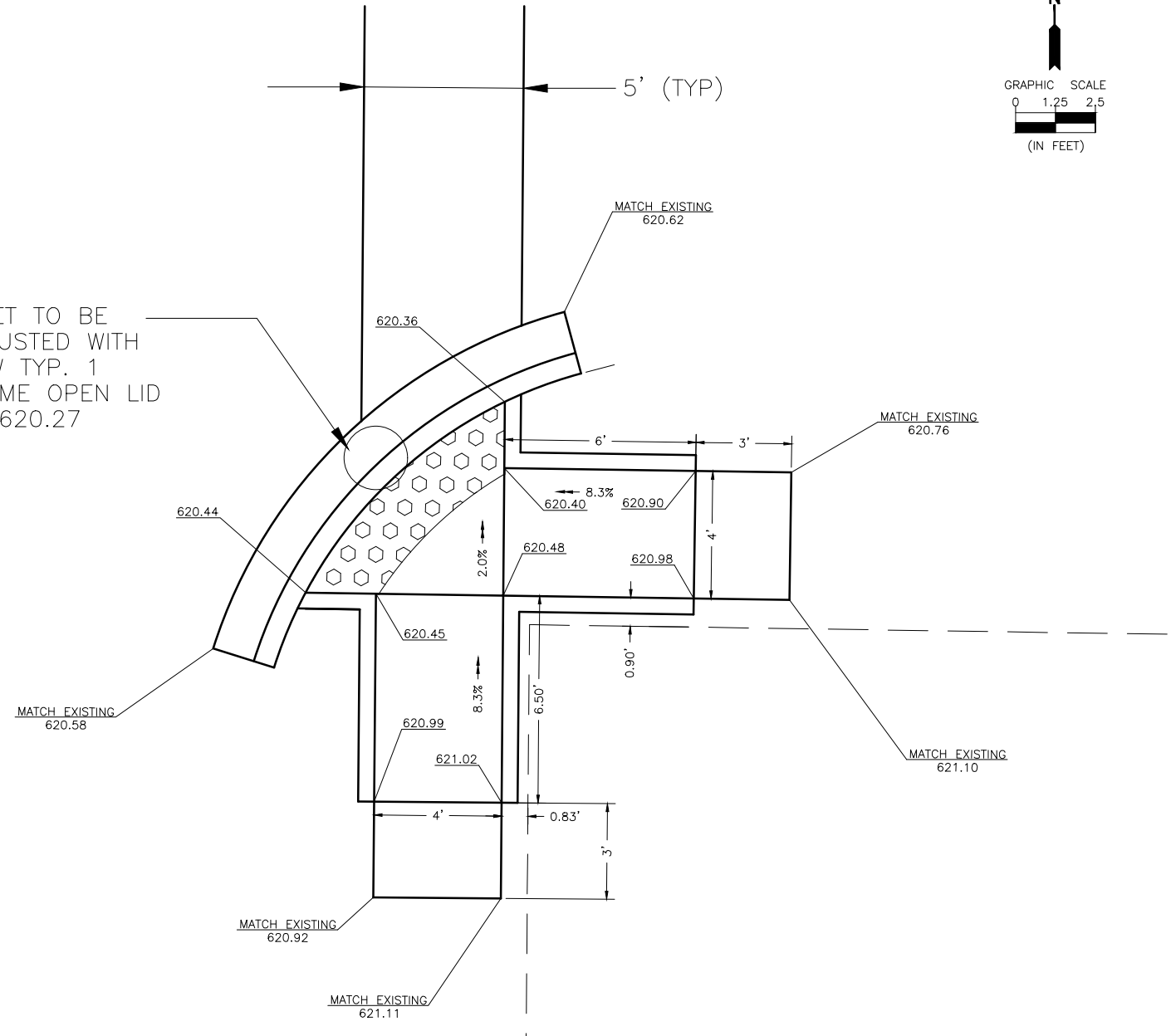

# SWIFT AVENUE

"CONTRACT NO. 87871"

LEVEL	BY	DATE	REVISIONS	DESCRIPTION



PERU MORRIS  
OTTAWA MENDOTA  
ILLINOIS

OGLESBY SAFE ROUTES TO SCHOOL  
SECTION 22-00042-00-SW  
OGLESBY, ILLINOIS

INTERSECTION DETAILS

CONSTRUCTION  
PLANS

CURRENT AS OF: 03/24/2025	SHEET 16
SCALE: AS NOTED	OF 21
FILE NO.: 66393.00 Y-	



CHAMLIN & ASSOCIATES, INC. © 2022  
 Drawing Name: G:\Users\G66393-00-Oglesby-2021-SRTE\CAD\017-INTER-DETAIL.dwg Last Modified: Sunday, May 04, 2025 5:31:13 PM Plotted On: Sunday, May 04, 2025 5:31:36 PM by Jim Clifford

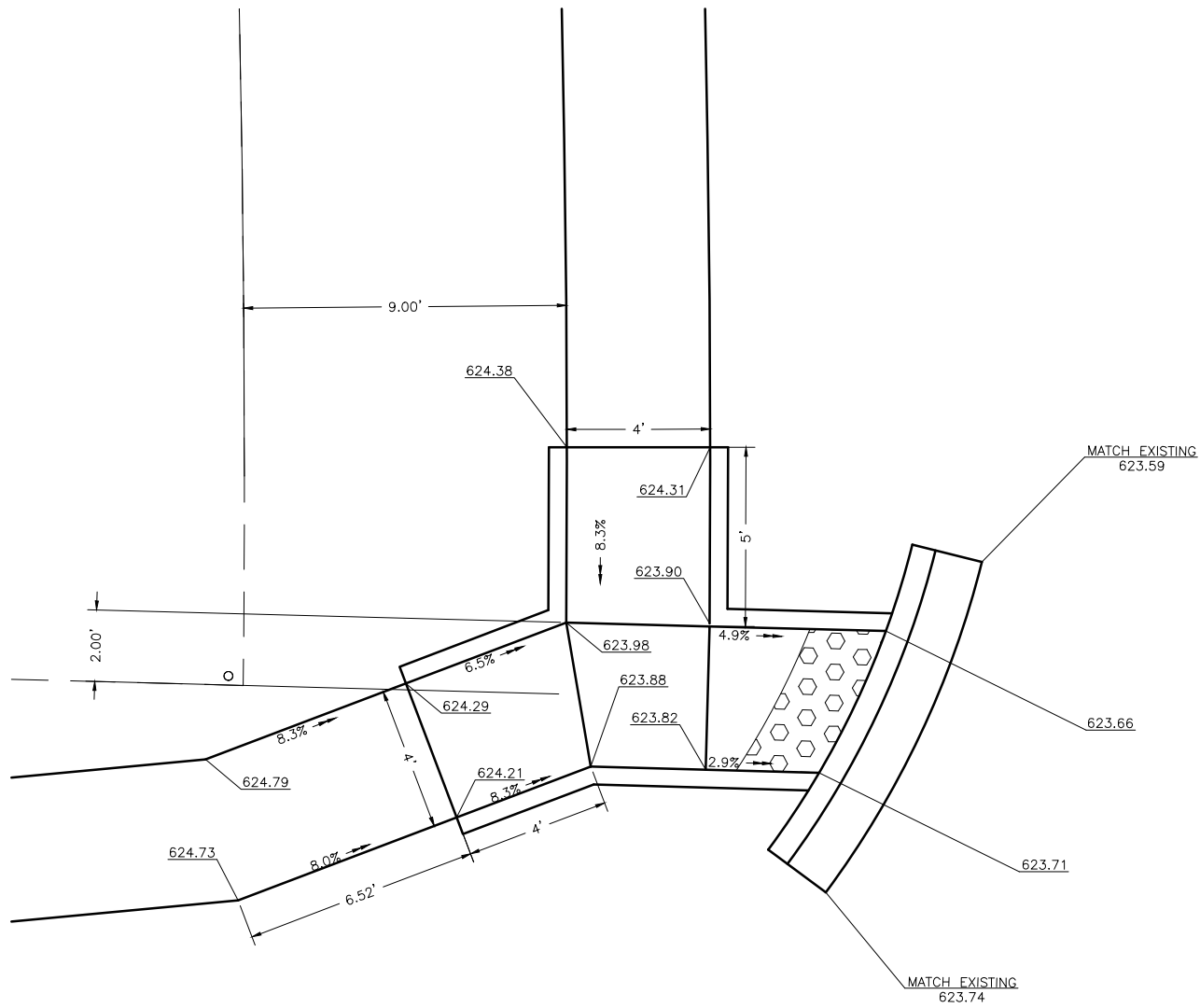

# CLARK STREET

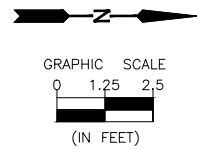
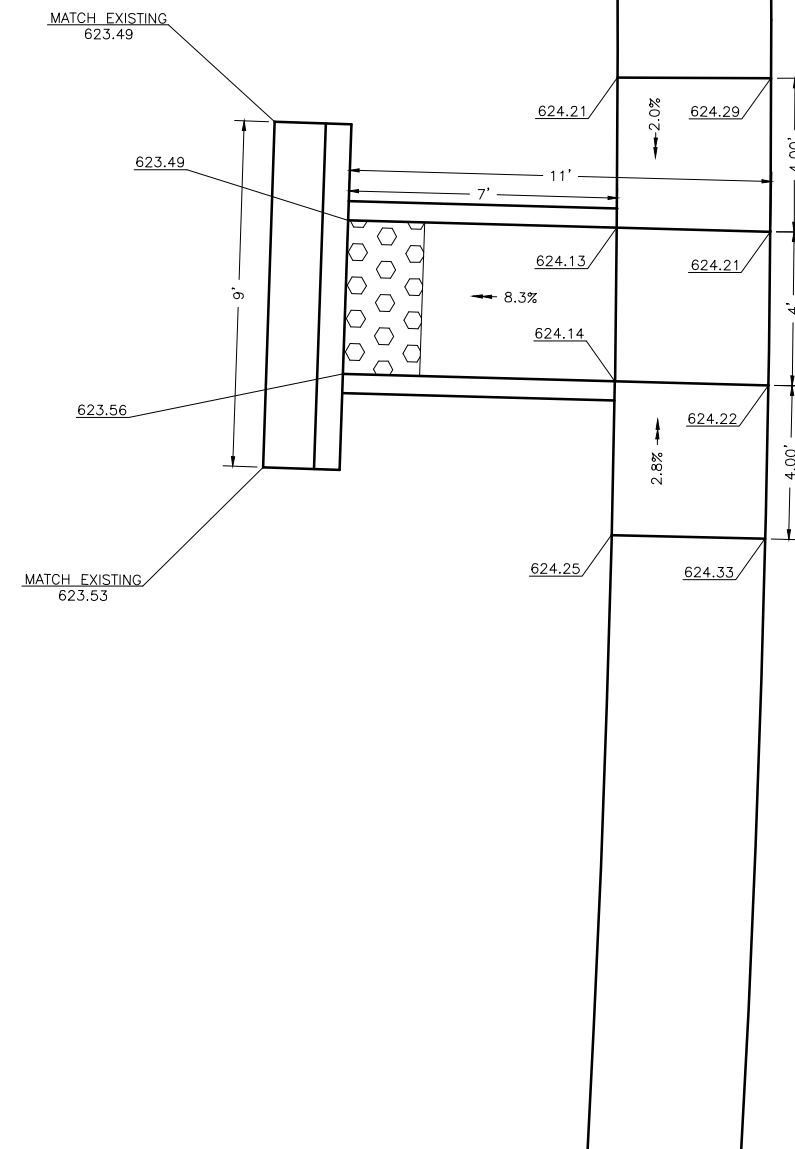

# OAKWOOD AVENUE

**"CONTRACT NO. 87871"**

DRAWN BY: LP	REVISIONS			
	LEVEL	BY	DATE	DESCRIPTION
CHECKED BY: CHECKED				
DATE: 10/31/22				

PERU MORRIS  
 OTTAWA MENDOTA  
 ILLINOIS

**OGLESBY SAFE ROUTES TO SCHOOL**  
**SECTION 22-00042-00-SW**  
**OGLESBY, ILLINOIS**

**INTERSECTION DETAILS**

<b>CONSTRUCTION PLANS</b>	CURRENT AS OF: 03/24/2025	
	SCALE: AS NOTED	SHEET 17
	FILE NO.: 66393.00 Y-	OF 21

CHAMLIN & ASSOCIATES, INC. © 2022  
 Drawing Name: G:\Users\G66393-00-Oglesby-2021-SRTE\CAD\018-INTER-DETAIL.dwg Last Modified: Monday, May 05, 2025 2:04:34 PM Plotted On: Monday, May 05, 2025 2:08:37 PM by Jim Clinard

# HAZEN AVENUE

# MORRIS STREET

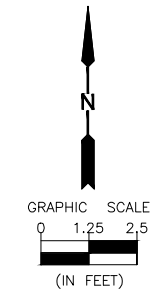
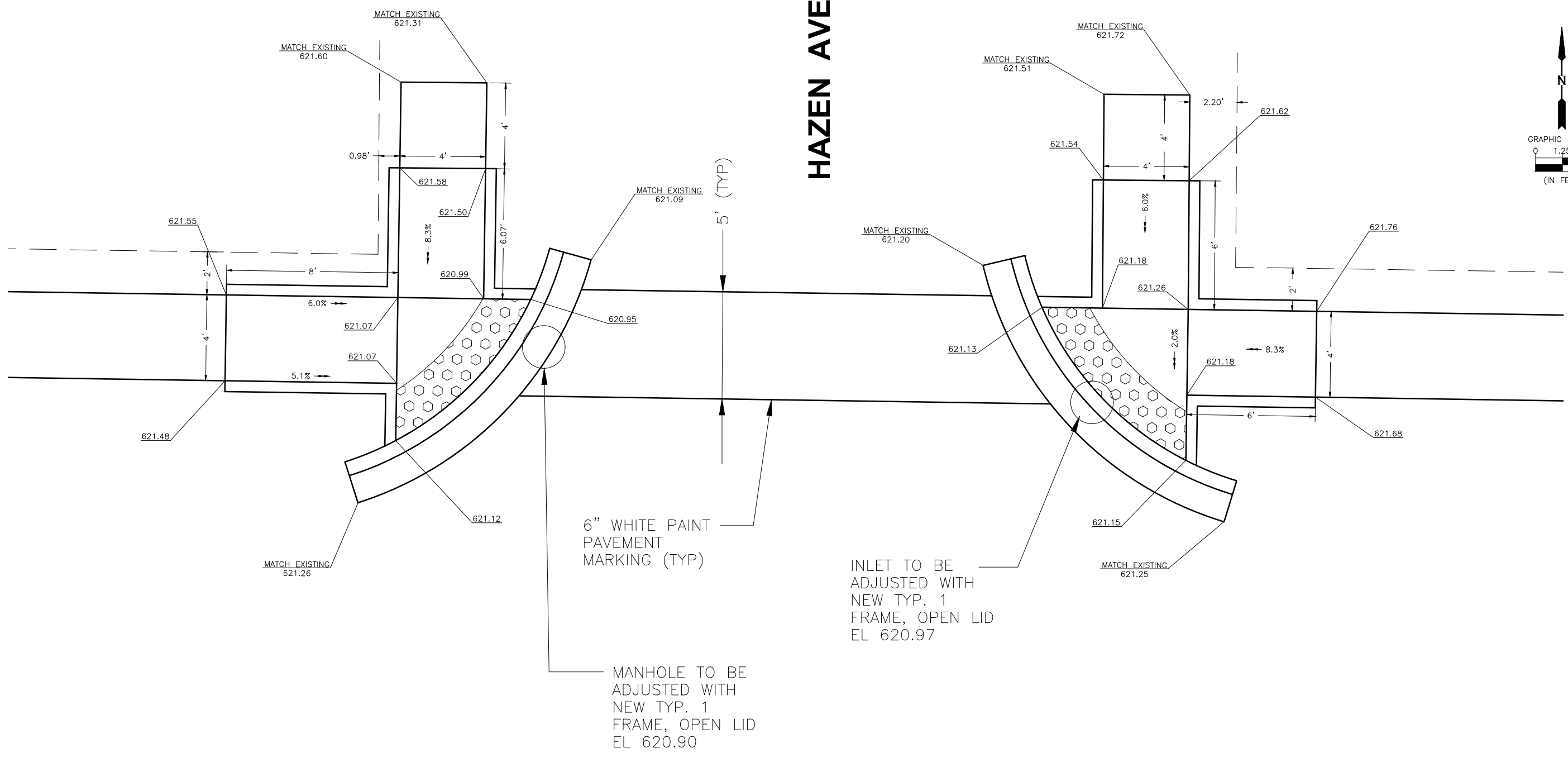

**"CONTRACT NO. 87871"**

DRAWN BY: LP	LEVEL	BY	DATE	REVISIONS	DESCRIPTION
CHECKED BY: CHECKED					
DATE: 10/31/22					

PERU MORRIS  
 OTTAWA MENDOTA  
 ILLINOIS

**OGLESBY SAFE ROUTES TO SCHOOL  
 SECTION 22-00042-00-SW  
 OGLESBY, ILLINOIS**

**INTERSECTION DETAILS**

<b>CONSTRUCTION PLANS</b>	CURRENT AS OF: 03/24/2025	
	SCALE: AS NOTED	SHEET 18
	FILE NO.: 66393.00 Y-	OF 21

CHAMLIN & ASSOCIATES, INC. © 2022  
 Drawing Name: G:\Users\G66393-00-Oglesby-2021-SRTE\CAD\019-INTER-DETAIL.dwg Last Modified: Monday, May 05, 2025 3:07:47 PM Plotted On: Monday, May 05, 2025 3:25:23 PM by Jim Clined

# CLARK STREET

# SWIFT AVENUE

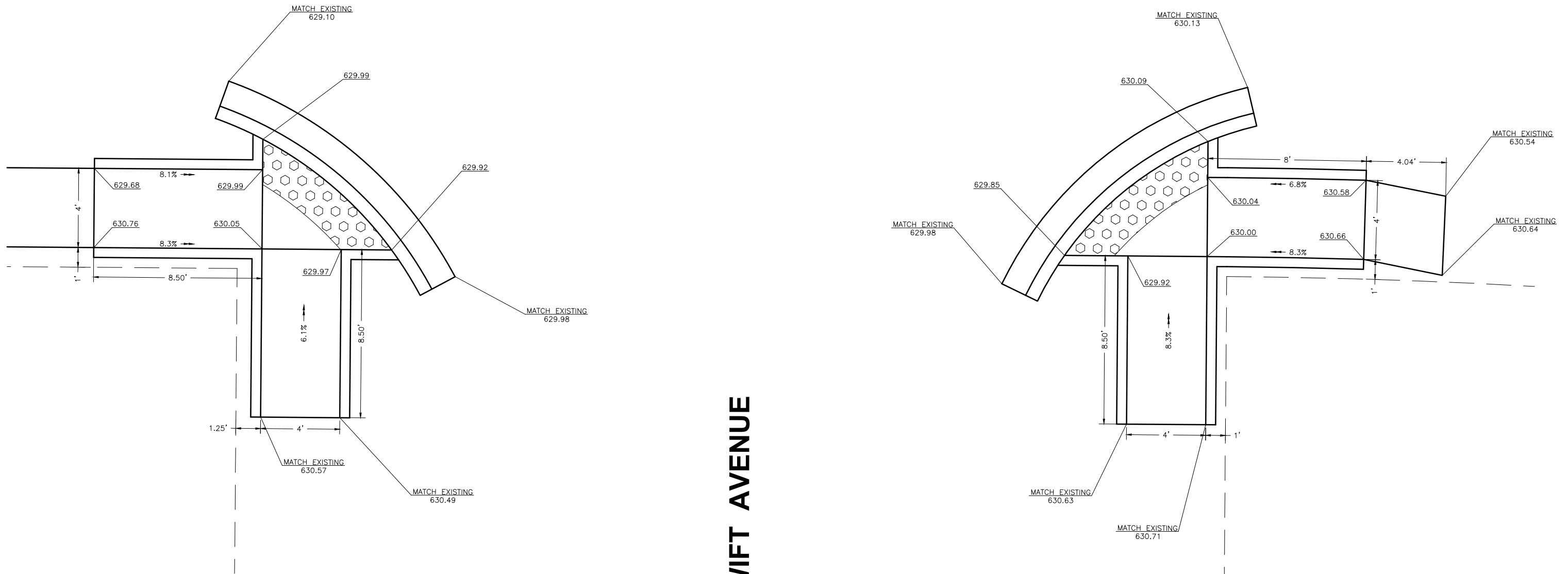
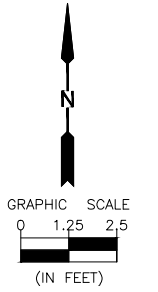

**"CONTRACT NO. 87871"**

LEVEL	BY	DATE	REVISIONS	DESCRIPTION



PERU MORRIS  
 OTTAWA MENDOTA  
 ILLINOIS

**OGLESBY SAFE ROUTES TO SCHOOL  
 SECTION 22-00042-00-SW  
 OGLESBY, ILLINOIS**

**INTERSECTION DETAILS**

**CONSTRUCTION  
 PLANS**

CURRENT AS OF: 04/21/2025	
SCALE: AS NOTED	SHEET 19
FILE NO.: 66393.00 Y-	OF 21

CHAMLIN & ASSOCIATES, INC. © 2022  
 Drawing Name: G:\Users\G6393\OneDrive - Chamlin & Associates, Inc.\Documents\2021-2022\Oglesby\2021-SRRTS\CAD\020-INTER-DETAIL.dwg Last Modified: Tuesday, May 06, 2025 9:55:26 AM Plotted On: Tuesday, May 06, 2025 9:58:59 AM by Jim Clinard

**SWIFT AVENUE**

**CLARK STREET**

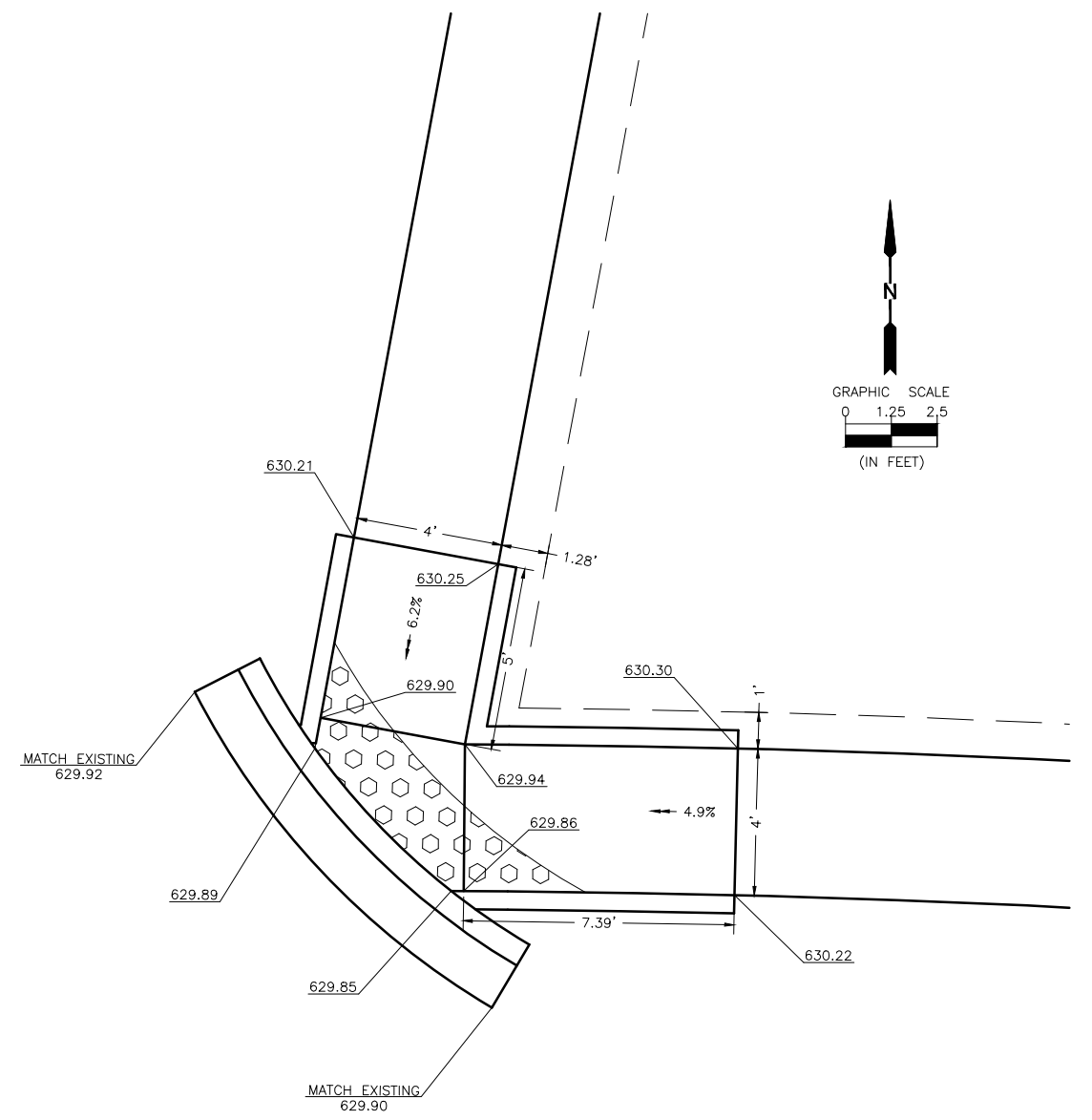
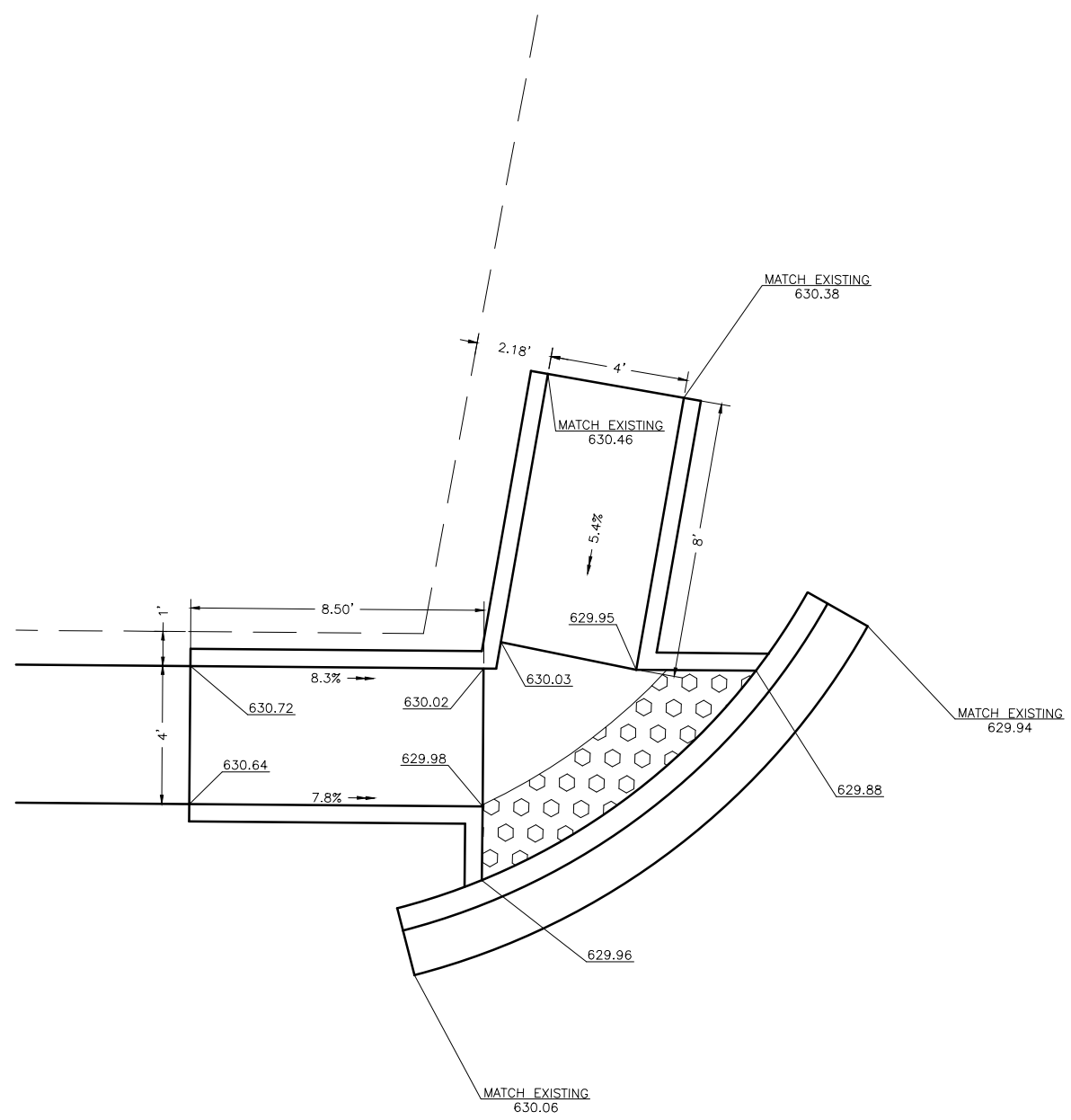

DRAWN BY: LP	REVISIONS			
CHECKED BY: CHECKED	LEVEL	BY	DATE	DESCRIPTION
DATE: 10/31/22				



PERU MORRIS  
OTTAWA MENDOTA  
ILLINOIS

**OGLESBY SAFE ROUTES TO SCHOOL**  
**SECTION 22-00042-00-SW**  
**OGLESBY, ILLINOIS**

**INTERSECTION DETAILS**

**"CONTRACT NO. 87871"**

**CONSTRUCTION PLANS**

CURRENT AS OF: 04/21/2025	
SCALE: AS NOTED	SHEET 20
FILE NO.: 66393.00 Y-	OF 21

CHAMLIN & ASSOCIATES, INC. © 2022  
 Drawing Name: G:\Users\G66393-00\Oglesby-2021-SRTE\CAD\021-INTER-DETAIL.dwg Last Modified: Thursday, May 15, 2025 7:44:45 PM by Jim Clinard  
 Plotted On: Thursday, May 15, 2025 7:42:30 PM

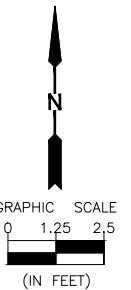

# BENNETT AVENUE

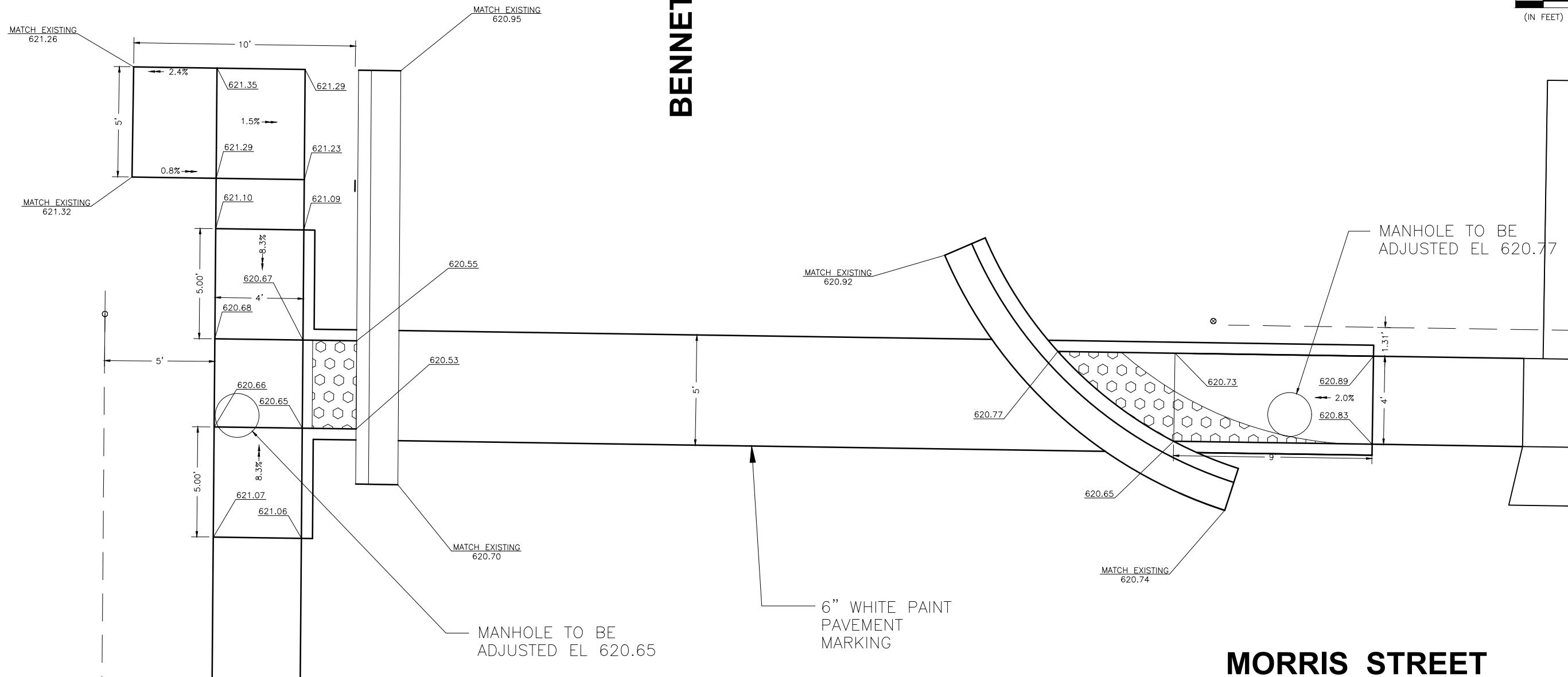

# MORRIS STREET

**"CONTRACT NO. 87871"**

DRAWN BY: LP	REVISIONS			
	LEVEL	BY	DATE	DESCRIPTION
CHECKED BY: CHECKED				
DATE: 10/31/22				

PERU MORRIS  
OTTAWA MENDOTA  
ILLINOIS

**OGLESBY SAFE ROUTES TO SCHOOL  
SECTION 22-00042-00-SW  
OGLESBY, ILLINOIS**

**INTERSECTION DETAILS**

<b>CONSTRUCTION PLANS</b>	CURRENT AS OF: 03/24/2025	
	SCALE: AS NOTED	SHEET 21
	FILE NO.: 66393.00 Y-	OF 21