

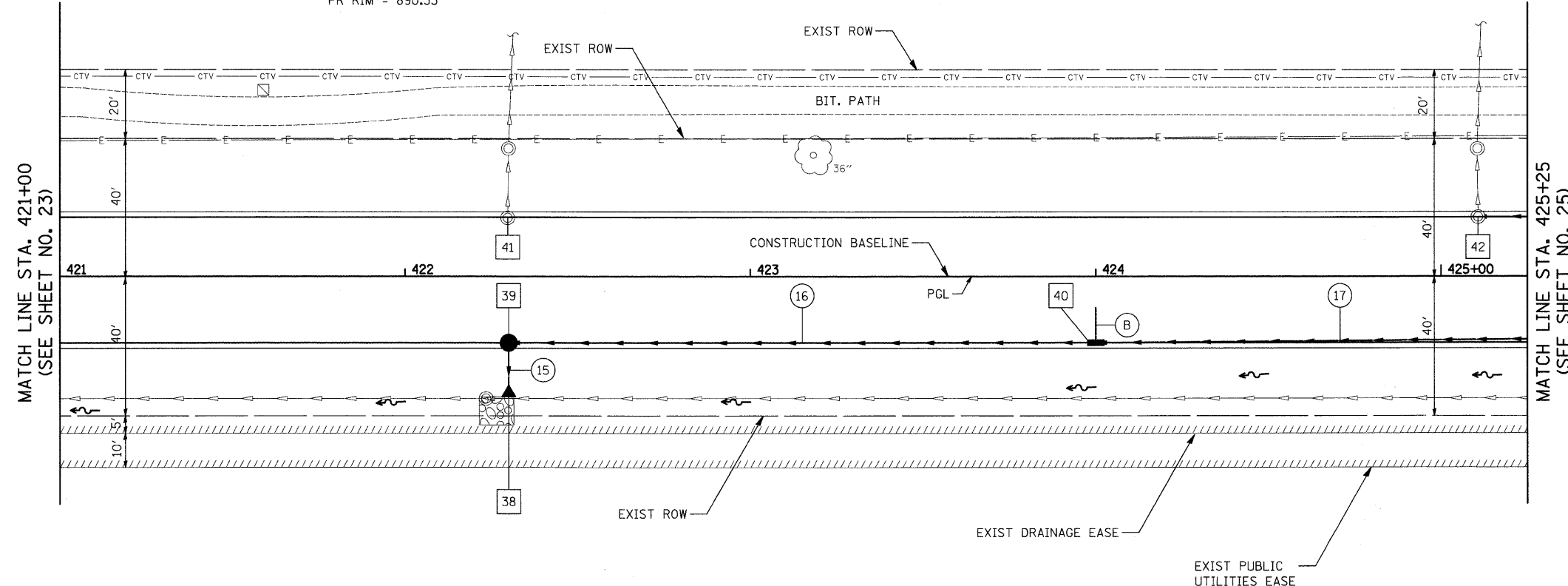

- 38 STA. 422+30, 34.7' RT.
PRC FLAR END SEC 12"
INV = 887.05 (12" N)
- 39 STA. 422+30, 19.0' RT.
RD CB 4 DIA T11F&G
RIM = 890.17
INV = 887.27 (12" E)
INV = 887.17 (12" S)
- 40 STA. 424+00, 19.0' RT.
RD INLETS TB T11F&G
RIM = 891.73
INV = 888.52 (12" W)
INV = 888.62 (12" E)
- 41 STA. 422+29.72, 16.83' LT.
CB ADJUST
EX RIM = 889.52
PR RIM = 890.33
- 42 STA. 425+10.71, 17.06' LT.
CB ADJUST
EX RIM = 891.88
PR RIM = 892.72
EX INV = 885.98 (12" N)
PR INV = 889.21 (12" E)



- 15 6' - STORM SEW CL A 1, 12" @ 1.00%
T.B.F. = 0.0 CU. YD.
- 16 167' - STORM SEW CL A 1, 12" @ 0.75%
T.B.F. = 22.1 CU. YD.
- 17 217' - STORM SEW CL A 1, 12" @ 0.50%
T.B.F. = 28.7 CU. YD.
- B 9' - P UNDR FAB LINE TR, 4"

REED ROAD

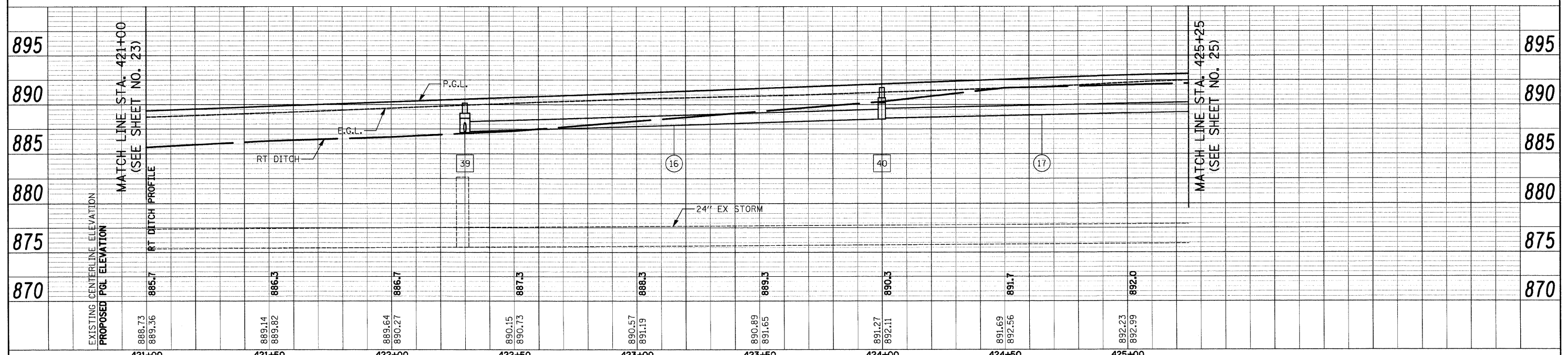

FILE NAME = J:\2213\road\sheet\2213.D&U.05.dgn	USER NAME = ead	DESIGNED - EAD	REVISED -	STATE OF ILLINOIS	REED ROAD - DRAINAGE AND UTILITIES	F.A.U. RTE. 4075	SECTION 08-00032-00-RS	COUNTY MCHENRY	TOTAL SHEETS 49	SHEET NO. 24
PLOT SCALE = 20.0000' / IN. PLOT DATE = 5/1/2009				DEPARTMENT OF TRANSPORTATION		SCALE 1"=20'		SHEET NO. 5 OF SHEETS		STA. 421+00 TO STA. 425+25
CHECKED - DNM DATE - 5/1/09				REVISIONS: REVISIONS - REVISIONS - REVISIONS -		FED. ROAD DIST. NO. ILLINOIS FED. AID PROJECT CONTRACT NO. 63193				

PLAN	SURVEYED	BY	DATE
NO.	NO.		
PLOTTED / CHECKED REVISIONS / DATE CADD FILE NAME			

PROFILE	SURVEYED	BY	DATE
NO.	NO.		
PLOTTED / CHECKED REVISIONS / DATE STRUCTURE NOTATIONS CHKD			