

F.A.P. RTE.	SECTION	COUNTY	TOTAL SHEETS	SHE NO.
346	.	LAKE	469	69
STA.		TO STA.		
FED. ROAD DIST. NO. D-91-404-99		ILLINOIS	FED. AID PROJ. NO.	
• 125X-HB-(1&2) R-1		CONTRACT # 60		

DATE	BY
DATE	BY
DATE	BY
DATE	BY

DATE	BY
DATE	BY
DATE	BY
DATE	BY

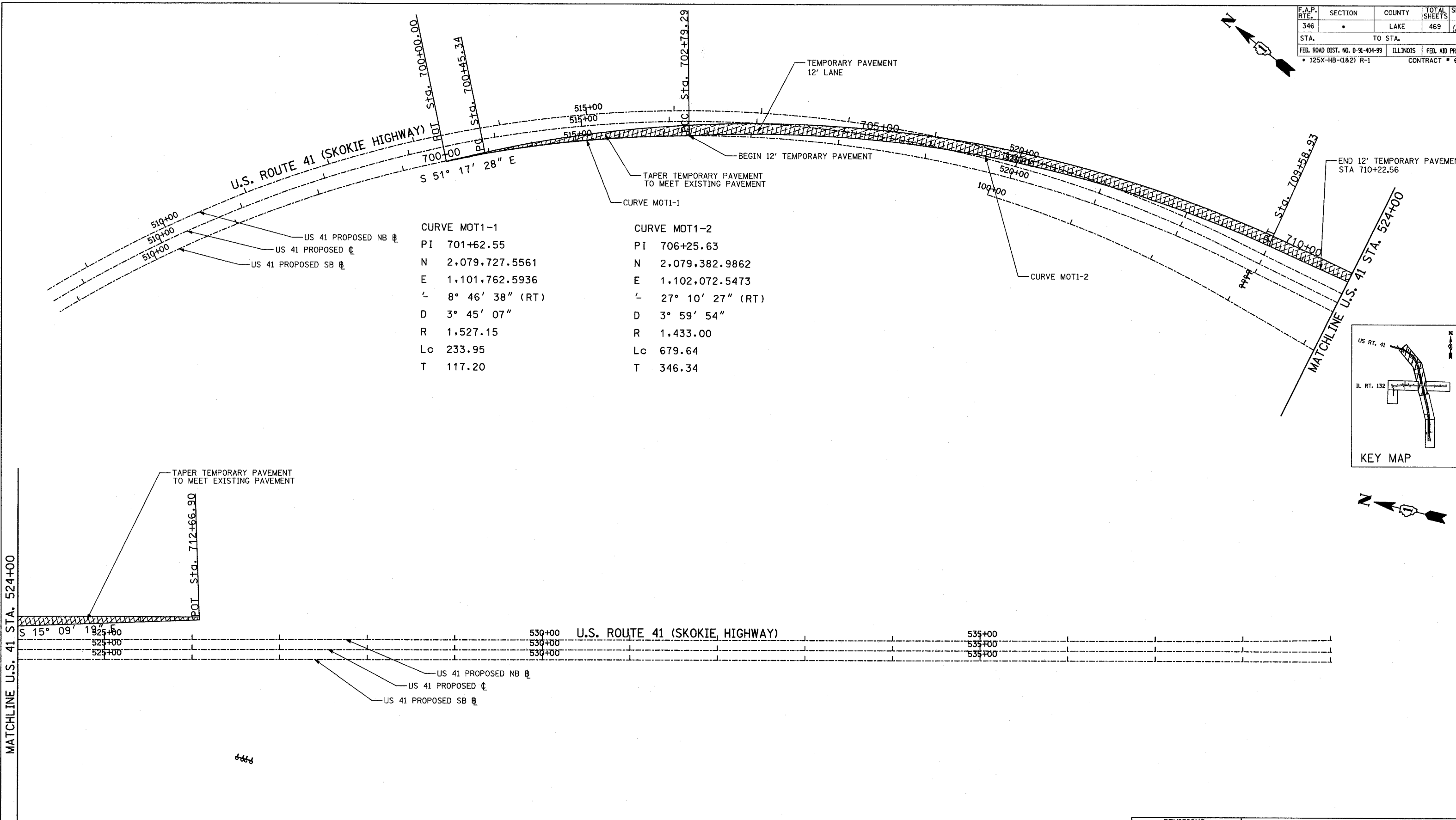

<b>CURVE MOT1-1</b>	<b>CURVE MOT1-2</b>
PI 701+62.55	PI 706+25.63
N 2,079,727.5561	N 2,079,382.9862
E 1,101,762.5936	E 1,102,072.5473
∠ 8° 46' 38" (RT)	∠ 27° 10' 27" (RT)
D 3° 45' 07"	D 3° 59' 54"
R 1.527.15	R 1.433.00
Lc 233.95	Lc 679.64
T 117.20	T 346.34

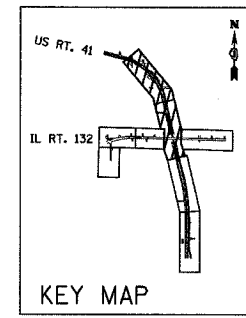

MATCHLINE U.S. 41 STA. 524+00

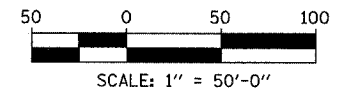
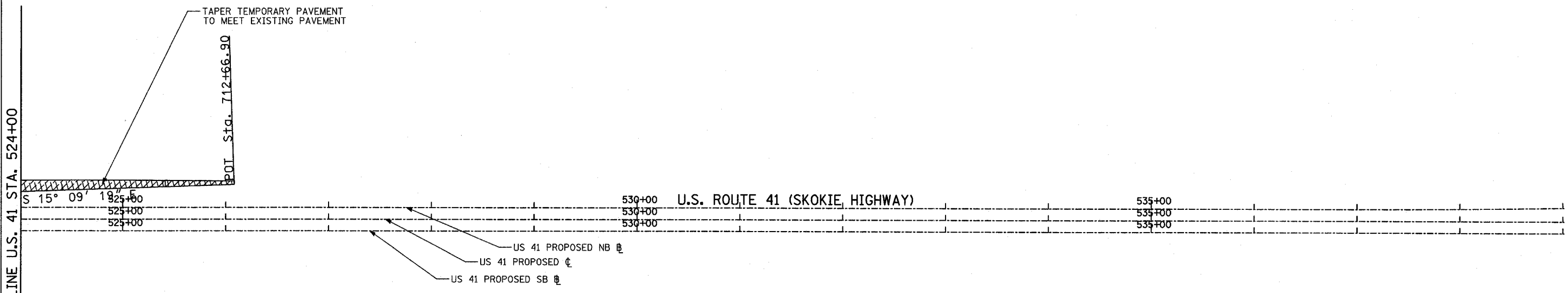

REVISIONS	
NAME	DATE

ILLINOIS DEPARTMENT OF TRANSPORTATION  
 U.S. 41 (SKOKIE HIGHWAY)  
 AT IL ROUTE 132  
 TRAFFIC CONTROL STAGING  
 TEMPORARY PAVEMENT ALIGNMENT  
 STAGE 1

SCALE: 1"=50'

DATE: MAY 12, 2008

DRAWN BY:

CHECKED BY: