

STATE OF ILLINOIS  
DEPARTMENT OF TRANSPORTATION

F.A.P. RTE.	SECTION	COUNTY	TOTAL SHEETS	SHEET NO.
623	(31)CJS	LASALLE	7	1
		ILLINOIS	CONTRACT NO. 66L05	

**INDEX OF SHEETS**

- 1 COVER SHEET
- 2 GENERAL NOTES
- 3 SUMMARY OF QUANTITIES
- 4 TYPICAL SECTIONS
- 5 LINE DIAGRAM
- 6 SCHEDULES
- 7 DETAIL

**LIST OF ILLINOIS DOT HIGHWAY STANDARDS**

000001-07	STANDARD SYMBOLS, ABBREVIATIONS AND PATTERNS
001006	DECIMAL OF AN INCH AND OF A FOOT
701001-02	OFF-ROAD OPERATIONS 2L, 2W, MORE THAN 15' (4.5 m) AWAY
701006-05	OFF-ROAD OPERATIONS 2L, 2W, 15' (4.5 m) TO 24' (600 mm) FROM PAVEMENT EDGE
701301-04	LANE CLOSURE, 2L, 2W, SHORT TIME OPERATIONS
701306-04	LANE CLOSURE, 2L, 2W, SLOW MOVING OPERATIONS DAY ONLY, FOR SPEEDS $\geq$ 45 MPH
701311-03	LANE CLOSURE, 2L, 2W, MOVING OPERATIONS - DAY ONLY
701501-06	URBAN LANE CLOSURE, 2L, 2W, UNDIVIDED
701901-08	TRAFFIC CONTROL DEVICES

# PROPOSED HIGHWAY PLANS

FAP ROUTE 623 (US 6)  
SECTION (31)CJS  
PROJECT NHPP-QTX4(346)  
CRACK & JOINT SEALING  
LASALLE COUNTY

D-93-052-20

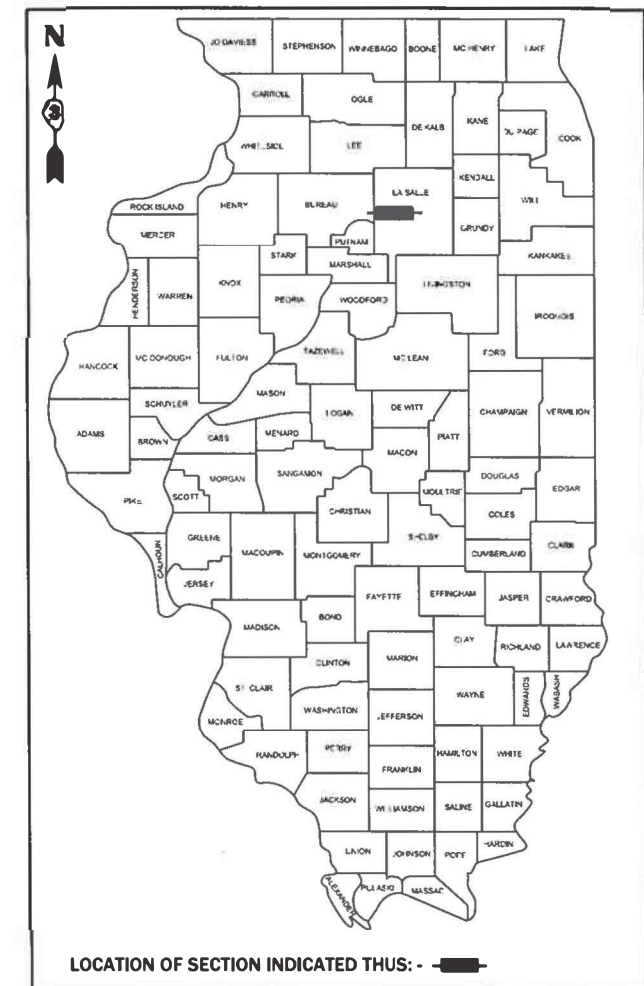

**FUNCTIONAL CLASSIFICATION**  
**OTHER ARTERIAL**  
**2019 ADT=6,150**  
**PV=81.1% SU=5.1% MU=13.8%**

STATE OF ILLINOIS  
DEPARTMENT OF TRANSPORTATION

SUBMITTED July 5th 20 2020  
[Signature] REGIONAL ENGINEER  
June 26, 2020  
[Signature] ENGINEER OF DESIGN AND ENVIRONMENT  
June 26, 2020  
[Signature] DIRECTOR OF HIGHWAYS PROJECT IMPLEMENTATION

**PRINTED BY THE AUTHORITY  
OF THE STATE OF ILLINOIS**

STA EQUATION  
STA 1087 + 87.75 BK =  
STA 70 + 43 AH

PROJECT BEGINS  
STA 1084 + 21.75

STATION EQUATION  
STA 162 + 25 BK =  
STA 171 + 72.10 AH

C-93-088-20

STATION EQUATION  
STA 252 + 00 BK =  
STA 266 + 39.71 AH

PROJECT ENDS  
STA 279 + 80

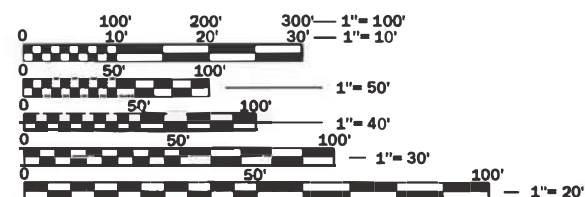

FULL SIZE PLANS HAVE BEEN PREPARED USING STANDARD ENGINEERING SCALES. REDUCED SIZED PLANS WILL NOT CONFORM TO STANDARD SCALES. IN MAKING MEASUREMENTS ON REDUCED PLANS, THE ABOVE SCALES MAY BE USED.

J.U.L.I.E.  
JOINT UTILITY LOCATION INFORMATION FOR EXCAVATION  
1-800-892-0123  
OR 811

PROJECT ENGINEER: JACOB OYIER, PE  
UNIT CHIEF: ARLENE OTERO-FEBUS  
DISTRICT 3 NO. (815) 434-6131  
CONTRACT NO. 66L05

CULVERT  
SN 050-2587  
STA 73 + 40

GROSS LENGTH = 18850 FT. = 3.57 MILE  
NET LENGTH = 18850 FT. = 3.57 MILE

CULVERT  
SN 050-2588

BRIDGE  
SN 050-0115

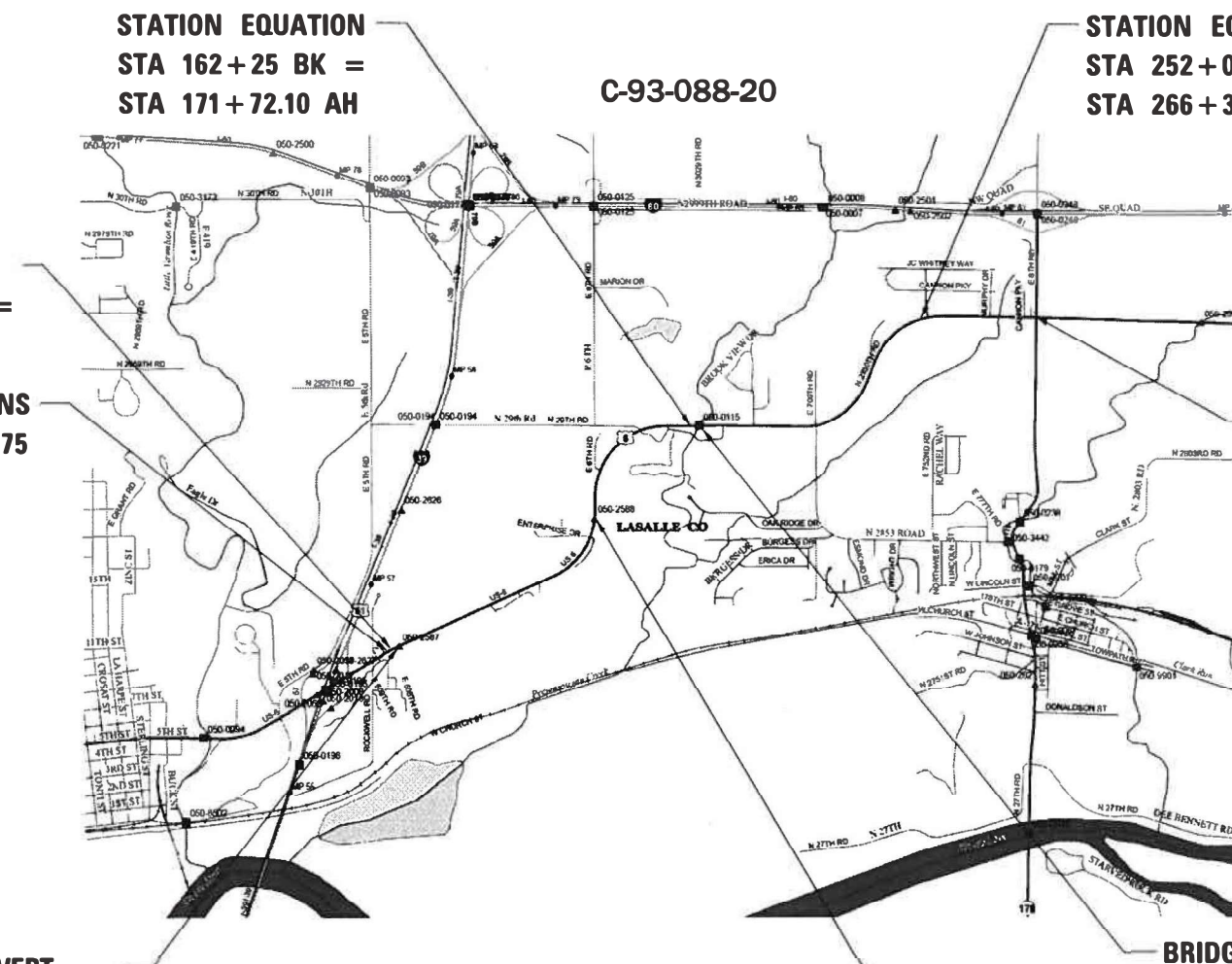

MODEL Default  
FILE Name: p:\publanroom\datalinks\gov\PI\DOT\Documents\DOT Office\District 3\projects\0366\05\CADD\data\0366\05-shc-cover.dgn

GENERAL NOTES

THE INTENT OF THIS PROJECT IS TO ROUT AND SEAL WORKING TRANSVERSE CRACKS AND PRIMARY LONGITUDINAL CRACKS GREATER THAN 1/4" IN WIDTH. SECONDARY CRACKS GREATER THAN 1/4" IN WIDTH SHALL BE CLEANED AND SEALED.

THE CONTRACTOR SHALL NOT DISTURB THE EXISITNG PAVEMENT MARKING OR RAISED REFLECTIVE PAVEMENT MARKERS. THE CONTRACTOR SHALL REPLACE, AT NO ADDITIONAL COST TO THE DEPARTMENT, ANY PAVEMENT MARKING OR RAISED REFLECTIVE PAVEMENT MARKERS DAMAGED BY HIS OPERATION.

THE ENGINEER SHALL DETERMINE WHETHER SECTIONS OF CRACKS SEALING SHOULD BE OMITTED IN ORDER TO AVOID DAMAGING THE PAVEMENT MARKING IN THOSE AREAS.

PLAN DIMENSIONS AND DETAIL RELATIVE TO THE EXISTING PLANS ARE SUBJECT TO ROUTINE VARIATIONS. THE CONTRACTOR SHALL FIELD VERIFY EXISTING DIMENSIONS AND DETAILS AFFECTING NEW CONSTRUCTION OF ORDERING OF MATERIALS, SUCH VARIATIONS SHALL NOT BE CAUSE FOR ADDITIONAL COMPENSATION FOR A CHANGE IN THE SCOPE OF THE WORK, HOWEVER, THE CONTRACTOR WILL BE PAID FOR THE QUANTITY FURNISHED BASED UPON THE UNIT BID PRICE.

ALL PCC BRIDGE DECKS AND PAVEMENT SHALL BE OMITTED. BRIDGE DECKS WITH HMA OVERLAYS ARE TO BE SEALED ONLY (NO ROUTING).

THE FOLLOWING RATES OF APPLICATION HAVE BEEN USED IN CALCULATING PLAN QUANTITIES:

CRACK FILLING	0.35	POUND/FOOT
---------------	------	------------

COMMITMENTS

STATE OF ILLINOIS  
DEPARTMENT OF TRANSPORTATION  
DISTRICT THREE  
AS BUILT INFORMATION

SUPERVISING CONSTRUCTION FIELD ENGINEER

RESIDENT ENGINEER / TECHNICIAN

START & END DATES  
OF CONSTRUCTION:

INSPECTORS:

STATE OF ILLINOIS  
DEPARTMENT OF TRANSPORTATION  
DISTRICT THREE

PREPARED BY: \_\_\_\_\_  
DISTRICT STUDIES & PLANS ENGINEER

DATE: \_\_\_\_\_

EXAMINED BY: \_\_\_\_\_  
DISTRICT CONSTRUCTION ENGINEER

\_\_\_\_\_  
DISTRICT MATERIALS ENGINEER

\_\_\_\_\_  
DISTRICT OPERATIONS ENGINEER

	USER NAME = NOLASCOCJ	DESIGNED -	REVISED -	STATE OF ILLINOIS DEPARTMENT OF TRANSPORTATION	GENERAL NOTES			F.A.P. RTE.	SECTION	COUNTY	TOTAL SHEETS	SHEET NO.
		DRAWN -	REVISED -					623	(31)CJ5	LASALLE	7	2
	PLOT SCALE = 100,0000 ' / in.	CHECKED -	REVISED -					CONTRACT NO. 66L05				
	PLOT DATE = 4/24/2020	DATE -	REVISED -		SCALE:	SHEET 1	OF 1	SHEETS	STA.	TO STA.	ILLINOIS FED. AID PROJECT	

MODEL Default  
FILE Name: p:\publanroom\datalinks\gov\PW\DOT\Documents\DOT Office\District 3\projects\0366\05\CADD\05-shc-detail.dgn

	USER NAME = NOLASCOCJ	DESIGNED -	REVISED -
		DRAWN -	REVISED -
	PLOT SCALE = 100.0000 ' / in.	CHECKED -	REVISED -
	PLOT DATE = 4/24/2020	DATE -	REVISED -

STATE OF ILLINOIS  
DEPARTMENT OF TRANSPORTATION

SUMMARY OF QUANTITIES			
SCALE:	SHEET 1	OF 1	SHEETS
	STA.	TO STA.	

F.A.P. RTE.	SECTION	COUNTY	TOTAL SHEETS	SHEET NO.
623	(31)CJS	LASALLE	7	3
CONTRACT NO. 66L05				
ILLINOIS		FED. AID PROJECT		

CODE NO.	ITEM	UNIT	TOTAL QUANTITY	CONSTR. CODE
				NHPP FUNDING
				ROADWAY
				0005 RURAL
45100100	CRACK ROUTING (PAVEMENT)	FOOT	35684	35684
45100200	CRACK FILLING	POUND	12489	12489
67100100	MOBILIZATION	L SUM	1	1
70100460	TRAFFIC CONTROL AND PROTECTION, STANDARD 701306	L SUM	1	1
Z0030850	TEMPORARY INFORMATION SIGNING	SQ FT	42	42

MODEL Default  
FILE Name: p:\publanroom\datalinks\gov\PWIDOT\Documents\DOT Office\Detail\3\Projects\0366L05\CADD\05-shc-detail.dgn

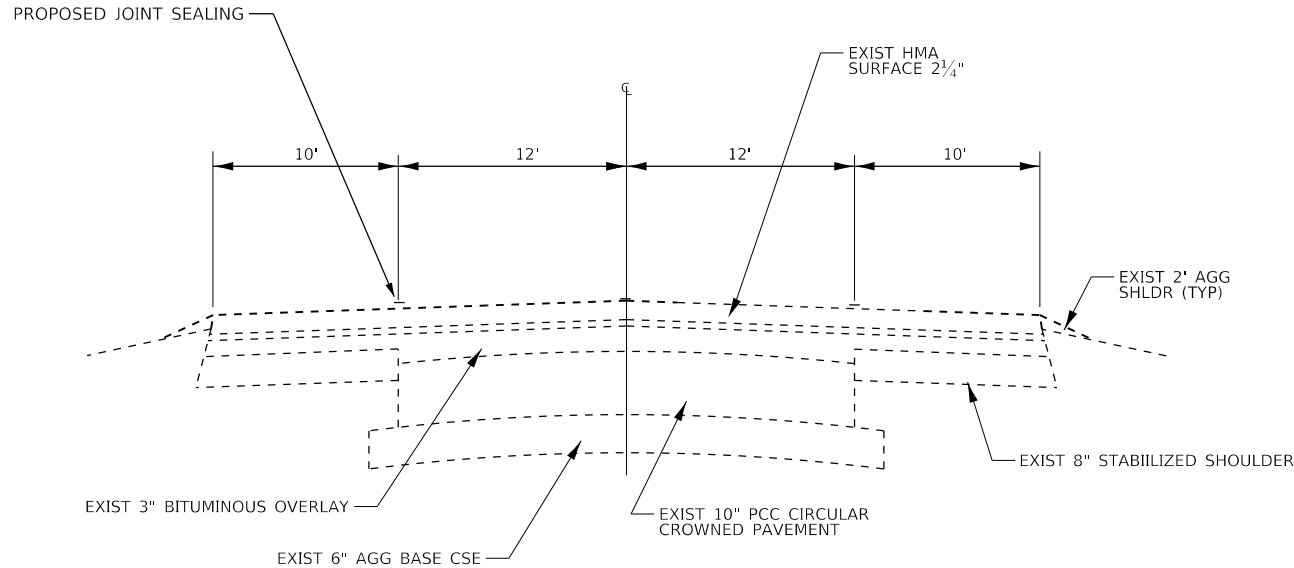

**TYPICAL SECTION 1**

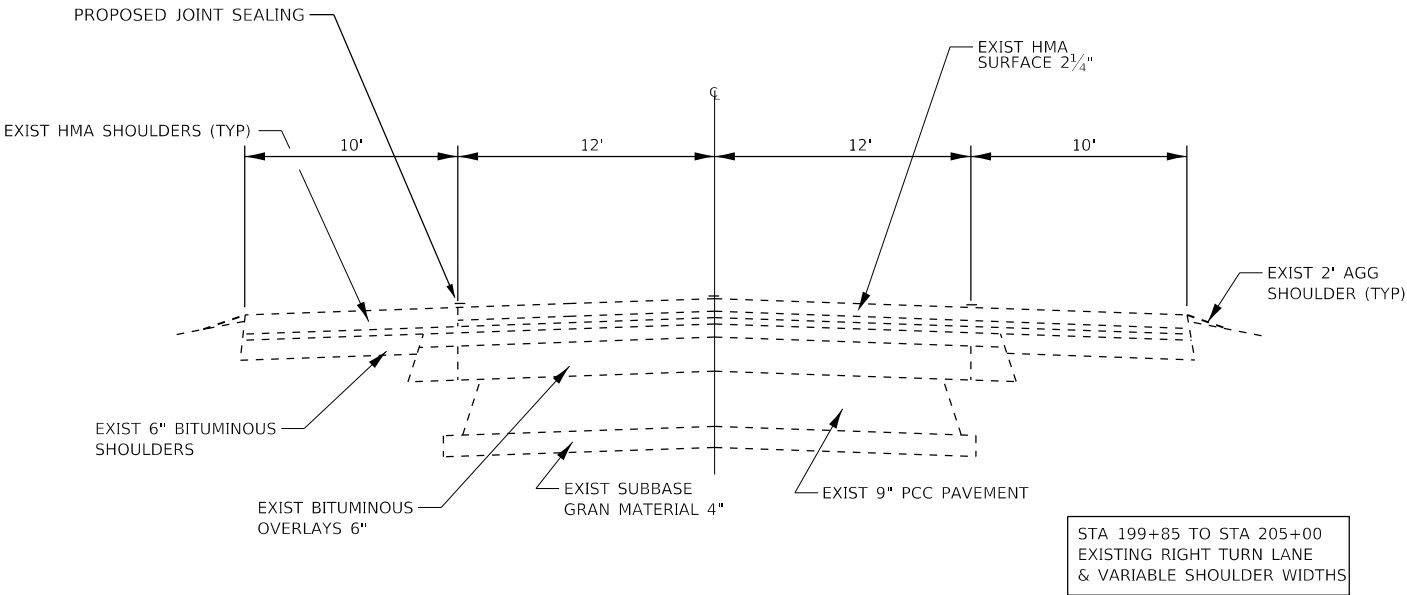

**TYPICAL SECTION 3**

STA 158+00 TO STA 162+25  
(STA EQUATION: 162+25 BK = 171+72.10 AH)  
STA 171+72.10 TO STA 205+00  
PROPOSED CRACK SEALING - SEE DETAIL

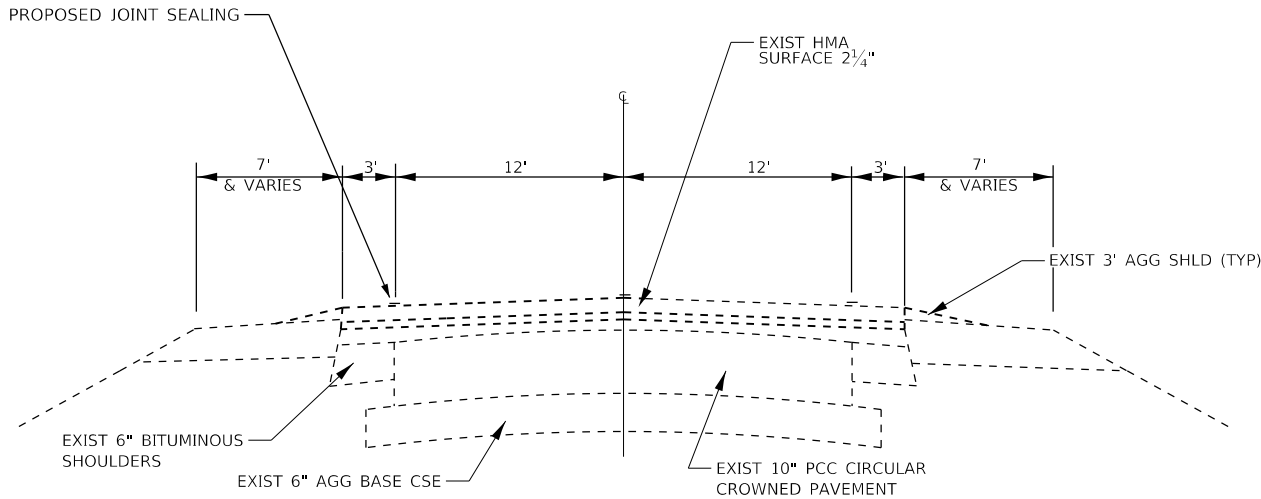

**TYPICAL SECTION 2**

STA 71+77 TO STA 158+00  
STA 205+00 TO STA 223+66.5  
STA 249+40 TO STA 252+00  
(STA EQUATION: 252+00 BK = 266+39.71 AH)  
STA 266+39.71 TO STA 279+80  
WIDTH TRANSITION: STA 278+83 TO STA 279+80  
PROPOSED CRACK SEALING - SEE DETAIL

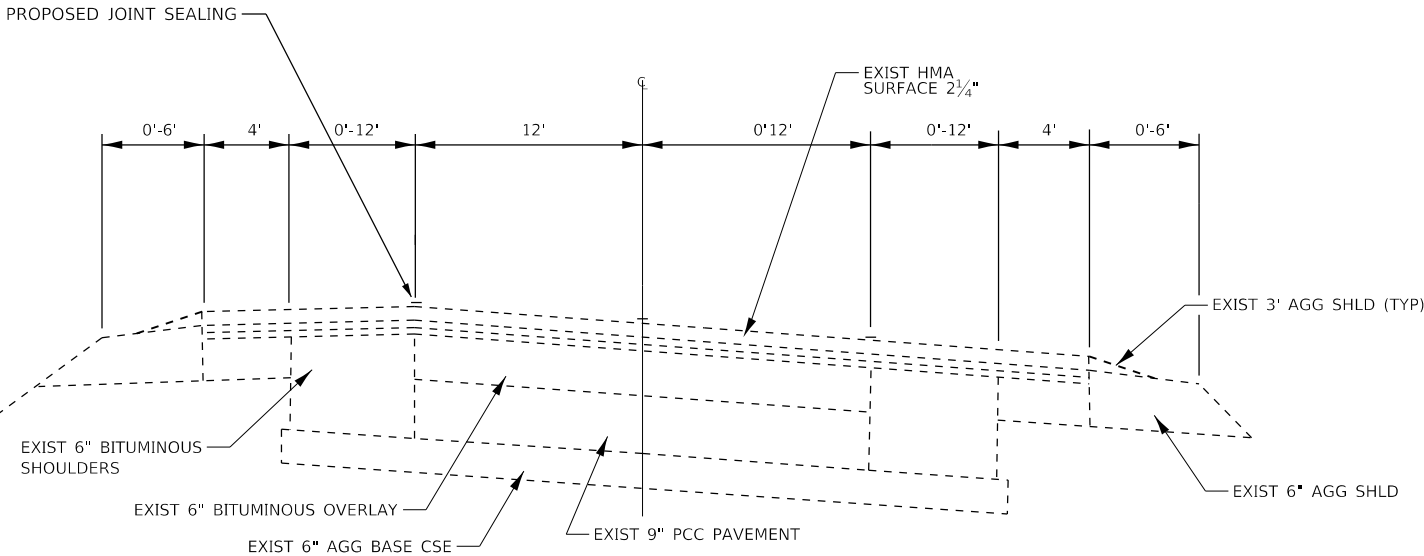

**TYPICAL SECTION 4**

STA 223+65.5 TO STA 249+40  
PROPOSED CRACK SEALING - SEE DETAIL

	USER NAME   = NOLASCOCJ	DESIGNED   -	REVISED   -	STATE OF ILLINOIS DEPARTMENT OF TRANSPORTATION	TYPICAL SECTIONS				F.A.P. RTE.	SECTION	COUNTY	TOTAL SHEETS	SHEET NO.
		DRAWN    -	REVISED   -						623	(31)CJS	LASALLE	7	4
	PLOT SCALE   = 100,0000 ' / in.	CHECKED   -	REVISED   -		CONTRACT NO. 66L05								
	PLOT DATE    = 4/24/2020	DATE       -	REVISED   -		ILLINOIS FED. AID PROJECT								
						SCALE:	SHEET 1	OF 1	SHEETS	STA.	TO STA.		

MODEL Default  
FILE Name: p:\publanroom\dat\illinois\gov\PWIDOT\Documents\IDOT Office\District 3\projects\0366\05\CADD\data\0366\05-shc-detail.dgn

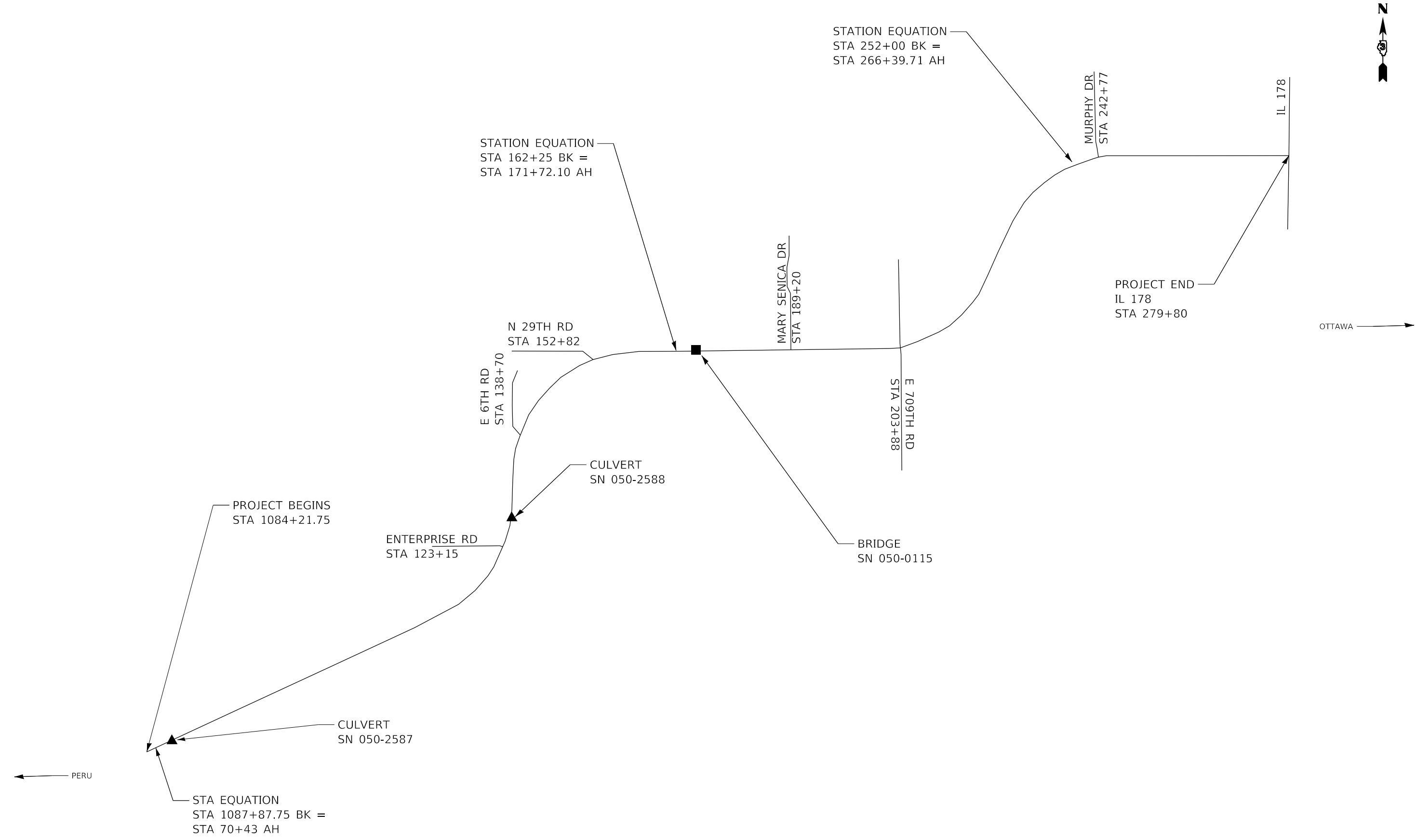

USER NAME	= NOLASCOCJ	DESIGNED	-	REVISED	-
		DRAWN	-	REVISED	-
PLOT SCALE	= 100.0000 ' / in.	CHECKED	-	REVISED	-
PLOT DATE	= 4/24/2020	DATE	-	REVISED	-

STATE OF ILLINOIS  
DEPARTMENT OF TRANSPORTATION

LINE DIAGRAM

SCALE: SHEET 1 OF 1 SHEETS STA. TO STA.

F.A.P. RTE.	SECTION	COUNTY	TOTAL SHEETS	SHEET NO.
623	(31)CJ5	LASALLE	7	5
CONTRACT NO. 66L05				
ILLINOIS FED. AID PROJECT				

MODEL Default  
FILE Name: p:\publanroom\datalinks\gov\PW\DOT\Documents\DOT Office\District 3\projects\0366\05\CADD\05-shc-sheet6.dgn

	USER NAME = NOLASCOCJ	DESIGNED -	REVISED -
		DRAWN -	REVISED -
	PLOT SCALE = 100.0000 ' / in.	CHECKED -	REVISED -
	PLOT DATE = 4/24/2020	DATE -	REVISED -

<b>STATE OF ILLINOIS DEPARTMENT OF TRANSPORTATION</b>
---

SCHEDULES			
SCALE:	SHEET 1	OF 1 SHEETS	STA. TO STA.

F.A.P. RTE.	SECTION	COUNTY	TOTAL SHEETS	SHEET NO.
623	(31)CJS	LASALLE	7	6
CONTRACT NO. 66L05				
		ILLINOIS	FED. AID PROJECT	

CRACK AND SEALING SCHEDULE				
LOCATION	LONGITUDINAL CRACK ROUTING (PAVEMENT)	TRANSVERSE CRACK ROUTING (PAVEMENT)	LONGITUDINAL CRACK FILLING	TRANSVERSE CRACK FILLING
	FOOT	FOOT	POUND	POUND
US 6	25,040	10,644	8,764	3,725
TOTAL	35,684		12,489	

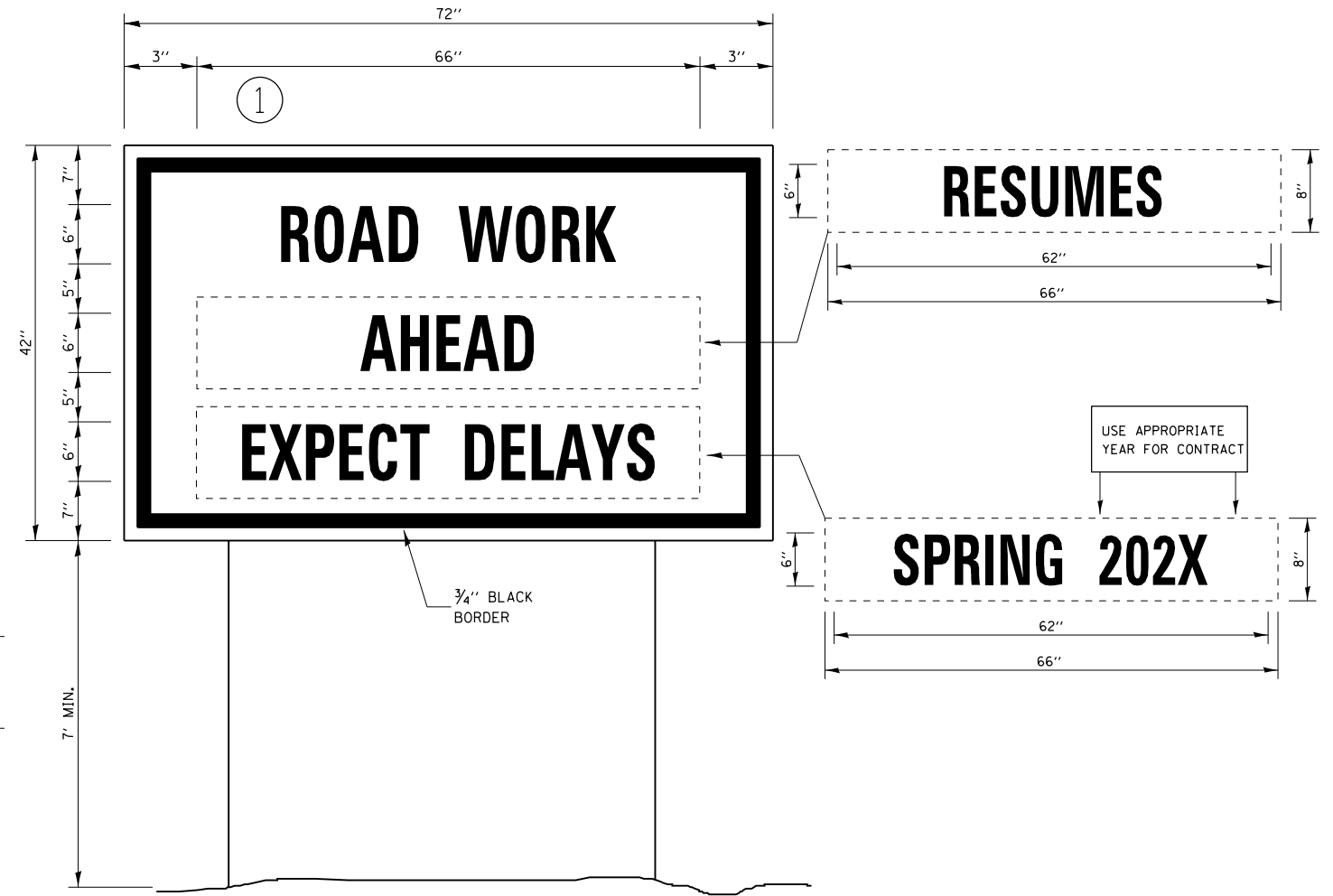
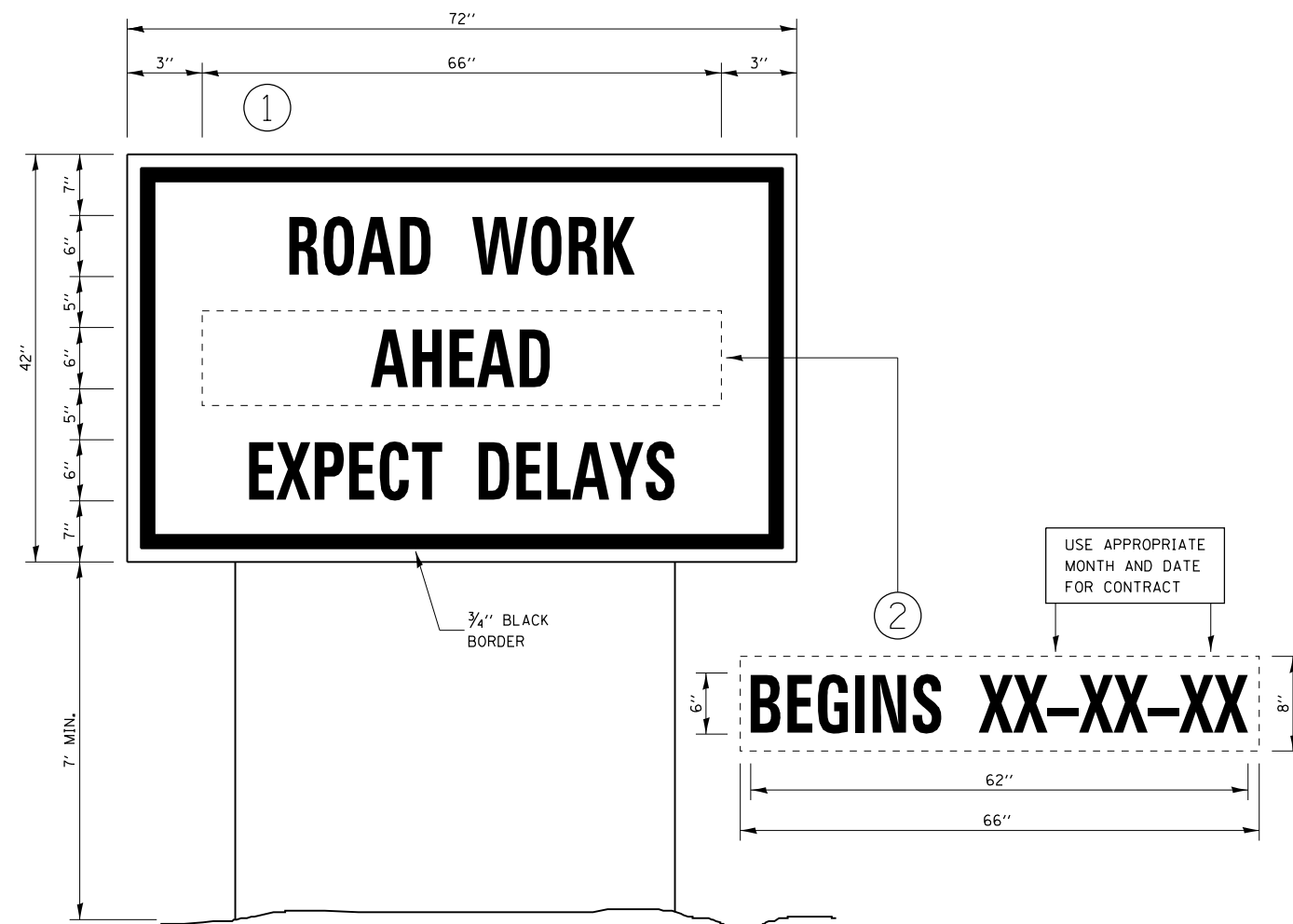

## TEMPORARY INFORMATION SIGNING

## WINTER SHUT DOWN SIGNING

NOTES:

1. USE 6" D BLACK LETTERING ON FLOURESCENT ORANGE BACKGROUND.
2. ERECT SIGNS AT LOCATIONS IN ADVANCE OF THE "ROAD CONSTRUCTION AHEAD" SIGNS AS DIRECTED BY THE ENGINEER.
3. ERECT SIGN① WITH INSTALLED PANEL ② A MINIMUM OF ONE WEEK PRIOR TO THE START OF THE LANE CLOSURE.
4. REMOVE PANEL ② ON THAT DATE.
5. SEE SPECIAL PROVISION "TEMPORARY INFORMATION SIGNING" FOR ADDITIONAL INFORMATION.
6. WILL BE PAID FOR PER SQ FT AS "TEMPORARY INFORMATION SIGNING". EACH SIGN = 21 SQ FT AND THE DATE PANEL ② WILL NOT BE MEASURED SEPARATELY FOR PAYMENT.

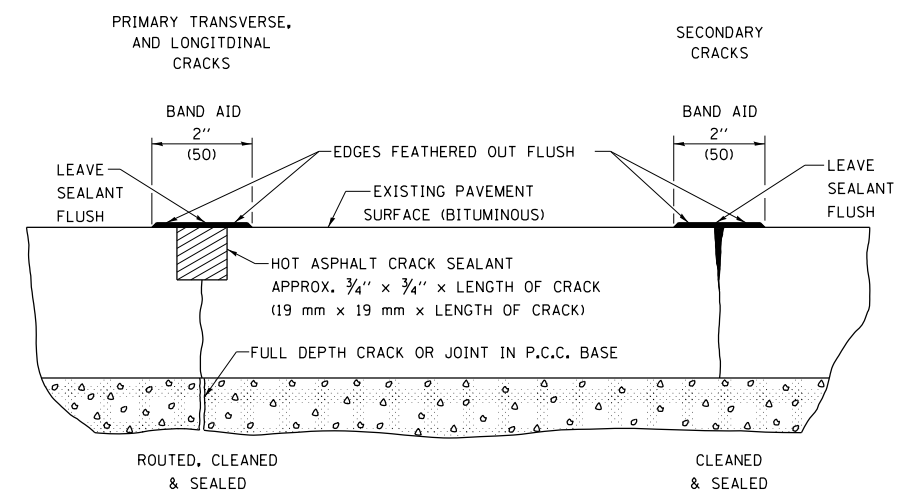

### **CRACK SEALING HMA PAVEMENT DETAIL**

[illegible]