

F.A.I. RTE.	SECTION	COUNTY	TOTAL SHEETS	SHEET NO.
90/94	*	COOK	860	360
STA. 2024+00		TO STA. 2011+00		
FED. ROAD DIST. NO.		ILLINOIS FED. AID PROJECT		
* (1516,1,1717 & 1818) R-8		62694		

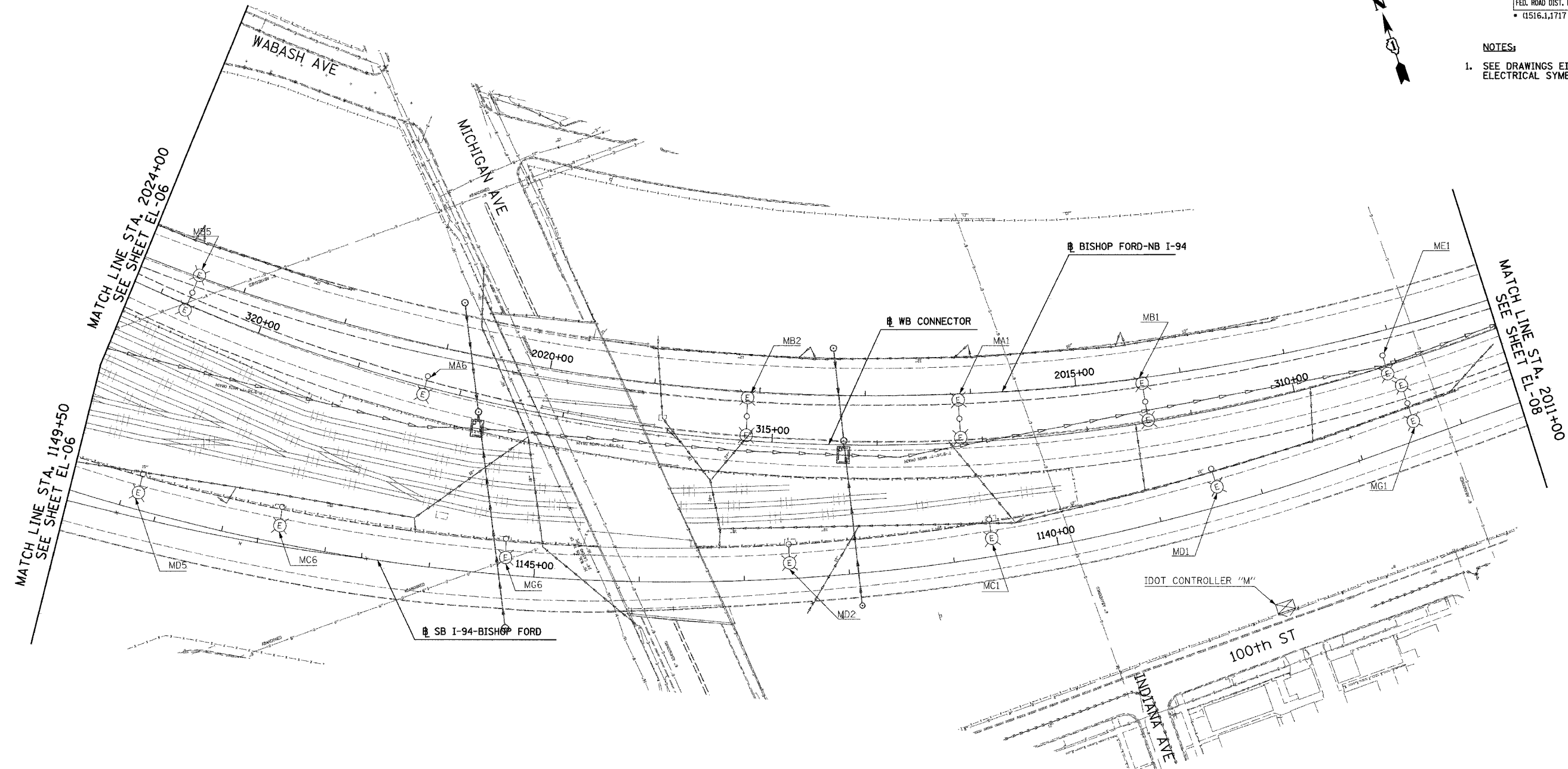

- NOTES:
- SEE DRAWINGS EI-100 AND EI-101 FOR ELECTRICAL SYMBOLS AND ABBREVIATIONS.



NO ELECTRICAL WORK ON THIS SHEET
FOR REFERENCE ONLY



17A/EL-07

SINGH
SINGH & ASSOCIATES, INC.
CONSULTING ENGINEERS

300 W. ADAMS ST.
CHICAGO, IL 60606
TEL: (312) 629-0240
FAX: (312) 629-8449

REVISIONS	
NAME	DATE
REVISED	5/06/05

ILLINOIS DEPARTMENT OF TRANSPORTATION
F.A.I. 90/94 (DAN RYAN EXPRESSWAY)
ROADWAY LIGHTING AND SURVEILLANCE PLANS
EXISTING CONDITIONS, TEMPORARY
AND DEMOLITION
SCALE: 1"=50'
DATE: MARCH 18, 2005
DRAWN BY: VK
CHECKED BY: TM

4/27/2005 8:49:54 AM