

F.A.P. RTE.	SECTION	COUNTY	TOTAL SHEETS	SHEET NO.
310		MADISON	452	247
STA. 31+325.000 TO STA. 31+350.000				
FED. ROAD DIST. NO.		ILLINOIS FED. AID PROJECT		
SECTION 60-14		SECTION 60-14-1B		

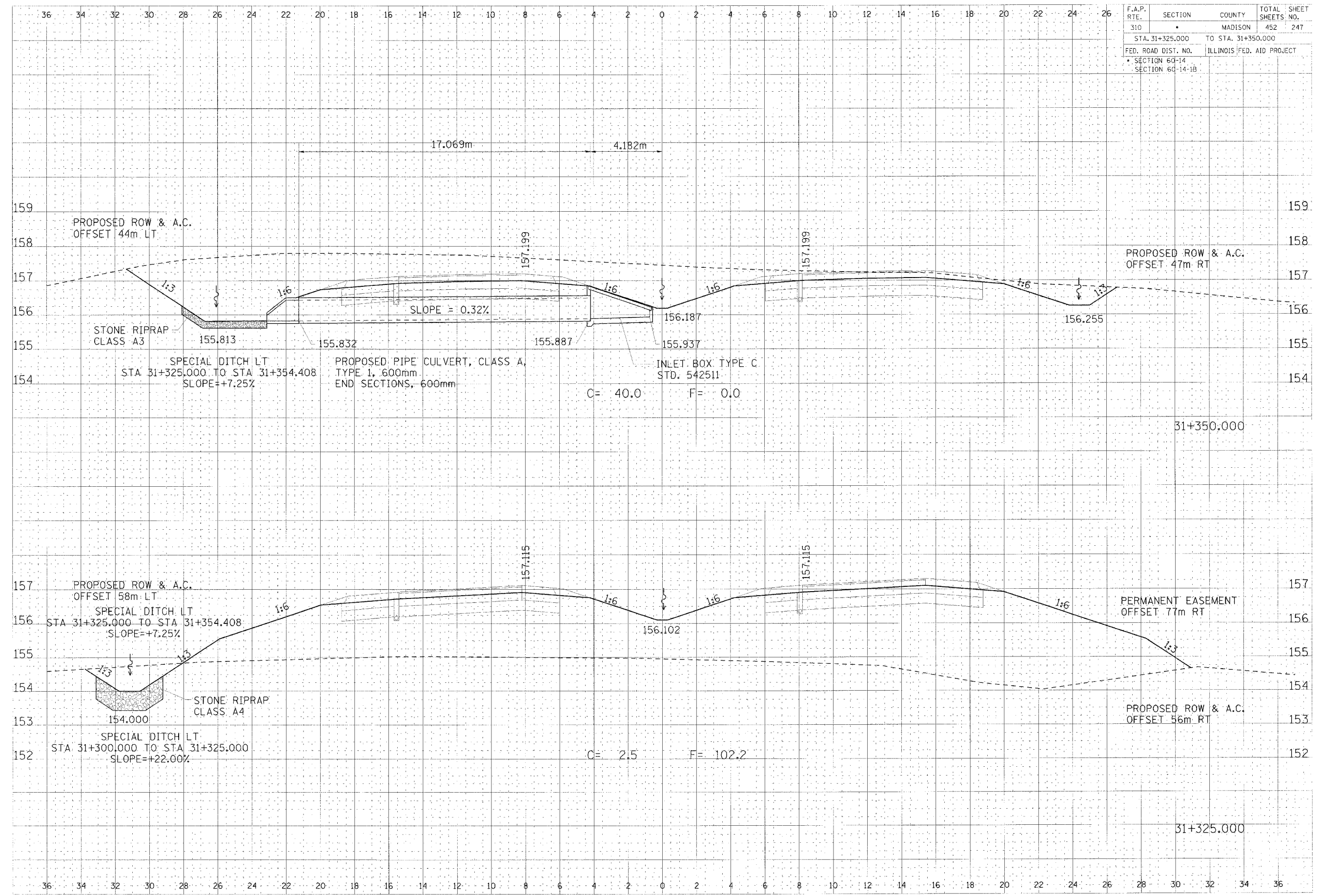

DATE	BY	REVISION

DATE	BY	REVISION

CROSS SECTION, FAP ROUTE 310, STA 31+325.000 TO STA 31+350.000