

F.A.P. RTE.	SECTION	COUNTY	TOTAL SHEETS	SHEET NO.
95	*	EFFINGHAM	409	61
STA. 361+00.00 TO STA. 373+00.00				
FED. ROAD DIST. NO. 7 ILLINOIS FED. AID PROJECT				
* (6,7)Y, RS-1, 6B-1, 7B-1 & 7B-2				
CONTRACT NO. 94356				

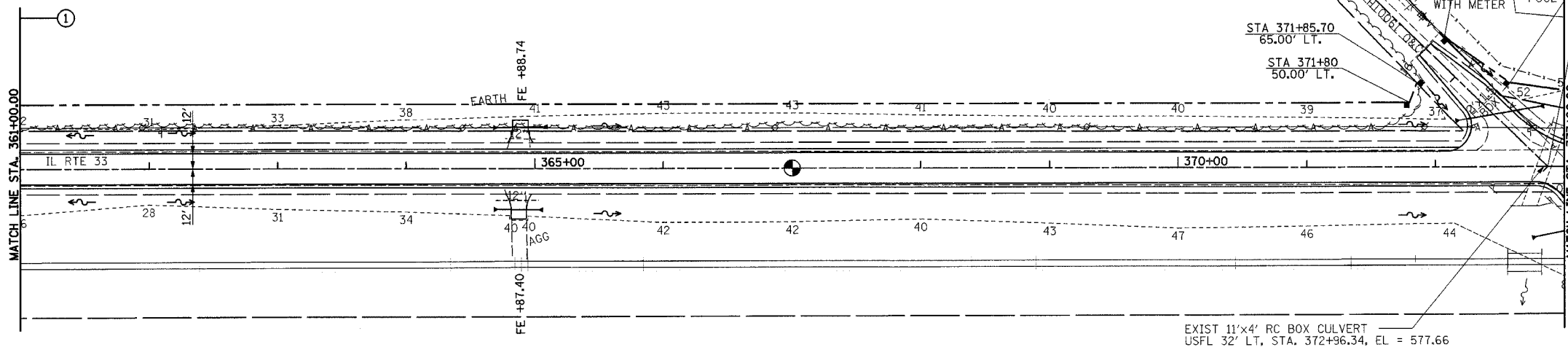

FURNISHING AND ERECTING RIGHT-OF-WAY MARKERS

50' LT STA. 371+80.00	1 EACH
65' LT STA. 371+85.70	1 EACH
100.45' LT STA. 372+07.10	1 EACH
65' LT STA. 372+58.00	1 EACH
TOTAL	4 EACH



PERMANENT SURVEY MARKERS, TYPE I
P.O.T. STA. 367+00.00 1 EACH

PIPE CULVERTS, CLASS D, TYPE I
EQUIVALENT ROUND-SIZE, 24"
STA. 372+50.06, 41' LT
LENGTH = 62'
UPSTREAM FLOWLINE = 581.60
DOWNSTREAM FLOWLINE = 578.52

END SECTIONS, EQUIVALENT ROUND-SIZE, 24"
36' LT STA. 372+19.50 1 EACH
47' LT STA. 372+80.62 1 EACH
TOTAL 2 EACH

EXIST 11'x4' RC BOX CULVERT
USFL 32' LT, STA. 372+96.34, EL = 577.66
DSFL 31' RT, STA. 372+72.78, EL = 577.49

BOX CULVERTS TO BE CLEANED
31' LT STA. 372+96.34 TO
32' RT STA. 372+72.78 1 EACH

BOX CULVERT REMOVAL
1900TH ST N 25'

DATE	BY
DATE	BY
DATE	BY
DATE	BY

DATE	BY
DATE	BY
DATE	BY
DATE	BY

