

STATE OF ILLINOIS  
DEPARTMENT OF TRANSPORTATION

F.A.P. RTE.	SECTION	COUNTY	TOTAL SHEETS	SHEET NO.
525	2024-1026-RS	MCHENRY	24	1
ILLINOIS CONTRACT NO. 62X68				

D-91-059-25

FOR INDEX OF SHEETS, SEE SHEET NO. 2

THE PROJECT IS LOCATED IN:  
  
THE CITY OF MARENGO AND  
UNINCORPORATED CORAL TOWNSHIP

TRAFFIC DATA:

U.S. 20 (GRANT HIGHWAY)  
2023 - ADT: 8350  
SPEED LIMIT: (35 - 55) MPH  
OTHER PRINCIPAL ARTERIAL

PROPOSED  
HIGHWAY PLANS

FAP ROUTE 525: U.S. 20 (GRANT MEMORIAL HIGHWAY)  
960 FEET EAST OF PROSPECT STREET TO WEST OF UNION ROAD  
SECTION: 2024-1026-RS  
STANDARD OVERLAY AND ADA IMPROVEMENTS  
MCHENRY COUNTY  
C-91-079-25

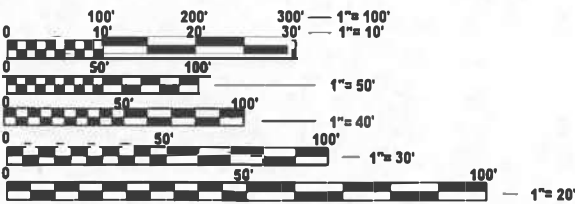

FULL SIZE PLANS HAVE BEEN PREPARED USING STANDARD  
ENGINEERING SCALES. REDUCED SIZED PLANS WILL NOT  
CONFORM TO STANDARD SCALES. IN MAKING MEASUREMENTS  
ON REDUCED PLANS, THE ABOVE SCALES MAY BE USED.

J.U.L.I.E.  
JOINT UTILITY LOCATION INFORMATION FOR EXCAVATION  
1-800-892-0123  
OR 811

PROJECT BEGINS  
STA 24+61.98

PROJECT ENDS  
STA 80+48.64

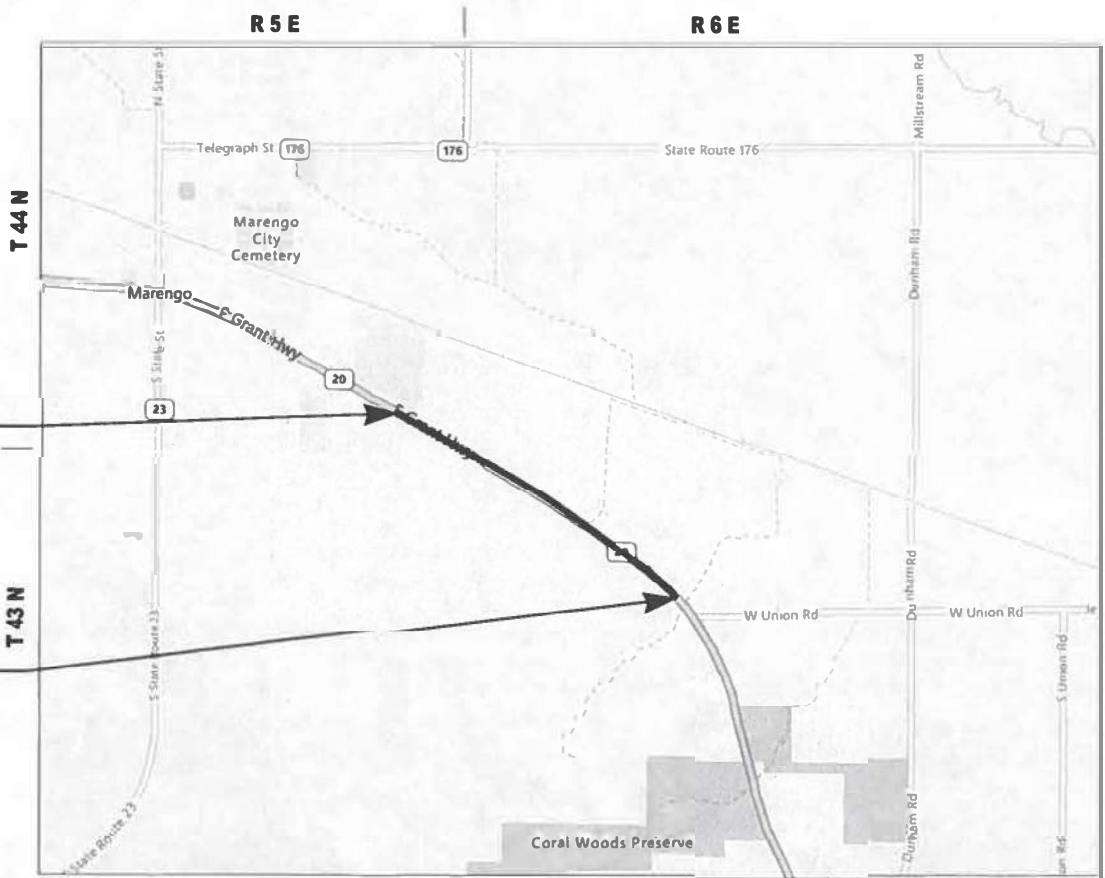

MARENGO, SENECA, AND CORAL TOWNSHIP

GROSS AND NET LENGTH = 5,586.66 FT. = 1.058 MILE

PROJECT ENGINEER: DANIEL WILGREEN, P.E. (847) 705-4240  
PROJECT MANAGER: J. ALAIN MIDY, P.E. (847) 221-3056

CONTRACT NO. 62X68

STATE OF ILLINOIS  
DEPARTMENT OF TRANSPORTATION

SUBMITTED March 17<sup>th</sup> 2025  
Scott A. Etkin REGIONAL ENGINEER

May 9 2025  
Scott A. Etkin ENGINEER OF DESIGN AND ENVIRONMENT

May 9 2025  
Scott A. Etkin DIRECTOR OF HIGHWAYS PROJECT IMPLEMENTATION

PRINTED BY THE AUTHORITY  
OF THE STATE OF ILLINOIS

MODEL: GenNotesSh01 [Sheet]  
FILE NAME: c:\paw\_work\paw\td\kalor\td103751\01D105925-sh1-gennote.dgn

INDEX OF SHEETS

SHEET NO.

DESCRIPTION

1	COVER SHEET
2	INDEX OF SHEETS, STATE STANDARDS, AND GENERAL NOTES
3-4	SUMMARY OF QUANTETIES
5	TYPICAL SECTIONS
6-8	EXISTING AND PROPOSED ROADWAY PLANS
9-10	ADA DETAILS PLAN SHEET
11	DRIVEWAY DETAILS - DISTANCE BETWEEN R.O.W. AND FACE OF CURB & EDGE OF SHOULDER >15' (BD-01)
12	DETAILS FOR FRAMES AND LIDS ADJUSTMENTS WITH MILLING (BD-08)
13	PAVEMENT PATCHING FOR HMA SURFACED PAVEMENT (BD-22)
14	CURB OR CURB AND GUTTER REMOVAL AND REPLACEMENT (BD-24)
15	BUTT JOINT AND HMA TAPER DETAILS (BD-32)
16	DETAILS FOR DEPRESSED CURB & GUTTER AND SHOULDER TREATMENT AT TBT TY.1 SPL. (BD-34)
17	RUMBLE STRIPES FOR CENTERLINE, NON-FREEWAY (BD-55)
18	TRAFFIC CONTROL AND PROTECTION FOR SIDE ROADS, INTERSECTIONS, AND DRIVEWAYS (TC-10)
19	TYPICAL APPLICATIONS RAISED REFLECTIVE PAVEMENT MARKERS (SNOW-PLOW RESISTANT) (TC-11)
20	DISTRICT ONE TYPICAL PAVEMENT MARKINGS (TC-13)
21	SHORT TERM PAVEMENT MARKING LETTERS AND SYMBOLS (TC-16)
22	ARTERIAL ROAD INFORMATION SIGN (TC-22)
23	PROJECT DETAIL FOR SINGLE PERPENDICULAR CURB RAMPS (PD - 01)
24	PROJECT DETAIL FOR SINGLE PERPENDICULAR CURB RAMPS WITH TURNING SPACE (PD - 04)

STATE STANDARDS

STANDARD NO.

DESCRIPTION

000001-08	STANDARD SYMBOLS, ABBREVIATIONS, AND PATTERNS
424001-12	PERPENDICULAR CURB RAMPS FOR SIDEWALKS
424021-07	DEPRESSED CORNER FOR SIDEWALKS
442201-03	CLASS C AND D PATCHES
482011-03	HMA SHLD. STRIPS/SHLDS. WITH RESURFACING OR WIDENING AND RESURFACING PROJECTS
604001-05	FRAME AND LIDS TYPE 1
604091-05	FRAME AND GRATE TYPE 24
606001-08	CONCRETE CURB TYPE B AND COMBINATION CONCRETE CURB AND GUTTER
630001-13	STEEL PLATE BEAM GAURDRAIL
630301-09	SHOULDER WIDENING FOR TYPE 1 (SPECIAL) GUARDRAIL TERMINALS
701006-05	OFF-RD OPERATIONS, 2L, 2W, 15' (4.5M) TO 24" (600MM) FROM PAVEMENT EDGE
701011-04	OFF-RD MOVING OPERATIONS, 2L, 2W, DAY ONLY
701201-05	LANE CLOSURE, 2L, 2W, DAY ONLY FOR SPEEDS GREATER THAN OR EQUAL TO 45 MPH
701301-04	LANE CLOSURE, 2L, 2W, SHORT TIME OPERATIONS
701306-04	LANE CLOSURE, 2L, 2W, SLOW MOVING OPERATIONS DAY ONLY, FOR SPEEDS GREATER THAN OR EQUAL TO 45 MPH
701311-03	LANE CLOSURE, 2L, 2W, MOVING OPERATIONS DAY ONLY
701501-06	URBAN LANE CLOSURE, 2L, 2W, UNDIVIDED
701502-09	URBAN LANE CLOSURE, 2L, 2W, BI-DIRECTIONAL LEFT TURN LANE
701701-10	URBAN LANE CLOSURE, MULTILANE INTERSECTION
701801-06	SIDEWALK, CORNER OR CROSSWALK CLOSURE
701901-10	TRAFFIC CONTOL DEVICES
725001-01	OBJECT AND TERMINAL MARKERS
780001-05	TYPICAL PAVEMENT MARKINGS
781001-04	TYPICAL APPLICATIONS RAISED REFLECTIVE PAVEMENT MARKERS
782006-01	GUARDRAIL AND BARRIER WALL REFLECTOR MOUNTING DETAILS

GENERAL NOTES

- BEFORE STARTING ANY EXCAVATION, THE CONTRACTOR SHALL CALL "JULIE AT (800) 892-0123 OR 811 FOR FIELD LOCATIONS OF BURIED ELECTRIC, TELEPHONE AND GAS FACILITIES, (48 HOURS NOTIFICATION IS REQUIRED).
- THE CONTRACTOR SHALL COORDINATE CONSTRUCTION ACTIVITIES WITH UTILITY COMPANIES, CITY OF MARENGO AND UNINCORPORATED CORAL TOWNSHIP..
- THE CONTRACTOR WILL NOT BE ALLOWED TO SET UP A YARD OR FIELD OFFICE ON STATE PROPERTY WITHOUT WRITTEN PERMISSION FROM THE DEPARTMENT.
- ALL MILLED SURFACES SHALL BE A UNIFORM CROSS SLOPE PER LANE AND FREE OF RIDGES BETWEEN PASSES. ANY DEVIATIONS SHALL BE CORRECTED AT NO COST TO THE DEPARTMENT.
- BEFORE BEGINNING ANY WORK, THE CONTRACTOR SHALL RETAIN AND RECORD FOR FUTURE REFERENCE, ALL EXISTING PAVEMENT MARKING LINES (AND RAISED REFLECTIVE PAVEMENT MARKERS) IN ORDER THAT THESE LOCATIONS CAN BE RE-ESTABLISHED FOR STRIPING. EXACT LOCATIONS OF ALL PAVEMENT MARKINGS SHALL BE AS DIRECTED BY THE ENGINEER.
- BUTT JOINTS WILL BE INSTALLED AT THE ENDS OF ALL RESURFACING (WHERE RESURFACING MEETS EXISTING PAVEMENT) ACCORDING TO THE "BUTT JOINT AND HOT-MIX ASPHALT TAPER DETAILS" SHEET INCLUDED IN THE PLANS, UNLESS OTHERWISE SPECIFIED.
- THE RESIDENT ENGINEER SHALL CONTACT BRANDY KENNEDY AREA TRAFFIC FIELD ENGINEER, AT BRANDY.KENNEDY@ILLINOIS.GOV, A MINIMUM OF TWO (2) WEEKS PRIOR TO THE PLACEMENT OF PERMANENT PAVEMENT MARKINGS.
- ALL PAVEMENT PATCHING LOCATIONS WILL BE DETERMINED IN THE FIELD BY THE ENGINEER.
- LOCATION OF COMBINATION CONCRETE CURB AND GUTTER REMOVAL AND REPLACEMENT [OR COMBINATION CURB AND GUTTER (THE TYPE SPECIFIED ON THE PLANS)], WILL BE DETERMINED IN THE FIELD BY THE ENGINEER.
- SIDEWALK REMOVAL AND P.C.C. SIDEWALK 5" LOCATIONS SHALL BE DETERMINED BY THE ENGINEER.
- DRAINAGE ADJUSTMENT OR RECONSTRUCTION LOCATIONS WILL BE DETERMINED IN THE FIELD BY THE ENGINEER.
- ANY DAMAGE TO EXISTING PAVEMENT MARKINGS OR RAISED REFLECTIVE PAVEMENT MARKERS OUTSIDE THE REMOVAL LINE SHOWN ON THE PLANS SHALL BE REPLACED AT THE CONTRACTOR'S EXPENSE.
- ALL PAVEMENT MARKINGS SHALL BE PLACED THROUGHOUT THE IMPROVEMENT ACCORDING TO DISTRICT 1 TYPICAL PAVEMENT MARKING DETAIL.
- FRAMES AND GRATES ADJUSTMENT OF PRIVATE UTILITIES WITHIN THE PROJECT LIMITS SHALL BE DONE BY THEIR RESPECTIVE OWNERS AND ARE NOT PART OF THIS CONTRACT.
- THE CONTRACTOR SHALL CONTACT THE DISTRICT ONE TRAFFIC CONTROL SUPERVISOR AT KALPANA.KANNAN-HOSADURGA@ILLINOIS.GOV A MINIMUM OF 72 HOURS IN ADVANCE OF BEGINNING WORK.
- IT SHALL BE THE CONTRACTOR'S RESPONSIBILITY TO VERIFY ALL DIMENSIONS AND CONDITIONS EXISTING IN THE FIELD PRIOR TO CONSTRUCTION AND ORDERING OF MATERIALS.
- THE CONTRACTOR SHALL BE REQUIRED TO KEEP A RECORD OF THE LOCATIONS OF THE BURIED STRUCTURES ACCORDING TO THE LOCATION AND DISTANCE LEFT OR RIGHT OF THE CENTERLINE OF PAVEMENT. UPON COMPLETION OF THE WORK, THE CONTRACTOR SHALL DELIVER THE RECORD TO THE ENGINEER.
- EXISTING BROKEN FRAMES AND LIDS SHALL BE REMOVED AND DISPOSED OF BY THE CONTRACTOR AND SHALL BE REPLACED AS DIRECTED BY THE ENGINEER. REPLACEMENT FRAMES AND LIDS WILL BE PAID FOR ACCORDING TO ARTICLE 109.04 OF THE STANDARD SPECIFICATIONS UNLESS A SEPARATE PAY ITEM HAS BEEN PROVIDED.
- PAVEMENT MARKING, TYPE IV TAPE SHALL BE USED FOR SHORT TERM PAVEMENT MARKINGS ON ALL FINAL SURFACES.
- THE CONTRACTOR SHALL BE REQUIRED TO PROVIDE ACCESS TO ABUTTING PROPERTY AT ALL TIMES DURING THE CONSTRUCTION OF THIS PROJECT.
- RAISED REFLECTIVE PAVEMENT MARKERS SHALL BE PLACED THROUGHOUT THE IMPROVEMENT ACCORDING TO THE DISTRICT STANDARDS AS NOTED IN THE DETAIL.
- OVERNIGHT LANE CLOSURES SHALL NOT BE ALLOWED FOR REHABILITATION PROJECTS INVOLVING DAYTIME MILLING AND RESURFACING OPERATIONS AND CLASS D PATCHES UNLESS OTHER CONDITIONS WARRANT EXTENDED LANE CLOSURES AS DETERMINED AND APPROVED IN WRITING BY THE ENGINEER OR AS PROVIDED FOR IN THE CONTRACT SPECIFICATIONS.
- DO NOT SCALE PLANS FOR CONSTRUCTION DIMENSIONS.
- DITCHES FLOW DIRECTION ARE TO BE MAINTAINED.
- THE LOCATIONS FOR THE GUARDRAIL REMOVAL AND REPLACEMENT ARE TO BE DETERMINED IN THE FIELD BY THE RESIDENT ENGINEER AND/OR AS SHOWN ON THE PLANS.
- THE LOCATIONS FOR THE DRIVEWAY PAVEMENT REMOVAL AND REPLACEMENT ARE TO BE DETERMINED IN THE FIELD BY THE RESIDENT ENGINEER.
- THE LOCATIONS FOR THE PIPE CULVERTS WITHIN THE RESURFACING LIMITS SHALL BE CLEANED AS DIRECTED BY THE RESIDENT ENGINEER.

	USER NAME = Rana.Kalo	DESIGNED -	REVISED -	STATE OF ILLINOIS DEPARTMENT OF TRANSPORTATION	INDEX OF SHEETS, STATE STANDARDS, AND GENERAL NOTES U.S. ROUTE 20 (EAST OF PROSPECT ST. TO WEST OF UNION RD.)				F.A.P RTE.	SECTION	COUNTY	TOTAL SHEETS	SHEET NO.
		DRAWN -	REVISED -						525	2024-1026-RS	MCHENRY	24	2
	PLOT SCALE = 0.16666633 ' / in.	CHECKED -	REVISED -						CONTRACT NO. 62X68				
	PLOT DATE = 3/6/2025	DATE -	REVISED -		SCALE: NONE	SHEET 1	OF 1	SHEETS	STA.	TO STA.	ILLINOIS FED. AID PROJECT		

MODEL: SQQ 1-2 (Sheet)  
FILE NAME: c:\pw\_work\wtd\illka\orm\10375\01056925-4ht-SQQ.dgn

SUMMARY OF QUANTITIES					TYPE      CODE					
					URBAN	URBAN	URBAN	URBAN	URBAN	URBAN
					ROADWAY	ROADWAY				
					100% STATE	100% STATE				
	Code No.	Item	Unit	Total Quantity	0005	0005				
	20200100	EARTH EXCAVATION	CU YD	45	45					
	21101615	TOPSOIL FURNISH AND PLACE, 4"	SQ YD	383	383					
	21400100	GRADING AND SHAPING DITCHES	FOOT	400	400					
	25000210	SEEDING, CLASS 2A	ACRE	0.02	0.02					
	25100630	EROSION CONTROL BLANKET	SQ YD	89	89					
	25200110	SODDING, SALT TOLERANT	SQ YD	160	160					
	25200200	SUPPLEMENTAL WATERING	UNIT	1.6	1.6					
	35501308	HOT-MIX ASPHALT BASE COURSE, 6"	SQ YD	125	125					
	40600290	BITUMINOUS MATERIALS (TACK COAT)	POUND	12925	12925					
	40600370	LONGITUDINAL JOINT SEALANT	FOOT	8106	8106					
	40600400	MIXTURE FOR CRACKS, JOINTS, AND FLANGEWAYS	TON	28.7	28.7					
	40600982	HOT-MIX ASPHALT SURFACE REMOVAL - BUTT JOINT	SQ YD	94	94					
	40601005	HOT-MIX ASPHALT REPLACEMENT OVER PATCHES	TON	72	72					
	40603200	POLYMERIZED HOT-MIX ASPHALT BINDER COURSE, IL-4.75, N50	TON	790	790					
	40604060	HOT-MIX ASPHALT SURFACE COURSE, IL-9.5, MIX "D", N50	TON	14	14					
	40604172	POLYMERIZED HOT-MIX ASPHALT SURFACE COURSE, IL-9.5, MIX "E", N70	TON	1877	1877					
	42001300	PROTECTIVE COAT	SQ YD	418	418					
	42400200	PORTLAND CEMENT CONCRETE SIDEWALK 5 INCH	SQ FT	1802	1802					
	42400800	DETECTABLE WARNINGS	SQ FT	141	141					
	44000159	HOT-MIX ASPHALT SURFACE REMOVAL, 2 1/2"	SQ YD	19148	19148					
	44000200	DRIVEWAY PAVEMENT REMOVAL	SQ YD	125	125					
		USER NAME    = Rana.Kalo	DESIGNED    -	REVISED    -	STATE OF I DEPARTMENT OF TR					
			DRAWN       -	REVISED    -						
			CHECKED    -	REVISED    -						
		PLOT DATE    = 3/6/2025	DATE        -	REVISED    -						

SUMMARY OF QUANTITIES					TYPE CODE					
					URBAN	URBAN	URBAN	URBAN	URBAN	URBAN
					ROADWAY					
					100% STATE	100% STATE				
	Code No.	Item	Unit	Total Quantity	0005	0005				
	70102640	TRAFFIC CONTROL AND PROTECTION, STANDARD 701801	L SUM	1	1					
	70300100	SHORT TERM PAVEMENT MARKING	FOOT	11792	11792					
	70300150	SHORT TERM PAVEMENT MARKING REMOVAL	SQ FT	4914	4914					
	70300211	TEMPORARY PAVEMENT MARKING LETTERS AND SYMBOLS - PAINT	SQ FT	657	657					
	70300221	TEMPORARY PAVEMENT MARKING - LINE 4"- PAINT	FOOT	52755	52755					
	70300241	TEMPORARY PAVEMENT MARKING - LINE 6"- PAINT	FOOT	2831	2831					
	70300261	TEMPORARY PAVEMENT MARKING - LINE 12"- PAINT	FOOT	723	723					
	70300281	TEMPORARY PAVEMENT MARKING - LINE 24"- PAINT	FOOT	191	191					
	70307120	TEMPORARY PAVEMENT MARKING - LINE 4" - TYPE IV TAPE	FOOT	2949	2949					
	72501000	TERMINAL MARKER - DIRECT APPLIED	EACH	4	4					
*	78000100	THERMOPLASTIC PAVEMENT MARKING - LETTERS AND SYMBOLS	SQ FT	219	219					
*	78000200	THERMOPLASTIC PAVEMENT MARKING - LINE 4"	FOOT	16801	16801					
*	78000400	THERMOPLASTIC PAVEMENT MARKING - LINE 6"	FOOT	944	944					
*	78000600	THERMOPLASTIC PAVEMENT MARKING - LINE 12"	FOOT	241	241					
*	78000650	THERMOPLASTIC PAVEMENT MARKING - LINE 24"	FOOT	64	64					
*	78100100	RAISED REFLECTIVE PAVEMENT MARKER	EACH	185	185					
	78300200	RAISED REFLECTIVE PAVEMENT MARKER REMOVAL	EACH	171	171					
	78300202	PAVEMENT MARKING REMOVAL - WATER BLASTING	SQ FT	6921	6921					
	X0320050	CONSTRUCTION LAYOUT (SPECIAL)	L SUM	1	1					
	X2020110	GRADING AND SHAPING SHOULDERS	UNIT	111.8	111.8					

	USER NAME = Rana.Kalo	DESIGNED -	REVISED -	<b>STATE OF TAMIL NADU DEPARTMENT OF TRANSPORTATION</b>
		DRAWN -	REVISED -	
		CHECKED -	REVISED -	
PLOT DATE = 3/6/2025		DATE -	REVISED -	

[illegible]

LEGEND - EXISTING:

- ① PORTLAND CEMENT CONCRETE PAVEMENT 9"±
- ② HOT-MIX ASPHALT PAVEMENT 3"±
- ③ HOT-MIX ASPHALT SAFETY SHOULDER
- ④ AGGREGATE SHOULDER, TYPE B

LEGEND - PROPOSED

- ⑤ POLYMERIZED HOT- MIX ASPHALT SURFACE COURSE, IL-9.5, MIX "E", N70, 1¾"
- ⑥ POLYMERIZED HOT- MIX ASPHALT BINDER COURSE, IL-4.75, N50, ¾"
- ⑦ GRADING AND SHAPING SHOULDERS
- ⑧ AGGREGATE WEDGE SHOULDER, TYPE B
- ⑨ CENTER LINE - RUMBLE STRIP - 16"

U.S. ROUTE 20  
(GRANT MEMORIAL HIGHWAY)

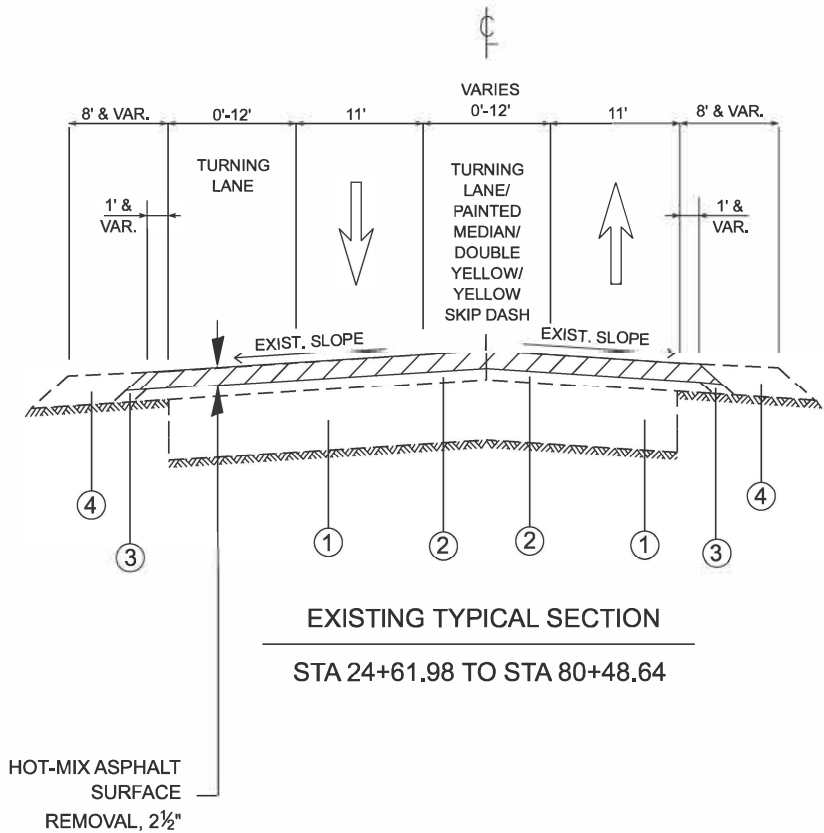

U.S. ROUTE 20  
(GRANT MEMORIAL HIGHWAY)

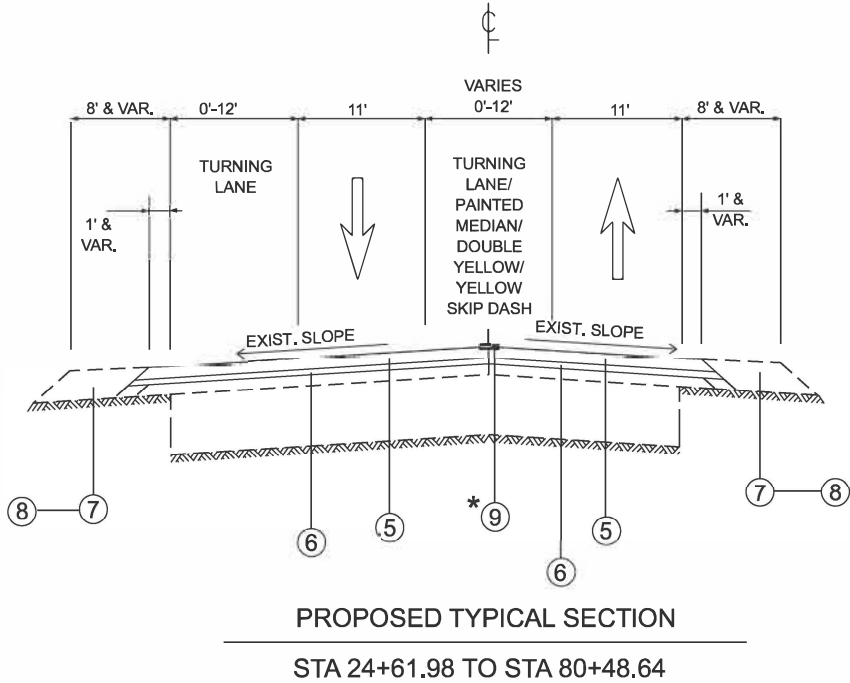

NOTES:

NOTE 1: THE UNIT WEIGHT USED TO CALCULATE ALL HOT-MIX ASPHALT SURFACE MIXTURE QUANTITIES IS 112 LBS/SQ YD/IN.

NOTE 2: THE "AC TYPE" FOR POLYMERIZED HMA MIXES SHALL BE "SBS/SBR PG 76 -22" AND AND FOR NON-POLYMERIZED HMA THE "AC TYPE" SHALL BE "PG 64 -22" UNLESS MODIFIED BY RECLAIMED MATERIALS SPECIFICATIONS.

NOTE 3: THE LONGITUDINAL JOINT SEALANT SHALL BE PLACED OVER THE POLYMERIZED BINDER COURSE, IL-4.75, N50

NOTE 4: THE CONTRACTOR SHALL PERFORM THE PAVEMENT PATCHING OPERATIONS PRIOR TO THE HMA SURFACE REMOVAL OPERATION. SEE IDOT DISTRICT 1 DETAIL PAVEMENT PATCHING FOR HMA SURFACED PAVEMENT (BD-22) FOR ADDITIONAL INFORMATION.

\* CENTER LINE - RUMBLE STRIP - 16" FROM STA 59+66 TO STA 80+48.64

HOT-MIX ASPHALT MIXURE REQUIREMENTS

MIXTURE USES	MIXTURE TYPE	AIR VOIDS(%) Ndes	QUALITY MANAGEMENT PROGRAM (QMP)
PAVEMENT RESURFACING	POLYMERIZED HOT- MIX ASPHALT SURFACE COURSE, IL-9.5, MIX "E", N70, 1¾"	4.0% @ 70 GYR.	QCP
	POLYMERIZED HOT- MIX ASPHALT BINDER COURSE, IL-4.75, N50, ¾"	3.5% @ 50 GYR.	QC/OA
PATCHING	HMA REPLACEMENT OVER PATCHES (HMA BINDER IL-19 MM)	4.0% @ 70 GYR.	QC/OA
	CLASS D PATCHES (HMA BINDER IL-19 MM	4.0% @ 70 GYR.	QC/OA
DRIVEWAYS	HOT-MIX ASPHALT SURFACE COURSE, (IL-9.5 mm), MIX "D", N50, 2"	4.0% @ 50 GYR.	QC/OA
	HOT-MIX ASPHALT BASE COURSE, (HMA BINDER) (IL-19 mm); CE - 8"	4.0% @ 50 GYR.	QC/OA
QMP DESIGNATION: QUALITY CONTROL/QUALITY ASSURANCE (QC/QA); QUALITY CONTROL FOR PERFORMANCE (QCP); PAY FOR PERFORMANCE (PFP)			

STATE OF ILLINOIS  
DEPARTMENT OF TRANSPORTATION

EXISTING AND PROPOSED TYPICAL SECTIONS  
U.S. ROUTE 20 (EAST OF PROSPECT ST. TO WEST OF UNION RD.)

SCALE: NONE SHEET 1 OF 1 SHEETS STA. TO STA.

F A P RTE	SECTION	COUNTY	TOTAL SHEETS	SHEET NO.
525	2024-1026-RS	MCHENRY	24	5
CONTRACT NO. 62X68				
ILLINOIS FED. AID PROJECT				

MODEL: EXCL - Plan 1 [Sheet]  
FILE NAME: c:\p\work\idokaborm\1037510\105925-shr-plan.dgn

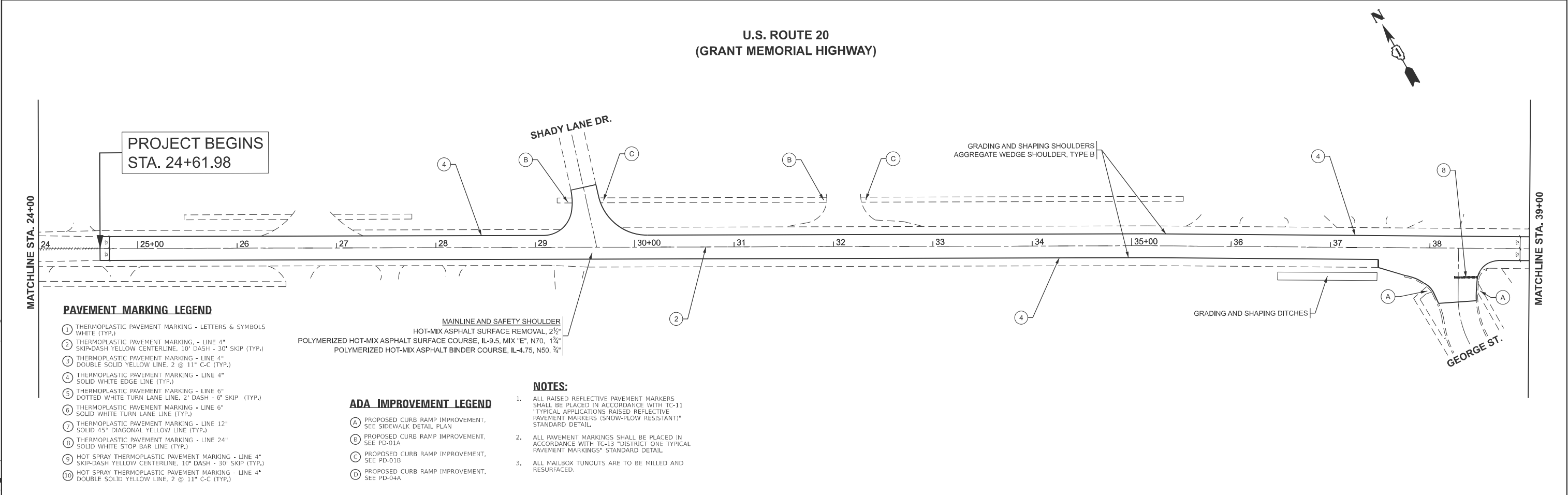
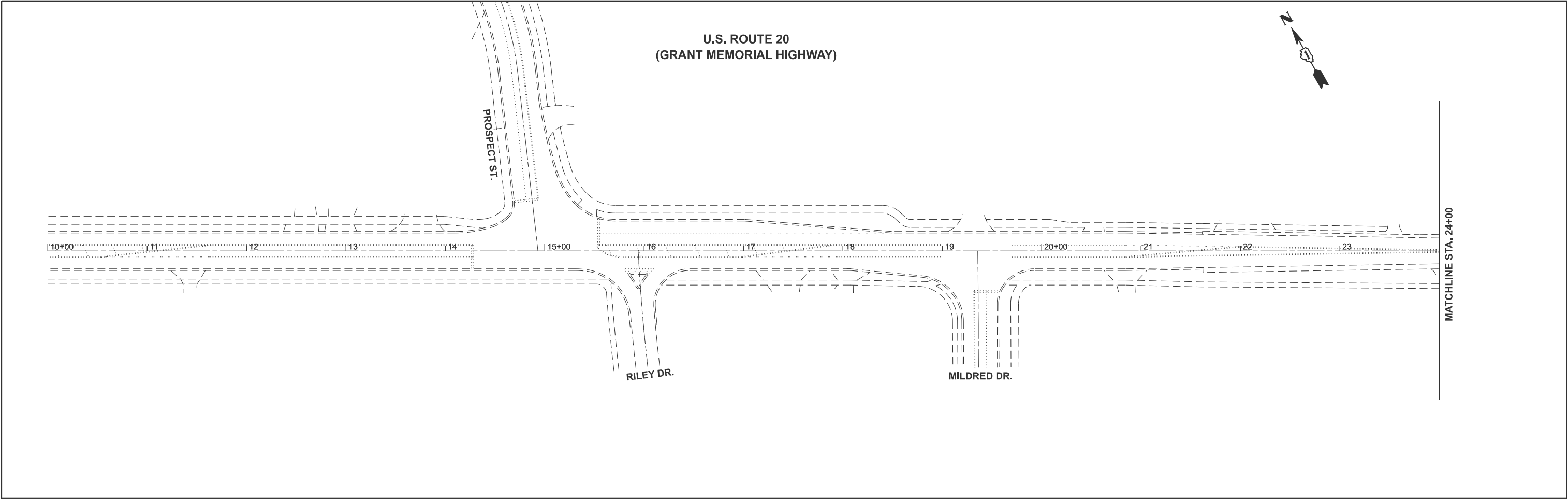

	USER NAME = Rana.Kalo		DESIGNED -	REVISED -	STATE OF ILLINOIS DEPARTMENT OF TRANSPORTATION	EXISTING AND PROPOSED ROADWAY PLAN U.S. ROUTE 20 (EAST OF PROSPECT ST. TO WEST OF UNION RD.)			F.A.P RTE.	SECTION	COUNTY	TOTAL SHEETS	SHEET NO.
			DRAWN -	REVISED -					525	2024-1026-RS	MCHENRY	24	6
			CHECKED -	REVISED -					CONTRACT NO. 62X68				
	PLOT DATE = 3/6/2025		DATE -	REVISED -		SCALE: 1"=50'	SHEET 1	OF 3 SHEETS	STA. 10+00.00	TO STA. 39+00.00	ILLINOIS FED. AID PROJECT		



- ### PAVEMENT MARKING LEGEND

- ### ADA IMPROVEMENT LEGEND

- MAINLINE AND SAFETY SHOULDER  
MIX ASPHALT SURFACE REMOVAL, 2½"  
FACE COURSE, IL-9.5, MIX "E", N70, 1¾"  
HALT BINDER COURSE, IL-4.75, N50, ¾"

USER NAME     = Rana,Kalo	DESIGNED   -	REVISED   -	STATE OF ILLINOIS DEPARTMENT OF TRANSPORTATION	EXISTING AND PROPOSED ROADWAY PLAN				F.A.P RTE.	SECTION		COUNTY	TOTAL SHEETS	SHEET NO.	
	DRAWN   -	REVISED   -		U.S. ROUTE 20 (EAST OF PROSPECT ST. TO WEST OF UNION RD.)				525	2024-1026-RS		MCHENRY	24	7	
	CHECKED   -	REVISED   -						CONTRACT NO. 62X68						
PLOT DATE     = 3/6/2025	DATE   -	REVISED   -		SCALE: 1"=50'     SHEET 2     OF 3     SHEETS     STA. 39+00.00     TO STA. 69+00.00				ILLINOIS   FED. AID PROJECT						

MODEL: ExCL - Plan 3 [Sheet]  
FILE NAME: c:\pw\_work\pwltd\kalorm\ld1037510\ID105925-shi-plan.dgn





- (A) PROPOSED CURB RAMP IMPROVEMENT,  
SEE SIDEWALK DETAIL PLAN
- (B) PROPOSED CURB RAMP IMPROVEMENT,  
SEE PD-01A
- (C) PROPOSED CURB RAMP IMPROVEMENT,  
SEE PD-01B
- (D) PROPOSED CURB RAMP IMPROVEMENT,  
SEE PD-04A

- ① THERMOPLASTIC PAVEMENT MARKING - LETTERS & SYMBOLS WHITE (TYP.)
- ② THERMOPLASTIC PAVEMENT MARKING - LINE 4" SKIP-DASH YELLOW CENTERLINE, 10' DASH - 30" SKIP (TYP.)
- ③ THERMOPLASTIC PAVEMENT MARKING - LINE 4" DOUBLE SOLID YELLOW LINE, 2 @ 11" C-C (TYP.)
- ④ THERMOPLASTIC PAVEMENT MARKING - LINE 4" SOLID WHITE EDGE LINE (TYP.)
- ⑤ THERMOPLASTIC PAVEMENT MARKING - LINE 6" DOTTED WHITE TURN LANE LINE, 2' DASH - 6" SKIP (TYP.)
- ⑥ THERMOPLASTIC PAVEMENT MARKING - LINE 6" SOLID WHITE TURN LANE LINE (TYP.)
- ⑦ THERMOPLASTIC PAVEMENT MARKING - LINE 12" SOLID 45° DIAGONAL YELLOW LINE (TYP.)
- ⑧ THERMOPLASTIC PAVEMENT MARKING - LINE 24" SOLID WHITE STOP BAR LINE (TYP.)
- ⑨ HOT SPRAY THERMOPLASTIC PAVEMENT MARKING - LINE 4" SKIP-DASH YELLOW CENTERLINE, 10' DASH - 30" SKIP (TYP.)
- ⑩ HOT SPRAY THERMOPLASTIC PAVEMENT MARKING - LINE 4" DOUBLE SOLID YELLOW LINE, 2 @ 11" C-C (TYP.)

1. USE HOT SPRAY THERMOPLASTIC PAVEMENT MARKING AT THE LOCATIONS OF THE PROPOSED CENTERLINE RUMBLE STRIPS, 16".
2. ALL RAISED REFLECTIVE PAVEMENT MARKERS SHALL BE PLACED IN ACCORDANCE WITH TC-11 "TYPICAL APPLICATIONS RAISED REFLECTIVE PAVEMENT MARKERS (SNOW-PLOW RESISTANT)" STANDARD DETAIL.
3. SEE D1 DETAIL BD-55, RUMBLE STRIPS FOR CENTERLINE, NON - FREEWAY FOR DETAILS.
4. ALL PAVEMENT MARKINGS SHALL BE PLACED IN ACCORDANCE WITH TC-13 "DISTRICT ONE TYPICAL PAVEMENT MARKINGS" STANDARD DETAIL.
5. ALL MAILBOX TUNOUTS ARE TO BE MILLED AND RESURFACED.

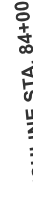

**STATE OF ILLINOIS**  
**DEPARTMENT OF TRANSPORTATION**

SCALE: 1"=50'	SHEET 3	OF 3	SHEETS	STA. 69+00.00	TO STA. 89+16.09
---------------	---------	------	--------	---------------	------------------

MODEL: EXCL - Plan 5 [Sheet]  
FILE NAME: c:\pw\_work\pwdot\kalorm\1037510\105925-sht-plan.dgn





CP #4

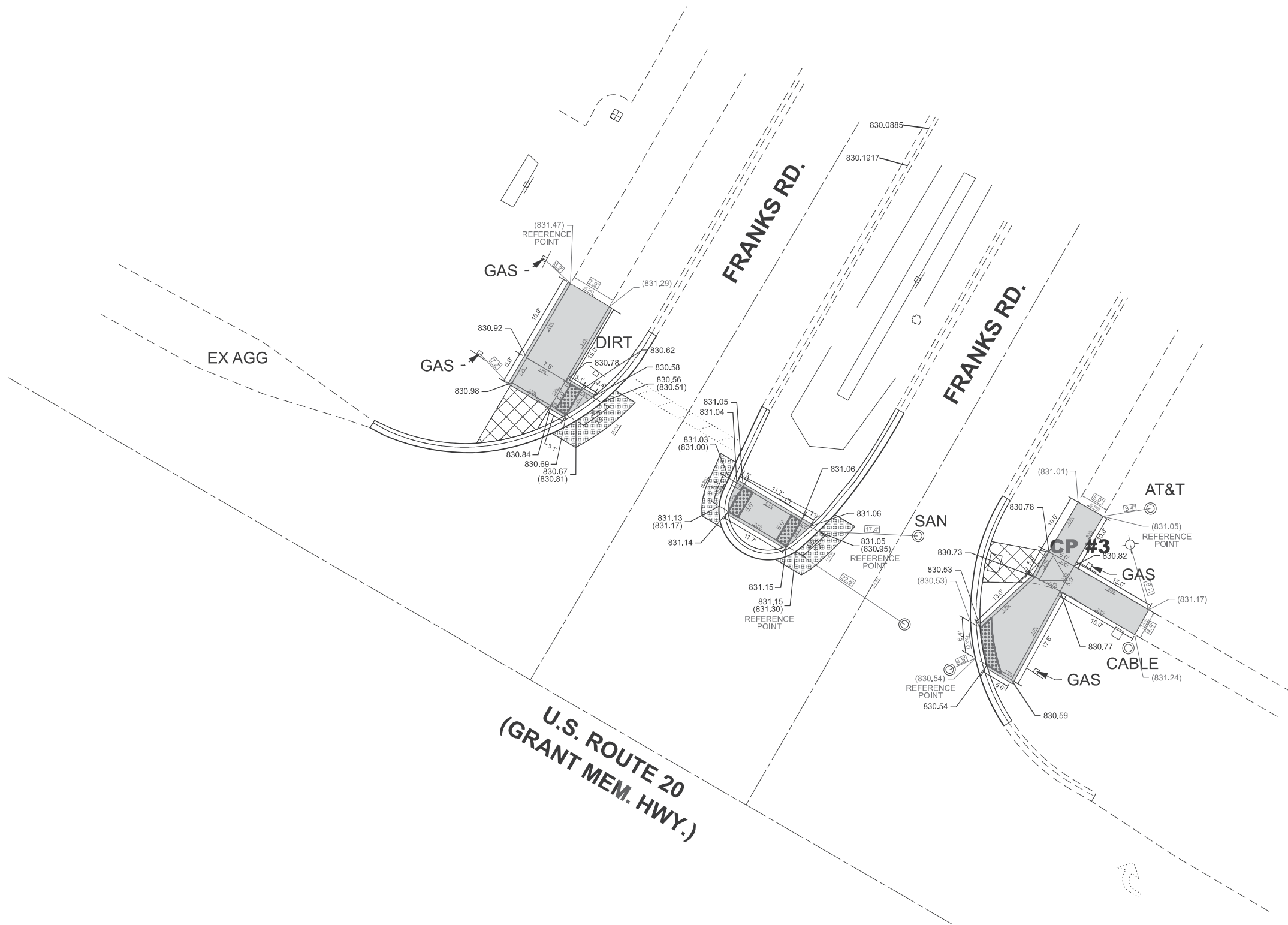

**LEGEND**

XX.XX'

EXISTING LENGTH

PROPOSED SIDE CURB

( )

EXISTING ELEVATION/SLOPE



PROPOSED SIDEWALK



DETECTABLE WARNINGS



SIDEWALK REMOVAL  
REPLACE W/TOPSOIL & SOD



CLASS D PATCH

BM - BOLT W/ ARROW IN FIRE HYDRANT ON E. SIDE OF FRANKS RD ± 175' N. OF US 20:  
EL. 831.17

USER NAME	= Rana.Kalo	DESIGNED	-	REVISED	-
DRAWN	-	CHECKED	-	REVISED	-
DATE	-	DATE	-	REVISED	-
PLOT DATE	= 1/14/2025				

STATE OF ILLINOIS  
DEPARTMENT OF TRANSPORTATION

ADA DETAILS PLAN SHEET  
U.S. ROUTE 20 (EAST OF PROSPECT ST. TO WEST OF UNION RD.)

SCALE: NONE SHEET 2 OF 2 SHEETS STA. TO STA.

F.A.P RTE.	SECTION	COUNTY	TOTAL SHEETS	SHEET NO.
525	2024-1026-RS	MCHENRY	24	10
CONTRACT NO. 62X68				
ILLINOIS FED. AID PROJECT				



1. DRIVEWAY SLOPES, LOCATIONS, & GEOMETRIC LAYOUT SHALL BE IN ACCORDANCE WITH THE LATEST EDITION OF THE "HANDBOOK FOR POLICY ON PERMITS FOR ACCESS DRIVEWAYS TO STATE HIGHWAYS". FOR FURTHER LAYOUT REQUIREMENTS, REFER TO ILLUSTRATIONS IN THE PERMIT HANDBOOK. DRIVEWAYS SHALL BE REPLACED IN KIND, UNLESS OTHERWISE NOTED ON THE PLANS.
2. COMMERCIAL DRIVEWAYS SHALL BE CONSTRUCTED WITH CONCRETE CURB, TYPE B RETURNS EXCEPT WHEN THE SIDEWALK EDGE IS 4 FEET (1.2 METERS) OR LESS FROM THE BACK OF CURB, CONSTRUCT A FLARE DRIVEWAY WITHOUT CURB.



MODEL: BD-1 [Sheet]  
FILE NAME: c:\pw work\pwidot\kalorm\d1037510\ID105925-sht-DistSids.dgn

F.A.P RTE.	SECTION	COUNTY	TOTAL SHEETS	SHEET NO.
525	2024-1026-RS	MCHENRY	24	11
<b>BD400-01 (BD-01)</b>		CONTRACT NO. 62X68		
ILLINOIS		FED. AID PROJECT		

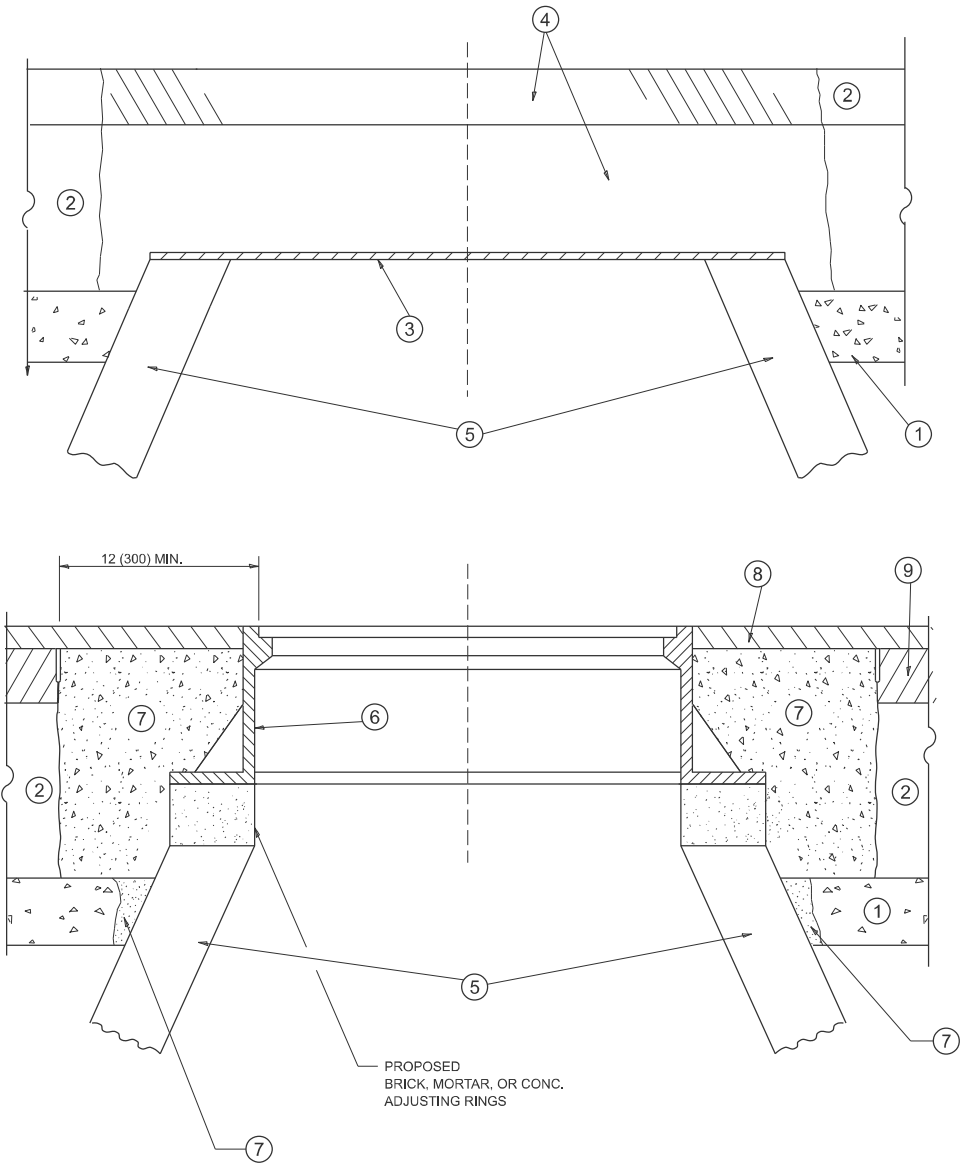

**DETAILS FOR FRAMES AND LIDS ADJUSTMENT  
WITH MILLING**

**NOTES**

- EXISTING BROKEN FRAMES AND LIDS SHALL BE REMOVED AND DISPOSED OF BY THE CONTRACTOR AND SHALL BE REPLACED AS DIRECTED BY THE ENGINEER. REPLACEMENT FRAMES AND LIDS WILL BE PAID FOR IN ACCORDANCE WITH ARTICLE 109.04 OF THE STANDARD SPECIFICATIONS UNLESS A SEPARATE PAY ITEM HAS BEEN PROVIDED.
- IF THE EXISTING LIDS ARE OPEN, THE FRAME WILL BE ADJUSTED TO THE ELEVATION OF THE MILLED PAVEMENT SURFACE PRIOR TO THE MILLING OPERATION. THE FRAME WILL NOT BE REMOVED AND COVERED BY THE METAL PLATE.
- CITY OF CHICAGO CASTINGS ARE THE PROPERTY OF THE CITY AND THE CONTRACTOR SHALL NOTIFY THE CITY FOR REMOVAL AND DISPOSITION OF THE CASTINGS.
- THE METAL PLATE USED TO COVER THE STRUCTURE SHALL REMAIN THE PROPERTY OF THE CONTRACTOR.
- THE CONTRACTOR SHALL REMOVE ALL TRAFFIC CONTROL DEVICES BY THE END OF EACH WORK SHIFT.

**CONSTRUCTION PROCEDURES**

- STAGE 1** (BEFORE PAVEMENT MILLING)
- REMOVE A MINIMUM OF 12 (300) OF THE PAVEMENT FROM AROUND THE STRUCTURE.
  - REMOVE THE EXISTING FRAME AND LID FROM THE STRUCTURE.
  - COVER THE STRUCTURE OPENING WITH A 36 (900) DIAMETER METAL PLATE.
  - BACKFILL WITH CRUSHED STONE AND HMA SURFACE MIX APPROVED BY THE ENGINEER. (MIN. 3 (80) HMA TO REMAIN AFTER MILLING).

- STAGE 2** (AFTER PAVEMENT MILLING)
- REMOVE THE HMA SURFACE MIX AND CRUSHED STONE.
  - INSTALL THE FRAME AND LID; ADJUST THE FRAME TO ITS FINAL SURFACE ELEVATION.
  - THE SURROUNDING SPACE SHALL BE FILLED WITH CLASS PP-2\* CONCRETE TO THE ELEVATION OF THE SURFACE OF THE EXISTING BASE COURSE OR THE BINDER COURSE.

\*UNLESS OTHERWISE SPECIFIED IN THE PLANS.

THE PROCEDURE EXPLAINED ABOVE SHALL CONFORM TO THE APPLICABLE PORTIONS OF SECTIONS 353, 406, 602, AND 603 OF THE STANDARD SPECIFICATIONS EXCEPT THAT "THE CONTRACTOR SHALL ADJUST THE STRUCTURES TO THE FINISHED PAVEMENT ELEVATION NO MORE THAN 5 CALENDAR DAYS PRIOR TO PLACEMENT OF THE FINAL LIFT OF SURFACE UNLESS APPROVED BY THE ENGINEER."

**LEGEND**

- |  |                               |
|--|-------------------------------|
| ① SUB-BASE GRANULAR MATERIAL                 | ⑥ FRAME AND LID (SEE NOTES)   |
| ② EXISTING PAVEMENT                          | ⑦ CLASS PP-2* CONCRETE        |
| ③ 36 (900) DIAMETER METAL PLATE              | ⑧ PROPOSED HMA SURFACE COURSE |
| ④ PROPOSED CRUSHED STONE AND HMA SURFACE MIX | ⑨ PROPOSED HMA BINDER COURSE  |
| ⑤ EXISTING STRUCTURE                         |                               |

**LOCATION OF STRUCTURES**

THE CONTRACTOR WILL BE REQUIRED TO KEEP A RECORD OF THE LOCATIONS OF THE BURIED STRUCTURES ACCORDING TO THE STATION AND DISTANCE LEFT OR RIGHT OF THE CENTERLINE OF PAVEMENT. UPON COMPLETION OF THE WORK, THE CONTRACTOR WILL DELIVER THE RECORD TO THE ENGINEER.

**BASIS OF PAYMENT**

- REMOVING FRAMES AND LIDS ON DRAINAGE AND UTILITY STRUCTURES IN THE PAVEMENT PRIOR TO MILLING, AND ADJUSTING TO FINAL GRADE PRIOR TO PLACING THE SURFACE COURSE, WILL BE PAID FOR AT THE CONTRACT UNIT PRICE EACH FOR "FRAMES AND LIDS TO BE ADJUSTED (SPECIAL)."
- THIS WORK WILL NOT BE PAID FOR WHEN DRAINAGE AND UTILITY STRUCTURES ARE SPECIFIED FOR PAYMENT AS STRUCTURE RECONSTRUCTION.
- NEW FRAMES AND LIDS, WHEN SPECIFIED, WILL BE PAID FOR SEPARATELY.
- WHEN STRUCTURES ARE TO BE ADJUSTED OR RECONSTRUCTED, THE LOWERING AND RAISING OF THE FRAMES AND LIDS WILL NOT BE PAID FOR SEPARATELY BUT WILL BE INCLUDED IN THE COST OF THE CORRESPONDING PAY ITEM.

ALL DIMENSIONS ARE IN INCHES (MILLIMETERS) UNLESS OTHERWISE SHOWN

**STATE OF ILLINOIS  
DEPARTMENT OF TRANSPORTATION**

**DETAILS FOR  
FRAMES AND LIDS ADJUSTMENT WITH MILLING**

SCALE: NONE SHEET 1 OF 1 SHEETS STA. TO STA.

F.A.P. RTE.	SECTION	COUNTY	TOTAL SHEETS	SHEET NO.
525	2024-1026-RS	MCHENRY	24	12
BD600-03 (BD-08)		CONTRACT NO. 62X68		
ILLINOIS		FED. AID PROJECT		

METHOD OF MEASUREMENT

REFER TO SECTION 442 OF THE STANDARD SPECIFICATIONS FOR ROAD AND BRIDGE CONSTRUCTION AND THE RECURRING SPECIAL PROVISION "PATCHING WITH HOT-MIX ASPHALT OVERLAY REMOVAL."

BASIS OF PAYMENT

- 1. REFER TO SECTION 442 OF THE STANDARD SPECIFICATIONS FOR ROAD AND BRIDGE CONSTRUCTION AND THE RECURRING SPECIAL PROVISION "PATCHING WITH HOT-MIX ASPHALT OVERLAY REMOVAL."
- 2. SAW CUT/SCORING OF EXISTING HMA OVERLAY IS INCLUDED IN THE COST OF PAVEMENT PATCHING.
- 3. SAW CUT/SCORING OF EXISTING PAVEMENT IS INCLUDED IN THE COST OF PAVEMENT PATCHING.

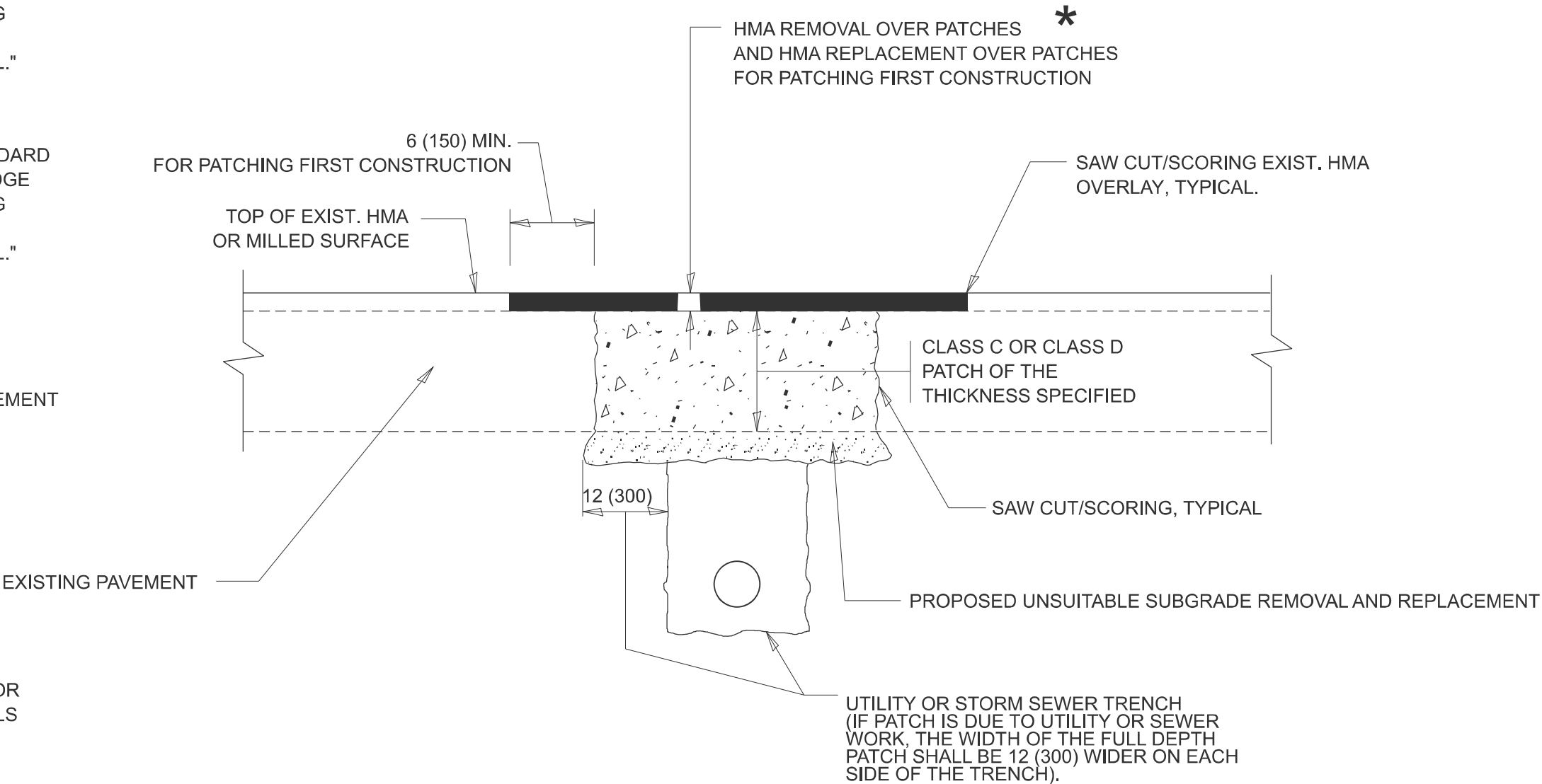

SEQUENCE OF CONSTRUCTION (PATCHING FIRST)

- 1. REMOVE THE EXISTING HMA MATERIAL OVER THE AREA TO BE PATCHED.
- 2. REMOVE AND REPLACE WITH CLASS C OR D PATCH.
- 3. REPLACE HMA MATERIAL OVER THE AREA TO BE PATCHED.

SEQUENCE OF CONSTRUCTION (MILLING FIRST)

- 1. MILL HMA FIRST IF THERE IS AT LEAST 4 1/2 INCHES OR MORE OF HMA MATERIAL ON TOP OF THE EXISTING PAVEMENT OR IF THE PAVEMENT IS FULL DEPTH HMA. A MINIMUM OF 2 INCHES OF HMA MATERIAL SHALL BE IN PLACE AFTER MILLING.
- 2. REMOVE AND REPLACE WITH FULL DEPTH CLASS D PATCHES TO TOP OF MILLED SURFACE.

ALL DIMENSIONS ARE IN INCHES (MILLIMETERS) UNLESS OTHERWISE SHOWN.

MODEL: BD-22 (Sheet)  
FILE NAME: c:\pav\_work\pav\kalo\bdm\103751\01\105925-sh1-dist\stds.dgn

	USER NAME = Rana.Kalo	DESIGNED - R. SHAH	REVISED - R. BORO 01-01-07	STATE OF ILLINOIS DEPARTMENT OF TRANSPORTATION	PAVEMENT PATCHING FOR HMA SURFACED PAVEMENT			F.A. RTE.	SECTION	COUNTY	TOTAL SHEETS	SHEET NO.
		DRAWN -	REVISED - R. BORO 09-04-07					525	2024-1026-RS	MCHERNY	24	13
		CHECKED -	REVISED - K. ENG 10-27-08		BD400-04 (BD-22)			CONTRACT NO. 62X68				
	PLOT DATE = 2/13/2025	DATE - 10-25-94	REVISED - K. SMITH 11-18-22		SCALE: NONE	SHEET 1	OF 1 SHEETS	STA.	TO STA.	ILLINOIS   FED. AID PROJECT		



MODEL: BD-32 [Sheet]  
FILE NAME: c:\pav\_work\pav\tdot\kabr\mtd103751\01D105925-sh1-Dist5tds.dgn

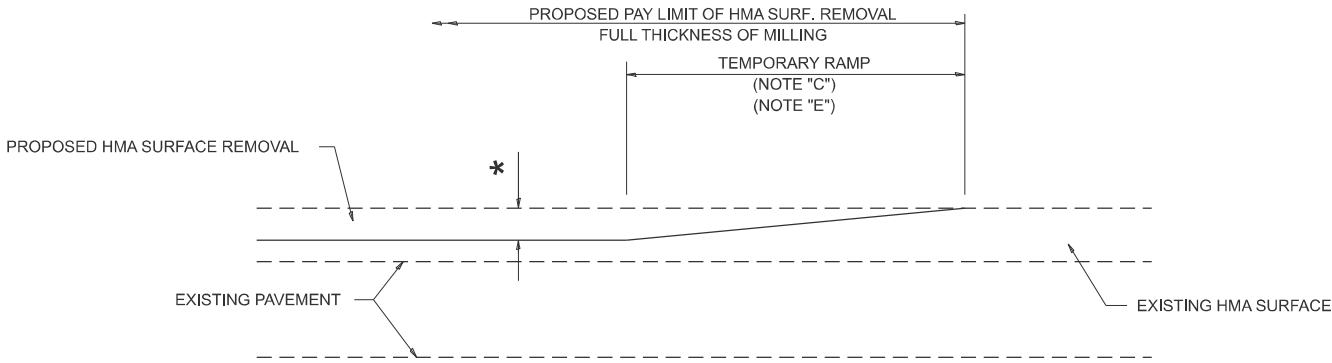

**MILLED TEMPORARY RAMP**  
(FOR BUTT JOINT AND HMA TAPER SEE DETAIL BELOW)

**OPTION 1**

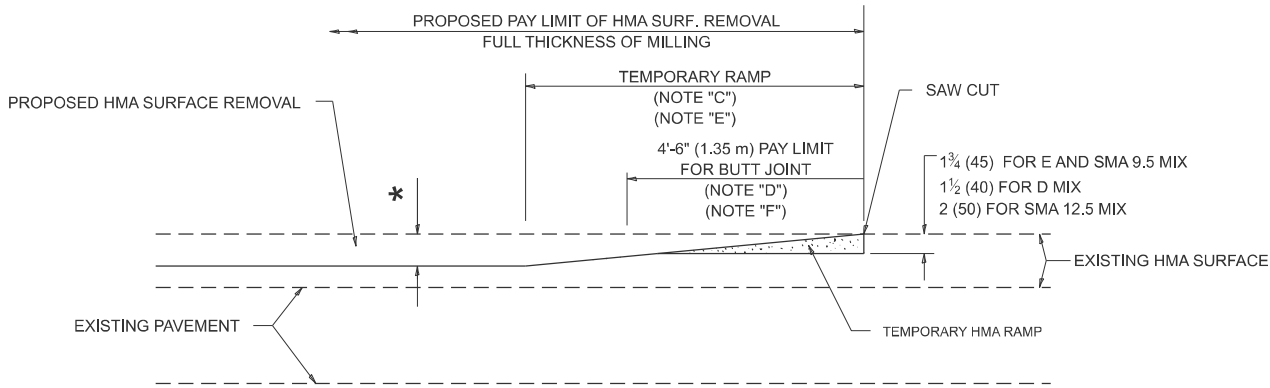

**HMA CONSTRUCTED TEMPORARY RAMP**  
(FOR BUTT JOINT AND HMA TAPER SEE DETAIL BELOW)

**OPTION 2**

**TYPICAL TEMPORARY RAMP**

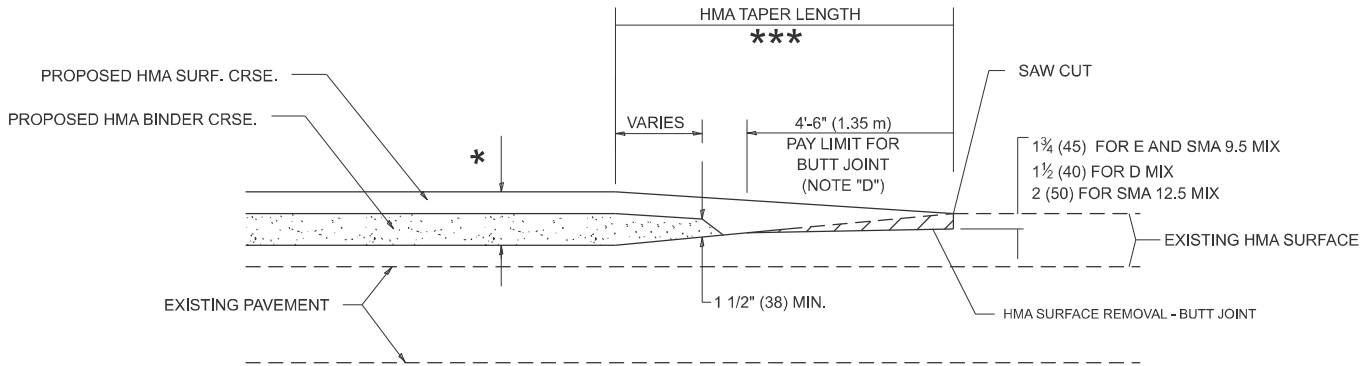

**BUTT JOINT AND  
HMA TAPER**

**TYPICAL BUTT JOINT AND HMA TAPER  
FOR MILLING AND RESURFACING**

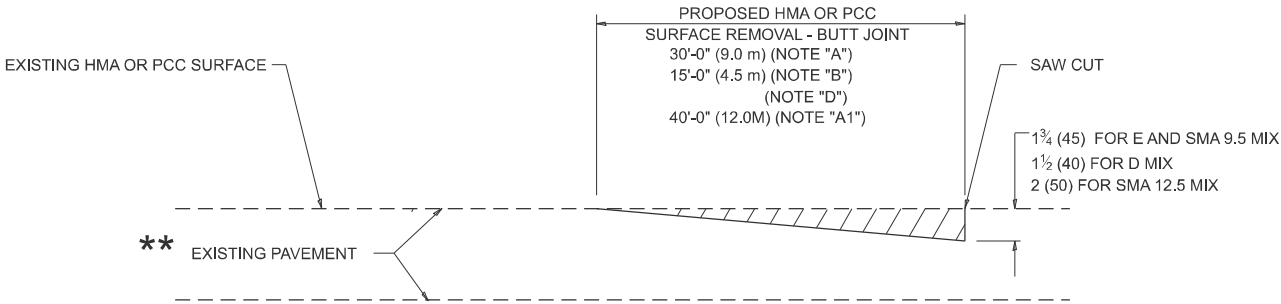

**BUTT JOINT DETAIL**

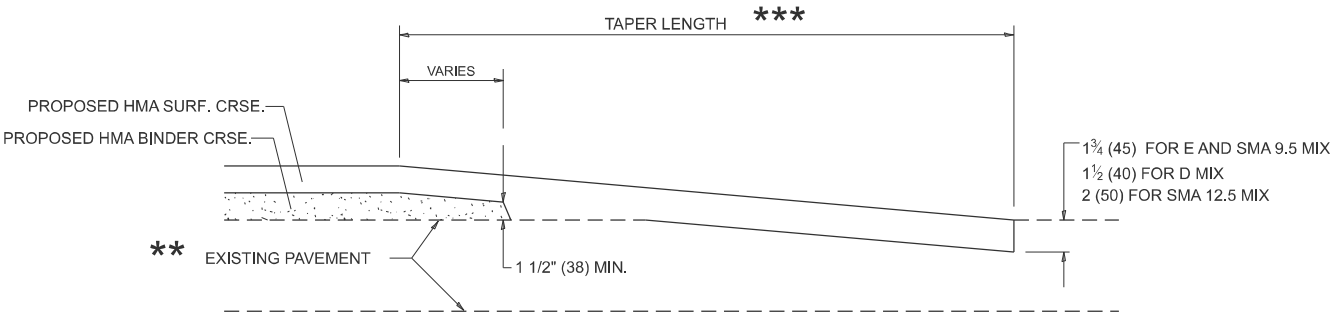

**HMA TAPER DETAIL**

**TYPICAL BUTT JOINT AND HMA TAPER  
FOR RESURFACING ONLY**

\*\* PC CONCRETE, HMA OR HMA RESURFACED PAVEMENT.

**GENERAL NOTES**

- A. MAINLINE ARTERIAL ROADWAYS AND MAJOR SIDE ROADS.
- A1. INTERSTATES
- B. MINOR SIDE ROADS.
- C. THE TEMP. RAMP SHALL BE CONSTRUCTED IMMEDIATELY UPON REMOVAL OF THE EXISTING HMA SURFACE.
- D. THE BUTT JOINT SHALL BE CONSTRUCTED IMMEDIATELY PRIOR TO PLACING THE PROPOSED HMA COURSES.
- E. TAPER THE TEMP. RAMP AT A RATE OF 3' - 4" (1.02m) PER 1 INCH (25 mm) OF MILLING THICKNESS.  
\* SEE TYPICAL SECTIONS FOR MILLING THICKNESS.
- F. SEE ARTICLE 406.08 AND 406.14 OF THE STANDARD SPECIFICATIONS FOR "HMA AND/OR PCC SURFACE REMOVAL, BUTT JOINT".  
\*\*\*  
20'-0" (6.1 m) PER 1 (25) RESURFACING (NOTE "A")  
10'-0" (3.0 m) PER 1 (25) RESURFACING (NOTE "B")

**BASIS OF PAYMENT**

1. THE BUTT JOINT WILL BE PAID FOR AT THE CONTRACT UNIT PRICE PER SQUARE YARD (SQUARE METER) FOR "HOT-MIX ASPHALT SURFACE REMOVAL - BUTT JOINT" OR FOR "PORTLAND CEMENT CONCRETE SURFACE REMOVAL- BUTT JOINT".
2. THE TEMPORARY RAMP AND SAW CUT SHALL BE INCLUDED IN THE UNIT COST FOR HMA OR PCC SURFACE REMOVAL-BUTT JOINT.

ALL DIMENSIONS ARE IN INCHES (MILLIMETERS) UNLESS OTHERWISE SHOWN.

USER NAME = Rana,Kalo	DESIGNED - M. DE YONG	REVISED - A. ABBAS 03-21-97
	DRAWN -	REVISED - M. GOMEZ 04-06-01
	CHECKED -	REVISED - R. BORO 01-01-07
PLOT DATE = 2/13/2025	DATE - 06-13-90	REVISED - K. SMITH 11-18-22

STATE OF ILLINOIS  
DEPARTMENT OF TRANSPORTATION

**BUTT JOINT AND  
HMA TAPER DETAILS**

SCALE: NONE SHEET 1 OF 1 SHEETS STA. TO STA.

F.A.P. RTE.	SECTION	COUNTY	TOTAL SHEETS	SHEET NO.
525	2024-1026-RS	MCHENRY	24	15
BD400-05 BD-32		CONTRACT NO. 62X68		
		ILLINOIS	FED. AID PROJECT	





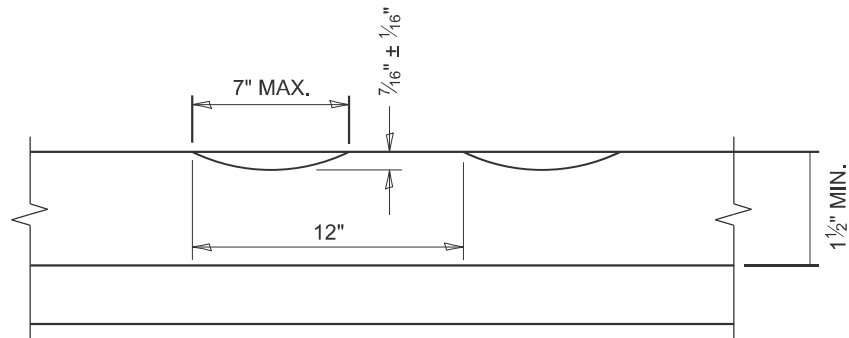

**SECTION A-A**

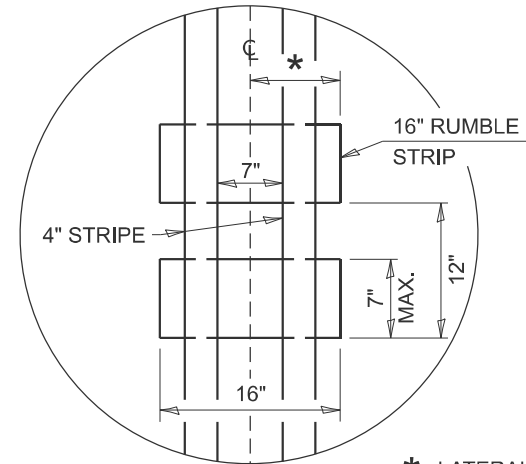

\* LATERAL DEVIATION SHALL NOT EXCEED ONE INCH IN 100 FEET.

**DETAIL B**

**GENERAL NOTES**

- CENTERLINE RUMBLE STRIPS SHALL BE CONSTRUCTED ACCORDING TO SECTION 642 ALONG THE CENTERLINE OF PAVEMENT.
- SEE STANDARD 780001 FOR OTHER STRIPING LAYOUTS.
- RUMBLE STRIPS SHALL NOT BE PLACED ON BRIDGES.
- ALL RUMBLE STRIPS SHALL BE MILLED.
- CENTERLINE RUMBLE STRIPS SHALL BE CONTINUOUS THROUGH CONNECTIONS OF SIDEROADS WITH NO LEFT TURN LANES.
- DISCONTINUE CENTERLINE RUMBLE STRIPS THROUGH THE LIMITS OF ALL LEFT TURN LANES, INCLUDING ANY LANE TAPER SECTIONS.
- AFTER RUMBLE STRIPS ARE INSTALLED, THE PAVEMENT SURFACE SHALL BE SWEEPED CLEAN PRIOR TO THE PLACEMENT OF THE NEW PAVEMENT MARKINGS.
- WHERE USED, ADJUST SPACING OF RAISED REFLECTIVE PAVEMENT MARKERS TO FALL IN WIDER GAP BETWEEN RUMBLE STRIPS.

**BASIS OF PAYMENT**

- THIS WORK WILL BE PAID FOR AT THE CONTRACT UNIT PRICE PER FOOT FOR CENTERLINE-RUMBLE STRIP OF THE WIDTH SPECIFIED.
- HOT-SPRAY THERMOPLASTIC PAVEMENT MARKING WILL BE USED OVER THE RUMBLE STRIPS, AND WILL BE PAID FOR SEPARATELY.

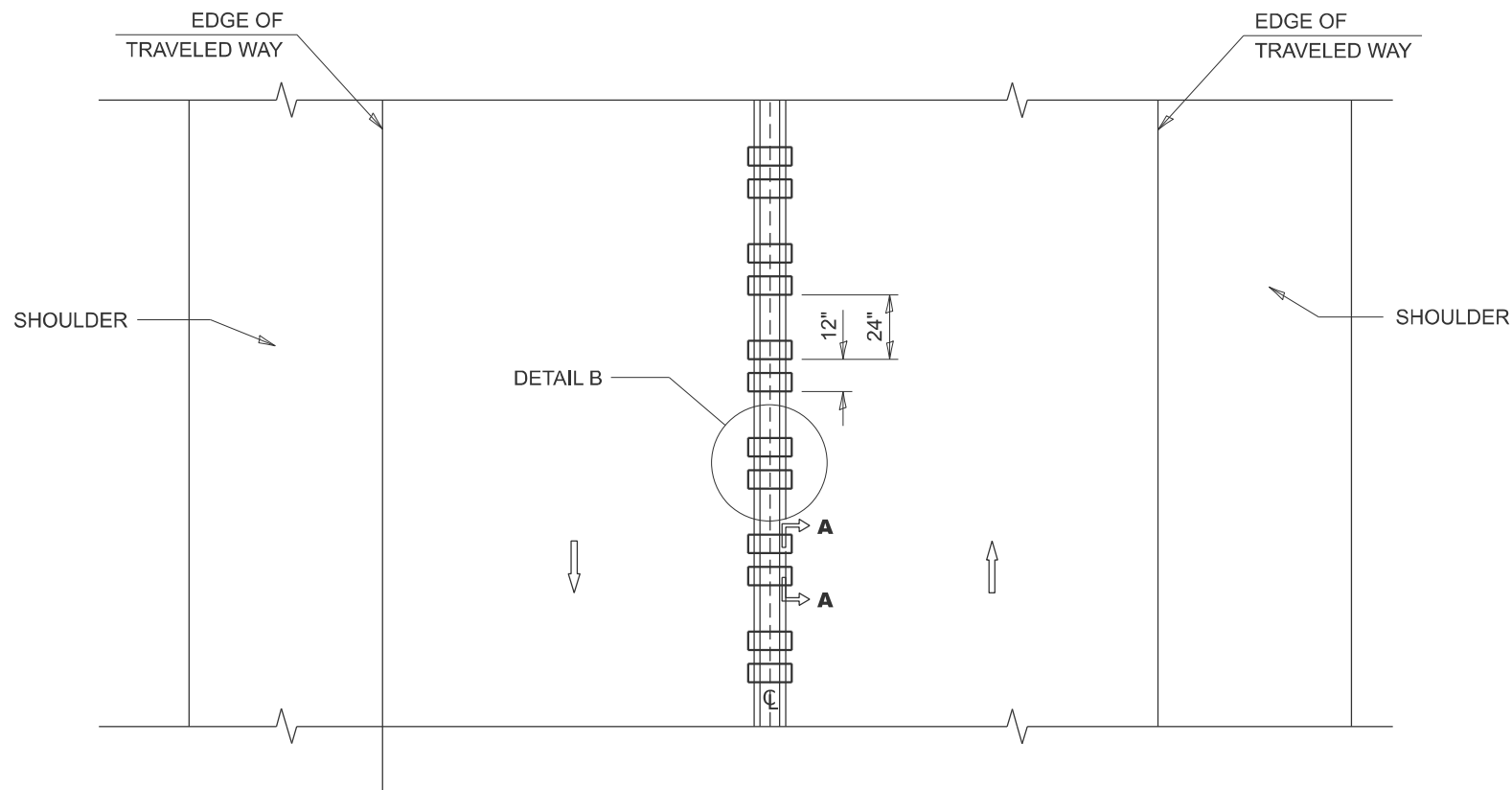

**TWO-WAY ROAD**

STATE OF ILLINOIS  
DEPARTMENT OF TRANSPORTATION

RUMBLE STRIPS FOR CENTERLINE, NON-FREEWAY

SCALE: NONE SHEET 1 OF 1 SHEETS STA. TO STA.

F.A.P. RTE.	SECTION	COUNTY	TOTAL SHEETS	SHEET NO.
525	2024-1026-RS	MCHENRY	24	17
BD 55		CONTRACT NO. 62X68		
		ILLINOIS	FED. AID PROJECT	

USER NAME = Rana.Kalo	DESIGNED - R. BORO	REVISED - K. SMITH 11-18-22
	DRAWN -	REVISED -
	CHECKED -	REVISED -
PLOT DATE = 2/13/2025	DATE - 08-06-2012	REVISED -

MODEL: TC-10 [Sheet]  
FILE NAME: c:\p\work\pwtol\kalb\mtd103751\01D105925-sh1-DistStd.sgm

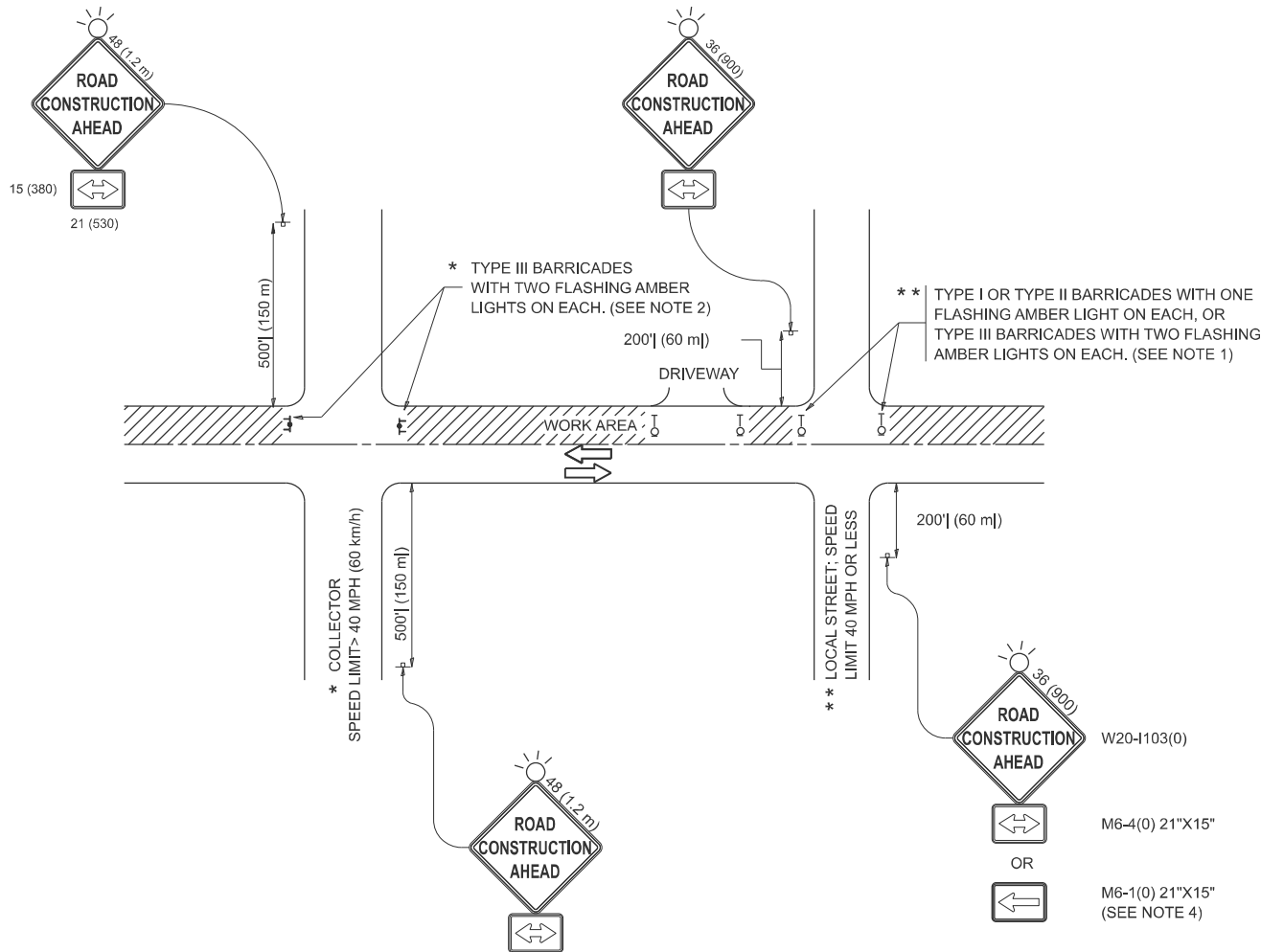

**NOTES:**

- SIDE ROAD WITH A SPEED LIMIT OF 40 MPH (60 km/h) OR LESS AS SHOWN ON THE DRAWING AND AS DIRECTED BY THE ENGINEER:
  - ONE "ROAD CONSTRUCTION AHEAD" SIGN 36 x 36 (900x900) WITH A FLASHER MOUNTED ON IT APPROXIMATELY 200' (60 m) IN ADVANCE OF THE MAIN ROUTE.
  - THE CLOSED PORTION OF THE MAIN ROUTE SHALL BE PROTECTED BY BLOCKING WITH TYPE I, TYPE II OR TYPE III BARRICADES, 1/3 OF THE CROSS SECTION OF THE CLOSED PORTION.
- SIDE ROAD WITH A SPEED LIMIT GREATER THAN 40 MPH (60 km/h) AS SHOWN ON THE DRAWING AND AS DIRECTED BY THE ENGINEER:
  - ONE "ROAD CONSTRUCTION AHEAD" SIGN 48 x 48 (1.2 m x 1.2 m) WITH A FLASHER MOUNTED ON IT APPROXIMATELY 500' (150 m) IN ADVANCE OF THE MAIN ROUTE.
  - THE CLOSED PORTION OF THE MAIN ROUTE SHALL BE PROTECTED BY BLOCKING WITH TYPE III BARRICADES, 1/2 OF THE CROSS SECTION OF THE CLOSED PORTION.
- CONES MAY BE SUBSTITUTED FOR BARRICADES OR DRUMS AT HALF THE SPACING DURING DAY OPERATIONS. CONES SHALL BE A MINIMUM OF 28 (710) IN HEIGHT.
- WHEN THE SIDE ROAD LIES BETWEEN THE BEGINNING OF THE MAINLINE SIGNING AND THE WORK ZONE, A SINGLE HEADED ARROW (M6-1) SHALL BE USED IN LIEU OF THE DOUBLE HEADED ARROW (M6-4).
- WHEN WORK IS BEING PERFORMED ON A SIDE ROAD OR DRIVEWAY, FOLLOW THE APPLICABLE STANDARD(S). THE DIRECTIONAL ARROW (M6-1 OR M6-4) SHALL BE COVERED OR REMOVED WHEN NO LONGER CONSISTENT WITH THE TRAFFIC CONTROL SET-UP.
- ADVANCE WARNING SIGNS ARE TO BE OMITTED ON DRIVEWAYS UNLESS OTHERWISE SPECIFIED IN THE PLANS OR BY THE ENGINEER.
- THE TRAFFIC CONTROL AND PROTECTION FOR SIDE ROADS, INTERSECTIONS, AND DRIVEWAYS SHALL BE INCLUDED IN THE COST OF SPECIFIED TRAFFIC CONTROL STANDARDS OR ITEMS.

All dimensions are in inches (millimeters)  
unless otherwise shown.

	USER NAME	= Rana.Kalo	DESIGNED	-	L.H.A.	REVISED	-	T. RAMMACHER 01-06-00	STATE OF ILLINOIS DEPARTMENT OF TRANSPORTATION	TRAFFIC CONTROL AND PROTECTION FOR SIDE ROADS, INTERSECTIONS, AND DRIVEWAYS					F.A.P. RTE.	SECTION	COUNTY	TOTAL SHEETS	SHEET NO.
			DRAWN	-		REVISED	-	A. SCHUETZE 07-01-13							525	2024-1026-RS	MCHENRY	24	18
			CHECKED	-		REVISED	-	A. SCHUETZE 09-15-06							TC-10				
	PLOT DATE	= 2/13/2025	DATE	-	06-89	REVISED	-	D. SENDERAK 05-03-24		ILLINOIS   FED. AID PROJECT									
	SCALE:		SHEET		OF		SHEETS								STA.		TO STA.		

MODEL: TC-11 [Sheet]  
FILE NAME: c:\pwwork\pwwork\alorma\103751\0105925-shr-dist\stds.dgn

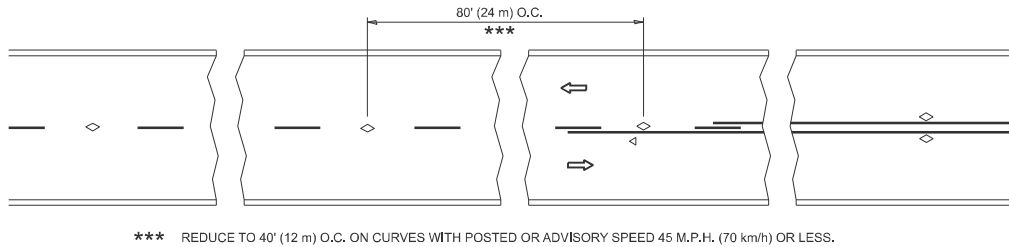

## TWO-LANE/TWO-WAY

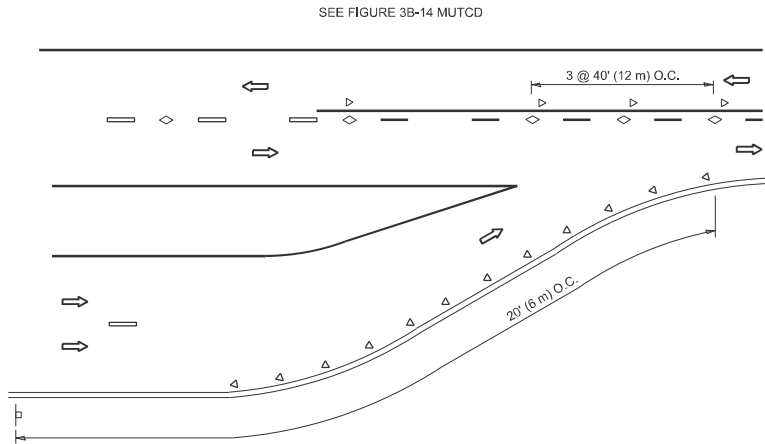

## LANE REDUCTION TRANSITION

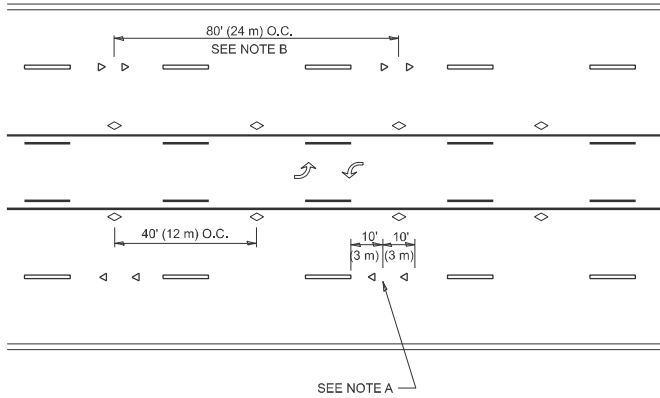

## TWO-WAY LEFT TURN

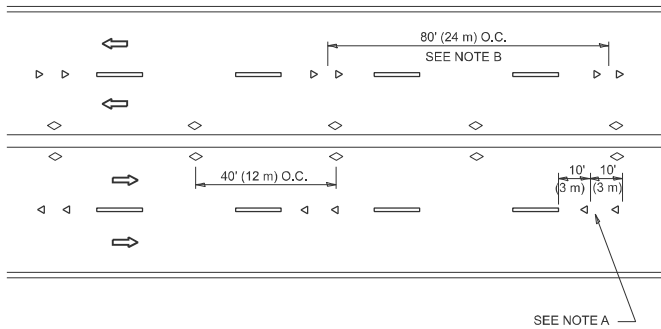

## MULTI-LANE/UNDIVIDED

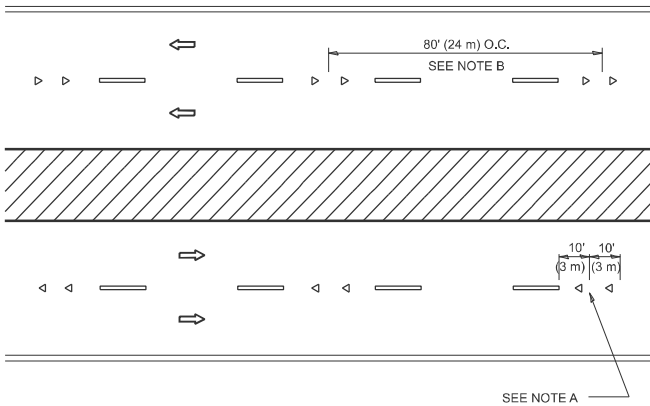

## MULTI-LANE/DIVIDED

## GENERAL NOTES

- MARKERS USED WITH DASHED LINES SHALL BE CENTERED IN THE GAP BETWEEN SEGMENTS.
- MARKERS USED ADJACENT TO SOLID LINES SHALL BE OFFSET 2 TO 3 (50 TO 75) TOWARD TRAFFIC AS SHOWN.
- MARKERS THROUGH TANGENTS LESS THAN 500' (150 m) IN LENGTH BETWEEN CURVES SHALL BE INSTALLED AT THE LESSER OF THE TWO CURVE SPACINGS.
- MARKERS ARE TO BE USED ADJACENT TO BOTH SOLID WHITE LINES IN DUAL LEFT TURN LANES

## SYMBOLS

- YELLOW STRIPE
- WHITE STRIPE
- ONE-WAY AMBER MARKER
- ONE-WAY CRYSTAL MARKER (W/O)
- TWO-WAY AMBER MARKER

## LANE MARKER NOTES

- USE DOUBLE LANE LINE MARKERS SPACED AS SHOWN.
- REDUCE TO 40' (12 m) O.C. ON CURVES WHERE ADVISORY SPEEDS ARE 10 M.P.H (20 km/h) LOWER THAN POSTED SPEEDS.

## DESIGN NOTES

- DOUBLE LANE LINE MARKERS SHALL BE USED UNLESS SPECIFIED OTHERWISE.
- EXCEPT AS SHOWN ON THE LANE REDUCTION TRANSITION AND FREEWAY EXIT RAMP DETAIL, MARKERS ARE NOT TO BE SPECIFIED ON RIGHT EDGE LINES.
- THE EXACT MARKER LIMITS, SPACING, AND COLOR SHALL BE INCLUDED IN THE PLANS WHEN STANDARD SPECIFICATIONS ARE NOT BEING USED.
- MARKERS SHOULD NOT BE USED ALONGSIDE CURBS EXCEPT FOR EXTREMELY SHORT SECTIONS OF CURBS WHERE NOT MORE THAN TWO MARKERS WOULD BE INVOLVED.

All dimensions are in inches (millimeters) unless otherwise shown.

MODEL: TC-11 [Sheet] FILE NAME: c:\pwwork\pwwork\alorma\103751\0105925-shr-dist\stds.dgn	USER NAME = Rana.Kalo	DESIGNED -	REVISED - T. RAMMACHER 03-12-99	STATE OF ILLINOIS DEPARTMENT OF TRANSPORTATION	TYPICAL APPLICATIONS RAISED REFLECTIVE PAVEMENT MARKERS (SNOW-PLOW RESISTANT)			F.A.P. RTE.	SECTION	COUNTY	TOTAL SHEETS	SHEET NO.
		DRAWN -	REVISED - T. RAMMACHER 01-06-00					525	2024-1026-RS	MCHENRY	24	19
		CHECKED -	REVISED - C. JUCIUS 09-09-09					TC-11		CONTRACT NO. 62X68		
	PLOT DATE = 2/13/2025	DATE -	REVISED - C. JUCIUS 07-01-13		SCALE: NONE	SHEET 1	OF 1 SHEETS	STA.	TO STA.	ILLINOIS FED. AID PROJECT		

MODEL: TC-13 (Sheet)  
FILE NAME: c:\paw\work\illinois\kb\m\103751\01D105925-sh-TypDistStds.dgn

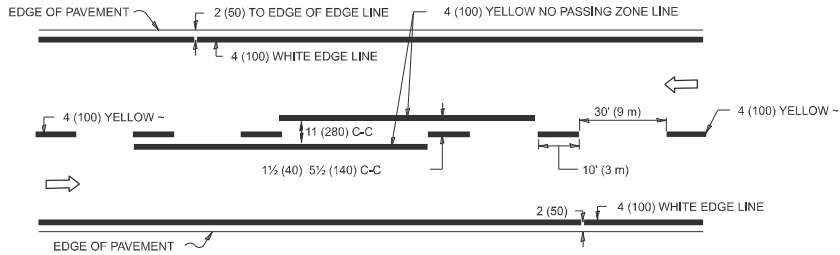

## 2-LANE ROADWAY

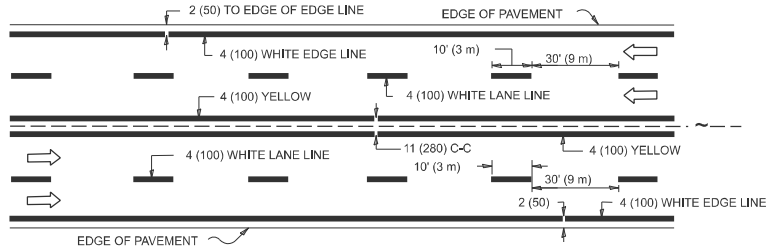

## MULTI-LANE UNDIVIDED

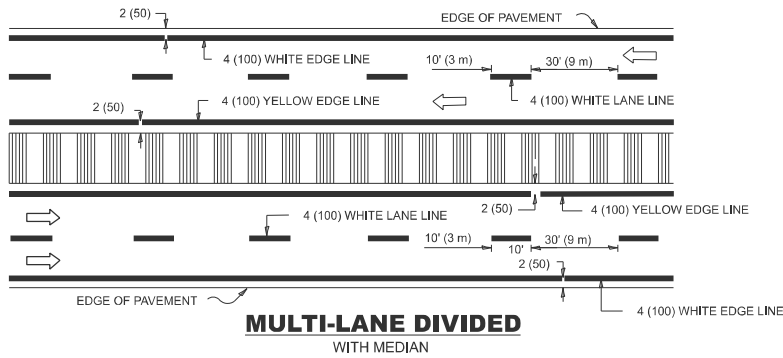

## MULTI-LANE DIVIDED WITH MEDIAN

## TYPICAL LANE AND EDGE LINE MARKING

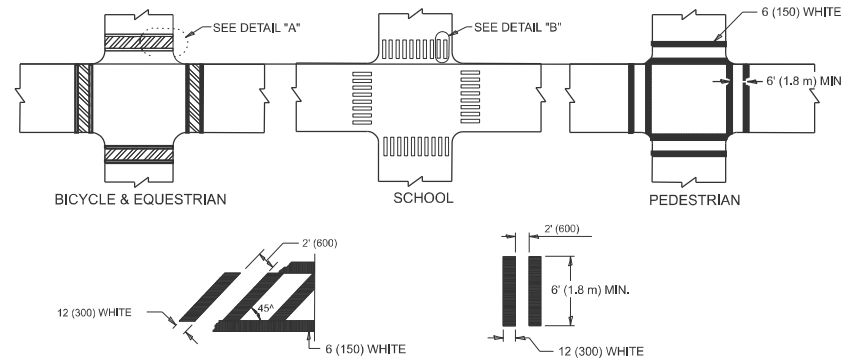

### DETAIL "A"

### DETAIL "B"

## TYPICAL CROSSWALK MARKING

\* MARKINGS SHALL BE INSTALLED PARALLEL TO THE CENTERLINE OF THE ROAD WHICH IT CROSSES

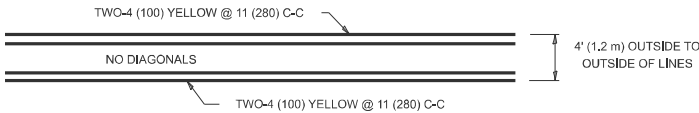

## 4' (1.2 m) WIDE MEDIANS ONLY

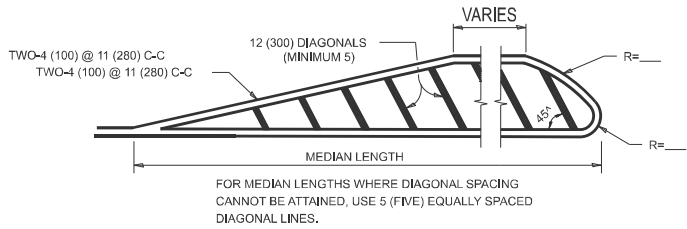

DIAGONAL LINE SPACING: 50' (15 m) C-C (LESS THAN 30MPH (50 km/h))  
75' (25 m) C-C 30MPH (50 km/h) TO 45MPH (70 km/h)  
150' (45 m) C-C (MORE THAN 45MPH (70 km/h))

## MEDIANS OVER 4' (1.2 m) WIDE

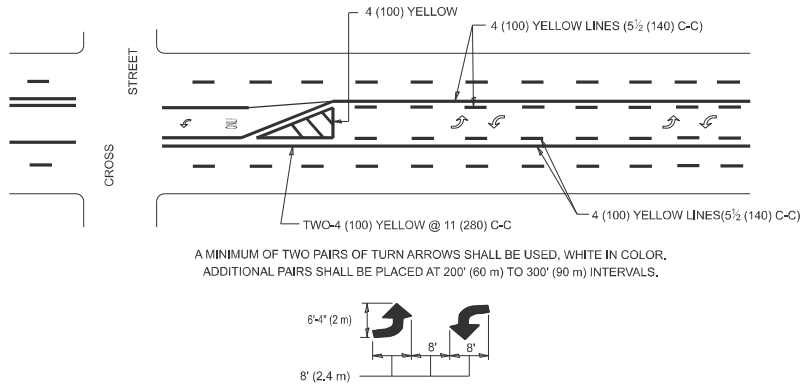

A MINIMUM OF TWO PAIRS OF TURN ARROWS SHALL BE USED, WHITE IN COLOR. ADDITIONAL PAIRS SHALL BE PLACED AT 200' (60 m) TO 300' (90 m) INTERVALS.

## MEDIAN WITH TWO-WAY LEFT TURN LANE

## TYPICAL PAINTED MEDIAN MARKING

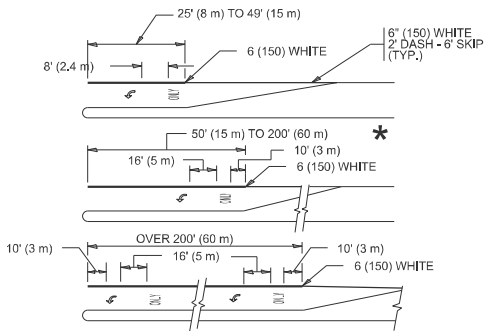

FULL SIZE LETTERS 8' (2.4 m) AND ARROWS SHALL BE USED.  
AREA = 15.6 SQ. FT. (1.5 m<sup>2</sup>) ONLY AREA = 20.8 SQ. FT. (1.9 m<sup>2</sup>)

\* TURN LANES IN EXCESS OF 400' (120 m) IN LENGTH MAY HAVE AN ADDITIONAL SET OF ARROW - "ONLY" INSTALLED MIDWAY BETWEEN THE OTHER TWO SETS OF ARROW - "ONLY".

## TYPICAL LEFT (OR RIGHT) TURN LANE

## TYPICAL TURN LANE MARKING

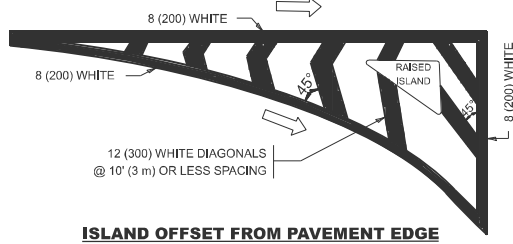

## ISLAND OFFSET FROM PAVEMENT EDGE

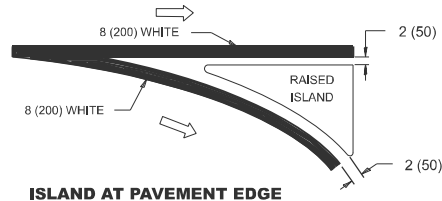

## ISLAND AT PAVEMENT EDGE

## TYPICAL ISLAND MARKING

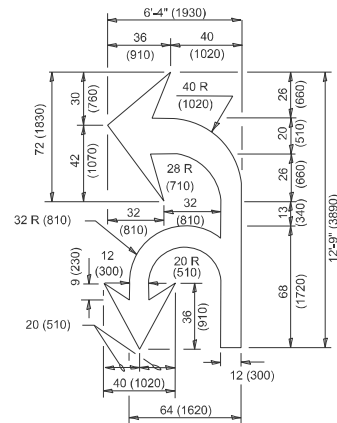

## COMBINATION LEFT AND U-TURN

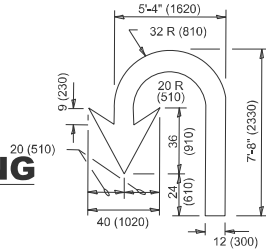

## U-TURN

## LANE REDUCTION TRANSITION

\* LANE REDUCTION ARROWS REQUIRED AT SPEEDS OF 45 MPH OR GREATER OR WHEN SPECIFIED IN PLANS.

TYPE OF MARKING	WIDTH OF LINE	PATTERN	COLOR	SPACING / REMARKS
CENTERLINE ON 2 LANE PAVEMENT	4 (100)	SKIP-DASH	YELLOW	10' (3 m) LINE WITH 30' (9 m) SPACE
CENTERLINE ON MULTI-LANE UNDIVIDED PAVEMENT	2 @ 4 (100)	SOLID	YELLOW	11 (280) C-C
NO PASSING ZONE LINES: FOR ONE DIRECTION FOR BOTH DIRECTIONS	4 (100) 2 @ 4 (100)	SOLID SOLID	YELLOW YELLOW	5 1/2 (140) C-C FROM SKIP-DASH CENTERLINE 11 (280) C-C OMIT SKIP-DASH CENTERLINE BETWEEN
LANE LINES	4 (100) 5 (125) ON FREEWAYS	SKIP-DASH SKIP-DASH	WHITE WHITE	10' (3 m) LINE WITH 30' (9 m) SPACE
DOTTED LINES (EXTENSIONS OF CENTER, LANE OR TURN LANE MARKINGS)	SAME AS LINE BEING EXTENDED	SKIP-DASH	SAME AS LINE BEING EXTENDED	2' (600) LINE WITH 6' (1.8 m) SPACE
EDGE LINES	4 (100)	SOLID	YELLOW-LEFT WHITE-RIGHT	OUTLINE MEDIANS IN YELLOW
TURN LANE MARKINGS	6 (150) LINE: FULL SIZE LETTERS & SYMBOLS (8' (2.4m))	SOLID	WHITE	SEE TYPICAL TURN LANE MARKING DETAIL
TWO WAY LEFT TURN MARKING	2 @ 4 (100) EACH DIRECTION 8' (2.4m) LEFT ARROW	SKIP-DASH AND SOLID IN PAIRS	YELLOW WHITE	10' (3 m) LINE WITH 30' (9 m) SPACE FOR SKIP-DASH: 5 1/2 (140) C-C BETWEEN SOLID LINE AND SKIP-DASH LINE SEE TYPICAL TWO-WAY LEFT TURN MARKING DETAIL
CROSSWALK LINES (PEDESTRIAN) A. DIAGONALS (BIKE & EQUESTRIAN) B. LONGITUDINAL BARS (SCHOOL)	2 @ 6 (150) 12 (300) @ 45° 12 (300) @ 90°	SOLID SOLID SOLID	WHITE WHITE WHITE	NOT LESS THAN 6' (1.8 m) APART 2' (600) APART 2' (600) APART SEE TYPICAL CROSSWALK MARKING DETAILS.
STOP LINES	24 (600)	SOLID	WHITE	PLACE 4' (1.2 m) IN ADVANCE OF AND PARALLEL TO CROSSWALK, IF PRESENT. OTHERWISE, PLACE AT DESIRED STOPPING POINT, PARALLEL TO CROSSROAD CENTERLINE, WHERE POSSIBLE
PAINTED MEDIANS	2 @ 4 (100) WITH 12 (300) DIAGONALS @ 45° NO DIAGONALS USED FOR 4' (1.2 m) WIDE MEDIANS	SOLID	YELLOW: TWO WAY TRAFFIC WHITE: ONE WAY TRAFFIC	11 (280) C-C FOR THE DOUBLE LINE SEE TYPICAL PAINTED MEDIAN MARKING.
GORE MARKING AND CHANNELIZING LINES	8 (200) WITH 12 (300) DIAGONALS @ 45°	SOLID	WHITE	DIAGONALS: 15' (4.5 m) C-C (LESS THAN 30MPH (50 km/h)) 20' (6 m) C-C 30MPH (50 km/h) TO 45MPH (70 km/h) 30' (9 m) C-C (OVER 45MPH (70 km/h))
RAILROAD CROSSING	24 (600) TRANSVERSE LINES: "RR" IS 6' (1.8 m) LETTERS: 16 (400) LINE FOR "X"	SOLID	WHITE	SEE STATE STANDARD 780001 AREA OF: *R*=3.6 SQ. FT. (0.33 m <sup>2</sup> ) EACH *X*=54.0 SQ. FT. (5.0 m <sup>2</sup> )
SHOULDER DIAGONALS (REQUIRED FOR SHOULDERS ≥ 8')	12 (300) @ 45°	SOLID	WHITE - RIGHT YELLOW - LEFT	50' (15 m) C-C (LESS THAN 30MPH (50 km/h)) 75' (25 m) C-C (30 MPH (50 km/h) TO 45MPH (70 km/h)) 150' (45 m) C-C (OVER 45MPH (70 km/h))
U TURN ARROW	SEE DETAIL	SOLID	WHITE	16.3 SF
2 ARROW COMBINATION LEFT AND U TURN	SEE DETAIL	SOLID	WHITE	30.4 SF

FOR FURTHER DETAILS ON PAVEMENT MARKING REFER TO  
STANDARD SPECIFICATIONS FOR ROAD AND BRIDGE  
CONSTRUCTION AND STATE STANDARD 780001.

All dimensions are in inches (millimeters)  
unless otherwise shown.

USER NAME = Rana.Kalo	DESIGNED - EVERS	REVISED - C. JUCIUS 09-09-09
	DRAWN -	REVISED - C. JUCIUS 07-01-13
	CHECKED -	REVISED - C. JUCIUS 12-21-15
PLOT DATE = 2/13/2025	DATE - 03-19-90	REVISED - C. JUCIUS 04-12-16

## STATE OF ILLINOIS DEPARTMENT OF TRANSPORTATION

## DISTRICT ONE TYPICAL PAVEMENT MARKINGS

SCALE: NONE SHEET 1 OF 1 SHEETS STA. TO STA.

F.A.P. RTE.	SECTION	COUNTY	TOTAL SHEETS	SHEET NO.
525	2024-1026-RS	MCHENRY	24	20
TC-13		CONTRACT NO. 62X68		
		ILLINOIS	FED. AID PROJECT	

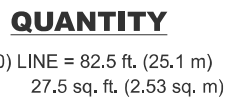
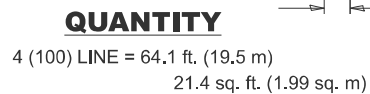
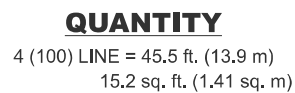

ALL QUANTITIES OF PLACEMENT ARE REPRESENTED  
IN LINEAR FEET OF 4" LINES TO MATCH THE  
4" TEMPORARY TAPE PAY ITEM AND REPRESENTS  
THE TOTAL QUANTITY OF 4" TAPE REQUIRED.

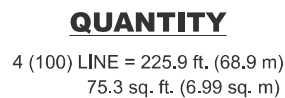

MODEL: TC-16 [Sheet]  
FILE NAME: c:\pw\_work\pwidot\kalorm\1037510\105925-sht-DistStds.dgn

USER NAME = Rana,Kalo	DESIGNED -	REVISED - T. RAMMACHER 03-02-98
	DRAWN -	REVISED - E. GOMEZ 08-28-00
	CHECKED -	REVISED - E. GOMEZ 08-28-00
PLOT DATE = 2/13/2025	DATE - 09-18-94	REVISED - A. SCHUETZE 09-15-16

**STATE OF ILLINOIS**  
**DEPARTMENT OF TRANSPORTATION**

## SHORT TERM PAVEMENT MARKING LETTERS AND SYMBOLS

SCALE: NONE	SHEET 1 OF 1 SHEETS	STA. TO STA.
-------------	---------------------	--------------

F.A.P RTE.	SECTION	COUNTY	TOTAL SHEETS	SHEET NO.
525	2024-1026-RS	MCHENRY	24	21
<b>TC-16</b>		CONTRACT NO. 62X68		
ILLINOIS		FED. AID PROJECT		

MODEL: TC-22 [Sheet]  
FILE NAME: c:\p\work\pwork\kalbom\1037510\105925-sh1-Dist5tds.dgn

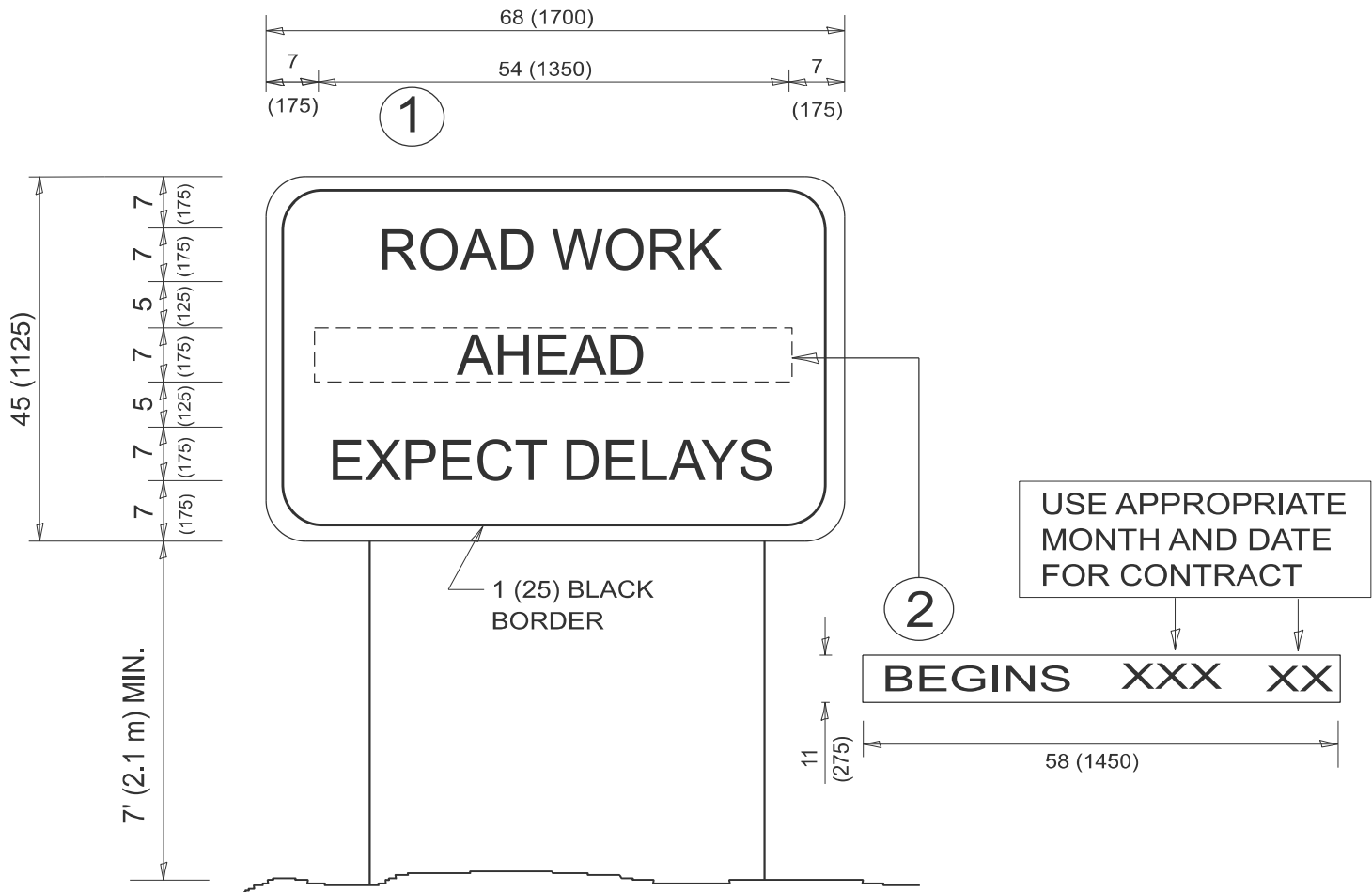

NOTES:

1. USE BLACK LETTERING ON ORANGE BACKGROUND.
2. ERECT SIGNS IN ADVANCE OF THE LOCATION FOR THE "ROAD CONSTRUCTION AHEAD" SIGN AT LOCATIONS AS DIRECTED BY THE ENGINEER.
3. ERECT SIGN ① WITH INSTALLED PANEL ② ONE WEEK PRIOR TO THE START OF CONSTRUCTION.
4. REMOVE PANEL ② SOON AFTER THE START OF CONSTRUCTION.
5. SEE SPECIAL PROVISION FOR "TEMPORARY INFORMATION SIGNING" FOR ADDITIONAL INFORMATION.
6. ONE SIGN ASSEMBLY EQUALS 25.70 SQ. FT. (2.3 SQ. M.)
7. SHALL BE PAID FOR AS TEMPORARY INFORMATION SIGNING.

ALL DIMENSIONS ARE IN INCHES (MILLIMETERS)  
UNLESS OTHERWISE SHOWN.

	USER NAME   = Rana.Kalo	DESIGNED   -	REVISED   -   R. MIRS 09-15-97	STATE OF ILLINOIS DEPARTMENT OF TRANSPORTATION	ARTERIAL ROAD INFORMATION SIGN					F.A.P. RTE.	SECTION	COUNTY	TOTAL SHEETS	SHEET NO.			
		DRAWN    -	REVISED   -   R. MIRS 12-11-97							525	2024-1026-RS	MCHENRY	24	22			
		CHECKED   -	REVISED   - T. RAMMACHER 02-02-99							TC-22					CONTRACT NO. 62X68		
	PLOT DATE   = 2/13/2025	DATE       -	REVISED   -   C. JUCIUS 01-31-07							ILLINOIS FED. AID PROJECT							
						SCALE: NONE	SHEET   1	OF   1	SHEETS	STA.	TO STA.						



ADA DETAIL FOR SINGLE PERPENDICULAR CURB RAMPS W/ EXIST. 5% OR LESS RUN. SLOPE

PD-01A

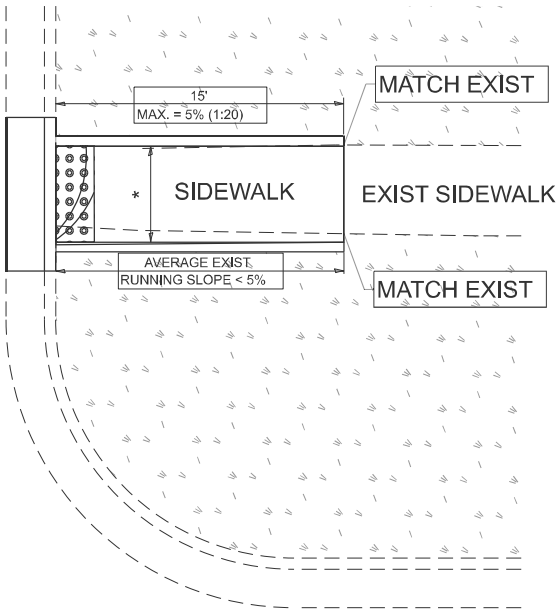

PD-01B

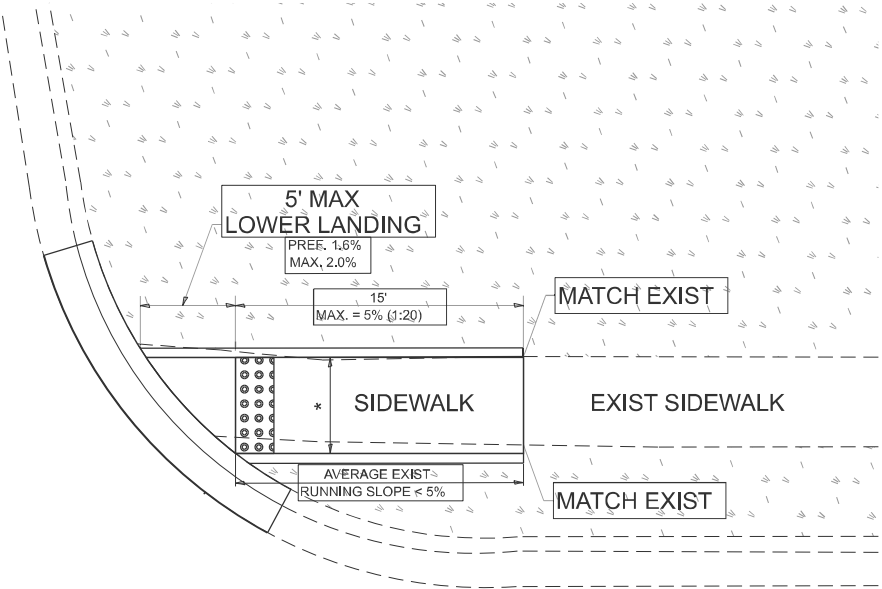

PD-01C

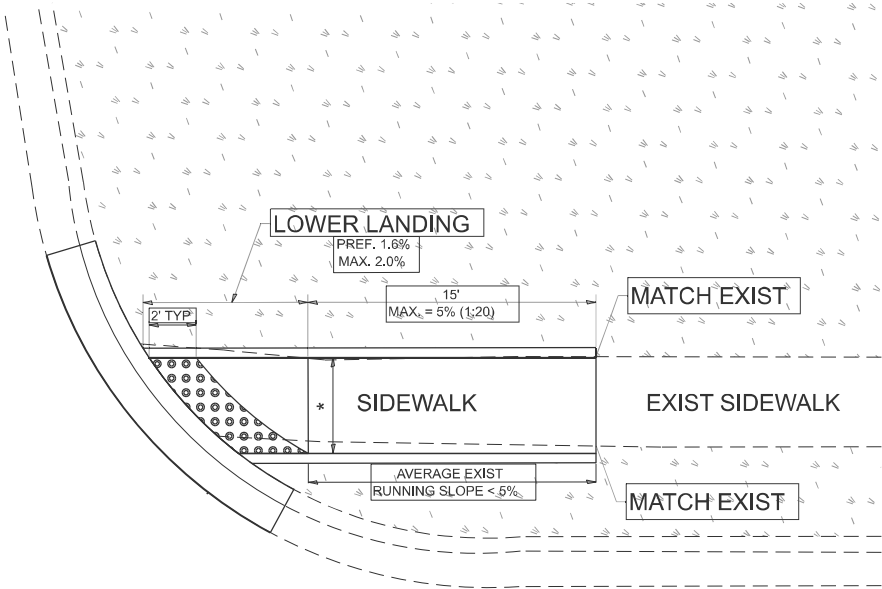

LEGEND

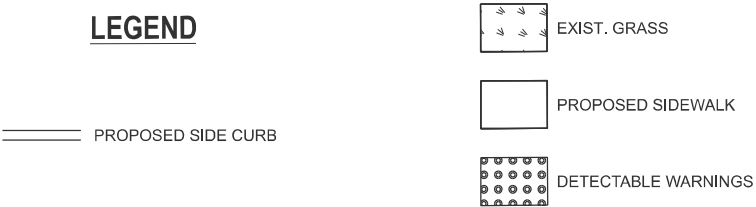

CONSTRUCTION NOTES:  
1) ALL CROSS SLOPES ARE PREFERRED 1.6% (1:64), MAXIMUM 2% (1:50) EXCEPT WHEN TRANSITIONING TO EXISTING SIDEWALK  
\* MATCH EXISTING SIDEWALK WIDTH

MODEL: PD-01 [Sheet]  
FILE NAME: c:\p\work\kalo\kalo\mtd103751\0105925-sh1-dist\stds.dgn

USER NAME	= Rana.Kalo	DESIGNED	-	REVISED	-
		DRAWN	-	REVISED	-
		CHECKED	-	REVISED	-
PLOT DATE	= 2/13/2025	DATE	-	REVISED	-

STATE OF ILLINOIS  
DEPARTMENT OF TRANSPORTATION

PROJECT DETAIL FOR SINGLE PERPENDICULAR CURB RAMPS  
(PD-01)

SCALE: NONE SHEET 1 OF 1 SHEETS STA. TO STA.

F.A.P. RTE.	SECTION	COUNTY	TOTAL SHEETS	SHEET NO.
525	2024-1026-RS	MCHENRY	24	23
PD-01		CONTRACT NO. 62X68		
ILLINOIS		FED. AID PROJECT		

ADA DETAIL FOR SINGLE PERPENDICULAR CURB RAMPS W/ TURNING SPACE

PD-04A

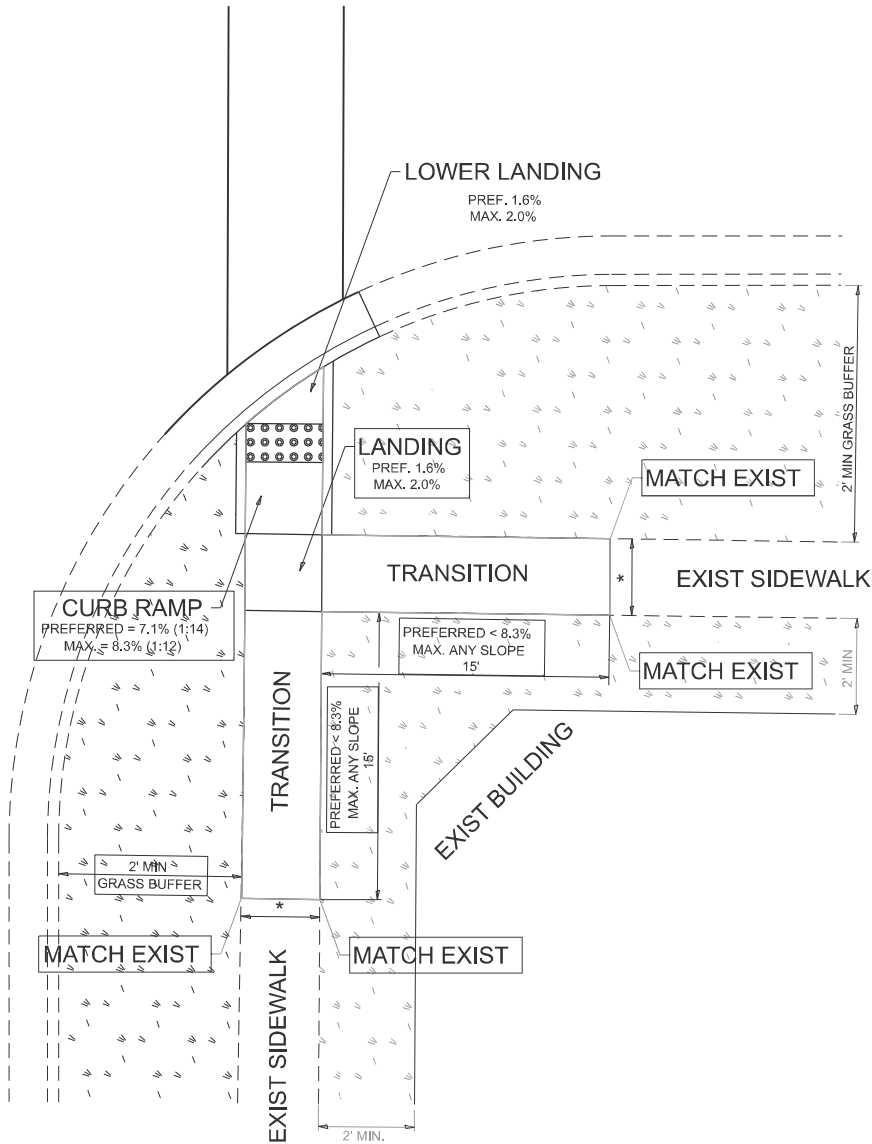

PD-04B

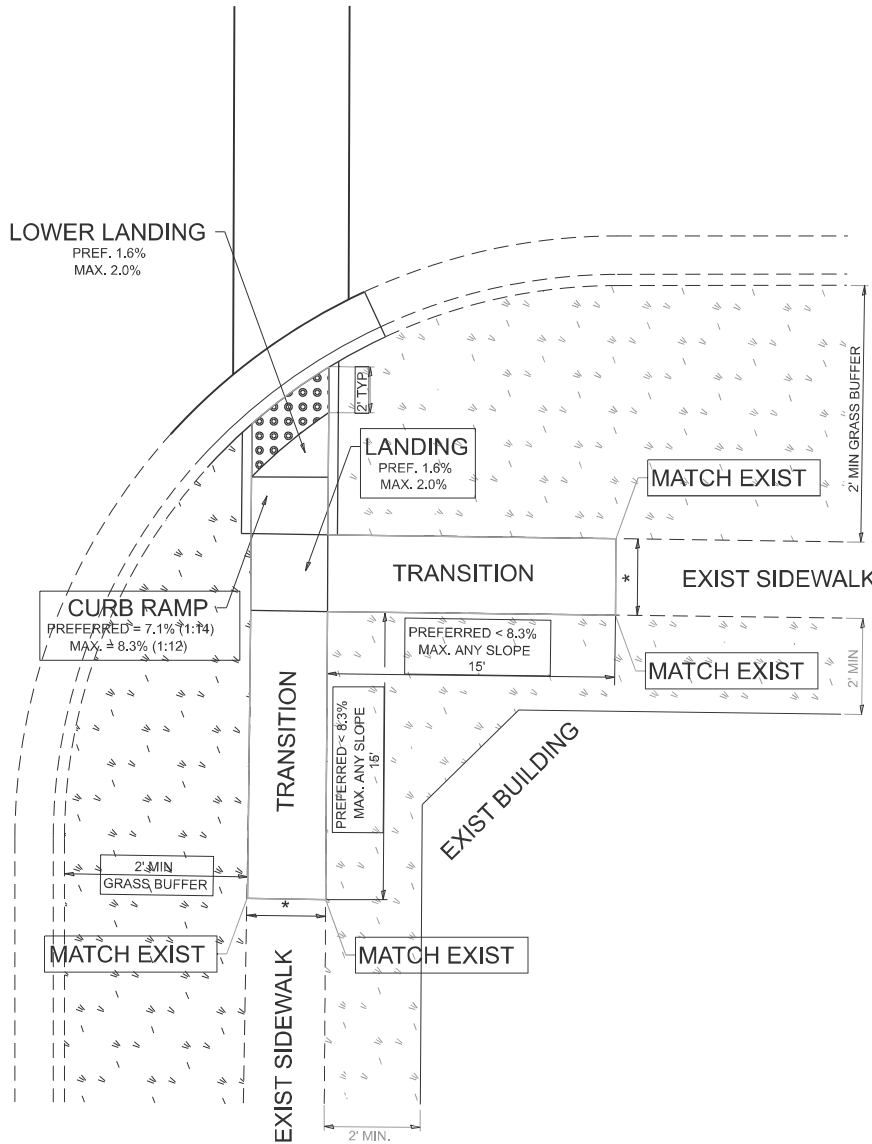

LEGEND

PROPOSED SIDE CURB



EXIST. GRASS



PROPOSED SIDEWALK



DETECTABLE WARNINGS

CONSTRUCTION NOTES:

1) ALL CROSS SLOPES ARE PREFERRED 1.6% (1:64), MAXIMUM 2% (1:50) EXCEPT WHEN TRANSITIONING TO EXISTING SIDEWALK

\* MATCH EXISTING SIDEWALK WIDTH

STATE OF ILLINOIS  
DEPARTMENT OF TRANSPORTATION

PROJECT DETAIL FOR SINGLE PERPENDICULAR CURB RAMPS WITH  
TURNING SPACE (PD-04)

SCALE: NONE SHEET 1 OF 1 SHEETS STA. TO STA.

F.A.P. RTE.	SECTION	COUNTY	TOTAL SHEETS	SHEET NO.
525	2024-1026-RS	MCHENRY	24	24
PD-04		CONTRACT NO. 62X68		
ILLINOIS		FED. AID PROJECT		

MODEL: Plan Single Sheet  
FILE NAME: \\illinois.gov\DOT\Users\COTTHOMASELM\My Documents\Bentley\CONNECT1012\Organization-Civil\DOT\_Standards\Drawings\Sheet Seeds\Civil\_Named\_Boundary\_SheetSeeds.dgnlib

USER NAME	= Eric.L.Thomas	DESIGNED	-	REVISED	-
		DRAWN	-	REVISED	-
		CHECKED	-	REVISED	-
PLOT DATE	= 8/20/2024	DATE	-	REVISED	-

DESIGNED	-
REVISED	-
REVISED	-
REVISED	-