

PLAN	SURVEYED	BY	DATE
	PLANNED		
	CHECKED		
	RT. OF WAY CHECKED		
	ADD. FILE NAME		
	NO.		

PROFILE	SURVEYED	BY	DATE
	PLOTTED		
	CHECKED		
	STRUCTURE NOTATIONS CHK'D		
	NO.		

EXIST. CURVE EXCURSION
 PI STA. = 178+02.24
 $\Delta = 6^\circ 03' 09''$ (LT)
 $D = 2^\circ 23' 14''$
 $R = 2,400.00'$
 $T = 126.88'$
 $L = 253.53'$
 $E = 3.35'$
 $e = 4.4\%$
 $T.R. = 33'$
 $S.E. RUN = 99'$
 $P.C. STA. = 176+75.36$
 $P.T. STA. = 179+28.89$

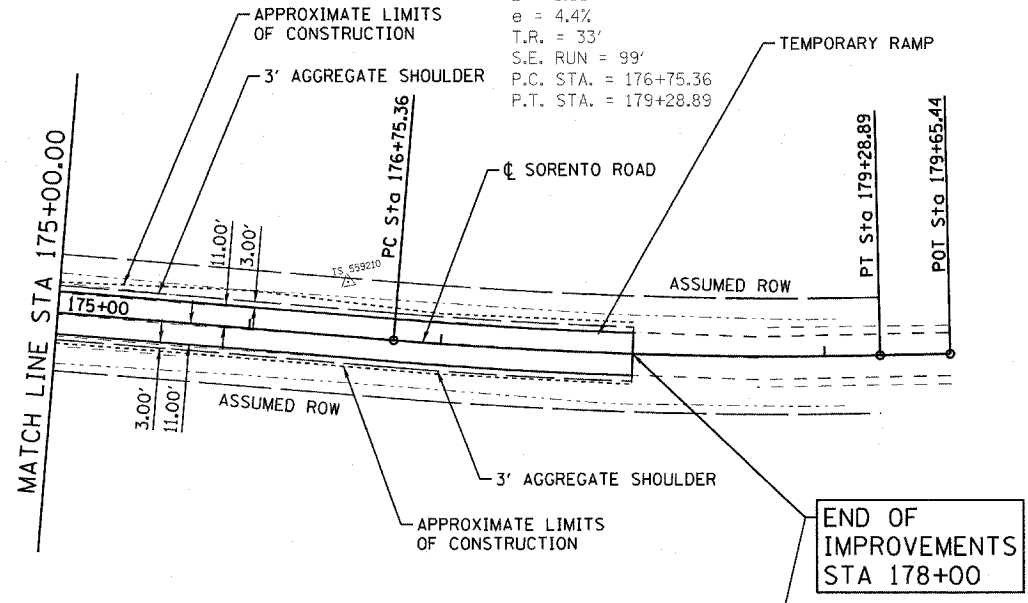
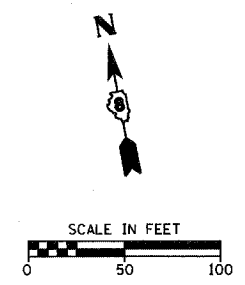

LEGEND
 - - - - - APPROXIMATE LIMITS OF CONSTRUCTION
 ———— SHOULDER
 ———— EXISTING APPROXIMATE ROW

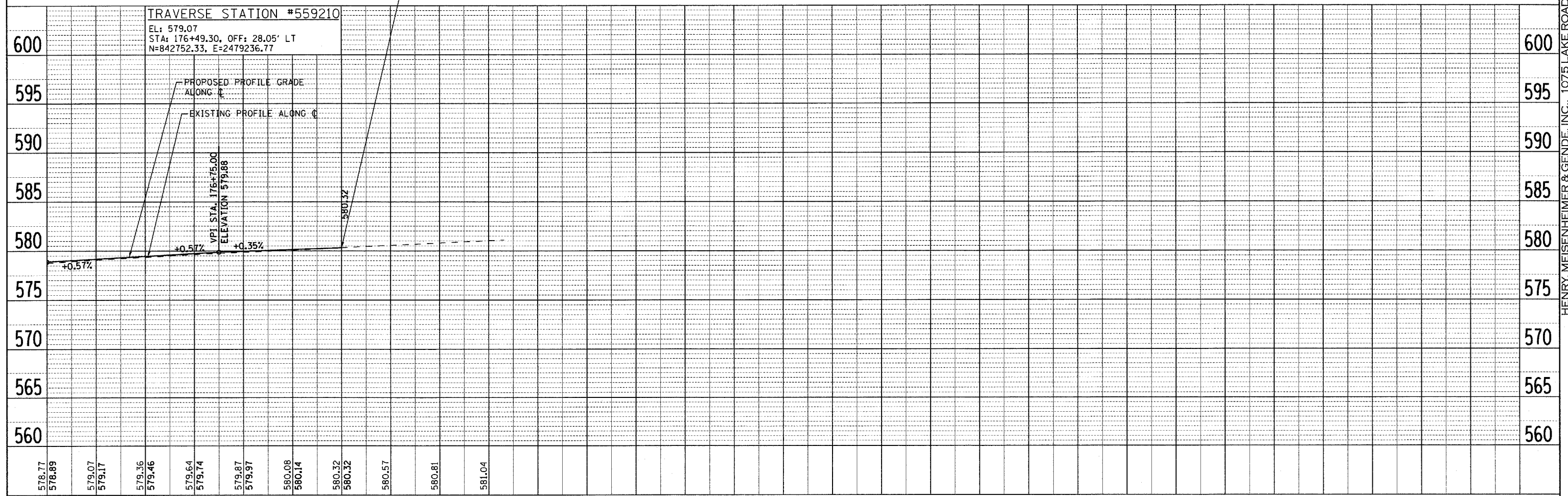

FILE NAME = H:\5592\PP_SR_5592_12.dgn	USER NAME = _USERDESCR_	DESIGNED - DLD	REVISED -	STATE OF ILLINOIS DEPARTMENT OF TRANSPORTATION	PLAN & PROFILE - SORENTO ROAD	F.A.S. RTE. 777	SECTION 05-00080-00-RS	COUNTY BOND	TOTAL SHEETS 90	SHEET NO. 26	
PLOT SCALE = 50.0000' / IN.	DATE = 1-17-08	DRAWN - KOJ	REVISED -			SCALE: 50	SHEET NO. OF SHEETS	STA. 175+00 TO STA. 179+65.44	CONTRACT NO. 97341		
PLOT DATE = 3/21/2008		CHECKED -	REVISED -			FED. ROAD DIST. NO. 8 ILLINOIS FED. AID PROJECT					
		DATE	REVISED -								

HENRY, MEISENHEIMER & GENDE, INC., 1075 LAKE ROAD, PO BOX 70, CARLYLE, IL 62231 PHONE (618) 594-3711 WWW.HMENGINEERS.COM