

CONTRACT NO. 64C89

F.A.P. RTE.	SECTION	COUNTY	TOTAL SHEETS	SHEET NO.
301	2415	JO DAVIESS	11	6
STA.		TO STA.		
FED. ROAD DIST. NO.		ILLINOIS FED. AID PROJECT		

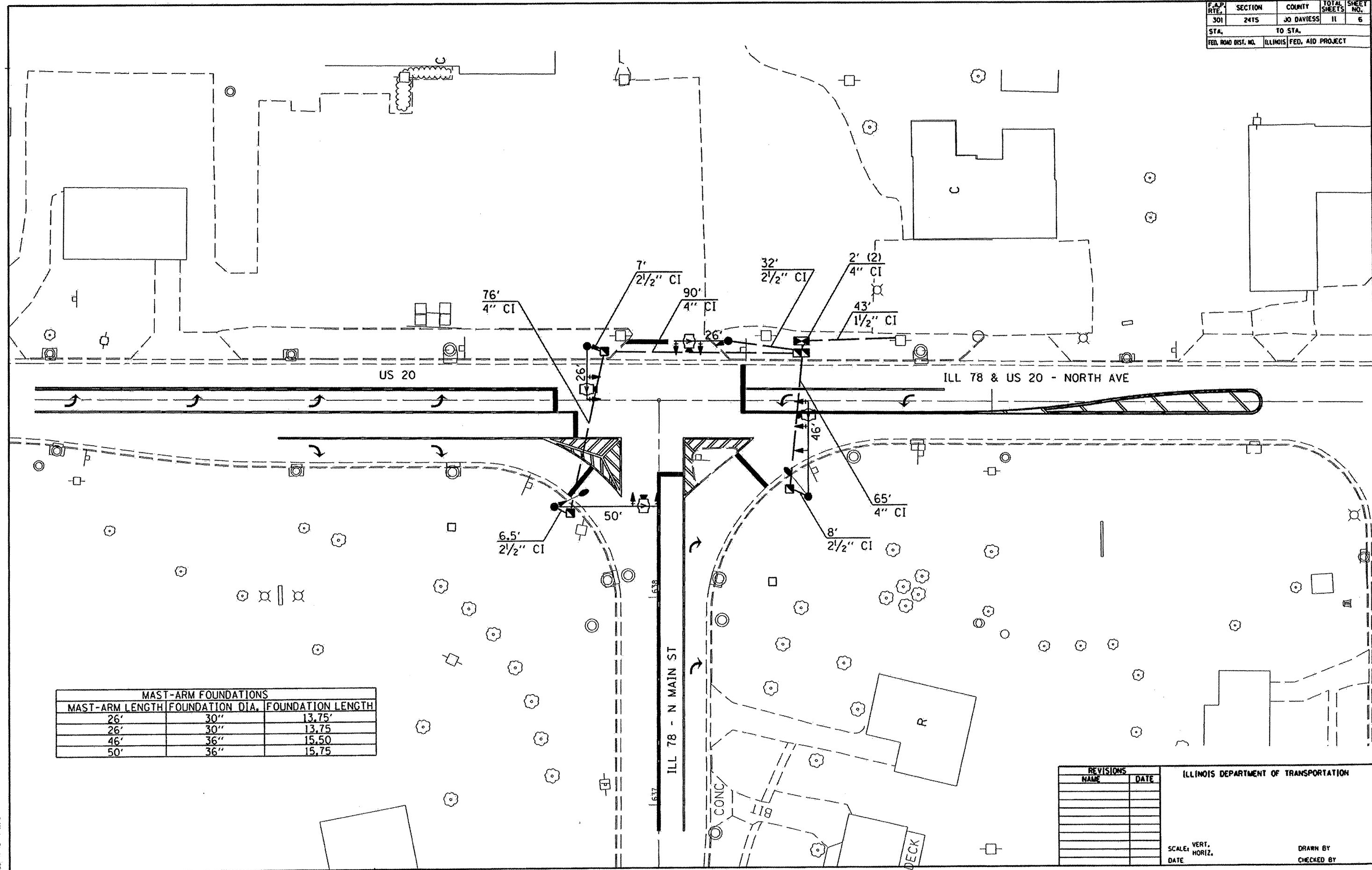

MAST-ARM LENGTH	FOUNDATION DIA.	FOUNDATION LENGTH
26'	30"	13.75'
26'	30"	13.75'
46'	36"	15.50'
50'	36"	15.75'

NO.	NAME	DATE

ILLINOIS DEPARTMENT OF TRANSPORTATION

SCALE: VERT. DATE
HORIZ.

DRAWN BY
CHECKED BY

PLOT DATE: 11 Nov 12 10:00:07 2008
 FILE NAME: I:\Users\jwheeler\My Documents\US 241. ILL 78 STRUCTURE\02-627-87501A.dwg
 PLOT SCALE: AS SHOWN IN TITLE
 USER NAME: jwheeler