

GENERAL NOTES:

THIS SECTION SHALL BE CONSTRUCTED IN ACCORDANCE WITH THE PLANS, SPECIAL PROVISIONS AND "STANDARD SPECIFICATIONS FOR ROAD AND BRIDGE CONSTRUCTION", ADOPTED JANUARY 1, 2007.

THE WORK INVOLVED ON THIS SECTION CONSISTS OF THE REMOVAL OF THE EXISTING STRUCTURE, THE CONSTRUCTION OF A 80 FOOT LONG SINGLE SPAN PRECAST, PRESTRESSED CONCRETE DECK BEAM BRIDGE, EARTH APPROACHES, AGGREGATE SURFACE COURSE AND OTHER MISCELLANEOUS ITEMS NECESSARY TO COMPLETE THIS SECTION.

ALL ELEVATIONS ARE BASED ON U.S.G.S. MEAN SEA LEVEL DATUM.

IT SHALL BE THE CONTRACTOR'S RESPONSIBILITY TO CONTACT ALL THE UTILITIES, AFFECTING THE PROJECT, PRIOR TO CONSTRUCTION.

NOTE: CONSTRUCTION TRANSITIONS
 STA. 2+20 TO STA 2+70
 STA 8+20 TO STA 8+70
 ALL QUANTITIES ARE INCLUDED IN THE PROPOSAL

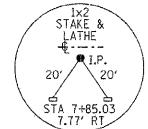
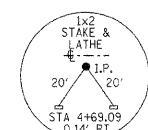
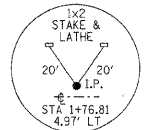

CURVE #1
 P.I. STA: 6+12.83
 Δ: LT. 28°04'55"
 D= 22°55'06"
 R= 250'
 T= 62.52'
 L= 122.53'
 E= 7.70'
 e= 0.035
 T.R.= 22'
 S.E. RUN= 52'
 P.C. STA: 5+50.30
 P.T. STA: 6+72.83

T.R. BEGINS = 3+91.92
 S.E. RUNOFF BEGINS = 4+25.7
 S.E. AT BRIDGE = 2.0%
 STOPS = 4+50
 STARTS = 5+50
 FULL S.E. = 5+68.23

T.R. ENDS = 7+29.51
 S.E. RUNOFF ENDS = 7+07.51
 FULL S.E. = 6+55.51

TYPICAL CROSS SECTION PROPOSED

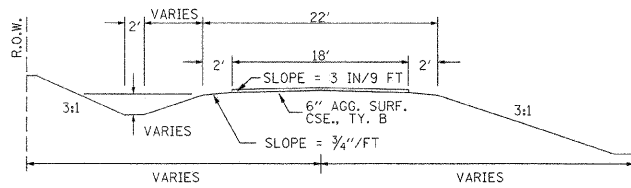

TYPICAL CROSS SECTION EXISTING

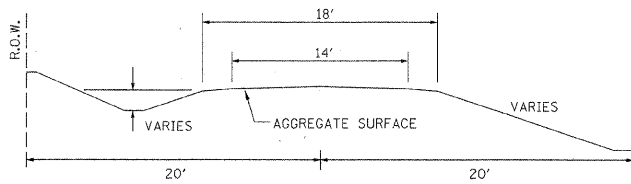

UTILITIES:
 J.U.L.I.E. 1-800-892-0123

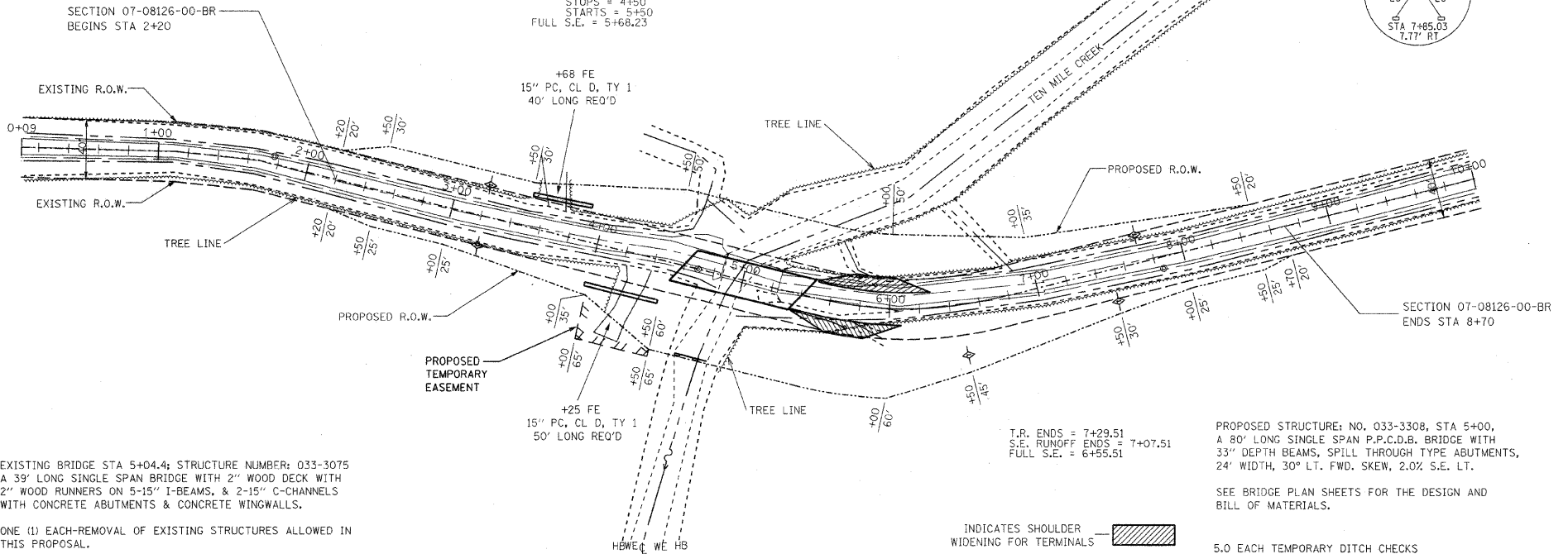

EXISTING BRIDGE STA 5+04.4; STRUCTURE NUMBER: 033-3075
 A 39' LONG SINGLE SPAN BRIDGE WITH 2" WOOD DECK WITH 2" WOOD RUNNERS ON 5-15" I-BEAMS, & 2-15" C-CHANNELS WITH CONCRETE ABUTMENTS & CONCRETE WINGWALLS.

ONE (1) EACH-REMOVAL OF EXISTING STRUCTURES ALLOWED IN THIS PROPOSAL.

INDICATES SHOULDER WIDENING FOR TERMINALS
 TEMPORARY DITCH CHECKS
 AGGREGATE (EROSION CONTROL)

PROPOSED STRUCTURE: NO. 033-3308, STA 5+00, A 80' LONG SINGLE SPAN P.P.C.D.B. BRIDGE WITH 33" DEPTH BEAMS, SPILL THROUGH TYPE ABUTMENTS, 24' WIDTH, 30° LT. FWD. SKEW, 2.0% S.E. LT.

SEE BRIDGE PLAN SHEETS FOR THE DESIGN AND BILL OF MATERIALS.

5.0 EACH TEMPORARY DITCH CHECKS
 0.4 TREE REMOVAL, ACRES
 18.0 TONS AGGREGATE (EROSION CONTROL)
 0.6 ACRES SEEDING, CLASS 2 SPECIAL REQUIRED

FIELD ENTRANCE DETAIL

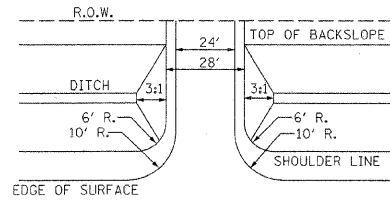

NOTE: CONSTRUCT SPECIAL DITCH

STA 2+20 TO STA 4+68.3 LT
 STA 2+20 TO STA 4+71.8 RT
 STA 5+23.5 TO STA 8+70 RT
 STA 6+00 TO STA 6+75 LT
 STA 6+80 TO STA 8+70 LT

NOTE: CONSTRUCT STONE RIPRAP DITCH

STA 3+88 TO STA 4+68.3 LT (0.62 TON/LIN FT)
 STA 4+50 TO STA 4+71.8 RT (0.62 TON/LIN FT)
 STA 5+23.5 TO STA 5+50 RT (0.62 TON/LIN FT)
 STA 6+60 TO STA 7+00 LT (0.62 TON/LIN FT)
 105 TON STONE RIPRAP DITCH ALLOWED IN PROPOSAL.

SEE STONE RIPRAP DITCH DETAIL.

STONE RIPRAP DITCH DESIGN

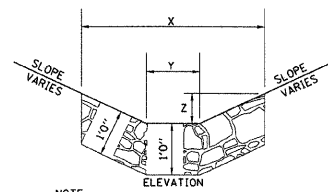
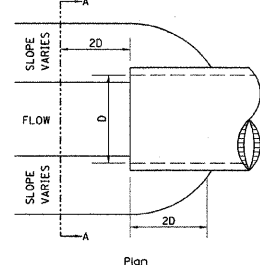

NOTE: FOR PLACEMENT, QUALITY GRADATION AND OTHER MISCELLANEOUS REQUIREMENTS FOR STONE RIPRAP DITCH-SEE SPECIAL PROVISIONS.

BOTTOM OF DITCH	SLOPE			
2 FT	1 1/2:1	2:1	3:1	TON/LIN. FT
X= 5 FT	6 FT	8 FT		
Y= 2 FT	2 FT	2 FT		
Z= 1 FT	1 FT	1 FT		
	0.40	0.48	0.62	

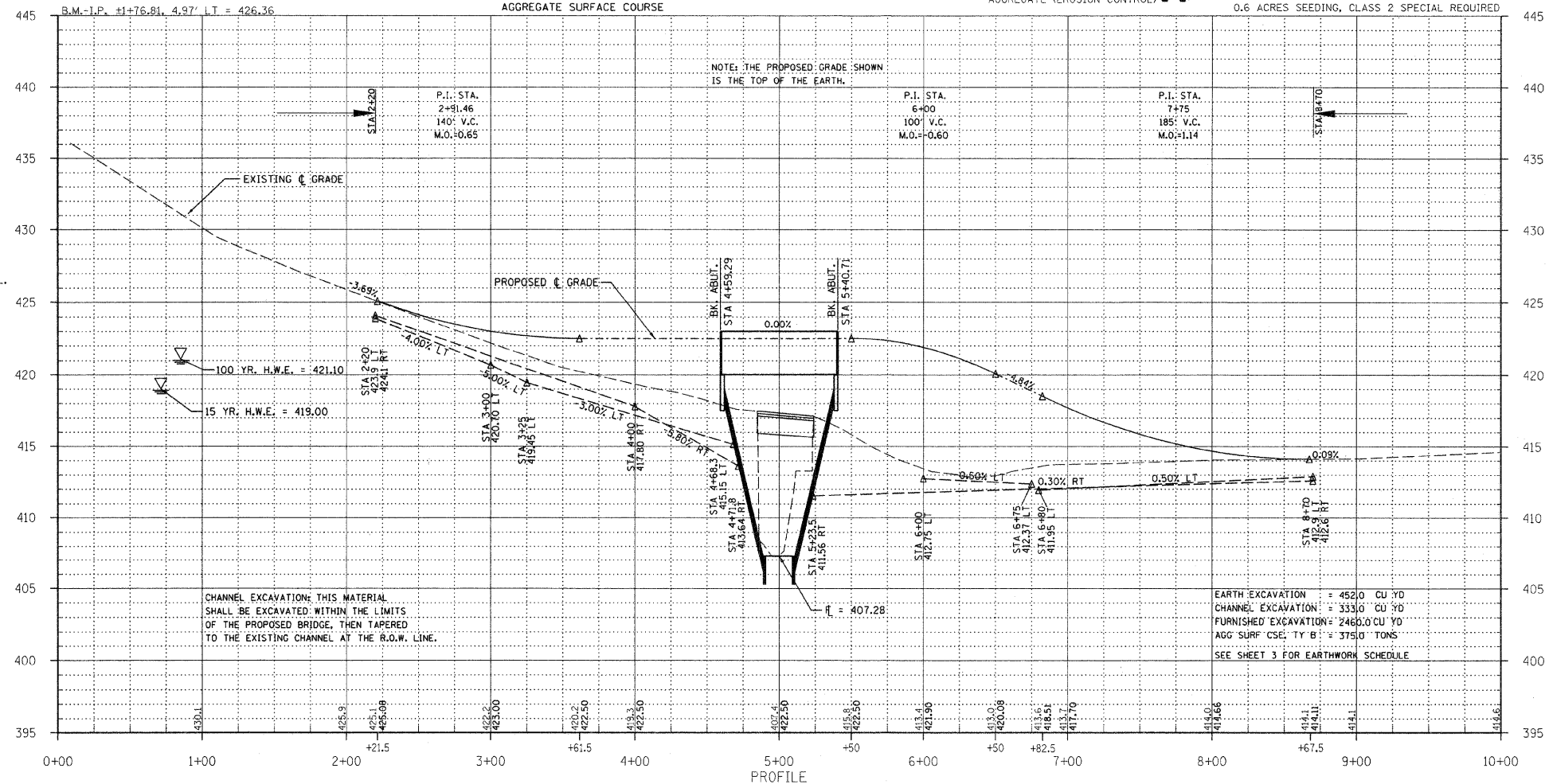

CHANNEL EXCAVATION: THIS MATERIAL SHALL BE EXCAVATED: WITHIN THE LIMITS OF THE PROPOSED BRIDGE, THEN TAPERED TO THE EXISTING CHANNEL AT THE R.O.W. LINE.

EARTH EXCAVATION = 452.0 CU YD
 CHANNEL EXCAVATION = 333.0 CU YD
 FURNISHED EXCAVATION = 2460.0 CU YD
 AGG SURF CSE: TY B = 375.0 TONS
 SEE SHEET 3 FOR EARTHWORK SCHEDULE



PROFESSIONAL DESIGN FIRM
 LAND SURVEY & PROFESSIONAL ENGINEERING CORPORATION
 184-000887
 (62-032435)(35-002769)

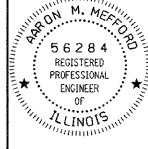

AARON M. MEFFORD
 NAME
 SIGNATURE
 DATE
 11-30-09
 EXPIRES

TOWNSHIP ROUTE 200
 OVER TEN MILE CREEK
 HAMILTON COUNTY, ILLINOIS

SHEET TITLE:
 PLAN & PROFILE

SCALE: VARIES
 BY: AMM
 DATE: 12/09
 REV:

2 OF 13
 SHEETS

SHEET NO.
 2