

F. A. U. ROUTE	SECTION	COUNTY	TOTAL SHEETS	SHEET NUMBER
9732	00-00103-00-FP	JACKSON	37	37
CITY OF CARBONDALE		PROJECT NO. M-500BK 199		
CONTRACT NO. 99182		JOB NO. C99-504-03		
FEDERAL AID PROJECT				

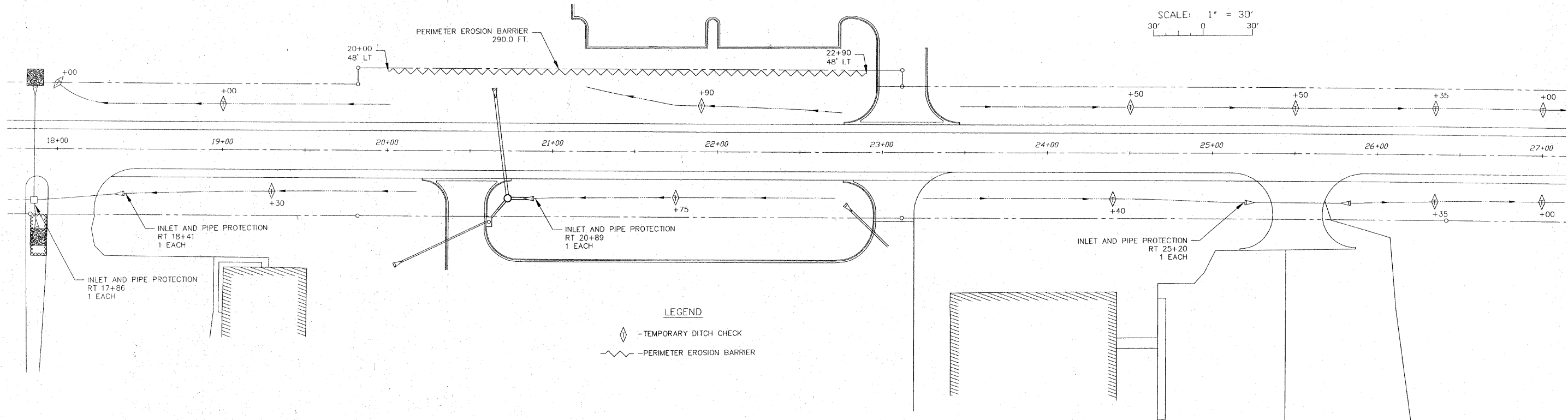

LEGEND
 ◆ - TEMPORARY DITCH CHECK
 ~~~~~ - PERIMETER EROSION BARRIER

FILE: ?  
 DRAWN BY: ?  
 DATE: ?  
 PROJ. NAME: ?  
 LAYER STATE: ?  
 CTB FILE: ?  
 PS PLOT TAB: ?  
 PLOT VIEW: ?  
 PLOT SCALE: ?  
 LINETYPE SCALE: ?

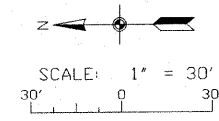
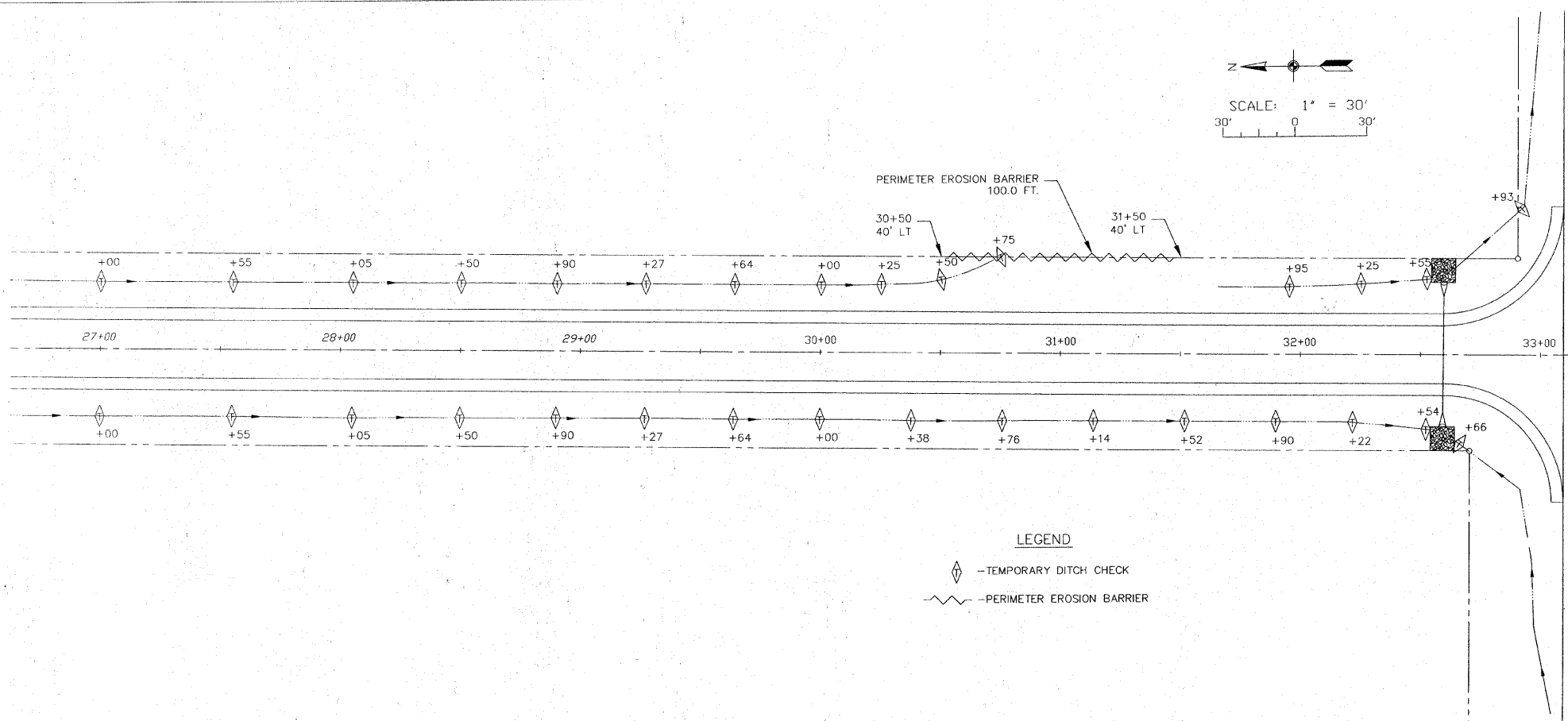

**LEGEND**  
 ◆ - TEMPORARY DITCH CHECK  
 ~~~~~ - PERIMETER EROSION BARRIER

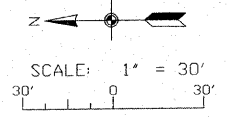

TEMPORARY DITCH CHECKS

| STATION | EACH | STATION | EACH |
|----------------|------|----------|------|
| 1+44 LT | 1 | 7+20 RT | 1 |
| 2+34 LT | 1 | 7+40 RT | 1 |
| 4+42 LT | 1 | 7+60 RT | 1 |
| 4+72 LT | 1 | 7+80 RT | 1 |
| 5+02 LT | 1 | 8+00 RT | 1 |
| 6+30 LT | 1 | 8+60 RT | 1 |
| 6+95 LT | 1 | 14+40 RT | 1 |
| 7+25 LT | 1 | 15+05 RT | 1 |
| 7+54 LT | 1 | 15+70 RT | 1 |
| 7+83 LT | 1 | 19+30 RT | 1 |
| 8+12 LT | 1 | 21+75 RT | 1 |
| 8+15 LT | 1 | 24+40 RT | 1 |
| 8+23 LT | 1 | 26+35 RT | 1 |
| 8+52 LT | 1 | 27+00 RT | 1 |
| 14+35 LT | 1 | 27+55 RT | 1 |
| 15+00 LT | 1 | 28+05 RT | 1 |
| 15+75 LT | 1 | 28+50 RT | 1 |
| 16+50 LT | 1 | 28+90 RT | 1 |
| 18+00 LT | 1 | 29+27 RT | 1 |
| 19+00 LT | 1 | 29+64 RT | 1 |
| 21+90 LT | 1 | 30+00 RT | 1 |
| 24+50 LT | 1 | 30+38 RT | 1 |
| 25+50 LT | 1 | 30+76 RT | 1 |
| 26+35 LT | 1 | 31+14 RT | 1 |
| 27+00 LT | 1 | 31+52 RT | 1 |
| 27+55 LT | 1 | 31+90 RT | 1 |
| 28+05 LT | 1 | 32+22 RT | 1 |
| 28+50 LT | 1 | 32+54 RT | 1 |
| 28+90 LT | 1 | 32+66 RT | 1 |
| 29+27 LT | 1 | | |
| 29+64 LT | 1 | | |
| 30+00 LT | 1 | | |
| 30+25 LT | 1 | | |
| 30+50 LT | 1 | | |
| 30+75 LT | 1 | | |
| 31+95 LT | 1 | | |
| 32+25 LT | 1 | | |
| 32+35 LT | 1 | | |
| 32+93 LT | 1 | | |
| TOTAL: 68 EACH | | | |

INLET AND PIPE PROTECTION

| STATION | EACH |
|------------|------|
| 4+12 LT | 1 |
| 6+50 RT | 1 |
| 9+31 LT | 1 |
| 11+11 LT | 1 |
| 11+83.5 RT | 1 |
| 12+01 RT | 1 |
| 12+50 LT | 1 |
| 13+33 LT | 1 |
| 13+35 LT | 1 |
| 13+69 LT | 1 |
| 13+76 RT | 1 |
| 17+39 RT | 1 |
| 17+86 RT | 1 |
| 18+41 RT | 1 |
| 20+89 RT | 1 |
| 25+20 RT | 1 |
| TOTAL 16 | |

PERIMETER EROSION BARRIER

| STATION TO STATION | LENGTH |
|----------------------|--------|
| 7+66 RT TO 8+66 RT | 100.0' |
| 8+83 RT | 40.0' |
| 9+30 RT | 60.0' |
| 9+30 RT TO 9+90 RT | 60.0' |
| 20+00 LT TO 22+90 LT | 290.0' |
| 30+50 LT TO 31+50 LT | 100.0' |
| TOTAL 650.0' | |

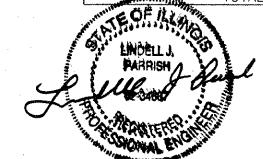

CIP NO. ST0102 - REED STATION ROAD
 EROSION CONTROL PLAN
 STA. 18+00 TO STA. 33+10