

**Bench Mark:** RR spike in 2nd power pole N. of CPT 207, 1 ft. above ground, Elev. 534.690  
**Existing Structure:** None

STATE OF ILLINOIS  
 DEPARTMENT OF TRANSPORTATION

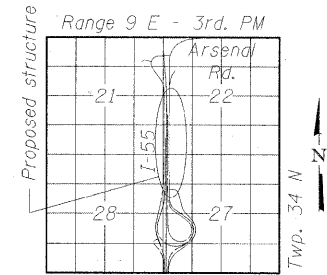

LOCATION SKETCH

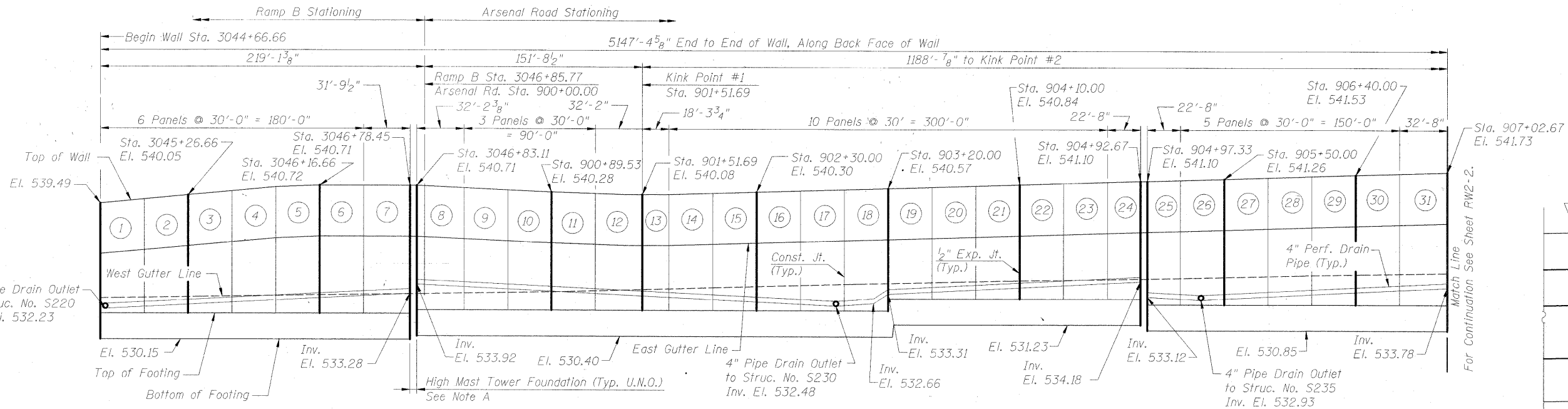

ELEVATION  
 (Looking at Back Face of Wall)

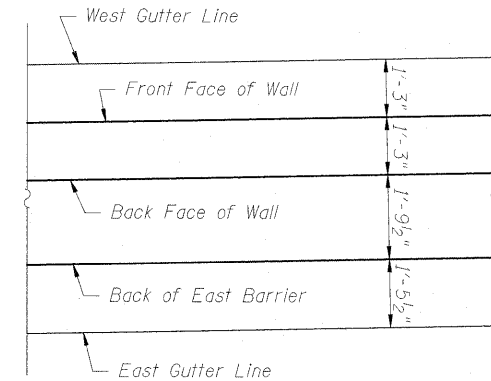

DETAIL A

Typ., see sheets RW2-14 & RW2-15 for sections.

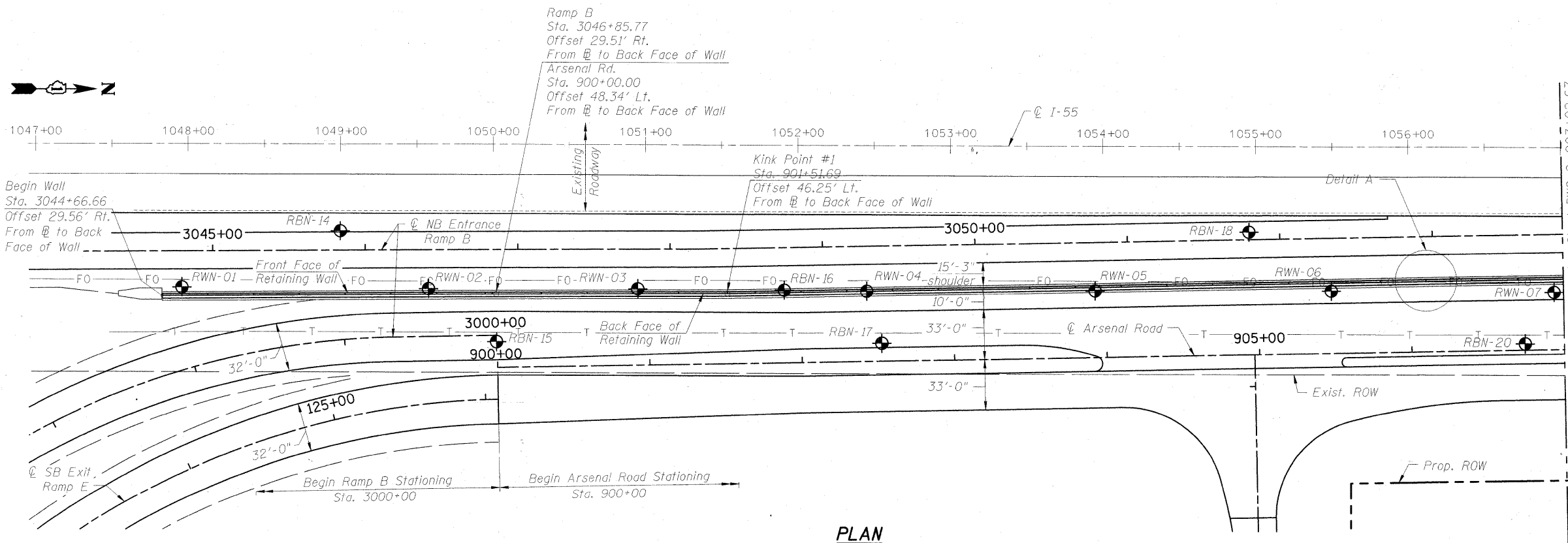

PLAN

NOTES:

- Offsets are measured from the  $\text{C}$  of Arsenal Rd., u.n.o.
- Construction joints shall be placed at 30' on center and expansion joints shall be placed at 90' on center, u.n.o.

LEGEND:

- Soil Boring
- Panel No.

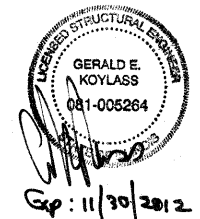

GENERAL PLAN & ELEVATION - 1  
 SECTION NO. (99-1&2) R-6  
 WILL COUNTY  
 STATION 3044+66.66 TO 949+27.33  
 STRUCTURE NO. 099-W027

DESIGNED	PMH
CHECKED	MJL
DRAWN	PMH
CHECKED	BB

Note A:  
 For high mast tower foundation details see sheets S-1 to S-4.

**McDonough Associates Inc.**  
 Engineers / Architects  
 130 East Randolph Street  
 Chicago, Illinois 60601  
 (312) 946-8600

SHEET NO. RW2-1 SHEETS RW2-31	F.A.I. RTE.	SECTION	COUNTY	TOTAL SHEETS	SHEET NO.
	55	(99-1&2) R-6	WILL	756	465
CONTRACT NO. 60F12					
FED. ROAD DIST. NO. ILLINOIS FED. AID PROJECT					