

F.A.P. RTE.	SECTION	COUNTY	TOTAL SHEETS	SHEET NO.
331	*	JACKSON	258	133
STA. 53+62.29 TO STA. 53+77.41				
FED. ROAD DIST. NO. 7 ILLINOIS FED. AID PROJECT				
* (12-1)2N, 1-5, TS-3, B-				

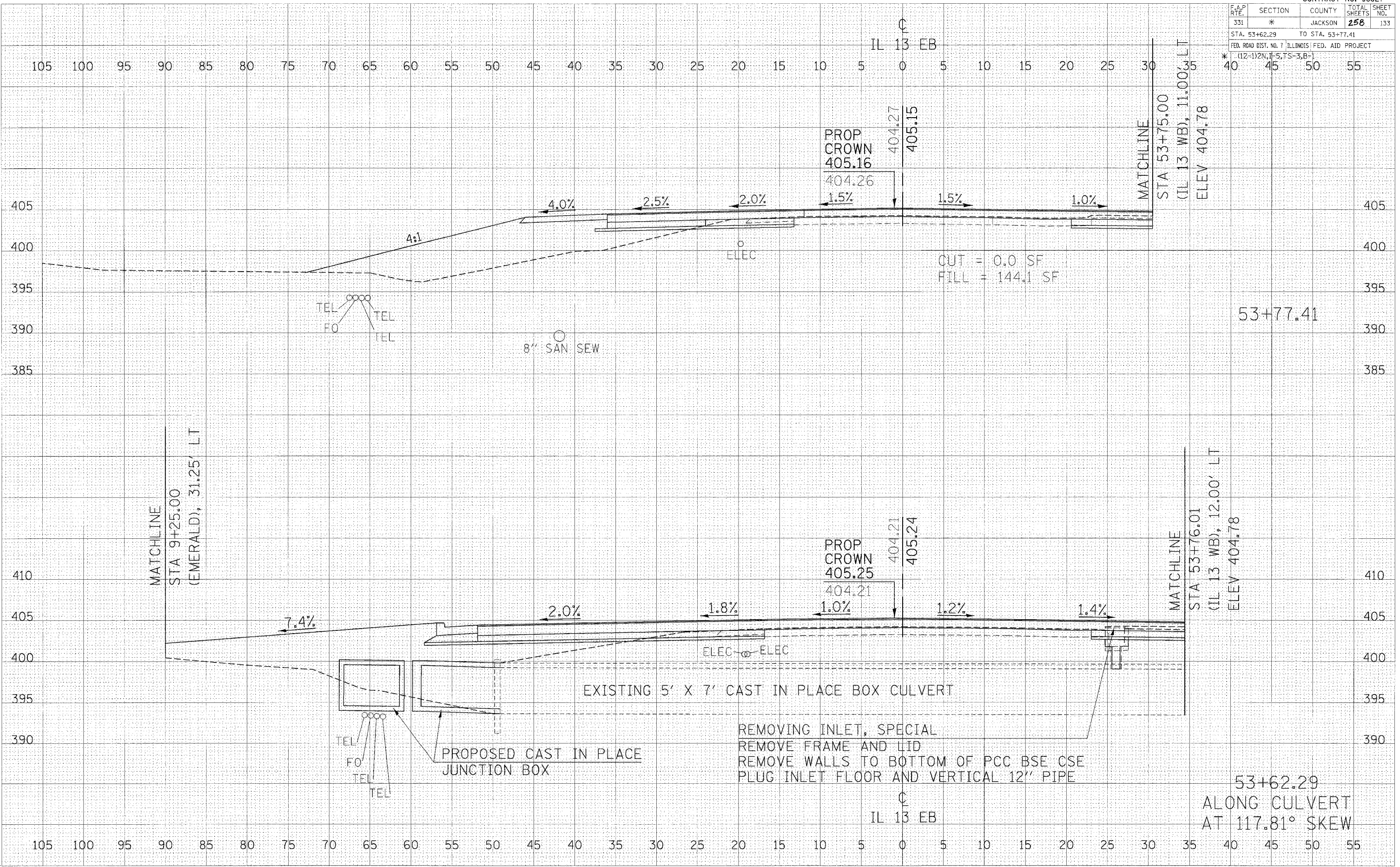

DATE	BY

DATE	BY

2/15/2006
 en:\proj\sta_0724401\plan\crossecg
 5.0000' / 1/4"