

SQUAD LEADER: VINCE MADONIA  
PHONE: (217)785-9046

PROJECT ENGINEER: JOHN NEGANGARD  
PHONE: (217)782-6990

FOR INDEX OF SHEETS, SEE SHEET NO. 2

STATE OF ILLINOIS  
DEPARTMENT OF TRANSPORTATION  
DIVISION OF HIGHWAYS  
**PROPOSED  
HIGHWAY PLANS**

FAP ROUTE 717 (IL 10)  
SECTION 109I-1  
LOGAN COUNTY  
C-95-056-06  
AT DEER CREEK 4.5 MI. E. OF IL 121 IN LINCOLN

BRIDGE OMISSION  
SN 054-0012 (STA 307+15.00)  
STA 306+72 TO STA 307+58  
DEER CREEK

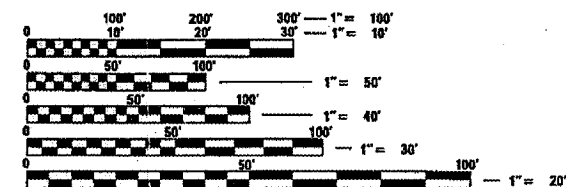

FULL SIZE PLANS HAVE BEEN PREPARED USING STANDARD  
ENGINEERING SCALES. REDUCED SIZED PLANS WILL NOT  
CONFORM TO STANDARD SCALES. IN MAKING MEASUREMENTS  
ON REDUCED PLANS, THE ABOVE SCALES MAY BE USED.

J.U.L.I.E.  
JOINT UTILITY LOCATION INFORMATION FOR EXCAVATION  
1-800-892-0123

CONTRACT NO. 70537

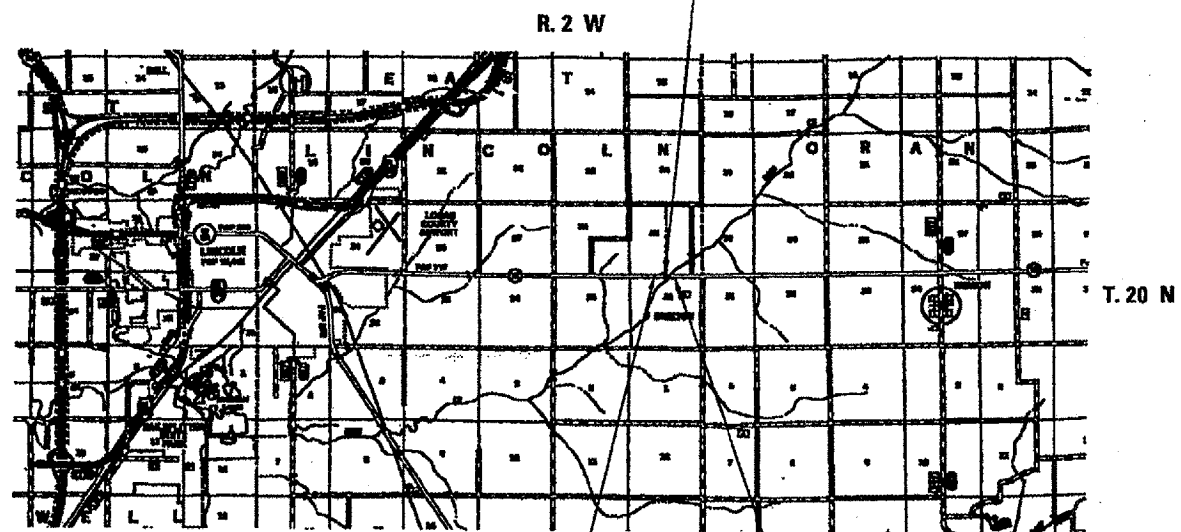

BEGIN PROJECT  
STA 304+72

END PROJECT  
STA 309+58

NET LENGTH OF PROJECT = 486.00 FT = 0.092 MI  
GROSS LENGTH OF PROJECT = 486.00 FT = 0.092 MI

F.A.P. RTE.	SECTION	COUNTY	TOTAL SHEETS	SHEET NO.
717	109I-1	LOGAN	5	1

D-95-056-06

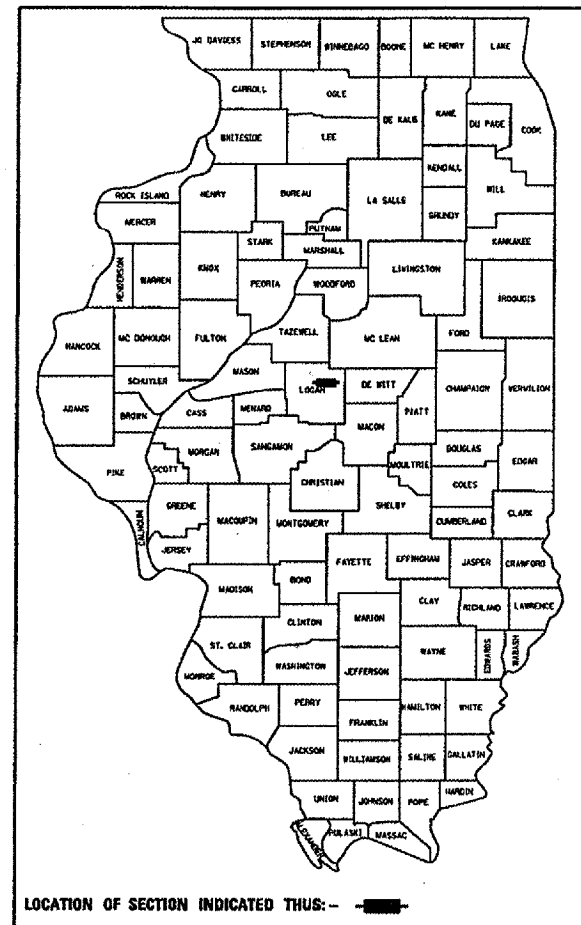

STATE OF ILLINOIS  
DEPARTMENT OF TRANSPORTATION  
DIVISION OF HIGHWAYS

SUBMITTED Jan 13 20 06  
[Signature]  
DEPUTY DIRECTOR OF HIGHWAYS, REGION ENGINEER

March 24 20 06  
Mike Hine  
ENGINEER OF DESIGN AND ENVIRONMENT

March 24 20 06  
Milton R. Sees, P.E.  
DIRECTOR OF HIGHWAYS, CHIEF ENGINEER

PRINTED BY THE AUTHORITY  
OF THE STATE OF ILLINOIS

F.A.P. RITE.	SECTION	COUNTY	TOTAL SHEETS	SHEET NO.
717	1091-1	LOGAN	5	2
STA. 57+64.50		TO STA. 631+30.00		
FED. ROAD DIST. NO. 6		ILLINOIS	FED. AID PROJECT	
CONTRACT NO. 70537				

G.N. -100  
ENGLISH UNITS OF MEASUREMENT SHALL GOVERN OVER AND SUPERSEDE ANY METRIC UNITS SHOWN IN THIS CONTRACT. WHERE INCLUDED, METRIC UNITS ARE FOR INFORMATION ONLY.

G.N. -1004.03  
REVISE ARTICLE 1004.03 (c) NOTE 5/ OF THE STANDARD SPECIFICATIONS TO READ:  
'5/ GRADATION CA-16 SHALL BE USED IN LIEU OF CA-13 WHEN THE SURFACE COURSE IS LESS THAN 1 3/4 INCHES IN THICKNESS. CA-13 OR CA-16 MAY BE USED WHEN THE SURFACE COURSE IS 1 3/4 INCHES OR MORE IN THICKNESS.'

G.N. -406H  
MIXTURE REQUIREMENTS

The following mixture requirements are applicable for this project:

Location(s):	
Mixture Use(s):	BITUMINOUS CONCRETE SURFACE COURSE SUPERPAVE
AC/PG:	PG 64-22
RAP %: (Max)**	15%
Design Air Voids:	4% @ N DESIGN=50
Mixture Composition: (Gradation Mixture)	IL 9.5 OR 12.5
Friction Aggregate:	MIX "C"

G.N. -781  
RAISED REFLECTIVE PAVEMENT MARKERS SHALL BE PLACED IN ACCORDANCE WITH STANDARD 781001, AND THE DETAILS SHOWN IN THE PLANS. IF THERE IS ANY DISCREPENCY BETWEEN THE STANDARD AND THE DETAILS IN THE PLANS, THE DETAILS IN THE PLANS SHALL GOVERN. THE FINAL PAVEMENT MARKINGS SHALL BE IN PLACE PRIOR TO PLACING THE RAISED REFLECTIVE PAVEMENT MARKERS AND THE RAISED REFLECTIVE PAVEMENT MARKERS SHALL BE PLACED MIDWAY IN THE 30 FOOT (9 m) SPACE BETWEEN THE DASHED CENTERLINE STRIPES (WHEN APPLICABLE).

G.N. -703A  
SHORT TERM PAVEMENT MARKING SHALL BE APPLIED TO THE PAVEMENT AFTER ANY OF THE FOLLOWING: COLD MILLING AND/OR PLACING BITUMINOUS MATERIALS (PRIME COAT), LEVELING BINDER (MACHINE METHOD), BINDER AND SURFACE COURSES. SHORT TERM PAVEMENT MARKING PLACED ON THE SURFACE, SHALL COINCIDE WITH THE FINAL PAVEMENT STRIPING. SHORT TERM PAVEMENT MARKING PLACED PRIOR TO THE SURFACE SHALL COINCIDE WITH THE EXISTING PAVEMENT MARKINGS. USE 4 FEET PER 40 FEET (OR 10% PER STATION).

INDEX OF SHEETS

SHEET NO.	DESCRIPTION
1	TITLE SHEET
2	GENERAL NOTES
3	SUMMARY OF QUANTITIES
4	TYPICAL SECTIONS
5	PLAN AND ELEVATION VIEWS

STANDARDS

000001-04	STANDARD SYMBOLS, ABBREVIATIONS AND PATTERNS
701301-02	LANE CLOSURE, 2L, 2W, SHORT TIME OPERATIONS
701306-01	LANE CLOSURE, 2L, 2W, SLOW MOVING OPERATIONS DAY ONLY, FOR SPEEDS ≥ 45 MPH
701311-02	LANE CLOSURE, 2L 2W, MOVING OPERATIONS-DAY ONLY
702001-06	TRAFFIC CONTROL DEVICES
780001-01	TYPICAL PAVEMENT MARKINGS
781001-02	TYPICAL APPLICATIONS RAISED REFLECTIVE PAVEMENT MARKERS
001006	DECIMAL OF AN INCH AND OF A FOOT

COMMITMENTS

THE FIELD/RESIDENT ENGINEER SHALL CONTACT STUDIES AND PLANS CONCERNING ANY MAJOR PLAN CHANGES TO MAKE SURE NO PREVIOUS COMMITMENTS (NOT LISTED ) WERE MADE AFFECTING THE DESIGN AND ALLOW AN IMPROVED DESIGN FOR FUTURE PROJECTS.

REVISIONS	
NAME	DATE

ILLINOIS DEPARTMENT OF TRANSPORTATION

GENERAL NOTES  
& COMMITMENTS

FAP ROUTE 717  
SECTION 1091-1  
LOGAN COUNTY

SCALE: NONE  
DATE: AUG 2004

DRAWN BY: MLH  
CHECKED BY: LDB

SUMMARY OF QUANTITIES

CONTRACT NO. 70537				
F.A.P. RTE.	SECTION	COUNTY	TOTAL SHEETS	SHEET NO.
717	1091-1	LOGAN	5	3
STA.		TO STA.		
FED. ROAD DIST. NO.		ILLINOIS	FED. AID PROJECT	

LOCATION OF WORK: F. A. P. 717  
IL RTE. 10  
RURAL  
STATION 304+72.00  
TO  
STATION 309+58.00  
100% STATE

FUNDING BREAKOUT:

CONSTRUCTION TYPE CODE: I000

CODE NO. ITEM	UNIT	TOTAL QUANTITY	QUANTITY
40600100 BITUMINOUS MATERIALS (PRIME COAT)	GAL	143.0	143.0
40600300 AGGREGATE (PRIME COAT)	TON	3.0	3.0
40600980 BITUMINOUS SURFACE REMOVAL - BUTT JOINT	SQ YD	1,423.0	1,423.0
40600990 TEMPORARY RAMP	SQ YD	95.0	95.0
67100100 MOBILIZATION	L SUM	1.0	1.0
70100460 TRAFFIC CONTROL AND PROTECTION, STANDARD 701306	L SUM	1.0	1.0
70300100 SHORT-TERM PAVEMENT MARKING	FOOT	144.0	144.0
70301000 WORK ZONE PAVEMENT MARKING REMOVAL	SQ FT	24.0	24.0
• 78001120 PAINT PAVEMENT MARKING - LINE 5"	FOOT	1,094.0	1,094.0
• 78100100 RAISED REFLECTIVE PAVEMENT MARKER	EACH	6.0	6.0
78300200 RAISED REFLECTIVE PAVEMENT MARKER REMOVAL	EACH	5.0	5.0
X4066414 BITUMINOUS CONCRETE SURFACE COURSE, SUPERPAVE, MIX "C", N50	TON	160.0	160.0

• SPECIALTY ITEM

REVISIONS	
NAME	DATE

ILLINOIS DEPARTMENT OF TRANSPORTATION  
SUMMARY OF QUANTITIES

FAP 717  
SECTION 1091-1  
LOGAN COUNTY

SCALE: VERT.  
HORIZ.  
DATE

DRAWN BY  
CHECKED BY

F.A.P. RTE.	SECTION	COUNTY	TOTAL SHEETS	SHEET NO.
717	1091-1	LOGAN	5	4
STA. 57+64.50		TO STA. 631+30.00		
FED. ROAD DIST. NO. 6		ILLINOIS	FED. AID PROJECT	
CONTRACT NO. 70537				

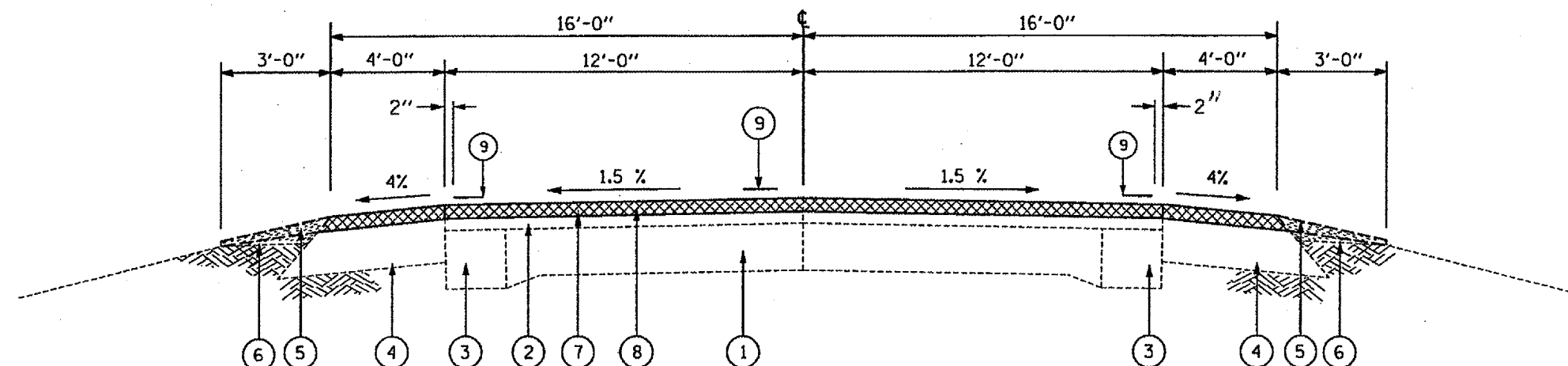

- ① EXISTING P.C.C. PAVEMENT (9-6-9)
- ② EXISTING BITUMINOUS OVERLAY 3" -
- ③ EXISTING BASE COURSE WIDENING 9"
- ④ EXISTING BITUMINOUS SHOULDER
- ⑤ EXISTING AGGREGATE SHOULDER
- ⑥ EXISTING STEEL PLATE BEAM GUARDRAIL
- ⑦ PROPOSED BITUMINOUS SURFACE REMOVAL - BUTT JOINT (2" AVE)
- ⑧ PROPOSED BITUMINOUS CONCRETE SURFACE COURSE SUPERPAVE, MIX "C", N50 (2 ")
- ⑨ PROPOSED PAINT PAVEMENT MARKING, LINE 5"

LOCATION  
 STA 304+72.00 TO 306+72.00  
 STA 306+72.00 TO STA 307+58.00 - BRIDGE OMISSION  
 STA 307+58.00 TO STA 309+58.00

REVISIONS		ILLINOIS DEPARTMENT OF TRANSPORTATION	
NAME	DATE	TYPICAL SECTIONS	
		FAP ROUTE 717 (IL 10)	
		SECTION 1091-1	
		LOGAN COUNTY	
		SCALE: NOT TO SCALE	
		DATE: AUG 2004	
		DRAWN BY MLH	
		CHECKED BY LDB	

CONTRACT NO. 70537				
F.A.P. RTE.	SECTION	COUNTY	TOTAL SHEETS	SHEET NO.
717	1091-1	LOGAN	5	5
STA.			TO STA.	
FED. ROAD DIST. NO.			ILLINOIS FED. AID PROJECT	

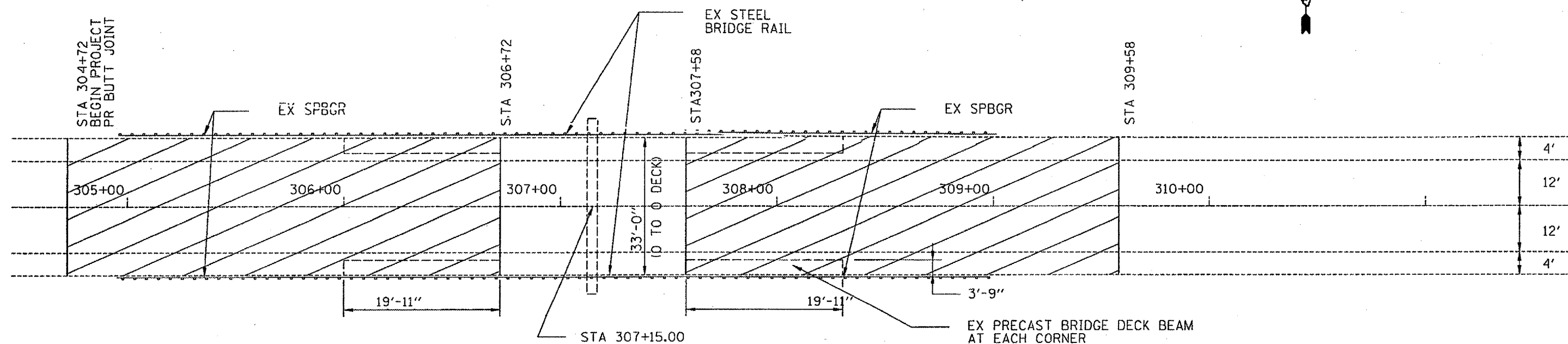

PLAN VIEW

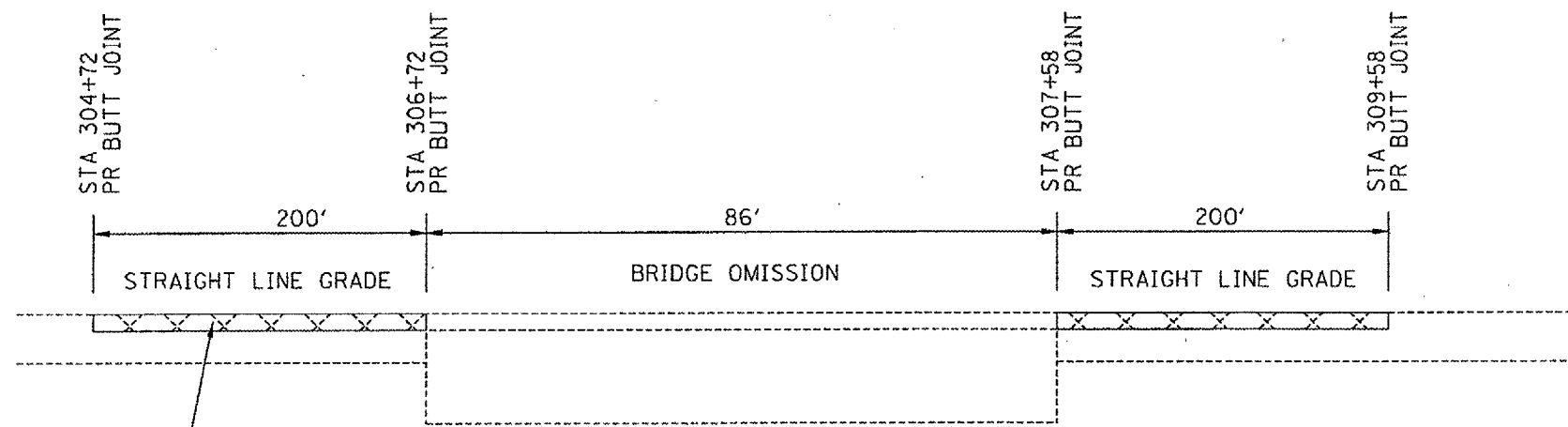

\* PR BIT. SURF. REM. (BUTT JOINT) - 2" AVG  
 & \* PR BIT. CONC. SURF. CSE., SUPERPAVE, MIX "C", N50 (2")

REVISIONS	
NAME	DATE

ILLINOIS DEPARTMENT OF TRANSPORTATION  
 PLAN AND ELEVATION DETAILS

FAP 717  
 SECTION 1091-1  
 LOGAN COUNTY

SCALE: VERT.  
 DATE: HORIZ.

DRAWN BY  
 CHECKED BY