

ITEM 16A
LETTING DATE: APRIL 25, 2025

TOTAL SHEETS: 10
PO021

CONSTRUCTION PLANS FOR
PONTIAC MUNICIPAL AIRPORT
CITY OF PONTIAC
PONTIAC, ILLINOIS

IL. PROJ. NO. PNT-5182
AIP PROJ. NO. 3-17-SBGP-XX

RECONSTRUCT T-HANGAR PAVEMENTS

Sheet List Table	
Sheet Number	Sheet Title
GI001	COVER SHET
GI101	SITE PLAN
GC001	CONSTRUCTION ACTIVITY NOTES
GC002	CONSTRUCTION ACTIVITY DETAILS
GC101	CONSTRUCTION ACTIVITY PLAN
CD101	EXISTING CONDITIONS & REMOVALS
CP100	PROJECT CONTROL & ALIGNMENT DATA
CP101	PROPOSED IMPROVEMENTS
CP301	TYPICAL SECTIONS
CS101	STAKING PLAN 1

SUMMARY OF QUANTITIES			
BASE BID			
ITEM NO.	DESCRIPTION	UNIT	QUANTITY
AR150520	MOBILIZATION	L SUM	1
AR152410	UNCLASSIFIED EXCAVATION	CU YD	405
AR209608	CRUSHED AGG. BASE COURSE - 8"	SQ YD	2,100
AR401010	CONTRACTOR QUALITY CONTROL PROGRAM	L SUM	1
AR401610	BITUMINOUS SURFACE COURSE	TON	490
AR501900	REMOVE PCC PAVEMENT	SQ YD	950
AR602510	BITUMINOUS PRIME COAT	GALLON	525
AR603510	BITUMINOUS TACK COAT	GALLON	315
ADDITIVE ALTERNATE #1 - SUBGRADE REPAIR			
ITEM NO.	DESCRIPTION	UNIT	QUANTITY
AS152515	SUBGRADE UNDERCUT	CU YD	210

MARCH, 10 2025



Know what's below.
Call before you dig.

COMMON GROUND ALLIANCE

www.call811.com or
Phone: 811

THE LOCATION, SIZE AND TYPE OF MATERIAL OF EXISTING UNDERGROUND UTILITIES INDICATED ON THE PLANS IS NOT REPRESENTED AS BEING ACCURATE, SUFFICIENT OR COMPLETE. IT SHALL BE THE CONTRACTOR'S RESPONSIBILITY TO DETERMINE THE ACTUAL LOCATION OF ALL SUCH FACILITIES, INCLUDING SERVICE CONNECTIONS TO UNDERGROUND UTILITIES. PRIOR TO CONSTRUCTION, THE CONTRACTOR SHALL NOTIFY THE UTILITY COMPANIES OF HIS OPERATIONAL PLANS AND SHALL OBTAIN FROM THE RESPECTIVE UTILITY COMPANIES DETAILED INFORMATION AND ASSISTANCE RELATIVE TO THE LOCATION OF THEIR FACILITIES AND THE WORKING SCHEDULE OF THE COMPANIES FOR REMOVAL OR ADJUSTMENT WHERE REQUIRED. IN THE EVENT AN UNEXPECTED UTILITY INTERFERENCE IS ENCOUNTERED DURING CONSTRUCTION, THE CONTRACTOR SHALL IMMEDIATELY NOTIFY THE UTILITY COMPANY OF JURISDICTION. THE ENGINEER SHALL ALSO BE IMMEDIATELY NOTIFIED. ANY SUCH MAINS AND SERVICES SHALL BE RESTORED TO SERVICE AT ONCE AND PAID FOR BY THE CONTRACTOR AT NO ADDITIONAL COST TO THE CONTRACT.

CALL 911 IN THE EVENT IN WHICH DAMAGE RESULTS IN THE RELEASE OF NATURAL GAS.

DESIGN INFORMATION

GEOMETRIC CRITERIA

TAXIWAY CONSTRUCTION

DESIGN GROUP - I

WING SPAN - UP TO BUT NOT INCLUDING 40 FEET.

DESIGN APPROACH CATEGORY - A

PONTIAC MUNICIPAL AIRPORT

TOWNSHIP: T28N
RANGE: R5E
SECTION: 3
COUNTY: LIVINGSTON
CIVIL TOWNSHIP: PONTIAC

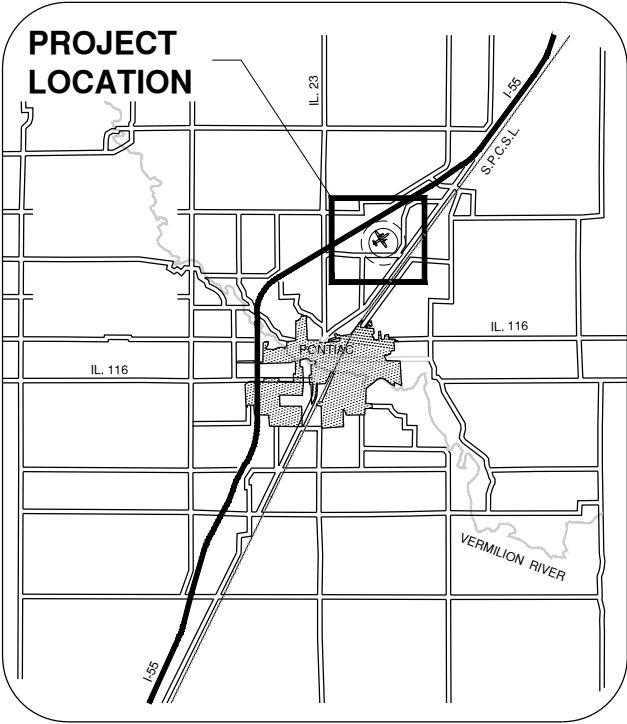

LOCATION MAP

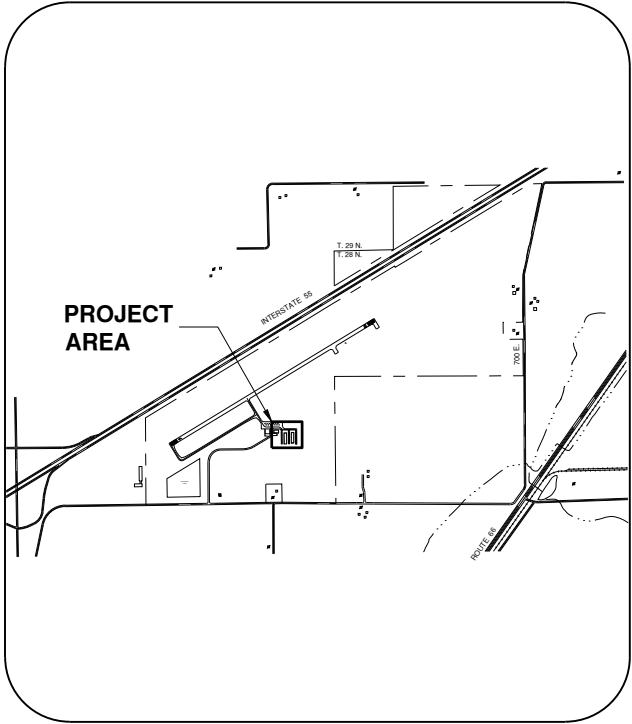

SITE PLAN



Exp. 11/30/2025

CITY OF PONTIAC
PONTIAC MUNICIPAL AIRPORT
PONTIAC, ILLINOIS

APPROVED 
CITY ADMINISTRATOR

DATE 3/6/2025



■ SPRINGFIELD, IL ■ AURORA, IL ■ PEORIA, IL

SUBMITTED BY 
DATE 02/27/2025

CMT JOB NUMBER: 24007712-00

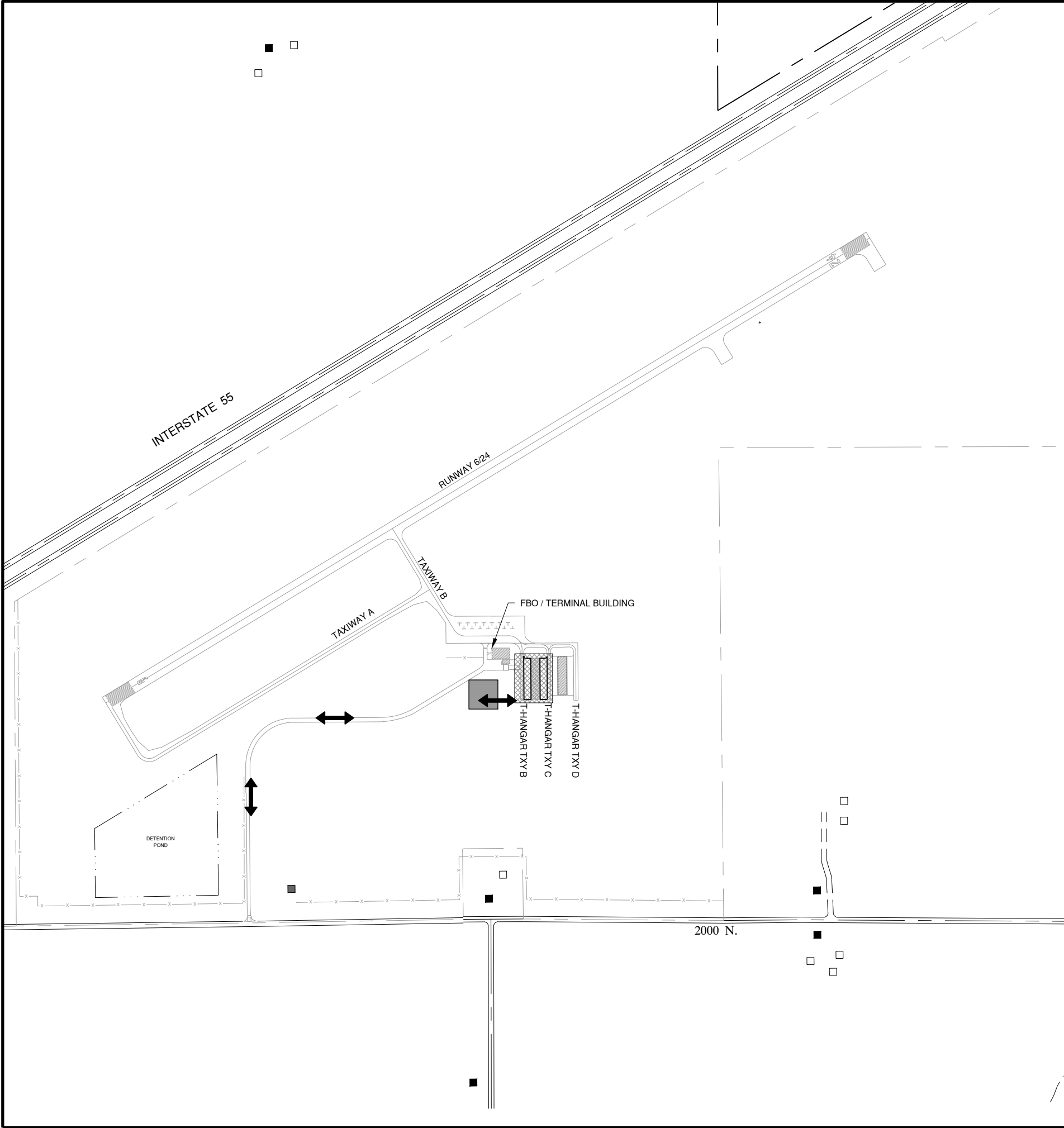

Path: K:\Pontiac\AP\24007712-00_Reconstruct\Thg\Pvt\Draw\Shwets\24007712-G1100.dwg
Date: Thursday, March 6, 2025 1:48:59 PM



NOTES

1. THE CONTRACTOR WILL BE PERMITTED TO STORE EQUIPMENT AND MATERIALS AT THE LOCATION SHOWN ON THE CONSTRUCTION ACTIVITY PLAN. THE MAXIMUM HEIGHT OF EQUIPMENT, MATERIALS, AND STOCKPILES SHALL BE 25 FEET ABOVE GROUND ELEVATION.
2. ALL CONSTRUCTION TRAFFIC OPERATING ON OR CROSSING TAXIWAYS AND APRONS OPEN TO AIRCRAFT TRAFFIC SHALL BE UNDER CONTROL OF AN ESCORT.
3. WHEN CONFLICTS ARISE BETWEEN CONSTRUCTION ACTIVITIES AND AIRCRAFT OPERATIONS AND SAFETY, AIRCRAFT OPERATIONS AND SAFETY SHALL TAKE PRECEDENCE AND SHALL GOVERN. FINAL AUTHORITY IN THE APPROVAL OF CONSTRUCTION SEQUENCING LIES WITH THE CITY.
4. ROADS AND/OR STORAGE AREAS SHALL BE MAINTAINED AND REPAIRED IN KIND BY THE CONTRACTOR TO THE SATISFACTION OF THE RESIDENT ENGINEER AND THE AIRPORT. NO ADDITIONAL COMPENSATION SHALL BE MADE TO THE CONTRACTOR FOR THIS WORK.
5. ALL DISTURBED AREAS WITHIN THE PROJECT LIMITS SHALL BE SEEDED AND STABILIZED. ANY AREAS DISTURBED BY THE CONTRACTOR OUTSIDE THE LIMITS SHOWN SHALL BE SEEDED & STABILIZED AT THE CONTRACTOR'S EXPENSE TO THE SATISFACTION OF THE RESIDENT ENGINEER AND THE AIRPORT.
6. THE CONTRACTOR SHALL CONTINUOUSLY CLEAN CONSTRUCTION AREAS WHICH WILL BE OPENED TO AIR TRAFFIC.
7. IT WILL BE NECESSARY FOR THE CONTRACTOR TO MAKE HIS OWN FIELD INVESTIGATION TO DETERMINE THE EXACT LOCATION OF THE UNDERGROUND UTILITIES AT CRITICAL POINTS SO AS TO AVOID ANY DAMAGE. ANY UTILITY, INCLUDING AIRFIELD ELECTRICAL CABLE AND LIGHTS, DAMAGED BY THE CONTRACTOR SHALL BE REPAIRED BY HIM AT HIS OWN EXPENSE IN A MANNER WHICH IS SATISFACTORY TO THE RESIDENT ENGINEER AND TO THE OWNER OF THE UTILITY. ANY REPAIRS THAT MUST BE MADE BY THE OWNER OF THE UTILITY SHALL HAVE THE COST REIMBURSED TO THE UTILITY BY THE CONTRACTOR. AIRFIELD LIGHTING CABLES DAMAGED BY THE CONTRACTOR SHALL BE REPAIRED BY A QUALIFIED ELECTRICIAN WITH THE COSTS TO BE BORNE BY THE CONTRACTOR.
8. SEE CONSTRUCTION ACTIVITY PLAN SHEETS FOR NOTES REGARDING THE CONTRACTOR'S ACCESS AND DETAILED PHASING REQUIREMENTS.
9. CONTRACTOR'S VEHICLES AND EQUIPMENT SHALL BE LIGHTED, MARKED, AND FLAGGED PER SECTION 70-10 OF THE STANDARD SPECIFICATIONS. MAXIMUM HEIGHT OF CONTRACTOR'S EQUIPMENT WILL BE 25 FEET.
10. THE CONTRACTOR SHALL TAKE ALL NECESSARY PRECAUTIONS TO PROTECT PUBLIC AND PRIVATE PROPERTY INCLUDING UTILITIES AND STRUCTURES TO REMAIN. IF AT ANY TIME, THE CONTRACTOR DAMAGES OR DESTROYS ANY OTHER PUBLIC OR PRIVATE PROPERTY, THE CONTRACTOR SHALL, AT HIS OWN EXPENSE, RESTORE SUCH PROPERTY TO A CONDITION EQUAL TO THAT OF EXISTING BEFORE SUCH DAMAGE. PUBLIC ROADWAYS, PRIVATE ENTRANCES, AND OTHER FACILITIES SHALL REMAIN ACCESSIBLE AND FREE OF CONSTRUCTION DEBRIS. ANY MATERIAL TO BE STAGED OR STOCKPILED SHALL BE COORDINATED WITH THE AIRPORT THROUGH THE RESIDENT ENGINEER.
11. IF EXISTING ROADWAY SIGNS INTERFERE WITH THE INSTALLATION OF THE WORK FOR THIS PROJECT, SUCH SIGNS AND POSTS SHALL BE REMOVED AND REPLACED AFTER CONSTRUCTION. THE COST OF REMOVING AND STORING EXISTING SIGNS WILL NOT BE PAID FOR DIRECTLY. THE COST SHALL BE INCLUDED IN OTHER PAY ITEMS.
12. ACCESS TO ALL ENTRANCES SHALL BE MAINTAINED AT ALL TIMES UNLESS NOTED OTHERWISE ON THE PLANS.

LEGEND

-  AREA OF CONSTRUCTION
-  CONTRACTOR'S STAGING, STORAGE & PARKING AREA
-  CONTRACTORS ACCESS



License No. 184-000613

CONSULTANTS

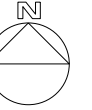

THIS BAR IS EQUAL TO 2" AT FULL SCALE (34X22).

100% SUBMITTAL
APRIL, 25 2025

RECONSTRUCT T-HANGAR PAVEMENTS

OWNER



PONTIAC
ILLINOIS

CITY OF PONTIAC
PONTIAC MUNICIPAL AIRPORT
PONTIAC, ILLINOIS

MARK | DATE | DESCRIPTION

AIP PROJ. NO. 3-17-SBGP-XX PO021

IL PROJ. NO. PNT-5182

CMT PROJECT NO: 24007712

CAD DWG FILE: 24007712-G1100.DWG

DESIGNED BY: MRK

DRAWN BY: MRK

CHECKED BY: MJD

APPROVED BY: CBG

COPYRIGHT:

SHEET TITLE

SITE PLAN

G1101
SHEET 2 OF 10

Path: K:\Pontiac\AP\24007712-00_Reconstruct\ThgPvtDraw\Shwets\24007712-GC000.dwg
Date: Thursday, March 6, 2025 1:40:05 PM

0. GENERAL
1.

THE CONTRACTOR AND ALL SUBCONTRACTORS SHALL FOLLOW THE REQUIREMENTS OF THE AIRPORT'S APPROVED CONSTRUCTION SAFETY AND PHASING PLAN (CSPP), FAA AC 150/5370-2 (LATEST VERSION), AND ALL AIRPORT SAFETY AND SECURITY REQUIREMENTS.
2.

PRIOR TO THE START OF CONSTRUCTION THE CONTRACTOR SHALL SUBMIT TO THE AIRPORT FOR APPROVAL A SAFETY PLAN COMPLIANCE DOCUMENT (SPCD) IN ACCORDANCE WITH FAA AC 150/5370-2 (LATEST VERSION). NO CONSTRUCTION ACTIVITY SHALL BEGIN UNTIL THE AIRPORT HAS APPROVED THE SPCD.
3.

THE CSPP COVERS OPERATIONAL SAFETY. THE CONTRACTOR SHALL BE RESPONSIBLE FOR THE INDIVIDUAL SAFETY OF HIS/HER PERSONNEL AND MEETING OSHA REQUIREMENTS.
4.

PRIOR TO THE START OF CONSTRUCTION THE CONTRACTOR SHALL PROVIDE A LIST OF SUBCONTRACTORS AND MATERIAL SUPPLIERS.
5.

ALL CONTRACTOR COSTS ASSOCIATED WITH THE REQUIREMENTS LISTED ON THIS SHEET SHALL BE CONSIDERED INCIDENTAL TO THE CONTRACT UNLESS A SPECIFIC PAY ITEM IS PROVIDED.
6.

WORK SHALL BE COMPLETED IN 17 CALENDAR DAYS (BASE BID), +1 DAYS FOR THE FIRST AWARDED ADDITIVE ALTERNATE.
7.

CONSTRUCTION SHALL NOT BEGIN UNTIL A MUTUALLY AGREED UPON DATE BETWEEN THE CONTRACTOR & THE CITY AFTER MAY 1ST 2024.

1. COORDINATION
1.

PRIOR TO THE START OF CONSTRUCTION THE CONTRACTOR SHALL ATTEND A PRECONSTRUCTION CONFERENCE WITH THE AIRPORT, ENGINEER, AND ILLINOIS DIVISION OF AERONAUTICS (IDA). THE COST OF PREPARING FOR AND ATTENDING THE PRECONSTRUCTION CONFERENCE SHALL BE INCIDENTAL TO THE CONTRACT.
2.

ON OR BEFORE THE PRECONSTRUCTION CONFERENCE, THE CONTRACTOR SHALL SUBMIT A PROPOSED SCHEDULE FOR THE PROJECT. THE SCHEDULE SHALL INCLUDE A START AND COMPLETION DATE FOR EACH ITEM OF WORK. THE SCHEDULE SHALL BE UPDATED ON A WEEKLY BASIS. ALL COSTS ASSOCIATED WITH THE SCHEDULE SHALL BE INCIDENTAL TO THE CONTRACT.
3.

DURING CONSTRUCTION THE CONTRACTOR SHALL ATTEND A WEEKLY COORDINATION MEETING WITH THE AIRPORT STAFF AND RPR. ALL COSTS ASSOCIATED WITH ATTENDING THE WEEKLY MEETING SHALL BE INCIDENTAL TO THE CONTRACT.

2. PHASING
1.

PHASING SHALL BE AS NOTED BELOW AND AS SHOWN ON THE CONSTRUCTION ACTIVITY PLAN (CAP) SHEETS.

3. AREAS AND OPERATIONS AFFECTED BY THE CONSTRUCTION ACTIVITY
1.

ALL RUNWAYS, TAXIWAYS AND APRONS SHALL BE KEPT OPEN TO AIRCRAFT TRAFFIC DURING CONSTRUCTION EXCEPT AS ALLOWED IN THE PLANS.
2.

WHEN CONFLICTS ARISE BETWEEN CONSTRUCTION ACTIVITIES AND AIRCRAFT OPERATIONS AND SAFETY, AIRCRAFT OPERATIONS AND SAFETY SHALL TAKE PRECEDENCE AND SHALL GOVERN. FINAL AUTHORITY IN THE APPROVAL OF CONSTRUCTION SEQUENCING LIES WITH THE AIRPORT.
3.

ALL CONSTRUCTION TRAFFIC SHALL IMMEDIATELY YIELD TO ONCOMING AIRCRAFT AT ALL TIMES.
4.

THE CONTRACTORS STORAGE AND STAGING AREAS WILL BE AS SHOWN IN THE PLANS.

4. PROTECTION OF NAVIGATION AIDS (NAVAIDS)
1.

THE CONTRACTOR SHALL REMAIN CLEAR OF NAVAID FACILITIES AT ALL TIMES.

5. CONTRACTOR ACCESS
1.

CONTRACTOR ACCESS SHALL BE AS NOTED BELOW AND AS SHOWN IN THE PLANS. ALL COSTS RELATING TO CONTRACTOR'S ACCESS AND SECURITY SHALL BE THE RESPONSIBILITY OF THE CONTRACTOR.
2.

THE CONTRACTOR IS TO ACCESS THE SITE USING THE GATES SHOWN. THE CONTRACTOR SHALL BE RESPONSIBLE FOR KEEPING THE ACCESS GATE(S) CLOSED DURING WORK HOURS OR THE CONTRACTOR SHALL POST A COMPETENT SECURITY GUARD TO CONTROL ACCESS AT THE GATE. THE CONTRACTOR SHALL REPLACE ANY UNSATISFACTORY SECURITY GUARDS AS DIRECTED.

5. CONTRACTOR ACCESS (CONT.)
3.

CONTRACTOR SHALL OBTAIN ALL NECESSARY PERMITS AND TEMPORARY EASEMENTS FOR THE PUBLIC ACCESS ROAD(S) SHOWN AND SHALL COMPLY WITH ALL REQUIREMENTS, LOAD RESTRICTIONS, & TRAFFIC CONTROL SIGNAGE REQUIRED BY THE CITY, COUNTY, TOWNSHIP, OR I.D.O.T.
4.

CONTRACTOR'S VEHICLES AND EQUIPMENT SHALL BE MARKED AND FLAGGED PER THE PLAN DETAILS AND SPECIFICATIONS. MAXIMUM HEIGHT OF CONTRACTOR'S EQUIPMENT WILL BE 25'.
5.

DRIVERS OF TRUCKS CONTAINING MATERIAL DELIVERIES (AGGREGATE, CONCRETE, ETC.) WILL NOT NEED TO OBTAIN AN AIRPORT ID BADGE BUT SHALL BE REQUIRED TO SUBMIT THEIR NAME, DRIVER'S LICENSE NUMBER, TRUCK LICENSE PLATE NUMBER AND NAME OF TRUCKING COMPANY TO THE PRIME CONTRACTOR PRIOR TO ENTERING THE JOBSITE. WHILE INSIDE THE AOA, THE TRUCK DRIVERS SHALL BE UNDER THE CONTROL OF AND SUPERVISED BY THE CONTRACTOR.
6.

ALL CONSTRUCTION TRAFFIC OPERATING ON, OR CROSSING RUNWAYS, TAXIWAYS AND APRONS OPEN TO AIRCRAFT TRAFFIC SHALL BE UNDER CONTROL BY A FLAGMAN OR ESCORT. THE CONTRACTOR SHALL PROVIDE HIS OWN FLAGMEN.
7.

THE CONTRACTORS STORAGE AND STAGING AREAS WILL BE AS SHOWN IN THE PLANS.
8.

THE CONTRACTOR SHALL KEEP A RECORD OF THE NAMES OF ALL EMPLOYEES ENTERING THE JOB SITE ON A DAILY BASIS. A RECORD OF EACH SUBCONTRACTOR ENTERING THE JOB SITE SHALL ALSO BE KEPT BY THE CONTRACTOR.

9.

WHEN THE CONTRACTOR IS NOT WORKING, EQUIPMENT SHALL BE RETURNED TO & STORED AT THE STAGING AREA.
10.

DURING ADVERSE WEATHER THE CONTRACTOR SHALL MAINTAIN ACCESS TO THE WORK AT NO ADDITIONAL COST TO THE CONTRACT. NO EXTENSION OF THE CONTRACT TIME WILL BE CONSIDERED FOR DELAYS DUE TO LACK OF ADEQUATE ACCESS TO THE WORK SITE.
11.

THE CONTRACTOR WILL BE PERMITTED TO STORE EQUIPMENT AND MATERIALS ONLY AT THE LOCATIONS SHOWN. PARKED EQUIPMENT AND MATERIAL STOCKPILES SHALL NOT PENETRATE SURFACES DEFINED BY F.A.R. TITLE 14 PART 77 - OBJECTS AFFECTING NAVIGABLE AIRSPACE. EXISTING TURF AREAS DISTURBED BY THE CONTRACTOR'S OPERATIONS SHALL BE RESTORED BY HIM AT HIS EXPENSE TO THE SATISFACTION OF THE ENGINEER AND THE AIRPORT.
12.

THE CONTRACTOR SHALL THOROUGHLY CLEAN ALL CONSTRUCTION AREAS AND HAUL ROUTES WHICH ARE OR WILL BE OPENED TO AIR TRAFFIC OR VEHICULAR TRAFFIC TO THE SATISFACTION OF THE AIRPORT. A POWER BROOM AND OPERATOR SHALL BE ON SITE AT ALL TIMES WHEN ACTIVE PAVEMENTS ARE UTILIZED FOR CONSTRUCTION TRAFFIC.
13.

ALL PAVEMENTS, DRIVES OR ANY OTHER AREAS UTILIZED BY THE CONTRACTOR FOR HAUL ROADS OR STORAGE AREAS SHALL BE MAINTAINED AND REPAIRED TO THE SAME CONDITION OR BETTER THAN THEY WERE PRIOR TO BEGINNING CONSTRUCTION. NO ADDITIONAL COMPENSATION WILL BE MADE TO THE CONTRACTOR FOR THIS WORK.
14.

ALL VEHICLE AND EQUIPMENT OPERATORS USED BY THE CONTRACTOR SHALL BE PROPERLY TRAINED BY THE CONTRACTOR.
15.

THE CONTRACTOR SHALL NOTIFY THE APPROPRIATE SAFTEY AGENCY AND/OR THE AIRCRAFT RESCUE AND FIRE FIGHTING (ARFF) FACILITY IF CONSTRUCTION ACTIVITY MAY REQUIRE THE BLOCKAGE OF EMERGENCY ACCESS TO THE AIRPORT.

6. WILDLIFE MANAGEMENT
1.

THE CONTRACTOR SHALL NOTIFY THE AIRPORT IF ANY WILDLIFE IS SEEN ON OR ENTERING THE AIRPORT.
2.

CONTRACTOR ACCESS GATES SHALL REMAIN CLOSED WHEN THE CONTRACTOR IS NOT WORKING. ANY JOBSITE FENCING IS TO BE INSPECTED & MAINTAINED BY THE CONTRACTOR.
3.

THE CONTRACTOR SHALL DISPOSE OF ALL TRASH INCLUDING FOOD SCRAPS IN APPROVED CONTRACTOR PROVIDED CONTAINERS.
4.

THE CONTRACTOR SHALL CONTROL GRASS HEIGHTS WITHIN THE WORK AREA THROUGH MOWING TO ASSIST WITH WILDLIFE CONTROL.
5.

THE CONTRACTOR SHALL TAKE NECESSARY METHODS TO PREVENT & REMOVE THE ACCUMULATION OF STANDING WATER ON THE JOBSITE. STANDING WATER SHALL NOT EXIST FOR MORE THAN 48 HOURS.
7. FOREIGN OBJECT DEBRIS (FOD) MANAGEMENT

1.

THE CONTRACTOR SHALL PICK UP ANY FOREIGN OBJECT DEBRIS (FOD) SEEN ON THE AIRFIELD PAVEMENTS.

2.

THE CONTRACTOR SHALL SECURE ALL LOOSE ITEMS FROM VEHICLES PRIOR TO DRIVING ON AIRFIELD PAVEMENTS.

8. HAZARDOUS MATERIALS (HAZMAT) MANAGEMENT
1.

THE CONTRACTOR SHALL DEVELOP A HAZMAT MANAGEMENT PLAN AND KEEP COPIES ON THE JOBSITE OF MATERIAL SAFETY DATA SHEETS (MSDS) FOR ALL MATERIALS HANDLED ON THE JOBSITE.

9. NOTIFICATION OF CONSTRUCTION ACTIVITIES
1.

THE CONTRACTOR SHALL PROVIDE A 24 HOUR EMERGENCY CONTACT PERSON AND PHONE NUMBER.
2.

THE CONTRACTOR SHALL GIVE A MINIMUM OF 72 HOURS NOTICE TO THE AIRPORT PRIOR TO CLOSING ANY PAVEMENTS SO THAT PROPER NOTAMS MAY BE ISSUED BY THE AIRPORT.
3.

FOR ANY EQUIPMENT USED BY THE CONTRACTOR WITH A HEIGHT GREATER THAN 25', THE CONTRACTOR SHALL PROVIDE TO THE AIRPORT THE TYPE OF EQUIPMENT, TOTAL HEIGHT, AND LOCATION WHERE THE EQUIPMENT WILL BE USED. THE AIRPORT WILL SUBMIT FAA FORM 7460-1 TO THE FAA FOR AN AIRSPACE STUDY. NO EQUIPMENT WITH A HEIGHT GREATER THAN 25' SHALL BE USED UNTIL A DETERMINATION FROM FAA IS RECEIVED.
4.

IN THE EVENT OF AN EMERGENCY, THE CONTRACTOR SHALL CALL 911, FOLLOWED BY AIRPORT OPERATIONS.

<u>AIRPORT MANAGER</u> SARAH PETERSEN	815-844-3396
<u>CITY ADMINISTRATOR</u> JIM WOOLFORD	815-844-3396

10. INSPECTION REQUIREMENTS
1.

THE CONTRACTOR SHALL INSPECT THE JOBSITE DAILY TO ENSURE COMPLIANCE WITH THE CSPP. THE CHECKLIST FOUND IN APPENDIX 3 OF FAA AC 150/5370-2 (LATEST VERSION) MAY BE USED TO AID IN THE INSPECTIONS.
2.

THE CONTRACTOR SHALL REQUEST AND ATTEND AN INSPECTION OF EACH PHASE WORK AREA PRIOR THE AREA BEING REOPENED. THE AIRPORT WILL DETERMINE IF THE WORK AREA IS SUITABLE TO BE OPENED.
3.

THE CONTRACTOR SHALL SUBMIT TO THE RESIDENT ENGINEER A "SUBSTANTIALLY COMPLETE" LETTER WHEN HE FEELS THE PROJECT IS COMPLETE AND AT THE POINT OF HAVING FINAL ACCEPTANCE. UPON THE RESIDENT ENGINEERS RECOMMENDATION TO IDA, A FINAL ACCEPTANCE OF THE PROJECT WILL THEN BE SCHEDULED.

11. UNDERGROUND UTILITIES
1.

IT WILL BE NECESSARY FOR THE CONTRACTOR TO MAKE HIS OWN FIELD INVESTIGATION TO DETERMINE THE EXACT LOCATION OF THE UNDERGROUND UTILITIES AT CRITICAL POINTS. THE LOCATION OF UNDERGROUND UTILITIES AS INDICATED ON THE PLANS HAS BEEN OBTAINED FROM EXISTING RECORDS. NEITHER THE OWNER NOR THE ENGINEER ASSUMES ANY RESPONSIBILITY IN RESPECT TO THE ACCURACY, COMPLETENESS OR SUFFICIENCY OF THE INFORMATION. ANY UTILITY, INCLUDING AIRFIELD ELECTRICAL CABLE AND LIGHTS, DAMAGED BY THE CONTRACTOR SHALL BE REPAIRED BY HIM AT HIS OWN EXPENSE IN A MANNER WHICH IS SATISFACTORY TO THE ENGINEER AND TO THE OWNER OF THE UTILITY. ANY REPAIRS THAT MUST BE MADE BY THE OWNER OF THE UTILITY SHALL HAVE THE COST REIMBURSED TO THE UTILITY BY THE CONTRACTOR. AIRFIELD LIGHTING CABLES DAMAGED BY THE CONTRACTOR SHALL BE REPAIRED BY A QUALIFIED ELECTRICIAN WITH THE COSTS TO BE BORNE BY THE CONTRACTOR.
2.

BEFORE INITIATING ANY DIGGING, DRILLING OR EXCAVATING ON THE AIRPORT PROPERTY, THE CONTRACTOR SHALL CALL J.U.L.I.E. THE AIRPORT, AND CONTACT THE LOCAL FAA OFFICE (847-294-7336) TO ARRANGE FOR UTILITY LOCATES.

12. PENALTIES
1.

NONCOMPLIANCE BY THE CONTRACTOR WITH AIRPORT RULES AND REGULATIONS OR FAILURE TO COMPLY WITH THE AIRPORT'S APPROVED CSPP, THE CONTRACTOR'S APPROVED SPCD OR THE SECURITY PLAN MAY RESULT IN FINES AS ALLOWED BY LAW.

13. SPECIAL CONDITIONS
1.

ADJACENT CONSTRUCTION MAY IMPACT THE OPERATIONS OF THE CONTRACTOR. SEE THE COORDINATION NOTES FOR ADDITIONAL INFORMATION.

14. RUNWAY AND TAXIWAY VISUAL AIDS
1.

ALL RUNWAYS, TAXIWAYS, AND APRONS SHALL BE KEPT OPEN TO AIRPORT TRAFFIC DURING CONSTRUCTION EXCEPT AS NOTED IN THE PLANS.
2.

IF ANY RUNWAY OR TAXIWAY CLOSURES ARE REQUESTED BY THE CONTRACTOR AND APPROVED BY THE AIRPORT, THE CONTRACTOR SHALL USE MARKING, LIGHTING AND SIGNS THAT FOLLOWING THE REQUIREMENTS OF THE PLANS & FAA AC 150/5370-2 (LATEST VERSION.)

15. MARKING AND SIGNS FOR ACCESS ROUTES
1.

BARRICADES AND SIGNS SHALL BE USED ALONG THE CONTRACTOR'S ACCESS ROUTE AS DETAILED IN THE PLANS.

16. HAZARD MARKING AND LIGHTING
1.

THE CONTRACTOR SHALL FURNISH, ERECT, AND MAINTAIN MARKINGS AND ASSOCIATED LIGHTING OF OPEN TRENCHES, EXCAVATIONS, TEMPORARY STOCKPILES, AND CONSTRUCTION EQUIPMENT.
2.

ALL CONSTRUCTION EQUIPMENT SHALL BE FLAGGED AND/OR LIGHTED IN ACCORDANCE WITH FAA ADVISORY CIRCULAR 150/5370-2G AND 150/5210-5D (OR LATEST) AT ALL TIMES WHILE OPERATING ON AIRPORT PROPERTY. THE MAXIMUM EQUIPMENT HEIGHT IS 25'.
3.

BARRICADES SHALL BE PLACED AT THE LOCATIONS SHOWN IN THE PLANS OR AS DIRECTED BY THE AIRPORT.
4.

THE CONTRACTOR SHALL INSPECT THE BARRICADES ONCE DURING EACH WORK DAY TO INSURE PROPER PLACEMENT AND PROPER OPERATION OF THE LIGHTS AND FLAG PLACEMENT.

17. PROTECTION OF AREAS & SURFACES
1.

ALL WORK REQUIRED ON AN ACTIVE TAXIWAY OR INSIDE OF AN ACTIVE TAXIWAY OBJECT FREE AREA, WHICH EXTENDS 44.5' FROM THE TAXIWAY CENTERLINE, WILL REQUIRE THE TAXIWAY TO BE CLOSED. THE CONTRACTOR SHALL COORDINATE WITH THE AIRPORT A MINIMUM OF 72 HOURS PRIOR TO THE REQUESTED CLOSURE TIME.
2.

ALL WORK REQUIRED ON AN ACTIVE TAXILANE OBJECT FREE AREA, WHICH EXTENDS 39.5' FROM THE TAXILANE/APRON CENTERLINE, WILL REQUIRE A PORTION OF THAT APRON TO BE CLOSED. THE CONTRACTOR SHALL COORDINATE WITH THE AIRPORT A MINIMUM OF 72 HOURS PRIOR TO THE REQUESTED CLOSURE TIME.

18. OTHER LIMITATIONS ON CONSTRUCTION
1.

IF, DURING CONSTRUCTION, AN EMERGENCY IS DECLARED BY THE AIRPORT, THE CONTRACTOR SHALL IMMEDIATELY CLEAR THE PAVEMENT OF ALL VEHICLES, PERSONNEL AND EQUIPMENT.
2.

BROKEN CONCRETE, BROKEN ASPHALT, RUBBISH FROM DEMO, AND OTHER MISCELLANEOUS DEBRIS SHALL BE DISPOSED OF OFF AIRPORT PROPERTY, UNLESS OTHERWISE SPECIFIED.

19. AIRPORT SECURITY REQUIREMENTS
1.

MAINTAINING THE SECURITY REQUIREMENTS OF THE AIRPORT SHALL BE A PRIMARY CONCERN FOR THE CONTRACTOR.
2.

THE CONTRACTOR WILL BE RESPONSIBLE FOR MAINTAINING AIRPORT SECURITY BY SUPERVISING OPENINGS OR MAINTAINING THE AIRPORT PERIMETER FENCE LINE AT ALL TIMES.
3.

AS A MINIMUM, THE CONTRACTOR SHALL BE RESPONSIBLE FOR SECURITY DURING CONSTRUCTION AS FOLLOWS:

a.

VISIBLY DELINEATE HIS CONSTRUCTION ZONE BY PLACING A LINE OF BARRICADES OR FLAGGING AROUND THE WORK ZONE PAVEMENTS DURING EACH PHASE OF THE CONTRACT.

b.

ENSURE THAT NO CONSTRUCTION EMPLOYEES, EMPLOYEES OF SUBCONTRACTORS OR SUPPLIERS, OR OTHER PERSONS ENTER ANY PART OF THE AIRCRAFT OPERATIONS AREA FROM CONSTRUCTION SITE UNLESS AUTHORIZED.

c.

THE CONTRACTOR SHALL BE REQUIRED TO MAINTAIN SECURITY ON THE AIRPORT AS SPECIFIED OR AS DIRECTED BY THE AIRPORT.

d.

THE CONTRACTOR WILL DESIGNATE A MINIMUM OF ONE INDIVIDUAL TO BE THE 24-HOUR POINT OF CONTACT AND ASSUME ALL ON-SITE SECURITY RESPONSIBILITIES FOR ALL EMPLOYEES DURING THE PROJECT. THIS INDIVIDUAL SHALL PROVIDE THE AIRPORT AUTHORITY A 24-HOUR CONTACT FOR EMERGENCY PURPOSES.



License No. 184-000613
CONSULTANTS

THIS BAR IS EQUAL TO 2" AT FULL SCALE (34X22).

100% SUBMITTAL
APRIL, 25 2025

RECONSTRUCT T-HANGAR
PAVEMENTS



MARK	DATE	DESCRIPTION
------	------	-------------

AIP PROJ. NO. 3-17-SBGp-XX
IL PROJ. NO. PNT-5182
CMT PROJECT NO: 24007712
CAD DWG FILE: 24007712-GC000.DWG
DESIGNED BY: MRK
DRAWN BY: MRK
CHECKED BY: MJD
APPROVED BY: CBG
COPYRIGHT:

SHEET TITLE
CONSTRUCTION
ACTIVITY NOTES

GC001
SHEET 3 OF 10

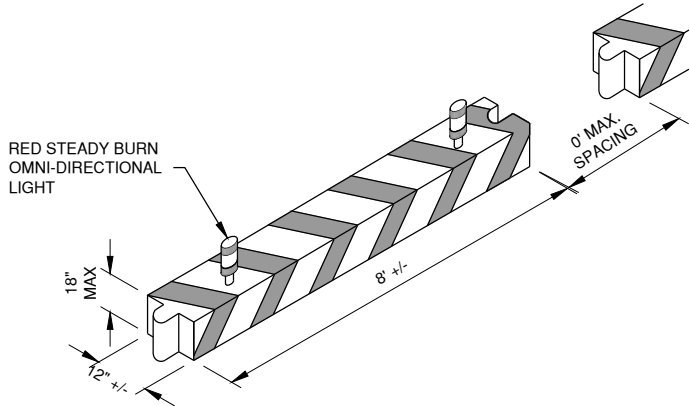
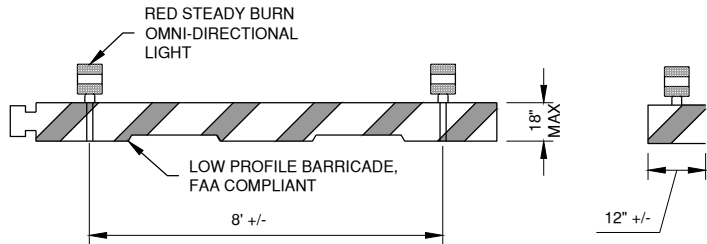

1 BEAM BARRICADE DETAIL
N.T.S.

BEAM BARRICADE NOTES

- BARRICADE SHALL BE WEIGHTED TO WITHSTAND DISPLACEMENT BY WIND, JET OR PROP BLAST.
- BARRICADE MUST BE OF LOW MASS AND EASILY COLLAPSIBLE UPON CONTACT WITH AN AIRCRAFT.
- NO SEPARATE PAYMENT WILL BE MADE FOR THIS ITEM. COSTS SHALL BE CONSIDERED INCIDENTAL TO THE PROJECT.
- PLACE AS SHOWN IN PLANS AND AS DIRECTED BY THE ENGINEER.
- BARRICADES SHALL BE COMPLIANT WITH FAA AC 150/5370-2 (LATEST VERSION).

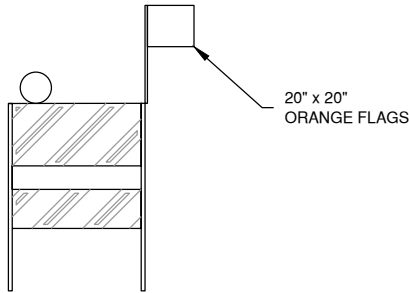

2 FLASHER BARRICADE DETAIL - IDOT TYPE 1
N.T.S.

FLASHER BARRICADE NOTES

- FLASHERS TO BE BATTERY OPERATED. LENS TO BE RED AND BE ABLE TO ROTATE 90 DEGREES.
- SANDBAGS TO BE PLACED ON EACH SUPPORT BRACE AS REQUIRED TO PREVENT DISPLACEMENT BY WIND, JET OR PROP BLAST.
- NO SEPARATE PAYMENT WILL BE MADE FOR THIS ITEM. COSTS SHALL BE CONSIDERED INCIDENTAL TO THE PROJECT.
- PLACE AT 20' INTERVALS.

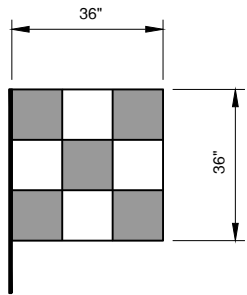

3 EQUIPMENT & VEHICLE SIGNAL FLAG
N.T.S. (ORANGE / WHITE)

SIGNAL FLAG NOTES

- ALL CONTRACTOR VEHICLES AND EQUIPMENT SHALL DISPLAY COMPANY LOGO PLACARDS AND FLAG.
- WHEN WORKING PRIOR TO DAWN OR AFTER DUSK, A 360 DEGREE ROTATING AMBER BEACON IS REQUIRED ON ALL EQUIPMENT AND TRUCKS.
- CONTRACTOR SHALL REPLACE FLAGS THAT ARE WORN AND INEFFECTIVE.



License No. 184-000613
CONSULTANTS

THIS BAR IS EQUAL TO 2" AT FULL SCALE (34X22).

100% SUBMITTAL
APRIL, 25 2025

RECONSTRUCT T-HANGAR
PAVEMENTS

OWNER



PONTIAC
ILLINOIS

CITY OF PONTIAC
PONTIAC MUNICIPAL AIRPORT
PONTIAC, ILLINOIS

MARK	DATE	DESCRIPTION

AIP PROJ. NO. 3-17-SBGP-XX

IL. PROJ. NO. PNT-5182

CMT PROJECT NO: 24007712

CAD DWG FILE: 24007712-GC000.DWG

DESIGNED BY: MRK

DRAWN BY: MRK

CHECKED BY: MJD

APPROVED BY: CBG

COPYRIGHT:

SHEET TITLE

CONSTRUCTION
ACTIVITY DETAILS

GC002
SHEET 4 OF 10

Path: K:\Pontiac\AP\24007712-00_ReconstructTHgPvtDraw\Shwets\24007712-GC100.dwg
Date: Thursday, March 6, 2025 1:40:14 PM

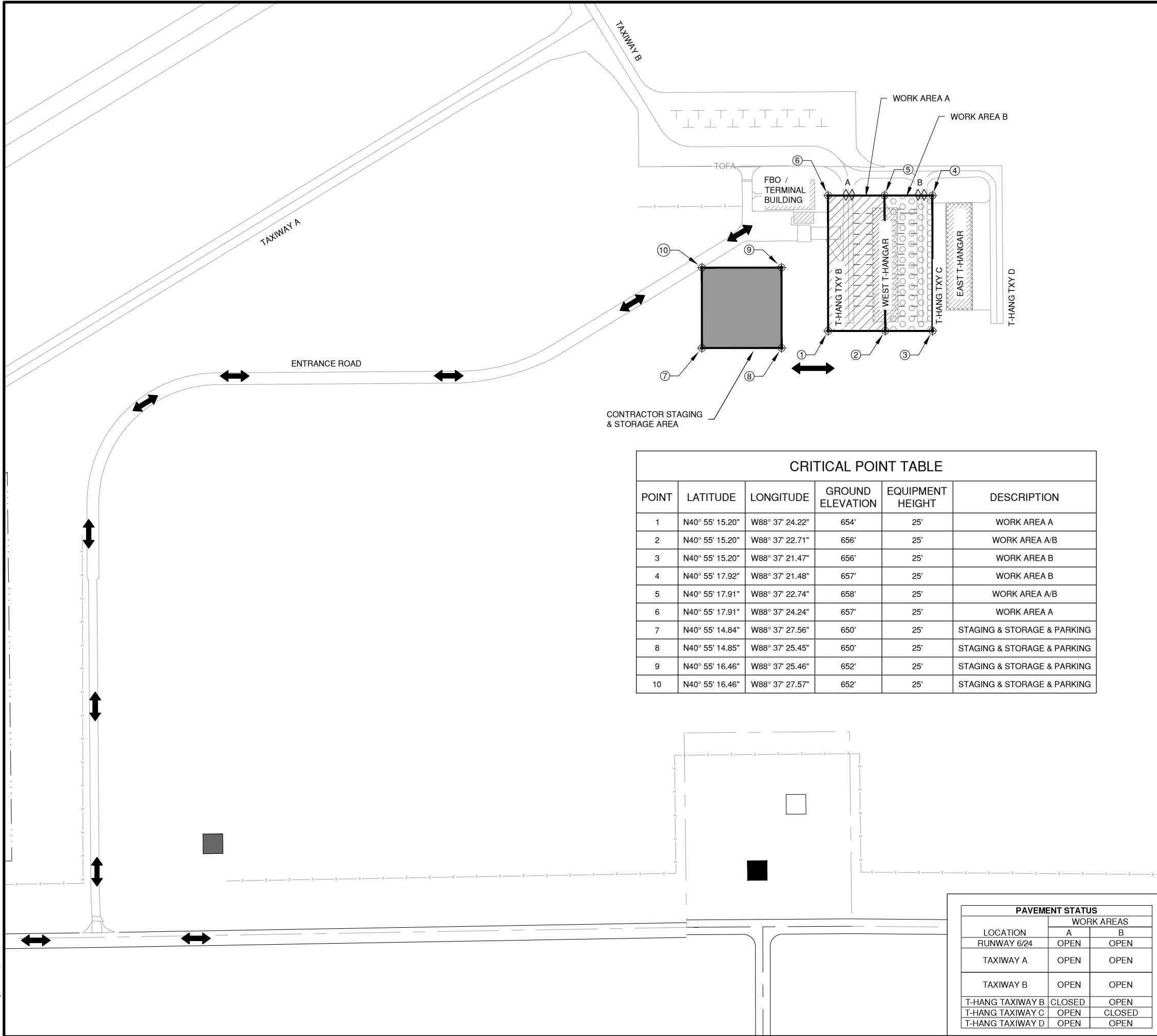

CRITICAL POINT TABLE

POINT	LATITUDE	LONGITUDE	GROUND ELEVATION	EQUIPMENT HEIGHT	DESCRIPTION
1	N40° 55' 15.20"	W88° 37' 24.22"	654'	25'	WORK AREA A
2	N40° 55' 15.20"	W88° 37' 22.71"	656'	25'	WORK AREA A/B
3	N40° 55' 15.20"	W88° 37' 21.47"	656'	25'	WORK AREA B
4	N40° 55' 17.92"	W88° 37' 21.48"	657'	25'	WORK AREA B
5	N40° 55' 17.91"	W88° 37' 22.74"	658'	25'	WORK AREA A/B
6	N40° 55' 17.91"	W88° 37' 24.24"	657'	25'	WORK AREA A
7	N40° 55' 14.84"	W88° 37' 27.56"	650'	25'	STAGING & STORAGE & PARKING
8	N40° 55' 14.85"	W88° 37' 25.45"	650'	25'	STAGING & STORAGE & PARKING
9	N40° 55' 16.46"	W88° 37' 25.46"	652'	25'	STAGING & STORAGE & PARKING
10	N40° 55' 16.46"	W88° 37' 27.57"	652'	25'	STAGING & STORAGE & PARKING

PAVEMENT STATUS		
LOCATION	WORK AREAS	
	A	B
RUNWAY 6/24	OPEN	OPEN
TAXIWAY A	OPEN	OPEN
TAXIWAY B	OPEN	OPEN
T-HANG TAXIWAY B	CLOSED	OPEN
T-HANG TAXIWAY C	OPEN	CLOSED
T-HANG TAXIWAY D	OPEN	OPEN

LEGEND

- CONTRACTOR STAGING & STORAGE AREA
- WORK AREA A
- WORK AREA B
- BEAM BARRICADES / WORK AREA
- CONTRACTOR & TENANT ACCESS ROUTE

NOTES

- PRIOR TO STARTING WORK IN ALL WORK AREAS THE CONTRACTOR SHALL HAVE TRAFFIC CONTROL AND ACCESS ROUTES IN PLACE.
- AT NO TIME SHALL THE CONTRACTOR ENTER THE TAXIWAY OBJECT FREE AREA (TOFA) OF THE APRON TAXIWAY UNLESS AUTHORIZED BY THE AIRPORT.
- THE TIMELY PROSECUTION OF THE OVERALL PROJECT IS DEPENDANT UPON THE PROPER COORDINATION BETWEEN CONTRACTORS.
- THE AIRPORT WILL REQUIRE 7 DAYS NOTICE PRIOR TO INITIATING WORK IN ANY WORK AREAS TO COORDINATE WITH THE T-HANGAR TENANTS.
- WORK AREAS MAY BE ACTIVE CONCURRENTLY WITH THE APPROVAL OF THE AIRPORT.
- STAGING AND STORAGE AREA SHALL BE RESTORED TO ORIGINAL CONDITION. PRIOR TO PROJECT COMPLETION.



License No. 184-000613

CONSULTANTS

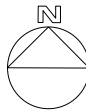

0 100' 200'
THIS BAR IS EQUAL TO 2" AT FULL SCALE (34X22).

100% SUBMITTAL
APRIL, 25 2025

RECONSTRUCT T-HANGAR
PAVEMENTS

OWNER



PONTIAC
ILLINOIS

CITY OF PONTIAC
PONTIAC MUNICIPAL AIRPORT
PONTIAC, ILLINOIS

MARK DATE DESCRIPTION

AIP PROJ. NO. 3-17-SBGP-XX

IL. PROJ. NO. PNT-5182

CMT PROJECT NO: 24007712

CAD DWG FILE: 24007712-GC100.DWG

DESIGNED BY: MRK

DRAWN BY: MRK

CHECKED BY: MJD

APPROVED BY: CBG

COPYRIGHT:

SHEET TITLE

CONSTRUCTION
ACTIVITY PLAN

GC101
SHEET 5 OF 10

THE LOCATION OF UNDERGROUND UTILITIES AS INDICATED ON THE PLANS HAS BEEN OBTAINED FROM EXISTING RECORDS. NEITHER THE OWNER, NOR THE PROJECT ENGINEER ASSUMES ANY RESPONSIBILITY WHATSOEVER IN RESPECT TO THE ACCURACY, COMPLETENESS, OR SUFFICIENCY OF THE INFORMATION. THERE IS NO GUARANTEE, EITHER EXPRESSED OR IMPLIED, THAT THE LOCATIONS, SIZE, AND TYPE OF MATERIAL OF EXISTING UNDERGROUND UTILITIES INDICATED ARE REPRESENTATIVE OF THOSE TO BE ENCOUNTERED IN THE CONSTRUCTION.

IT SHALL BE THE CONTRACTOR'S RESPONSIBILITY TO DETERMINE THE ACTUAL LOCATION OF ALL SUCH FACILITIES, INCLUDING SERVICE CONNECTIONS TO UNDERGROUND UTILITIES. PRIOR TO CONSTRUCTION, THE CONTRACTOR SHALL NOTIFY THE UTILITY COMPANY AND FAA OF HIS OPERATIONAL PLANS. THE CONTRACTOR SHALL MAKE ARRANGEMENTS FOR DETAILED INFORMATION AND ASSISTANCE IN LOCATING UTILITIES. IN THE EVENT AN UNEXPECTED UTILITY INTERFERENCE IS ENCOUNTERED DURING CONSTRUCTION, THE CONTRACTOR SHALL IMMEDIATELY NOTIFY THE UTILITY COMPANY, THE OWNER, AND THE RESIDENT ENGINEER. ANY SUCH MAINS AND/OR SERVICES DISTURBED BY THE CONTRACTOR'S OPERATIONS SHALL BE RESTORED IMMEDIATELY AT HIS EXPENSE TO THE SATISFACTION OF THE OWNER AND THE ENGINEER.

	PCC PAVEMENT REMOVAL
	UNCLASSIFIED EXCAVATION
	FULL DEPTH SAWCUT
	EXIST. DUCT BANK
	EXIST. STORM SEWER
	EXIST. OVERHEAD LIGHT
	EXIST. FIRE HYDRANT
	EXIST. STORM SEWER INLET
	EXIST. BORE / PVMT CORE LOCATION
	EXIST. TELEPHONE PEDESTAL
	EXIST. GATE POST
	EXIST. TRANSFORMER
	EXIST. IRON PIN
	EXIST. UTILITY POLE
	EXIST. FENCE
	EXIST. POWER METER

1. PROTECT ALL EXISTING INLETS, MANHOLES, & OTHER SURFACE OBJECTS DURING CONSTRUCTION OPERATIONS.
2. PROTECT ALL EDGES THAT ARE TO REMAIN IN PLACE DURING CONSTRUCTION OPERATIONS.
3. PCC PAVEMENT REMOVAL SHALL NOT DAMAGE THE EXISTING T-HANGAR BUILDING FOUNDATION. CONTRACTOR SHALL TAKE CARE WHEN EXCAVATING AROUND THE BUILDING FOUNDATION.
4. PCC PAVEMENT REMOVAL SHALL NOT DAMAGE THE EXISTING TAXILANE PAVEMENT. CONTRACTOR SHALL REPAIR ANY DAMAGE TO THE EXISTING PAVEMENT CAUSED BY THE REMOVAL PROCESS.
5. REFER TO SHEET CP301 FOR TYPICAL SECTIONS

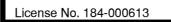

RECONSTRUCT T-HANGAR PAVEMENTS



OWNER

MARK	DATE	DESCRIPTION
AIP PROJ. NO. 3-17-SBGP-XX		P0021
IL. PROJ. NO. PNT-5182		
CMT PROJECT NO: 24007712		
CAD DWG FILE: 24007712-CD100.DWG		
DESIGNED BY:	MRK	
DRAWN BY:	MRK	
CHECKED BY:	MJD	
APPROVED BY:	CBG	
COPYRIGHT:		

SHEET TITLE
EXISTING CONDITIONS & REMOVALS

CD101
SHEET 6 OF 10

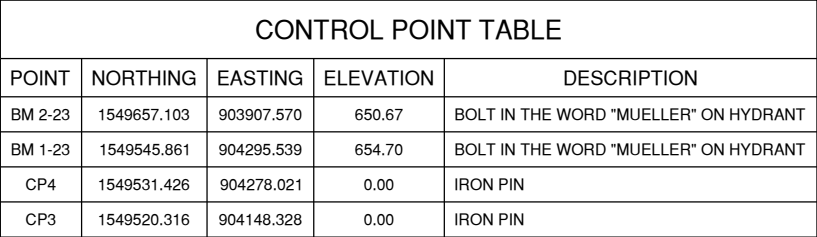

CONTROL POINT TABLE				
POINT	NORTHING	EASTING	ELEVATION	DESCRIPTION
BM 2-23	1549657.103	903907.570	650.67	BOLT IN THE WORD "MUELLER" ON HYDRANT
BM 1-23	1549545.861	904295.539	654.70	BOLT IN THE WORD "MUELLER" ON HYDRANT
CP4	1549531.426	904278.021	0.00	IRON PIN
CP3	1549520.316	904148.328	0.00	IRON PIN

SURVEY BENCHMARK

1. ALL PROJECT BENCHMARKS AND CONTROL POINTS SHOULD BE FIELD CHECKED BY THE CONTRACTOR FOR POSSIBLE DISTURBANCE PRIOR TO UTILIZING THEM FOR STAKING PURPOSES.
2. IT IS THE CONTRACTOR'S RESPONSIBILITY TO CONFIRM THE COORDINATES BASED ON THE DIMENSIONS SHOWN ON THE PLANS.
3. THE CONTRACTOR IS RESPONSIBLE FOR COORDINATING THIS DRAWING WITH THE OTHER DRAWINGS THAT CONTAIN DIMENSIONS TO ENSURE THAT THE PLAN DIMENSIONS ARE CONSISTENT WITH THE COORDINATES PRESENTED ON THE PLAN. FOLLOWING STAKEOUT OF ANY FACILITY BY COORDINATES, THE CONTRACTOR SHALL CONFIRM CONSISTENCY WITH THE PLAN DIMENSIONS PRIOR TO CONSTRUCTION.
4. COORDINATES PROVIDED BASED ON THE HORIZONTAL DATUM OF NAD83 STATE PLANE COORDINATES ILLINOIS EAST ZONE AT THE TIME OF SURVEY.
5. ELEVATIONS PROVIDED BASED ON THE VERTICAL DATUM OF NAVD88 AT THE TIME OF SURVEY.

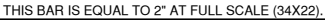

CITY OF PONTIAC
PONTIAC MUNICIPAL AIRPORT
PONTIAC, ILLINOIS

MARK	DATE	DESCRIPTION
------	------	-------------

AIP PROJ. NO. 3-17-SBG-P-XX	
IL PROJ. NO. PNT-5182	
CMT PROJECT NO: 24007712	
CAD DWG FILE:	24007712-CP100.DWG
DESIGNED BY:	MRK
DRAWN BY:	MRK
CHECKED BY:	MJD
APPROVED BY:	CBG
COPYRIGHT:	

SHEET TITLE

PROJECT CONTROL & ALIGNMENT DATA

SHEET 7 OF 10

LOCATION	LOADING	MIX	PG GRADE	MAX RAP	ACCEPTANCE	DENSITY
APRON	UNDER 60K LBS	AERO 401 N30 @ 3.0%	SBS76-28	0%	METHOD I	MAINLINE: NUCLEAR GAUGE JOINTS: CORES

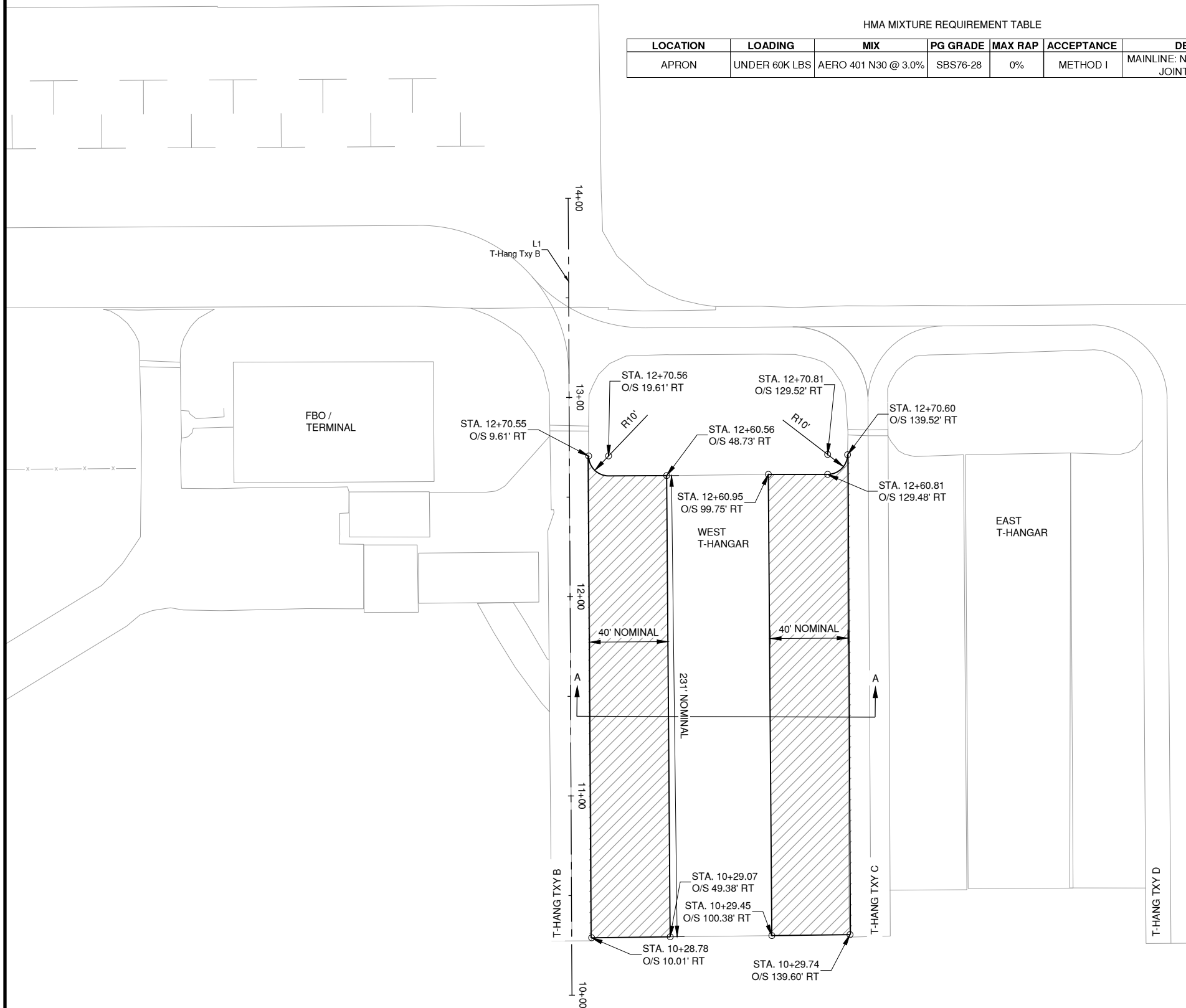

LEGEND



NEW HMA PAVEMENT

NOTES

1. REFER TO SHEET CP301 FOR TYPICAL SECTIONS

KEY MAP

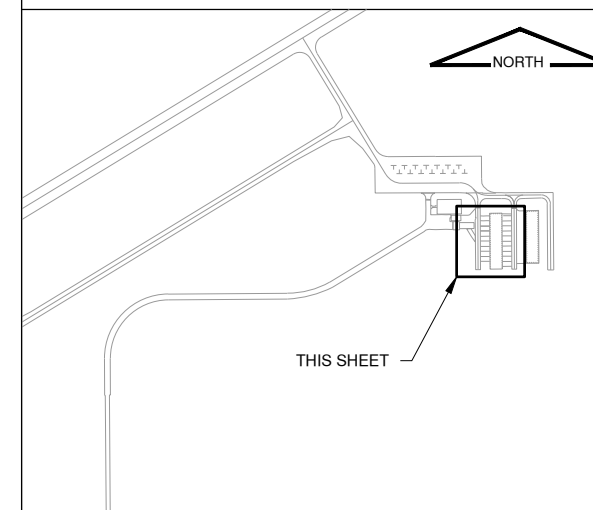

License No. 184-000613

CONSULTANTS

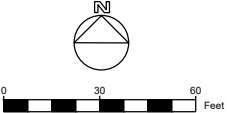

THIS BAR IS EQUAL TO 2" AT FULL SCALE (34X22).

100% SUBMITTAL
APRIL, 25 2025

RECONSTRUCT T-HANGAR PAVEMENTS



OWNER

CITY OF PONTIAC
PONTIAC MUNICIPAL AIRPORT
PONTIAC, ILLINOIS

[illegible]

SHEET TITLE	
<p>PROPOSED IMPROVEMENTS</p>	

CP101

SHEET 8 OF 10

Path: K:\Pontiac\AP\24007712-00_ReconstructTHgrPvt\Drawl\Shwets\24007712-CS100.dwg
Date: Thursday, March 6, 2025 1:49:46 PM

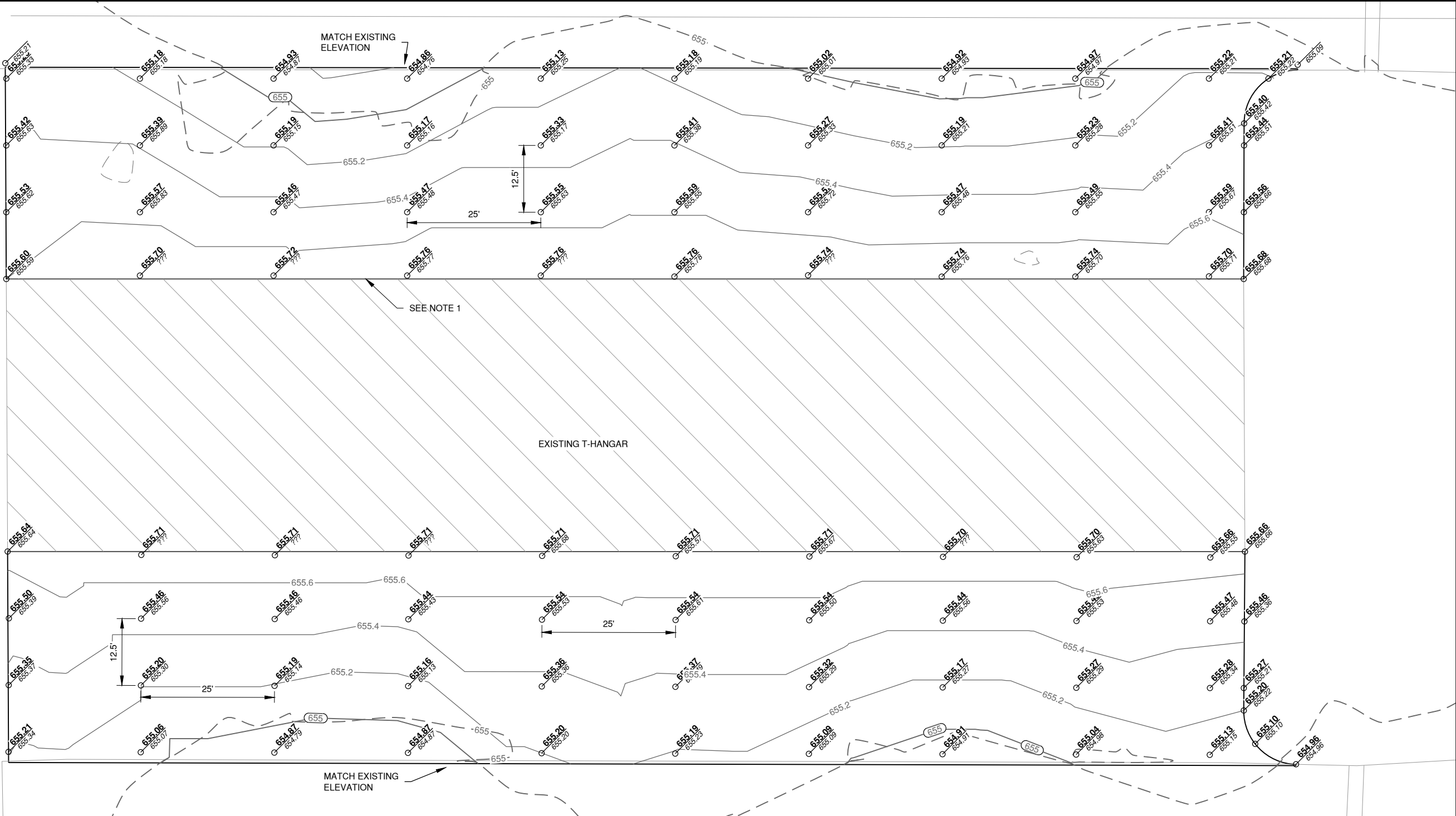

NOTES

1. MATCH EXISTING GRADE AT ALL BUILDINGS, PAVEMENTS, CATCH BASINS, AND OTHER SURFACE FEATURES (MANHOLES, TRANSFORMERS, ETC).

LEGEND

- NEW ELEVATION
 EXISTING ELEVATION
 PROPOSED CONTOUR 1' and 0.2'
 EXISTING CONTOUR 1'

KEY MAP

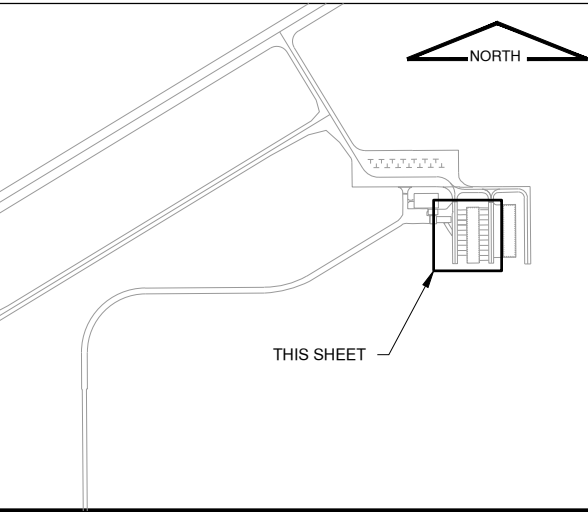

License No. 184-000613

CONSULTANTS

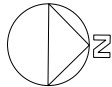

THIS BAR IS EQUAL TO 2" AT FULL SCALE (34X22).

100% SUBMITTAL
APRIL, 25 2025

RECONSTRUCT T-HANGAR
PAVEMENTS

OWNER



CITY OF PONTIAC
PONTIAC MUNICIPAL AIRPORT
PONTIAC, ILLINOIS

MARK DATE DESCRIPTION

AIP PROJ. NO. 3-17-SBGP-XX
IL PROJ. NO. PNT-5182
CMT PROJECT NO: 24007712
CAD DWG FILE: 24007712-CS100.DWG
DESIGNED BY: MRK
DRAWN BY: MRK
CHECKED BY: MJD
APPROVED BY: CBG
COPYRIGHT:

SHEET TITLE

STAKING PLAN 1

CS101
SHEET 10 OF 10