

CONSTRUCTION PLANS - 100% SUBMITTAL, ISSUED FEBRUARY 28, 2025

REHABILITATE AUTO PARKING LOT

CITY OF GALESBURG
GALESBURG MUNICIPAL AIRPORT (GBG)
GALESBURG, KNOX COUNTY, ILLINOIS

ILLINOIS PROJECT NO. GBG-4988
SBG PROJECT NO. N/A

NOTICE TO CONTRACTORS AND BIDDERS

THESE CONSTRUCTION PLANS RELY UPON THE SPECIAL PROVISIONS
AND THE SPECIFICATIONS TO PROVIDE FOR A COMPLETE DESCRIPTION
OF THE WORK AND CONSTRUCTION REQUIREMENTS. THE PLANS SHALL
ONLY BE USED IN COMBINATION WITH ALL CONTRACT DOCUMENTS.

GALESBURG MUNICIPAL AIRPORT

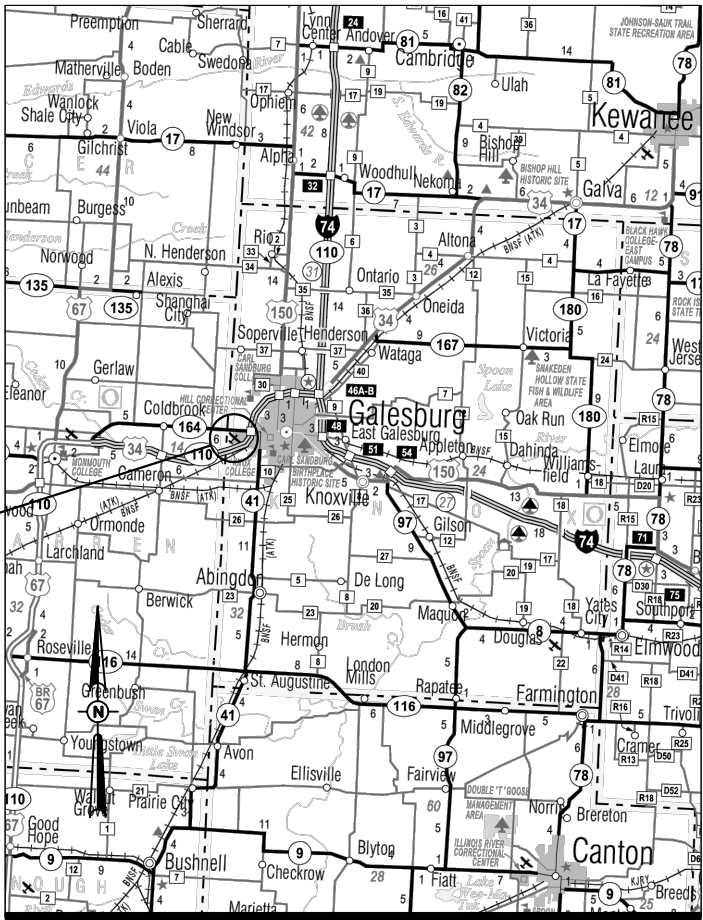

VICINITY MAP

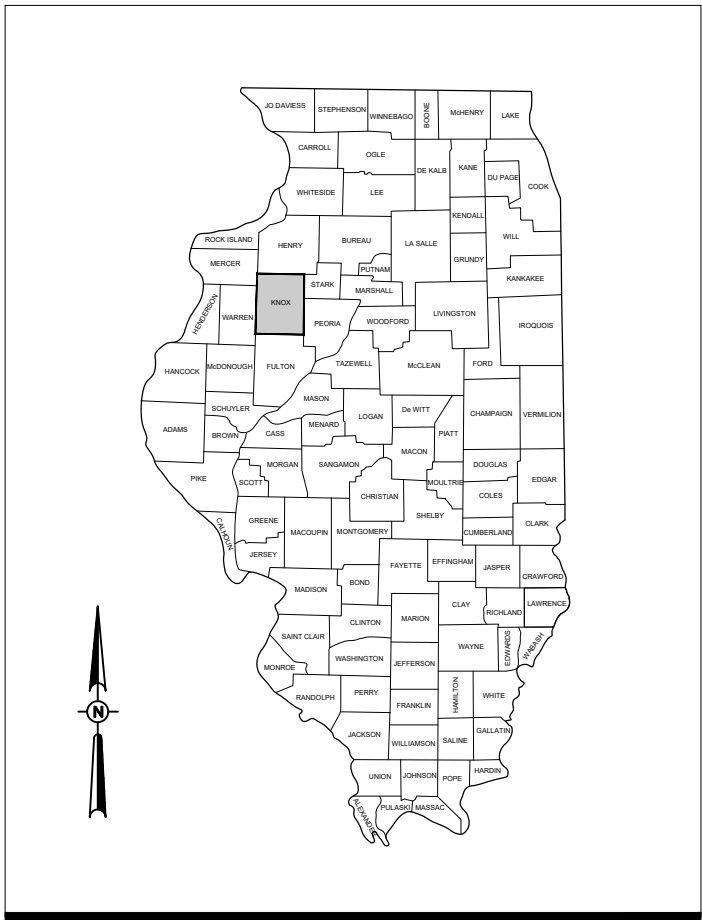

LOCATION MAP

No.	Issue/Description	Sheets Changed	Date	By



HANSON PROFESSIONAL SERVICES INC.
1525 S. Sixth St.
Springfield, Illinois 62703
Telephone: 217.788.2450
Fax: 217.788.2503



Jeffrey Olson
Jeffrey Olson, P.E.
Project Manager

Lic. Exp. 11/30/2025

02/28/2025
Date



Aaron Gavin
Aaron Gavin
City Engineer

GALESBURG MUNICIPAL AIRPORT

City of Galesburg
55 West Tompkins Street
Galesburg, Illinois 61401
Telephone: 309.342.3134

02/28/2025
Date

FEB 28, 2025 2:36 PM CRAFT02387
I:\24\05\24\A010_00\CAD\AIRPORT\SheetG-002-FLP

INDEX OF SHEETS	
SHEET NUMBER	SHEET TITLE
1	COVER SHEET
2	SHEET INDEX AND SUMMARY OF QUANTITIES
3	SCOPE OF WORK
4	CONSTRUCTION SAFETY AND PHASING PLAN
5	CONSTRUCTION SAFETY AND PHASING DETAILS AND NOTES
6	PROPOSED DEMOLITION & EROSION CONTROL PLAN
7	PROPOSED TYPICAL SECTIONS
8	PROPOSED CONSTRUCTION PLAN - BASE BID
9	PROPOSED CONSTRUCTION PLAN - ADD ALT 1
10	PROPOSED GRADING PLAN - BASE BID
11	PROPOSED GRADING PLAN - ADD ALT 1
12	PROPOSED MARKING PLAN - BASE BID
13	PROPOSED MARKING PLAN - ADD ALT 1
14	PROPOSED ADMIN PARKING LOT RESTRIPING PLAN AND MARKING DETAILS
15	HIGHWAY STANDARD 701901-08 (1)
16	HIGHWAY STANDARD 602301-04
17	HIGHWAY STANDARD 604036-03

SUMMARY OF QUANTITIES - BASE BID				
ITEM NO.	DESCRIPTION	UNIT	TOTAL QUANTITY	AS-BUILT QUANTITY
AR150520	MOBILIZATION	L SUM	1	
AR152410	UNCLASSIFIED EXCAVATION	CU YD	664	
AR152480	SHOULDER ADJUSTMENT	SQ YD	1,089	
AR209608	CRUSHED AGG. BASE COURSE - 8"	SQ YD	1,851	
AR401613	BIT. SURF. CSE.-METHOD I, SUPERPAVE	TON	446	
AR401900	REMOVE BITUMINOUS PAVEMENT	SQ YD	792	
AR403613	BIT. BASE CSE.-METHOD I, SUPERPAVE	TON	314	
AR602510	BITUMINOUS PRIME COAT	GALLON	463	
AR603510	BITUMINOUS TACK COAT	GALLON	235	
AR620520	PAVEMENT MARKING-WATERBORNE	SQ FT	1,004	
AR751411	INLET-TYPE A	EACH	1	
AR751927	REPLACE FRAME & GRATE	EACH	1	
AR901510	SEEDING	ACRE	0.23	
AR908510	MULCHING	ACRE	0.23	

SUMMARY OF QUANTITIES - ADD ALT 1				
ITEM NO.	DESCRIPTION	UNIT	TOTAL ADD ALT QUANTITY	AS-BUILT QUANTITY
AS152410	UNCLASSIFIED EXCAVATION	CU YD	239	
AS152480	SHOULDER ADJUSTMENT	SQ YD	65	
AS209606	CRUSHED AGG. BASE COURSE - 6"	SQ YD	668	
AS401613	BIT. SURF. CSE.-METHOD I, SUPERPAVE	TON	75	
AS403613	BIT. BASE CSE.-METHOD I, SUPERPAVE	TON	112	
AS602510	BITUMINOUS PRIME COAT	GALLON	167	
AS603510	BITUMINOUS TACK COAT	GALLON	33	
AS620520	PAVEMENT MARKING WATERBORNE	SQ FT	154	
AS901510	SEEDING	ACRE	0.02	
AS908510	MULCHING	ACRE	0.02	

UTILITY NOTE

THE LOCATION, SIZE, AND TYPE OF MATERIAL OF EXISTING UNDERGROUND AND/OR ABOVEGROUND UTILITIES INDICATED ON THE PLANS ARE NOT REPRESENTED AS BEING ACCURATE, SUFFICIENT, OR COMPLETE. NEITHER THE OWNER NOR THE ENGINEER ASSUMES ANY RESPONSIBILITY WHATSOEVER IN RESPECT TO THE ACCURACY, COMPLETENESS, OR SUFFICIENCY OF THE INFORMATION. THERE IS NO GUARANTEE, EITHER EXPRESSED OR IMPLIED, THAT THE LOCATIONS, SIZE, AND TYPE OF MATERIAL OF EXISTING UNDERGROUND UTILITIES INDICATED ARE REPRESENTATIVE OF THOSE TO BE ENCOUNTERED IN THE CONSTRUCTION. IT SHALL BE THE CONTRACTOR'S RESPONSIBILITY TO DETERMINE THE ACTUAL LOCATION OF ALL SUCH FACILITIES, INCLUDING SERVICE CONNECTIONS TO UNDERGROUND UTILITIES. PRIOR TO CONSTRUCTION, THE CONTRACTOR SHALL NOTIFY THE UTILITY COMPANIES OF THEIR OPERATIONAL PLANS AND SHALL OBTAIN FROM THE RESPECTIVE UTILITY COMPANIES DETAILED INFORMATION AND ASSISTANCE RELATIVE TO THE LOCATION OF THEIR FACILITIES AND THE WORKING SCHEDULE OF THE COMPANIES FOR REMOVAL OR ADJUSTMENT WHERE REQUIRED. IN THE EVENT AN UNEXPECTED UTILITY INTERFERENCE IS ENCOUNTERED DURING CONSTRUCTION, THE CONTRACTOR SHALL IMMEDIATELY NOTIFY THE UTILITY COMPANY OF JURISDICTION, THE OWNER'S REPRESENTATIVE, AND/OR THE RESIDENT ENGINEER SHALL ALSO BE IMMEDIATELY NOTIFIED. ANY DAMAGE TO SUCH MAINS AND SERVICES SHALL BE RESTORED TO SERVICE AT ONCE AND PAID FOR BY THE CONTRACTOR AT NO ADDITIONAL COST TO THE CONTRACT. ALL UTILITY CABLES AND LINES SHALL BE LOCATED WITH THE RESPECTIVE UTILITY. **CONTACT JULIE (JOINT UTILITY LOCATION INFORMATION FOR EXCAVATORS) FOR UTILITY INFORMATION, PHONE: 1-800-892-0123.** CONTACT THE FAA (FEDERAL AVIATION ADMINISTRATION) FOR ASSISTANCE IN LOCATING FAA CABLES AND UTILITIES. LOCATION OF FAA POWER, CONTROL, AND COMMUNICATION CABLES SHALL BE COORDINATED WITH AND/OR LOCATED BY THE FAA. ALSO CONTACT THE AIRPORT DIRECTOR/MANAGER AND AIRPORT PERSONNEL FOR ASSISTANCE IN LOCATING UNDERGROUND AIRPORT CABLES AND/OR UTILITIES. ALSO COORDINATE WORK WILL ALL ABOVEGROUND UTILITIES.

J.U.L.I.E. INFORMATION

COUNTY	_____	KNOX
CITY	_____	GALESBURG
TOWNSHIP	_____	T-11-N
RANGE	_____	R-1-E
SECTION NO.	_____	18
ADDRESS	_____	GALESBURG MUNICIPAL AIRPORT 275 LLOYD STEARMAN DR, GALESBURG, IL 61401

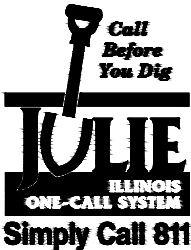

GENERAL NOTES

NDPES PERMIT

THIS PROJECT WILL NOT DISTURB MORE THAN 1 ACRE. THEREFORE A NPDES PERMIT IS NOT REQUIRED.

QUANTITIES

PAYMENT WILL BE MADE UNDER THE ITEM NUMBERS, DESCRIPTIONS, AND UNITS NOTED IN THE ABOVE TABLE IN ACCORDANCE WITH THE BASIS OF PAYMENT FOR EACH RESPECTIVE WORK ITEM COMPLETED AND ACCEPTED BY THE ENGINEER.

MATERIAL CERTIFICATIONS

MATERIALS CANNOT BE INSTALLED UNTIL ALL THE MATERIAL CERTIFICATIONS FOR THAT ITEM HAVE BEEN RECEIVED, REVIEWED AND ACCEPTED BY THE RESIDENT ENGINEER. MATERIALS INSTALLED WITHOUT APPROVAL ARE SUBJECT TO REMOVAL AND REPLACEMENT AT THE CONTRACTOR'S EXPENSE.

CERTIFIED PAYROLLS

THE RESIDENT ENGINEER/TECHNICIAN CANNOT FORWARD CONSTRUCTION REPORTS TO THE ILLINOIS DIVISION OF AERONAUTICS FOR PROCESSING UNTIL ALL CERTIFIED PAYROLLS FOR THE PERIOD HAVE BEEN RECEIVED.



Hanson Professional Services Inc.
1525 S. 6th Street
Springfield, IL 62703
phone: 217-788-2450
fax: 217-788-2503

Offices Nationwide
www.hanson-inc.com

Illinois Licensed
Professional Service Corporation
#184-001084



Galesburg Municipal Airport (GBG)
City of Galesburg
55 West Tompkins Street
Galesburg, Illinois 61401

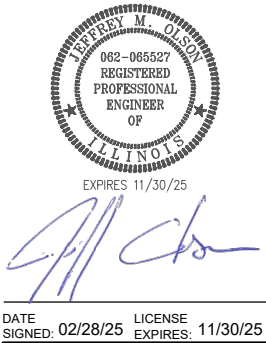

REHABILITATE AUTO-PARKING LOT

IDA No: GBG-4988

SBG No: N/A

CONTRACT No: GA012

NO.	DATE	DESCRIPTION			
		DES	DWN	REV	

ISSUE: FEBRUARY 28, 2025

PROJECT NO: 24A0010.00

CAD FILE: G-002-FLP.DWG

DESIGN BY: JAP 01/17/2025

DRAWN BY: KCB 01/17/2025

REVIEWED BY: JMO 01/29/2025









SHEET TITLE

SHEET INDEX AND
SUMMARY OF
QUANTITIES

100% SUBMITTAL

1. PROJECT DESCRIPTION: THIS PROJECT SHALL CONSIST OF RESURFACING THE ASPHALT PAVEMENT ON THE NORTH AUTOMOBILE PARKING LOT. NEW BITUMINOUS PAVEMENT WILL BE PLACED AS SHOWN. AMONG OTHER INCIDENTAL WORK ARE INLET ADJUSTMENT, MARKING, SEEDING, AND MULCHING.
2. THE RULES, REGULATIONS, AND SPECIFICATIONS HEREIN SHALL BE CONSIDERED AS MINIMUM REQUIREMENTS. THEY SHALL NOT PROHIBIT THE CONTRACTOR FROM FURNISHING AND INSTALLING HIGHER GRADES OF MATERIAL THAN ARE SPECIFIED HEREIN, IF APPROVED BY THE ENGINEER.
3. ACCESS TO THE SITE SHALL BE RESTRICTED EXCLUSIVELY TO THE DESIGNATED CONSTRUCTION ENTRANCE, STAGING AREA, AND HAUL ROUTE. NO EQUIPMENT OR PERSONNEL SHALL BE PERMITTED OUTSIDE THE GENERAL PROJECT AREA.
4. IT SHALL BE THE RESPONSIBILITY OF THE CONTRACTOR TO PROTECT AND KEEP CLEAN OF DEBRIS ALL EXISTING AIRFIELD AND ROADWAY PAVEMENTS AT ALL TIMES. ANY DAMAGE TO EXISTING ELECTRICAL, DRAINAGE, AND PAVEMENT STRUCTURES SHALL BE IMMEDIATELY REPAIRED AT NO ADDITIONAL COST TO THE CONTRACT.
5. CONTRACTOR IS REQUIRED TO PROVIDE THEIR OWN RESTROOM FACILITIES.
6. THE OWNER SHALL HAVE THE RIGHT OF FIRST REFUSAL FOR ALL SALVAGEABLE MATERIAL REMOVED ON THE PROJECT.
7. EXCESS EXCAVATION MATERIAL SHALL BE PLACED AT A LOCATION ON AIRPORT PROPERTY TO BE DETERMINED BY THE AIRPORT MANAGER. ALL OTHER WASTE MATERIALS SHALL BE HAULED FROM THE AIRPORT AND PROPERLY DISPOSED OF UNLESS OTHERWISE SPECIFIED HEREIN.
8. THE CONTRACTOR SHALL BE RESPONSIBLE FOR OBTAINING PERMITS FOR HAULING ON PUBLIC ROADS, AS APPLICABLE. THE CONTRACTOR SHALL BE RESPONSIBLE FOR CORRECTING ANY DAMAGES TO ANY PAVEMENTS (PUBLIC OR PRIVATE) CAUSED BY THEIR CONSTRUCTION EQUIPMENT OR PERSONNEL.
9. THE CONTRACTOR SHALL PROVIDE ONE SET OF PRELIMINARY REDLINED RECORD DRAWINGS TO THE RESIDENT ENGINEER AT THE COMPLETION OF THE PROJECT FOR INCORPORATION INTO THE OFFICIAL RECORD DRAWINGS TO BE PREPARED.
10. APPROXIMATE LOCATIONS OF UNDERGROUND UTILITIES ARE SHOWN THROUGHOUT THESE PLANS. THE CONTRACTOR SHALL DETERMINE EXACT LOCATIONS AND PROTECT THESE UTILITIES DURING CONSTRUCTION. ANY UTILITIES DAMAGED DURING CONSTRUCTION SHALL BE REPAIRED AT THE CONTRACTOR'S EXPENSE. CONTRACTOR SHALL COORDINATE WITH THE PROPER AUTHORITIES FOR THE PURPOSE OF LOCATING AND PROTECTING EXISTING UNDERGROUND UTILITIES.
11. THE CONTRACTOR SHALL PROVIDE CONSTRUCTION STAKING AND LAYOUT, BOTH VERTICALLY AND HORIZONTALLY.
12. ALL REQUESTS FOR INFORMATION SHALL BE PROVIDED IN WRITING AND ALL DIRECTIVES SHALL BE RECEIVED IN WRITING.
13. CHANGES TO THE PROJECT SHALL NOT BE INCORPORATED INTO THE PROJECT UNTIL EXPRESSLY APPROVED BY THE ENGINEER.
14. THE BUY AMERICAN WAIVER, IF REQUIRED FOR THIS PROJECT, SHALL BE APPLIED FOR BY THE OWNER USING DATA COMPILED AND PROVIDED BY THE CONTRACTOR SHOWING DOMESTIC VERSUS NON-DOMESTIC CONTENT. THE WAIVER SHALL BE APPROVED PRIOR TO NOTICE TO PROCEED BEING ISSUED. NO DELAY MAY BE CLAIMED BY THE CONTRACTOR RELATED TO DURATION TO OBTAIN APPROVAL OF THE WAIVER.

SURVEY CONTROL POINTS				
NO.	DESCRIPTION	NORTHING	EASTING	ELEVATION
①	HPS1	1557770.10	2223535.48	760.63
②	HPS2	1558345.91	2223652.376	758.53
③	BENCHMARK	1558014.14	2223539.315	758.75

EXISTING	PROPOSED	LEGEND
		AIRPORT PROPERTY LINE
		FENCE
		BUILDINGS
		BITUMINOUS OVERLAY
		BITUMINOUS PAVEMENT
		BITUMINOUS PAVEMENT REMOVAL
		STAGING AREA

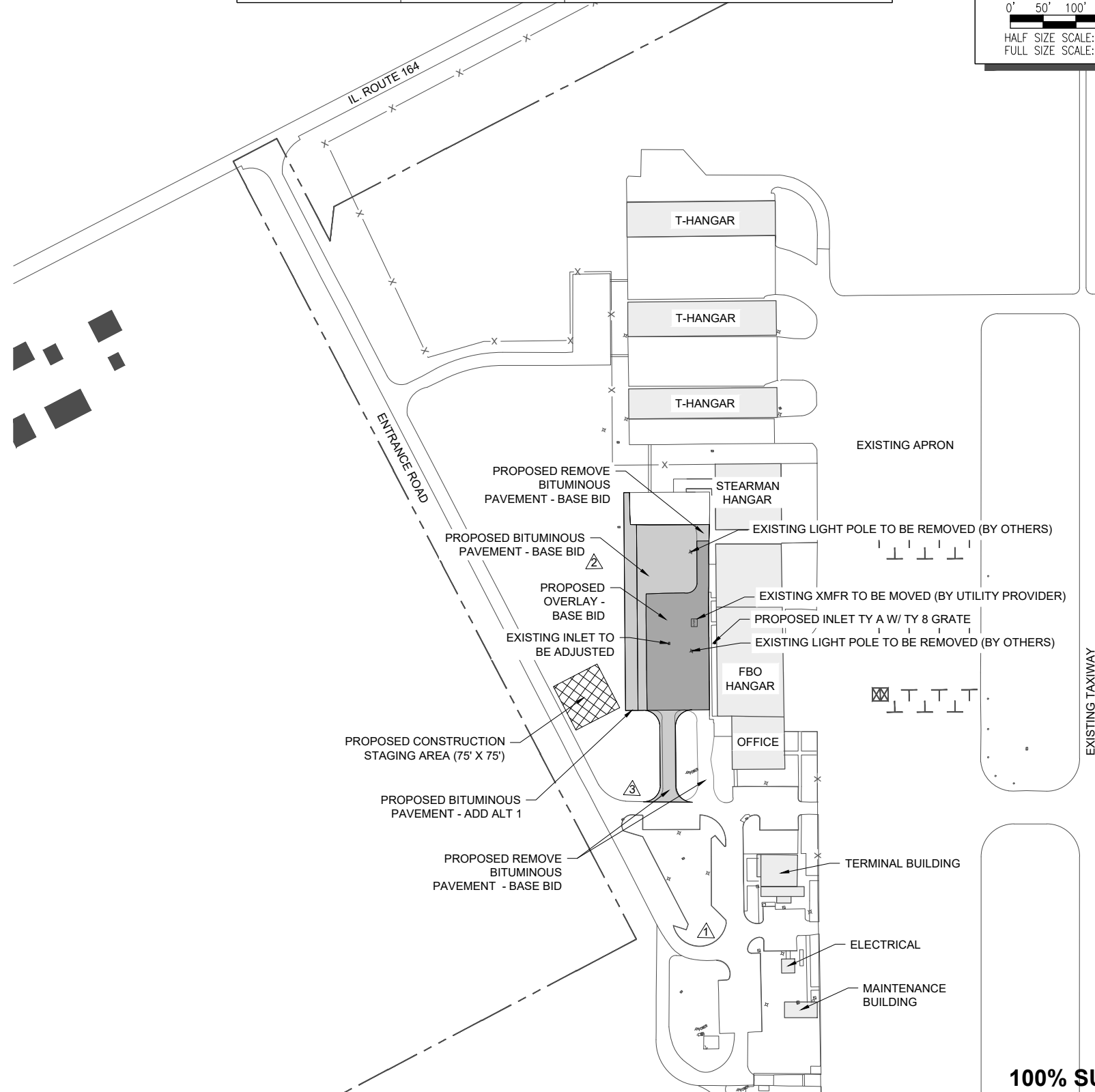
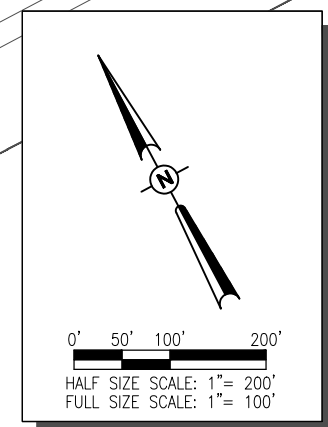

100% SUBMITTAL



Galesburg Municipal Airport (GBG)
City of Galesburg
55 West Tompkins Street
Galesburg, Illinois 61401

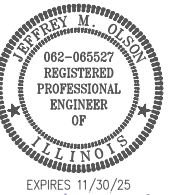

DATE SIGNED: 02/28/25 LICENSE EXPIRES: 11/30/25

REHABILITATE
AUTO-PARKING LOT

DA No: GBG-4988
SBG No: N/A
CONTRACT No: GA012

NO.	DATE	DESCRIPTION		
		DES	DWN	REV

ISSUE: FEBRUARY 28, 2025
PROJECT NO: 24A0010.00
CAD FILE: C-101-SOW.DWG
DESIGN BY: JAP 01/17/2025
DRAWN BY: KCB 01/17/2025
REVIEWED BY: JMO 01/29/2025

SHEET TITLE

SCOPE OF WORK

CRITICAL POINTS						
POINT NO.	LAT.	LONG.	DESCRIPTION	EXIST. GROUND ELEV. (MSL)	OBJECT HEIGHT (FT)	OBJECT ELEV. (MSL)
1	N040° 56' 43.77"	W090° 25' 49.14"	CONSTRUCTION EQUIPMENT	759	25	784
2	N040° 56' 43.21"	W090° 25' 47.73"	CONSTRUCTION EQUIPMENT	760	25	785
3	N040° 56' 40.32"	W090° 25' 49.78"	CONSTRUCTION EQUIPMENT	761	25	786
4	N040° 56' 38.98"	W090° 25' 50.39"	CONSTRUCTION EQUIPMENT	761	25	786
5	N040° 56' 39.21"	W090° 25' 50.95"	CONSTRUCTION EQUIPMENT	760	25	785
6	N040° 56' 38.95"	W090° 25' 50.52"	TRAFFIC DRUM	761	4	764
7	N040° 56' 39.56"	W090° 25' 51.80"	CONSTRUCTION EQUIPMENT	759	25	784
8	N040° 56' 40.82"	W090° 25' 51.04"	CONSTRUCTION EQUIPMENT	759	25	784
9	N040° 56' 41.37"	W090° 25' 51.32"	STAGING AREA	758	25	783
NOTE: OBJECT HEIGHT TO BE VERIFIED IN THE FIELD						

CONSTRUCTION SAFETY PLAN

1.

SCOPE OF WORK - THIS PROJECT CONSISTS OF REHABILITATING THE NORTH PARKING LOT. OVERLAY OF THE EXISTING BITUMINOUS PAVEMENTS, NEW BITUMINOUS PAVEMENT, BITUMINOUS PAVEMENT REMOVAL, INLET ADJUSTMENT, SEEDING, MULCHING, MARKING AND OTHER ASSOCIATED ITEMS WILL BE COMPLETED.
2.

GENERAL - GALESBURG MUNICIPAL AIRPORT IS NON-TOWER CONTROLLED, GENERAL AVIATION AIRPORT COMPRISED OF TWO PAVED RUNWAYS. BOTH RUNWAYS WILL REMAIN OPEN THROUGHOUT THE PROJECT DURATION.
3.

AIRFIELD SAFETY ASSURANCE - NO AIRSIDE ACCESS PERMITTED.

EXISTING	PROPOSED	LEGEND
---		PROPERTY LINE
— X —		FENCE
— T —		TELEPHONE SERVICE LINE
— W —		UNDERGROUND WATER SERVICE
— G —		UNDERGROUND GAS SERVICE
— E —		UNDERGROUND ELECTRIC
— — > —		STORM SEWER
— — SAN —		SANITARY SEWER
	●	INLET
		BUILDING
		BITUMINOUS OVERLAY
		BITUMINOUS PAVEMENT
		HAUL ROUTE
		CONSTRUCTION SIGN
		TRAFFIC DRUM
		CONTRACTOR STAGING AREA

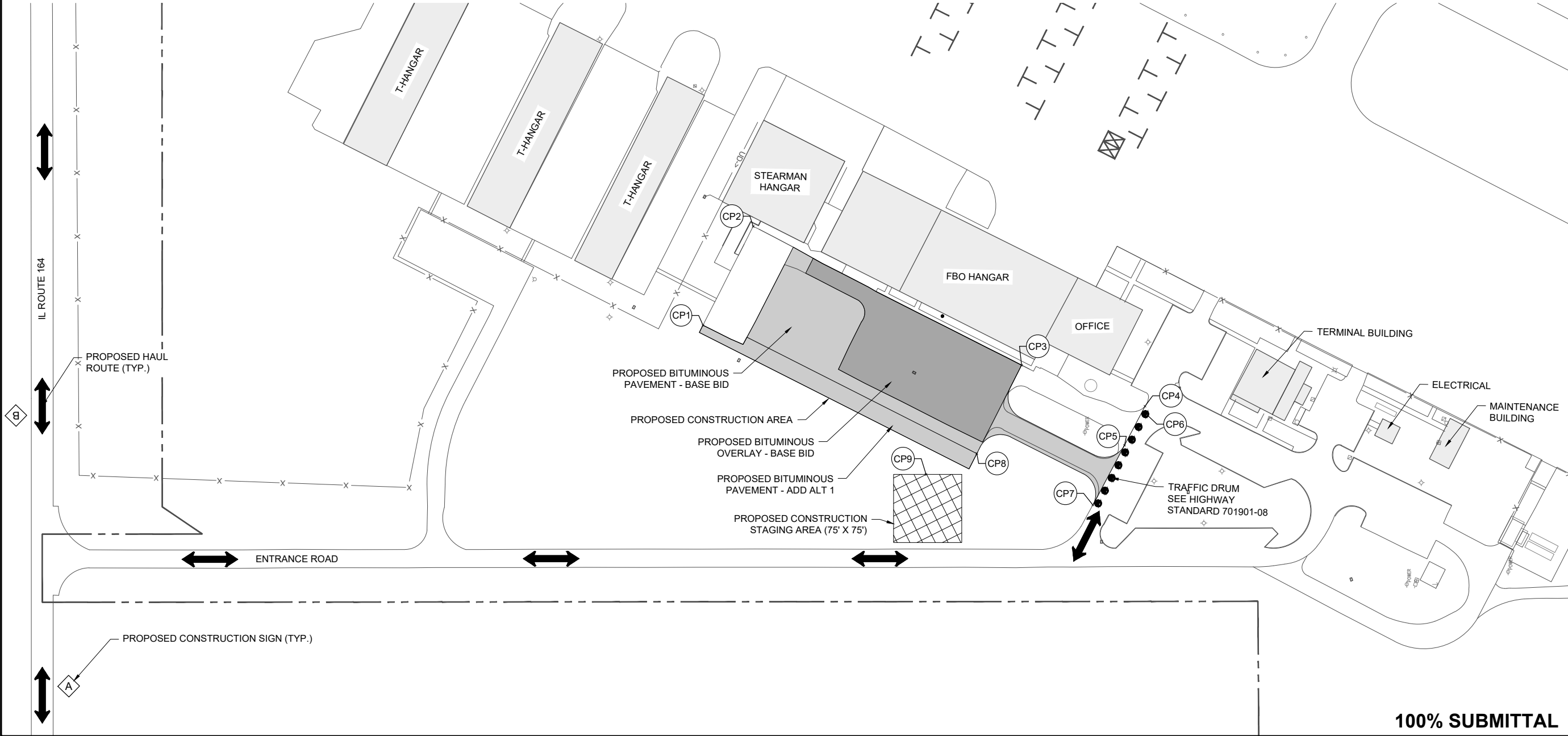
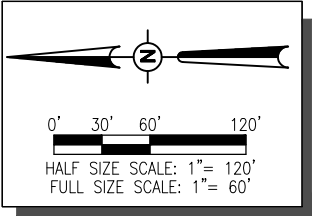



Engineering | Planning | Allied Services

Hanson Professional Services Inc.
1525 S. 6th Street
Springfield, IL 62703
phone: 217-788-2450
fax: 217-788-2503

Offices Nationwide
www.hanson-inc.com

Illinois Licensed
Professional Service Corporation
#184-001084



Galesburg Municipal Airport (GBG)
City of Galesburg
55 West Tompkins Street
Galesburg, Illinois 61401



JEFFREY M. OLSON
082-065527
REGISTERED
PROFESSIONAL
ENGINEER
OF
ILLINOIS
EXPIRES 11/30/25



DATE SIGNED: 02/28/25 LICENSE EXPIRES: 11/30/25

REHABILITATE
AUTO-PARKING LOT

IDA No: GBG-4988
SBG No: N/A
CONTRACT No: GA012

NO.		DATE			DESCRIPTION		
		DES	DWN	REV	DES	DWN	REV
ISSUE: FEBRUARY 28, 2025							
PROJECT NO: 24A0010.00							
CAD FILE: C-102-CSPP.DWG							
DESIGN BY: JAP 01/17/2025							
DRAWN BY: KCB 01/17/2025							
REVIEWED BY: JMO 01/29/2025							
SHEET TITLE							

CONSTRUCTION
SAFETY AND
PHASING PLAN

100% SUBMITTAL

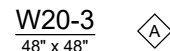

NOT TO SCALE

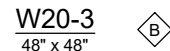

NOT TO SCALE

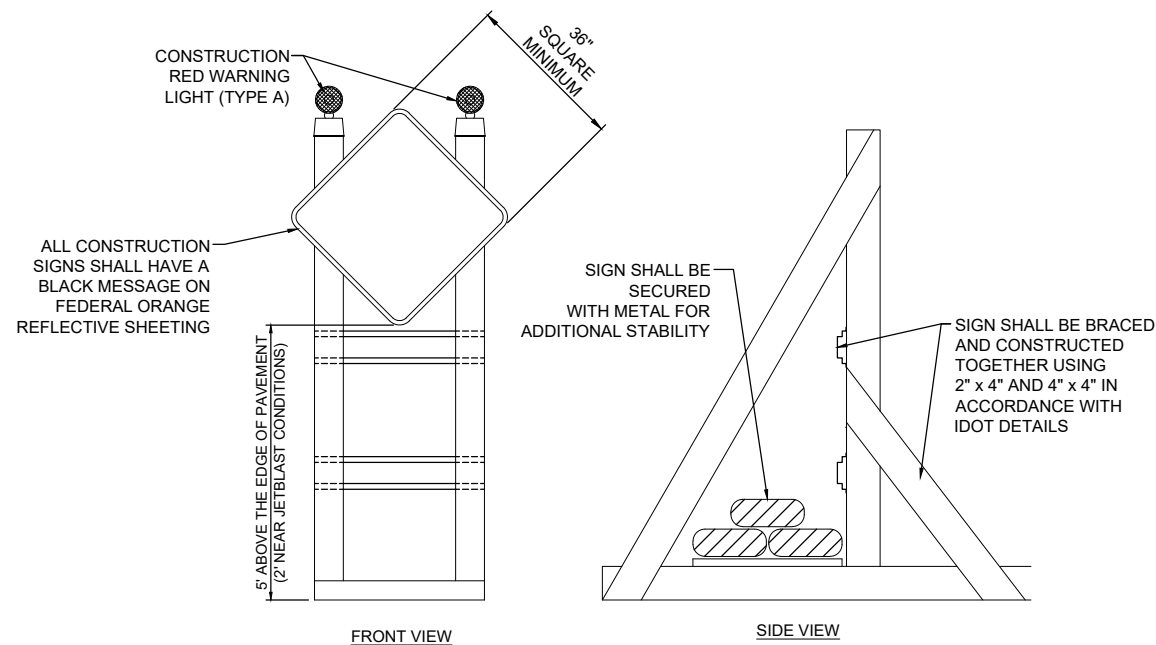

1. ALL CONSTRUCTION SIGNS AND TRAFFIC CONTROL DEVICES SHALL CONFORM TO THE MANUAL ON UNIFORM TRAFFIC CONTROL DEVICES INCLUDING THE ILLINOIS SUPPLEMENT (LATEST EDITION) AND THE FAA ADVISORY CIRCULARS (LATEST EDITION) UNLESS NOTED OTHERWISE. THE FAA OR MORE STRINGENT SPECIFICATIONS SHALL GOVERN.
2. UNLESS OTHERWISE SPECIFIED, CONSTRUCTION SIGNS SHALL BE MOUNTED ON PORTABLE OR NON-PORTABLE SUPPORTS. A PORTABLE SUPPORT IS DEFINED AS A TYPICAL SIGN STANDARD AS SHOWN ON THIS SHEET, OR A SMALL LIGHT WEIGHT TRAILER. A NON-PORTABLE SUPPORT IS DEFINED AS DRIVEN METAL OR WOOD POST. ALL SIGNS, REGARDLESS OF THE TYPE OF SUPPORTS USED, SHALL BE MOUNTED SUCH THAT THE MESSAGE ON THE SIGN IS LEVEL IN THE HORIZONTAL PLANE AFTER PLACEMENT. THE COST OF CONSTRUCTION WARNING LIGHTS SHALL BE INCLUDED IN THE COST OF THE CONSTRUCTION SIGNS.
3. CONSTRUCTION RED WARNING LIGHT: THESE ARE PORTABLE, LENS DIRECTED, ENCLOSED LIGHTS. THE COLOR OF THE LIGHT EMITTED SHALL BE RED. THEY ARE TO BE USED IN A LOW INTENSITY FLASHING MODE (TYPE A).
4. THE LIGHTING SHALL BE MAINTAINED IN OPERATION DURING THE HOURS OF DARKNESS BETWEEN 1/2 HOUR AFTER SUNSET AND 1/2 HOUR BEFORE SUNRISE AND WHEN CONDITIONS EXIST WHICH TEND TO OBSCURE VISION.
5. COST FOR PROVIDING, PLACING, MAINTAINING, AND REMOVING SIGNS SHALL BE INCIDENTAL TO THE PROJECT.

1. ALL CONSTRUCTION SIGNS AND TRAFFIC CONTROL DEVICES SHALL CONFORM TO THE MANUAL ON UNIFORM TRAFFIC CONTROL DEVICES INCLUDING THE ILLINOIS SUPPLEMENT (LATEST EDITION) AND THE FAA ADVISORY CIRCULARS (LATEST EDITION) UNLESS NOTED OTHERWISE. THE FAA OR MORE STRINGENT SPECIFICATIONS SHALL GOVERN.
2. BARRICADES/ TRAFFIC DRUMS SHALL BE LIGHTED AND CONFORM TO HIGHWAY STANDARD 701901-08.
3. THE LIGHTING SHALL BE MAINTAINED IN OPERATION DURING THE HOURS OF DARKNESS BETWEEN 1/2 HOUR BEFORE SUNSET AND 1/2 HOUR AFTER SUNRISE AND WHEN CONDITIONS EXIST WHICH TEND TO OBSCURE VISION.
4. COST FOR PROVIDING, PLACING, MAINTAINING, AND REMOVING BARRICADES SHALL BE PAID FOR UNDER ITEM AR150520 - MOBILIZATION.

1. THE FOLLOWING NOTES ARE THE CONSTRUCTION SAFETY PROCEDURES THAT THE CONTRACTOR SHALL FOLLOW THROUGHOUT THIS PROJECT. ADDITIONAL REQUIREMENTS ARE SHOWN ON THE CONSTRUCTION SAFETY AND PHASING PLAN SHEET AND THIS SHEET.
2. ALL PROVISIONS OF THE LATEST EDITION OF FAA ADVISORY CIRCULAR AC 150/5370-2G (CURRENT EDITION), "OPERATIONAL SAFETY ON AIRPORTS DURING CONSTRUCTION", APPLY TO THIS CONTRACT, EXCEPT AS MODIFIED BY THIS SAFETY PLAN, OR AS MODIFIED BY THE OWNER THROUGH THE RESIDENT ENGINEER/TECHNICIAN AT THE PRECONSTRUCTION CONFERENCE, OR DURING THE COURSE OF THE CONTRACT.
3. THE CONTRACTORS SHALL MINIMIZE DISRUPTION OF STANDARD OPERATING PROCEDURES FOR AERONAUTICAL ACTIVITY BY REMAINING WITHIN THE PRESCRIBED STAGING, CONSTRUCTION, AND PHASING AREAS PRESENTED ON THE CONSTRUCTION SAFETY AND PHASING PLAN SHEETS.
4. NO UNAUTHORIZED PERSONNEL SHALL ENTER ANY AREA OF THE AIRPORT THAT COULD POTENTIALLY BE HAZARDOUS. THE AIRPORT MANAGER RESERVES THE RIGHT TO SUSPEND OPERATIONS IN ORDER TO MAINTAIN SAFETY AT THE AIRPORT.
5. CONTRACTOR EQUIPMENT, VEHICLES, AND PROJECT MATERIALS SHALL BE STORED AT THE STAGING AREA SHOWN ON THE PLAN VIEW, EXCEPT AS OTHERWISE PROVIDED FOR AT THE PRE-CONSTRUCTION CONFERENCE.
6. NO CONSTRUCTION EQUIPMENT GREATER THAN 25' TALL WILL BE PERMITTED ON THE AIRPORT UNLESS PERMITTED WITH THE APPROVAL OF THE AIRPORT MANAGER AND AIRSPACE APPROVAL BY THE FAA.
7. NO OPEN FLAME WELDING OR TORCH CUTTING OPERATION IS PERMITTED UNLESS ADEQUATE FIRE AND SAFETY PRECAUTIONS ARE PROVIDED AND HAVE BEEN APPROVED BY THE AIRPORT MANAGER NO FLARE POTS ARE ALLOWED ON THE PROJECT.
8. SOIL, DEBRIS, AND LOOSE MATERIAL DROPPED OR TRACKED ONTO AIRPORT ROADS, TAXIWAYS, AND SOD SURFACES, OR WHICH CAN BE BLOWN ONTO SUCH SURFACES, SHALL BE IMMEDIATELY SWEEPED, PICKED UP AND REMOVED, OR PLACED INTO CLOSED CONTAINERS. ANY DAMAGE TO AIRPORT PROPERTY SHALL BE REPAIRED IMMEDIATELY AT NO COST TO THE OWNER.
9. THE CONTRACTOR SHALL PERIODICALLY PERFORM ONSITE INSPECTIONS THROUGHOUT THE DURATION OF THE PROJECT WITH THE IMMEDIATE REMEDY OF ANY DIFFERENCES, WHETHER CAUSED BY NEGLIGENCE, OVERSIGHT, OR PROJECT SCOPE CHANGE.
10. CONTRACTOR SHALL MOVE MAINTENANCE OF TRAFFIC COMPONENTS AT THE WRITTEN DIRECTION OF THE RESIDENT ENGINEER/TECHNICIAN AT NO ADDITIONAL COST.
11. CONTRACTOR SHALL NOT REMOVE THE BARRICADES WITHOUT THE APPROVAL BY THE RESIDENT ENGINEER/TECHNICIAN.
12. CONTRACTOR SHALL MAINTAIN FLASHERS, SIGNS AND/OR BARRICADES AS REQUIRED BY THE PLANS, CITY OR COUNTY REGULATIONS OR CONTRACTOR ACTIVITIES. CONTRACTOR SHALL OBTAIN ANY AND ALL REQUIRED LOCAL PERMITS UNLESS SPECIFIED OTHERWISE.
13. UNLESS SPECIFIED OTHERWISE, COST FOR THE ABOVE IS TO BE CONSIDERED INCIDENTAL TO THE PROJECT. SEPARATE PAYMENT SHALL NOT BE MADE.



Hanson Professional Services Inc
1525 S. 6th Street
Springfield, IL 62703
phone: 217-788-2450
fax: 217-788-2503

Offices Nationwide
www.hanson-inc.com

Illinois Licensed
Professional Service Corporation
#184-001084



Galesburg Municipal Airport (GBG)
City of Galesburg
55 West Tompkins Street
Galesburg, Illinois 61401

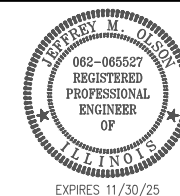

EXPIRES 11/30/

DATE SIGNED: 02/28/25 LICENSE EXPIRES: 11/30/25

REHABILITATE
AUTO-PARKING LOT

IDA No: GBG-4988

SBG No: N/A

CONTRACT No: GA012

NO.	DATE	DESCRIPTION		
		DES	DWN	RE

ISSUE: FEBRUARY 28, 2025

PROJECT NO: 24A0010.00

CAD FILE: C-102-CSPP.DWG

DESIGN BY: JAP 01/17/20

DRAWN BY: KCB 01/17/20

REVIEWED BY: JMO 01/29/20

SHEET TITLE

CONSTRUCTION SAFETY AND PHASING DETAILS AND NOTES

100% SUBMITTAL



Offices Nationwide
www.hanson-inc.com



JEFFREY M. OLSON
062-065527
REGISTERED
PROFESSIONAL
ENGINEER
OF
ILLINOIS

EXPIRES 11/30/25

DATE SIGNED: 02/28/25 LICENSE EXPIRES: 11/30/25

CONTRACT No: GA012

NO.	DATE	DESCRIPTION		
		DES	DWN	REV

ISSUE: FEBRUARY 28, 2025

PROJECT NO: 24A0010.00

CAD FILE: C-122-DEM.DWG

DESIGN BY: JAP 01/17/2025

DRAWN BY: KCB 01/17/2025

REVIEWED BY: JMO 01/29/2025

SHEET TITLE

100% SUBMITTAL

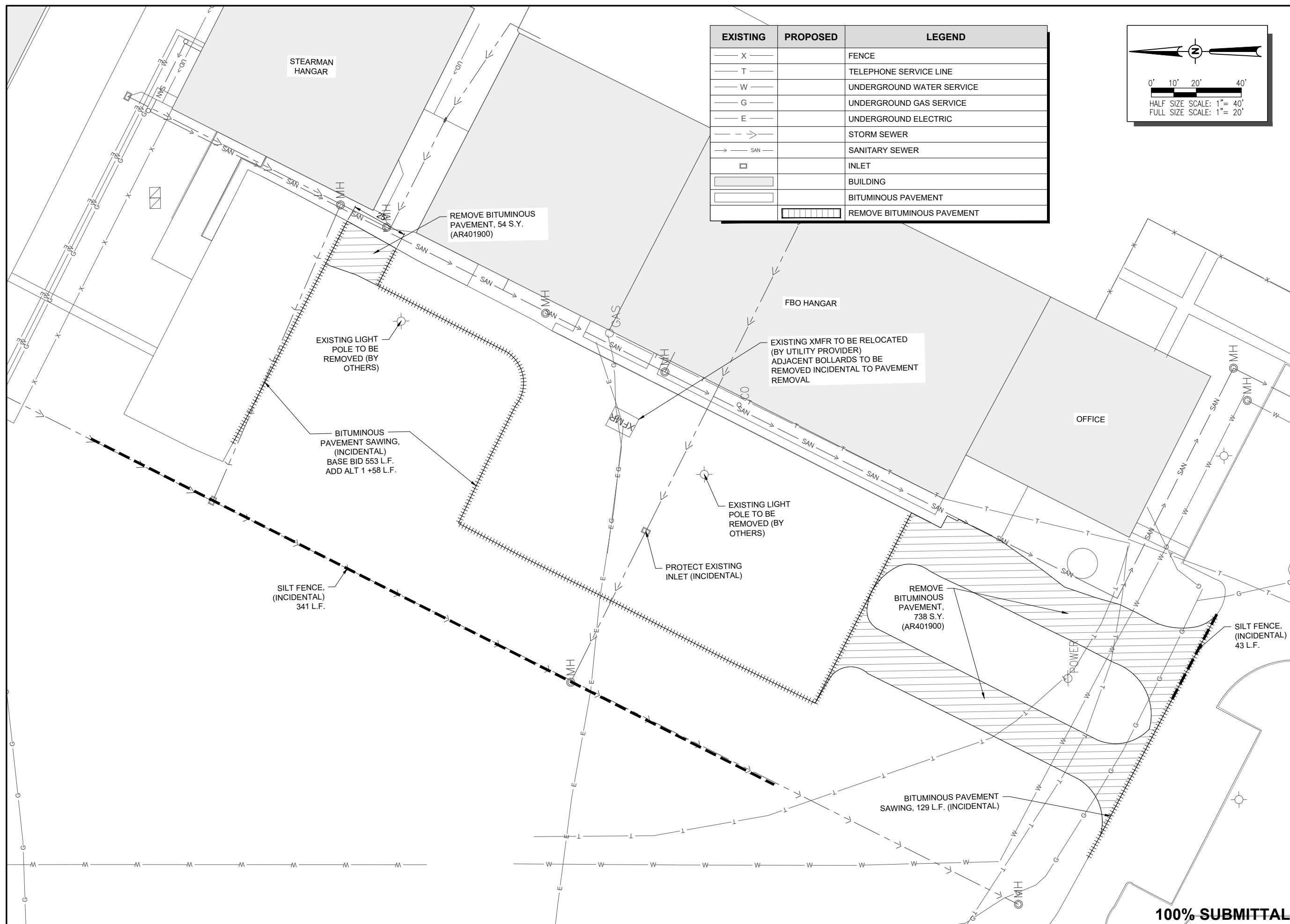

FEB 28, 2025 2:06 PM CRAFT02387
\\24\JOBS\24A0010_00\CAD\AIRPORT\SHEET\C-122-DEM



JEFFREY M. OLSON
062-065527
REGISTERED
PROFESSIONAL
ENGINEER
OF
ILLINOIS
EXPIRES 11/30/25

DA No: GBG-4988
SBG No: N/A
CONTRACT No: GA012

NO.	DATE	DESCRIPTION		
		DES	DWN	REV

SHEET TITLE

7



THE AC TYPE SHALL BE PG-58-28



100% SUBMITTAL



Offices Nationwide
www.hanson-inc.com



JEFFREY M. OLSON
062-065527
REGISTERED
PROFESSIONAL
ENGINEER
OF
ILLINOIS
EXPIRES 11/30/25

[Signature]

REHABILITATE
AUTO-PARKING LOT

SBG No: N/A

NO.	DATE	DESCRIPTION		
		DES	DWN	REV

PROJECT NO: 24A0010.00

PROJECT NO: 24A0010.00

CAD FILE: C-121-CON.DWG

DESIGN BY: JAP 01/17/2025

DRAWN BY: KCB 01/17/2025

REVIEWED BY: JMO 01/29/2025

SHEET TITLE

PROPOSED
CONSTRUCTION
PLAN - BASE BID

CONSTRUCTION POINTS				
POINT #	NORTHING	EASTING	EXISTING ELEV.	PROPOSED ELEV.
1	1558367.70	2223737.54	758.45	758.45
2	1558324.97	2223816.70	758.97	758.97
3	1558314.94	2223835.68	758.94	758.94
4	1558293.32	2223823.08	759.91	760.07
5	1558301.94	2223806.77	759.73	759.89
6	1558244.65	2223776.07	759.98	760.15
7	1558254.10	2223762.67	759.93	759.86
8	1558241.57	2223752.11	759.51	759.68
9	1558267.79	2223700.35	759.21	759.37
10	1558110.53	2223617.54	759.82	759.99
11	1558066.18	2223701.45	761.16	761.32
12	1558078.80	2223677.57	760.31	760.47
13	1558056.70	2223665.89	760.31	760.31
14	1558068.38	2223643.79	760.17	760.14
15	1557988.12	2223601.36	759.28	760.47
16	1557976.43	2223623.46	759.69	759.69
17	1557954.52	2223611.44	759.48	759.48
18	1557990.53	2223546.25	758.24	758.24
19	1558012.22	2223558.68	758.20	758.20
20	1558000.53	2223580.78	758.89	758.95
21	1558079.60	2223622.57	759.85	759.93
22	1558091.28	2223600.47	759.04	759.04
23	1558113.39	2223612.16	759.48	759.92
24	1558117.12	2223605.08	759.04	759.85

LEGEND:

- BUILDING
- BITUMINOUS OVERLAY
- BITUMINOUS PAVEMENT
- SHOULDER ADJUSTMENT/SEEDING AND MULCHING

EXISTING SIDEWALK

FBO HANGAR

**PROPOSED INLET TY A
W/ TY 8 GRATE
FRAME ELEV. - 761.21
INVERT ELEV. - 756.19**

OFFICE

PROPOSED 5" BITUMINOUS PAVEMENT (TYP.), 209 TONS - BASE BID

PROPOSED 2" BITUMINOUS OVERLAY, 236 TONS - BASE BID

**ADJUST EXISTING INLET WITH NEW FRAME AND GRATE - BASE BID
NEENAH 4122-6172 OR APPROVED EQUIVALENT**

PROPOSED SHOULDER ADJUSTMENT - 7 FT AND SEEDING/MULCHING

100% SUBMITTA

100% SUBMITTAL



JEFFREY M. OLSON
062-065527
REGISTERED
PROFESSIONAL
ENGINEER
OF
ILLINOIS
EXPIRES 11/30/25

DATE SIGNED: 02/28/25 LICENSE EXPIRES: 11/30/25

NO.	DATE	DESCRIPTION		
		DES	DWN	RE

PROPOSED
CONSTRUCTION
PLAN - ADD ALT 1

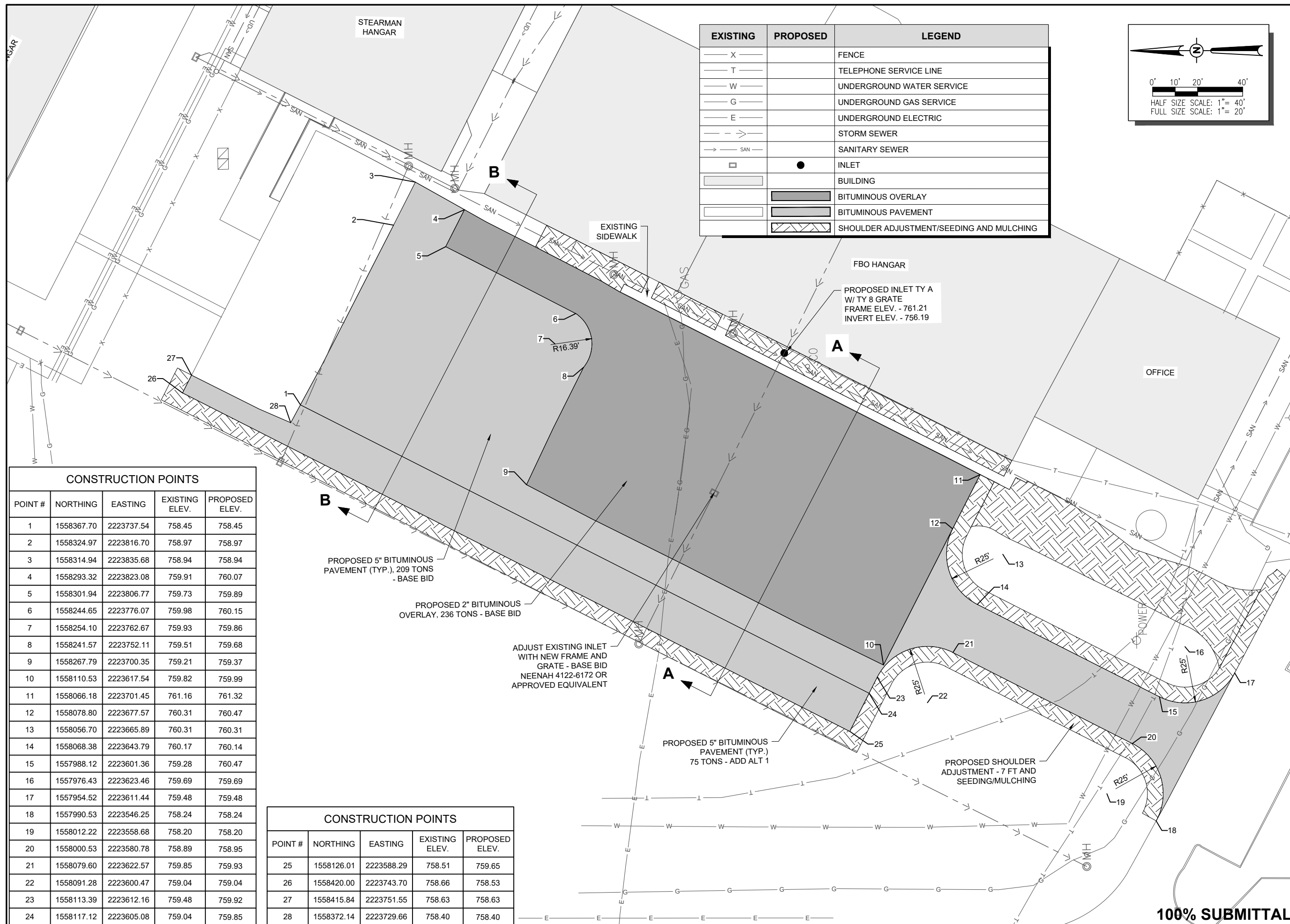

FEB 28, 2025 2:28 PM CRAFT02387
I:\24\JOBS\24A010_00\CAD\AIRPORT\1\SHEET\TC-501-MRK

EXISTING	PROPOSED	LEGEND
X		FENCE
		BUILDING
		BITUMINOUS PAVEMENT

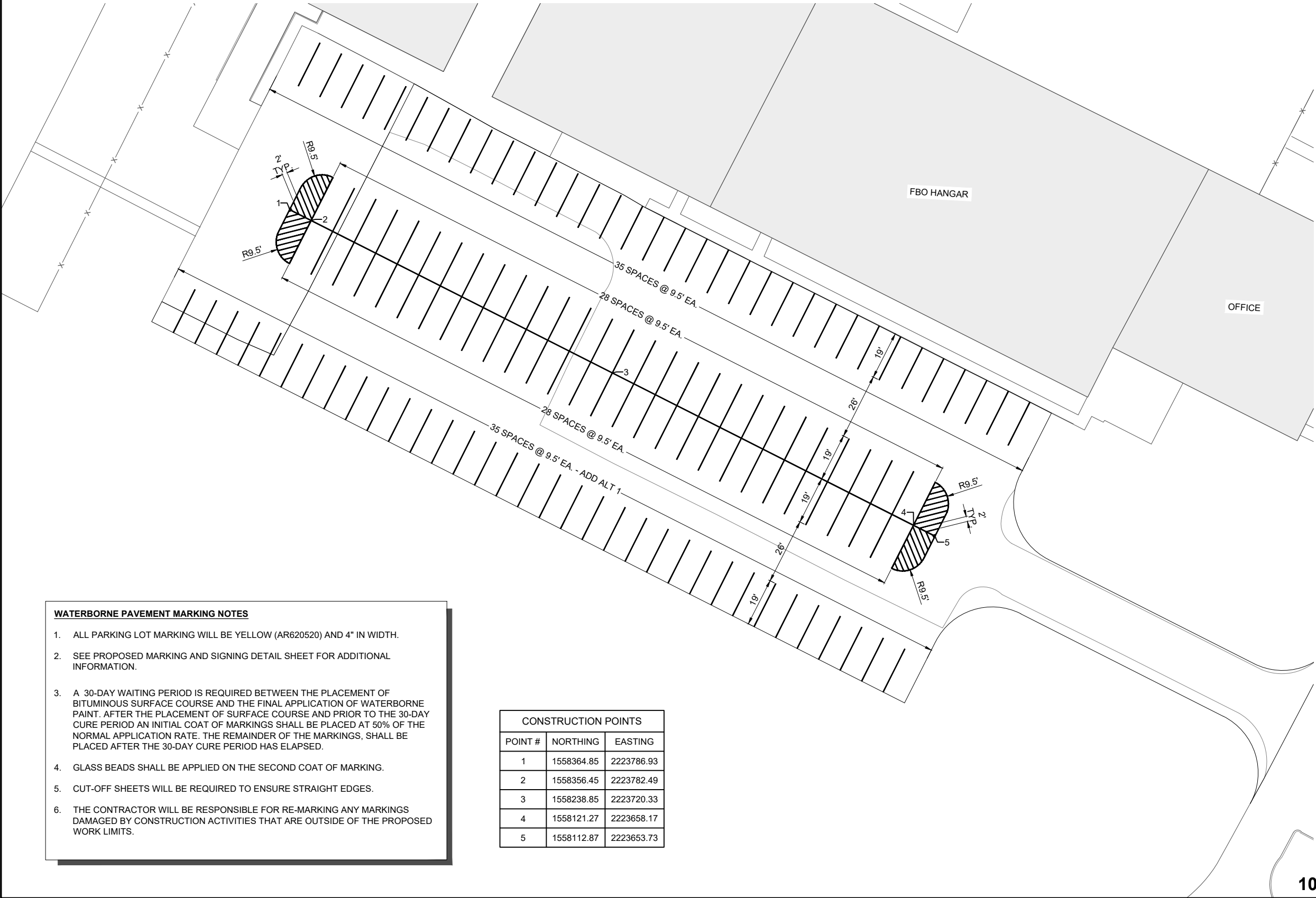
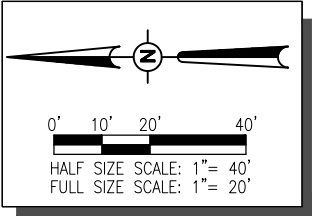

WATERBORNE PAVEMENT MARKING NOTES

- ALL PARKING LOT MARKING WILL BE YELLOW (AR620520) AND 4" IN WIDTH.
- SEE PROPOSED MARKING AND SIGNING DETAIL SHEET FOR ADDITIONAL INFORMATION.
- A 30-DAY WAITING PERIOD IS REQUIRED BETWEEN THE PLACEMENT OF BITUMINOUS SURFACE COURSE AND THE FINAL APPLICATION OF WATERBORNE PAINT. AFTER THE PLACEMENT OF SURFACE COURSE AND PRIOR TO THE 30-DAY CURE PERIOD AN INITIAL COAT OF MARKINGS SHALL BE PLACED AT 50% OF THE NORMAL APPLICATION RATE. THE REMAINDER OF THE MARKINGS, SHALL BE PLACED AFTER THE 30-DAY CURE PERIOD HAS ELAPSED.
- GLASS BEADS SHALL BE APPLIED ON THE SECOND COAT OF MARKING.
- CUT-OFF SHEETS WILL BE REQUIRED TO ENSURE STRAIGHT EDGES.
- THE CONTRACTOR WILL BE RESPONSIBLE FOR RE-MARKING ANY MARKINGS DAMAGED BY CONSTRUCTION ACTIVITIES THAT ARE OUTSIDE OF THE PROPOSED WORK LIMITS.

CONSTRUCTION POINTS		
POINT #	NORTHING	EASTING
1	1558364.85	2223786.93
2	1558356.45	2223782.49
3	1558238.85	2223720.33
4	1558121.27	2223658.17
5	1558112.87	2223653.73



Engineering | Planning | Allied Services

Hanson Professional Services Inc.
1525 S. 6th Street
Springfield, IL 62703
phone: 217-788-2450
fax: 217-788-2503

Offices Nationwide
www.hanson-inc.com

Illinois Licensed
Professional Service Corporation
#184-001084



Galesburg Municipal Airport (GBG)
City of Galesburg
55 West Tompkins Street
Galesburg, Illinois 61401



JEFFREY M. OLSON
082-065527
REGISTERED
PROFESSIONAL
ENGINEER
OF
ILLINOIS
EXPIRES 11/30/25

Jeffrey M. Olson

DATE SIGNED: 02/28/25 LICENSE EXPIRES: 11/30/25

**REHABILITATE
AUTO-PARKING LOT**

IDA No: GBG-4988
SBG No: N/A
CONTRACT No: GA012

NO.	DATE	DESCRIPTION		
		DES	DWN	REV

ISSUE: FEBRUARY 28, 2025
PROJECT NO: 24A0010.00
CAD FILE: C-501-MRK.DWG
DESIGN BY: JAP 01/17/2025
DRAWN BY: KCB 01/17/2025
REVIEWED BY: JMO 01/29/2025

SHEET TITLE

**PROPOSED MARKING
PLAN - ADD ALT 1**

100% SUBMITTAL

FEB 28, 2025 2:13 PM CRAFT02387
I:\24JOBS\24A0010_00\CAD\AIRPORT\SHEET\C-501-MRK



Galesburg Municipal Airport (GBG)
City of Galesburg
55 West Tompkins Street
Galesburg, Illinois 61401

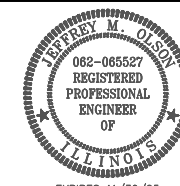

EXPIRES 11/30/25

DATE SIGNED: 02/28/25 LICENSE EXPIRES: 11/30/25

REHABILITATE
AUTO-PARKING LOT

IDA No: GBG-4988

SBG No: N/A

CONTRACT No: GA012

[illegible]

ISSUE: FEBRUARY 28, 2025

PROJECT NO: 24A0010.00

CAD FILE: C-503-TCSTD.DWG

DESIGN BY: --- JAB-01/17/2025

DRAWN BY: KCB 01/17/2025

REVIEWED BY: JMO 04/29/2025

SHEET TITLE

HIGHWAY STANDARD
701901-08 (1)

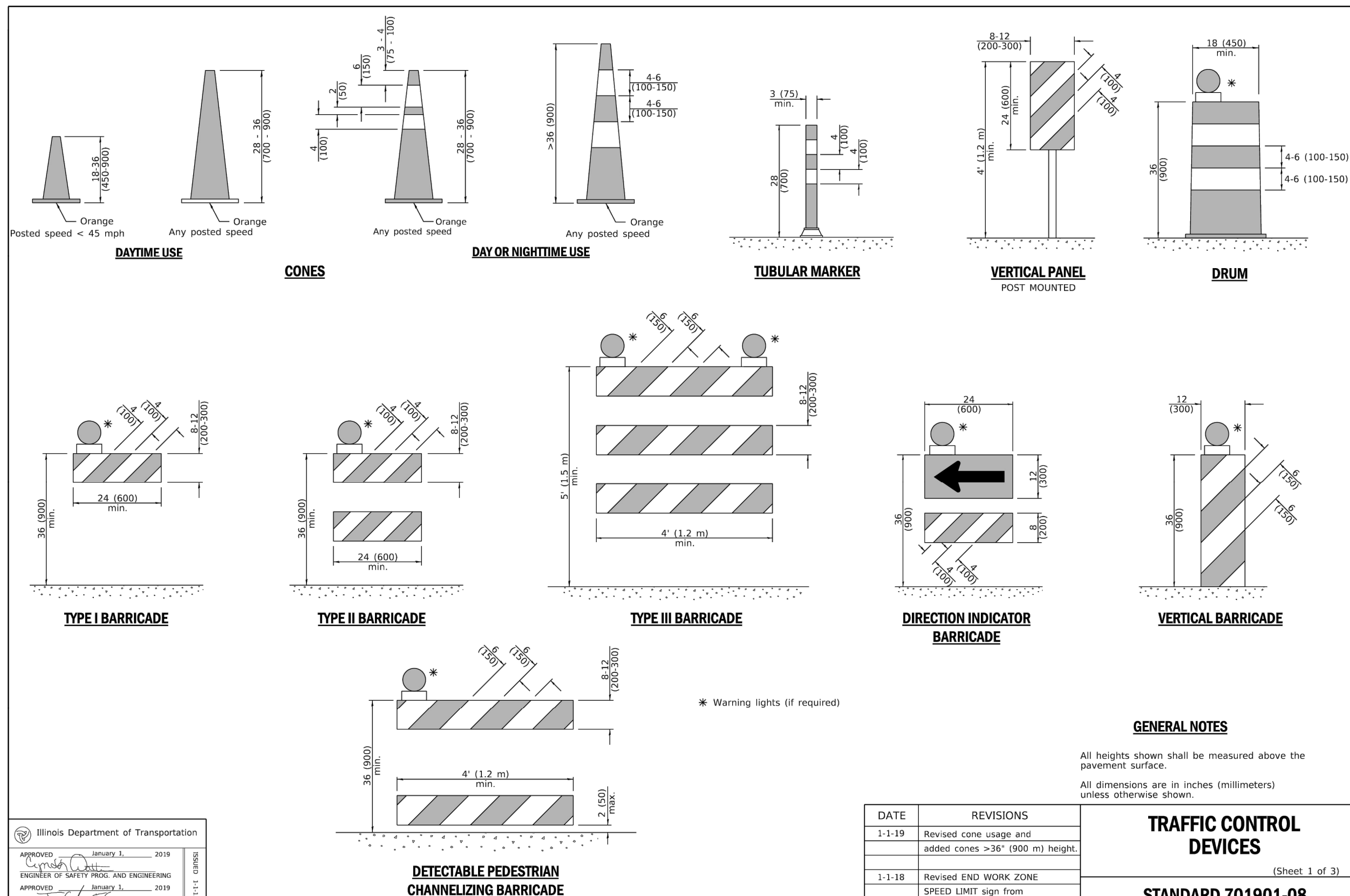



Offices Nationwide
www.hanson-inc.com

Illinois Licensed
Professional Service Corporation
#184-001084



Galesburg Municipal Airport (GBG)
City of Galesburg
55 West Tompkins Street
Galesburg, Illinois 61401



EXPIRES 11/30/

DATE SIGNED: 02/28/25 LICENSE EXPIRES: 11/30/25

REHABILITATE
AUTO-PARKING LOT

IDA No: GBG-4988

SBG No: N/A

CONTRACT No: GA012

NO.	DATE	DESCRIPTION		
		DES	DWN	RE

ISSUE: FEBRUARY 28, 2025

PROJECT NO: 24A0010.00

CAD FILE: C-503-TCSTD.DWG

DESIGN BY: --- JAP-01/17/202

DRAWN BY: --- KCB 01/17/202

REVIEWED BY: JMO 01/29/2022

SHEET TITLE

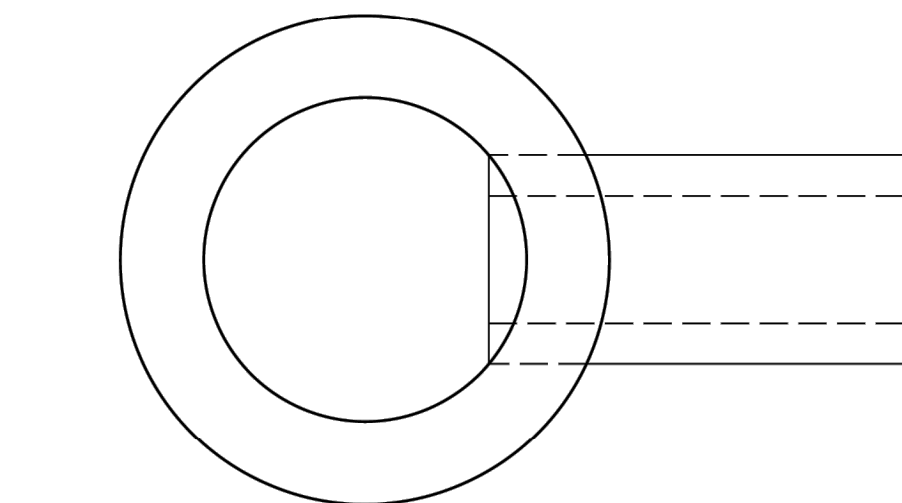
HIGHWAY STANDARD
602301-04

PLAN

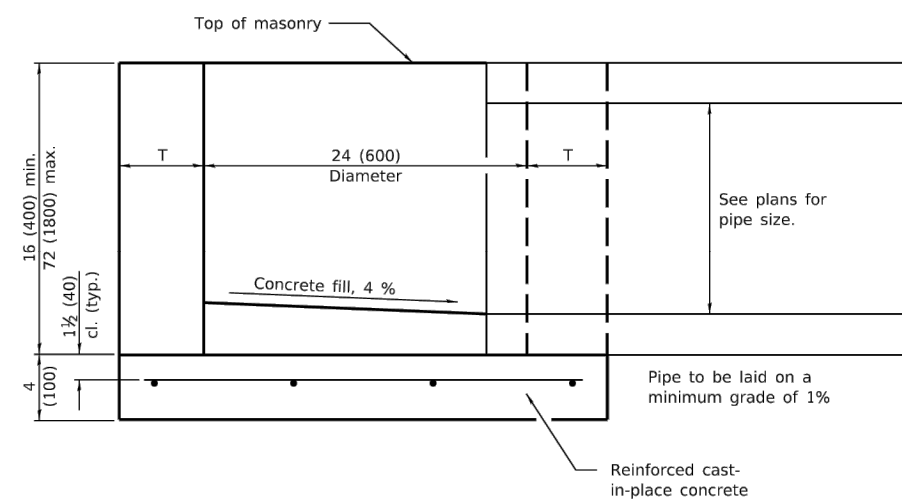

ELEVATION

ALTERNATE MATERIALS FOR WALLS	T
BRICK MASONRY	8 (200)
CAST-IN-PLACE CONCRETE	6 (150)
CONCRETE MASONRY UNIT	5 (125)
PRECAST REINFORCED CONCRETE SECTION	3 (75)

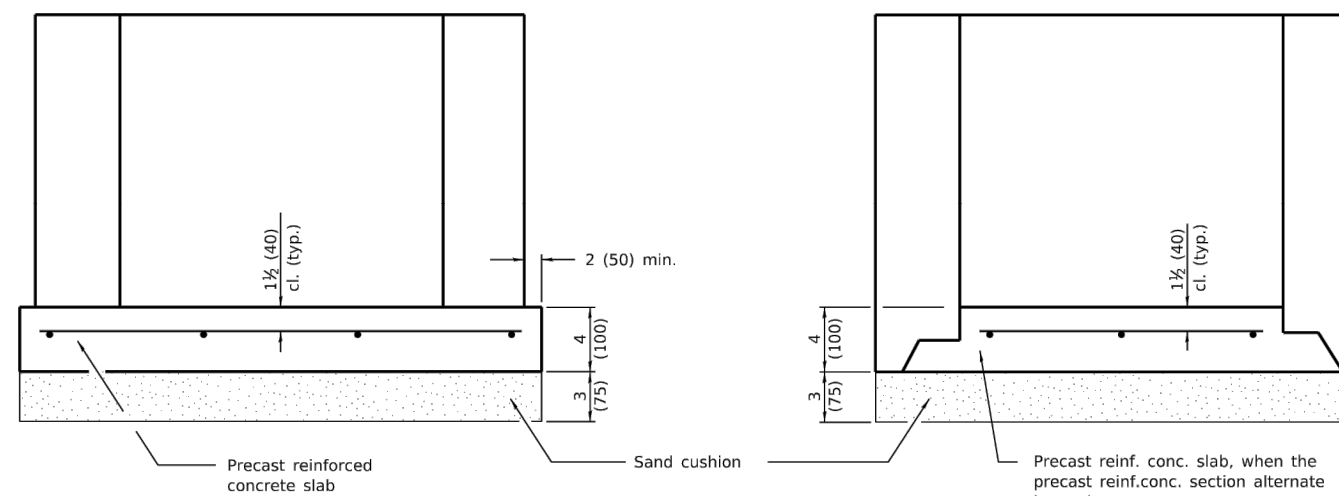

ALTERNATE METHODS

GENERAL NOTES

Bottom slabs shall be reinforced with a minimum of 0.24 sq. in./ft. (510 sq. mm/m) in both directions with a maximum spacing of 10 (250).

Bottom slabs may be connected to the riser as determined by the fabricator; however, only a single row of reinforcement around the perimeter may be utilized.

All dimensions are in inches (millimeters) unless otherwise shown.

DATE	REVISIONS	INLET - TYPE A
1-1-14	Increased height to 72 (1800) maximum.	
1-1-11	Detailed rein. in slabs.	
	Added max. limit to height.	STANDARD 602301-04
	Added general notes.	

INLET - TYPE A

STANDARD 602301-04

100% SUBMITTAL

FEB 28, 2025 2:13 PM CRAFT02387
I:\24\JOBS\24A0010_00\CAD\AIRPORTSHEET\TC-503-TCSTD



Galesburg Municipal Airport (GBG)
City of Galesburg
55 West Tompkins Street
Galesburg, Illinois 61401



EXPIRES 11/30/25
[Signature]
DATE SIGNED: 02/28/25 LICENSE EXPIRES: 11/30/25

REHABILITATE
AUTO-PARKING LOT

IDA No: GBG-4988
SBG No: N/A
CONTRACT No: GA012

NO.	DATE	DESCRIPTION		
		DES	DWN	REV

ISSUE: FEBRUARY 28, 2025
PROJECT NO: 24A0010.00
CAD FILE: C-503-TCSTD.DWG
DESIGN BY: --- JAP-01/17/2025
DRAWN BY: --- KCB 01/17/2025
REVIEWED BY: JMO 04/29/2025

SHEET TITLE

HIGHWAY STANDARD
604036-03

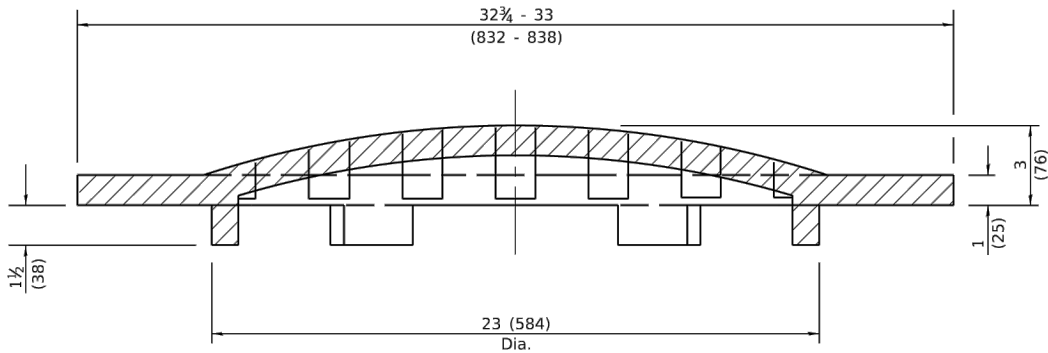
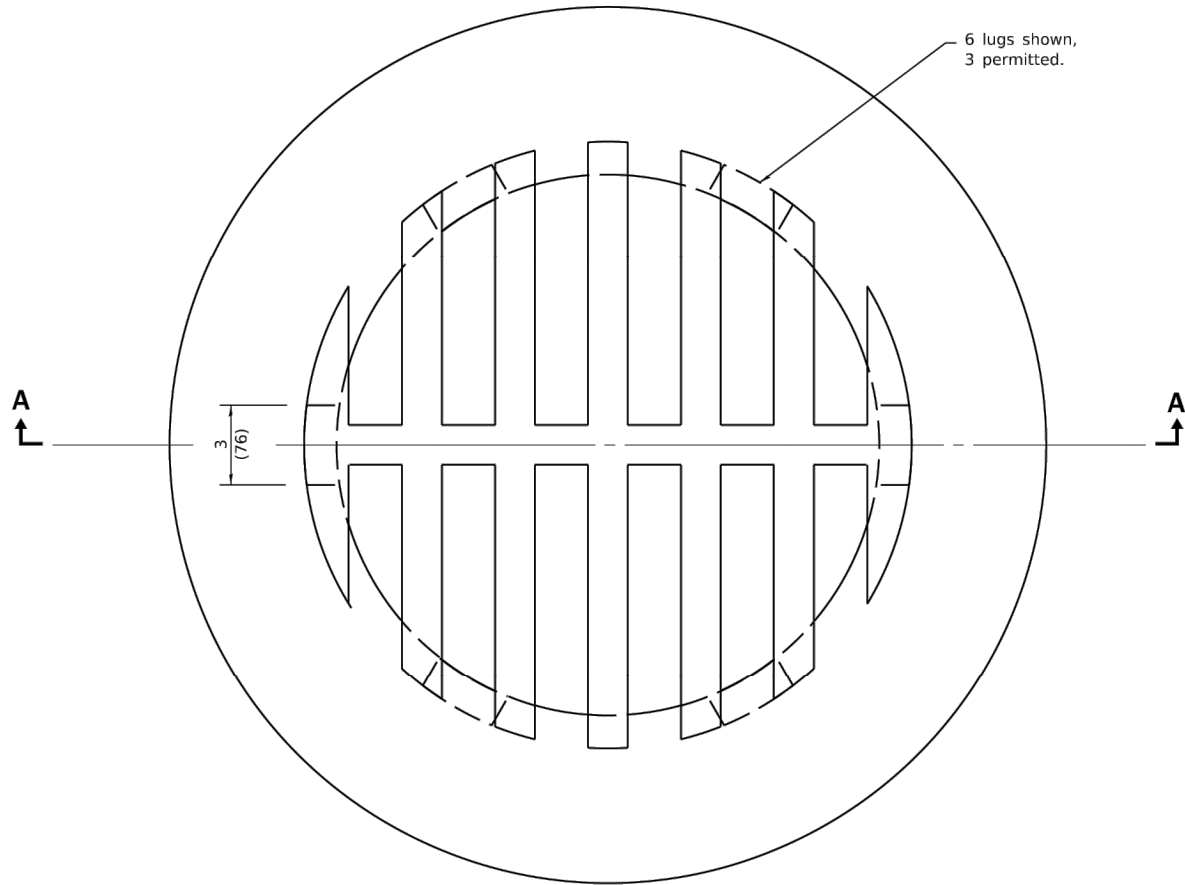

SECTION A-A

CAST GRATE

All dimensions are in inches (millimeters)
unless otherwise shown.

DATE	REVISIONS	GRATE TYPE 8 STANDARD 604036-03
1-1-15	Revised dimensions.	
1-1-09	Switched units to	
	English (metric).	

Illinois Department of Transportation

PASSED January 1, 2015
ENGINEER OF POLICY AND PROCEDURES
APPROVED January 1, 2015
ENGINEER OF DESIGN AND ENVIRONMENT

ISSUED 1-1-97