

STATE OF ILLINOIS
DEPARTMENT OF TRANSPORTATION

F.A.P. RTE.	SECTION	COUNTY	TOTAL SHEETS	SHEET NO.
343	FAP 0343 23 SMART	COOK	25	1
		ILLINOIS	CONTRACT NO. 62V73	

D-91-051-24

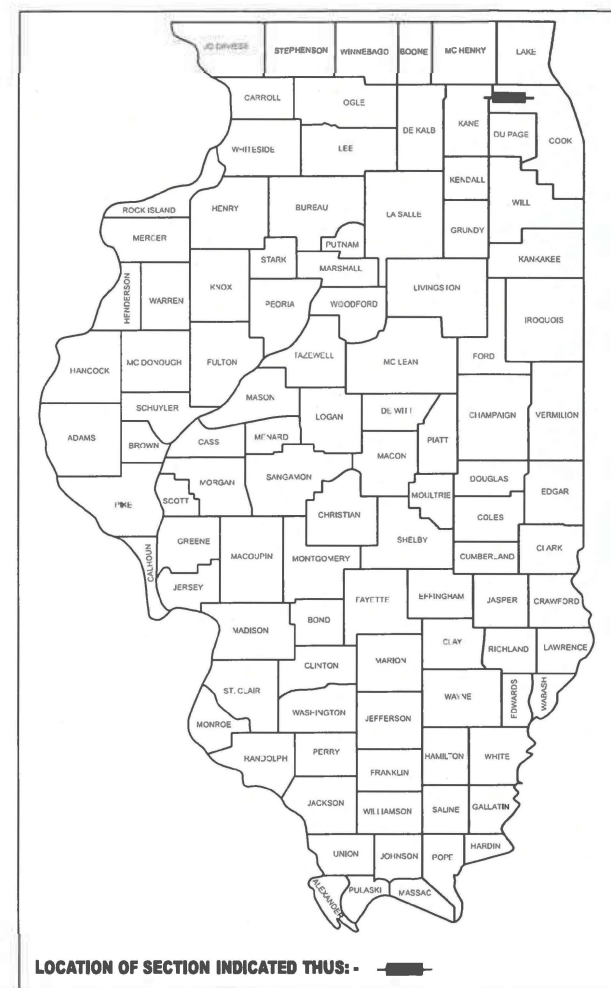

LOCATION OF SECTION INDICATED THUS: -

FOR INDEX OF SHEETS, SEE SHEET NO. 2

THIS PROJECT IS LOCATED IN:
THE VILLAGE OF BARRINGTON HILLS

**PROPOSED
HIGHWAY PLANS**
FAP ROUTE 343 ILL 68 (DUNDEE ROAD)
SECTION: FAP 0343 23 SMART
PROJECT: NHPP 6LX9 (253)
SMART OVERLAY
KANE COUNTY LINE TO ILL 62 (ALGONQUIN ROAD)
COOK COUNTY

C-91-059-24

R 9 E

TRAFFIC DATA:

ILL 68 DUNDEE RD

ADT (2023) = 7450

POSTED AND DESIGN SPEED LIMIT: 45-55 MPH

PROJECT BEGINS
STA 15+00

PROJECT ENDS
STA 161+20

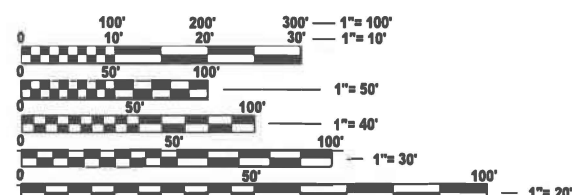

FULL SIZE PLANS HAVE BEEN PREPARED USING STANDARD ENGINEERING SCALES. REDUCED SIZED PLANS WILL NOT CONFORM TO STANDARD SCALES. IN MAKING MEASUREMENTS ON REDUCED PLANS, THE ABOVE SCALES MAY BE USED.

J.U.L.I.E.
JOINT UTILITY LOCATION INFORMATION FOR EXCAVATION
1-800-892-0123
OR 811

T 42 N

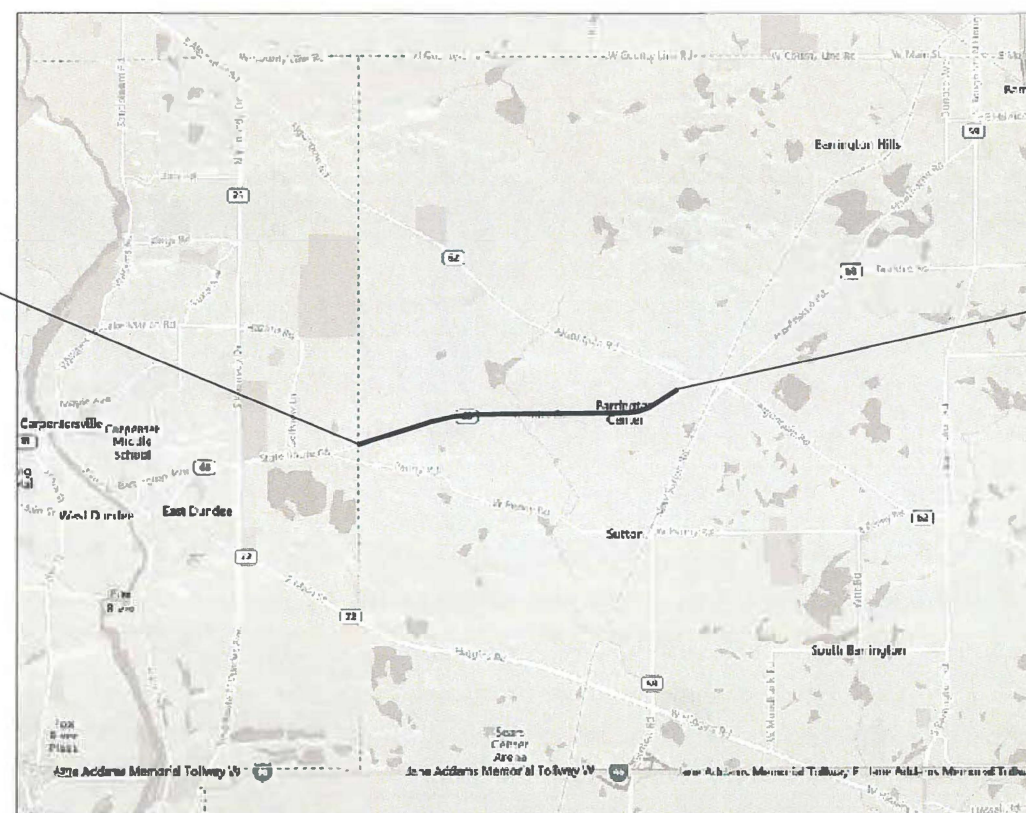

BARRINGTON TOWNSHIP

GROSS AND NET LENGTH = 14620 FT. = 2.77 MILE

PROJECT ENGINEER: DANIEL WILGREEN, P.E. (847) 705-4240
PROJECT MANAGER: J. ALAIN MIDY, P.E. (847) 221-3056

CONTRACT NO. 62V73

STATE OF ILLINOIS
DEPARTMENT OF TRANSPORTATION

SUBMITTED Jan 24 2025 IR
REGIONAL ENGINEER

March 21 2025
ENGINEER OF DESIGN AND ENVIRONMENT

March 21 2025
DIRECTOR OF HIGHWAYS PROJECT IMPLEMENTATION

PRINTED BY THE AUTHORITY
OF THE STATE OF ILLINOIS

Model: GenNot01 (Sheet)
File Name: p:\illinois\pennsylvania.com\PMIDOT\Documents\IDOT Offices\District 1\ORD Projects\105124\CADData\CADsheets\105124-shitgennots.dgn

INDEX OF SHEETS

SHEET NO.

DESCRIPTION

1	COVER SHEET
2	INDEX OF SHEETS, STATE STANDARDS, AND GENERAL NOTES
3-4	SUMMARY OF QUANTITIES
5	LANDSCAPING SCHEDULE
6-7	TYPICAL SECTIONS
8-13	EXISTING AND PROPOSED ROADWAY PLANS
14	FRAMES AND LIDS ADJUSTMENT WITH MILLING (BD-08)
15	PAVEMENT PATCHING FOR HMA SURFACED PAVEMENT (BD-22)
16	CURB AND GUTTER REMOVAL AND REPLACEMENT (BD-24)
17	BUTT JOINT AND HMA TAPER DETAILS (BD-32)
18	RUMBLE STRIPS FOR CENTERLINE, NON-FREEWAY (BD-55)
19	TRAFFIC CONTROL AND PROTECTION FOR SIDE ROADS, INTERSECTIONS, AND DRIVEWAYS (TC-10)
20	TYPICAL APPLICATIONS RAISED REFLECTIVE PAVEMENT MARKERS (SNOW-PLOW RESISTANT) (TC-11)
21	DISTRICT ONE TYPICAL PAVEMENT MARKINGS (TC-13)
22	TRAFFIC CONTROL AND PROTECTION AT TURN BAYS (TO REMAIN OPEN TO TRAFFIC) (TC-14)
23	SHORT TERM PAVEMENT MARKING LETTERS AND SYMBOLS (TC-16)
24	ARTERIAL ROAD INFORMATION SIGN (TC-22)
25	DRIVEWAY ENTRANCE SIGNING (TC-26)

STATE STANDARDS

DESCRIPTION

STANDARD NO.

000001-08	STANDARD SYMBOLS, ABBREVIATIONS, AND PATTERNS
442201-03	CLASS C AND D PATCHES
482011-03	HMA SHLD. STRIPS/SHLDS. WITH RESURFACING OR WIDENING AND RESURFACING PROJECTS
606001-08	CONCRETE CURB TYPE B AND COMBINATION CONCRETE CURB AND GUTTER
642006-01	SHOULDER RUMBLE STRIPS, 8 in
701006-05	OFF-RD OPERATIONS, 2L, 2W, 15' (4.5 m) to 24" (600 mm) FROM PAVEMENT EDGE
701011-04	OFF-RD MOVING OPERATIONS, 2L, 2W, DAY ONLY
701201-05	LANE CLOSURE, 2L 2W, DAY ONLY, FOR SPEEDS ≥ 45MPH
701301-04	LANE CLOSURE, 2L, 2W, SHORT TIME OPERATIONS
701306-04	LANE CLOSURE, 2L, 2W, SLOW MOVING OPERATIONS DAY ONLY, FOR SPEED ≥ 45MPH
701311-03	LANE CLOSURE, 2L, 2W MOVING OPERATIONS- DAY ONLY
701501-06	URBAN LANE CLOSURE, 2L, 2W, UNDIVIDED
701502-09	URBAN LANE CLOSURE, 2L, 2W, WITH BIDIRECTIONAL LEFT TURN LANE
701602-10	URBAN LANE CLOSURE, MULTILANE, 2W WITH BIDIRECTIONAL LEFT TURN LANE
701701-10	URBAN LANE CLOSURE, MULTILANE INTERSECTION
701901-10	TRAFFIC CONTROL DEVICES
780001-05	TYPICAL PAVEMENT MARKINGS
781001-04	TYPICAL APPLICATIONS RAISED REFLECTIVE PAVEMENT MARKERS

GENERAL NOTES

- ALL PAVEMENT PATCHING LOCATIONS WILL BE DETERMINED IN THE FIELD BY THE ENGINEER.
- ALL MILLED SURFACES SHALL BE A UNIFORM CROSS SLOPE PER LANE AND FREE OF RIDGES BETWEEN PASSES, ANY DEVIATIONS SHALL BE CORRECTED AT NO COST TO THE DEPARTMENT.
- LOCATION OF COMBINATION CONCRETE CURB AND GUTTER REMOVAL AND REPLACEMENT [OR COMBINATION CURB AND GUTTER (THE TYPE SPECIFIED ON THE PLANS)], WILL BE DETERMINED IN THE FIELD BY THE ENGINEER.
- TEN (10) FOOT TRANSITIONS SHALL BE USED TO MATCH PROPOSED CURB AND GUTTER AND MEDIAN ITEMS OF WORK TO EXISTING CURBS AND GUTTER AND MEDIANS IN THE FIELD, UNLESS OTHERWISE SHOWN.
- IT SHALL BE THE CONTRACTOR'S RESPONSIBILITY TO VERIFY ALL DIMENSIONS AND CONDITIONS EXISTING IN THE FIELD PRIOR TO CONSTRUCTION AND ORDERING OF MATERIALS.
- THE CONTRACTOR SHALL BE REQUIRED TO KEEP A RECORD OF THE LOCATIONS OF PLATED STRUCTURES BY STATION AND OFFSET LEFT OR RIGHT OF THE CENTERLINE OF PAVEMENT.
- OVERNIGHT LANE CLOSURES SHALL NOT BE ALLOWED FOR REHABILITATION PROJECTS INVOLVING DAYTIME MILLING AND RESURFACING OPERATIONS AND CLASS D PATCHING UNLESS OTHER CONDITIONS WARRANT EXTENDED LANE CLOSURES AS DETERMINED AND APPROVED IN WRITING BY THE ENGINEER OR AS PROVIDED FOR IN THE CONTRACT SPECIFICATIONS.
- THE CONTRACTOR WILL NOT BE ALLOWED TO SET UP A YARD OR FIELD OFFICE ON STATE PROPERTY WITHOUT WRITTEN PERMISSION FROM THE DEPARTMENT.
- BEFORE BEGINNING ANY WORK, THE CONTRACTOR SHALL RETAIN AND RECORD FOR FUTURE REFERENCE, ALL EXISTING PAVEMENT MARKING LINES (AND RAISED REFLECTIVE PAVEMENT MARKERS) IN ORDER THAT THESE LOCATIONS CAN BE RE-ESTABLISHED FOR STRIPING. EXACT LOCATIONS OF ALL PAVEMENT MARKINGS SHALL BE AS DIRECTED BY THE ENGINEER.
- BUTT JOINTS WILL BE INSTALLED AT THE ENDS OF ALL RESURFACING (WHERE RESURFACING MEETS EXISTING PAVEMENT) ACCORDING TO THE "BUTT JOINT AND HOT-MIX ASPHALT TAPER DETAILS" SHEET INCLUDED IN THE PLANS, UNLESS OTHERWISE SPECIFIED.
- THE RESIDENT ENGINEER SHALL CONTACT MR. FADI SULTAN AREA TRAFFIC FIELD ENGINEER, AT FADI.SULTAN@ILLINOIS.GOV, A MINIMUM OF TWO (2) WEEKS PRIOR TO THE PLACEMENT OF PERMANENT PAVEMENT MARKINGS.
- ANY DAMAGE TO EXISTING PAVEMENT MARKINGS OR RAISED REFLECTIVE PAVEMENT MARKERS OUTSIDE THE REMOVAL LINE SHOWN ON THE PLANS SHALL BE REPLACED AT THE CONTRACTOR'S EXPENSE.
- ALL PAVEMENT MARKINGS ACCORDING TO DISTRICT 1 TYPICAL PAVEMENT MARKING DETAIL TC-13.
- THE CONTRACTOR SHALL CONTACT THE DISTRICT TRAFFIC CONTROL SUPERVISOR AT KALPANA.KANNAN-HOSADURGA@ILLINOIS.GOV A MINIMUM OF 72 HOURS IN ADVANCE OF BEGINNING WORK.
- THE CONTRACTOR SHALL BE REQUIRED TO PROVIDE ACCESS TO ABUTTING PROPERTY AT ALL TIMES DURING THE CONSTRUCTION OF THIS PROJECT.
- RAISED REFLECTIVE PAVEMENT MARKERS SHALL BE PLACED THROUGHOUT THE IMPROVEMENT ACCORDING TO THE DISTRICT STANDARDS AS NOTED IN THE DETAIL.
- ALL RAISED REFLECTIVE PAVEMENT MARKERS SHALL BE INSTALLED ACCORDING TO IDOT D1 RRPM DETAIL TC-11.
- CONTRACTOR MUST NOT ENCROACH, PERFORM ANY CONSTRUCTION ACTIVITIES, OR PARK ANY CONSTRUCTION EQUIPMENT OR VEHICLES IN THE AREA WITHIN 30' FROM THE CENTERLINE OF THE NEAREST TRACK.
- RE SHALL CONTACT ROADSIDE DEVELOPMENT UNIT AT 847-705-4171 TWO WEEKS IN ADVANCE PRIOR TO FORESTRY WORK FOR LAYOUT.
- PAVEMENT MARKING, TYPE IV TAPE SHALL BE USED FOR SHORT TERM PAVEMENT MARKINGS ON ALL FINAL SURFACES.

	USER NAME = Rana,Kalo	DESIGNED -	REVISED -	STATE OF ILLINOIS DEPARTMENT OF TRANSPORTATION	INDES OF SHEETS, STATE STANDARDS, AND GENERAL NOTES IL. RTE. 68 (DUNDEE RD.) (KANE CO. LINE TO IL. RTE. 62 (ALGONQUIN RD.))			F.A.P RTE.	SECTION	COUNTY	TOTAL SHEETS	SHEET NO.
		DRAWN -	REVISED -					343	FAP 0343 23 SMART	COOK	25	2
	PLOT SCALE = \$SCALE\$	CHECKED -	REVISED -					CONTRACT NO. 62V73				
	PLOT DATE = 3/14/2025	DATE -	REVISED -		SCALE: NONE	SHEET 1	OF 1 SHEETS	STA.	TO STA.	ILLINOIS FED. AID PROJECT		

MODEL: SQQ_1 [Sheet]
FILE NAME: c:\pw\work\ill\kalam\40838033\0105124-411-SQQ.dgn

SUMMARY OF QUANTITIES					TYPE CODE					
					URBAN	URBAN	URBAN	URBAN	URBAN	URBAN
					ROADWAY	ROADWAY				
					80% FED 20% STATE	100% STATE				
	Code No.	Item	Unit	Total Quantity	0005	0005				
	20100110	TREE REMOVAL (6 TO 15 UNITS DIAMETER)	UNIT	240.4	240.4					
	20100210	TREE REMOVAL (OVER 15 UNITS DIAMETER)	UNIT	15.2	15.2					
	25000300	SEEDING, CLASS 3	ACRE	1.47	1.47					
	25100630	EROSION CONTROL BLANKET	SQ YD	7109	7109					
	28100105	STONE RIPRAP, CLASS A3	SQ YD	5	5					
	40600290	BITUMINOUS MATERIALS (TACK COAT)	POUND	25618	25618					
	40600370	LONGITUDINAL JOINT SEALANT	FOOT	17639	17639					
	40600400	MIXTURE FOR CRACKS, JOINTS, AND FLANGEWAYS	TON	86	86					
	40600982	HOT-MIX ASPHALT SURFACE REMOVAL - BUTT JOINT	SQ YD	148	148					
	40604062	HOT-MIX ASPHALT SURFACE COURSE, IL-9.5, MIX "D", N70	TON	4782	4782					
	42001300	PROTECTIVE COAT	SQ YD	36.67	36.67					
	44000155	HOT-MIX ASPHALT SURFACE REMOVAL, 1 1/2"	SQ YD	56928	56928					
	44201827	CLASS D PATCHES, TYPE II, 15 INCH	SQ YD	300	300					
	44201831	CLASS D PATCHES, TYPE III, 15 INCH	SQ YD	200	200					
	44201833	CLASS D PATCHES, TYPE IV, 15 INCH	SQ YD	300	300					
	48102100	AGGREGATE WEDGE SHOULDER, TYPE B	TON	369	369					
	60920015	PIPE CULVERTS TO BE CLEANED 15"	FOOT	30	30					
	64200108	SHOULDER RUMBLE STRIPS, 8 INCH	FOOT	28111	28111					
	67100100	MOBILIZATION	L SUM	1	1					
	70100450	TRAFFIC CONTROL AND PROTECTION, STANDARD 701201	L SUM	1	1					
	70100460	TRAFFIC CONTROL AND PROTECTION, STANDARD 701306	L SUM	1	1					
		USER NAME = Rana.Kalo	DESIGNED -	REVISED -	STATE OF I DEPARTMENT OF TR					
			DRAWN -	REVISED -						
			CHECKED -	REVISED -						
		PLOT DATE = 2/4/2025	DATE -	REVISED -						

Ø 0042

MODEL: C:\neod1\Sheet1
FILE NAME: pr\jads\paw\benHer.com\PAW\DOT\Documents\DOT-OfficeData\District_1\CRSD-Projects\DOT105124\CAD\data\CAD\benHer\DOT105124-shr-schedule.dgn

X0100018	TREE REMOVAL (UNDER 6 UNITS DIAMETER SAWED FLUSH)	
UNIT	STATION	QUANTITY
	31+55RT	4.8
	57+90LT	5.7
	71+30RT	6.6
	71+30RT	6.5
	71+30RT	6.4
	135+00RT	4.8
	139+90RT	3.8
	148+48LT	4.5
	TOTAL	43.1

X2010200	TREE LIMB REMOVAL (OVER 10 INCHES DIAMETER)	
EACH	STATION	QUANTITY
	15+12LT	1
	18+46LT	1
	27+81LT	1
	64+44LT	1
	65+94LT	1
	88+97LT	1
	89+08LT	1
	113+50LT	1
	120+50LT	1
	134+46RT	1
	159+10LT	1
	TOTAL	11

20100210	TREE REMOVAL (OVER 15 UNITS DIAMETER)	
UNIT	STATION	QUANTITY
	138+81RT	15.2
	TOTAL	15.2

X2010100	TREE LIMB REMOVAL (4 - 10 INCHES DIAMETER)	
EACH	STATION	QUANTITY
	16+90LT	1
	33+25LT	1
	29+93RT	1
	75+21RT	1
	114+05LT	1
	151+78RT	1
	160+10LT	1
	TOTAL	7

20100110	TREE REMOVAL (6 TO 15 UNITS DIAMETER)	
UNIT	STATION	QUANTITY
	16+28LT	8.3
	16+30LT	7.5
	26+25LT	7.4
	38+21LT	7.9
	31+51RT	6.6
	42+49LT	8.2
	57+90RT	6.5
	76+01LT	6.8
	84+08LT	10.1
	71+10RT	10.4
	72+90RT	6.9
	75+50RT	11.8
	75+75RT	12.5
	77+10RT	8
	90+95LT	11.8
	92+52LT	8.9
	121+30LT	7.9
	121+38LT	6.7
	124+10LT	11.7
	139+90RT	7.5
	141+25RT	11.4
	143+97RT	7.9
	144+00RT	10.1
	149+94LT	10
	147+81RT	11.4
	160+05LT	8.4
	161+05LT	7.8
	TOTAL	240.4

Z0064800	SELECTIVE CLEARING	
UNIT (1000 SF)	STATION	QUANTITY
	15+20LT	4.53
	15+10RT	3.66
	25+73LT	0.54
	37+08LT	5.52
	25+87RT	2.9
	32+51RT	0.34
	34+21RT	1.52
	43+41LT	1.57
	41+20RT	0.85
	57+65LT	1.56
	61+21LT	0.34
	63+10LT	0.25
	64+38LT	2.01
	68+95LT	0.45
	61+25RT	1.98
	68+95RT	2
	72+10LT	0.87
	77+01LT	1.52
	83+15LT	1.68
	71+72RT	1.01
	73+75RT	0.28
	76+20RT	0.28
	86+80LT	0.24
	87+97LT	0.58
	89+75LT	0.49
	92+90LT	1.49
	86+11RT	0.9
	87+89RT	0.96
	113+00LT	4.75
	113+55RT	1.8
	120+70LT	1.35
	123+75LT	3.26
	116+31RT	0.1
	117+69RT	0.34
	119+90RT	1.38
	123+83RT	0.34
	137+50LT	1.25
	136+03RT	0.42
	138+00RT	1.72
	140+94RT	0.96
	143+65RT	1.47
	148+58LT	0.56
	153+98LT	0.96
	147+70RT	1.45
	152+61RT	0.48
	154+40RT	1.07
	TOTAL	63.98

NOTE: SEEDING, CLASS 3 AND EROSION CONTROL BLANKET ARE TO BE ADDED TO THE SELECTIVE CLEARING AREAS.

X2100002	PRUNING FOR SAFETY & EQUIP. CLEAR	
UNIT (100 LF)	STATION	QUANTITY
	20+51LT	0.84
	21+95LT	0.34
	15+51RT	0.27
	15+71LT	0.47
	17+10RT	0.81
	18+35RT	0.95
	19+91RT	1.84
	22+18RT	1.93
	24+74RT	0.99
	25+08LT	0.87
	26+78LT	0.69
	28+67LT	0.42
	34+77LT	0.53
	36+08LT	0.46
	38+93LT	0.37
	29+90RT	0.34
	36+70RT	2.52
	43+71LT	0.3
	51+41LT	2.08
	54+45LT	0.58
	54+51RT	0.75
	55+51LT	1.64
	58+71LT	0.36
	61+19LT	0.72
	62+28LT	0.55
	66+41LT	0.47
	56+05RT	0.4
	38+80RT	0.52
	60+03RT	1.25
	62+05RT	0.25
	63+02RT	0.37
	64+00RT	0.37
	65+10RT	0.42
	66+24RT	0.54
	70+51LT	0.6
	71+43LT	0.45
	72+18LT	0.43
	73+88LT	0.87
	75+20LT	0.59
	76+10LT	0.57
	83+18LT	0.14
	84+60LT	0.33
	70+75RT	0.34
	74+71RT	0.55
	75+90RT	0.3
	85+50LT	0.19
	89+81LT	1.68
	92+47LT	0.59
	93+88LT	0.66
	95+18LT	0.41
	96+15LT	0.46
	99+45LT	0.45
	100+40LT	0.74
	101+47LT	8.13
	109+55LT	1.73
	111+97LT	1.4
	113+05LT	0.16
	114+39LT	1.34
	113+71RT	0.38
	116+40LT	0.37
	117+08LT	0.84
	118+15LT	1.32
	122+31LT	1.57
	124+36LT	3.41
	115+48RT	0.36
	117+09RT	0.39
	118+10RT	0.21
	119+75RT	0.45
	121+10RT	1.03
	134+21LT	0.49
	141+08LT	0.86
	142+68LT	0.78
	143+89LT	1.02
	135+38RT	1.05
	139+40RT	0.44
	141+05RT	0.56
	143+60RT	0.44
	145+85LT	0.63
	151+61LT	0.67
	156+80LT	0.43
	153+48RT	0.31
	154+08RT	0.37
	156+38RT	1.67
	TOTAL	69.37

	USER NAME = Rena.Kalo	DESIGNED -	REVISED -	STATE OF ILLINOIS DEPARTMENT OF TRANSPORTATION	LANDSCAPING SCHEDULE				F.A.P. RTE.	SECTION	COUNTY	TOTAL SHEETS	SHEET NO.
		DRAWN -	REVISED -		KANE COUNTY LINE TO ILL 62 (ALGONQUIN RD)				343	FAP 0343 23 SMART	COOK	25	5
	PLOT SCALE = \$SCALE\$	CHECKED -	REVISED -						CONTRACT NO. 62V73				
	PLOT DATE = 2/4/2025	DATE -	REVISED -		SCALE: NONE	SHEET 1	OF 1	SHEETS	STA.	TO STA.			

Model: T:\p5sec02 [Sheet]
FILE NAME: p:\info\csw\ben\ben\com\p\m\DOT\Documents\JDOT Office\District 1\ORD Projects\DI05124\CA\Data\CAD\Drawings\DI05124-shb-typical.dgn

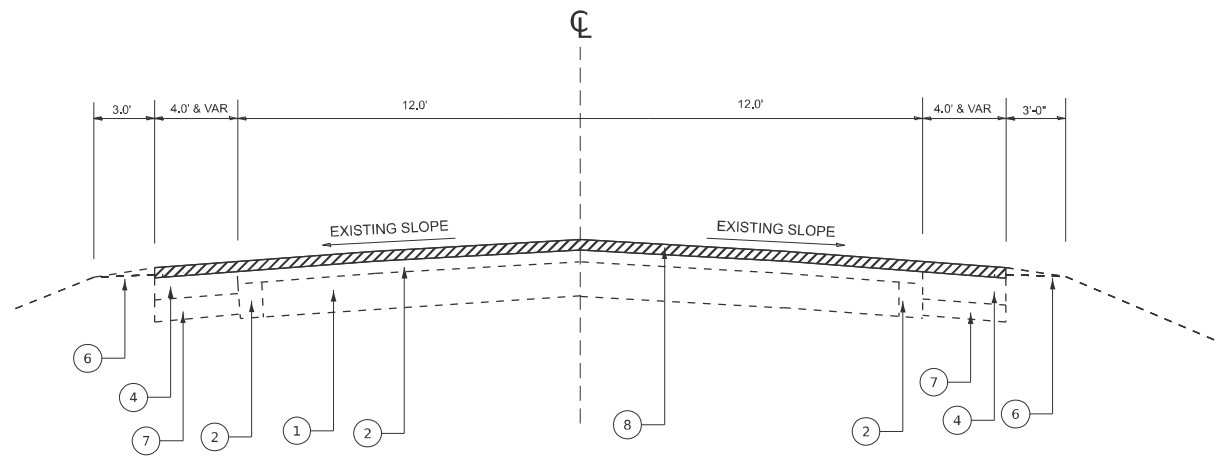

EXISTING TYPICAL SECTION

STA 15+00 - STA 148+10.3

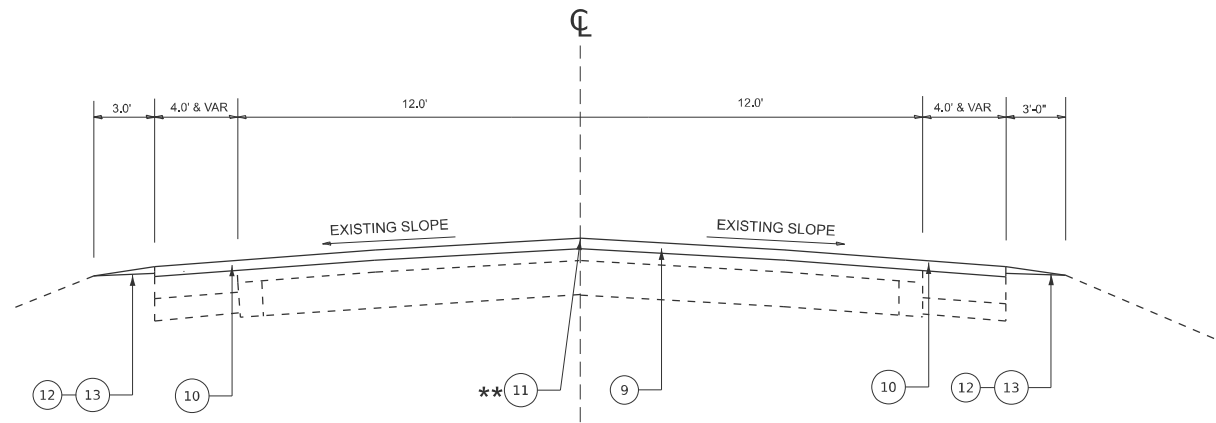

PROPOSED TYPICAL SECTION

STA 15+00 - STA 148+10.3

LEGEND

- EXISTING P.C.C. PAVEMENT, $\pm 8"$
- EXISTING HOT-MIX ASPHALT BASE COURSE, $\pm 8"$
- EXISTING HOT-MIX ASPHALT SHOULDER
- EXISTING HOT-MIX ASPHALT SHOULDER, $5\frac{3}{4}"$
- EXISTING COMBINATION CURB AND GUTTER, TYPE B-6.24
- EXISTING AGGREGATE SHOULDER
- EXISTING AGGREGATE BASE COURSE, TYPE A 4"
- EXISTING HMA SURFACE REMOVAL, $1\frac{1}{2}"$
- PROPOSED HOT-MIX ASPHALT SURFACE COURSE, IL-9.5, MIX "D", N70, $1\frac{1}{2}"$
- PROPOSED SHOULDER RUMBLE STRIPS, 8 INCH
- PROPOSED CENTER LINE - RUMBLE STRIP - 16"
- PROPOSED AGGREGATE WEDGE SHOULDER, TYPE B
- PROPOSED GRADING AND SHAPING SHOULDERS

HOT-MIX ASPHALT MIXTURE REQUIREMENTS		QMP
MIXTURE TYPE	AIR VOIDS @ Ndesign	
PAVEMENT RESURFACING		
HOT-MIX ASPHALT SURFACE COURSE, IL-9.5, MIX "D", N70, $1\frac{1}{2}"$	4% @ 70 Gyr.	QCP
PATCHING		
CLASS D PATCHES (HMA BINDER IL-19 mm)	4% @ 70 Gyr.	QC/QA
QMP Designations: Quality Control/Quality Assurance (QC/QA); Quality Control for Performance (QCP); Pay for Performance (PFP)		

THE UNIT WEIGHT USED TO CALCULATE ALL HMA SURFACE MIXTURE QUANTITIES IS 112 LBS/SQ YD/IN.

THE "AC TYPE" FOR POLYMERIZED HMA MIXES SHALL BE "SBS/SBR PG 76-22" AND FOR NON-POLYMERIZED HMA THE "AC TYPE" SHALL BE "PG 64-22" UNLESS MODIFIED BY RECLAIMED MATERIALS SPECIFICATIONS

NOTES:

- CONTRACTOR SHALL MILL BEFORE PATCHING
- LONGITUDINAL JOINT SEALANT SHALL BE PLACED OVER THE MILLED SURFACE
- ** CENTER LINE - RUMBLE STRIP - 16", STA. 15+00 TO STA. 148+10.3

STATE OF ILLINOIS DEPARTMENT OF TRANSPORTATION	USER NAME = Rana,Kalo	DESIGNED -	REVISED -	TYPICAL SECTIONS IL. RTE. 68 (DUNDEE RD.) (KANE CO. LINE TO IL. RTE. 62 (ALGONQUIN RD.))				F.A.P RTE.	SECTION	COUNTY	TOTAL SHEETS	SHEET NO.
		DRAWN -	REVISED -					343	FAP 0343 23 SMART	COOK	25	6
	PLOT SCALE = \$SCALE\$	CHECKED -	REVISED -					CONTRACT NO. 62V73				
	PLOT DATE = 2/27/2025	DATE -	REVISED -					ILLINOIS FED. AID PROJECT				
SCALE: NONE				SHEET 1	OF 2	SHEETS	STA.	TO STA.				

MODEL: T:\PSet03 [Sheet]
FILE NAME: p:\roadwork\ben\ben\com\PM\DOT\Documents\DOT Office\District 1\ORD Projects\DI05124\CA\Data\CAD\sheet\DI05124-shs-typical.dgn

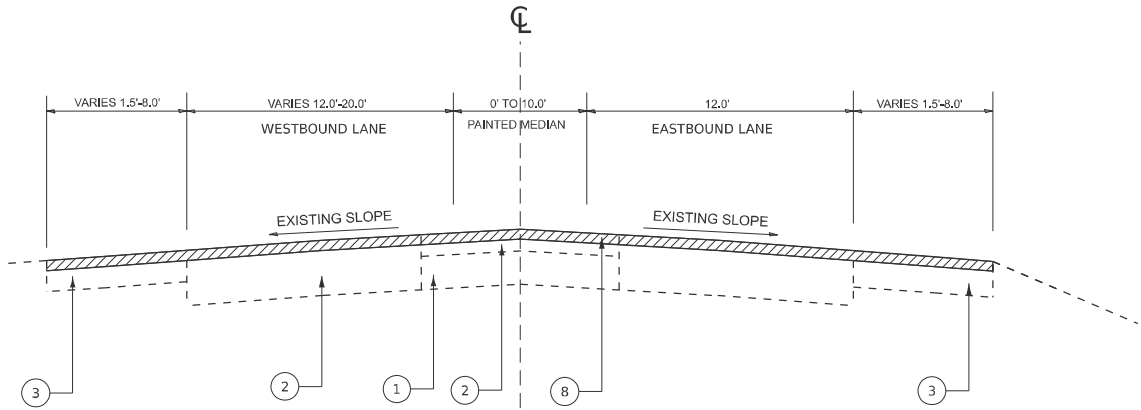

EXISTING TYPICAL SECTION

STA 148+10.3 - STA 161+20

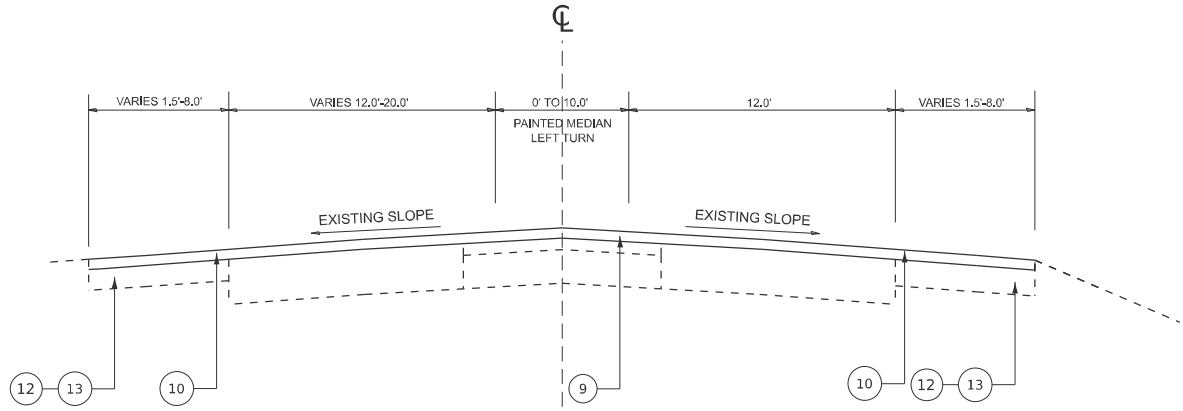

PROPOSED TYPICAL SECTION

STA 148+10.3 - STA 161+20

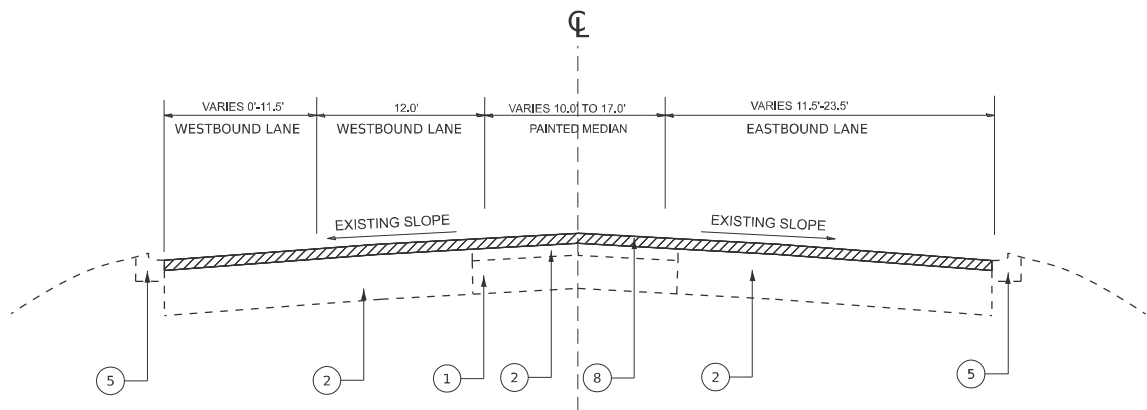

EXISTING TYPICAL SECTION

STA 153+35.82 - STA 161+20

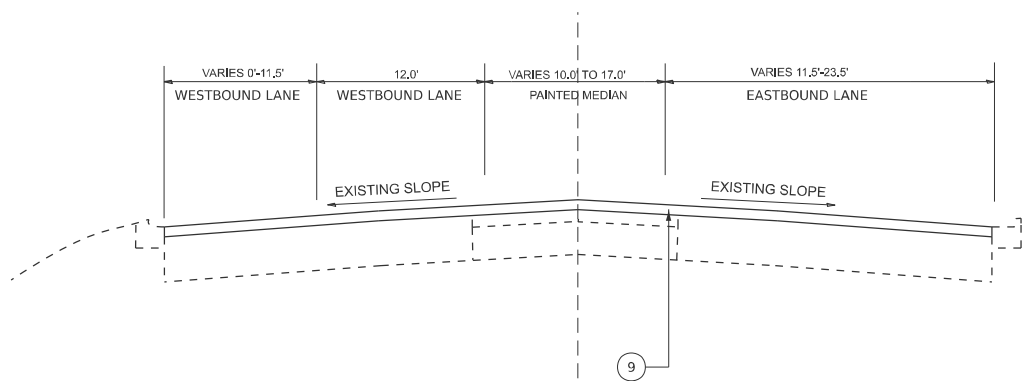

PROPOSED TYPICAL SECTION

STA 153+35.82 - STA 161+20

LEGEND

- EXISTING P.C.C. PAVEMENT, $\pm 8"$
- EXISTING HOT-MIX ASPHALT BASE COURSE, $\pm 8"$
- EXISTING HOT-MIX ASPHALT SHOULDER
- EXISTING HOT-MIX ASPHALT SHOULDER, $5\frac{3}{4}"$
- EXISTING COMBINATION CURB AND GUTTER, TYPE B-6.24
- EXISTING AGGREGATE SHOULDER
- EXISTING AGGREGATE BASE COURSE, TYPE A 4"
- EXISTING HMA SURFACE REMOVAL, $1\frac{1}{2}"$
- PROPOSED HOT-MIX ASPHALT SURFACE COURSE, IL-9.5, MIX "D", N70, $1\frac{1}{2}"$
- PROPOSED SHOULDER RUMBLE STRIPS, 8 INCH
- PROPOSED CENTER LINE - RUMBLE STRIP - 16"
- PROPOSED AGGREGATE WEDGE SHOULDER, TYPE B
- PROPOSED GRADING AND SHAPING SHOULDERS

NOTES:

- CONTRACTOR SHALL MILL BEFORE PATCHING
- LONGITUDINAL JOINT SEALANT SHALL BE PLACED OVER THE MILLED SURFACE
- ** CENTER LINE - RUMBLE STRIP - 16", STA. 15+00 TO STA. 148+10.3

STATE OF ILLINOIS
DEPARTMENT OF TRANSPORTATION

TYPICAL SECTIONS
IL. RTE. 68 (DUNDEE RD.) (KANE CO. LINE TO IL. RTE. 62 (ALGONQUIN RD.))

SCALE: NONE SHEET 2 OF 2 SHEETS STA. TO STA.

F.A.P RTE.	SECTION	COUNTY	TOTAL SHEETS	SHEET NO.
343	FAP 0343 23 SMART	COOK	25	7
CONTRACT NO. 62V73				
ILLINOIS FED. AID PROJECT				

MODEL: E:\CJ - Retire\Plan 1
FILE NAME: c:\pwworking\dwg\kalam\0838033\1051214-shit-plan.dgn

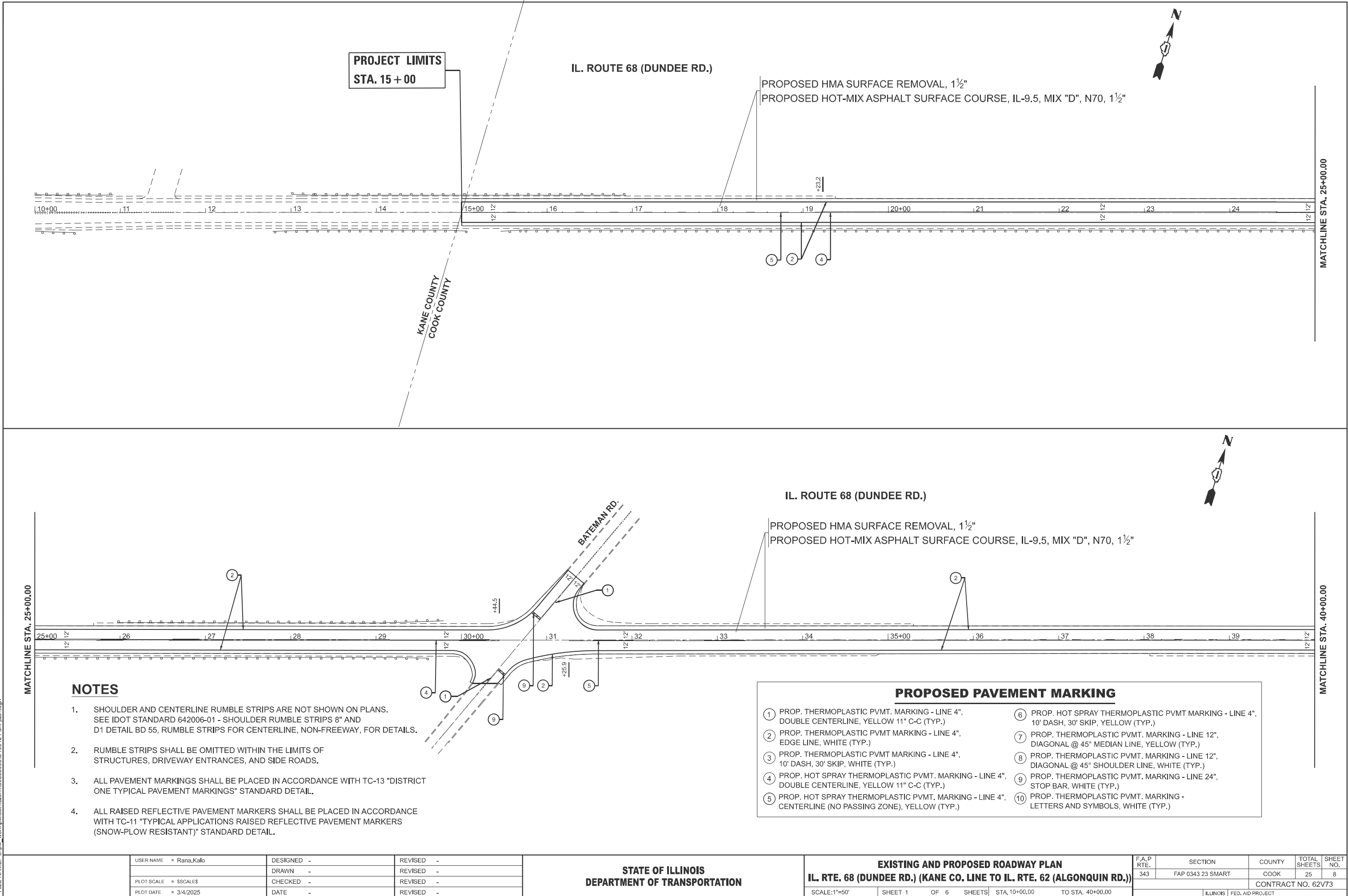

MODEL: EXCL - RdwyPlan 3
FILE NAME: c:\pwy_work\pilot\kalo\mtd0838033\1015124-shr-plan.dgn

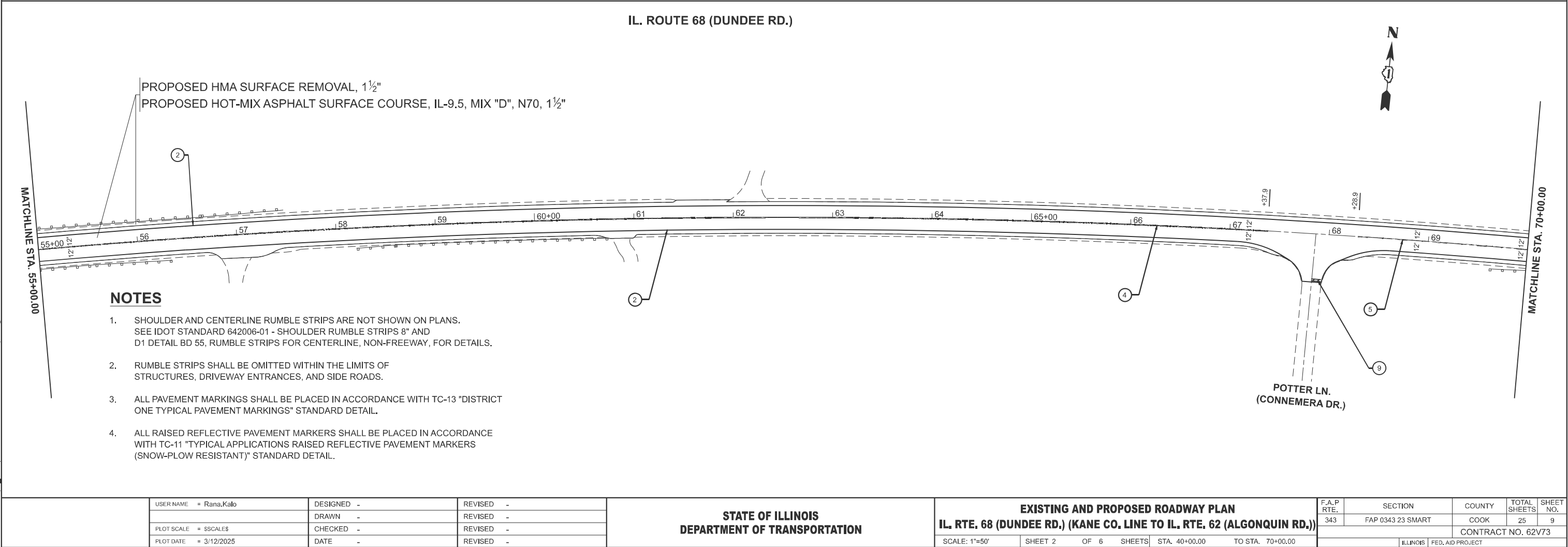
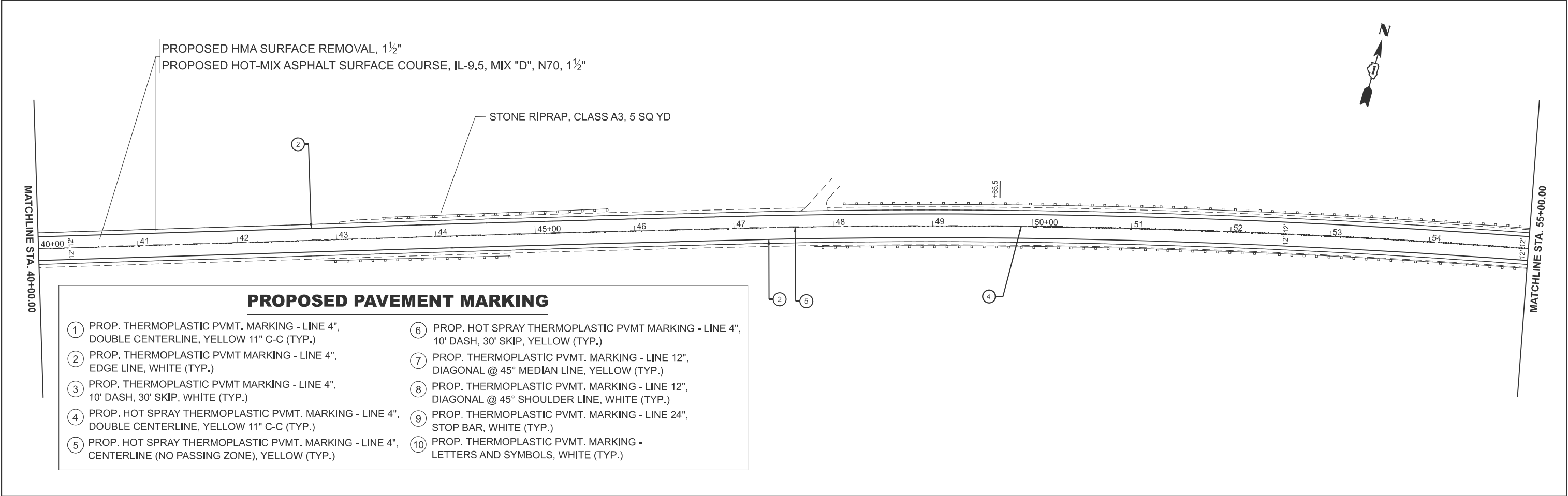

MODEL: EXCL - RdwyPlan 5
FILE NAME: c:\pwy_work\pilot\kabr\m\40838033\1015124-sh1-clan.dgn

MATCHLINE STA. 70+00.00

IL. ROUTE 68 (DUNDEE RD.)

PROPOSED HMA SURFACE REMOVAL, 1½"
PROPOSED HOT-MIX ASPHALT SURFACE COURSE, IL-9.5, MIX "D", N70, 1½"

PROPOSED PAVEMENT MARKING

- ① PROP. THERMOPLASTIC PVMT. MARKING - LINE 4", DOUBLE CENTERLINE, YELLOW 11" C-C (TYP.)

② PROP. THERMOPLASTIC PVMT MARKING - LINE 4", EDGE LINE, WHITE (TYP.)

③ PROP. THERMOPLASTIC PVMT MARKING - LINE 4", 10' DASH, 30' SKIP, WHITE (TYP.)

④ PROP. HOT SPRAY THERMOPLASTIC PVMT. MARKING - LINE 4", DOUBLE CENTERLINE, YELLOW 11" C-C (TYP.)

⑤ PROP. HOT SPRAY THERMOPLASTIC PVMT. MARKING - LINE 4", CENTERLINE (NO PASSING ZONE), YELLOW (TYP.)
- ⑥ PROP. HOT SPRAY THERMOPLASTIC PVMT MARKING - LINE 4", 10' DASH, 30' SKIP, YELLOW (TYP.)

⑦ PROP. THERMOPLASTIC PVMT. MARKING - LINE 12", DIAGONAL @ 45° MEDIAN LINE, YELLOW (TYP.)

⑧ PROP. THERMOPLASTIC PVMT. MARKING - LINE 12", DIAGONAL @ 45° SHOULDER LINE, WHITE (TYP.)

⑨ PROP. THERMOPLASTIC PVMT. MARKING - LINE 24", STOP BAR, WHITE (TYP.)

⑩ PROP. THERMOPLASTIC PVMT. MARKING - LETTERS AND SYMBOLS, WHITE (TYP.)

HEALY RD.

MATCHLINE STA. 85+00.00

IL. ROUTE 68 (DUNDEE RD.)

PROPOSED HMA SURFACE REMOVAL, 1½"
PROPOSED HOT-MIX ASPHALT SURFACE COURSE, IL-9.5, MIX "D", N70, 1½"

SPRING CREEK

MATCHLINE STA. 85+00.00

MATCHLINE STA. 100+00.00

NOTES

- SHOULDER AND CENTERLINE RUMBLE STRIPS ARE NOT SHOWN ON PLANS. SEE IDOT STANDARD 642006-01 - SHOULDER RUMBLE STRIPS 8" AND D1 DETAIL BD 55, RUMBLE STRIPS FOR CENTERLINE, NON-FREEWAY, FOR DETAILS.
- RUMBLE STRIPS SHALL BE OMITTED WITHIN THE LIMITS OF STRUCTURES, DRIVEWAY ENTRANCES, AND SIDE ROADS.
- ALL PAVEMENT MARKINGS SHALL BE PLACED IN ACCORDANCE WITH TC-13 "DISTRICT ONE TYPICAL PAVEMENT MARKINGS" STANDARD DETAIL.
- ALL RAISED REFLECTIVE PAVEMENT MARKERS SHALL BE PLACED IN ACCORDANCE WITH TC-11 "TYPICAL APPLICATIONS RAISED REFLECTIVE PAVEMENT MARKERS (SNOW-PLOW RESISTANT)" STANDARD DETAIL.

STATE OF ILLINOIS
DEPARTMENT OF TRANSPORTATION

EXISTING AND PROPOSED ROADWAY PLAN
IL. RTE. 68 (DUNDEE RD.) (KANE CO. LINE TO IL. RTE. 62 (ALGONQUIN RD.))

SCALE: 1"=50'

SHEET 3

OF 6

SHEETS

STA. 70+00.00

TO STA. 100+00.00

F.A.P RTE.	SECTION	COUNTY	TOTAL SHEETS	SHEET NO.
343	FAP 0343 23 SMART	COOK	25	10
CONTRACT NO. 62V73				
ILLINOIS FED. AID PROJECT				

MODEL: EXCL - RdwyPlan 7
FILE NAME: c:\pwy_work\pilot\kabrmd\0838033\1015124-sh-ft-plan.dgn

MATCHLINE STA. 100+00.00

PROPOSED PAVEMENT MARKING			
①	PROP. THERMOPLASTIC PVMT. MARKING - LINE 4", DOUBLE CENTERLINE, YELLOW 11" C-C (TYP.)	⑥	PROP. HOT SPRAY THERMOPLASTIC PVMT MARKING - LINE 4", 10' DASH, 30' SKIP, YELLOW (TYP.)
②	PROP. THERMOPLASTIC PVMT MARKING - LINE 4", EDGE LINE, WHITE (TYP.)	⑦	PROP. THERMOPLASTIC PVMT. MARKING - LINE 12", DIAGONAL @ 45° MEDIAN LINE, YELLOW (TYP.)
③	PROP. THERMOPLASTIC PVMT MARKING - LINE 4", 10' DASH, 30' SKIP, WHITE (TYP.)	⑧	PROP. THERMOPLASTIC PVMT. MARKING - LINE 12", DIAGONAL @ 45° SHOULDER LINE, WHITE (TYP.)
④	PROP. HOT SPRAY THERMOPLASTIC PVMT. MARKING - LINE 4", DOUBLE CENTERLINE, YELLOW 11" C-C (TYP.)	⑨	PROP. THERMOPLASTIC PVMT. MARKING - LINE 24", STOP BAR, WHITE (TYP.)
⑤	PROP. HOT SPRAY THERMOPLASTIC PVMT. MARKING - LINE 4", CENTERLINE (NO PASSING ZONE), YELLOW (TYP.)	⑩	PROP. THERMOPLASTIC PVMT. MARKING - LETTERS AND SYMBOLS, WHITE (TYP.)

IL. ROUTE 68 (DUNDEE RD.)

PROPOSED HMA SURFACE REMOVAL, 1½"
PROPOSED HOT-MIX ASPHALT SURFACE COURSE, IL-9.5, MIX "D", N70, 1½"

WOOD CREEK DR.

MATCHLINE STA. 115+00.00

IL. ROUTE 68 (DUNDEE RD.)

PROPOSED HMA SURFACE REMOVAL, 1½"
PROPOSED HOT-MIX ASPHALT SURFACE COURSE, IL-9.5, MIX "D", N70, 1½"

MATCHLINE STA. 115+00.00

MATCHLINE STA. 130+00.00

NOTES

- SHOULDER AND CENTERLINE RUMBLE STRIPS ARE NOT SHOWN ON PLANS. SEE IDOT STANDARD 642006-01 - SHOULDER RUMBLE STRIPS 8" AND D1 DETAIL BD 55, RUMBLE STRIPS FOR CENTERLINE, NON-FREEWAY, FOR DETAILS.
- RUMBLE STRIPS SHALL BE OMITTED WITHIN THE LIMITS OF STRUCTURES, DRIVEWAY ENTRANCES, AND SIDE ROADS.
- ALL PAVEMENT MARKINGS SHALL BE PLACED IN ACCORDANCE WITH TC-13 "DISTRICT ONE TYPICAL PAVEMENT MARKINGS" STANDARD DETAIL.
- ALL RAISED REFLECTIVE PAVEMENT MARKERS SHALL BE PLACED IN ACCORDANCE WITH TC-11 "TYPICAL APPLICATIONS RAISED REFLECTIVE PAVEMENT MARKERS (SNOW-PLOW RESISTANT)" STANDARD DETAIL.

USER NAME	= Rana.Kalo	DESIGNED	-	REVISED	-
		DRAWN	-	REVISED	-
PLOT SCALE	= \$\$SCALE\$	CHECKED	-	REVISED	-
PLOT DATE	= 3/12/2025	DATE	-	REVISED	-

STATE OF ILLINOIS
DEPARTMENT OF TRANSPORTATION

EXISTING AND PROPOSED ROADWAY PLAN
IL. RTE. 68 (DUNDEE RD.) (KANE CO. LINE TO IL. RTE. 62 (ALGONQUIN RD.))

SCALE: 1"=50' SHEET 4 OF 6 SHEETS STA. 100+00.00 TO STA. 130+00.00

F.A.P RTE.	SECTION	COUNTY	TOTAL SHEETS	SHEET NO.
343	FAP 0343 23 SMART	COOK	25	11
CONTRACT NO. 62V73				
ILLINOIS		FED. AID PROJECT		

NOTES

- SHOULDER AND CENTERLINE RUMBLE STRIPS ARE NOT SHOWN ON PLANS.
SEE IDOT STANDARD 642006-01 - SHOULDER RUMBLE STRIPS 8" AND
D1 DETAIL BD 55, RUMBLE STRIPS FOR CENTERLINE, NON-FREEWAY, FOR DETAILS.
- RUMBLE STRIPS SHALL BE OMITTED WITHIN THE LIMITS OF
STRUCTURES, DRIVEWAY ENTRANCES, AND SIDE ROADS.
- ALL PAVEMENT MARKINGS SHALL BE PLACED IN ACCORDANCE WITH TC-13 "DISTRICT
ONE TYPICAL PAVEMENT MARKINGS" STANDARD DETAIL.
- ALL RAISED REFLECTIVE PAVEMENT MARKERS SHALL BE PLACED IN ACCORDANCE
WITH TC-11 "TYPICAL APPLICATIONS RAISED REFLECTIVE PAVEMENT MARKERS
(SNOW-PLOW RESISTANT)" STANDARD DETAIL.

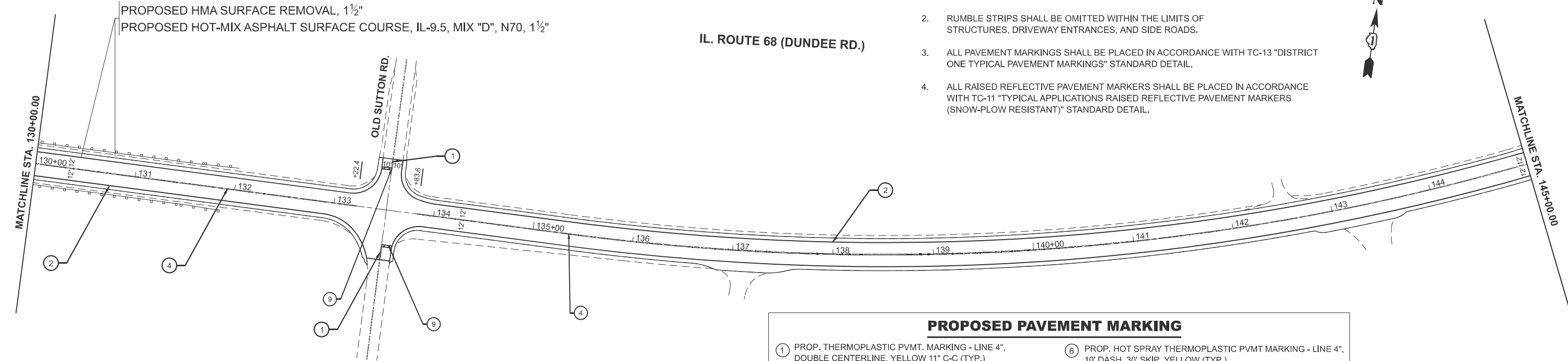

PROPOSED PAVEMENT MARKING

- | | |
|---|---|
| ① PROP. THERMOPLASTIC PVMT. MARKING - LINE 4",
DOUBLE CENTERLINE, YELLOW 11" C-C (TYP.) | ⑥ PROP. HOT SPRAY THERMOPLASTIC PVMT MARKING - LINE 4",
10' DASH, 30' SKIP, YELLOW (TYP.) |
| ② PROP. THERMOPLASTIC PVMT MARKING - LINE 4",
EDGE LINE, WHITE (TYP.) | ⑦ PROP. THERMOPLASTIC PVMT. MARKING - LINE 12",
DIAGONAL @ 45° MEDIAN LINE, YELLOW (TYP.) |
| ③ PROP. THERMOPLASTIC PVMT MARKING - LINE 4",
10' DASH, 30' SKIP, WHITE (TYP.) | ⑧ PROP. THERMOPLASTIC PVMT. MARKING - LINE 12",
DIAGONAL @ 45° SHOULDER LINE, WHITE (TYP.) |
| ④ PROP. HOT SPRAY THERMOPLASTIC PVMT. MARKING - LINE 4",
DOUBLE CENTERLINE, YELLOW 11" C-C (TYP.) | ⑨ PROP. THERMOPLASTIC PVMT. MARKING - LINE 24",
STOP BAR, WHITE (TYP.) |
| ⑤ PROP. HOT SPRAY THERMOPLASTIC PVMT. MARKING - LINE 4",
CENTERLINE (NO PASSING ZONE), YELLOW (TYP.) | ⑩ PROP. THERMOPLASTIC PVMT. MARKING -
LETTERS AND SYMBOLS, WHITE (TYP.) |

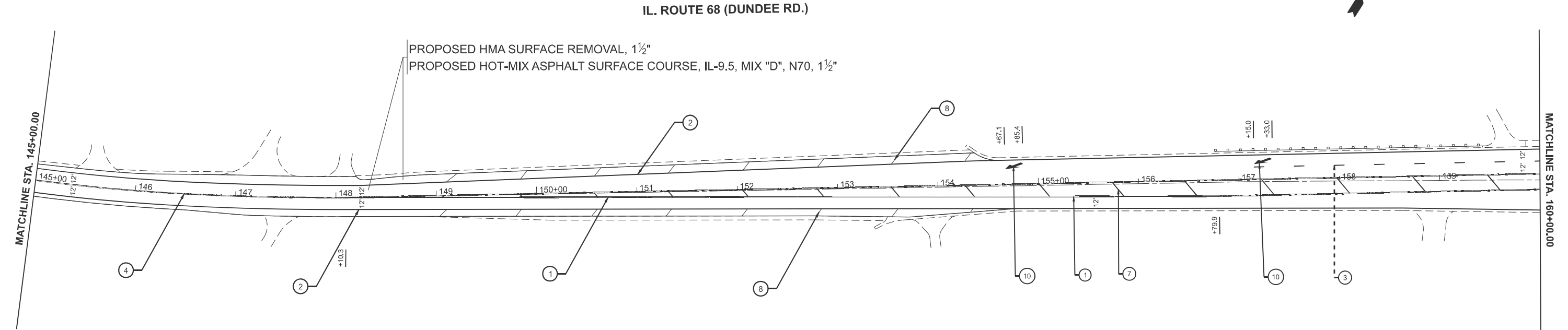

STATE OF ILLINOIS
DEPARTMENT OF TRANSPORTATION

EXISTING AND PROPOSED ROADWAY PLAN
IL. RTE. 68 (DUNDEE RD.) (KANE CO. LINE TO IL. RTE. 62 (ALGONQUIN RD.))

SCALE: 1"=50' SHEET 5 OF 6 SHEETS STA. 130+00.00 TO STA. 160+00.00

F.A.P RTE.	SECTION	COUNTY	TOTAL SHEETS	SHEET NO.
343	FAP 0343 23 SMART	COOK	25	12
CONTRACT NO. 62V73				
ILLINOIS FED. AID PROJECT				

MODEL: EXCL - RdwyPlan 9
FILE NAME: c:\pwy_work\pilot\kalbom\0838033\0105124-shr-clan.dgn

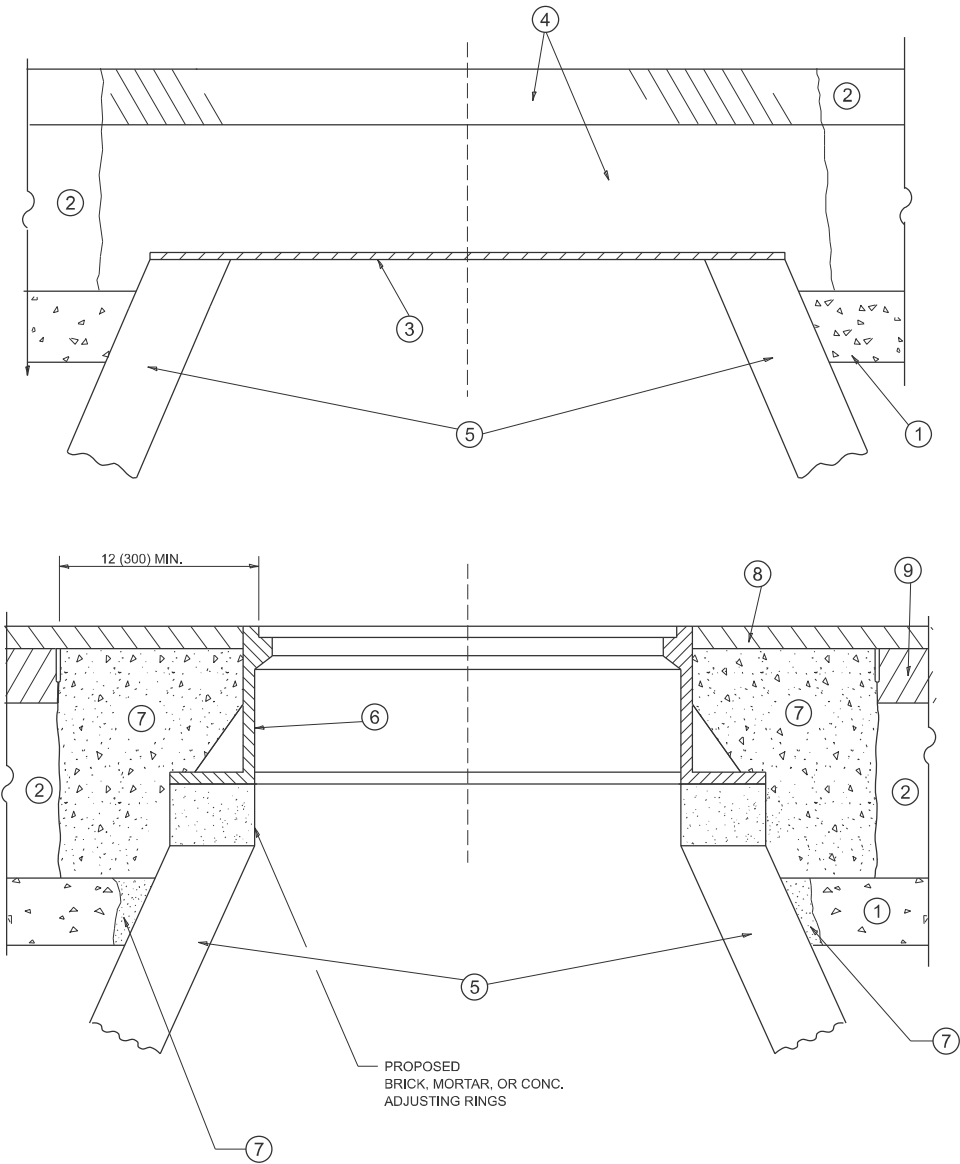

DETAILS FOR FRAMES AND LIDS ADJUSTMENT
WITH MILLING

NOTES

- EXISTING BROKEN FRAMES AND LIDS SHALL BE REMOVED AND DISPOSED OF BY THE CONTRACTOR AND SHALL BE REPLACED AS DIRECTED BY THE ENGINEER. REPLACEMENT FRAMES AND LIDS WILL BE PAID FOR IN ACCORDANCE WITH ARTICLE 109.04 OF THE STANDARD SPECIFICATIONS UNLESS A SEPARATE PAY ITEM HAS BEEN PROVIDED.
- IF THE EXISTING LIDS ARE OPEN, THE FRAME WILL BE ADJUSTED TO THE ELEVATION OF THE MILLED PAVEMENT SURFACE PRIOR TO THE MILLING OPERATION. THE FRAME WILL NOT BE REMOVED AND COVERED BY THE METAL PLATE.
- CITY OF CHICAGO CASTINGS ARE THE PROPERTY OF THE CITY AND THE CONTRACTOR SHALL NOTIFY THE CITY FOR REMOVAL AND DISPOSITION OF THE CASTINGS.
- THE METAL PLATE USED TO COVER THE STRUCTURE SHALL REMAIN THE PROPERTY OF THE CONTRACTOR.
- THE CONTRACTOR SHALL REMOVE ALL TRAFFIC CONTROL DEVICES BY THE END OF EACH WORK SHIFT.

CONSTRUCTION PROCEDURES

STAGE 1 (BEFORE PAVEMENT MILLING)

- REMOVE A MINIMUM OF 12 (300) OF THE PAVEMENT FROM AROUND THE STRUCTURE.
- REMOVE THE EXISTING FRAME AND LID FROM THE STRUCTURE.
- COVER THE STRUCTURE OPENING WITH A 36 (900) DIAMETER METAL PLATE.
- BACKFILL WITH CRUSHED STONE AND HMA SURFACE MIX APPROVED BY THE ENGINEER. (MIN. 3 (80) HMA TO REMAIN AFTER MILLING).

STAGE 2 (AFTER PAVEMENT MILLING)

- REMOVE THE HMA SURFACE MIX AND CRUSHED STONE.
- INSTALL THE FRAME AND LID; ADJUST THE FRAME TO ITS FINAL SURFACE ELEVATION.
- THE SURROUNDING SPACE SHALL BE FILLED WITH CLASS PP-2* CONCRETE TO THE ELEVATION OF THE SURFACE OF THE EXISTING BASE COURSE OR THE BINDER COURSE.

*UNLESS OTHERWISE SPECIFIED IN THE PLANS.

THE PROCEDURE EXPLAINED ABOVE SHALL CONFORM TO THE APPLICABLE PORTIONS OF SECTIONS 353, 406, 602, AND 603 OF THE STANDARD SPECIFICATIONS EXCEPT THAT "THE CONTRACTOR SHALL ADJUST THE STRUCTURES TO THE FINISHED PAVEMENT ELEVATION NO MORE THAN 5 CALENDAR DAYS PRIOR TO PLACEMENT OF THE FINAL LIFT OF SURFACE UNLESS APPROVED BY THE ENGINEER."

LEGEND

- | | |
|--|-------------------------------|
| 1 SUB-BASE GRANULAR MATERIAL | 6 FRAME AND LID (SEE NOTES) |
| 2 EXISTING PAVEMENT | 7 CLASS PP-2* CONCRETE |
| 3 36 (900) DIAMETER METAL PLATE | 8 PROPOSED HMA SURFACE COURSE |
| 4 PROPOSED CRUSHED STONE AND HMA SURFACE MIX | 9 PROPOSED HMA BINDER COURSE |
| 5 EXISTING STRUCTURE | |

LOCATION OF STRUCTURES

THE CONTRACTOR WILL BE REQUIRED TO KEEP A RECORD OF THE LOCATIONS OF THE BURIED STRUCTURES ACCORDING TO THE STATION AND DISTANCE LEFT OR RIGHT OF THE CENTERLINE OF PAVEMENT. UPON COMPLETION OF THE WORK, THE CONTRACTOR WILL DELIVER THE RECORD TO THE ENGINEER.

BASIS OF PAYMENT

- REMOVING FRAMES AND LIDS ON DRAINAGE AND UTILITY STRUCTURES IN THE PAVEMENT PRIOR TO MILLING, AND ADJUSTING TO FINAL GRADE PRIOR TO PLACING THE SURFACE COURSE, WILL BE PAID FOR AT THE CONTRACT UNIT PRICE EACH FOR "FRAMES AND LIDS TO BE ADJUSTED (SPECIAL)."
- THIS WORK WILL NOT BE PAID FOR WHEN DRAINAGE AND UTILITY STRUCTURES ARE SPECIFIED FOR PAYMENT AS STRUCTURE RECONSTRUCTION.
- NEW FRAMES AND LIDS, WHEN SPECIFIED, WILL BE PAID FOR SEPARATELY.
- WHEN STRUCTURES ARE TO BE ADJUSTED OR RECONSTRUCTED, THE LOWERING AND RAISING OF THE FRAMES AND LIDS WILL NOT BE PAID FOR SEPARATELY BUT WILL BE INCLUDED IN THE COST OF THE CORRESPONDING PAY ITEM.

ALL DIMENSIONS ARE IN INCHES (MILLIMETERS) UNLESS OTHERWISE SHOWN

STATE OF ILLINOIS
DEPARTMENT OF TRANSPORTATION

DETAILS FOR
FRAMES AND LIDS ADJUSTMENT WITH MILLING

SCALE: NONE SHEET 1 OF 1 SHEETS STA. TO STA.

F.A.P RTE.	SECTION	COUNTY	TOTAL SHEETS	SHEET NO.
343	FAP 0343 23 SMART	COOK	25	14
BD600-03 (BD-08)		CONTRACT NO. 62V73		
ILLINOIS		FED. AID PROJECT		

METHOD OF MEASUREMENT

REFER TO SECTION 442 OF THE STANDARD SPECIFICATIONS FOR ROAD AND BRIDGE CONSTRUCTION AND THE RECURRING SPECIAL PROVISION "PATCHING WITH HOT-MIX ASPHALT OVERLAY REMOVAL."

BASIS OF PAYMENT

- 1. REFER TO SECTION 442 OF THE STANDARD SPECIFICATIONS FOR ROAD AND BRIDGE CONSTRUCTION AND THE RECURRING SPECIAL PROVISION "PATCHING WITH HOT-MIX ASPHALT OVERLAY REMOVAL."
- 2. SAW CUT/SCORING OF EXISTING HMA OVERLAY IS INCLUDED IN THE COST OF PAVEMENT PATCHING.
- 3. SAW CUT/SCORING OF EXISTING PAVEMENT IS INCLUDED IN THE COST OF PAVEMENT PATCHING.

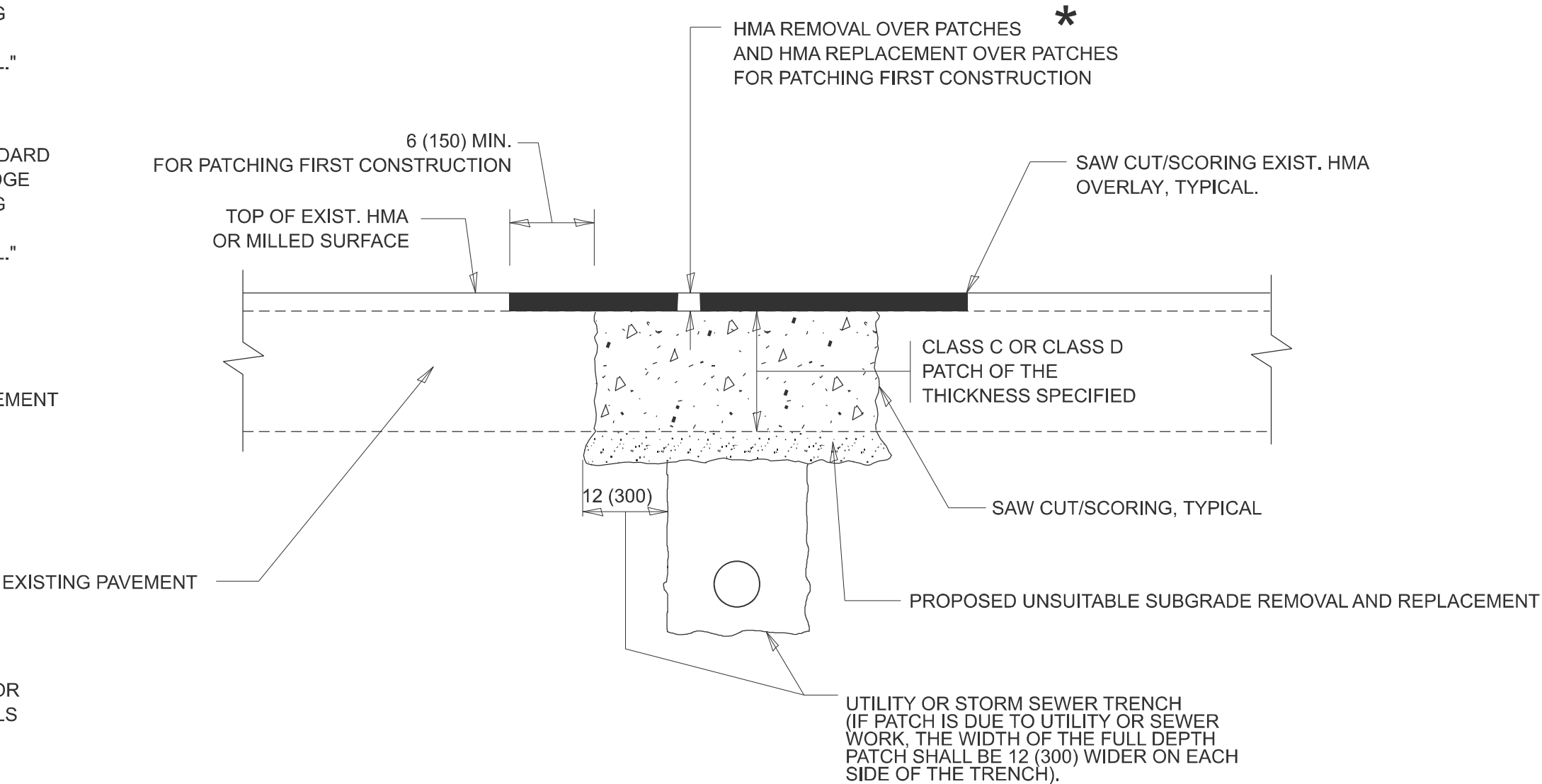

* SEE TYPICAL SECTIONS FOR THICKNESS AND MATERIALS

SEQUENCE OF CONSTRUCTION (PATCHING FIRST)

- 1. REMOVE THE EXISTING HMA MATERIAL OVER THE AREA TO BE PATCHED.
- 2. REMOVE AND REPLACE WITH CLASS C OR D PATCH.
- 3. REPLACE HMA MATERIAL OVER THE AREA TO BE PATCHED.

SEQUENCE OF CONSTRUCTION (MILLING FIRST)

- 1. MILL HMA FIRST IF THERE IS AT LEAST 4 1/2 INCHES OR MORE OF HMA MATERIAL ON TOP OF THE EXISTING PAVEMENT OR IF THE PAVEMENT IS FULL DEPTH HMA. A MINIMUM OF 2 INCHES OF HMA MATERIAL SHALL BE IN PLACE AFTER MILLING.
- 2. REMOVE AND REPLACE WITH FULL DEPTH CLASS D PATCHES TO TOP OF MILLED SURFACE.

ALL DIMENSIONS ARE IN INCHES (MILLIMETERS) UNLESS OTHERWISE SHOWN.

MODEL: BD22 (Sheet)
FILE NAME: c:\p\work\illinois.gov_hanan.alghizi\00638033\0105124-shh-DistSigs.dgn

	USER NAME = Hanan,Alghizi	DESIGNED - R. SHAH	REVISED - R. BORO 01-01-07	STATE OF ILLINOIS DEPARTMENT OF TRANSPORTATION	PAVEMENT PATCHING FOR HMA SURFACED PAVEMENT				F.A.P RTE.	SECTION	COUNTY	TOTAL SHEETS	SHEET NO.
		DRAWN -	REVISED - R. BORO 09-04-07						343	FAP 0343 23 SMART	COOK	25	15
		CHECKED -	REVISED - K. ENG 10-27-08						BD400-04 (BD-22) CONTRACT NO. 62V73				
	PLOT DATE = 1/10/2025	DATE - 10-25-94	REVISED - K. SMITH 11-18-22		ILLINOIS FED. AID PROJECT								
						SCALE: NONE	SHEET 1	OF 1	SHEETS	STA.	TO STA.		

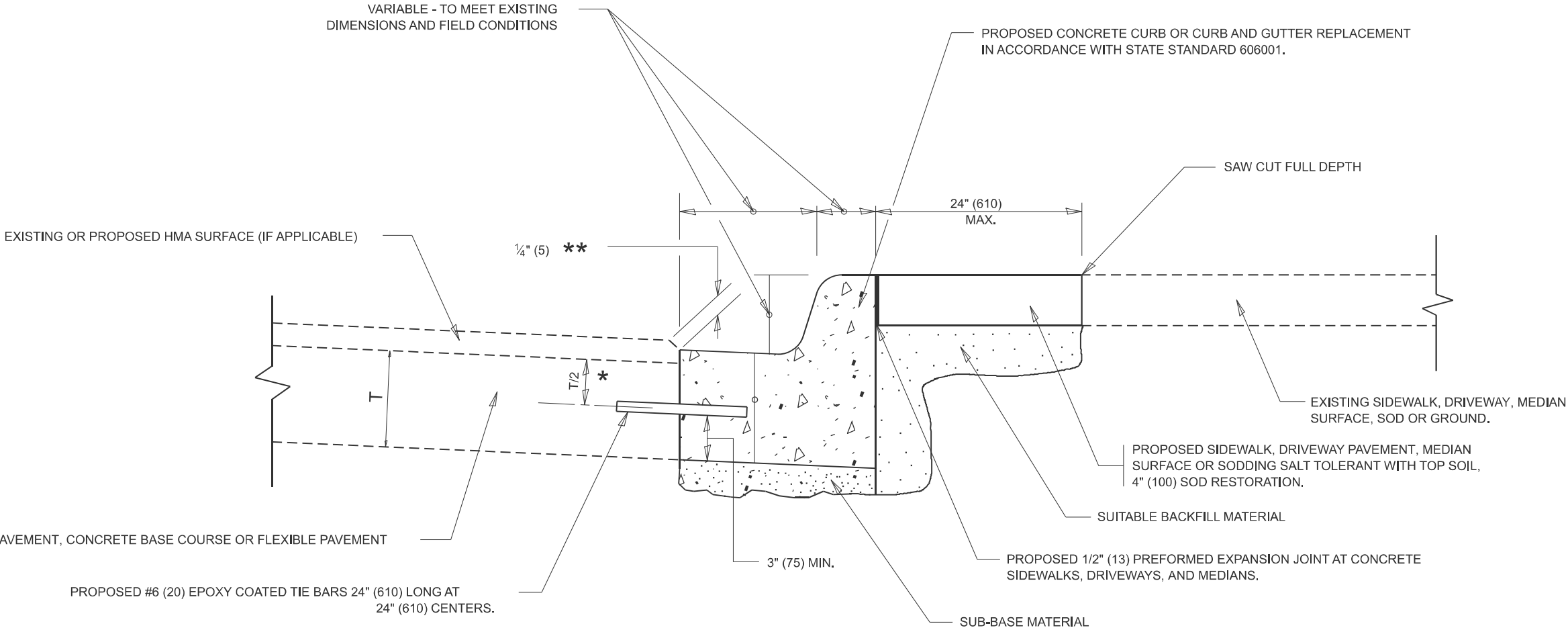

- * 3" (75) MINIMUM FROM TOP AND BOTTOM OF THE CONCRETE PAVEMENT OR BASE COURSE.
- ** IF THE FINAL SURFACE OF THE PAVEMENT IS CONCRETE, THE GUTTER IS TO BE FLUSH WITH THE PAVEMENT.

CURB OR CURB AND GUTTER REMOVAL AND REPLACEMENT

ALL DIMENSIONS ARE IN INCHES (MILLIMETERS)
UNLESS OTHERWISE SHOWN.

MODEL: BD-24 [Sheet]
FILE NAME: c:\p\work\illinois.gov_hanan.alghizi\illinois.gov\0063803\0105124-sh+Dist\Std.dgn

	USER NAME = Hanan.Alghizi	DESIGNED - A. HOUSEH	REVISED - A. ABBAS 03-21-97	STATE OF ILLINOIS DEPARTMENT OF TRANSPORTATION	CURB OR CURB AND GUTTER REMOVAL AND REPLACEMENT			F.A.P RTE.	SECTION	COUNTY	TOTAL SHEETS	SHEET NO.
		DRAWN -	REVISED - M. GOMEZ 01-22-01					343	FAP 0343 23 SMART	COOK	25	16
		CHECKED -	REVISED - R. BORO 12-15-09		BD600-06 (BD-24)			CONTRACT NO. 62V73				
	PLOT DATE = 1/10/2025	DATE - 03-11-94	REVISED - K. SMITH 07-11-19		SCALE: NONE	SHEET 1	OF 1 SHEETS	STA.	TO STA.	ILLINOIS FED. AID PROJECT		

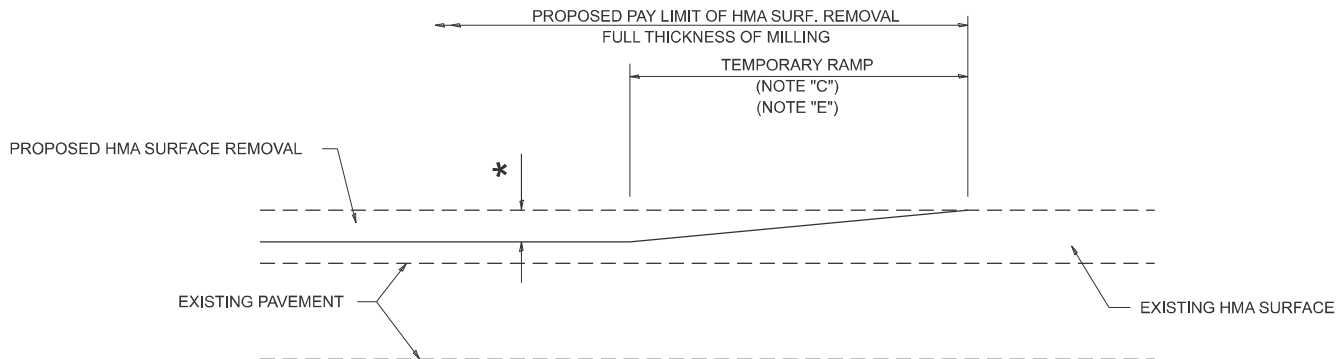

MILLED TEMPORARY RAMP
(FOR BUTT JOINT AND HMA TAPER SEE DETAIL BELOW)

OPTION 1

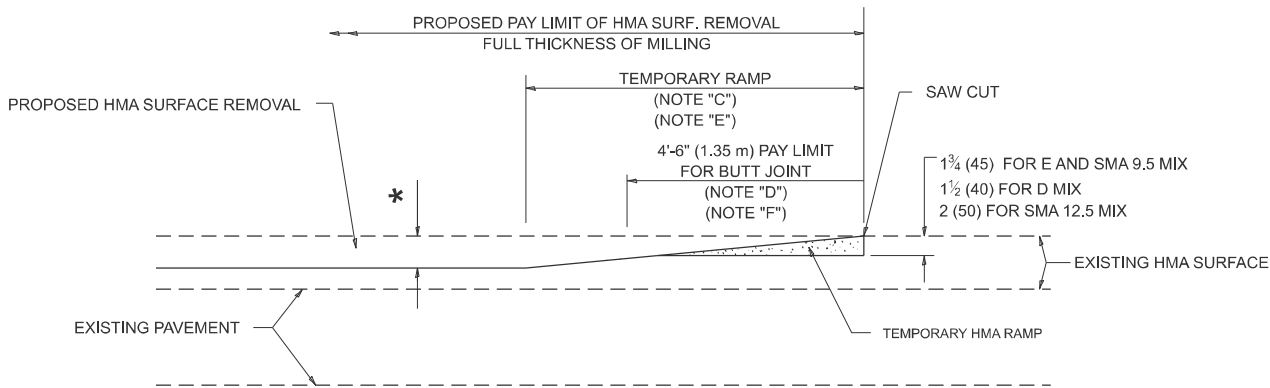

HMA CONSTRUCTED TEMPORARY RAMP
(FOR BUTT JOINT AND HMA TAPER SEE DETAIL BELOW)

OPTION 2

TYPICAL TEMPORARY RAMP

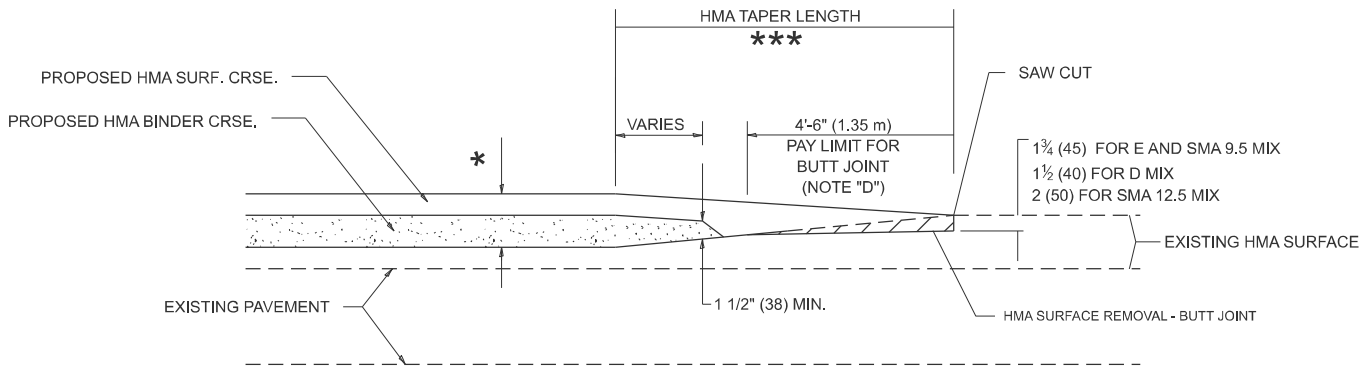

**BUTT JOINT AND
HMA TAPER**

**TYPICAL BUTT JOINT AND HMA TAPER
FOR MILLING AND RESURFACING**

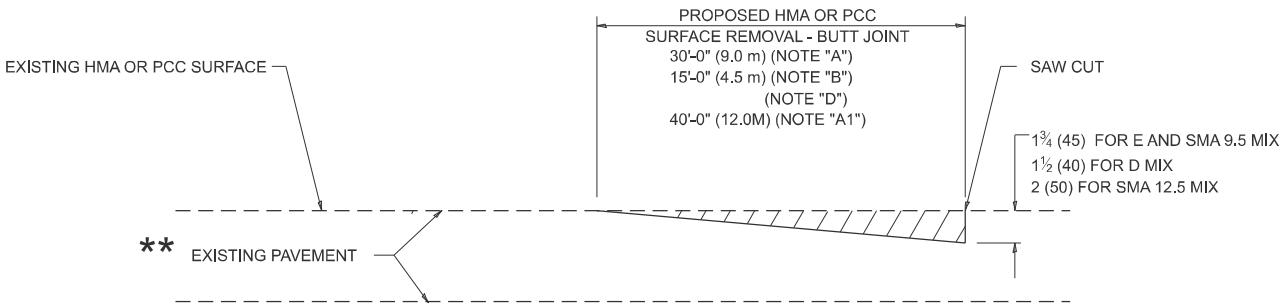

BUTT JOINT DETAIL

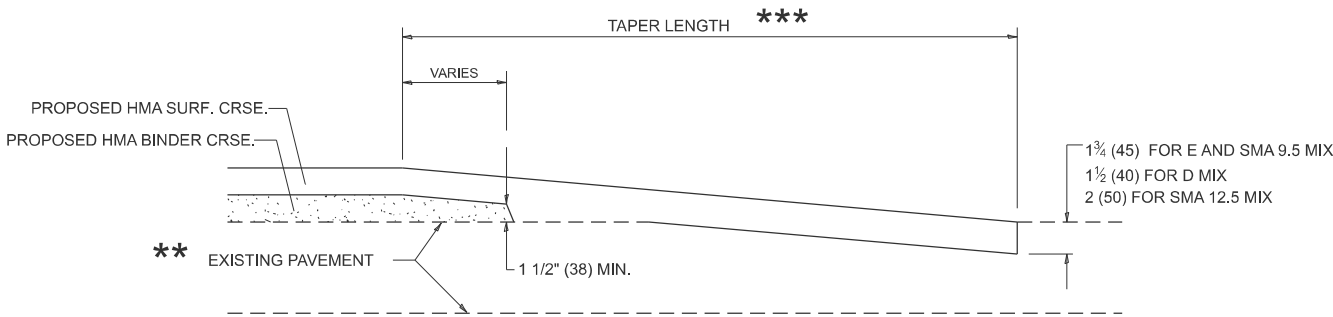

HMA TAPER DETAIL

**TYPICAL BUTT JOINT AND HMA TAPER
FOR RESURFACING ONLY**

****** PC CONCRETE, HMA OR HMA RESURFACED PAVEMENT.

GENERAL NOTES

- A. MAINLINE ARTERIAL ROADWAYS AND MAJOR SIDE ROADS.
- A1. INTERSTATES
- B. MINOR SIDE ROADS.
- C. THE TEMP. RAMP SHALL BE CONSTRUCTED IMMEDIATELY UPON REMOVAL OF THE EXISTING HMA SURFACE.
- D. THE BUTT JOINT SHALL BE CONSTRUCTED IMMEDIATELY PRIOR TO PLACING THE PROPOSED HMA COURSES.
- E. TAPER THE TEMP. RAMP AT A RATE OF 3' - 4" (1.02m) PER 1 INCH (25 mm) OF MILLING THICKNESS.
***** SEE TYPICAL SECTIONS FOR MILLING THICKNESS.
- F. SEE ARTICLE 406.08 AND 406.14 OF THE STANDARD SPECIFICATIONS FOR "HMA AND/OR PCC SURFACE REMOVAL, BUTT JOINT".

20'-0" (6.1 m) PER 1 (25) RESURFACING (NOTE "A")
10'-0" (3.0 m) PER 1 (25) RESURFACING (NOTE "B")

BASIS OF PAYMENT

- 1. THE BUTT JOINT WILL BE PAID FOR AT THE CONTRACT UNIT PRICE PER SQUARE YARD (SQUARE METER) FOR "HOT-MIX ASPHALT SURFACE REMOVAL - BUTT JOINT" OR FOR "PORTLAND CEMENT CONCRETE SURFACE REMOVAL- BUTT JOINT".
- 2. THE TEMPORARY RAMP AND SAW CUT SHALL BE INCLUDED IN THE UNIT COST FOR HMA OR PCC SURFACE REMOVAL-BUTT JOINT.

ALL DIMENSIONS ARE IN INCHES (MILLIMETERS) UNLESS OTHERWISE SHOWN.

MODEL: BD32 (Sheet)
FILE NAME: c:\p\work\pwrtd\illinois.gov_hanan.alghizi\00638033\0105124-shr-HDistSigs.dgn

USER NAME = Hanan.Alghizi	DESIGNED - M. DE YONG	REVISED - A. ABBAS 03-21-97
	DRAWN - M. GOMEZ 04-06-01	REVISED - R. BORO 01-01-07
	CHECKED -	REVISED - K. SMITH 11-18-22
PLOT DATE = 1/10/2025	DATE - 06-13-90	

STATE OF ILLINOIS
DEPARTMENT OF TRANSPORTATION

BUTT JOINT AND
HMA TAPER DETAILS

SCALE: NONE SHEET 1 OF 1 SHEETS STA. TO STA.

F.A.P RTE.	SECTION	COUNTY	TOTAL SHEETS	SHEET NO.
343	FAP 0343 23 SMART	COOK	25	17
BD400-05 BD-32		CONTRACT NO. 63V73		
ILLINOIS		FED. AID PROJECT		

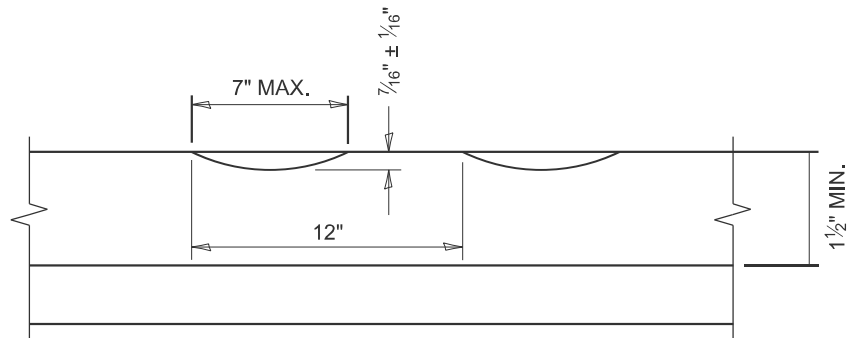

SECTION A-A

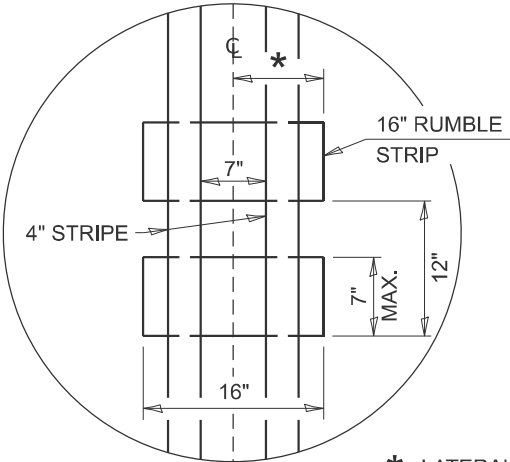

* LATERAL DEVIATION SHALL NOT EXCEED ONE INCH IN 100 FEET.

DETAIL B

GENERAL NOTES

- CENTERLINE RUMBLE STRIPS SHALL BE CONSTRUCTED ACCORDING TO SECTION 642 ALONG THE CENTERLINE OF PAVEMENT.
- SEE STANDARD 780001 FOR OTHER STRIPING LAYOUTS.
- RUMBLE STRIPS SHALL NOT BE PLACED ON BRIDGES.
- ALL RUMBLE STRIPS SHALL BE MILLED.
- CENTERLINE RUMBLE STRIPS SHALL BE CONTINUOUS THROUGH CONNECTIONS OF SIDEROADS WITH NO LEFT TURN LANES.
- DISCONTINUE CENTERLINE RUMBLE STRIPS THROUGH THE LIMITS OF ALL LEFT TURN LANES, INCLUDING ANY LANE TAPER SECTIONS.
- AFTER RUMBLE STRIPS ARE INSTALLED, THE PAVEMENT SURFACE SHALL BE SWEEPED CLEAN PRIOR TO THE PLACEMENT OF THE NEW PAVEMENT MARKINGS.
- WHERE USED, ADJUST SPACING OF RAISED REFLECTIVE PAVEMENT MARKERS TO FALL IN WIDER GAP BETWEEN RUMBLE STRIPS.

BASIS OF PAYMENT

- THIS WORK WILL BE PAID FOR AT THE CONTRACT UNIT PRICE PER FOOT FOR CENTERLINE-RUMBLE STRIP OF THE WIDTH SPECIFIED.
- HOT-SPRAY THERMOPLASTIC PAVEMENT MARKING WILL BE USED OVER THE RUMBLE STRIPS, AND WILL BE PAID FOR SEPARATELY.

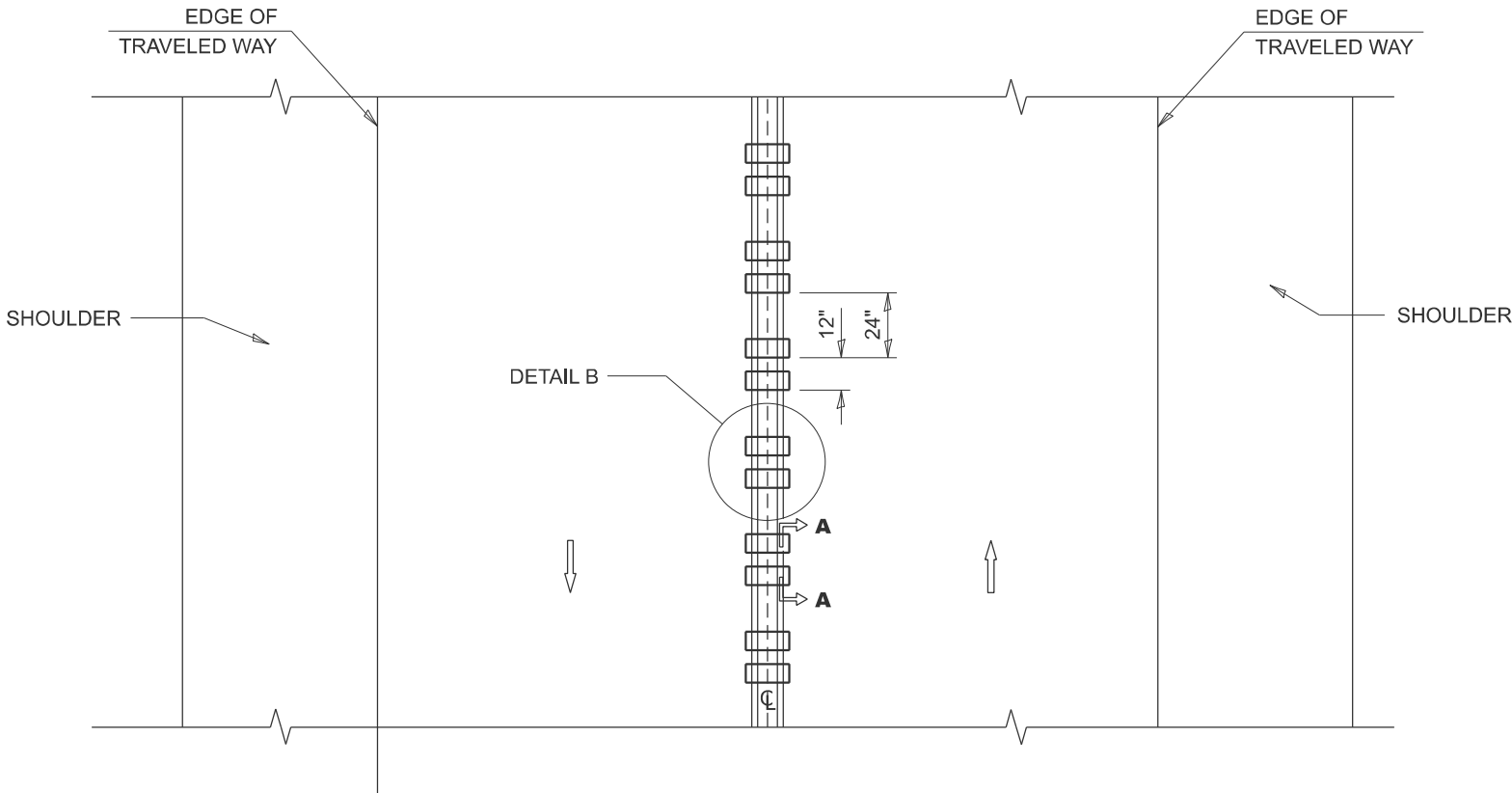

TWO-WAY ROAD

MODEL: BD55 [Sheet]
FILE NAME: c:\p\work\pwrtd\illinois.gov_hanan.alghizi\illinois.gov\0063803\0105124-shr-dist\stas.dgn

USER NAME = Hanan.Alghizi	DESIGNED - R. BORO	REVISED - K. SMITH 11-18-22
	DRAWN -	REVISED -
	CHECKED -	REVISED -
PLOT DATE = 1/10/2025	DATE - 08-06-2012	REVISED -

STATE OF ILLINOIS
DEPARTMENT OF TRANSPORTATION

RUMBLE STRIPS FOR CENTERLINE, NON-FREEWAY

SCALE: NONE SHEET 1 OF 1 SHEETS STA. TO STA.

F.A.P RTE.	SECTION	COUNTY	TOTAL SHEETS	SHEET NO.
343	FAP 0343 23 SMART	COOK	25	18
BD 55		CONTRACT NO. 62V73		
ILLINOIS		FED. AID PROJECT		

MODEL: TC10 (Sheet)
FILE NAME: c:\p\work\pwt\illinois.gov_hanan.alghizi\illinois.gov\00638033\0105124-sh1+DistStd.dgn

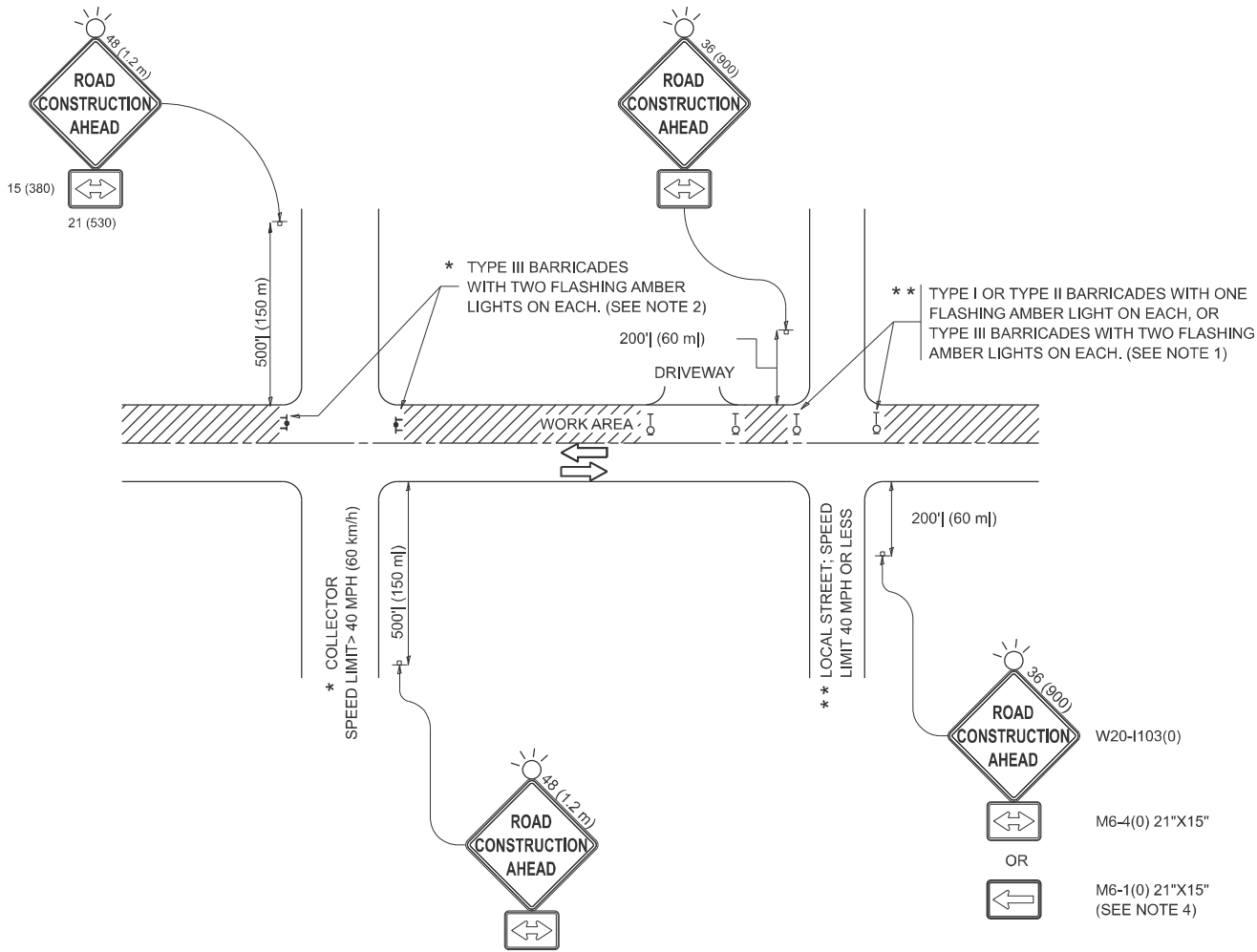

NOTES:

- SIDE ROAD WITH A SPEED LIMIT OF 40 MPH (60 km/h) OR LESS AS SHOWN ON THE DRAWING AND AS DIRECTED BY THE ENGINEER:
 - ONE "ROAD CONSTRUCTION AHEAD" SIGN 36 x 36 (900x900) WITH A FLASHER MOUNTED ON IT APPROXIMATELY 200' (60 m) IN ADVANCE OF THE MAIN ROUTE.
 - THE CLOSED PORTION OF THE MAIN ROUTE SHALL BE PROTECTED BY BLOCKING WITH TYPE I, TYPE II OR TYPE III BARRICADES, 1/3 OF THE CROSS SECTION OF THE CLOSED PORTION.
- SIDE ROAD WITH A SPEED LIMIT GREATER THAN 40 MPH (60 km/h) AS SHOWN ON THE DRAWING AND AS DIRECTED BY THE ENGINEER:
 - ONE "ROAD CONSTRUCTION AHEAD" SIGN 48 x 48 (1.2 m x 1.2 m) WITH A FLASHER MOUNTED ON IT APPROXIMATELY 500' (150 m) IN ADVANCE OF THE MAIN ROUTE.
 - THE CLOSED PORTION OF THE MAIN ROUTE SHALL BE PROTECTED BY BLOCKING WITH TYPE III BARRICADES, 1/2 OF THE CROSS SECTION OF THE CLOSED PORTION.
- CONES MAY BE SUBSTITUTED FOR BARRICADES OR DRUMS AT HALF THE SPACING DURING DAY OPERATIONS. CONES SHALL BE A MINIMUM OF 28 (710) IN HEIGHT.
- WHEN THE SIDE ROAD LIES BETWEEN THE BEGINNING OF THE MAINLINE SIGNING AND THE WORK ZONE, A SINGLE HEADED ARROW (M6-1) SHALL BE USED IN LIEU OF THE DOUBLE HEADED ARROW (M6-4).
- WHEN WORK IS BEING PERFORMED ON A SIDE ROAD OR DRIVEWAY, FOLLOW THE APPLICABLE STANDARD(S). THE DIRECTIONAL ARROW (M6-1 OR M6-4) SHALL BE COVERED OR REMOVED WHEN NO LONGER CONSISTENT WITH THE TRAFFIC CONTROL SET-UP.
- ADVANCE WARNING SIGNS ARE TO BE OMITTED ON DRIVEWAYS UNLESS OTHERWISE SPECIFIED IN THE PLANS OR BY THE ENGINEER.
- THE TRAFFIC CONTROL AND PROTECTION FOR SIDE ROADS, INTERSECTIONS, AND DRIVEWAYS SHALL BE INCLUDED IN THE COST OF SPECIFIED TRAFFIC CONTROL STANDARDS OR ITEMS.

All dimensions are in inches (millimeters)
unless otherwise shown.

	USER NAME = Hanan.Alghizi	DESIGNED - L.H.A.	REVISED - T. RAMMACHER 01-06-00	STATE OF ILLINOIS DEPARTMENT OF TRANSPORTATION	TRAFFIC CONTROL AND PROTECTION FOR SIDE ROADS, INTERSECTIONS, AND DRIVEWAYS				F.A.P RTE.	SECTION		COUNTY	TOTAL SHEETS	SHEET NO.
		DRAWN -	REVISED - A. SCHUETZE 07-01-13						343	FAP 0343 23 SMART		COOK	25	19
		CHECKED -	REVISED - A. SCHUETZE 09-15-06						TC-10		CONTRACT NO. 62V73			
	PLOT DATE = 1/10/2025	DATE - 06-89	REVISED - D. SENDERAK 05-03-24		SCALE:		SHEET	OF	SHEETS	STA.	TO STA.			
							ILLINOIS FED. AID PROJECT							

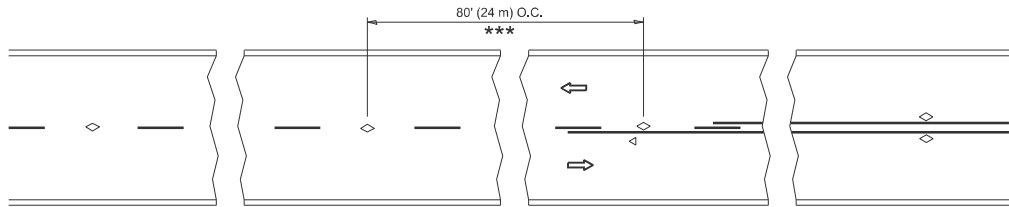

*** REDUCE TO 40' (12 m) O.C. ON CURVES WITH POSTED OR ADVISORY SPEED 45 M.P.H. (70 km/h) OR LESS.

TWO-LANE/TWO-WAY

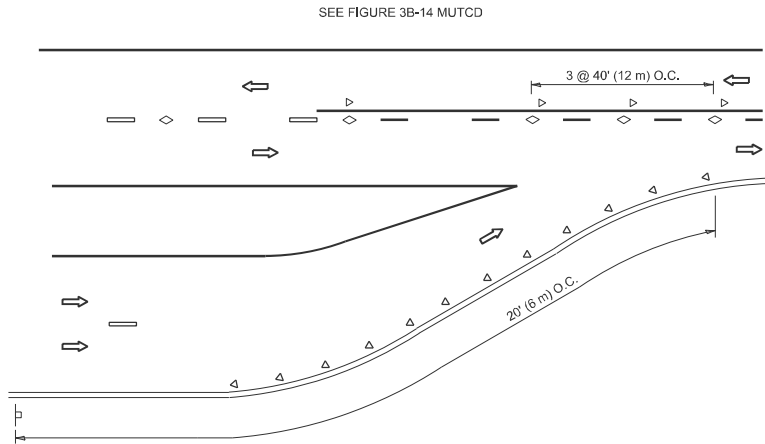

LANE REDUCTION TRANSITION

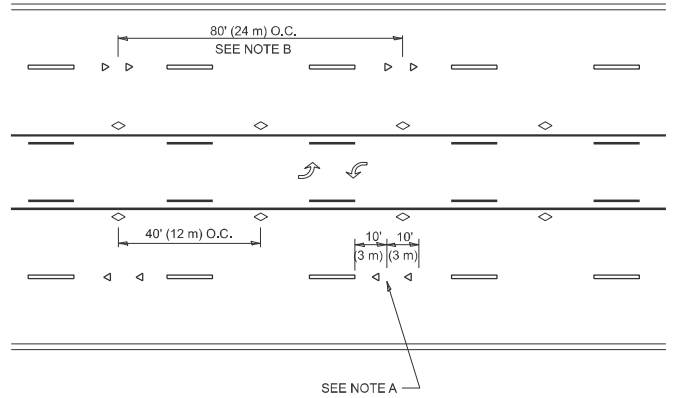

TWO-WAY LEFT TURN

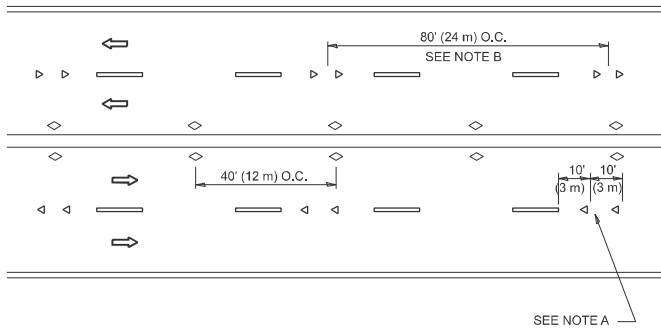

MULTI-LANE/UNDIVIDED

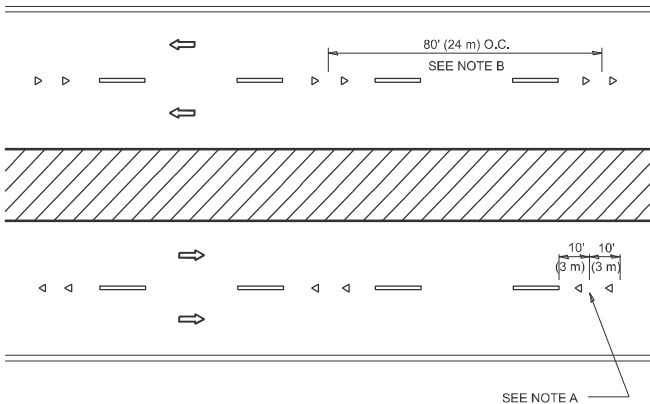

MULTI-LANE/DIVIDED

GENERAL NOTES

- MARKERS USED WITH DASHED LINES SHALL BE CENTERED IN THE GAP BETWEEN SEGMENTS.
- MARKERS USED ADJACENT TO SOLID LINES SHALL BE OFFSET 2 TO 3 (50 TO 75) TOWARD TRAFFIC AS SHOWN.
- MARKERS THROUGH TANGENTS LESS THAN 500' (150 m) IN LENGTH BETWEEN CURVES SHALL BE INSTALLED AT THE LESSER OF THE TWO CURVE SPACINGS.
- MARKERS ARE TO BE USED ADJACENT TO BOTH SOLID WHITE LINES IN DUAL LEFT TURN LANES

SYMBOLS

- YELLOW STRIPE
- WHITE STRIPE
- ONE-WAY AMBER MARKER
- ONE-WAY CRYSTAL MARKER (W/O)
- TWO-WAY AMBER MARKER

LANE MARKER NOTES

- USE DOUBLE LANE LINE MARKERS SPACED AS SHOWN.
- REDUCE TO 40' (12 m) O.C. ON CURVES WHERE ADVISORY SPEEDS ARE 10 M.P.H (20 km/h) LOWER THAN POSTED SPEEDS.

DESIGN NOTES

- DOUBLE LANE LINE MARKERS SHALL BE USED UNLESS SPECIFIED OTHERWISE.
- EXCEPT AS SHOWN ON THE LANE REDUCTION TRANSITION AND FREEWAY EXIT RAMP DETAIL, MARKERS ARE NOT TO BE SPECIFIED ON RIGHT EDGE LINES.
- THE EXACT MARKER LIMITS, SPACING, AND COLOR SHALL BE INCLUDED IN THE PLANS WHEN STANDARD SPECIFICATIONS ARE NOT BEING USED.
- MARKERS SHOULD NOT BE USED ALONGSIDE CURBS EXCEPT FOR EXTREMELY SHORT SECTIONS OF CURBS WHERE NOT MORE THAN TWO MARKERS WOULD BE INVOLVED.

All dimensions are in inches (millimeters) unless otherwise shown.

TURN LANES

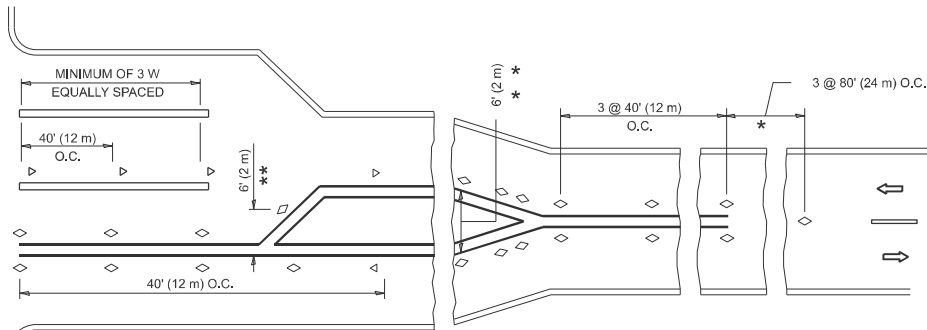
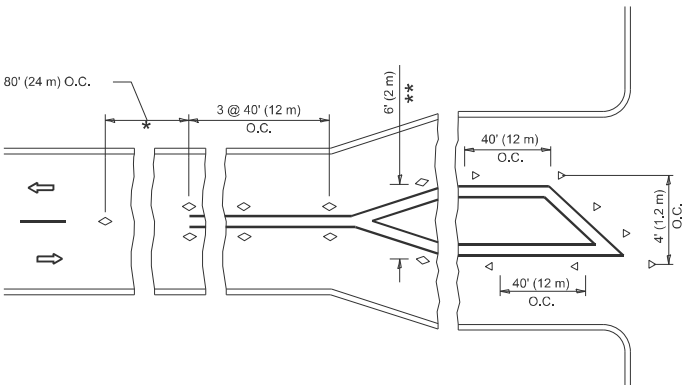

- * SEE TWO-LANE/TWO-WAY WHERE MARKERS CONTINUE
- ** WHERE THE MEDIAN WIDTH IS 6' (2 m) OR LESS USE TWO-WAY MARKERS.

STATE OF ILLINOIS
DEPARTMENT OF TRANSPORTATION

TYPICAL APPLICATIONS
RAISED REFLECTIVE PAVEMENT MARKERS (SNOW-PLOW RESISTANT)

SCALE: NONE SHEET 1 OF 1 SHEETS STA. TO STA.

F.A.P. RTE.	SECTION	COUNTY	TOTAL SHEETS	SHEET NO.
343	FAP 0343 23 SMART	COOK	25	20
TC-11		CONTRACT NO. 62V73		
ILLINOIS		FED. AID PROJECT		

MODEL: TC-13 (Sheet)
FILE NAME: c:\p\work\illinois.gov\00638033\0105124-shp-DistStd.sgm

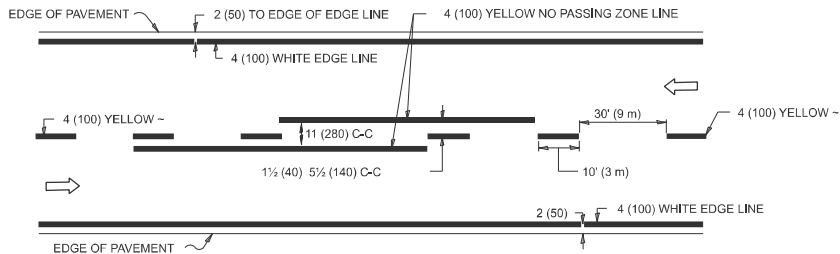

2-LANE ROADWAY

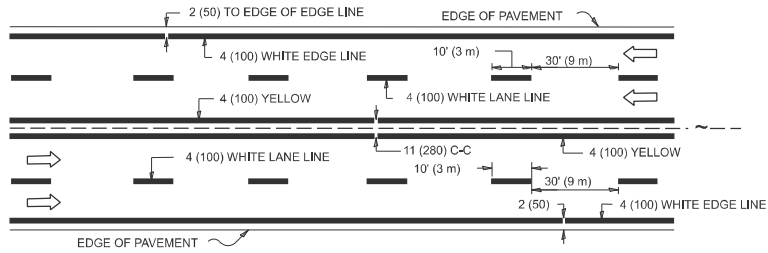

MULTI-LANE UNDIVIDED

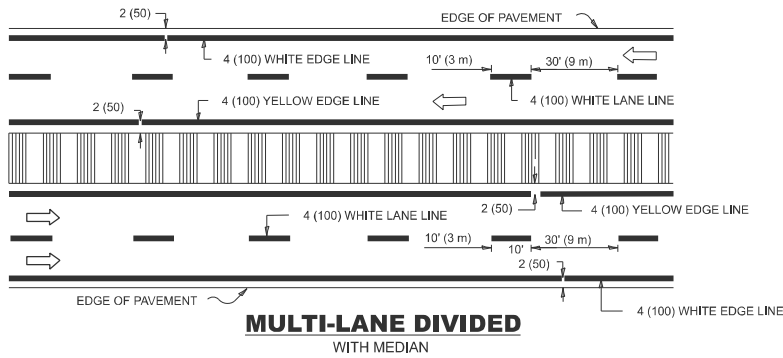

TYPICAL LANE AND EDGE LINE MARKING

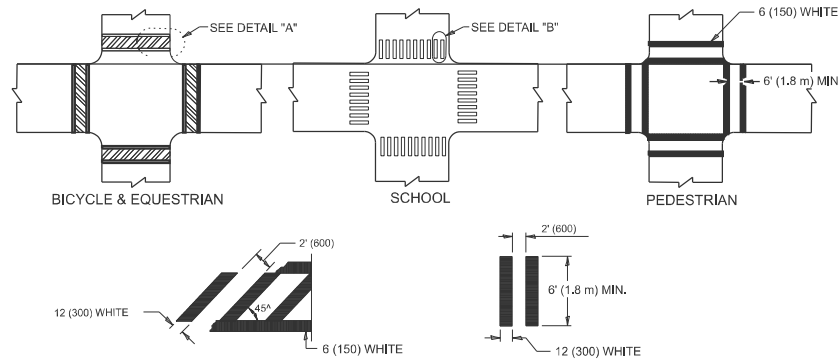

DETAIL "A"

DETAIL "B"

TYPICAL CROSSWALK MARKING

* MARKINGS SHALL BE INSTALLED PARALLEL TO THE CENTERLINE OF THE ROAD WHICH IT CROSSES

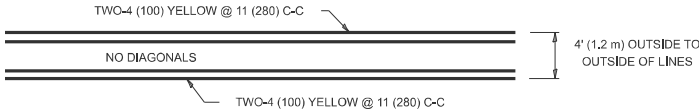

4' (1.2 m) WIDE MEDIANS ONLY

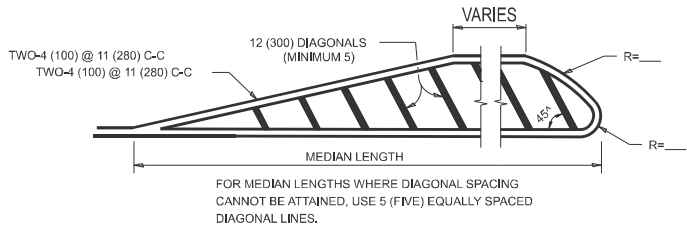

DIAGONAL LINE SPACING: 50' (15 m) C-C (LESS THAN 30MPH (50 km/h))
75' (25 m) C-C 30MPH (50 km/h) TO 45MPH (70 km/h)
150' (45 m) C-C (MORE THAN 45MPH (70 km/h))

MEDIANS OVER 4' (1.2 m) WIDE

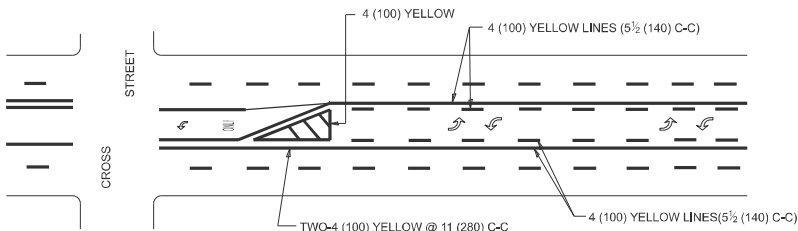

A MINIMUM OF TWO PAIRS OF TURN ARROWS SHALL BE USED, WHITE IN COLOR. ADDITIONAL PAIRS SHALL BE PLACED AT 200' (60 m) TO 300' (90 m) INTERVALS.

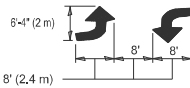

MEDIAN WITH TWO-WAY LEFT TURN LANE

TYPICAL PAINTED MEDIAN MARKING

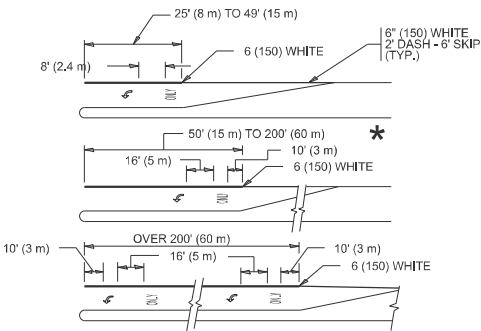

FULL SIZE LETTERS 8' (2.4 m) AND ARROWS SHALL BE USED.
AREA = 15.6 SQ. FT. (1.5 m²) ONLY AREA = 20.8 SQ. FT. (1.9 m²)

* TURN LANES IN EXCESS OF 400' (120 m) IN LENGTH MAY HAVE AN ADDITIONAL SET OF ARROW - "ONLY" INSTALLED MIDWAY BETWEEN THE OTHER TWO SETS OF ARROW - "ONLY".

TYPICAL LEFT (OR RIGHT) TURN LANE

TYPICAL TURN LANE MARKING

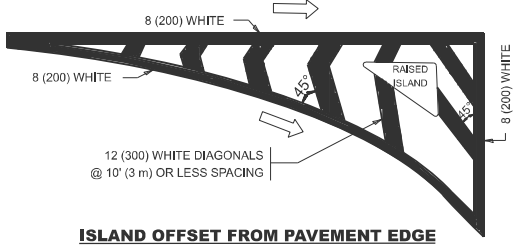

ISLAND OFFSET FROM PAVEMENT EDGE

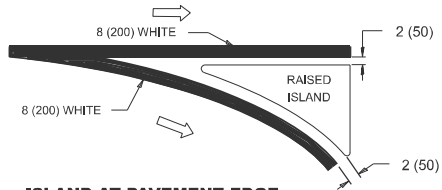

ISLAND AT PAVEMENT EDGE

TYPICAL ISLAND MARKING

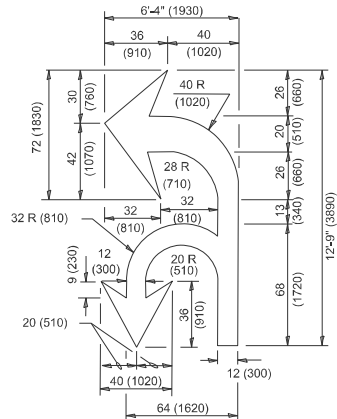

COMBINATION LEFT AND U-TURN

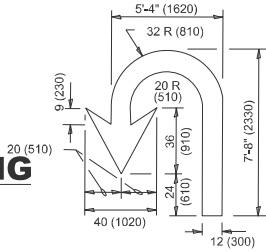

U-TURN

LANE REDUCTION TRANSITION

* LANE REDUCTION ARROWS REQUIRED AT SPEEDS OF 45 MPH OR GREATER OR WHEN SPECIFIED IN PLANS.

TYPE OF MARKING	WIDTH OF LINE	PATTERN	COLOR	SPACING / REMARKS
CENTERLINE ON 2 LANE PAVEMENT	4 (100)	SKIP-DASH	YELLOW	10' (3 m) LINE WITH 30' (9 m) SPACE
CENTERLINE ON MULTI-LANE UNDIVIDED PAVEMENT	2 @ 4 (100)	SOLID	YELLOW	11 (280) C-C
NO PASSING ZONE LINES: FOR ONE DIRECTION FOR BOTH DIRECTIONS	4 (100) 2 @ 4 (100)	SOLID SOLID	YELLOW YELLOW	5 1/2 (140) C-C FROM SKIP-DASH CENTERLINE 11 (280) C-C OMIT SKIP-DASH CENTERLINE BETWEEN
LANE LINES	4 (100) 5 (125) ON FREEWAYS	SKIP-DASH SKIP-DASH	WHITE WHITE	10' (3 m) LINE WITH 30' (9 m) SPACE
DOTTED LINES (EXTENSIONS OF CENTER, LANE OR TURN LANE MARKINGS)	SAME AS LINE BEING EXTENDED	SKIP-DASH	SAME AS LINE BEING EXTENDED	2' (600) LINE WITH 6' (1.8 m) SPACE
EDGE LINES	4 (100)	SOLID	YELLOW-LEFT WHITE-RIGHT	OUTLINE MEDIANS IN YELLOW
TURN LANE MARKINGS	6 (150) LINE: FULL SIZE LETTERS & SYMBOLS (8' (2.4m))	SOLID	WHITE	SEE TYPICAL TURN LANE MARKING DETAIL
TWO WAY LEFT TURN MARKING	2 @ 4 (100) EACH DIRECTION 8' (2.4m) LEFT ARROW	SKIP-DASH AND SOLID IN PAIRS	YELLOW WHITE	10' (3 m) LINE WITH 30' (9 m) SPACE FOR SKIP-DASH: 5 1/2 (140) C-C BETWEEN SOLID LINE AND SKIP-DASH LINE SEE TYPICAL TWO-WAY LEFT TURN MARKING DETAIL
CROSSWALK LINES (PEDESTRIAN) A. DIAGONALS (BIKE & EQUESTRIAN) B. LONGITUDINAL BARS (SCHOOL)	2 @ 6 (150) 12 (300) @ 45° 12 (300) @ 90°	SOLID SOLID SOLID	WHITE WHITE WHITE	NOT LESS THAN 6' (1.8 m) APART 2' (600) APART 2' (600) APART SEE TYPICAL CROSSWALK MARKING DETAILS.
STOP LINES	24 (600)	SOLID	WHITE	PLACE 4' (1.2 m) IN ADVANCE OF AND PARALLEL TO CROSSWALK, IF PRESENT. OTHERWISE, PLACE AT DESIRED STOPPING POINT, PARALLEL TO CROSSROAD CENTERLINE, WHERE POSSIBLE.
PAINTED MEDIANS	2 @ 4 (100) WITH 12 (300) DIAGONALS @ 45° NO DIAGONALS USED FOR 4' (1.2 m) WIDE MEDIANS	SOLID	YELLOW: TWO WAY TRAFFIC WHITE: ONE WAY TRAFFIC	11 (280) C-C FOR THE DOUBLE LINE SEE TYPICAL PAINTED MEDIAN MARKING.
GORE MARKING AND CHANNELIZING LINES	8 (200) WITH 12 (300) DIAGONALS @ 45°	SOLID	WHITE	DIAGONALS: 15' (4.5 m) C-C (LESS THAN 30MPH (50 km/h)) 20' (6 m) C-C 30MPH (50 km/h) TO 45MPH (70 km/h) 30' (9 m) C-C (OVER 45MPH (70 km/h))
RAILROAD CROSSING	24 (600) TRANSVERSE LINES: "RR" IS 6' (1.8 m) LETTERS: 16 (400) LINE FOR "X"	SOLID	WHITE	SEE STATE STANDARD 780001 AREA OF: *R*=3.6 SQ. FT. (0.33 m ²) EACH *X*=54.0 SQ. FT. (5.0 m ²)
SHOULDER DIAGONALS (REQUIRED FOR SHOULDERS ≥ 8')	12 (300) @ 45°	SOLID	WHITE - RIGHT YELLOW - LEFT	50' (15 m) C-C (LESS THAN 30MPH (50 km/h)) 75' (25 m) C-C (30 MPH (50 km/h) TO 45MPH (70 km/h)) 150' (45 m) C-C (OVER 45MPH (70 km/h))
U TURN ARROW	SEE DETAIL	SOLID	WHITE	16.3 SF
2 ARROW COMBINATION LEFT AND U TURN	SEE DETAIL	SOLID	WHITE	30.4 SF

FOR FURTHER DETAILS ON PAVEMENT MARKING REFER TO STANDARD SPECIFICATIONS FOR ROAD AND BRIDGE CONSTRUCTION AND STATE STANDARD 780001.

All dimensions are in inches (millimeters) unless otherwise shown.

USER NAME = Hanan.Alghizl	DESIGNED - EVERS	REVISED - C. JUCIUS 09-09-09
	DRAWN -	REVISED - C. JUCIUS 07-01-13
	CHECKED -	REVISED - C. JUCIUS 12-21-15
PLOT DATE = 1/10/2025	DATE - 03-19-90	REVISED - C. JUCIUS 04-12-16

STATE OF ILLINOIS DEPARTMENT OF TRANSPORTATION

DISTRICT ONE TYPICAL PAVEMENT MARKINGS

SCALE: NONE SHEET 1 OF 1 SHEETS STA. TO STA.

F.A.P RTE.	SECTION	COUNTY	TOTAL SHEETS	SHEET NO.
343	FAP 0343 23 SMART	COOK	25	21
TC-13		CONTRACT NO. 62V73		
		ILLINOIS FED. AID PROJECT		

TURN BAY ENTRANCE AT START
OF LANE CLOSURE TAPER

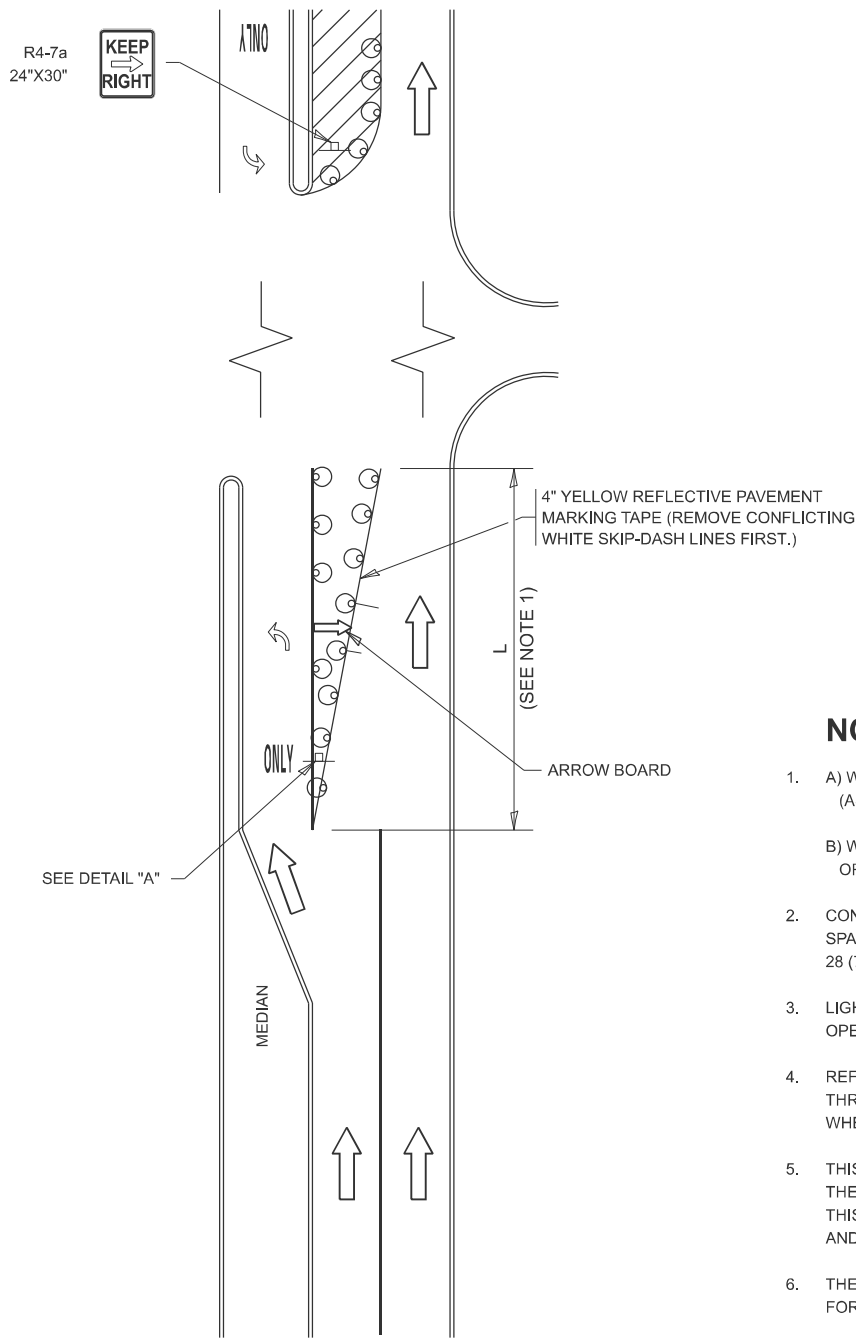
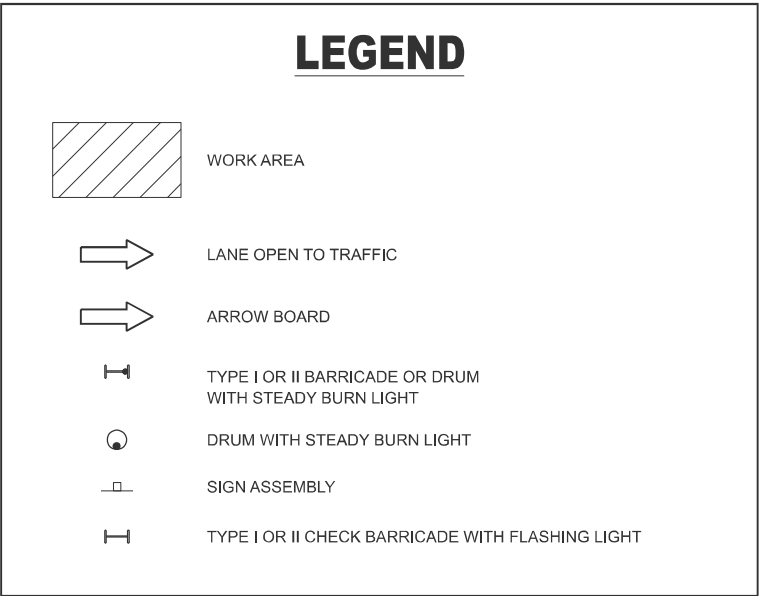

FIGURE 1

LEGEND



NOTES:

- A) WHEN "L" IS \leq THE STORAGE LENGTH OF THE TURN LANE (AS SHOWN IN FIG. 1), USE FIGURE 1.
B) WHEN "L" IS $>$ THE STORAGE LENGTH OF THE TURN LANE OR THE TURN LANE IS WITHIN THE LANE CLOSURE, USE FIGURE 2.
- CONES MAY BE SUBSTITUTED FOR BARRICADES OR DRUMS AT HALF THE SPACING DURING DAY OPERATIONS. CONES SHALL BE A MINIMUM OF 28 (710) IN HEIGHT.
- LIGHTS WILL NOT BE REQUIRED ON BARRICADES OR DRUMS FOR DAY OPERATIONS. ALL LIGHTS SHALL BE MONODIRECTIONAL.
- REFLECTIVE TEMPORARY PAVEMENT MARKINGS SHALL BE PLACED THROUGHOUT THE BARRICADED AREAS OF EACH TURN BAY AS SHOWN WHERE THE CLOSURE TIME IS GREATER THAN FOURTEEN (14) DAYS.
- THIS APPLICATION ALSO APPLIES WHEN WORK IS BEING PERFORMED IN THE RIGHT LANE(S) AND THE RIGHT TURN BAY IS TO REMAIN OPEN. UNDER THIS CONDITION, "RIGHT TURN LANE" R3-1100R 24 x 24 (600 x 600) AND M6-2R 21 x 15 (530 x 380) SHALL BE USED.
- THESE CONTROLS SHALL SUPPLEMENT MAINLINE TRAFFIC CONTROL FOR LANE CLOSURES.
- THE SIGNS SHALL BE MOUNTED ABOVE THE BARRICADES/DRUMS ON SEPARATE SIGN SUPPORTS THAT MEET NCHRP 350 OR MASH REQUIREMENTS.
- TRAFFIC CONTROL AND PROTECTION AT TURN BAYS (TO REMAIN OPEN TO TRAFFIC) SHALL BE INCLUDED IN THE COST OF SPECIFIED TRAFFIC CONTROL STANDARDS OR ITEMS.

TURN BAY ENTRANCE
WITHIN A LANE CLOSURE

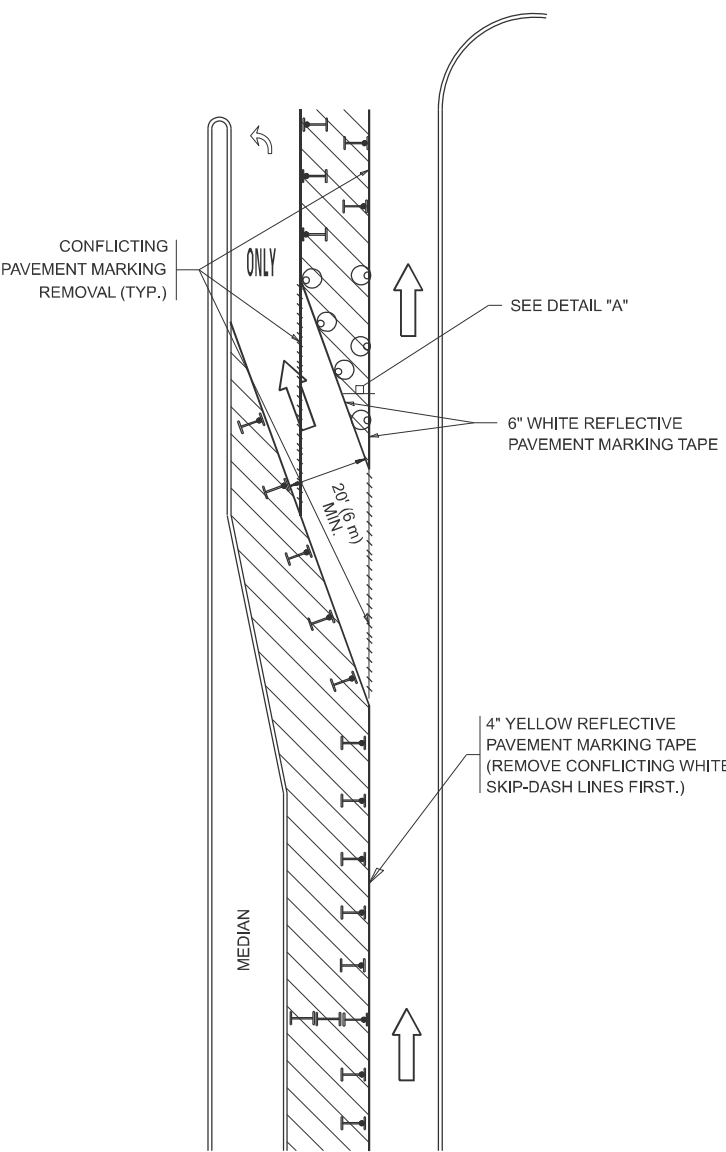
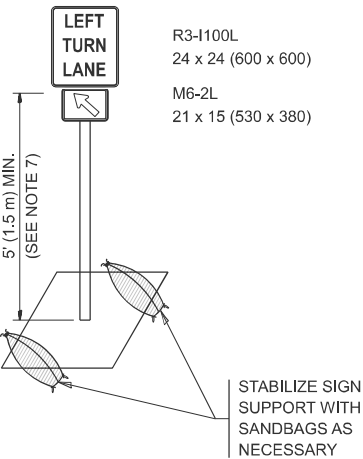

FIGURE 2



DETAIL A

All dimensions are in inches (millimeters) unless otherwise shown.

MODEL: TC-14 (Sheet)
FILE NAME: c:\p\work\illinois.gov_hanan.alghizi\00638033\0105124-shr-DistSigns.dgn

USER NAME = Hanan.Alghizi	DESIGNED - T. RAMMACHER 09-08-94	REVISED - R. BORO 09-14-09
	DRAWN - A. HOUSEH 11-07-95	REVISED - A. SCHUETZE 07-01-13
	CHECKED - A. HOUSEH 10-12-96	REVISED - A. SCHUETZE 09-15-16
PLOT DATE = 1/10/2025	DATE - T. RAMMACHER 01-06-00	REVISED -

DESIGNED - T. RAMMACHER 09-08-94	REVISED - R. BORO 09-14-09
DRAWN - A. HOUSEH 11-07-95	REVISED - A. SCHUETZE 07-01-13
CHECKED - A. HOUSEH 10-12-96	REVISED - A. SCHUETZE 09-15-16
DATE - T. RAMMACHER 01-06-00	REVISED -

STATE OF ILLINOIS
DEPARTMENT OF TRANSPORTATION

TRAFFIC CONTROL AND PROTECTION AT TURN BAYS
(TO REMAIN OPEN TO TRAFFIC)

SCALE: NONE SHEET 1 OF 1 SHEETS STA. TO STA.

F.A.P. RTE.	SECTION	COUNTY	TOTAL SHEETS	SHEET NO.
343	FAP 0343 23 SMART	COOK	25	22
TC-14		CONTRACT NO. 62V73		
		ILLINOIS	FED. AID PROJECT	

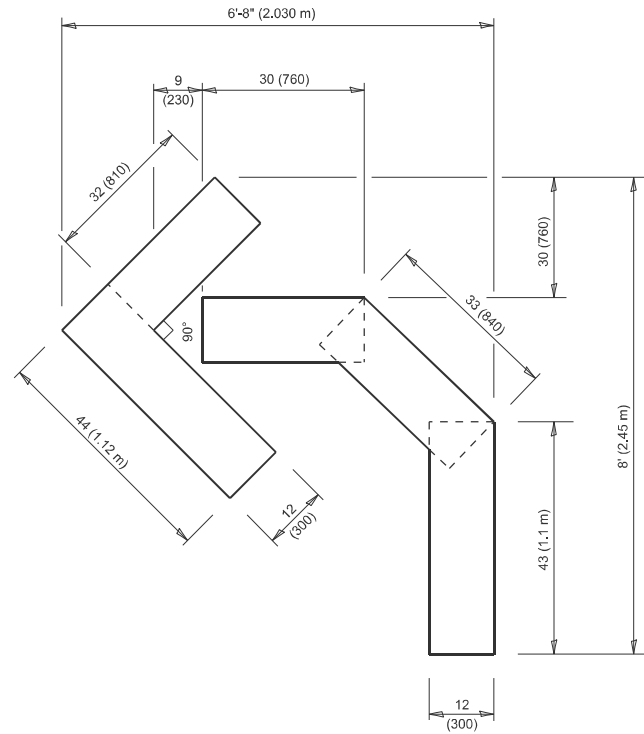

QUANTITY

4 (100) LINE = 45.5 ft. (13.9 m)
15.2 sq. ft. (1.41 sq. m)

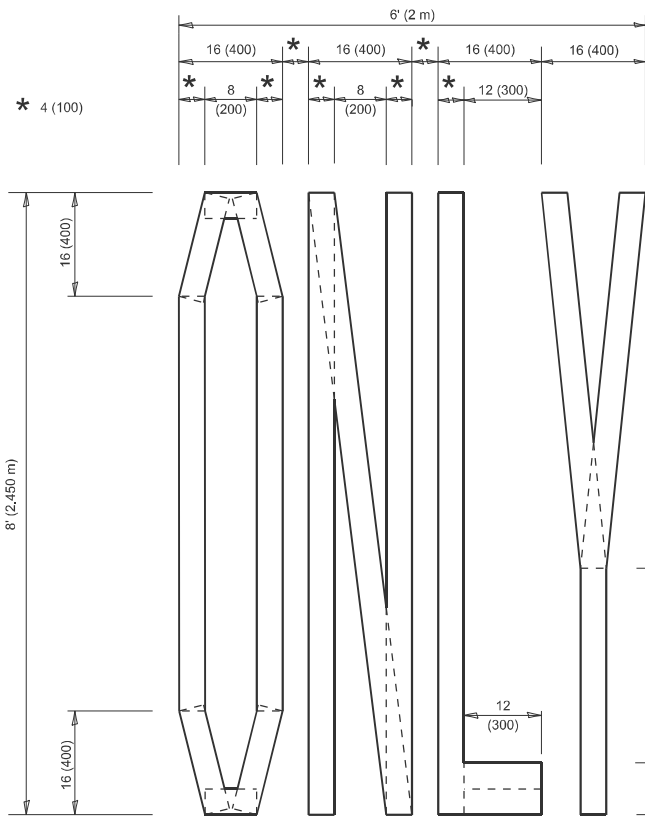

QUANTITY

4 (100) LINE = 64.1 ft. (19.5 m)
21.4 sq. ft. (1.99 sq. m)

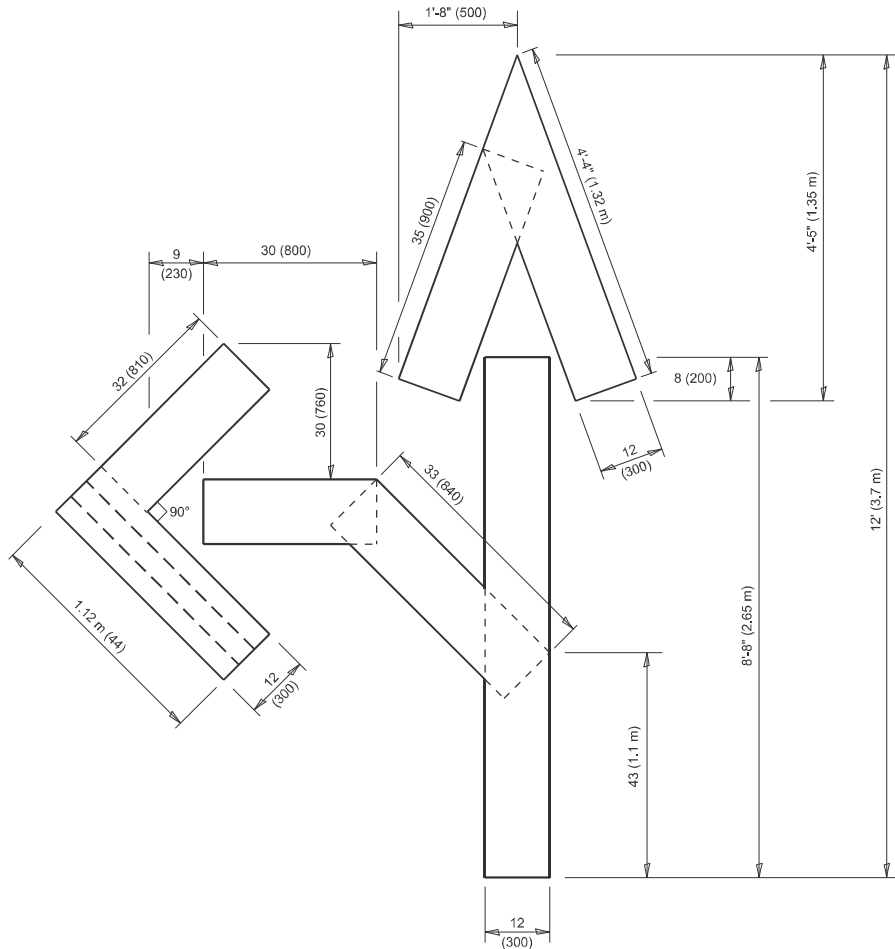

QUANTITY

4 (100) LINE = 82.5 ft. (25.1 m)
27.5 sq. ft. (2.53 sq. m)

NOTE:

ALL QUANTITIES OF PLACEMENT ARE REPRESENTED
IN LINEAR FEET OF 4" LINES TO MATCH THE
4" TEMPORARY TAPE PAY ITEM AND REPRESENTS
THE TOTAL QUANTITY OF 4" TAPE REQUIRED.

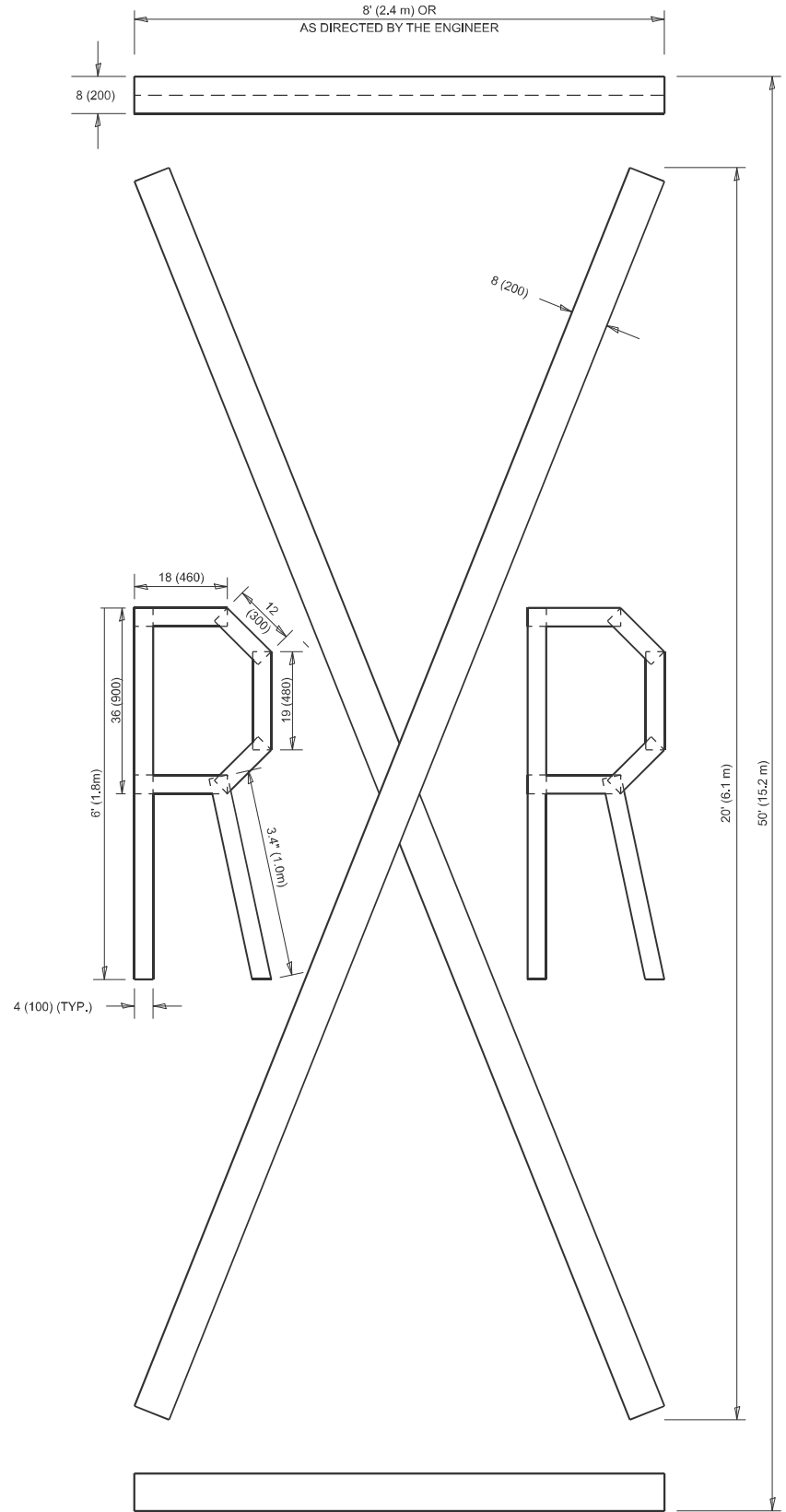

QUANTITY

4 (100) LINE = 225.9 ft. (68.9 m)
75.3 sq. ft. (6.99 sq. m)

All dimensions are in inches (millimeters)
unless otherwise shown.

MODEL: TC-16 (Sheet)
FILE NAME: c:\p\work\pwr\illinois.gov_hanan.alghizi@illinois.gov\d0638033\D105124-sh1-DistStds.dgn

PLOT DATE = 1/10/2025	USER NAME = Hanan.Alghizi	DESIGNED -	REVISED - T. RAMMACHER 03-02-98
		DRAWN -	REVISED - E. GOMEZ 08-28-00
		CHECKED -	REVISED - E. GOMEZ 08-28-00
	DATE - 09-18-94	REVISED - A. SCHUETZE 09-15-16	

STATE OF ILLINOIS
DEPARTMENT OF TRANSPORTATION

SHORT TERM PAVEMENT MARKING LETTERS AND SYMBOLS

SCALE: NONE SHEET 1 OF 1 SHEETS STA. TO STA.

F.A.P RTE.	SECTION	COUNTY	TOTAL SHEETS	SHEET NO.
343	FAP 0343 23 SMART	COOK	25	23
TC-16		CONTRACT NO. 62V73		
		ILLINOIS	FED. AID PROJECT	

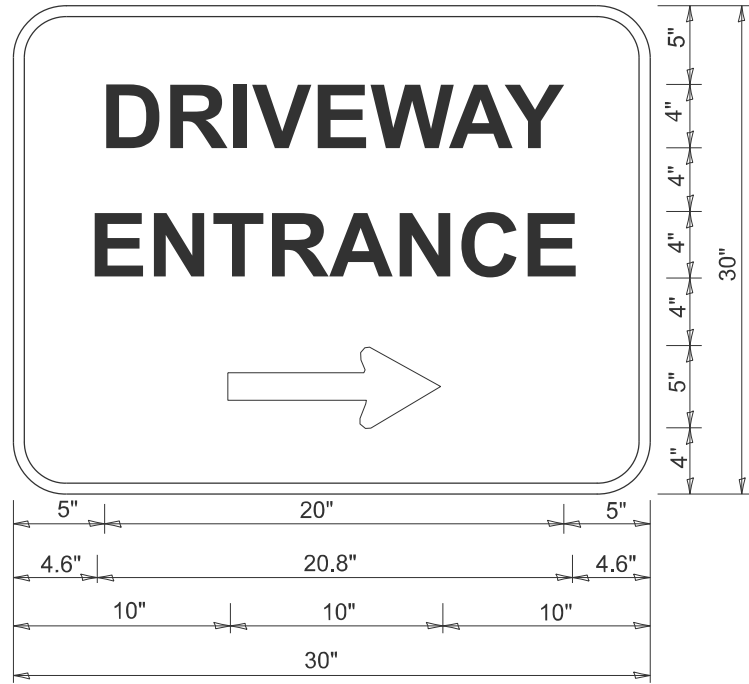

3.0" RADIUS, 0.5" BORDER, WHITE ON GREEN; REFLECTORIZED
"DRIVEWAY" D; "ENTRANCE" D; STANDARD ARROW CUSTOM 12.0" x 5.0"

- NOTES:**
1. HALF OF THE SIGNS WILL REQUIRE A LEFT HAND FACING ARROW.
 2. TWO SIGNS SHALL BE USED AT EACH COMMERCIAL ENTRANCE
PLACED BACK-TO-BACK: ONE WITH A RIGHT HAND ARROW (SHOWN)
SHALL BE PLACED ON THE NEAR RIGHT SIDE THE DRIVEWAY
AND ONE WITH A LEFT HAND ARROW SHALL BE PLACED ON THE
FAR LEFT SIDE OF THE DRIVEWAY.
 3. SIGNS TO BE PAID FOR AS ITEM "TEMPORARY INFORMATION SIGNING".

MODEL: TC-26 (Sheet)
FILE NAME: c:\p\work\pwrtd\illinois.gov_hanan.alghizi@illinois.gov\00638033\0105124-shh-DistSigns.dgn

	USER NAME = Hanan.Alghizi	DESIGNED -	REVISED - C. JUCIUS 02-15-07	STATE OF ILLINOIS DEPARTMENT OF TRANSPORTATION	DRIVEWAY ENTRANCE SIGNING			F.A.P RTE.	SECTION	COUNTY	TOTAL SHEETS	SHEET NO.
		DRAWN -	REVISED -					343	FAP 0343 23 SMART	COOK	25	25
		CHECKED -	REVISED -		TC-26			CONTRACT NO. 62V73				
	PLOT DATE = 1/10/2025	DATE -	REVISED -		SCALE: NONE	SHEET 1	OF 1 SHEETS	STA.	TO STA.	ILLINOIS FED. AID PROJECT		