

STATE OF ILLINOIS
DEPARTMENT OF TRANSPORTATION

F.A.I. RTE.	SECTION	COUNTY	TOTAL SHEETS	SHEET NO.
74	(74-3)I	PIATT	11	1
		ILLINOIS	CONTRACT NO. 70H56	

P-95-013-25



FOR INDEX OF SHEETS, SEE SHEET NO. 2
FOR SUMMARY OF QUANTITIES, SEE SHEET NO. 3-4

TRAFFIC DATA

	LEG "A"	LEG "B"
2024 ADT=	21,500	22,800
P.U. %	66.9	66.9
S.U. %	3.8	4.6
M.U. %	29.3	28.5

TRAFFIC DATA LOCATIONS

LEG "A" IS I-74 FROM 1.0 MILE E. OF 900E RD TO FAS 495
LEG "B" IS I-74 FROM FAS 495 TO 1.3 MILES W. OF CHAMPAIGN CO. LINE

**PROPOSED
HIGHWAY PLANS**

FAI ROUTE 74 (I 74)
SECTION (74-3)I
PROJECT NHPP-Y5DJ(830)
MICROSURFACING JOINT REPAIR
PIATT COUNTY
1 MI E OF 900E RD TO
C-95-042-25
1.3 MI W OF CHAMPAIGN CO LINE

BEGIN STATION: 1056+60.48
BEGIN SECTION:
(74-3)I
FAI 74
1 MI E OF 900E RD

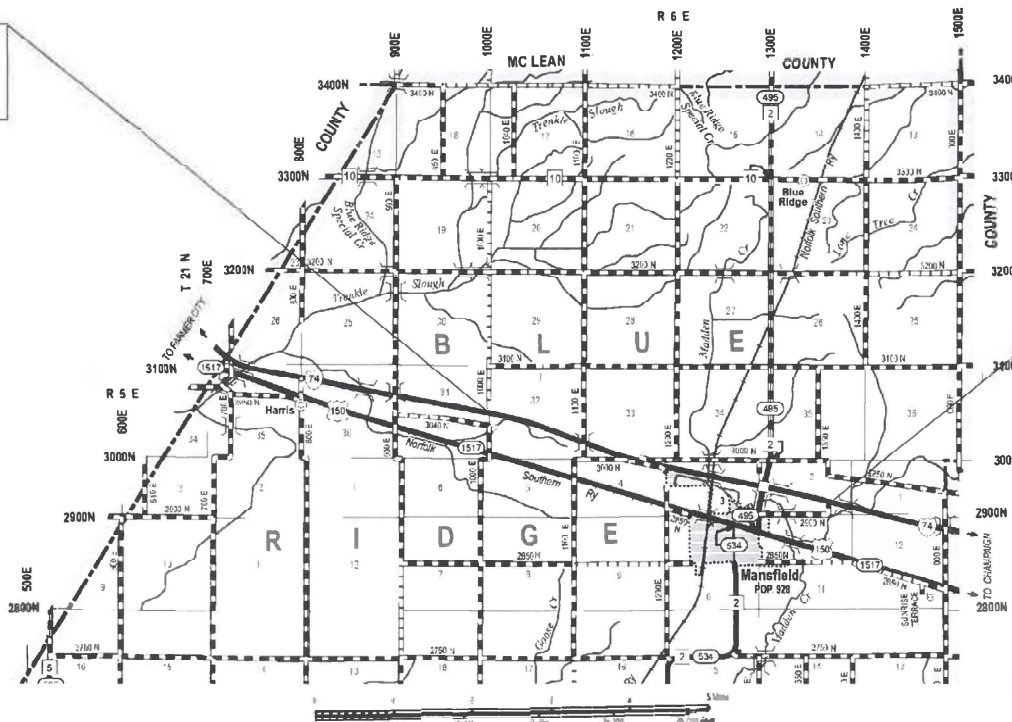

END STATION: 1258+12.00
END SECTION:
(74-3)I
FAI 74
1.3 MI W OF CHAMPAIGN CO LINE

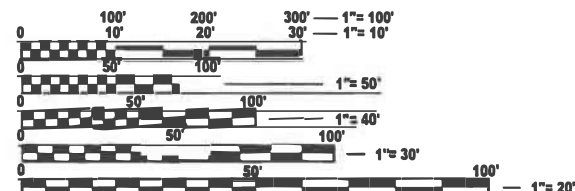

FULL SIZE PLANS HAVE BEEN PREPARED USING STANDARD
ENGINEERING SCALES. REDUCED SIZED PLANS WILL NOT
CONFORM TO STANDARD SCALES. IN MAKING MEASUREMENTS
ON REDUCED PLANS, THE ABOVE SCALES MAY BE USED.

J.U.L.I.E.
JOINT UTILITY LOCATION INFORMATION FOR EXCAVATION
1-800-892-0123
OR 811
TOWNSHIP
MAHOMET TOWNSHIP
BLUE RIDGE TOWNSHIP

PROJECT ENGINEER: RYAN T. CARROLL
SQUAD LEADER: TYLER J. PIERSON
DESIGNER: AARON FARNHAM
PHONE NUMBER: 217-465-4181

CONTRACT NO. 70H56

GROSS LENGTH = 20,151.5 FT. = 3.816 MILE
NET LENGTH = 20,151.5 FT. = 3.816 MILE

STATE OF ILLINOIS
DEPARTMENT OF TRANSPORTATION

SUBMITTED 1/24 20 25
Kennil A. Harnett REGIONAL ENGINEER
March 21 2025
Scott A. Etkin ENGINEER OF DESIGN AND ENVIRONMENT
March 21 2025
Harry DIRECTOR OF HIGHWAYS PROJECT IMPLEMENTATION

PRINTED BY THE AUTHORITY
OF THE STATE OF ILLINOIS

INDEX OF SHEETS

SHEET NO.	DESCRIPTION
1	COVER
2	INDEX OF SHEETS, GENERAL NOTES, LIST OF HIGHWAY STANDARDS, & COMMITMENTS
3 to 4	SUMMARY OF QUANTITIES
5	TYPICAL CROSS SECTIONS
6	SCHEDULE OF QUANTITIES
7 to 8	DISTRICT 5 DETAIL - PAVEMENT MARKING (INTERSTATE & MULTI-LANE APPLICATIONS)

GENERAL NOTES

G.N. -703A
SHORT TERM PAVEMENT MARKING SHALL BE APPLIED TO THE PAVEMENT AFTER ANY OF THE FOLLOWING: COLD MILLING AND/OR PLACING BITUMINOUS MATERIALS (TACK COAT), LEVELING BINDER (MACHINE METHOD), BINDER AND SURFACE COURSES. SHORT TERM PAVEMENT MARKING PLACED ON THE SURFACE SHALL COINCIDE WITH THE FINAL PAVEMENT STRIPING. SHORT TERM PAVEMENT MARKING PLACED PRIOR TO THE SURFACE SHALL COINCIDE WITH THE EXISTING PAVEMENT MARKINGS. USE 4 FEET PER 40 FEET (OR 10% PER STATION).

G.N. -781
THE FINAL PAVEMENT MARKINGS SHALL BE IN PLACE PRIOR TO PLACING THE RAISED REFLECTIVE PAVEMENT MARKERS.

HIGHWAY STANDARDS

STANDARD NO.	DESCRIPTION
000001-08	STANDARD SYMBOLS, ABBREVIATIONS AND PATTERNS
001006	DECIMAL OF AN INCH AND OF A FOOT
701400-12	APPROACH TO LANE CLOSURE, FREEWAY/EXPRESSWAY
701401-13	LANE CLOSURE, FREEWAY/EXPRESSWAY
701411-09	LANE CLOSURE, MULTILANE, AT ENTRANCE OR EXIT RAMP, FOR SPEEDS ≥ 45 MPH
701426-09	LANE CLOSURE, MULTILANE, INTERMITTENT OR MOVING OPERATION, FOR SPEEDS ≥ 45 MPH
701901-10	TRAFFIC CONTROL DEVICES
781001-04	TYPICAL APPLICATIONS RAISED REFLECTIVE PAVEMENT MARKERS

COMMITMENTS

THERE ARE NO COMMITMENTS FOR THIS CONTRACT

MODEL: Index [Sheet]
FILE NAME: c:\p\work\pwt\dist\amhambald\053185\DS70H56-sh-Index.dgn

	USER NAME = Bradley.Farnham	DESIGNED -	REVISED -	STATE OF ILLINOIS DEPARTMENT OF TRANSPORTATION	INDEX OF SHEETS, HIGHWAY STANDARDS, COMMITMENTS & GENERAL NOTES		F.A.I RTE.	SECTION	COUNTY	TOTAL SHEETS	SHEET NO.
		DRAWN -	REVISED -				74	(74-3)I	PIATT	11	2
		CHECKED -	REVISED -				CONTRACT NO. 70H56				
	PLOT DATE = 1/27/2025	DATE -	REVISED -		SCALE:	SHEET 1 OF 1 SHEETS	STA.	TO STA.	ILLINOIS FED. AID PROJECT		

SUMMARY OF QUANTITIES

LOCATION OF WORK:

FAI 74 (I 74)

RURAL

INTERSTATE

STA. 1060+00.00 TO STA. 1258+12.00

PIATT COUNTY

FUNDING BREAKOUT:

90% FED / 10% STATE

CONSTRUCTION TYPE CODE:

0005

	CODE NO.	ITEM	UNIT	TOTAL QUANTITY	
	40400001	FIBER-MODIFIED ASPHALT CRACK SEALING	FOOT	40,304.0	40,304.0
	40400118	MICRO-SURFACING, SINGLE PASS	SQ YD	13,435.0	13,435.0
	40600290	BITUMINOUS MATERIALS (TACK COAT)	POUND	3,023.0	3,023.0
	67100100	MOBILIZATION	L SUM	1.0	1.0
	70100420	TRAFFIC CONTROL AND PROTECTION, STANDARD 701411	EACH	4.0	4.0
	70100800	TRAFFIC CONTROL AND PROTECTION, STANDARD 701401	L SUM	1.0	1.0
	70107025	CHANGEABLE MESSAGE SIGN	CAL DAY	14.0	14.0
	70300100	SHORT TERM PAVEMENT MARKING	FOOT	4,031.0	4,031.0
	70300150	SHORT TERM PAVEMENT MARKING REMOVAL	SQ FT	1,344.0	1,344.0
*	78000400	THERMOPLASTIC PAVEMENT MARKING - LINE 6"	FOOT	10,076.0	10,076.0
*	78011035	GROOVING FOR RECESSED PAVEMENT MARKING 7"	FOOT	10,076.0	10,076.0
*	78100100	RAISED REFLECTIVE PAVEMENT MARKER	EACH	1,008.0	1,008.0
	78300200	RAISED REFLECTIVE PAVEMENT MARKER REMOVAL	EACH	1,008.0	1,008.0
	78300201	PAVEMENT MARKING REMOVAL - GRINDING	SQ FT	3,359.0	3,359.0
* DENOTES SPECIALTY ITEM					

MODEL: Summary of Quantities-1 (Sheet)
FILE NAME: c:\p\work\piatt\farham\ba1053185\DS70H56-sh-SOO.dgn

	USER NAME = Bradley.Farnham	DESIGNED - BAF	REVISED -	STATE OF ILLINOIS DEPARTMENT OF TRANSPORTATION	SUMMARY OF QUANTITIES			FAI RTE.	SECTION	COUNTY	TOTAL SHEETS	SHEET NO.
		DRAWN -	REVISED -					74	(74-3)I	PIATT	11	3
		CHECKED -	REVISED -					CONTRACT NO. 70H56				
	PLOT DATE = 1/27/2025	DATE -	REVISED -		SCALE:	SHEET 1	OF 2 SHEETS	STA.	TO STA.	ILLINOIS FED.AID PROJECT		

SUMMARY OF QUANTITIES

LOCATION OF WORK:

FAI 74 (I 74)

RURAL

INTERSTATE

STA. 1060+00.00 TO STA. 1258+12.00

PIATT COUNTY

FUNDING BREAKOUT:

90% FED / 10% STATE

CONSTRUCTION TYPE CODE:

0005

[illegible]

MODEL: Summary of Quantities-2 [Sheet]
FILE NAME: c:\pw_work\pilotofarmhambald10531851D570H56-sht-SOQ.dgn

FILE NAME:	USER NAME = Bradley.Farnham	DESIGNED - BAF	REVISED -	STATE OF ILLINOIS DEPARTMENT OF TRANSPORTATION	SUMMARY OF QUANTITIES				F.A.I RTE.	SECTION	COUNTY	TOTAL SHEETS	SHEET NO.	
		DRAWN -	REVISED -						74	(74-3)	PIATT	11	4	
	PLOT DATE = 1/27/2025	CHECKED -	REVISED -											
		DATE -	REVISED -		CONTRACT NO. 70H56									
					SCALE:	SHEET 2	OF 2	SHEETS	STA.	TO STA.				
					ILLINOIS FED. AID PROJECT									

STATION EQUATION:
STA. 1060+00.00 (BK) =
STA. 1056+60.48 (AH)

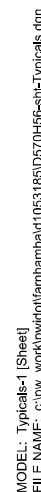
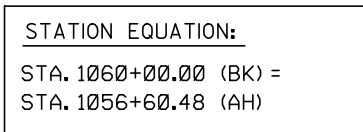

USER NAME = Bradley.Farnham	DESIGNED -	REVISED -	<div>STATE OF ILLINOIS DEPARTMENT OF TRANSPORTATION</div>	<div>TYPICAL CROSS SECTION</div>			F.A.I RTE.	SECTION	COUNTY	TOTAL SHEETS	SHEET NO.
	DRAWN -	REVISED -					74	(74-3)I	PIATT	11	5
	CHECKED -	REVISED -					CONTRACT NO. 70H56				
PLOT DATE = 1/27/2025	DATE -	REVISED -		SCALE:	SHEET 1	OF 1 SHEETS	STA.	TO STA.			

SCHEDULE OF QUANTITIES

LOCATION	DESCRIPTION	STATION	TO	STATION	LENGTH (FOOT)	40400001	40400118	40600290	70300100	70300150	78000400	78100100	78300200	78300201	78011035
						FIBER-MODIFIED ASPHALT CRACK SEALING	MICRO- SURFACING SINGLE PASS	BITUMINOUS MATERIALS (TACK COAT)*	SHORT TERM PAVEMENT MARKING	SHORT TERM PAVEMENT MARKING REMOVAL	THERMOPLASTIC PAVEMENT MARKING - LINE 6"	RAISED REFLECTIVE PAVEMENT MARKER	RAISED REFLECTIVE PAVEMENT MARKER REMOVAL	PAVEMENT MARKING REMOVAL- GRINDING **	GROOVING FOR RECESSED PAVEMENT MARKING 7"
						(FOOT)	(SQ YD)	(POUND)	(FOOT)	(SQ FT)	(FOOT)	(EACH)	(EACH)	(SQ FT)	(FOOT)
EB I-74	CENTERLINE	1056+60.48	TO	1258+12.00	20,151.5	20,151.5	6,717.2	1,511.4	2,015.2	671.7	5,037.9	504.0	504.0	1,679.3	5,037.9
WB I-74	CENTERLINE	1056+60.48	TO	1258+12.00	20,151.5	20,151.5	6,717.2	1,511.4	2,015.2	671.7	5,037.9	504.0	504.0	1,679.3	5,037.9
TOTAL =						40,303.0	13,434.3	3,022.7	4,030.3	1,343.4	10,075.8	1,008.0	1,008.0	3,358.6	10,075.8
ROUNDED =						40,304.0	13,435.0	3,023.0	4,031.0	1,344.0	10,076.0	1,008.0	1,008.0	3,359.0	10,076.0

*RESIDUAL ASPHALT RATE lb/sq ft (0.025)

**REMOVE EXISTING THERMO

TEMPORARY RUMBLE STRIPS		
APPROX. LOCATION	LANE	X7010118
		TEMPORARY RUMBLE STRIPS (SPECIAL)
		(EACH)
± 1.5 MI BEFORE TAPER	EBDL	2
± 1.5 MI BEFORE TAPER	EBPL	2
± 3 MI BEFORE TAPER	EBDL	2
± 3 MI BEFORE TAPER	EBPL	2
± 1.5 MI BEFORE TAPER	WBDL	2
± 1.5 MI BEFORE TAPER	WBPL	2
± 3 MI BEFORE TAPER	WBDL	2
± 3 MI BEFORE TAPER	WBPL	2
TOTAL =		16

CHANGEABLE MESSAGE SIGN	
DESCRIPTION	70107025
	CHANGEABLE MESSAGE SIGN
	(DAYS)
EB I-74 ADVANCE NOTICE	7
WB I-74 ADVANCE NOTICE	7
TOTAL =	14

MODEL: Schedules-1 [Sheet]
FILE NAME: c:\p\work\p\w\ill\amhambald\053185\DS70H56-eh-Schedules.dgn

MODEL: 7800BBB 6 INCH-1 [Sheet]
FILE NAME: c:\pw work\pwork\famhambal\1053185\ID570H56-sht-Detail_7800BBB.dgn

FOR RAISED REFLECTIVE PAVEMENT MARKERS, REFER TO STANDARD 781001.

TYPICAL PAVEMENT MARKING LEGEND

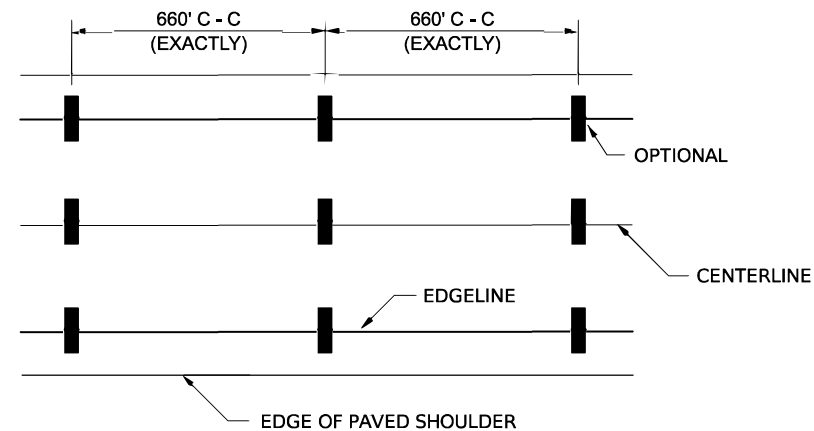

**IT WILL BE NECESSARY TO HAVE A REPRESENTATIVE OF THE
STATE POLICE PRESENT SO THAT THE ACCURACY OF MEASUREMENT
CAN BE ATTESTED TO IN COURT.**

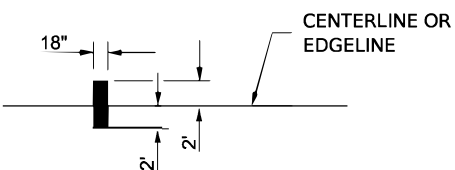

AERIAL SPEED CHECK ZONES

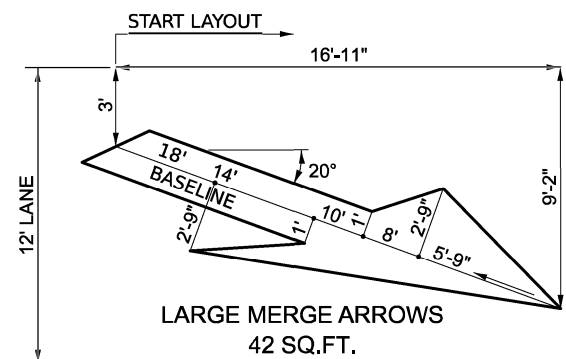

- 1 4" (100) SKIP-DASH (YELLOW)
- 2 4" (100) SOLID (YELLOW)
- 3 12" (300) DIAGONAL (YELLOW)
- 4 4" (100) DOUBLE YELLOW (NARROW)
- 5 6" (150) SOLID (YELLOW)
- 6 6" (150) SKIP-DASH (WHITE)
- 7 4" (100) SKIP-DASH (WHITE)
- 8 4" (100) SOLID (WHITE)
- 9 12" (300) DIAGONAL (WHITE)
- 10 6" (150) SOLID (WHITE)
- 11 24" (600) STOP BAR (WHITE)
- 12 8" (200) SOLID (WHITE)
- 13 6" (150) LANE LINE EXTENSIONS (WHITE)

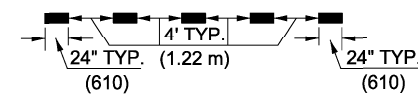
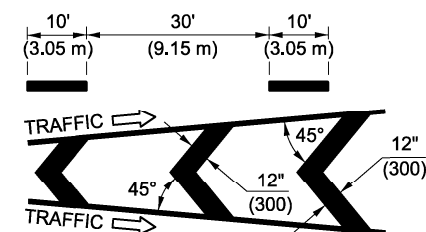
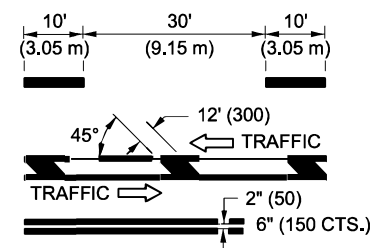

TYPICAL EXIT RAMP TERMINAL

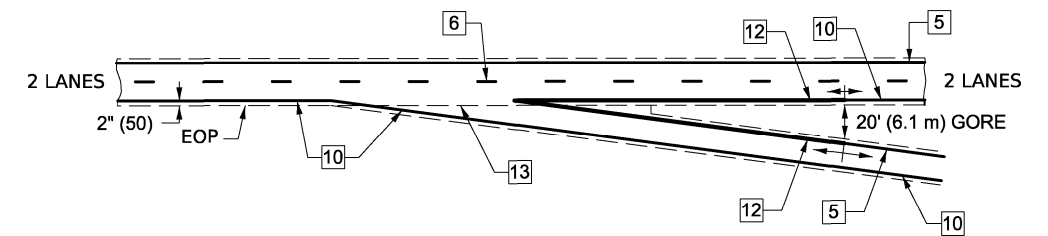

EXIT RAMP TERMINAL with EXCLUSIVE (auxiliary) LANE

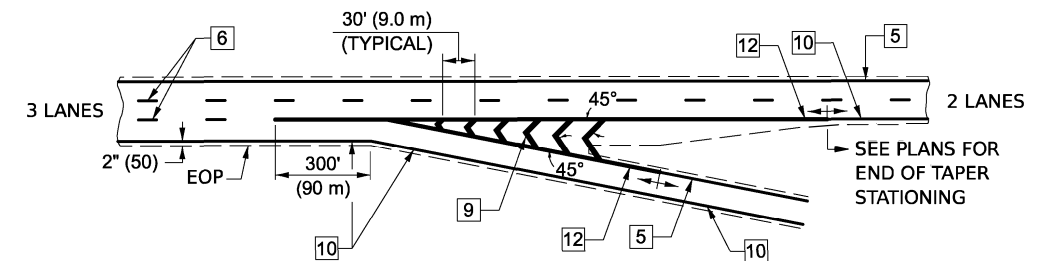

TYPICAL ENTRANCE RAMP TERMINAL

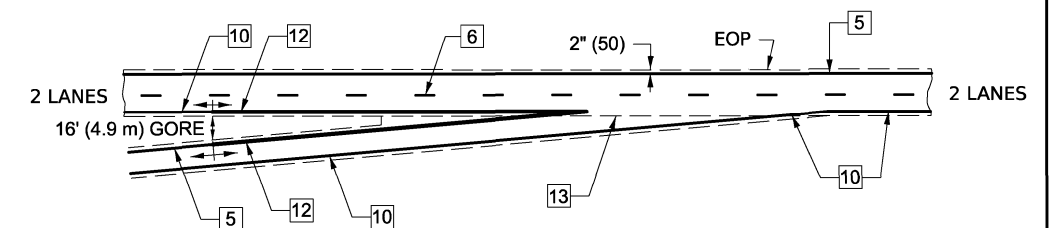

ENTRANCE RAMP TERMINAL with EXCLUSIVE LANE

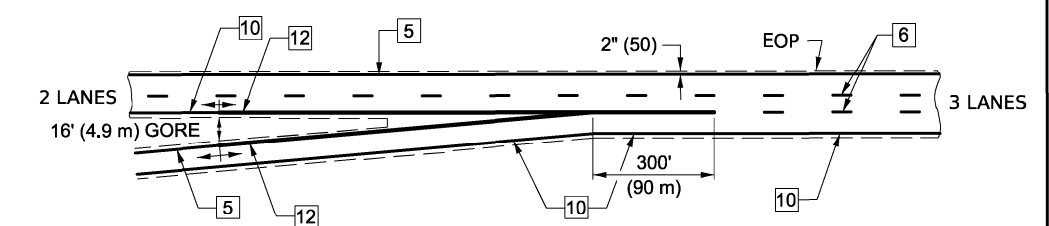

Note: All dimensions are in INCHES
(millimeters) unless otherwise shown.

DISTRICT 5 DETAIL NO. 7800BBBB

F.A.I RTE.	SECTION	COUNTY	TOTAL SHEETS	SHEET NO.
74	(74-3)	PIATT	11	7
CONTRACT NO. 70H56				

STATE OF ILLINOIS
DEPARTMENT OF TRANSPORTATION

DISTRICT 5 DETAIL
NO. 7800BBBB

SCALE:	SHEET 1	OF 1	SHEETS	STA.	TO STA.
--------	---------	------	--------	------	---------

DETAIL FOR TEMPORARY RUMBLE STRIPS (SPECIAL)

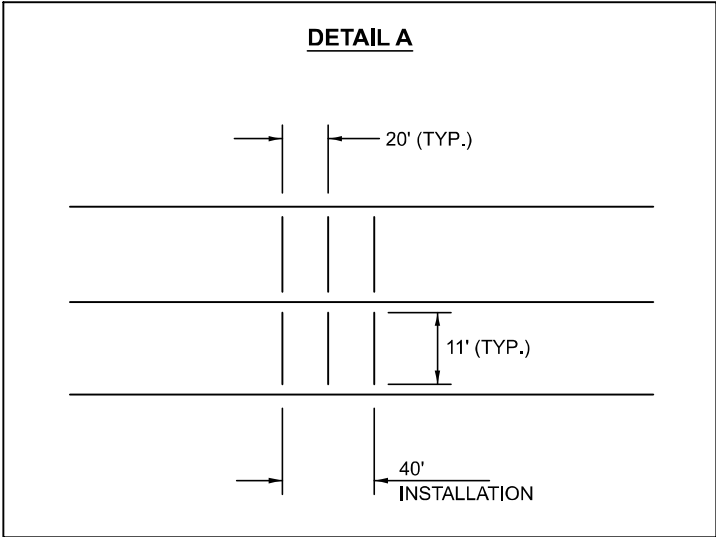
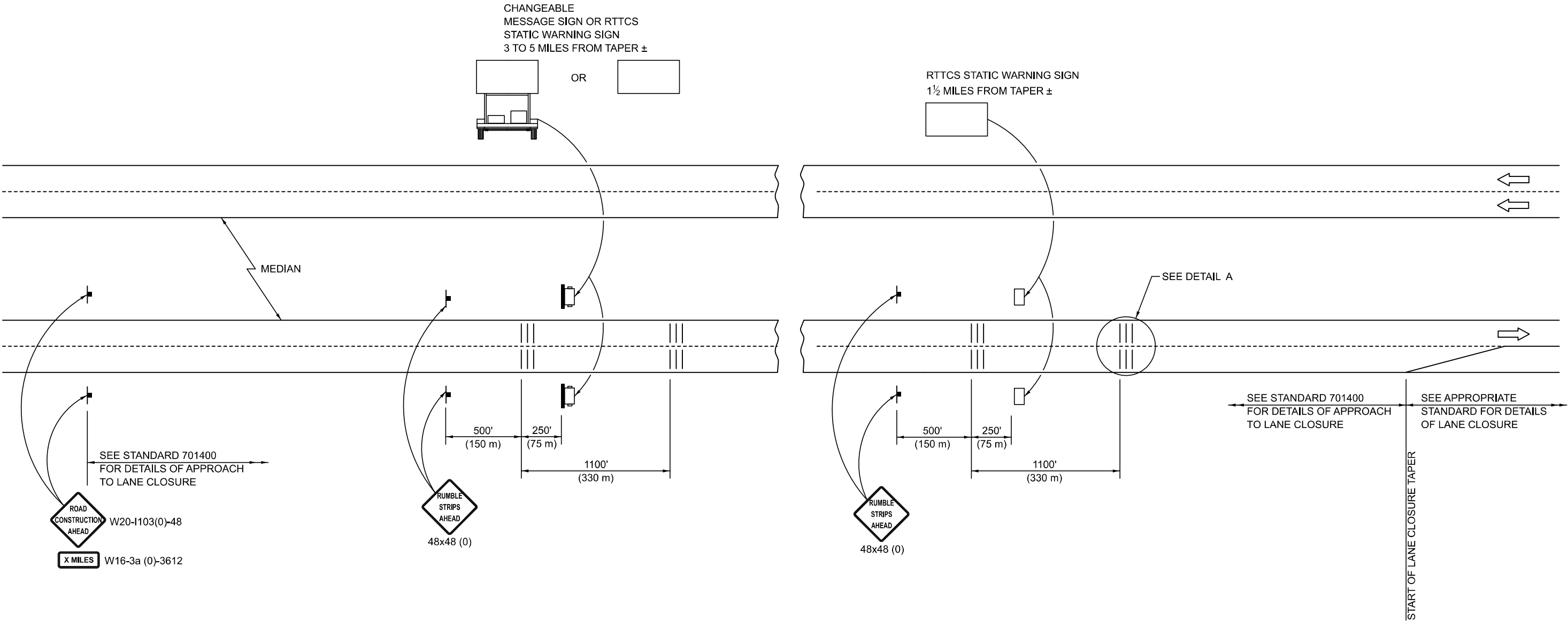

SYMBOLS

- SIGN
- TEMPORARY RUMBLE STRIPS (SPECIAL)
- TRAILER MOUNTED SIGN
- RTTCS STATIC WARNING SIGN

GENERAL NOTES

REMOVE THE TEMPORARY RUMBLE STRIPS (SPECIAL) PRIOR TO THE REMOVAL OF THE ADVANCED WARNING SIGNS.

ALL DIMENSIONS ARE IN INCHES (MILLIMETERS) UNLESS OTHERWISE SHOWN.

MODEL: Temporary Rumble Strip (Sheet)
FILE NAME: c:\pawork\jw\illdot\arnham\ba1053185\Detail For Temporary Rumble Strips (Special)\New.dgn

USER NAME = Bradley.Farnham	DESIGNED -	REVISED -
	DRAWN -	REVISED -
	CHECKED -	REVISED -
PLOT DATE = 1/27/2025	DATE -	REVISED -

STATE OF ILLINOIS
DEPARTMENT OF TRANSPORTATION

DETAIL FOR TEMPORARY
RUMBLE STRIPS (SPECIAL)

SCALE: SHEET 1 OF 1 SHEETS STA. TO STA.

F.A.I RTE.	SECTION	COUNTY	TOTAL SHEETS	SHEET NO.
74	(74-3)I	PIATT	11	8
CONTRACT NO. 70H56				
ILLINOIS FED. AID PROJECT				

REAL-TIME TRAFFIC CONTROL SYSTEM
EASTBOUND



RTTCS STATIC WARNING SIGN
•PAID FOR AS REAL-TIME TRAFFIC CONTROL WARNING SIGN
•48" X 96" (1200MM X 2400MM) WARNING SIGN THAT SAYS "STOPPED TRAFFIC NEXT MILE WHEN FLASHING"

STOPPED TRAFFIC
NEXT MILE
WHEN FLASHING



SINGLE PORTABLE CHANGEABLE MESSAGE SIGN PLACED ½ MILE IN ADVANCE OF 4TH RTTCS BOARD. IT SHALL READ "RIGHT/LEFT LANE CLOSED/X MILES AHEAD"
•THIS PORTABLE CHANGEABLE MESSAGE SIGN IS INCLUDED IN STANDARD 701400



SPEED SENSOR
•PAID FOR AS REAL-TIME TRAFFIC CONTROL MONITORING SENSOR UNIT

NOTES:

THE NUMBER AND LOCATION OF RTTCS STATIC WARNING SIGNS MAY BE CHANGED AS DIRECTED BY THE ENGINEER. RELOCATION OF RTTCS STATIC WARNING SIGNS IS INCLUDED IN THE RTTCS PAY ITEMS.

SPEED SENSORS SPACED APPROXIMATELY EVERY 1/2 MILE.
RTTC STATIC WARNING SIGNS SPACED EVERY 1 MILE.

RTTC = REAL-TIME TRAFFIC CONTROL

RTTCS = REAL-TIME TRAFFIC CONTROL SYSTEM



MODEL: RTTCS [Sheet]
FILE NAME: c:\p\work\lambd\lambd1053185\DS70H56-sh-Detail-RTTCS.dgn

USER NAME = Bradley.Farnham	DESIGNED -	REVISED -
	DRAWN -	REVISED -
	CHECKED -	REVISED -
PLOT DATE = 1/27/2025	DATE -	REVISED -

STATE OF ILLINOIS
DEPARTMENT OF TRANSPORTATION

REAL TIME TRAFFIC
CONTROL SYSTEM

SCALE: SHEET 1 OF 2 SHEETS STA. TO STA.

F.A.I RTE.	SECTION	COUNTY	TOTAL SHEETS	SHEET NO.
74	(74-3)I	PIATT	11	9
CONTRACT NO. 70H56				
ILLINOIS FED. AID PROJECT				

REAL-TIME TRAFFIC CONTROL SYSTEM
WESTBOUND

- 

RTTCS STATIC WARNING SIGN

 - PAID FOR AS REAL-TIME TRAFFIC CONTROL WARNING SIGN
 - 48" X 96" (1200MM X 2400MM) WARNING SIGN THAT SAYS "STOPPED TRAFFIC NEXT MILE WHEN FLASHING"

STOPPED TRAFFIC
NEXT MILE
WHEN FLASHING

- 

SINGLE PORTABLE CHANGEABLE MESSAGE SIGN PLACED ½ MILE IN ADVANCE OF 4TH RTTCS BOARD. IT SHALL READ "RIGHT/LEFT LANE CLOSED/X MILES AHEAD"

 - THIS PORTABLE CHANGEABLE MESSAGE SIGN IS INCLUDED IN STANDARD 701400

- 

SPEED SENSOR

 - PAID FOR AS REAL-TIME TRAFFIC CONTROL MONITORING SENSOR UNIT

NOTES:

THE NUMBER AND LOCATION OF RTTCS STATIC WARNING SIGNS MAY BE CHANGED AS DIRECTED BY THE ENGINEER. RELOCATION OF RTTCS STATIC WARNING SIGNS IS INCLUDED IN THE RTTCS PAY ITEMS.

SPEED SENSORS SPACED APPROXIMATELY EVERY 1/2 MILE.
RTTC STATIC WARNING SIGNS SPACED EVERY 1 MILE.

RTTC = REAL-TIME TRAFFIC CONTROL

RTTCS = REAL-TIME TRAFFIC CONTROL SYSTEM

START OF TAPER

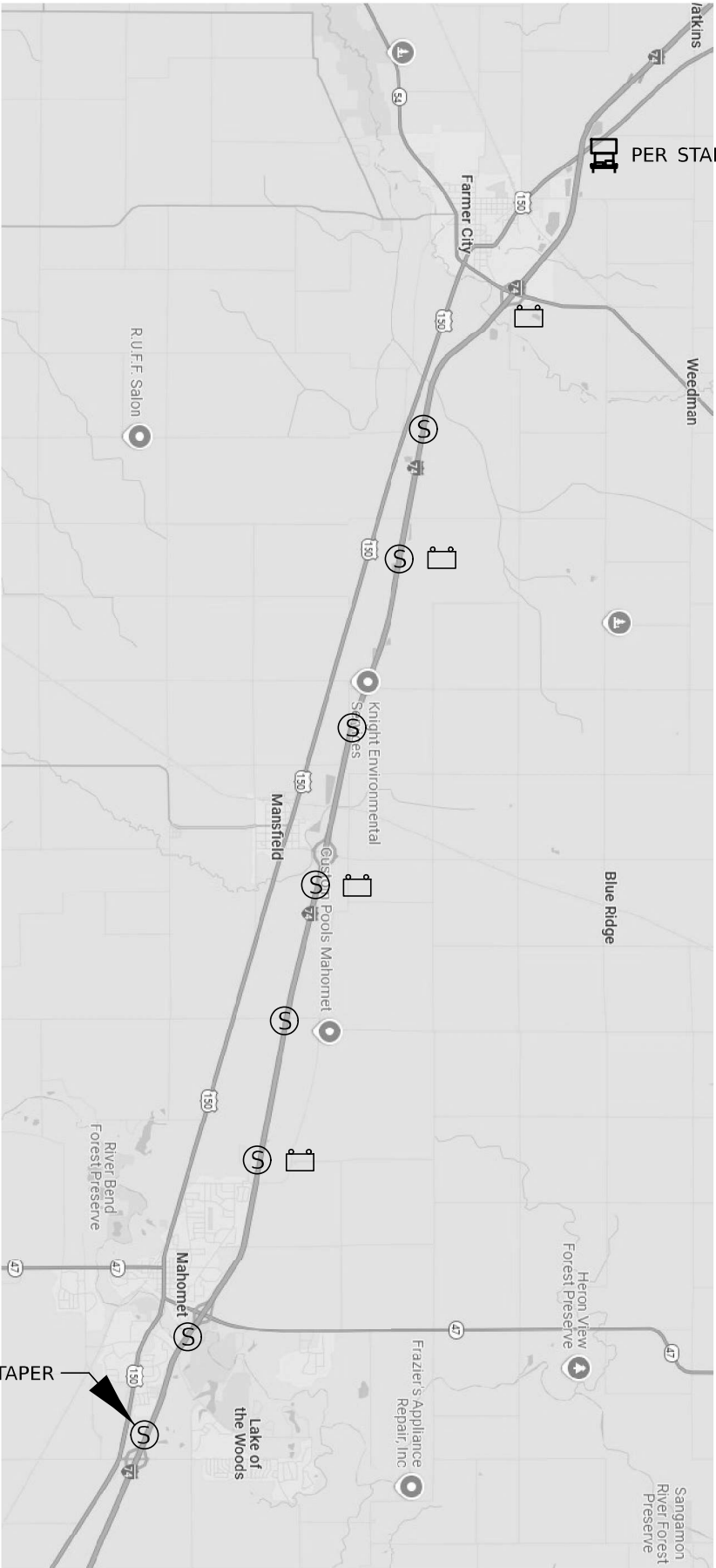

PER STANDARD 701400

MODEL: RTTCS-3 (Sheet)
FILE NAME: c:\p\work\kidd\lambd\1053185\DS70H56-sh-Detail\RTTCS.dgn

	USER NAME = Bradley.Farnham	DESIGNED -	REVISED -
		DRAWN -	REVISED -
		CHECKED -	REVISED -
	PLOT DATE = 1/27/2025	DATE -	REVISED -

STATE OF ILLINOIS
DEPARTMENT OF TRANSPORTATION

REAL TIME TRAFFIC
CONTROL SYSTEM

SCALE: SHEET 2 OF 2 SHEETS STA. TO STA.

F.A.I RTE.	SECTION	COUNTY	TOTAL SHEETS	SHEET NO.
74	(74-3)I	PIATT	11	10
CONTRACT NO. 70H56				
ILLINOIS FED. AID PROJECT				

MODEL: X032A4AA (Sheet)
FILE NAME: c:\p\work\lambald\053185\DS70H56-Sht-Detail_X032A4AA.dgn

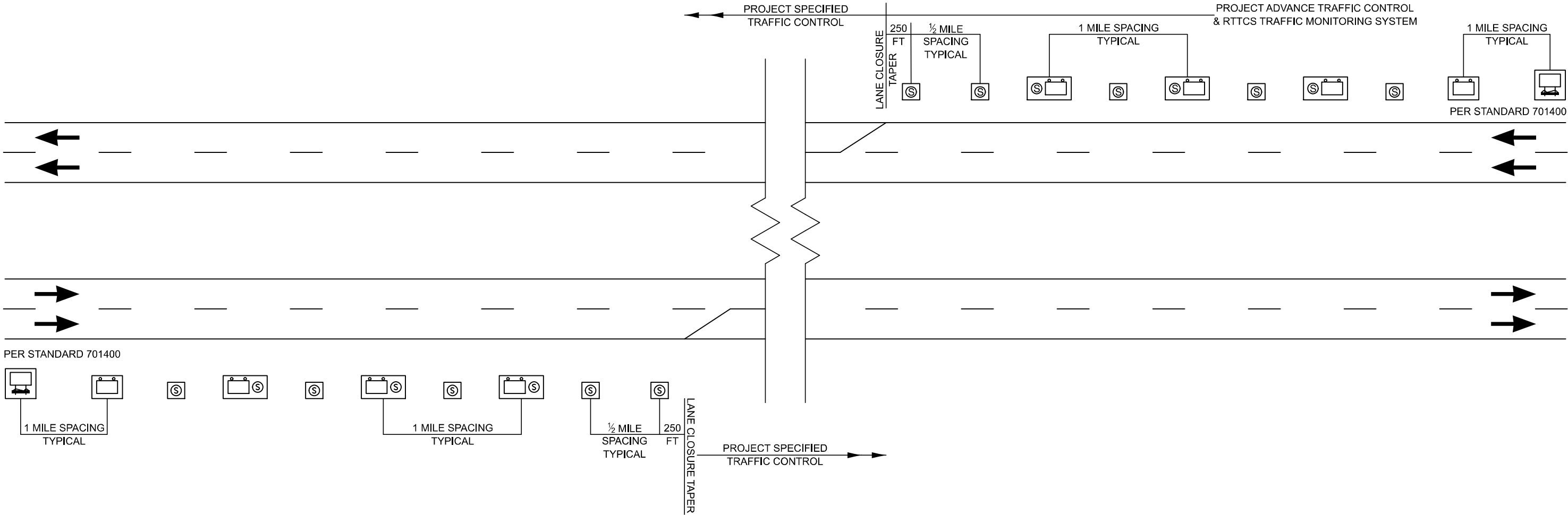

LEGEND

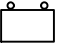

REAL-TIME TRAFFIC CONTROL WARNING SIGN
PROJECT SIGN SHALL BE A 48" X 96" (1200MM X 2400MM)
SIGN THAT SAYS:
"STOPPED TRAFFIC NEXT MILE WHEN FLASHING".



SINGLE PORTABLE CHANGEABLE MESSAGE SIGN PLACED 1 MILE
IN ADVANCE OF THE REAL-TIME TRAFFIC CONTROL WARNING SIGN.
IT SHALL READ: "RIGHT/LEFT LANE CLOSED // X MILES AHEAD"
THIS PORTABLE CHANGEABLE MESSAGE SIGN IS INCLUDED IN STANDARD 701400



REAL-TIME TRAFFIC MONITORING SENSOR UNIT

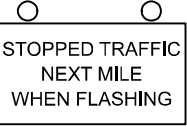

STOPPED TRAFFIC
NEXT MILE
WHEN FLASHING

NOTES:

1. THE NUMBER OF REAL-TIME TRAFFIC CONTROL WARNINGS SIGNS MAY BE CHANGED AS DIRECTED BY THE ENGINEER. RELOCATION OF REAL-TIME TRAFFIC CONTROL STATIC WARNING SIGNS IS INCLUDED IN THE REAL-TIME TRAFFIC CONTROL PAY ITEMS.
2. REAL-TIME TRAFFIC CONTROL MONITORING SENSOR UNITS SPACED APPROXIMATELY EVERY 1/2 MILE AND REAL-TIME TRAFFIC CONTROL WARNING SIGNS SPACED EVERY 1 MILE OR AS DIRECTED BY THE ENGINEER.
3. THE FIRST REAL-TIME TRAFFIC MONITORING SENSORS UNIT IS TO BE PLACED 250 FOOT UPSTREAM OF THE TAPER.
4. THE SECOND REAL-TIME SPEED TRAFFIC MONITORING SENSOR UNIT IS TO BE PLACED 250 FOOT IN ADVANCE OF THE RIGHT LANE/LEFT LANE CLOSED 1/2 MILE SIGN (STD. 701400).
5. THE FIRST REAL-TIME TRAFFIC CONTROL WARNINGS SIGN SHOULD BE PLACED 500 FOOT IN ADVANCE OF THE RIGHT/LEFT LANE CLOSED 1 MILE SIGN (STD. 701400)
6. THE NUMBER OF RTTCS DEVICES MAY BE REDUCED BASED ON THE LOCATION OF THE PORTABLE CHANGEABLE MESSAGE SIGN PER (STD. 701400) AS DIRECTED BY THE ENGINEER.

Note: All dimensions are in INCHES
(millimeters) unless otherwise shown.

DISTRICT 5 DETAIL NO. X032AAAA

USER NAME	= Bradley.Farnham	DESIGNED -	JWS	REVISED -	
		DRAWN -	BBP	REVISED -	
		CHECKED -		REVISED -	
PLOT DATE	= 1/27/2025	DATE	= 04/24	REVISED -	

STATE OF ILLINOIS
DEPARTMENT OF TRANSPORTATION

REAL-TIME TRAFFIC CONTROL SYSTEM

SCALE: SHEET 1 OF 1 SHEETS STA. TO STA.

F.A.I RTE.	SECTION	COUNTY	TOTAL SHEETS	SHEET NO.
74	(74-3)I	PIATT	11	11
CONTRACT NO. 70H56			ILLINOIS FED. AID PROJECT	