

STATE OF ILLINOIS
DEPARTMENT OF TRANSPORTATION

F.A.S RTE.	SECTION	COUNTY	TOTAL SHEETS	SHEET NO.
1323	(102)SFY	KANKAKEE	12	1
		ILLINOIS	CONTRACT NO. 66N61	

INDEX OF SHEETS

- 1 COVER SHEET
- 2 GENERAL NOTES
- 3-4 SUMMARY OF QUANTITIES
- 5-7 FLASHING BEACON LAYOUT PLAN
- 8 FLASHING BEACON CABLE PLAN
- 9-12 DETAILS

LIST OF ILLINOIS DOT HIGHWAY STANDARDS

- 000001-08 STANDARD SYMBOLS, ABBREVIATIONS AND PATTERNS
- 001006 DECIMAL OF AN INCH AND OF A FOOT
- 701001-02 OFF-ROAD OPERATIONS 2L, 2W, MORE THAN 15' (4.5 m) AWAY
- 701006-05 OFF-ROAD OPERATIONS 2L, 2W, 15' (4.5 m) TO 24" (600 mm) FROM PAVEMENT EDGE
- 701201-05 LANE CLOSURE, 2L, 2W, DAY ONLY, FOR SPEEDS ≥ 45 MPH
- 701901- 10 TRAFFIC CONTROL DEVICES
- 805001-01 ELECTRICAL SERVICE INSTALLATION DETAILS
- 814001-03 HANDHOLES
- 862001-01 UNINTERRUPTABLE POWER SUPPLY (UPS)
- 873001-02 TRAFFIC SIGNAL GROUNDING & BONDING
- 880001-01 SPAN WIRE MOUNTED SIGNALS AND FLASHING BEACON INSTALLATION

PROPOSED
HIGHWAY PLANS

FAS ROUTE 1323 (IL 115)
SECTION (102)SFY
PROJECT HSIP 94YU(547)
FLASHING BEACON INSTALLATION
KANKAKEE COUNTY

C-93-097-23

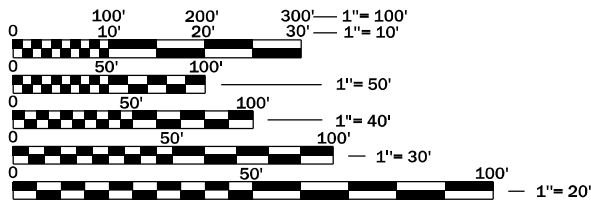

FULL SIZE PLANS HAVE BEEN PREPARED USING STANDARD
ENGINEERING SCALES. REDUCED SIZED PLANS WILL NOT
CONFORM TO STANDARD SCALES. IN MAKING MEASUREMENTS
ON REDUCED PLANS, THE ABOVE SCALES MAY BE USED.

J.U.L.I.E.
JOINT UTILITY LOCATION INFORMATION FOR EXCAVATION
1-800-892-0123
OR 811

PROJECT ENGINEER: NICHOLAS SPENCE, P.E.
UNIT CHIEF: BRANDON CRISS
DISTRICT 3 NO. (815) 434-6131
CONTRACT NO. 66N61

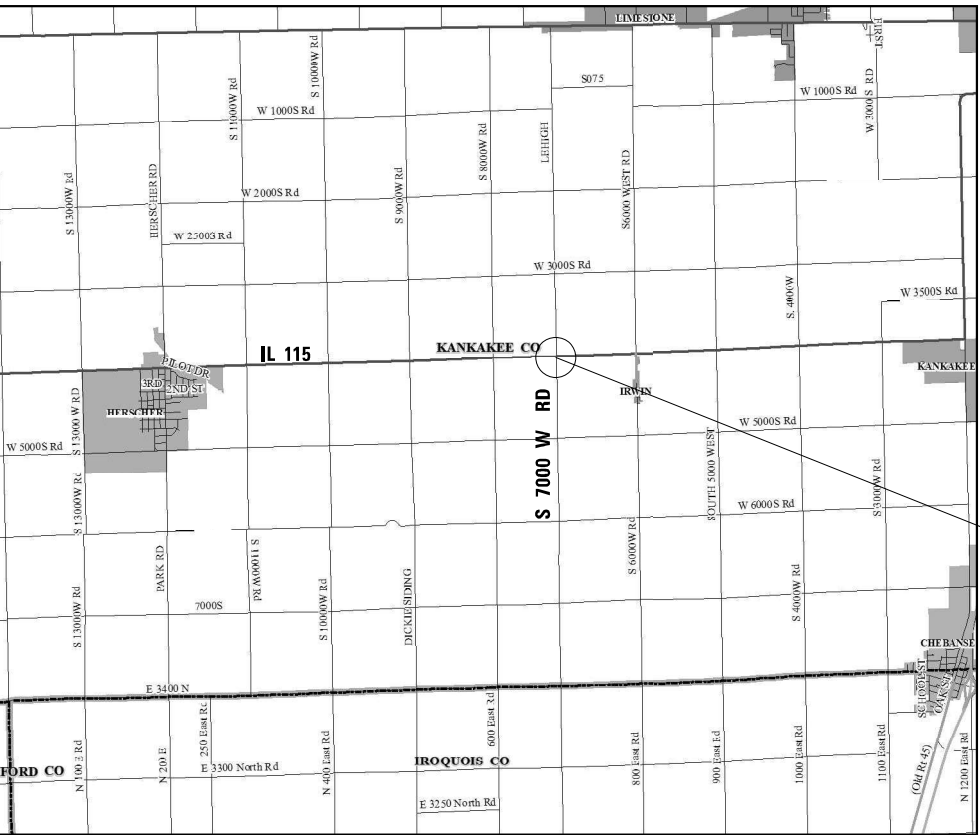

PROJECT LOCATION
IL 115 & W LEHIGH RD

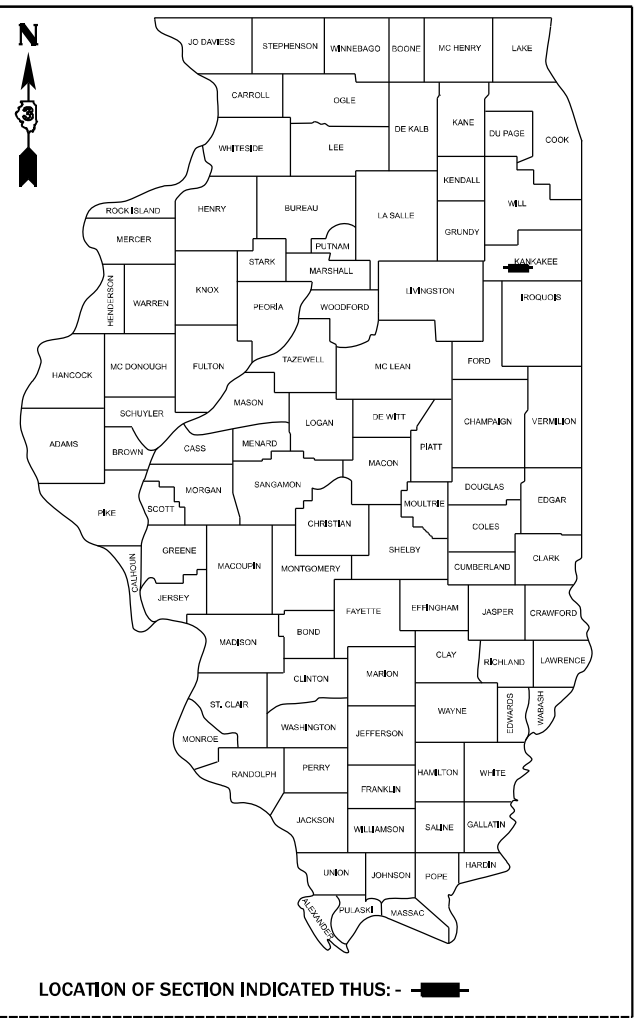

IL 115 - MAJOR COLLECTOR
2023 ADT = 1300
P.V. = 87.6% S.U. = 6.2% M.U. = 6.2%

STATE OF ILLINOIS
DEPARTMENT OF TRANSPORTATION

SUBMITTED January 31, 2025

Tasha Thompson REGIONAL ENGINEER

March 21, 2025

Scott A. Etkin ENGINEER OF DESIGN AND ENVIRONMENT

March 21, 2025

Y. H. H. H. DIRECTOR OF HIGHWAYS PROJECT IMPLEMENTATION

PRINTED BY THE AUTHORITY
OF THE STATE OF ILLINOIS

GROSS & NET LENGTH = POINT LOCATION

GENERAL NOTES

THE TRAFFIC SIGNAL SECTION AT THE ILLINOIS DEPARTMENT OF TRANSPORTATION, DISTRICT 3, SHALL BE NOTIFIED BY THE CONTRACTOR AT 815-434-8506 AT LEAST 72 HOURS PRIOR TO TURNING ON ANY FLASHER OR CONTROLLER UNITS.

A ¼” DIAMETER CONTINUOUS RODENT RESISTANT NYLON ROPE SHALL BE FURNISHED AND LEFT IN PLACE IN ALL CONDUITS BETWEEN HANDHOLES AND FOUNDATIONS OR CONTROLLER. THIS COST SHALL BE INCLUDED WITH THE COST OF CONDUIT PAY ITEM.

THE CONTRACTOR SHALL ARRANGE FOR A FACTORY OR SUPPLIER REPRESENTATIVE TO BE PRESENT AT THE INTERSECTION WHEN THE FLASHERS ARE TURNED ON. COST TO BE INCLUDED WITH THE FLASHER CONTROLLER PAY ITEM.

ALL CONDUIT IN TRENCH SHALL BE P.V.C. ALL PUSHED CONDUIT MAY BE P.V.C. OR GALVANIZED STEEL. CONDUIT ATTACHED TO STRUCTURES SHALL BE GALVANIZED STEEL.

ALL UTILITIES CROSSING UNDER DITCHES AND RAILROAD TRACKAGE USING HORIZONTAL DIRECTIONAL DRILLING (HDD) INSTALLATION SHOULD HAVE A MINIMUM DEPTH OF COVER OF SIX (6) FEET BELOW THE FLOWLINE OF THE DITCH OR GROUND SURFACE AND TWELVE (12) FEET FROM BASE OF RAIL IN FILL SECTIONS,THE NATURAL GROUND LINE AT THE TOE OF SLOPE WILL BE CONSIDERED AS DITCH GRADE

THE ELECTRICAL CONDUCTORS FOR ALL FLASHERS SHALL BE SOLID, SOFT COPPER.

ALL THREADS OF BOLTS USED IN THE ASSEMBLY OF TRAFFIC SIGNAL COMPONENTS SHALL BE COATED WITH A NON-LEAD BASED ANTI-SEIZE COMPOUND, SIMILAR TO LEAD PLATE, PRIOR TO ASSEMBLY.

ALL HARDWARE SHALL BE TIGHTENED AND WELL SECURED, CABLES SHALL BE NEATLY WOUND IN HANDHOLES. CABLES SHALL BE NEATLY TRAINED IN THE CONTROLLER CABINET.

THE CONTRACTOR SHALL BE RESPONSIBLE FOR OBTAINING ELECTRICAL SERVICE FOR THE FLASHERS. THE CONTRACTOR SHALL CONTACT THE UTILITY COMPANY PRIOR TO BEGINNING WORK TO OBTAIN THE UTILITY COMPANY REQUIREMENTS FOR THE SERVICE INSTALLATION.

BACKPLATES SHALL BE POLYCARBONATE, LOUVERED FORMED BACKPLATES.

ALL VEHICLE AND PEDESTRIAN SIGNAL HEADS SHALL HAVE POLYCARBONATE BLACK HOUSING AND BLACK BRACKETS.

ALL UNINTERRUPTIBLE POWER SUPPLIES SHALL BE EQUIPPED WITH ALPHA GUARD MONITORS.

GENERAL NOTES CONT.

ALL AREAS DISTURBED BY THE CONTRACTOR SHALL BE RESTORED WITH SEED OR SOD TO THE SATISFACTION OF THE ENGINEER. SEEDING OR SODDING SHALL NOT BE PERMITTED AT ANY TIME WHEN THE GROUND IS FROZEN, WET, OR IN AN UNTILLABLE CONDITION.

THE SURGE PROTECTOR IN THE CONTROLLER CABINET SHALL HAVE AN INDICATOR LIGHT.

ALL EXCAVATED MATERIAL, WHICH INCLUDES DIGGING OR GRADING OF ANY SOIL OR FILL MATERIAL, WITH THE EXCEPTION OF AGGREGATE FILLS, MUST BE INCORPORATED WITHIN THE IDOT RIGHT OF WAY DUE TO ENVIRONMENTAL DOCUMENTATION REQUIREMENTS.

MEMBERS OF JULIE KNOWN TO BE WITHIN THE LIMITS OF THE IMPROVEMENT ARE:
- AT&T
- COMED
- COMCAST

NON-MEMBERS OF JULIE KNOWN TO BE WITHIN THE LIMITS OF THE IMPROVEMENT ARE:
-VULCAN MATERIALS

COMMITMENTS:

ANY REMOVAL OF SOLAR POWERED SIGNS AND SOLAR PANELS SHALL BE RETURNED TO IDOT TRAFFIC DEPARTMENT AND DELIVERED TO EITHER THE OTTAWA OR PONTIAC SIGN SHOP. CONTACT ANDREW CARMIN AT (815) 434-8465 TO ARRANGE DELIVERY.

STATE OF ILLINOIS
DEPARTMENT OF TRANSPORTATION
DISTRICT THREE
AS BUILT INFORMATION

SUPERVISING CONSTRUCTION FIELD ENGINEER

RESIDENT ENGINEER / TECHNICIAN

START & END DATES
OF CONSTRUCTION:

INSPECTORS:

MODEL: General Notes [Sheet]
FILE NAME: c:\p\work\pw\idot\brandon.criss@illinois.gov\00878439\036N61 SHEET.dgn

	USER NAME = brandon.criss	DESIGNED -	REVISED -	STATE OF ILLINOIS DEPARTMENT OF TRANSPORTATION	GENERAL NOTES			F.A.S RTE.	SECTION	COUNTY	TOTAL SHEETS	SHEET NO.
		DRAWN -	REVISED -					1323	(102)SFY	KANKAKEE	12	2
	PLOT SCALE = \$SCALE\$	CHECKED -	REVISED -					CONTRACT NO. 66N61				
	PLOT DATE = 1/30/2025	DATE -	REVISED -		SCALE:	SHEET 1	OF 1 SHEETS	STA. __+__	TO STA. __+__	ILLINOIS FED. AID PROJECT		

MODEL: SQQ - 1 [Sheet]
FILE NAME: c:\p\work\pww\brandon.criss@illinois.gov\0878439\0366\N61 - SHEET.dgn

				90% FED 10% STATE
				CONSTR. CODE
				KANKAKEE
CODE NO.	ITEM	UNIT	TOTAL QUANTITY	SAFETY
				0021
				RURAL
67100100	MOBILIZATION	L SUM	1	1
70100450	TRAFFIC CONTROL AND PROTECTION, STANDARD 701201	L SUM	1	1
* 72000100	SIGN PANEL - TYPE 1	SQ FT	8	8
* 72400310	REMOVE SIGN PANEL - TYPE 1	SQ FT	8	8
* 72400710	RELOCATE SIGN PANEL - TYPE 1	SQ FT	7	7
73000100	WOOD SIGN SUPPORT	FOOT	1	1
80500300	SERVICE INSTALLATION, TYPE C	EACH	1	1
81028200	UNDERGROUND CONDUIT, GALVANIZED STEEL, 2" DIA.	FOOT	246	246
81028350	UNDERGROUND CONDUIT, PVC, 2" DIA.	FOOT	1572	1572
81100500	CONDUIT ATTACHED TO STRUCTURE, 1 1/2" DIA., GALVANIZED STEEL	FOOT	63	63
81400700	HANDHOLE, PORTLAND CEMENT CONCRETE	EACH	7	7
85800100	FLASHER CONTROLLER	EACH	1	1
87301215	ELECTRIC CABLE IN CONDUIT, SIGNAL NO. 14 2C	FOOT	2127	2127
87301805	ELECTRIC CABLE IN CONDUIT, SERVICE, NO. 6 2 C	FOOT	5	5

*= SPECIALTY ITEM

	USER NAME = brandon.criss	DESIGNED -	REVISED -	STATE OF ILLINOIS DEPARTMENT OF TRANSPORTATION	SUMMARY OF QUANTITIES			F A S RTE.	SECTION	COUNTY	TOTAL SHEETS	SHEET NO.
		DRAWN -	REVISED -					1323	(102)SFY	KANKAKEE	12	3
	PLOT SCALE = \$\$CALE\$	CHECKED -	REVISED -					CONTRACT NO. 66N61				
	PLOT DATE = 1/29/2025	DATE -	REVISED -		SCALE:	SHEET 1	OF 2 SHEETS	STA. +	TO STA. +	ILLINOIS FED. AID PROJECT		

MODEL: SQO - 2 [Sheet]
FILE NAME: c:\p\work\p\work\brandon.criss@illinois.gov\0878439\0366\61-SHEET.dgn





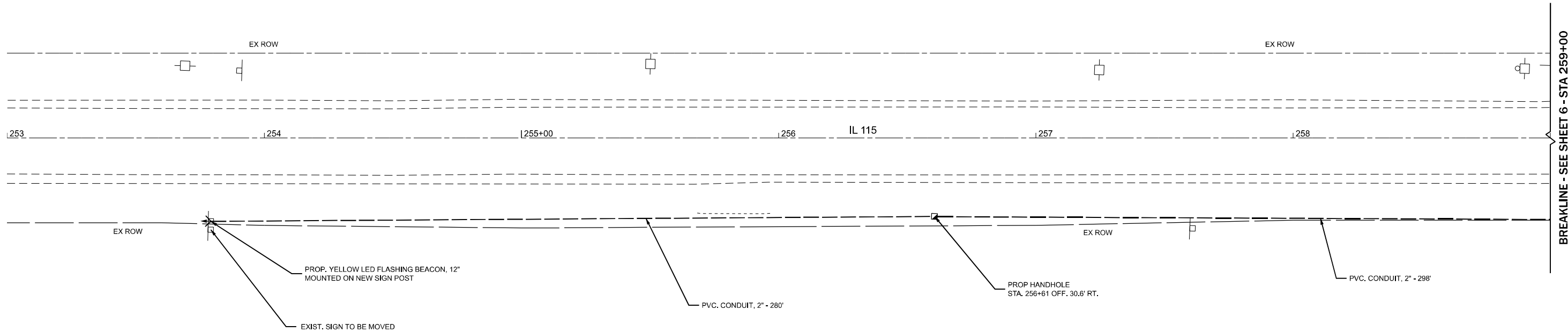

	USER NAME = brandon.criss	DESIGNED -	REVISED -	STATE OF ILLINOIS DEPARTMENT OF TRANSPORTATION	SUMMARY OF QUANTITIES			F.A.S RTE.	SECTION	COUNTY	TOTAL SHEETS	SHEET NO.
		DRAWN -	REVISED -					1323	(102)SFY	KANKAKEE	12	4
	PLOT SCALE = \$\$CALE\$	CHECKED -	REVISED -					CONTRACT NO. 66N61				
	PLOT DATE = 1/29/2025	DATE -	REVISED -		SCALE:	SHEET 2	OF 2	SHEETS	STA. + TO STA. +	ILLINOIS FED. AID PROJECT		

				90% FED 10% STATE
				CONSTR. CODE
				KANKAKEE
CODE NO.	ITEM	UNIT	TOTAL QUANTITY	SAFETY
				0021
				RURAL
87301900	ELECTRIC CABLE IN CONDUIT, EQUIPMENT GROUNDING CONDUCTOR, NO. 6 1C	FOOT	2127	2127
88040030	SIGNAL HEAD, POLYCARBONATE, LED, 1-FACE, 1-SECTION, POST MOUNTED	EACH	4	4
X7200061	TEMPORARY INFORMATION SIGNING	SQ FT	84	84
X8302125	WOOD POLE, 25 FT, CLASS 4	EACH	1	1
X8620200	UNINTERRUPTABLE POWER SUPPLY (SPECIAL)	EACH	1	1

MODEL: plan2 - Plan 4 (Sheet)
FILE NAME: c:\pwy_work\pwyid\brandon.criss@illinois.gov\00878439\0366N61 Layout 3.dgn



TRAFFIC SIGNALS LEGEND

-  **PROPOSED SERVICE INSTALLATION**
-  **PROPOSED FLASHER CONTROLLER**
-  **PROPOSED WOOD POLE**
-  **PROPOSED FLASHING BEACON**
-  **PROPOSED HANDHOLE**
-  **PROPOSED CONDUIT**

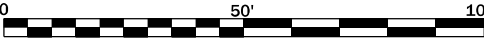

	USER NAME = brandon.criss	DESIGNED -	REVISED -	STATE OF ILLINOIS DEPARTMENT OF TRANSPORTATION	FLASHING BEACON LAYOUT PLAN			F.A.S RTE.	SECTION	COUNTY	TOTAL SHEETS	SHEET NO.
	PLOT SCALE = \$SCALE\$	CHECKED -	REVISED -					1323	(102)SFY	KANKAKEE	12	5
	PLOT DATE = 1/29/2025	DATE -	REVISED -		SCALE: 1"=20'			CONTRACT NO. 66N61				
					SHEET 1	OF 3	SHEETS	STA. 253+00.00	TO STA. 259+00.00	ILLINOIS FED. AID PROJECT		

MODEL: plan2 - Plan 5 (Sheet)
FILE NAME: c:\p\work\p\work\brandon.criss@illinois.gov\00878439\0366N61 Layout 3.dgn

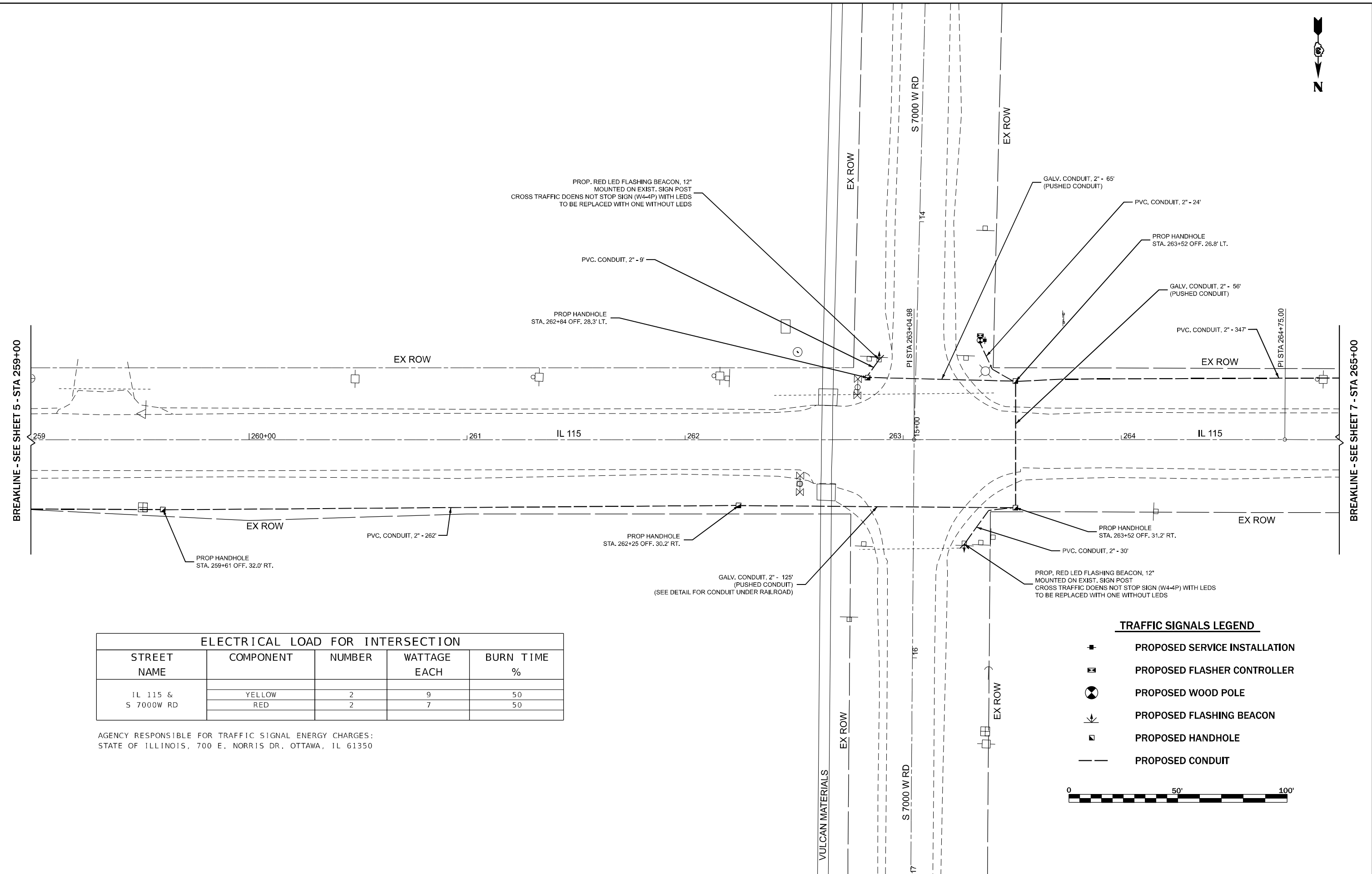

ELECTRICAL LOAD FOR INTERSECTION				
STREET NAME	COMPONENT	NUMBER	WATTAGE EACH	BURN TIME %
IL 115 & S 7000W RD	YELLOW	2	9	50
	RED	2	7	50

AGENCY RESPONSIBLE FOR TRAFFIC SIGNAL ENERGY CHARGES:
STATE OF ILLINOIS, 700 E. NORRIS DR. OTTAWA, IL 61350

TRAFFIC SIGNALS LEGEND

PROPOSED SERVICE INSTALLATION

PROPOSED FLASHER CONTROLLER

PROPOSED WOOD POLE

PROPOSED FLASHING BEACON

PROPOSED HANDHOLE

PROPOSED CONDUIT



BREAKLINE - SEE SHEET 6 - STA 265+00

PROP HANDHOLE
STA. 267+01 OFF. 30.4' LT.

PVC. CONDUIT, 2" - 322'

PROP. YELLOW LED FLASHING BEACON, 12"
MOUNTED ON EXIST. SIGN POST

EX ROW

EX ROW

265+00

266

267

268

IL 115

269

270+00

TRAFFIC SIGNALS LEGEND

- PROPOSED SERVICE INSTALLATION
- PROPOSED FLASHER CONTROLLER
- PROPOSED WOOD POLE
- PROPOSED FLASHING BEACON
- PROPOSED HANDHOLE
- PROPOSED CONDUIT

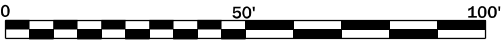

MODEL: plan2 - Plan 6 [Sheet]
FILE NAME: c:\p\work\p\work\brandon.criss@illinois.gov\00878439\0366N61 Layout 3.dgn

USER NAME	= brandon.criss	DESIGNED	-	REVISED	-
		DRAWN	-	REVISED	-
PLOT SCALE	= \$\$SCALE\$	CHECKED	-	REVISED	-
PLOT DATE	= 1/29/2025	DATE	-	REVISED	-

STATE OF ILLINOIS
DEPARTMENT OF TRANSPORTATION

FLASHING BEACON LAYOUT PLAN

SCALE: 1"=20' SHEET 3 OF 3 SHEETS STA. 265+00.00 TO STA. 271+00.00

F.A.S RTE.	SECTION	COUNTY	TOTAL SHEETS	SHEET NO.
1323	(102)SFY	KANKAKEE	12	7
CONTRACT NO. 66N61				
ILLINOIS FED. AID PROJECT				

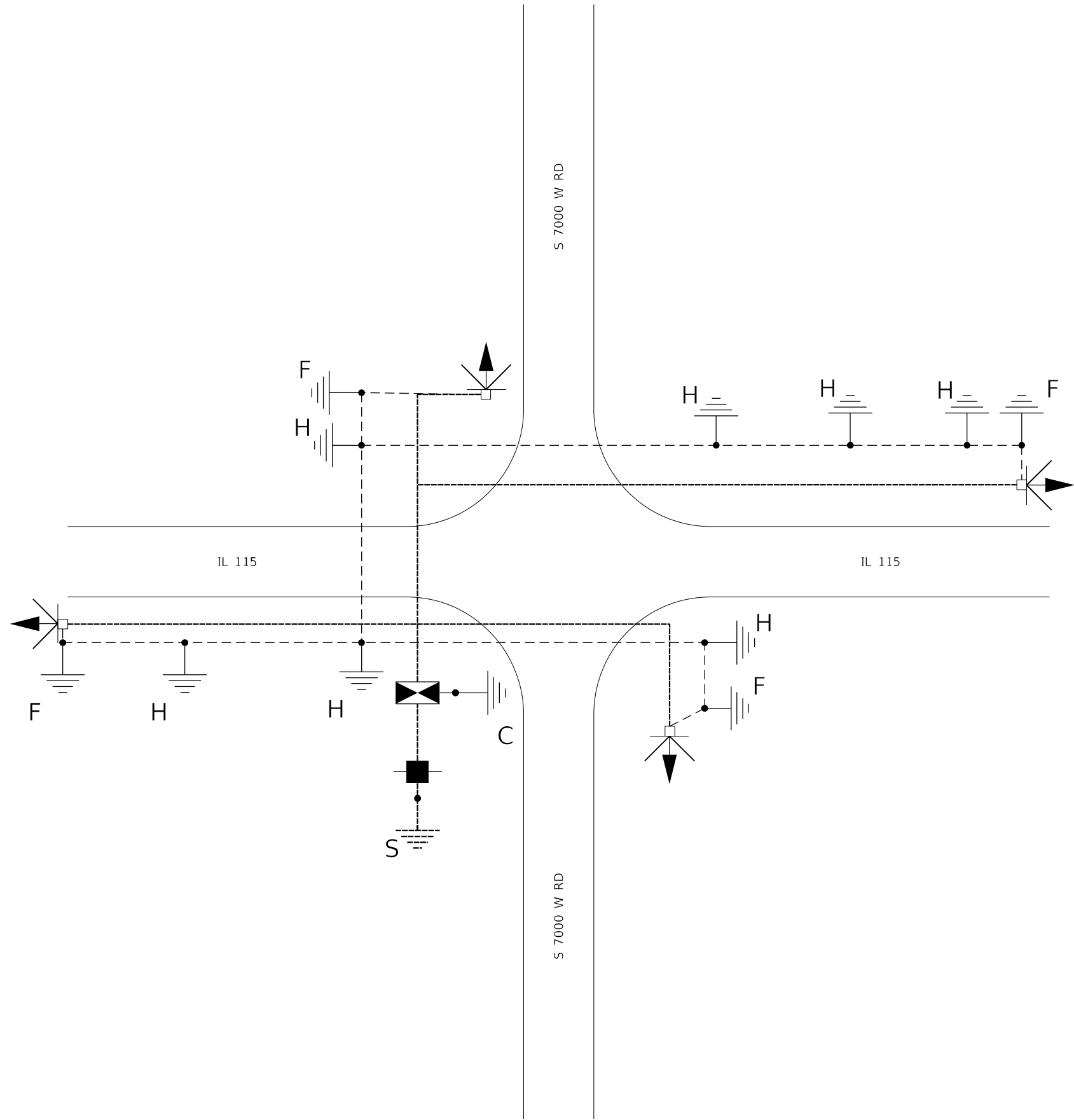

TRAFFIC SIGNALS LEGEND

- PROPOSED SERVICE INSTALLATION
- PROPOSED FLASHER CONTROLLER
- PROPOSED FLASHING BEACON
- PROPOSED HANDHOLE
- NO 14 2C
- NO 6 1C GROUNDING
- GROUNDING
 - F - FLASHER
 - C - CONTROLLER
 - S - SERVICE
 - H - HANDHOLE

MODEL: Cable PLAN [Sheet]
FILE NAME: c:\p\work\p\td\smur.kinfe@illinois.gov\0878439\0366N61 SHEET.dgn

USER NAME = Smur.Kinfe	DESIGNED -	REVISED -
DRAWN -	REVISED -	
PLOT SCALE = \$SCALE\$	CHECKED -	REVISED -
PLOT DATE = 1/24/2025	DATE -	REVISED -

STATE OF ILLINOIS
DEPARTMENT OF TRANSPORTATION

FLASHING BEACON CABLE PLAN

SCALE: SHEET 1 OF 1 SHEETS STA. ____+____ TO STA. ____+____

F.A.S RTE.	SECTION	COUNTY	TOTAL SHEETS	SHEET NO.
1323	(102)SFY	KANKAKEE	12	8
CONTRACT NO. 66N61				
ILLINOIS FED. AID PROJECT				

MODEL: Detail 1 (Sheet)
FILE NAME: c:\p\work\wdot\smur.kinfe@illinois.gov\d0878439\0366N61 SHEET.dgn

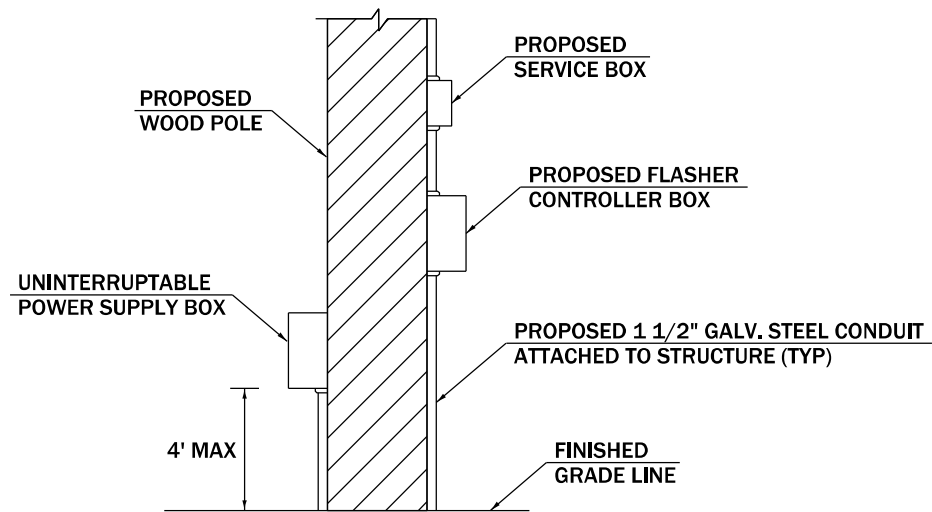

INTERSECTION CONTROLLER/SERVICE BOX INSTALLATION DETAIL (NTS)

NOTE: THE IDOT TRAFFIC SIGNAL SECTION SHALL BE CONTACTED AT 815-434-8506 BEFORE THE EQUIPMENT IS MOUNTED TO VERIFY AN ACCEPTABLE PLACEMENT AND ORIENTATION ON THE POLE

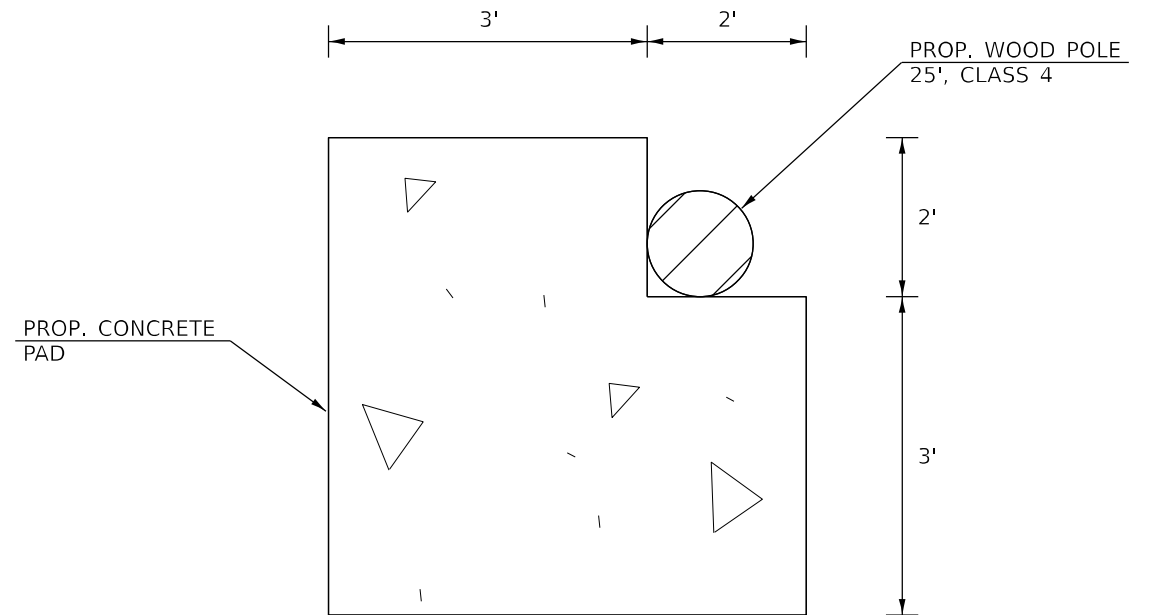

TOP VIEW

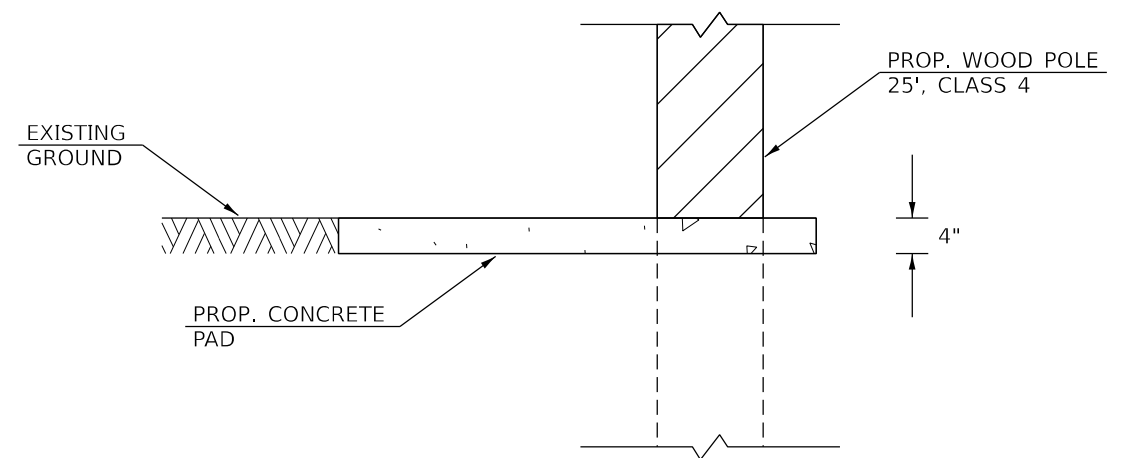

FRONT VIEW

WOOD POLE AND CONCRETE PAD LAYOUT

STATE OF ILLINOIS
DEPARTMENT OF TRANSPORTATION

DETAILS

SCALE: SHEET 1 OF 2 SHEETS STA. ____+____ TO STA. ____+____

F.A.S RTE.	SECTION	COUNTY	TOTAL SHEETS	SHEET NO.
1323	(102)SFY	KANKAKEE	12	9
CONTRACT NO. 66N61				
ILLINOIS FED. AID PROJECT				

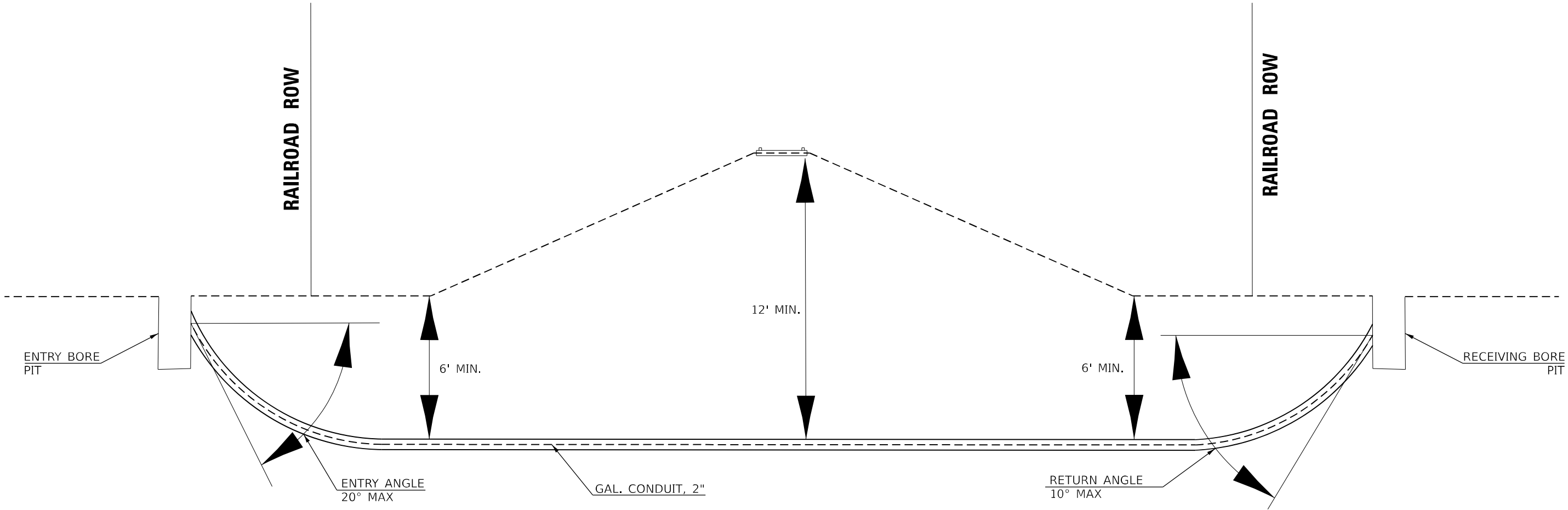

CONDUIT UNDER RAILROAD

MODEL: Detail 2 [Sheet]
FILE NAME: c:\p\work\p\work\smur.kinfe@illinois.gov\d0878439\0366\61 SHEET.dgn

	USER NAME = Smur.Kinfe	DESIGNED -	REVISED -	STATE OF ILLINOIS DEPARTMENT OF TRANSPORTATION	DETAILS			F.A.S RTE.	SECTION	COUNTY	TOTAL SHEETS	SHEET NO.
	PLOT SCALE = \$SCALE\$	DRAWN -	REVISED -					1323	(102)SFY	KANKAKEE	12	10
	PLOT DATE = 1/24/2025	CHECKED -	REVISED -		SCALE: SHEET 2 OF 2 SHEETS STA. ____+____ TO STA. ____+____			CONTRACT NO. 66N61				
		DATE -	REVISED -					ILLINOIS FED. AID PROJECT				

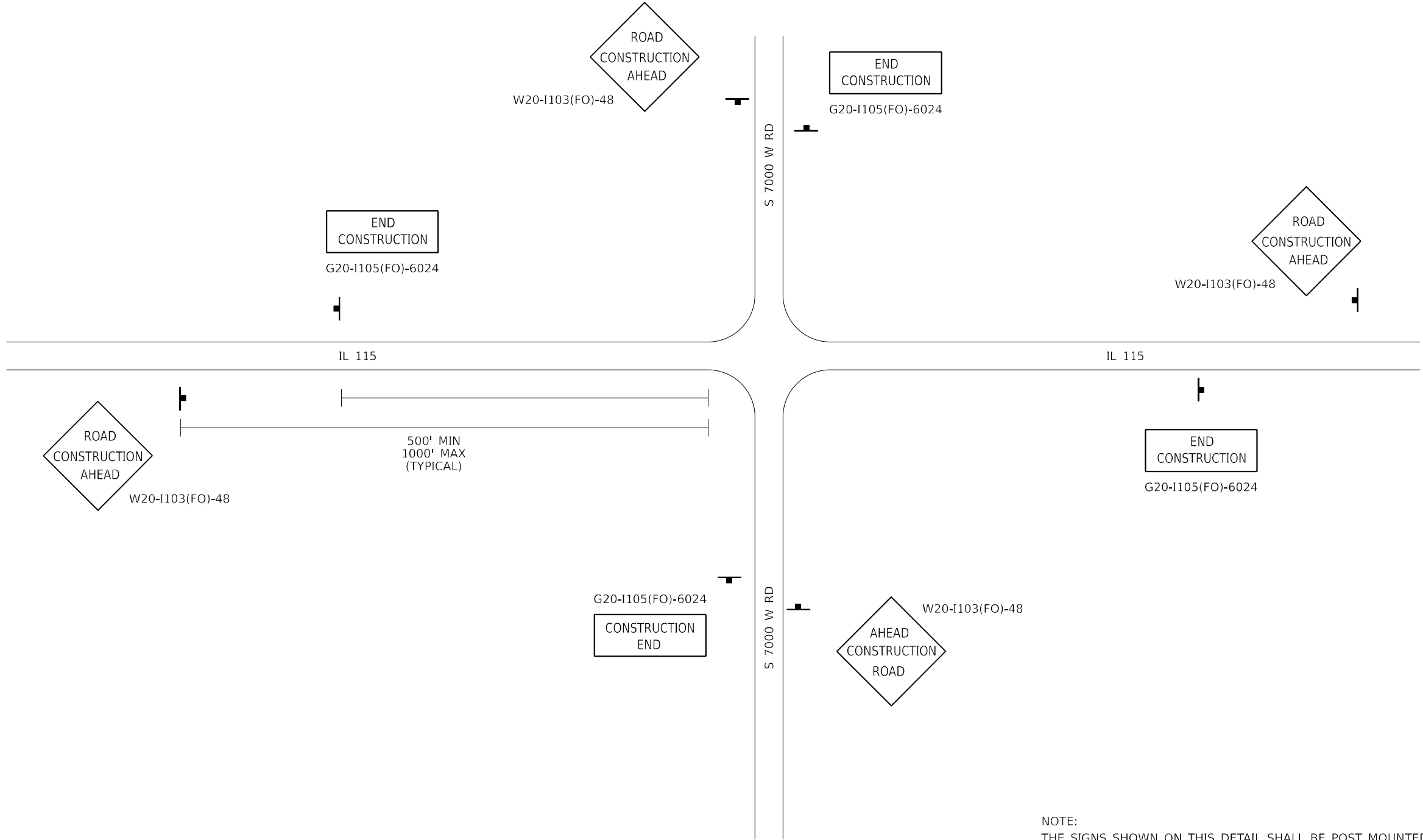

NOTE:
THE SIGNS SHOWN ON THIS DETAIL SHALL BE POST MOUNTED
AND THE PLACEMENT OF SIGNS SHALL BE CONSIDERED INCIDENTAL
TO TRAFFIC CONTROL AND PROTECTION STANDARD 701306

MODEL: Traffic Control Detail 1 [Sheet]
FILE NAME: c:\p\work\roads\smur.kinfe@illinois.gov\d0878439\0366N61 SHEET.dgn

	USER NAME = Smur.Kinfe	DESIGNED -	REVISED -	STATE OF ILLINOIS DEPARTMENT OF TRANSPORTATION	TRAFFIC CONTROL DETAILS			F.A.S RTE.	SECTION	COUNTY	TOTAL SHEETS	SHEET NO.
	PLOT SCALE = \$SCALE\$	DRAWN -	REVISED -					1323	(102)SFY	KANKAKEE	12	11
	PLOT DATE = 1/24/2025	CHECKED -	REVISED -		SCALE: SHEET 1 OF 2 SHEETS STA. ____+____ TO STA. ____+____			CONTRACT NO. 66N61				
		DATE -	REVISED -					ILLINOIS FED. AID PROJECT				

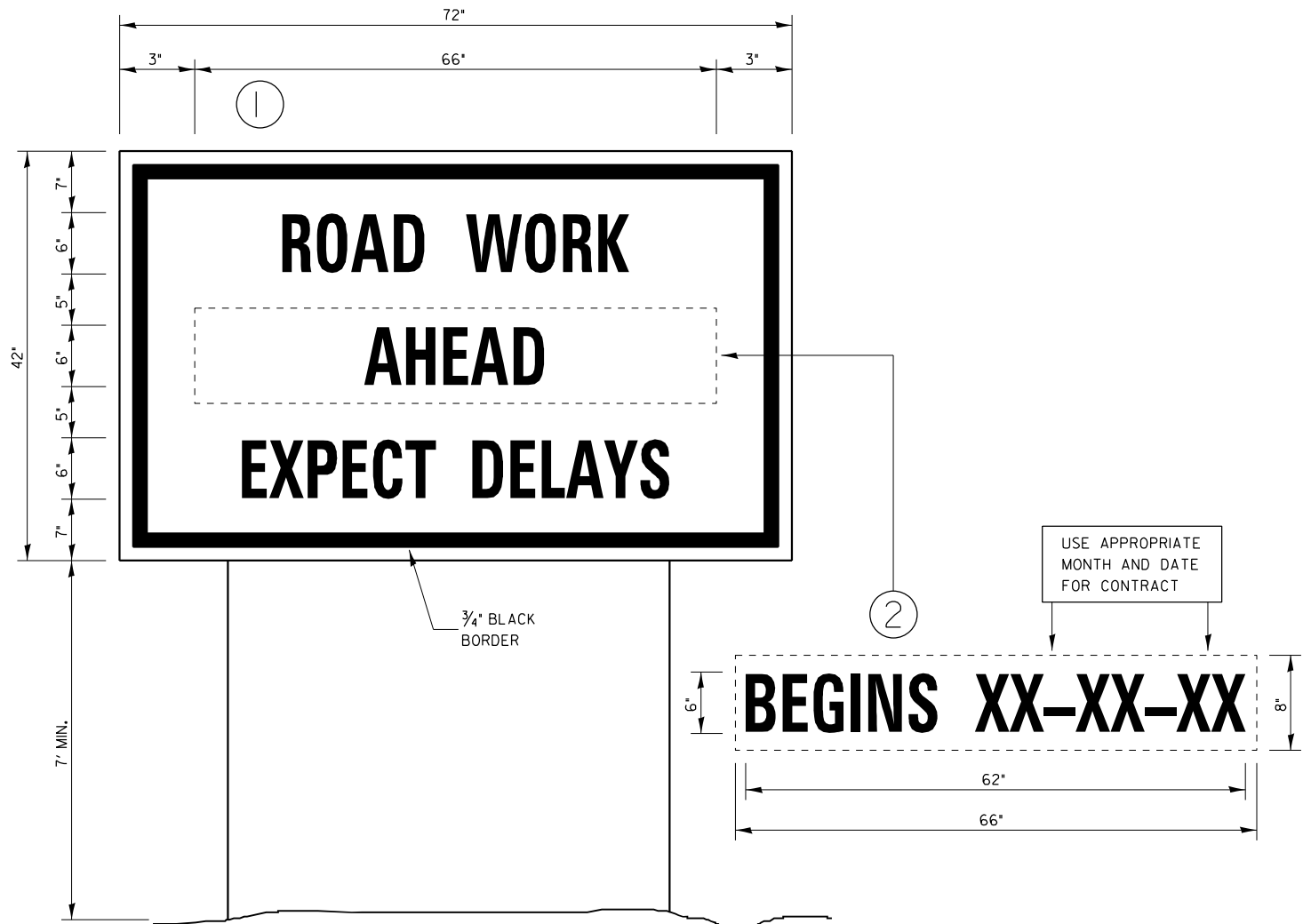

TEMPORARY INFORMATION SIGNING

NOTES:

1. USE 6"D BLACK LETTERING ON FLUORESCENT ORANGE BACKGROUND.
2. ERECT SIGNS AT LOCATIONS IN ADVANCE OF THE "ROAD CONSTRUCTION AHEAD" SIGNS AS DIRECTED BY THE ENGINEER.
3. ERECT SIGN ① WITH INSTALLED PANEL ② A MINIMUM OF ONE WEEK PRIOR TO THE START OF THE LANE CLOSURE.
4. REMOVE PANEL ② ON THAT DATE.
5. SEE SPECIAL PROVISION "TEMPORARY INFORMATION SIGNING" FOR ADDITIONAL INFORMATION.
6. WILL BE PAID FOR PER SO FT AS "TEMPORARY INFORMATION SIGNING". EACH SIGN = 2150 FT AND THE DATE PANEL ② WILL NOT BE MEASURED SEPARATELY FOR PAYMENT.

MODEL: Traffic Control Detail 2 (Sheet)
FILE NAME: c:\p\work\work\smur.kinfo@illinois.gov\0878439D366N61 SHEET.dgn

	USER NAME = Smur.Kinfo	DESIGNED -	REVISED -	STATE OF ILLINOIS DEPARTMENT OF TRANSPORTATION	TRAFFIC CONTROL DETAILS			F.A.S RTE.	SECTION	COUNTY	TOTAL SHEETS	SHEET NO.
	PLOT SCALE = \$SCALE\$	DRAWN -	REVISED -					1323	(102)SFY	KANKAKEE	12	12
	PLOT DATE = 1/24/2025	CHECKED -	REVISED -		SCALE: SHEET 2 OF 2 SHEETS STA. ____+____ TO STA. ____+____			CONTRACT NO. 66N61				
		DATE -	REVISED -					ILLINOIS FED. AID PROJECT				