

STATE OF ILLINOIS
DEPARTMENT OF TRANSPORTATION

F.A.I. RTE.	SECTION	COUNTY	TOTAL SHEETS	SHEET NO.
55	2024-1044-RS	WILL	14	1
		ILLINOIS	CONTRACT NO. 62X85	

FOR INDEX OF SHEETS, SEE SHEET NO. 2

THIS PROJECT IS LOCATED IN THE
CITY OF WILMINGTON, AND THE
VILLAGE OF DIAMOND

TRAFFIC DATA:
I-55 WEST FRONTAGE ROAD
ADT = N/A
SPEED LIMIT = 55 MPH

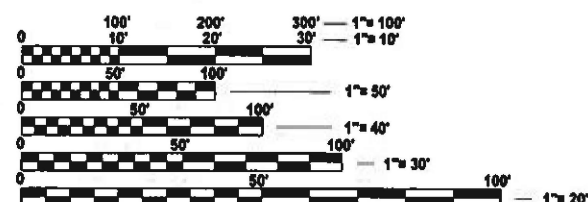

FULL SIZE PLANS HAVE BEEN PREPARED USING STANDARD
ENGINEERING SCALES. REDUCED SIZED PLANS WILL NOT
CONFORM TO STANDARD SCALES. IN MAKING MEASUREMENTS
ON REDUCED PLANS, THE ABOVE SCALES MAY BE USED.

J.U.L.I.E.
JOINT UTILITY LOCATION INFORMATION FOR EXCAVATION
1-800-892-0123
OR 811

PROJECT ENGINEER: DAN WILGREEN (847) 705-4240
PROJECT MANAGER: J. ALAIN MIDY (847) 221-3056

CONTRACT NO. 62X85

PROPOSED HIGHWAY PLANS

F.A.I. ROUTE 55 (I-55 WEST FRONTAGE ROAD)
SOUTH OF STRIPMINE ROAD TO IL 113 (DIVISION STREET)
SECTION: 2024-1044-RS
PROJECT: STP-9NPL(918)
DESIGNED OVERLAY
WILL COUNTY

C-91-111-25
R 9 E

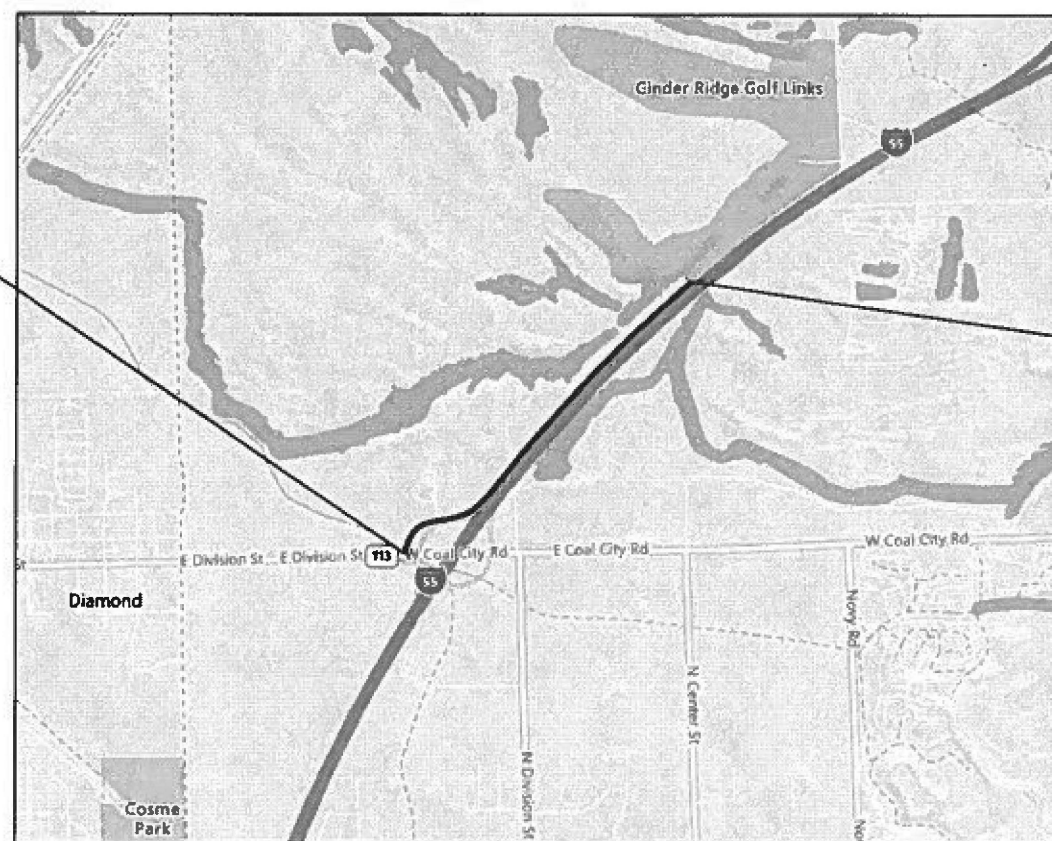

PROJECT BEGINS
STA. 10+21

PROJECT ENDS
STA. 73+00

WILMINGTON TOWNSHIP

GROSS AND NET LENGTH = 6,279 FT. = 1.19 MILES



STATE OF ILLINOIS
DEPARTMENT OF TRANSPORTATION

SUBMITTED Jan 29th 2025
JAN 29 2025
REGIONAL ENGINEER

March 21 2025
S. E. A. E. E.
ENGINEER OF DESIGN AND ENVIRONMENT

March 24 2025
J. M. A. E. E.
DIRECTOR OF HIGHWAYS PROJECT IMPLEMENTATION

PRINTED BY THE AUTHORITY
OF THE STATE OF ILLINOIS

INDEX OF SHEETS

SHEET NO. DESCRIPTION

1	COVER SHEET
2	INDEX OF SHEETS, HIGHWAY STANDARDS, AND GENERAL NOTES
3	SUMMARY OF QUANTITIES
4-5	EXISTING AND PROPOSED TYPICAL SECTIONS
6-8	EXISTING AND PROPOSED ROADWAY AND PAVEMENT MARKING PLAN
9	BD-22: PAVEMENT PATCHING FOR HMA SURFACED PAVEMENT
10	BD-32: BUTT JOINTS AND HMA TAPER DETAILS
11	TC-10: TRAFFIC CONTROL AND PROTECTION FOR SIDE ROADS, INTERSECTIONS, AND DRIVEWAYS
12	TC-11: RAISED REFLECTIVE PAVEMENT MARKERS (SNOW PLOW RESISTANT)
13	TC-13: DISTRICT ONE TYPICAL PAVEMENT MARKINGS
14	TC-22: ARTERIAL ROAD INFORMATION SIGN

HIGHWAY STANDARDS

STANDARD NO. DESCRIPTION

000001-08	STANDARD SYMBOLS, ABBREVIATIONS AND PATTERNS
442201-03	CLASS C AND D PATCHES
701006-05	OFF-RD OPERATIONS, 2L, 2W, 15' TO 24" FROM PAVEMENT EDGE
701011-04	OFF-RD MOVING OPERATIONS, 2L, 2W, DAY ONLY
701301-04	LANE CLOSURE, 2L 2W, SHORT TIME OPERATIONS
701306-04	LANE CLOSURE, 2L 2W, SLOW MOVING OPERATIONS DAY ONLY 45MPH OR MORE
701311-03	LANE CLOSURE, 2L 2W, MOVING OPERATIONS DAY ONLY
701336-07	LANE CLOSURE, 2L 2W, WORK AREAS IN SERIES 45MPH OR MORE
701701-10	URBAN LANE CLOSURE, MULTILANE INTERSECTION
701901-10	TRAFFIC CONTROL DEVICES
780001-05	TYPICAL PAVEMENT MARKINGS

GENERAL NOTES

- THE CONTRACTOR SHALL COORDINATE CONSTRUCTION ACTIVITIES WITH THE CITY OF WILMINGTON AND THE VILLAGE OF DIAMOND.
- THE CONTRACTOR SHALL CONTACT THE DISTRICT TRAFFIC CONTROL SUPERVISOR AT KALPANA.KANNAN-HOSADURGA@ILLINOIS.GOV A MINIMUM OF 72 HOURS IN ADVANCE OF BEGINNING WORK.
- THE RESIDENT ENGINEER SHALL CONTACT ERIC CAMPOS, AREA TRAFFIC FIELD ENGINEER, AT ERIC.CAMPOS@ILLINOIS.GOV A MINIMUM OF TWO (2) WEEKS PRIOR TO THE PLACEMENT OF PERMANENT PAVEMENT MARKINGS.
- THE CONTRACTOR WILL NOT BE ALLOWED TO SET UP A YARD OR FIELD OFFICE ON STATE PROPERTY WITHOUT WRITTEN PERMISSION FROM THE DEPARTMENT.
- ALL MILLED SURFACES SHALL BE A UNIFORM CROSS SLOPE PER LANE AND FREE OF RIDGES BETWEEN PASSES. ANY DEVIATIONS SHALL BE CORRECTED AT NO COST TO THE DEPARTMENT.
- BUTT JOINTS WILL BE INSTALLED AT THE ENDS OF ALL RESURFACING (WHERE RESURFACING MEETS EXISTING PAVEMENT) ACCORDING TO THE "BUTT JOINT AND HOT-MIX ASPHALT TAPER DETAILS" SHEET INCLUDED IN THE PLANS, UNLESS OTHERWISE SPECIFIED.
- IT SHALL BE THE CONTRACTOR'S RESPONSIBILITY TO VERIFY ALL DIMENSIONS AND CONDITIONS EXISTING IN THE FIELD PRIOR TO ORDERING MATERIALS AND BEGINNING CONSTRUCTION.
- THE CONTRACTOR SHALL BE REQUIRED TO PROVIDE ACCESS TO ABUTTING PROPERTY AT ALL TIMES DURING THE CONSTRUCTION OF THIS PROJECT.
- DROP-OFFS ADJACENT TO THE TRAVEL LANE SHALL BE KEPT AT A MINIMUM. PROTECTION OF THE DROP-OFF SHALL BE ACCORDING TO THE IDOT BUREAU OF SAFETY PROGRAMS AND ENGINEERING, SAFETY ENGINEERING POLICY MEMORANDUM 4-21. DROP-OFFS GREATER THAN OR EQUAL TO 12" WILL NOT BE ALLOWED AT LOCATIONS WHERE THE DROP-OFF IS LOCATED WITHIN 8 FT OF THE EDGE OF THE TRAVEL LANE. THE CONTRACTOR SHALL BE RESPONSIBLE FOR ENSURING THAT THE DROP-OFF AREAS MEET THE OFFSET, HEIGHT, AND DURATION REQUIREMENTS TO USE BARRICADES AT THE END OF EACH WORKDAY. THIS MAY REQUIRE THE CONTRACTOR TO REPLACE OR PLACE SUFFICIENT MATERIAL IN THE EXCAVATION TO REDUCE THE DROP-OFF TO BE COMPLIANT WITH THE REQUIREMENTS FOR USE OF BARRICADES. NO ADDITIONAL COMPENSATION SHALL BE ALLOWED TO COMPLY WITH THIS REQUIREMENT.
- ALL LOCATIONS OF PAVEMENT PATCHING AND PIPE CULVERTS TO BE CLEANED WILL BE DETERMINED IN THE FIELD BY THE RESIDENT ENGINEER.
- EXISTING BROKEN FRAMES AND LIDS SHALL BE REMOVED AND DISPOSED OF BY THE CONTRACTOR AND SHALL BE REPLACED AS DIRECTED BY THE RESIDENT ENGINEER. REPLACEMENT FRAMES AND LIDS WILL BE PAID FOR ACCORDING TO ARTICLE 109.04 OF THE STANDARD SPECIFICATIONS UNLESS A SEPARATE PAY ITEM HAS BEEN PROVIDED.
- OVERNIGHT LANE CLOSURES SHALL NOT BE ALLOWED FOR REHABILITATION PROJECTS INVOLVING DAYTIME MILLING AND RESURFACING OPERATIONS AND CLASS D PATCHING UNLESS OTHER CONDITIONS WARRANT EXTENDED LANE CLOSURES AS DETERMINED AND APPROVED IN WRITING BY THE RESIDENT ENGINEER OR AS PROVIDED FOR IN THE CONTRACT SPECIFICATIONS.
- PAVEMENT MARKING TAPE, TYPE IV SHALL BE USED FOR SHORT TERM PAVEMENT MARKINGS ON ALL FINAL SURFACES.

MODEL: GenNotesSh01 [Sheet]
FILE NAME: c:\pw_work\pwtdotlanq\mid1042851\shlgennote.dgn

	USER NAME = Farhan.Tariq	DESIGNED -	REVISED -	STATE OF ILLINOIS DEPARTMENT OF TRANSPORTATION	INDEX OF SHEETS, HIGHWAY STANDARDS AND GENERAL NOTES I-55 W. FRONTAGE RD. (S/O STRIPMINE RD. TO IL 113)			F.A.I. RTE.	SECTION	COUNTY	TOTAL SHEETS	SHEET NO.
		DRAWN -	REVISED -					55	2024-1044-RS	WILL	14	2
	PLOT SCALE = 0.166666833''/In.	CHECKED -	REVISED -					CONTRACT NO. 62X85				
	PLOT DATE = 1/31/2025	DATE -	REVISED -		SCALE:	SHEET	OF	SHEETS	STA.	TO STA.	ILLINOIS FED. AID PROJECT	

SUMMARY OF QUANTITIES				CONSTRUCTION TYPE CODE		
				80% FEDERAL 20% STATE	100% STATE	
				ROADWAY 0005 URBAN	ROADWAY 0005 URBAN	
CODE NO.	ITEM	UNIT	TOTAL QUANTITY			
40600290	BITUMINOUS MATERIALS (TACK COAT)	POUND	9590	9590		
40600370	LONGITUDINAL JOINT SEALANT	FOOT	6279	6279		
40600400	MIXTURE FOR CRACKS, JOINTS, AND FLANGEWAYS	TON	22	22		
40600982	HOT-MIX ASPHALT SURFACE REMOVAL - BUTT JOINT	SQ YD	82	82		
40602985	HOT-MIX ASPHALT BINDER COURSE, IL-9.5, N70	TON	1592	1592		
40604062	HOT-MIX ASPHALT SURFACE COURSE, IL-9.5, MIX "D", N70	TON	1393	1393		
44000153	HOT-MIX ASPHALT SURFACE REMOVAL, 1"	SQ YD	13497	13497		
44000164	HOT-MIX ASPHALT SURFACE REMOVAL, 3 3/4"	SQ YD	709	709		
44201717	CLASS D PATCHES, TYPE II, 6 INCH	SQ YD	270	270		
44201721	CLASS D PATCHES, TYPE III, 6 INCH	SQ YD	202	202		
44201723	CLASS D PATCHES, TYPE IV, 6 INCH	SQ YD	202	202		
48102100	AGGREGATE WEDGE SHOULDER, TYPE B	TON	396	396		
60920012	PIPE CULVERTS TO BE CLEANED 12"	FOOT	100		100	
67100100	MOBILIZATION	L SUM	1	1		
70100460	TRAFFIC CONTROL AND PROTECTION, STANDARD 701306	L SUM	1	1		
70100600	TRAFFIC CONTROL AND PROTECTION, STANDARD 701336	L SUM	1	1		
70102635	TRAFFIC CONTROL AND PROTECTION, STANDARD 701701	L SUM	1	1		
70300100	SHORT TERM PAVEMENT MARKING	FOOT	2450	2450		
70300150	SHORT TERM PAVEMENT MARKING REMOVAL	SQ FT	1021	1021		
70300221	TEMPORARY PAVEMENT MARKING - LINE 4"- PAINT	FOOT	17904	17904		
70300281	TEMPORARY PAVEMENT MARKING - LINE 24"- PAINT	FOOT	22	22		
70307120	TEMPORARY PAVEMENT MARKING - LINE 4" - TYPE IV TAPE	FOOT	613	613		
78000200	THERMOPLASTIC PAVEMENT MARKING - LINE 4"	FOOT	17904	17904		

[illegible]

MODEL: Final SOQ1 [Sheet]
FILE NAME: c:\pw_work\pilot\tariqfm\1042851\sh-t-SOQ.dgn

FILE NAME:	USER NAME = Farhan.Tariq	DESIGNED -	REVISED -	STATE OF ILLINOIS DEPARTMENT OF TRANSPORTATION	SUMMARY OF QUANTITIES I-55 W. FRONTAGE RD. (S/O STRIPMINE RD. TO IL 113)				F.A.I. RTE.	SECTION	COUNTY	TOTAL SHEETS	SHEET NO.	
		DRAWN -	REVISED -						55	2024-1044-RS	WILL	14	3	
		CHECKED -	REVISED -						CONTRACT NO. 62X85					
	PLOT DATE = 1/31/2025	DATE -	REVISED -		SCALE:	SHEET	OF	SHEETS	STA.	TO STA.				

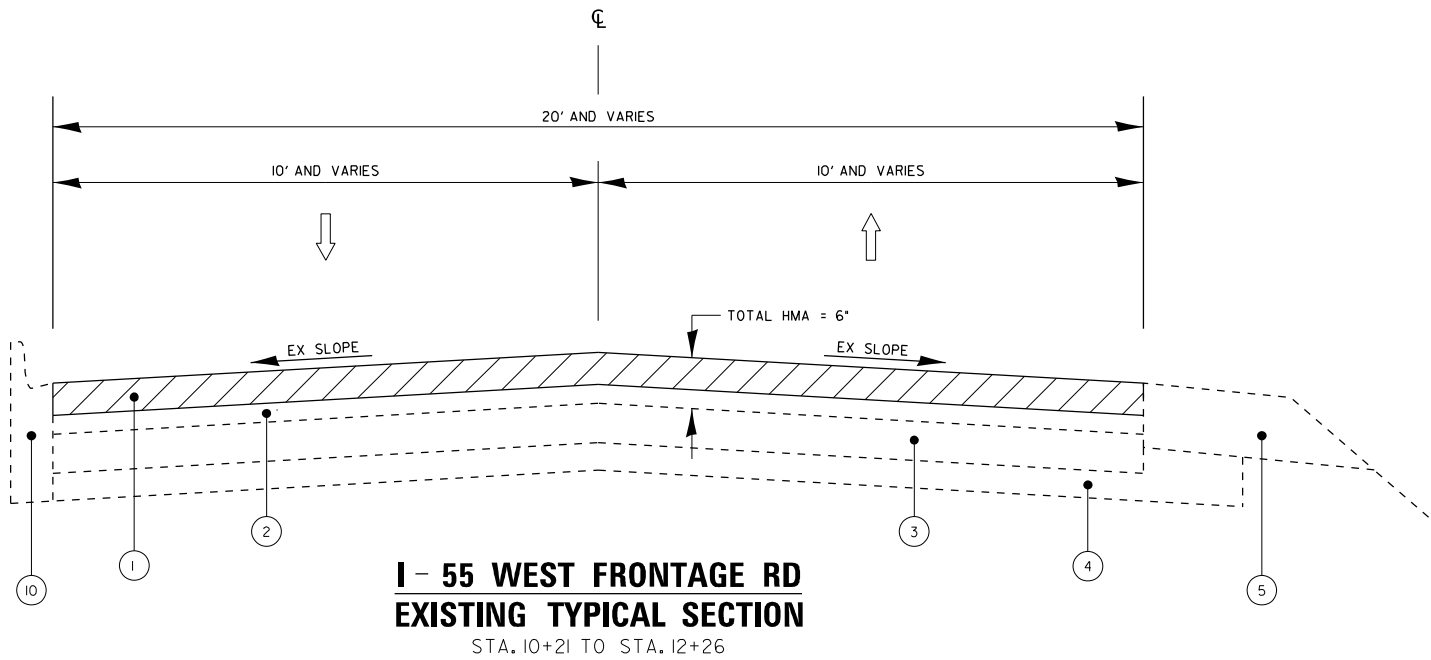

- LEGEND**
- 1 PROPOSED HMA SURFACE REMOVAL, 3¾"
 - 2 EXISTING HMA PAVEMENT TO REMAIN, 2¼"
 - 3 EXISTING PULVERIZED BASE MATERIAL (9½")
 - 4 EXISTING SUB-BASE GRANULAR MATERIAL, TYPE B (± 8")
 - 5 EXISTING AGGREGATE SHOULDERS
 - 6 PROPOSED HMA SURFACE COURSE, IL-9.5, MIX "D", N70, 1¾"
 - 7 PROPOSED HMA BINDER COURSE, IL-9.5, N70, 2"
 - 8 PROPOSED AGGREGATE WEDGE SHOULDER, TYPE B
 - 9 PROPOSED GRADING & SHAPING SHOULDERS
 - 10 EXISTING COMBINATION CONCRETE CURB AND GUTTER
 - 11 PROPOSED HMA SURFACE REMOVAL, 1"
 - 12 EXISTING HMA PAVEMENT TO REMAIN, 5"

- NOTES**
1. THE CONTRACTOR SHALL PATCH FIRST THEN MILL.
 2. THE LONGITUDINAL JOINT SEALANT SHALL BE PLACED ON THE HMA BINDER, IL-9.5, N70.

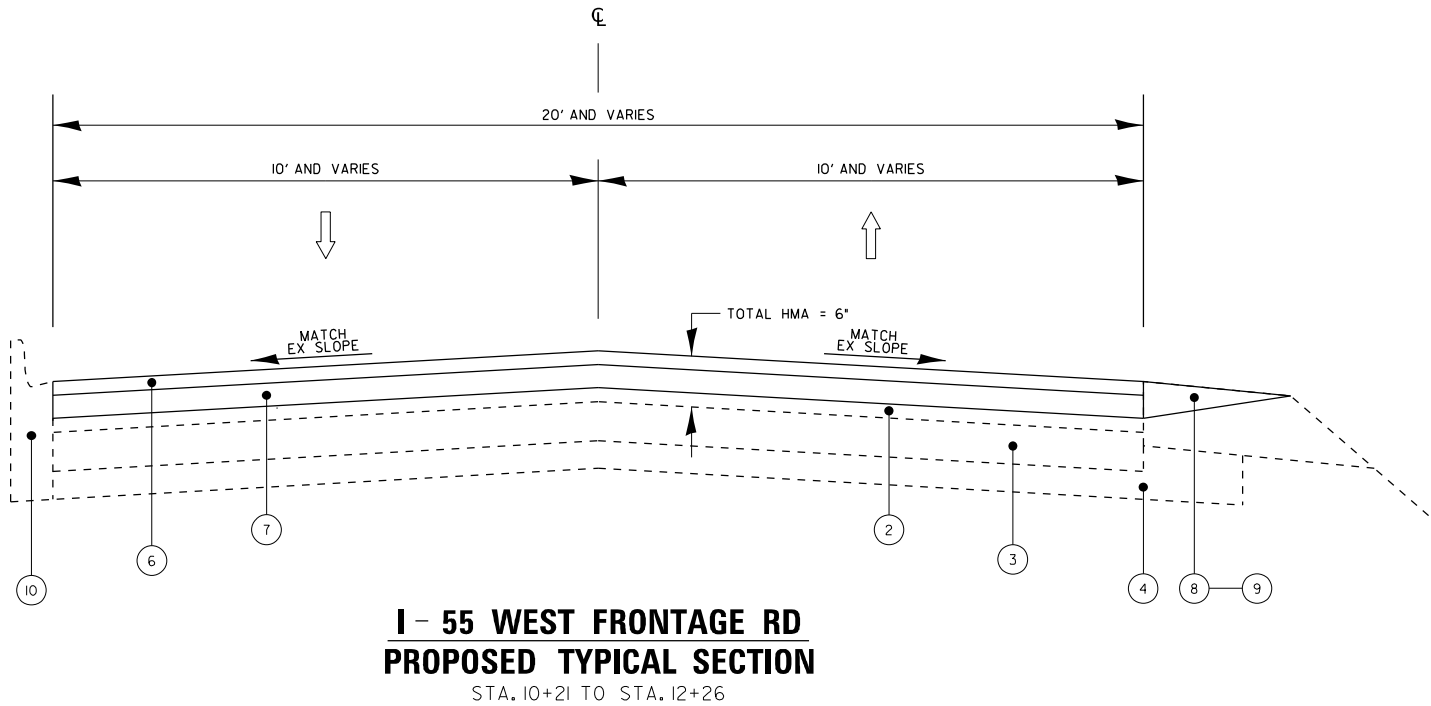

MIXTURE REQUIREMENTS		QUALITY MANAGEMENT PROGRAM (QMP)
MIXTURE USES AND TYPES	AIR VOIDS © Ndes	
PAVEMENT RESURFACING		
HMA SURFACE COURSE, IL-9.5, MIX "D", N70, 1¾"	4% AT 70 GYR.	QC/QA
HMA BINDER COURSE, IL-9.5, N70, 2"	4% AT 70 GYR.	QC/QA
PATCHING		
CLASS D PATCHES (HMA BINDER, IL-19.0), 6"	4% AT 70 GYR.	QC/QA
QMP DESIGNATIONS: QUALITY CONTROL/QUALITY ASSURANCE (QC/QA)		

NOTE 1: THE UNIT WEIGHT USED TO CALCULATE ALL HOT-MIX ASPHALT SURFACE MIXTURE QUANTITIES IS 112 LBS/SQ YD/IN.

NOTE 2: THE "AC TYPE" FOR POLYMERIZED HMA MIXES SHALL BE "SBS/SBR PG 76-22" AND FOR NON-POLYMERIZED HMA THE "AC TYPE" SHALL BE "PG 64-22" UNLESS MODIFIED BY RECLAIMED MATERIALS SPECIFICATIONS.

MODEL: TS_1 [Sheet]
FILE NAME: c:\p\work\ts1\ts1typical.dgn

	USER NAME = Farhan.Tariq	DESIGNED -	REVISED -	STATE OF ILLINOIS DEPARTMENT OF TRANSPORTATION	EXISTING AND PROPOSED TYPICAL SECTIONS I-55 W. FRONTAGE RD. (S/O STRIPMINE RD. TO IL 113)		F.A.I. RTE.	SECTION	COUNTY	TOTAL SHEETS	SHEET NO.
		DRAWN -	REVISED -				55	2024-1044-RS	WILL	14	4
		CHECKED -	REVISED -				CONTRACT NO. 62X85				
	PLOT DATE = 2/4/2025	DATE -	REVISED -				ILLINOIS FED. AID PROJECT				
SCALE:		SHEET	OF	SHEETS	STA.	TO STA.					

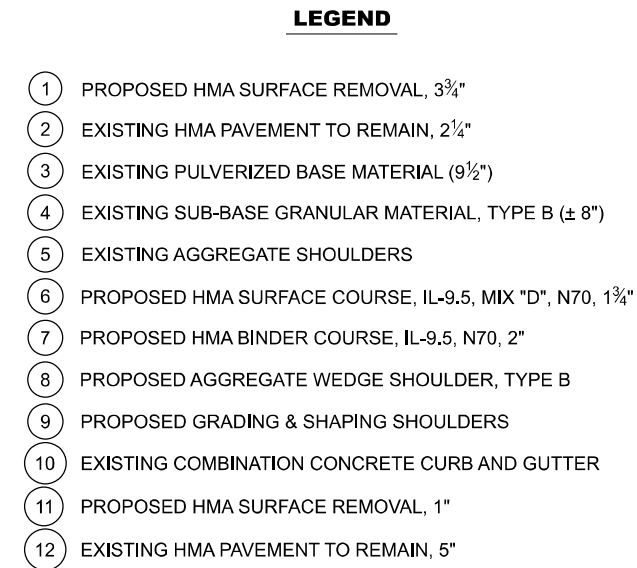

1. THE CONTRACTOR SHALL PATCH FIRST THEN MILL.
2. THE LONGITUDINAL JOINT SEALANT SHALL BE PLACED ON THE HMA BINDER, IL-9.5, N70.



PROPOSED PAVEMENT MARKING LEGEND

- 1

THERMOPLASTIC PAVEMENT MARKING - LINE 4" YELLOW SKIP-DASH CENTERLINE (10' DASH - 30' SKIP) (TYP.)
- 2

THERMOPLASTIC PAVEMENT MARKING - LINE 4" YELLOW DOUBLE SOLID CENTERLINE (2 @ 11" C-C) (TYP.)
- 3

THERMOPLASTIC PAVEMENT MARKING - LINE 4" YELLOW SOLID NO PASSING ZONE LINE FOR ONE DIRECTION, 5 1/2" C-C FROM SKIP-DASH CENTERLINE (TYP.)
- 4

THERMOPLASTIC PAVEMENT MARKING - LINE 4" WHITE EDGE LINE (TYP.)
- 5

THERMOPLASTIC PAVEMENT MARKING - LINE 24" WHITE SOLID STOP BAR (TYP.)

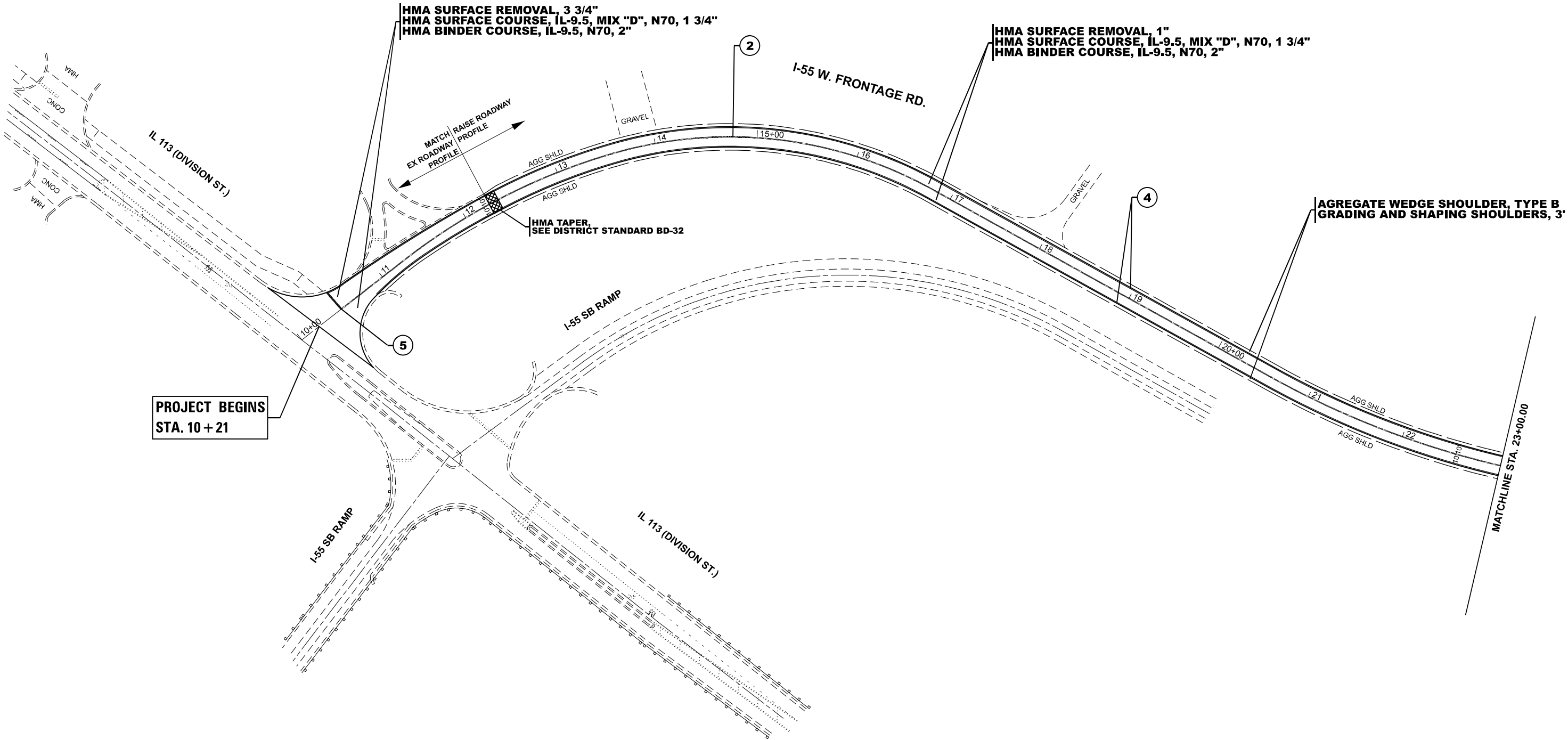

MODEL: I55WFrontageRd_E - Rwy_Plan_1 [Sheet]
FILE NAME: c:\p\work\illinois\tdm\124285\I1-55 (W Frontage Rd)-sh-plan.dgn

	USER NAME = Farhan,Tariq	DESIGNED -	REVISED -
		DRAWN -	REVISED -
		CHECKED -	REVISED -
	PLOT DATE = 2/4/2025	DATE -	REVISED -

STATE OF ILLINOIS
DEPARTMENT OF TRANSPORTATION

EXISTING AND PROPOSED ROADWAY AND PAVEMENT MARKING PLAN
I-55 W. FRONTAGE RD. (S/O STRIPMINE RD. TO IL 113)

SCALE: SHEET OF SHEETS STA. 8+00.00 TO STA. 23+00.00

F.A.I. RTE.	SECTION	COUNTY	TOTAL SHEETS	SHEET NO.
55	2024-1044-RS	WILL	14	6
CONTRACT NO. 62X85				
ILLINOIS FED. AID PROJECT				

MODEL: I55WFrontageRd_E-1 - Rdwy Plan 2 (Sheet)
FILE NAME: c:\p\work\illdot\atd\mud\24285\I1-55 (W Frontage Rd)-sh-plan.dgn

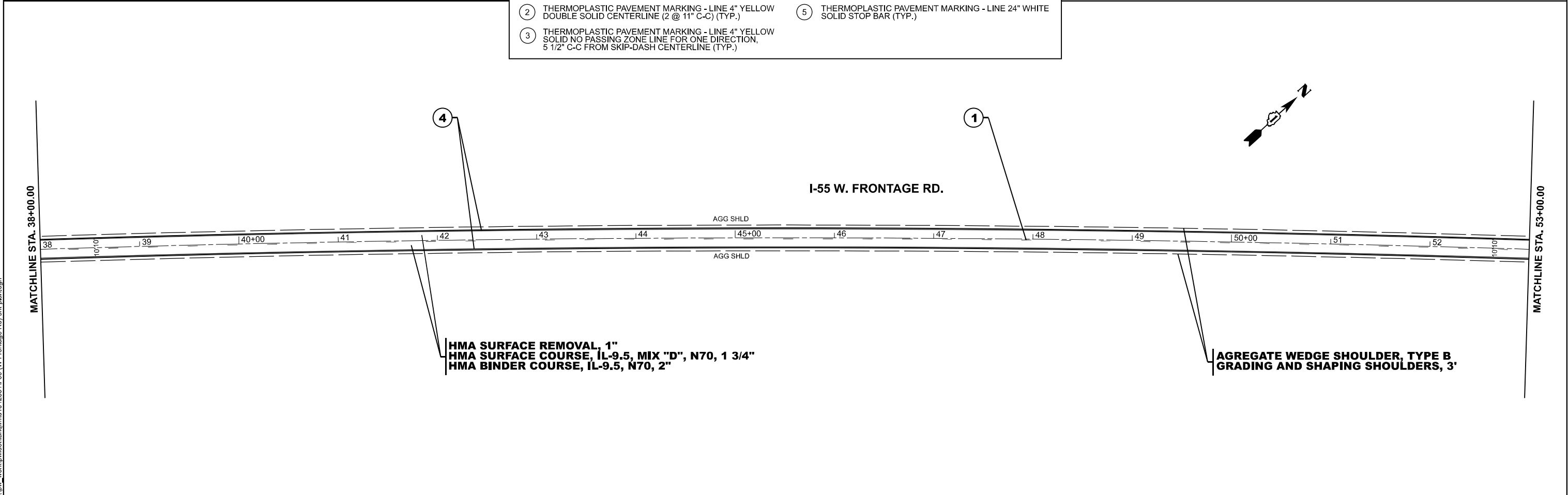
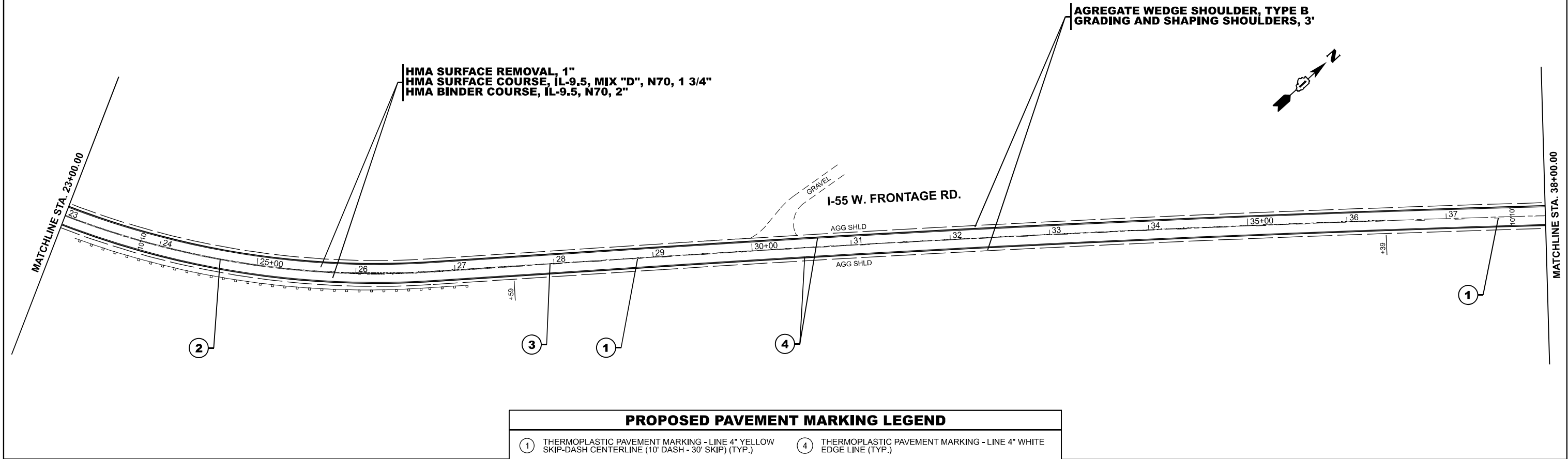

	USER NAME = Farhan,Tariq	DESIGNED -	REVISED -
		DRAWN -	REVISED -
		CHECKED -	REVISED -
	PLOT DATE = 2/4/2025	DATE -	REVISED -

STATE OF ILLINOIS
DEPARTMENT OF TRANSPORTATION

EXISTING AND PROPOSED ROADWAY AND PAVEMENT MARKING PLAN
I-55 W. FRONTAGE RD. (S/O STRIPMINE RD. TO IL 113)

SCALE: SHEET OF SHEETS STA. 23+00.00 TO STA. 53+00.00

F.A.I. RTE.	SECTION	COUNTY	TOTAL SHEETS	SHEET NO.
55	2024-1044-RS	WILL	14	7
CONTRACT NO. 62X85				
ILLINOIS FED. AID PROJECT				

METHOD OF MEASUREMENT

REFER TO SECTION 442 OF THE STANDARD SPECIFICATIONS FOR ROAD AND BRIDGE CONSTRUCTION AND THE RECURRING SPECIAL PROVISION "PATCHING WITH HOT-MIX ASPHALT OVERLAY REMOVAL."

BASIS OF PAYMENT

- 1. REFER TO SECTION 442 OF THE STANDARD SPECIFICATIONS FOR ROAD AND BRIDGE CONSTRUCTION AND THE RECURRING SPECIAL PROVISION "PATCHING WITH HOT-MIX ASPHALT OVERLAY REMOVAL."
- 2. SAW CUT/SCORING OF EXISTING HMA OVERLAY IS INCLUDED IN THE COST OF PAVEMENT PATCHING.
- 3. SAW CUT/SCORING OF EXISTING PAVEMENT IS INCLUDED IN THE COST OF PAVEMENT PATCHING.

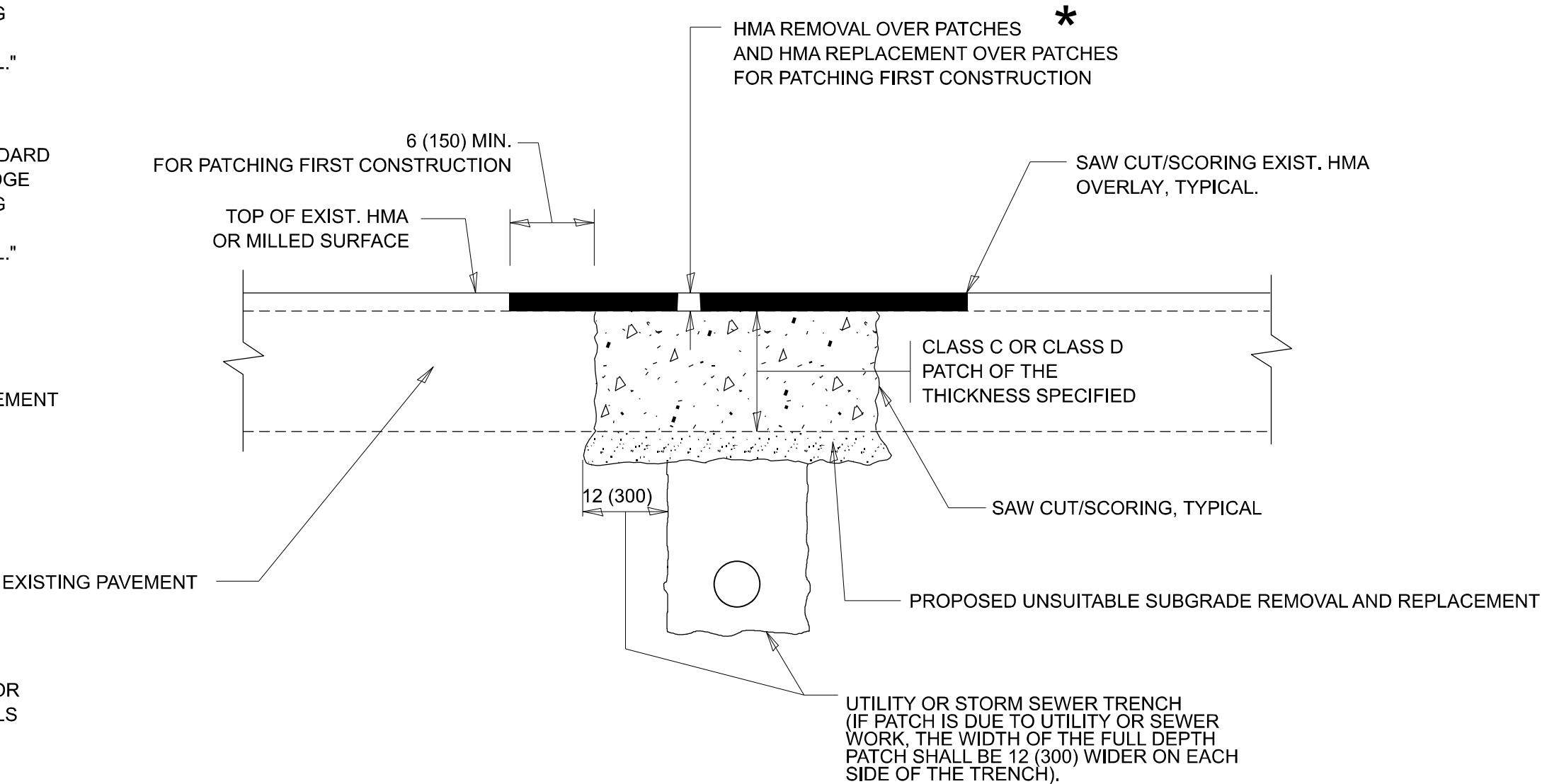

* SEE TYPICAL SECTIONS FOR THICKNESS AND MATERIALS

SEQUENCE OF CONSTRUCTION (PATCHING FIRST)

- 1. REMOVE THE EXISTING HMA MATERIAL OVER THE AREA TO BE PATCHED.
- 2. REMOVE AND REPLACE WITH CLASS C OR D PATCH.
- 3. REPLACE HMA MATERIAL OVER THE AREA TO BE PATCHED.

SEQUENCE OF CONSTRUCTION (MILLING FIRST)

- 1. MILL HMA FIRST IF THERE IS AT LEAST 4 1/2 INCHES OR MORE OF HMA MATERIAL ON TOP OF THE EXISTING PAVEMENT OR IF THE PAVEMENT IS FULL DEPTH HMA. A MINIMUM OF 2 INCHES OF HMA MATERIAL SHALL BE IN PLACE AFTER MILLING.
- 2. REMOVE AND REPLACE WITH FULL DEPTH CLASS D PATCHES TO TOP OF MILLED SURFACE.

ALL DIMENSIONS ARE IN INCHES (MILLIMETERS) UNLESS OTHERWISE SHOWN.

MODEL: BD-22 (Sheet)
FILE NAME: c:\pav_work\pav\illinois.gov\carlos.vaca@illinois.gov\1042851-shd-DistStrs.dgn

	USER NAME = Carlos.Vaca	DESIGNED - R. SHAH	REVISED - R. BORO 01-01-07	STATE OF ILLINOIS DEPARTMENT OF TRANSPORTATION	PAVEMENT PATCHING FOR HMA SURFACED PAVEMENT				F.A.I. RTE.	SECTION	COUNTY	TOTAL SHEETS	SHEET NO.
		DRAWN -	REVISED - R. BORO 09-04-07						55	2024-1044-RS	WILL	14	9
		CHECKED -	REVISED - K. ENG 10-27-08						BD400-04 (BD-22)				
	PLOT DATE = 1/7/2025	DATE - 10-25-94	REVISED - K. SMITH 11-18-22		ILLINOIS FED. AID PROJECT								
						SCALE: NONE	SHEET 1	OF 1 SHEETS	STA.	TO STA.			

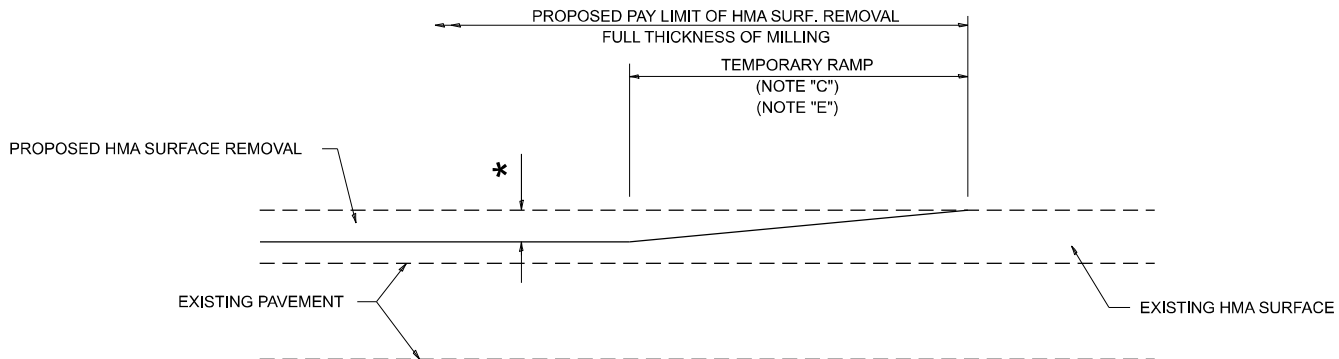

MILLED TEMPORARY RAMP
(FOR BUTT JOINT AND HMA TAPER SEE DETAIL BELOW)

OPTION 1

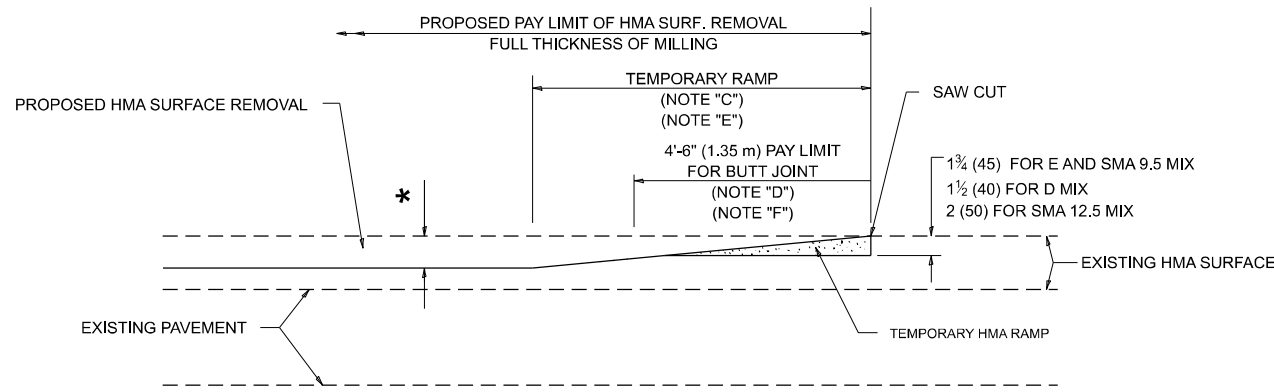

HMA CONSTRUCTED TEMPORARY RAMP
(FOR BUTT JOINT AND HMA TAPER SEE DETAIL BELOW)

OPTION 2

TYPICAL TEMPORARY RAMP

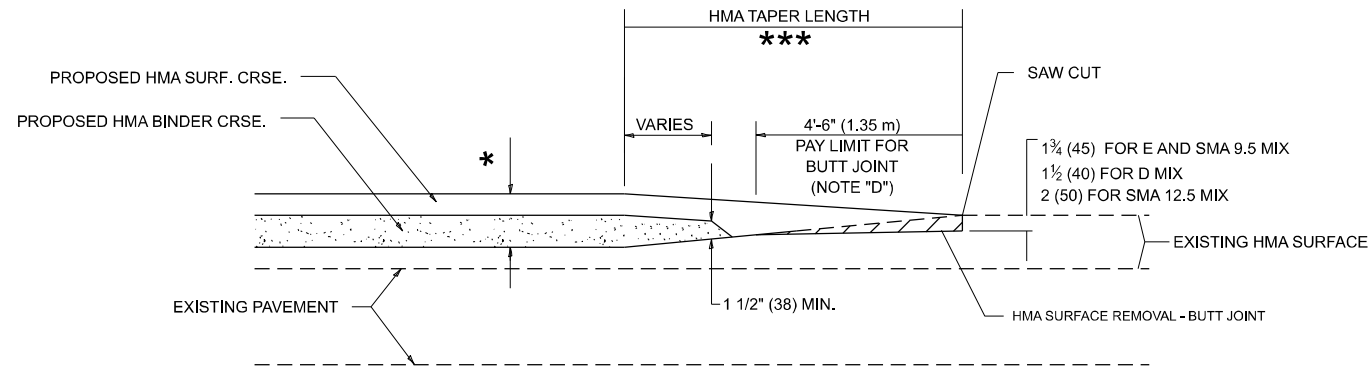

**BUTT JOINT AND
HMA TAPER**

**TYPICAL BUTT JOINT AND HMA TAPER
FOR MILLING AND RESURFACING**

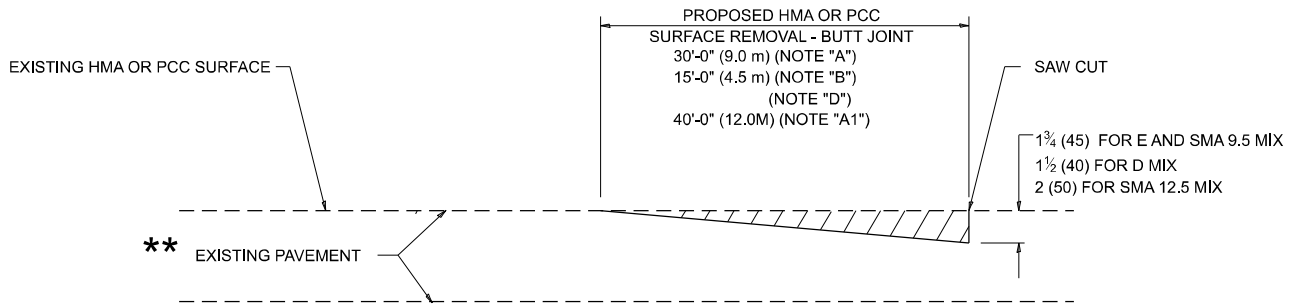

BUTT JOINT DETAIL

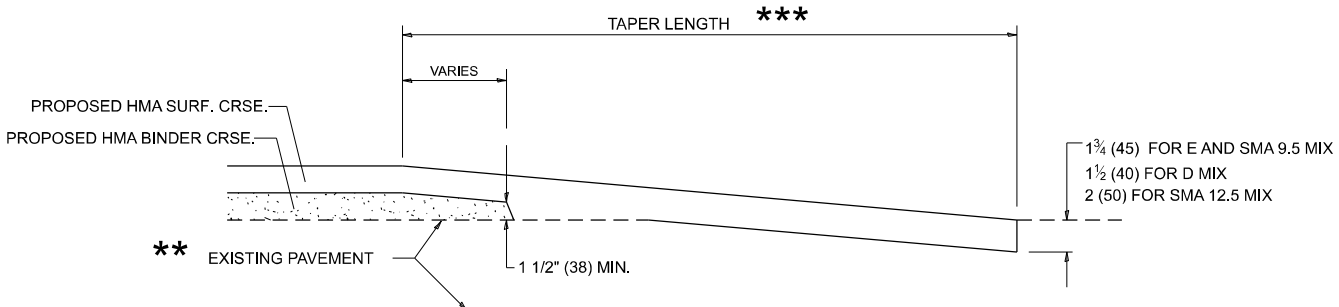

HMA TAPER DETAIL

**TYPICAL BUTT JOINT AND HMA TAPER
FOR RESURFACING ONLY**

** PC CONCRETE, HMA OR HMA RESURFACED PAVEMENT.

GENERAL NOTES

- A. MAINLINE ARTERIAL ROADWAYS AND MAJOR SIDE ROADS.
- A1. INTERSTATES
- B. MINOR SIDE ROADS.
- C. THE TEMP. RAMP SHALL BE CONSTRUCTED IMMEDIATELY UPON REMOVAL OF THE EXISTING HMA SURFACE.
- D. THE BUTT JOINT SHALL BE CONSTRUCTED IMMEDIATELY PRIOR TO PLACING THE PROPOSED HMA COURSES.
- E. TAPER THE TEMP. RAMP AT A RATE OF 3' - 4' (1.02m) PER 1 INCH (25 mm) OF MILLING THICKNESS.
* SEE TYPICAL SECTIONS FOR MILLING THICKNESS.
- F. SEE ARTICLE 406.08 AND 406.14 OF THE STANDARD SPECIFICATIONS FOR "HMA AND/OR PCC SURFACE REMOVAL, BUTT JOINT".

20'-0" (6.1 m) PER 1 (25) RESURFACING (NOTE "A")
10'-0" (3.0 m) PER 1 (25) RESURFACING (NOTE "B")

BASIS OF PAYMENT

- 1. THE BUTT JOINT WILL BE PAID FOR AT THE CONTRACT UNIT PRICE PER SQUARE YARD (SQUARE METER) FOR "HOT-MIX ASPHALT SURFACE REMOVAL - BUTT JOINT" OR FOR "PORTLAND CEMENT CONCRETE SURFACE REMOVAL- BUTT JOINT".
- 2. THE TEMPORARY RAMP AND SAW CUT SHALL BE INCLUDED IN THE UNIT COST FOR HMA OR PCC SURFACE REMOVAL-BUTT JOINT.

ALL DIMENSIONS ARE IN INCHES (MILLIMETERS) UNLESS OTHERWISE SHOWN.

MODEL: BD-32 [Sheet]
FILE NAME: c:\pav_work\pav\illinois.gov\1042851\shd-DistStrs.dgn

USER NAME = Carlos.Vaca	DESIGNED - M. DE YONG	REVISED - A. ABBAS 03-21-97
	DRAWN -	REVISED - M. GOMEZ 04-06-01
	CHECKED -	REVISED - R. BORO 01-01-07
PLOT DATE = 12/4/2024	DATE - 06-13-90	REVISED - K. SMITH 11-18-22

STATE OF ILLINOIS
DEPARTMENT OF TRANSPORTATION

**BUTT JOINT AND
HMA TAPER DETAILS**

SCALE: NONE SHEET 1 OF 1 SHEETS STA. TO STA.

F.A.I. RTE.	SECTION	COUNTY	TOTAL SHEETS	SHEET NO.
55	2024-1044-RS	WILL	14	10
BD400-05 BD-32		CONTRACT NO. 62X85		
ILLINOIS		FED. AID PROJECT		

MODEL: TC-10 (Sheet)
FILE NAME: c:\p\work\illinois.gov_carlos.vaca@illinois.gov\1042851-shd-DistStds.dgn

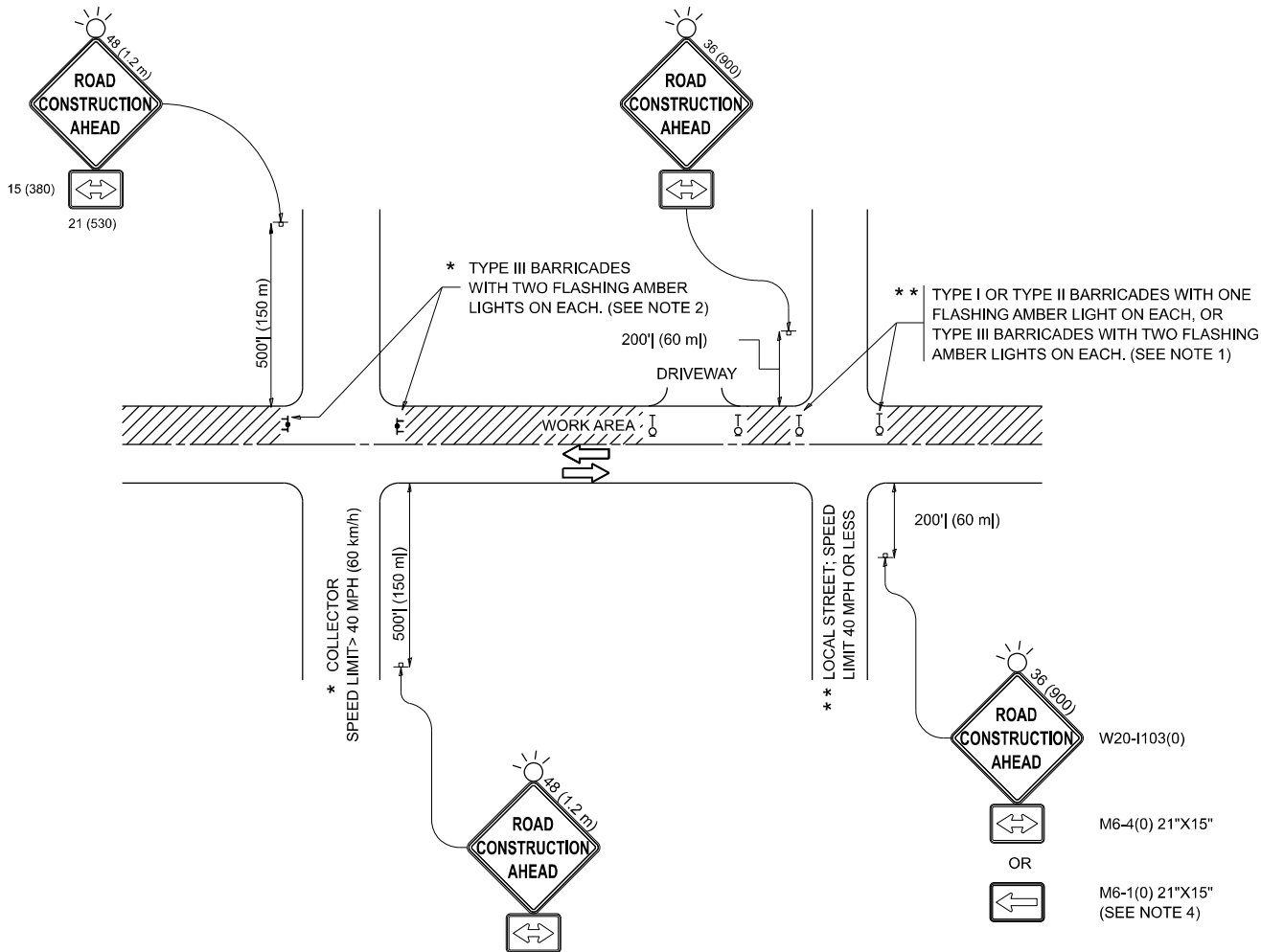

NOTES:

- SIDE ROAD WITH A SPEED LIMIT OF 40 MPH (60 km/h) OR LESS AS SHOWN ON THE DRAWING AND AS DIRECTED BY THE ENGINEER:
 - ONE "ROAD CONSTRUCTION AHEAD" SIGN 36 x 36 (900x900) WITH A FLASHER MOUNTED ON IT APPROXIMATELY 200' (60 m) IN ADVANCE OF THE MAIN ROUTE.
 - THE CLOSED PORTION OF THE MAIN ROUTE SHALL BE PROTECTED BY BLOCKING WITH TYPE I, TYPE II OR TYPE III BARRICADES, 1/3 OF THE CROSS SECTION OF THE CLOSED PORTION.
- SIDE ROAD WITH A SPEED LIMIT GREATER THAN 40 MPH (60 km/h) AS SHOWN ON THE DRAWING AND AS DIRECTED BY THE ENGINEER:
 - ONE "ROAD CONSTRUCTION AHEAD" SIGN 48 x 48 (1.2 m x 1.2 m) WITH A FLASHER MOUNTED ON IT APPROXIMATELY 500' (150 m) IN ADVANCE OF THE MAIN ROUTE.
 - THE CLOSED PORTION OF THE MAIN ROUTE SHALL BE PROTECTED BY BLOCKING WITH TYPE III BARRICADES, 1/2 OF THE CROSS SECTION OF THE CLOSED PORTION.
- CONES MAY BE SUBSTITUTED FOR BARRICADES OR DRUMS AT HALF THE SPACING DURING DAY OPERATIONS. CONES SHALL BE A MINIMUM OF 28 (710) IN HEIGHT.
- WHEN THE SIDE ROAD LIES BETWEEN THE BEGINNING OF THE MAINLINE SIGNING AND THE WORK ZONE, A SINGLE HEADED ARROW (M6-1) SHALL BE USED IN LIEU OF THE DOUBLE HEADED ARROW (M6-4).
- WHEN WORK IS BEING PERFORMED ON A SIDE ROAD OR DRIVEWAY, FOLLOW THE APPLICABLE STANDARD(S). THE DIRECTIONAL ARROW (M6-1 OR M6-4) SHALL BE COVERED OR REMOVED WHEN NO LONGER CONSISTENT WITH THE TRAFFIC CONTROL SET-UP.
- ADVANCE WARNING SIGNS ARE TO BE OMITTED ON DRIVEWAYS UNLESS OTHERWISE SPECIFIED IN THE PLANS OR BY THE ENGINEER.
- THE TRAFFIC CONTROL AND PROTECTION FOR SIDE ROADS, INTERSECTIONS, AND DRIVEWAYS SHALL BE INCLUDED IN THE COST OF SPECIFIED TRAFFIC CONTROL STANDARDS OR ITEMS.

All dimensions are in inches (millimeters)
unless otherwise shown.

	USER NAME = Carlos.Vaca	DESIGNED - L.H.A.	REVISED - T. RAMMACHER 01-06-00	STATE OF ILLINOIS DEPARTMENT OF TRANSPORTATION	TRAFFIC CONTROL AND PROTECTION FOR SIDE ROADS, INTERSECTIONS, AND DRIVEWAYS					F.A.I. RTE.	SECTION	COUNTY	TOTAL SHEETS	SHEET NO.	
		DRAWN -	REVISED - A. SCHUETZE 07-01-13							55	2024-1044-RS	WILL	14	11	
		CHECKED -	REVISED - A. SCHUETZE 09-15-06							TC-10					CONTRACT NO. 62X85
	PLOT DATE = 1/7/2025	DATE - 06-89	REVISED - D. SENDERAK 05-03-24		SCALE:		SHEET	OF	SHEETS	STA.	TO STA.	ILLINOIS FED. AID PROJECT			

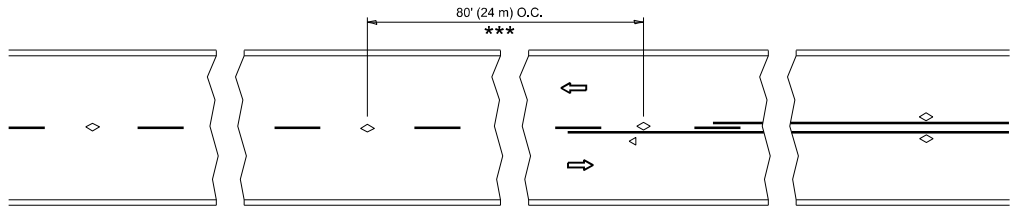

*** REDUCE TO 40' (12 m) O.C. ON CURVES WITH POSTED OR ADVISORY SPEED 45 M.P.H. (70 km/h) OR LESS.

TWO-LANE/TWO-WAY

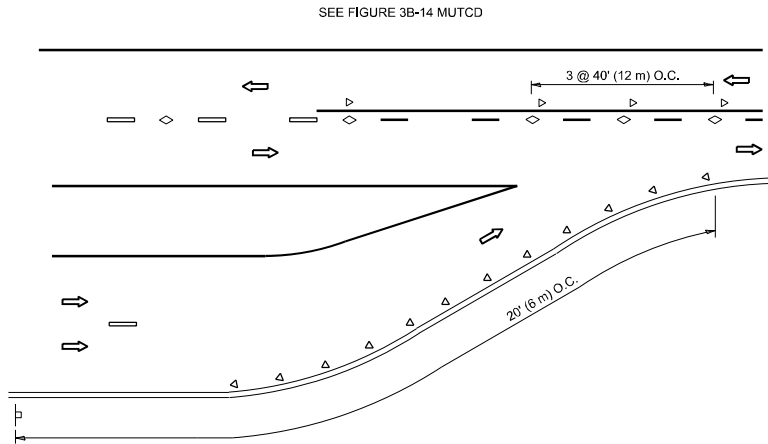

LANE REDUCTION TRANSITION

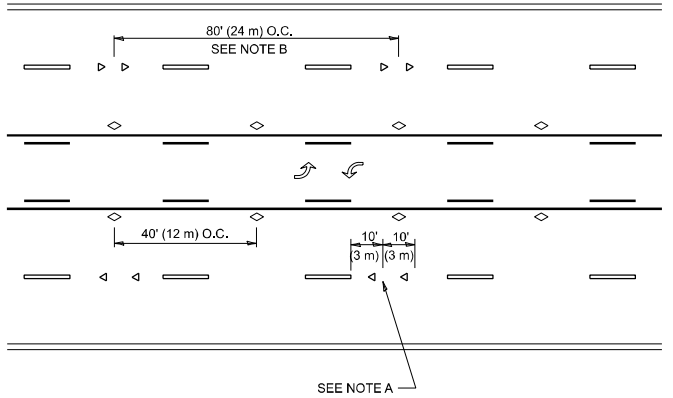

SEE NOTE A

TWO-WAY LEFT TURN

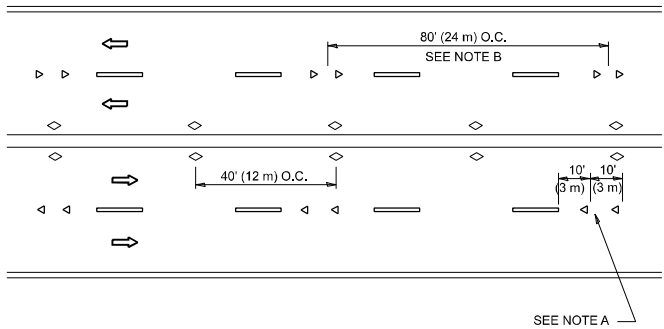

SEE NOTE A

MULTI-LANE/UNDIVIDED

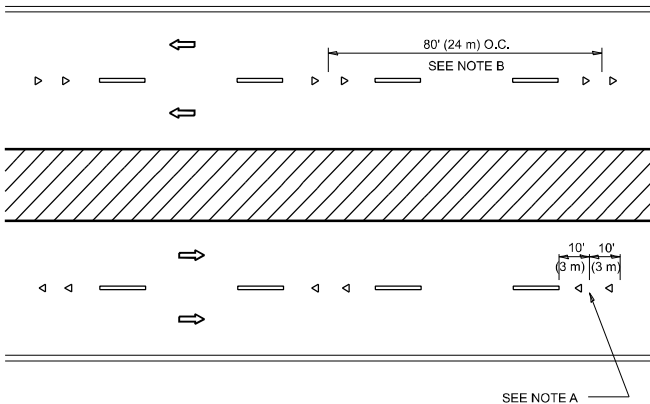

SEE NOTE A

MULTI-LANE/DIVIDED

GENERAL NOTES

- MARKERS USED WITH DASHED LINES SHALL BE CENTERED IN THE GAP BETWEEN SEGMENTS.
- MARKERS USED ADJACENT TO SOLID LINES SHALL BE OFFSET 2 TO 3 (50 TO 75) TOWARD TRAFFIC AS SHOWN.
- MARKERS THROUGH TANGENTS LESS THAN 500' (150 m) IN LENGTH BETWEEN CURVES SHALL BE INSTALLED AT THE LESSER OF THE TWO CURVE SPACINGS.
- MARKERS ARE TO BE USED ADJACENT TO BOTH SOLID WHITE LINES IN DUAL LEFT TURN LANES

SYMBOLS

- YELLOW STRIPE
- WHITE STRIPE
- ONE-WAY AMBER MARKER
- ONE-WAY CRYSTAL MARKER (W/O)
- TWO-WAY AMBER MARKER

LANE MARKER NOTES

- USE DOUBLE LANE LINE MARKERS SPACED AS SHOWN.
- REDUCE TO 40' (12 m) O.C. ON CURVES WHERE ADVISORY SPEEDS ARE 10 M.P.H (20 km/h) LOWER THAN POSTED SPEEDS.

DESIGN NOTES

- DOUBLE LANE LINE MARKERS SHALL BE USED UNLESS SPECIFIED OTHERWISE.
- EXCEPT AS SHOWN ON THE LANE REDUCTION TRANSITION AND FREEWAY EXIT RAMP DETAIL, MARKERS ARE NOT TO BE SPECIFIED ON RIGHT EDGE LINES.
- THE EXACT MARKER LIMITS, SPACING, AND COLOR SHALL BE INCLUDED IN THE PLANS WHEN STANDARD SPECIFICATIONS ARE NOT BEING USED.
- MARKERS SHOULD NOT BE USED ALONGSIDE CURBS EXCEPT FOR EXTREMELY SHORT SECTIONS OF CURBS WHERE NOT MORE THAN TWO MARKERS WOULD BE INVOLVED.

All dimensions are in inches (millimeters) unless otherwise shown.

MODEL: TC-11 [Sheet]
FILE NAME: c:\p\work\pwt\illinois.gov_carlos.vaca@illinois.gov\d1042851-shd-DistStrs.dgn

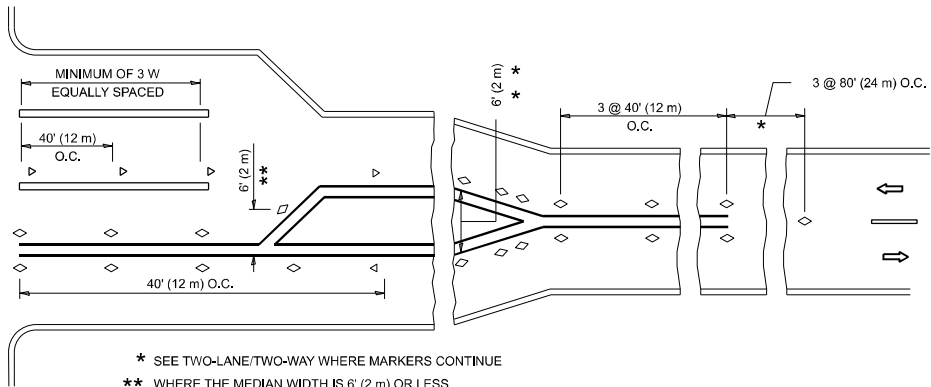
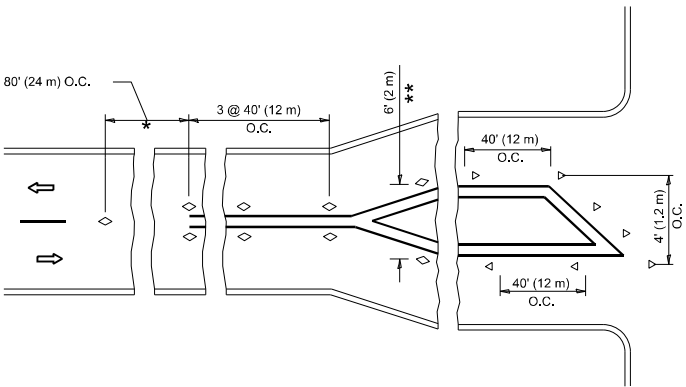

- * SEE TWO-LANE/TWO-WAY WHERE MARKERS CONTINUE
- ** WHERE THE MEDIAN WIDTH IS 6' (2 m) OR LESS USE TWO-WAY MARKERS.

TURN LANES

STATE OF ILLINOIS
DEPARTMENT OF TRANSPORTATION

TYPICAL APPLICATIONS
RAISED REFLECTIVE PAVEMENT MARKERS (SNOW-PLOW RESISTANT)

SCALE: NONE SHEET 1 OF 1 SHEETS STA. TO STA.

F.A.I. RTE.	SECTION	COUNTY	TOTAL SHEETS	SHEET NO.
55	2024-1044-RS	WILL	14	12
TC-11		CONTRACT NO. 62X85		
ILLINOIS		FED. AID PROJECT		

MODEL: TC-13 (Sheet)
FILE NAME: c:\paw\work\illinois.gov\d1042851-shd-DistStrls.dgn

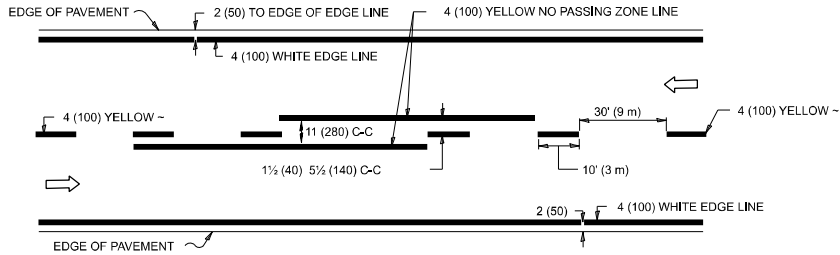

2-LANE ROADWAY

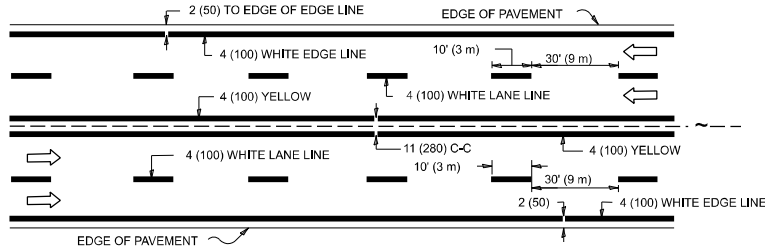

MULTI-LANE UNDIVIDED

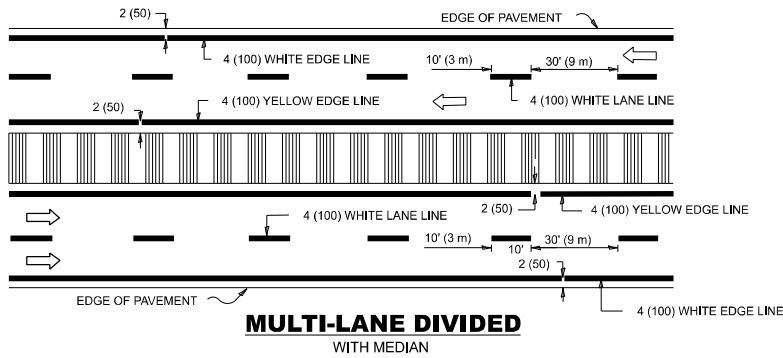

TYPICAL LANE AND EDGE LINE MARKING

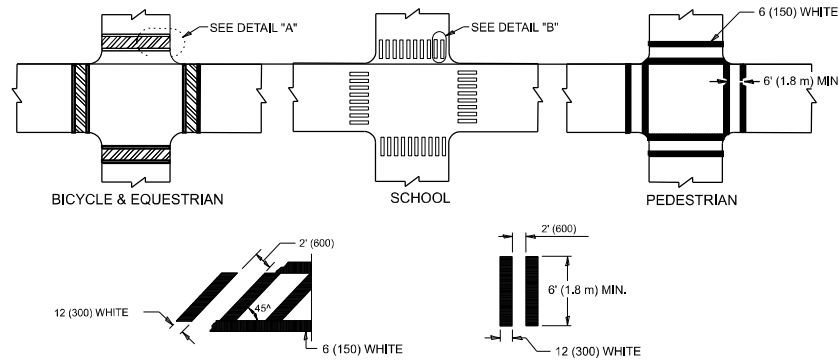

DETAIL "A"

DETAIL "B"

TYPICAL CROSSWALK MARKING

* MARKINGS SHALL BE INSTALLED PARALLEL TO THE CENTERLINE OF THE ROAD WHICH IT CROSSES

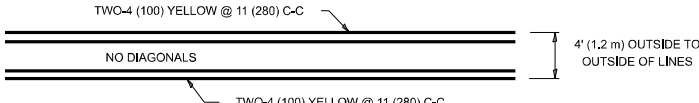

4' (1.2 m) WIDE MEDIANS ONLY

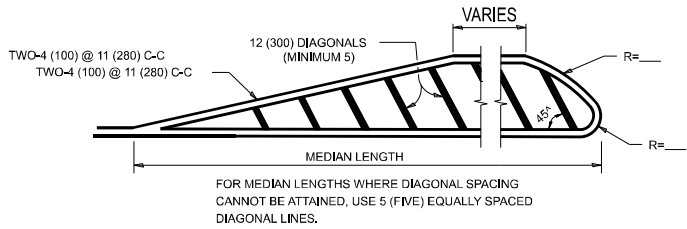

MEDIANS OVER 4' (1.2 m) WIDE

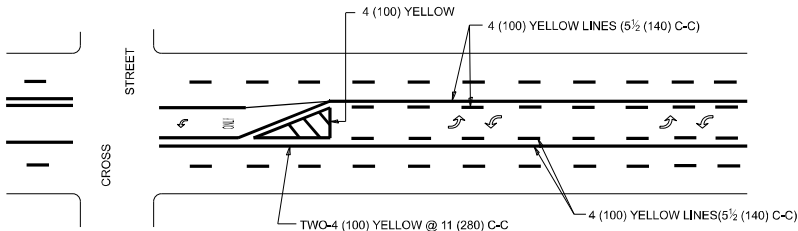

MEDIAN WITH TWO-WAY LEFT TURN LANE

TYPICAL PAINTED MEDIAN MARKING

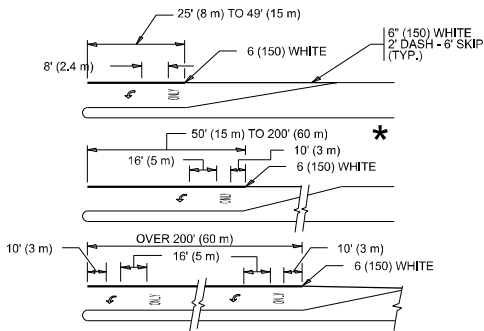

FULL SIZE LETTERS 8' (2.4 m) AND ARROWS SHALL BE USED.
AREA = 15.6 SQ. FT. (1.5 m²) ONLY AREA = 20.8 SQ. FT. (1.9 m²)

* TURN LANES IN EXCESS OF 400' (120 m) IN LENGTH MAY HAVE AN ADDITIONAL SET OF ARROW - "ONLY" INSTALLED MIDWAY BETWEEN THE OTHER TWO SETS OF ARROW - "ONLY".

TYPICAL LEFT (OR RIGHT) TURN LANE

TYPICAL TURN LANE MARKING

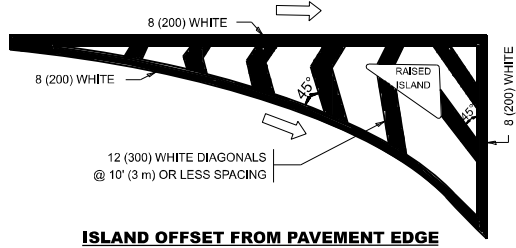

ISLAND OFFSET FROM PAVEMENT EDGE

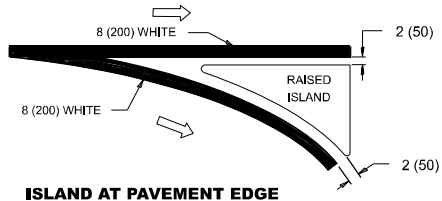

ISLAND AT PAVEMENT EDGE

TYPICAL ISLAND MARKING

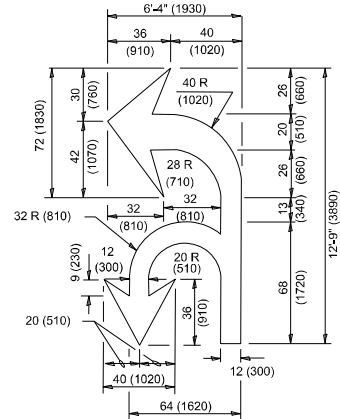

COMBINATION LEFT AND U-TURN

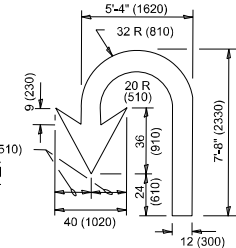

U-TURN

LANE REDUCTION TRANSITION

* LANE REDUCTION ARROWS REQUIRED AT SPEEDS OF 45 MPH OR GREATER OR WHEN SPECIFIED IN PLANS.

TYPE OF MARKING	WIDTH OF LINE	PATTERN	COLOR	SPACING / REMARKS
CENTERLINE ON 2 LANE PAVEMENT	4 (100)	SKIP-DASH	YELLOW	10' (3 m) LINE WITH 30' (9 m) SPACE
CENTERLINE ON MULTI-LANE UNDIVIDED PAVEMENT	2 @ 4 (100)	SOLID	YELLOW	11 (280) C-C
NO PASSING ZONE LINES: FOR ONE DIRECTION FOR BOTH DIRECTIONS	4 (100) 2 @ 4 (100)	SOLID SOLID	YELLOW YELLOW	5 1/2 (140) C-C FROM SKIP-DASH CENTERLINE 11 (280) C-C OMIT SKIP-DASH CENTERLINE BETWEEN
LANE LINES	4 (100) 5 (125) ON FREEWAYS	SKIP-DASH SKIP-DASH	WHITE WHITE	10' (3 m) LINE WITH 30' (9 m) SPACE
DOTTED LINES (EXTENSIONS OF CENTER, LANE OR TURN LANE MARKINGS)	SAME AS LINE BEING EXTENDED	SKIP-DASH	SAME AS LINE BEING EXTENDED	2' (600) LINE WITH 6' (1.8 m) SPACE
EDGE LINES	4 (100)	SOLID	YELLOW-LEFT WHITE-RIGHT	OUTLINE MEDIANS IN YELLOW
TURN LANE MARKINGS	6 (150) LINE: FULL SIZE LETTERS & SYMBOLS (8' (2.4m))	SOLID	WHITE	SEE TYPICAL TURN LANE MARKING DETAIL
TWO WAY LEFT TURN MARKING	2 @ 4 (100) EACH DIRECTION 8' (2.4m) LEFT ARROW	SKIP-DASH AND SOLID IN PAIRS	YELLOW WHITE	10' (3 m) LINE WITH 30' (9 m) SPACE FOR SKIP-DASH: 5 1/2 (140) C-C BETWEEN SOLID LINE AND SKIP-DASH LINE SEE TYPICAL TWO-WAY LEFT TURN MARKING DETAIL
CROSSWALK LINES (PEDESTRIAN) A. DIAGONALS (BIKE & EQUESTRIAN) B. LONGITUDINAL BARS (SCHOOL)	2 @ 6 (150) 12 (300) @ 45° 12 (300) @ 90°	SOLID SOLID SOLID	WHITE WHITE WHITE	NOT LESS THAN 6' (1.8 m) APART 2' (600) APART 2' (600) APART SEE TYPICAL CROSSWALK MARKING DETAILS.
STOP LINES	24 (600)	SOLID	WHITE	PLACE 4' (1.2 m) IN ADVANCE OF AND PARALLEL TO CROSSWALK, IF PRESENT. OTHERWISE, PLACE AT DESIRED STOPPING POINT, PARALLEL TO CROSSROAD CENTERLINE, WHERE POSSIBLE
PAINTED MEDIANS	2 @ 4 (100) WITH 12 (300) DIAGONALS @ 45° NO DIAGONALS USED FOR 4' (1.2 m) WIDE MEDIANS	SOLID	YELLOW: TWO WAY TRAFFIC WHITE: ONE WAY TRAFFIC	11 (280) C-C FOR THE DOUBLE LINE SEE TYPICAL PAINTED MEDIAN MARKING.
GORE MARKING AND CHANNELIZING LINES	8 (200) WITH 12 (300) DIAGONALS @ 45°	SOLID	WHITE	DIAGONALS: 15' (4.5 m) C-C (LESS THAN 30MPH (50 km/h)) 20' (6 m) C-C 30MPH (50 km/h) TO 45MPH (70 km/h)) 30' (9 m) C-C (OVER 45MPH (70 km/h))
RAILROAD CROSSING	24 (600) TRANSVERSE LINES: "RR" IS 8' (1.8 m) LETTERS: 16 (400) LINE FOR "X"	SOLID	WHITE	SEE STATE STANDARD 780001 AREA OF: *R*=3.6 SQ. FT. (0.33 m ²) EACH *X*=54.0 SQ. FT. (5.0 m ²)
SHOULDER DIAGONALS (REQUIRED FOR SHOULDERS ≥ 8')	12 (300) @ 45°	SOLID	WHITE - RIGHT YELLOW - LEFT	50' (15 m) C-C (LESS THAN 30MPH (50 km/h)) 75' (25 m) C-C (30 MPH (50 km/h) TO 45MPH (70 km/h)) 150' (45 m) C-C (OVER 45MPH (70 km/h))
U TURN ARROW	SEE DETAIL	SOLID	WHITE	16.3 SF
2 ARROW COMBINATION LEFT AND U TURN	SEE DETAIL	SOLID	WHITE	30.4 SF

FOR FURTHER DETAILS ON PAVEMENT MARKING REFER TO STANDARD SPECIFICATIONS FOR ROAD AND BRIDGE CONSTRUCTION AND STATE STANDARD 780001.

All dimensions are in inches (millimeters) unless otherwise shown.

USER NAME = Carlos.Vaca	DESIGNED - EVERS	REVISED - C. JUCIUS 09-09-09
	DRAWN -	REVISED - C. JUCIUS 07-01-13
	CHECKED -	REVISED - C. JUCIUS 12-21-15
PLOT DATE = 1/7/2025	DATE - 03-19-90	REVISED - C. JUCIUS 04-12-16

STATE OF ILLINOIS
DEPARTMENT OF TRANSPORTATION

DISTRICT ONE
TYPICAL PAVEMENT MARKINGS

SCALE: NONE SHEET 1 OF 1 SHEETS STA. TO STA.

F.A.I. RTE.	SECTION	COUNTY	TOTAL SHEETS	SHEET NO.
55	2024-1044-RS	WILL	14	13
TC-13		CONTRACT NO. 62X85		
		ILLINOIS	FED. AID PROJECT	

MODEL: TC-22 [Sheet]
FILE NAME: c:\p\work\pwrtd\illinois.gov_carlos.vaca@illinois.gov\1042851-shr-dist\stds.dgn

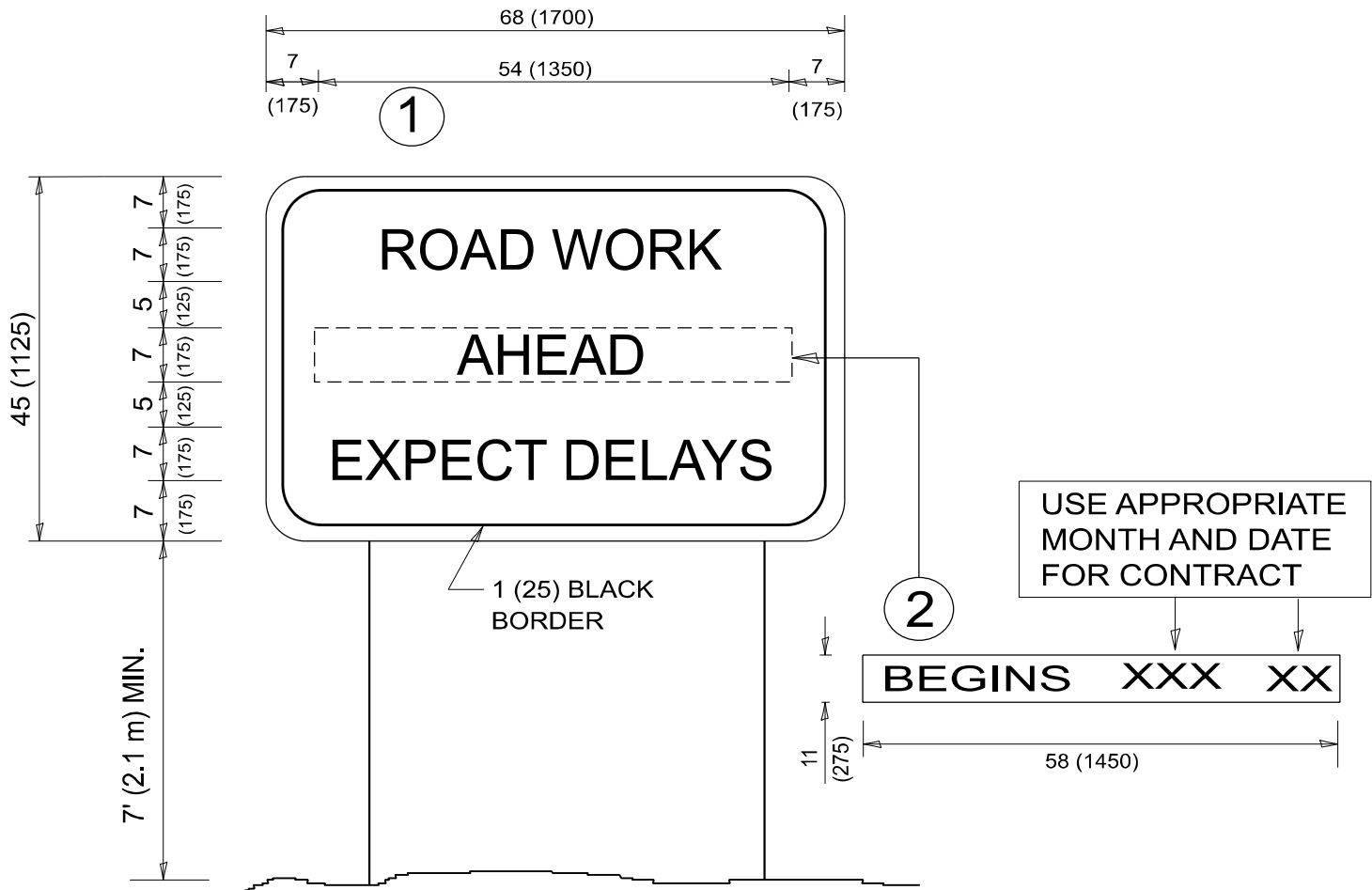

NOTES:

1. USE BLACK LETTERING ON ORANGE BACKGROUND.
2. ERECT SIGNS IN ADVANCE OF THE LOCATION FOR THE "ROAD CONSTRUCTION AHEAD" SIGN AT LOCATIONS AS DIRECTED BY THE ENGINEER.
3. ERECT SIGN ① WITH INSTALLED PANEL ② ONE WEEK PRIOR TO THE START OF CONSTRUCTION.
4. REMOVE PANEL ② SOON AFTER THE START OF CONSTRUCTION.
5. SEE SPECIAL PROVISION FOR "TEMPORARY INFORMATION SIGNING" FOR ADDITIONAL INFORMATION.
6. ONE SIGN ASSEMBLY EQUALS 25.70 SQ. FT. (2.3 SQ. M.)
7. SHALL BE PAID FOR AS TEMPORARY INFORMATION SIGNING.

ALL DIMENSIONS ARE IN INCHES (MILLIMETERS)
UNLESS OTHERWISE SHOWN.

	USER NAME = Carlos.Vaca	DESIGNED -	REVISED - R. MIRS 09-15-97	STATE OF ILLINOIS DEPARTMENT OF TRANSPORTATION	ARTERIAL ROAD INFORMATION SIGN				F.A.I. RTE.	SECTION	COUNTY	TOTAL SHEETS	SHEET NO.		
		DRAWN -	REVISED - R. MIRS 12-11-97						55	2024-1044-RS	WILL	14	14		
		CHECKED -	REVISED - T. RAMMACHER 02-02-99						TC-22					CONTRACT NO. 62X85	
	PLOT DATE = 1/7/2025	DATE -	REVISED - C. JUCIUS 01-31-07		SCALE: NONE					SHEET 1	OF 1	SHEETS	STA.	TO STA.	
							ILLINOIS FED. AID PROJECT								