

STATE OF ILLINOIS
DEPARTMENT OF TRANSPORTATION

F.A.P. RTE.	SECTION	COUNTY	TOTAL SHEETS	SHEET NO.
342	2023-928-RS,SW	COOK	23	1
		ILLINOIS	CONTRACT NO. 62W50	

* 23 + 1 = 24 TOTAL SHEETS

D-91-134-24

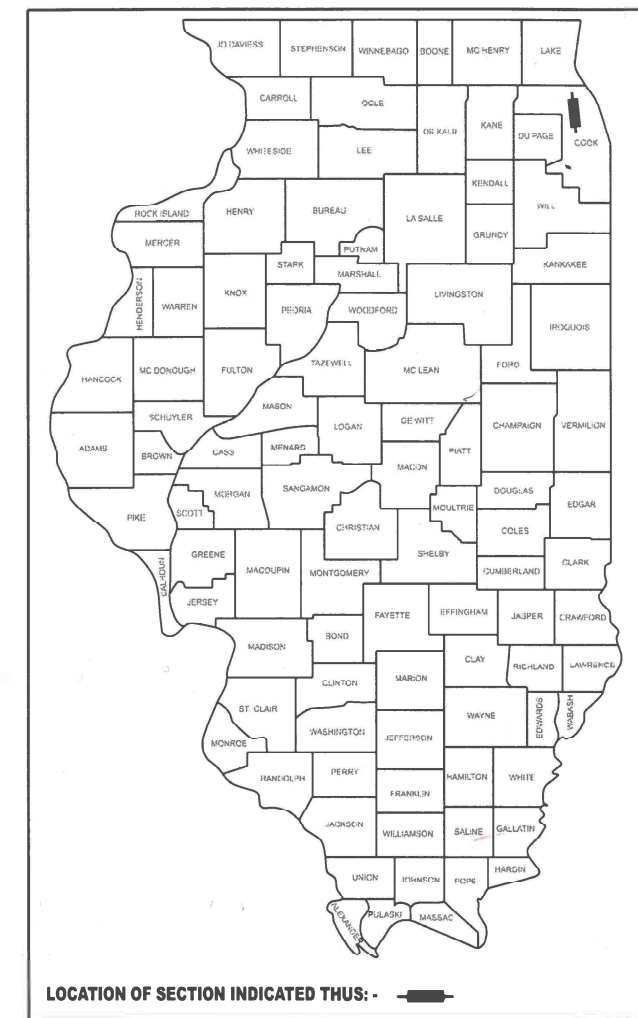

FOR INDEX OF SHEETS, SEE SHEET NO. 2

THIS PROJECT IS LOCATED IN
THE VILLAGE OF PALATINE.

TRAFFIC DATA:

IL 53 W. FRONTAGE RD / WILKE RD
ADT (2022): APPROX 1500 VPD
SPEED LIMIT = 30 MPH
FUNCTIONAL CLASS: LOCAL ROAD

PROPOSED
HIGHWAY PLANS
ROUTE FAP 342: IL 53 WEST FRONTAGE ROAD (WILKE ROAD)
US 12 (RAND ROAD) TO ALISON DRIVE
SECTION 2023-928-RS,SW
SMART OVERLAY, ADA IMPROVEMENTS
COOK COUNTY

C-91-154-24

R 11 E

T 42 N

PROJECT END
STA. 91+94

PROJECT BEGIN
STA. 17+00

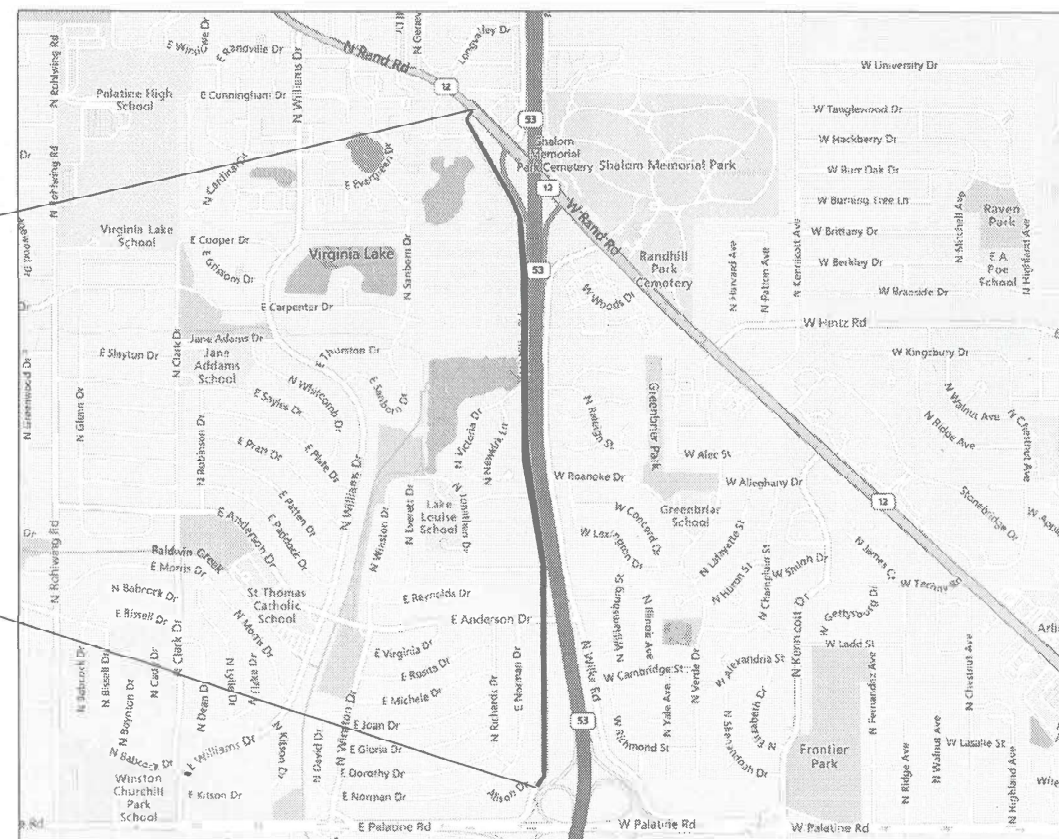

PALATINE TOWNSHIP

GROSS & NET LENGTH = 7,494 FT. = 1.42 MILES

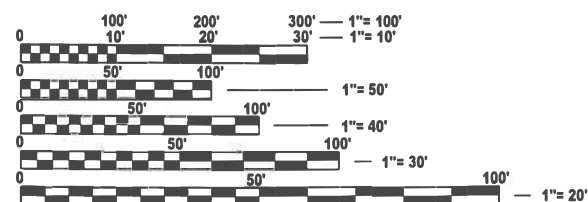

FULL SIZE PLANS HAVE BEEN PREPARED USING STANDARD
ENGINEERING SCALES. REDUCED SIZED PLANS WILL NOT
CONFORM TO STANDARD SCALES. IN MAKING MEASUREMENTS
ON REDUCED PLANS, THE ABOVE SCALES MAY BE USED.

J.U.L.I.E.
JOINT UTILITY LOCATION INFORMATION FOR EXCAVATION
1-800-892-0123
OR 811

PROJECT ENGINEER: VESELIN VELICHKOV (847-705-4432)
PROJECT MANAGER: FAWAD AQUEEL

CONTRACT NO. 62W50

STATE OF ILLINOIS
DEPARTMENT OF TRANSPORTATION

SUBMITTED Jan 23rd 2025 IR

March 21 2025 See E.A. Etk REGIONAL ENGINEER
ENGINEER OF DESIGN AND ENVIRONMENT

March 21 2025 4/25/25 5
DIRECTOR OF HIGHWAYS PROJECT IMPLEMENTATION

PRINTED BY THE AUTHORITY
OF THE STATE OF ILLINOIS

INDEX OF SHEETS

STATE STANDARDS

GENERAL NOTES

SHEET NO.

DESCRIPTION

STANDARD NO.

DESCRIPTION

1. BEFORE STARTING ANY EXCAVATION, THE CONTRACTOR SHALL CALL "JULIE AT(800) 892-0123 OR 811 FOR FIELD LOCATIONS OF BURIED ELECTRIC, TELEPHONE AND GAS FACILITIES, (48 HOURS NOTIFICATION IS REQUIRED).
2. THE CONTRACTOR SHALL COORDINATE CONSTRUCTION ACTIVITIES WITH UTILITY COMPANIES, VILLAGE OF PALATINE.
3. FRAMES AND GRATES ADJUSTMENT OF PRIVATE UTILITIES WITHIN THE PROJECT LIMITS SHALL BE DONE BY THEIR RESPECTIVE OWNERS AND ARE NOT PART OF THIS CONTRACT.
4. THE CONTRACTOR SHALL CONTACT THE DISTRICT TRAFFIC CONTROL SUPERVISOR AT KALPANA.KANNAN-HOSADURGA@ILLINOIS.GOV A MINIMUM OF 72 HOURS IN ADVANCE OF BEGINNING WORK.
5. THE CONTRACTOR WILL NOT BE ALLOWED TO SET UP A YARD OR FIELD OFFICE ON STATE PROPERTY WITHOUT WRITTEN PERMISSION FROM THE DEPARTMENT.
6. TEN (10) FOOT TRANSITION SHALL BE USED TO MATCH PROPOSED CURB AND GUTTER AND MEDIAN ITEMS OF WORK TO EXISTING CURBS AND GUTTER AND MEDIANS IN THE FIELD. UNLESS OTHERWISE SHOWN. THE TRANSITION SHALL BE PAID FOR AT THE CONTRACT UNIT PRICE FOR THE PROPOSED ITEMS OF WORK SPECIFIED.
7. ANY DAMAGE TO EXISTING PAVEMENT MARKINGS OR RAISED REFLECTIVE PAVEMENT MARKERS OUTSIDE THE REMOVAL LINE SHOWN ON THE PLANS SHALL BE REPLACED AT THE CONTRACTOR'S EXPENSE.
8. ALL MILLED SURFACES SHALL BE UNIFORM CROSS SLOPE PER LANE AND FREE OF RIDGES BETWEEN PASSES. ANY DEVIATIONS SHALL BE CORRECTED AT NO COST TO THE DEPARTMENT.
9. BEFORE BEGINNING ANY WORK, THE CONTRACTOR SHALL RETAIN AND RECORD FOR FUTURE REFERENCE, ALL EXISTING PAVEMENT MARKING LINES (AND RAISED REFLECTIVE PAVEMENT MARKERS) IN ORDER THAT THESE LOCATIONS CAN BE RE-ESTABLISHED FOR STRIPING. EXACT LOCATIONS OF ALL PAVEMENT MARKINGS SHALL BE AS DIRECTED BY THE ENGINEER.
10. WHEN MILLED PAVEMENT IS OPEN TO TRAFFIC, THE MAXIMUM GRADE DIFFERENTIAL BETWEEN PASSES OF THE MILLING MACHINE SHALL NOT EXCEED 1 1/2 INCHS WHERE THE SPEED LIMIT IS 40 MPH OR LESS, AND 1 INCH. WHERE THE SPEED LIMIT IS OVER 40 MPH WITH WRITTEN APPROVAL FROM THE RESIDENT ENGINEER, A MAXIMUM GRADE DIFFERENTIAL OF 3 INCHES MAY BE ALLOWED IF THE EDGE OF THE MILLING IS SLOPED A MINIMUM OF 1:3 (V:H).
11. THE RESIDENT ENGINEER SHALL CONTACT FADI SULTAN AREA TRAFFIC FIELD TECHNICIAN, AT FADI.SULTAN@ILLINOIS.GOV, A MINIMUM OF TWO (2) WEEKS PRIOR TO THE PLACEMENT OF PERMANENT PAVEMENT MARKINGS.
12. IT SHALL BE THE CONTRACTOR'S RESPONSIBILITY TO VERIFY ALL DIMENSIONS AND CONDITIONS EXISTING IN THE FIELD PRIOR TO CONSTRUCTION AND ORDERING MATERIALS.
13. ALL PAVEMENT PATCHING LOCATIONS WILL BE DETERMINED IN THE FIELD BY THE ENGINEER. ENGINEER HAS ALL AUTHORITY TO IDENTIFY ANY DISTRESS FOR PATCHING.
14. PAVEMENT MARKING TAPE, TYPE IV SHALL BE USED FOR SHORT TERM PAVEMENT MARKINGS ON ALL FINAL SURFACES.
15. LOCATION OF COMBINATION CONCRETE CURB AND GUTTER REMOVAL AND REPLACEMENT OR COMBINATION CURB AND GUTTER (THE TYPE SPECIFIED ON THE PLANS) WILL BE DETERMINED IN THE FIELD BY THE ENGINEER.
16. DRAINAGE ADJUSTMENT OR RECONSTRUCTION LOCATIONS WILL BE DETERMINED IN THE FIELD BY THE ENGINEER.
17. THE CONTRACTOR SHALL MAINTAIN PEDESTRIAN ACCESS AT ALL TIMES DURING CONSTRUCTION.
18. DO NOT SCALE PLANS FOR CONSTRUCTION DIMENSIONS.

1	COVER SHEET
2	INDEX OF SHEETS, STATE STANDARDS, AND GENERAL NOTES
3-4	SUMMARY OF QUANTITIES
5-8A	EXISTING AND PROPOSED TYPICAL SECTIONS
9-11	ROADWAY AND PAVEMENT MARKING PLAN
12-13	CURB RAMPS PROJECT DETAILS
14	FRAMES AND LIDS ADJUSTMENT WITH MILLING (BD-08)
15	PAVEMENT PATCHING FOR HMA SURFACED PAVEMENT (BD-22)
16	CURB OR GUTTER AND GUTTER REMOVAL AND REPLACEMENT (BD-24)
17	BUTT JOINT AND HMA TAPER DETAILS (BD-32)
18	TRAFFIC CONTROL AND PROTECTION FOR SIDEROADS, INTERSECTIONS, AND DRIVEWAYS (TC-10)
19	TYPICAL APPLICATIONS RAISED REFLECTIVE PAVEMENT MARKERS (SNOW-PLOW RESISTANT) (TC-11)
20	DISTRICT ONE TYPICAL PAVEMENT MARKING (TC-13)
21	SHORT TERM PAVEMENT MARKING LETTERS AND SYMBOLS (TC-16)
22	ARTERIAL ROAD INFORMATION SIGN (TC-22)
23	DRIVEWAY ENTRANCE SIGNING (TC-26)

000001-08	STANDARD SYMBOLS, ABBREVIATIONS, AND PATTERNS
280001-07	TEMPORARY EROSION CONTROL SYSTEMS
424001-12	PERPENDICULAR CURB RAMPS FOR SIDEWALKS
424011-05	CORNER PARALLEL CURB RAMPS FOR SIDEWALKS
424021-06	DEPRESSED CORNER FOR SIDEWALKS
442201-03	CLASS C AND D PATCHES
482011-03	HMA SHOULDER STRIPS / SHOULDERS WITH RESURFACING OR WIDENING AND RESURFACING PROJECTS
604001-05	FRAME AND LIDS TYPE 1
604061-03	FRAME AND GRATE, TYPE 12
606001-08	CONCRETE CURB TYPE B AND COMBINATION CONCRETE CURB AND GUTTER
606006-04	OUTLET FOR CONCRETE CURB AND GUTTER, TYPE B-6.24 (B-15.60)
701001-02	OFF ROAD OPERATIONS, 2L, 2W, MORE THAN 15' (4.5m) AWAY
701006-05	OFF-RD OPERATIONS, 2L, 2W, 15' (4.5M) TO 24" (600MM) FROM PAVEMENT EDGE
701011-04	OFF-RD MOVING OPERATIONS, 2L, 2W, DAY ONLY
701301-04	LANE CLOSURE, 2L, 2W, SHORT TIME OPERATIONS
701311-03	LANE CLOSURE, 2L, 2W, SLOW MOVING OPERATIONS DAY ONLY
701501-06	URBAN LANE CLOSURE, 2L, 2W, UNDIVIDED
701701-10	URBAN LANE CLOSURE, MULTILANE INTERSECTION
701801-06	SIDEWALK, CORNER OR CROSSWALK CLOSURE
701901-10	TRAFFIC CONTOL DEVICES
780001-05	TYPICAL PAVEMENT MARKINGS
781001-04	TYPICAL APPLICATIONS FOR RAISED REFLECTIVE PAVEMENT MARKERS

STATE OF ILLINOIS
DEPARTMENT OF TRANSPORTATION

INDEX OF SHEETS, STATE STANDARDS & GENERAL NOTES
IL 53 W FRONTAGE RD (US 12 / RAND RD TO ALISON DR)

SCALE: 1"=30' SHEET 1 OF 1 SHEETS STA. TOSTA.

F.A.P. RTE.	SECTION	COUNTY	TOTAL SHEETS	SHEET NO.
342	2023-928-RS,SW	COOK	23	2
		CONTRACT NO. 62W50		
		ILLINOIS FEA ID PROJECT		

MODEL: SOQ_1 [Sheet]
FILE NAME: c:\pw_work\pwid\qanum\dd940243D\13424-sh-SOQ.dgn

SUMMARY OF QUANTITIES					TYPE CODE					
					URBAN					
					SMART					
					100% STATE 0005					
	CODE NO.	ITEM	UNIT	TOTAL QUANTITY						
	20200100	EARTH EXCAVATION	CU YD	15	15					
	21101615	TOPSOIL FURNISH AND PLACE, 4"	SQ YD	65	65					
	25200110	SODDING, SALT TOLERANT	SQ YD	65	65					
	28000400	PERIMETER EROSION BARRIER	FOOT	2575	2575					
	40600290	BITUMINOUS MATERIALS (TACK COAT)	POUND	9007	9007					
	40600370	LONGITUDINAL JOINT SEALANT	FOOT	7500	7500					
	40600400	MIXTURE FOR CRACKS, JOINTS, AND FLANGEWAYS	TON	31	31					
	40600982	HOT-MIX ASPHALT SURFACE REMOVAL - BUTT JOINT	SQ YD	140	140					
	40604062	HOT-MIX ASPHALT SURFACE COURSE, IL-9.5, MIX "D", N70	TON	1685	1685					
	42001300	PROTECTIVE COAT	SQ YD	130	130					
	40601005	HOT-MIX ASPHALT REPLACEMENT OVER PATCHES	TON	50	50					
	42400200	PORTLAND CEMENT CONCRETE SIDEWALK 5 INCH	SQ FT	450	450					
	42400800	DETECTABLE WARNINGS	SQ FT	90	90					
	44000155	HOT-MIX ASPHALT SURFACE REMOVAL, 1 1/2"	SQ YD	20015	20015					
	44000600	SIDEWALK REMOVAL	SQ FT	450	450					
	44002210	HOT-MIX ASPHALT REMOVAL OVER PATCHES, 2 1/2"	SQ YD	340	340					
	44201765	CLASS D PATCHES, TYPE II, 10 INCH	SQ YD	105	105					
	44201769	CLASS D PATCHES, TYPE III, 10 INCH	SQ YD	130	130					
	44201771	CLASS D PATCHES, TYPE IV, 10 INCH	SQ YD	105	105					
	48102100	AGGREGATE WEDGE SHOULDER, TYPE B	TON	127	127					
	60406100	FRAMES AND LIDS, TYPE 1, CLOSED LID	EACH	1	1					
*	66900200	NON-SPECIAL WASTE DISPOSAL	CU YD	15	15					

SUMMARY OF QUANTITIES					TYPE CODE					
					URBAN					
					SMART					
					100% STATE 0005					
	CODE NO.	ITEM	UNIT	TOTAL QUANTITY						
*	66900530	SOIL DISPOSAL ANALYSIS	EACH	3	3					
*	66901001	REGULATED SUBSTANCES PRE-CONSTRUCTION PLAN	L SUM	1	1					
*	66901003	REGULATED SUBSTANCES FINAL CONSTRUCTION REPORT	L SUM	1	1					
*	66901006	REGULATED SUBSTANCES MONITORING	CAL DA	4	4					
	67100100	MOBILIZATION	L SUM	1	1					
	70102620	TRAFFIC CONTROL AND PROTECTION, STANDARD 701501	L SUM	1	1					
	70102635	TRAFFIC CONTROL AND PROTECTION, STANDARD 701701	L SUM	1	1					
	70102640	TRAFFIC CONTROL AND PROTECTION, STANDARD 701801	L SUM	1	1					
	70300100	SHORT TERM PAVEMENT MARKING	FOOT	5135	5135					
	70300150	SHORT TERM PAVEMENT MARKING REMOVAL	SQ FT	1715	1715					
	70300221	TEMPORARY PAVEMENT MARKING - LINE 4"- PAINT	FOOT	18810	18810					
	70300241	TEMPORARY PAVEMENT MARKING - LINE 6"- PAINT	FOOT	250	250					
	70300281	TEMPORARY PAVEMENT MARKING - LINE 24"- PAINT	FOOT	150	150					
*	78000200	THERMOPLASTIC PAVEMENT MARKING - LINE 4"	FOOT	9405	9405					
*	78000400	THERMOPLASTIC PAVEMENT MARKING - LINE 6"	FOOT	110	110					
*	78000650	THERMOPLASTIC PAVEMENT MARKING - LINE 24"	FOOT	70	70					
*	78100100	RAISED REFLECTIVE PAVEMENT MARKER	EACH	175	175					
	78300200	RAISED REFLECTIVE PAVEMENT MARKER REMOVAL	EACH	175	175					
	78300202	PAVEMENT MARKER REMOVAL - WATER BLASTING	SQ FT	3395	3395					
	X0320050	CONSTRUCTION LAYOUT (SPECIAL)	L SUM	1	1					
	X2020110	GRADING AND SHAPING SHOULDERS	UNIT	51	51					

* = SPECIALITY ITEM

	USER NAME = Nedal.Qarut	DESIGNED -	REVISED -	STATE OF ILLINOIS DEPARTMENT OF TRANSPORTATION	SUMMARY OF QUANTITIES IL 53 W FRONTAGE RD (US 12 / RAND RD TO ANDERSON DR)				F.A.P RTE.	SECTION	COUNTY	TOTAL SHEETS	SHEET NO.
		DRAWN -	REVISED -						342	2023-928-RS,SW	COOK	23	3
		CHECKED -	REVISED -		CONTRACT NO. 62W50								
	PLOT DATE = 1/25/2025	DATE -	REVISED -		ILLINOIS FED. AID PROJECT								
			SCALE:							SHEET 1	OF 2	SHEETS	STA.

[illegible][illegible]



- ### PROPOSED LEGEND

- ① HOT-MIX ASPHALT SURFACE COURSE, IL-9.5, MIX "D", N70, 1½"
- ② COMBINATION CONCRETE CURB AND GUTTER REMOVAL AND REPLACEMENT
- ③ GRADING AND SHAPING SHOULDER
- ④ AGGREGATE WEDGE SHOULDER TYPE B

NOTES:

- 1.) THE CONTRACTOR SHALL PATCH FIRST BEFORE MILLING.
- 2.) LONGITUDINAL JOINT SHALL BE PLACED OVER THE MILLED SURFACE.

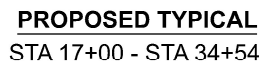

HOT-MIX ASPHALT MIXTURE REQUIREMENTS		QUALITY MANAGEMENT PROGRAM (QMP)
MIXTURE TYPE	AIR VOIDS @ N des	
PAVEMENT & SHOULDER RESURFACING		
HOT-MIX ASPHALT SURFACE COURSE, MIX "D", IL-9.5, N70, 1½"	4.0% AT 70 GYR.	QCP
PATCHING		
CLASS D PATCHES (HMA BINDER IL-19 mm)	4.0% AT 70 GYR.	QC/QA
HOT-MIX ASPHALT REPLACEMENT OVER PATCHES (HMA BINDER IL-19 MM)	4.0% AT 70 GYR.	QC/QA
QMP DESIGNATION: QUALITY CONTROL/QUALITY ASSURANCE (QC/QA); QUALITY CONTROL FOR PERFORMANCE (QCP); PAY FOR PERFORMANCE (PFP)		

NOTE 1: THE UNIT WEIGHT USED TO CALCULATE ALL HHMA SURFACE MIXTURES QUANTITIES IS 112 LBS/SQ YD/IN.

NOTE 2: THE "AC TYPE" FOR POLYMERIZED HMA MIXES SHALL BE "SBS/SBR PG 76-22" AND FOR NON-POLYMERIZED HMA THE "AC TYPE" SHALL BE "PG 64-22" UNLESS MODIFIED BY RECLAIMED MATERIALS SPECIFICATIONS.

* LOCATIONS TO BE DETERMINED IN THE FIELD BY THE ENGINEER

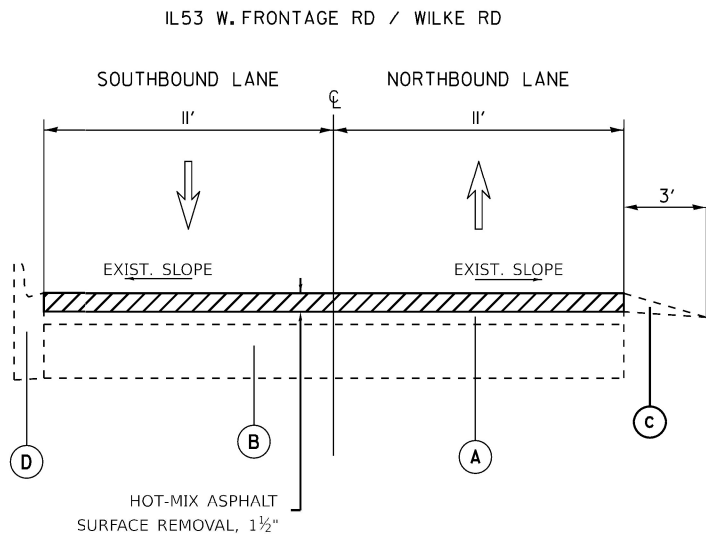

EXISTING TYPICAL
STA 34+54 - STA 49+00

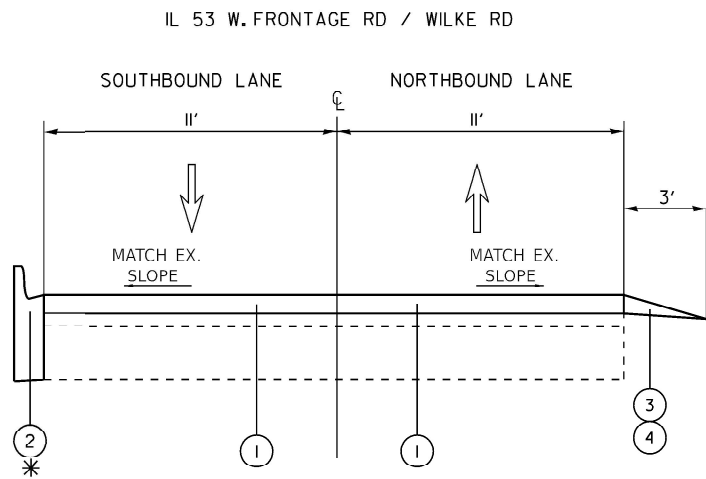

PROPOSED TYPICAL
STA 34+54 - STA 49+00

* LOCATIONS TO BE DETERMINED IN THE FIELD BY THE ENGINEER

EXISTING LEGEND

- (A) HOT-MIX ASPHALT PAVEMENT 2 ½"
- (B) PORTLAND CEMENT CONCRETE PAVEMENT 9"±
- (C) AGGREGATE SHOULDER 6"±
- (D) COMBINATION CONCRETE CURB AND GUTTER
- (E) HMA SHOULDERS 8"±
- (F) AGGREGATE SUBBASE

PROPOSED LEGEND

- ① HOT-MIX ASPHALT SURFACE COURSE, IL-9.5, MIX "D", N70, 1½"
- ② COMBINATION CONCRETE CURB AND GUTTER REMOVAL AND REPLACEMENT
- ③ GRADING AND SHAPING SHOUDLERS
- ④ AGGREGATE WEDGE SHOULDER TYPE B

MODEL: TYP 1 [Sheet]
FILE NAME: c:\pw\work\pwid\qarum\0940243D\13424-sht-typical.dgn

USER NAME = Nedaf.Qarui	DESIGNED -	REVISED -
	DRAWN -	REVISED -
	CHECKED -	REVISED -
PLOT DATE = 2/25/2025	DATE -	REVISED -

STATE OF ILLINOIS
DEPARTMENT OF TRANSPORTATION

TYPICAL SECTION
IL 53 W FRONTAGE RD (US 12 / RAND RD TO ALISON DR)

SCALE: SHEET 2 OF 4 SHEETS STA. TO STA.

F.A.P RTE.	SECTION	COUNTY	TOTAL SHEETS	SHEET NO.
342	2023-928-RS,SW	COOK	23	6
CONTRACT NO. 62W50				
ILLINOIS FED. AID PROJECT				

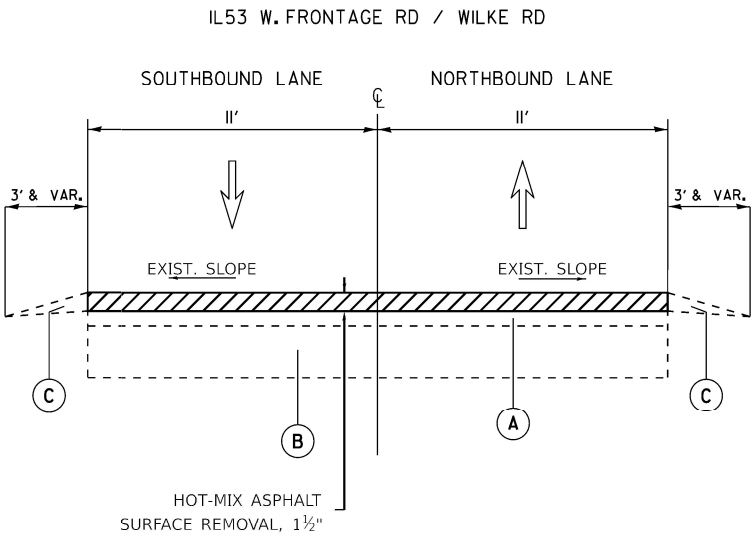

EXISTING TYPICAL
STA 49+00 - STA 76+00

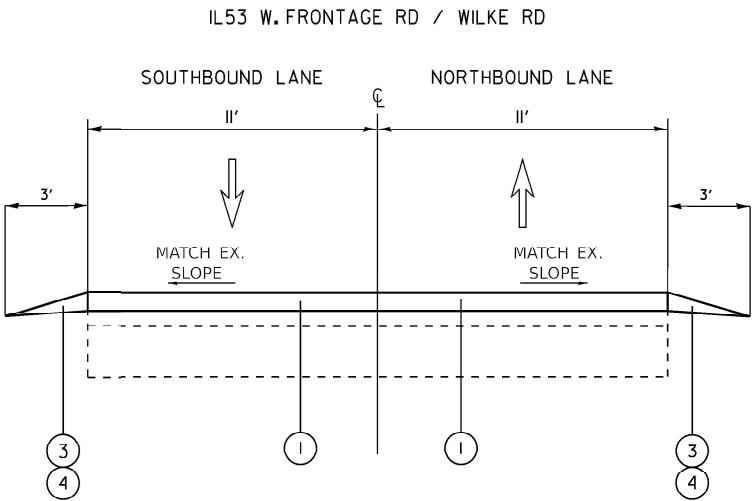

PROPOSED TYPICAL
STA 49+00 - STA 76+00

EXISTING LEGEND

- Ⓐ HOT-MIX ASPHALT PAVEMENT 2 ½"
- Ⓑ PORTLAND CEMENT CONCRETE PAVEMENT 9"±
- Ⓒ AGGREGATE SHOULDER 6"±
- Ⓓ COMBINATION CONCRETE CURB AND GUTTER
- Ⓔ HMA SHOULDERS 8"±
- Ⓕ AGGREGATE SUBBASE

PROPOSED LEGEND

- ① HOT-MIX ASPHALT SURFACE COURSE, IL-9.5, MIX "D", N70, 1½ "
- ② COMBINATION CONCRETE CURB AND GUTTER REMOVAL AND REPLACEMENT
- ③ GRADING AND SHAPING SHOUDLERS
- ④ AGGREGATE WEDGE SHOULDER TYPE B

MODEL: TYP2 [Sheet]
FILE NAME: c:\p\work\p\w\ilke\qarum\0940243D\13424-sht-typical.dgn

USER NAME = Nedaf.Qarui	DESIGNED -	REVISED -
	DRAWN -	REVISED -
	CHECKED -	REVISED -
PLOT DATE = 2/25/2025	DATE -	REVISED -

STATE OF ILLINOIS
DEPARTMENT OF TRANSPORTATION

TYPICAL SECTION
IL 53 W FRONTAGE RD (US 12 / RAND RD TO ALISON DR)

SCALE: SHEET 3 OF 4 SHEETS STA. TO STA.

F.A.P RTE.	SECTION	COUNTY	TOTAL SHEETS	SHEET NO.
342	2023-928-RS,SW	COOK	23	7
CONTRACT NO. 62W50				
ILLINOIS FED. AID PROJECT				

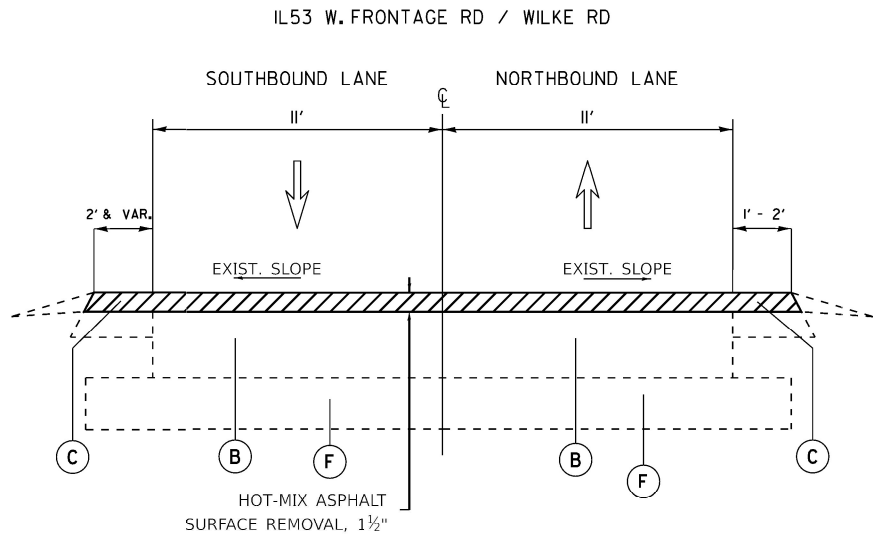

EXISTING TYPICAL
STA 76+00 - STA 86+29

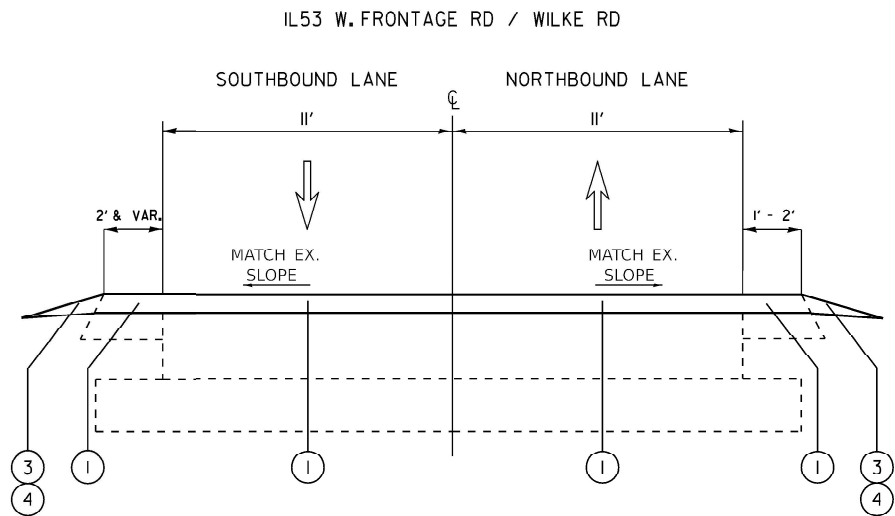

PROPOSED TYPICAL
STA 76+00 - STA 86+29

EXISTING LEGEND

- Ⓐ HOT-MIX ASPHALT PAVEMENT 2 ½"
- Ⓑ PORTLAND CEMENT CONCRETE PAVEMENT 9"±
- Ⓒ AGGREGATE SHOULDER 6"±
- Ⓓ COMBINATION CONCRETE CURB AND GUTTER
- Ⓔ HMA SHOULDERS 8"±
- Ⓕ AGGREGATE SUBBASE

PROPOSED LEGEND

- ① HOT-MIX ASPHALT SURFACE COURSE, IL-9.5, MIX "D", N70, 1½ "
- ② COMBINATION CONCRETE CURB AND GUTTER REMOVAL AND REPLACEMENT
- ③ GRADING AND SHAPING SHOUDLERS
- ④ AGGREGATE WEDGE SHOULDER TYPE B

MODEL: TYP 3 Sheet.dgn
FILE NAME: c:\p\work\p\wilke\qarut\mfd0940243D\13424-sht-typical.dgn

USER NAME = Nedaf.Qarut	DESIGNED -	REVISED -
	DRAWN -	REVISED -
	CHECKED -	REVISED -
PLOT DATE = 2/25/2025	DATE -	REVISED -

STATE OF ILLINOIS
DEPARTMENT OF TRANSPORTATION

TYPICAL SECTION
IL 53 W FRONTAGE RD (US 12 / RAND RD TO ALISON DR)

SCALE: SHEET 4 OF 4 SHEETS STA. TO STA.

F.A.P RTE.	SECTION	COUNTY	TOTAL SHEETS	SHEET NO.
342	2023-928-RS,SW	COOK	23	8
CONTRACT NO. 62W50				
ILLINOIS FED. AID PROJECT				

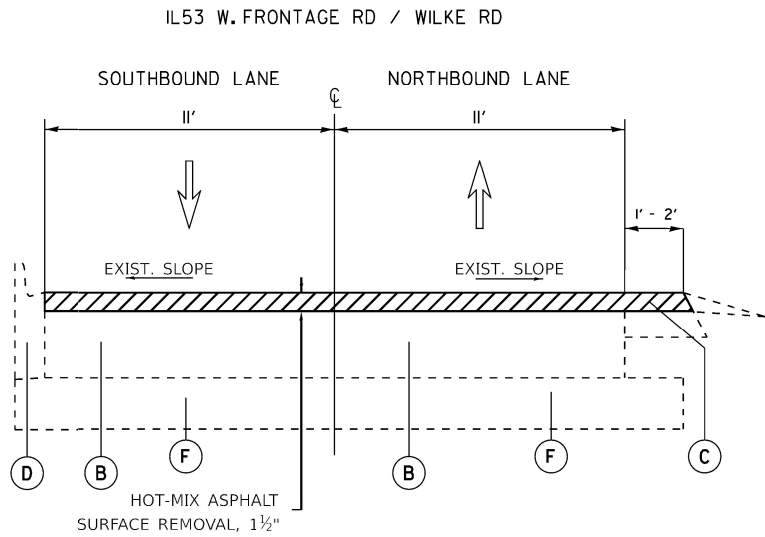

EXISTING TYPICAL
STA 86+29 - STA 91+94

EXISTING LEGEND

- Ⓐ HOT-MIX ASPHALT PAVEMENT 2 ½"
- Ⓑ PORTLAND CEMENT CONCRETE PAVEMENT 9"±
- Ⓒ AGGREGATE SHOULDER 6"±
- Ⓓ COMBINATION CONCRETE CURB AND GUTTER
- Ⓔ HMA SHOULDERS 8"±
- Ⓕ AGGREGATE SUBBASE

PROPOSED LEGEND

- ① HOT-MIX ASPHALT SURFACE COURSE, IL-9.5, MIX "D", N70, 1½ "
- ② COMBINATION CONCRETE CURB AND GUTTER REMOVAL AND REPLACEMENT
- ③ GRADING AND SHAPING SHOUDLERS
- ④ AGGREGATE WEDGE SHOULDER TYPE B

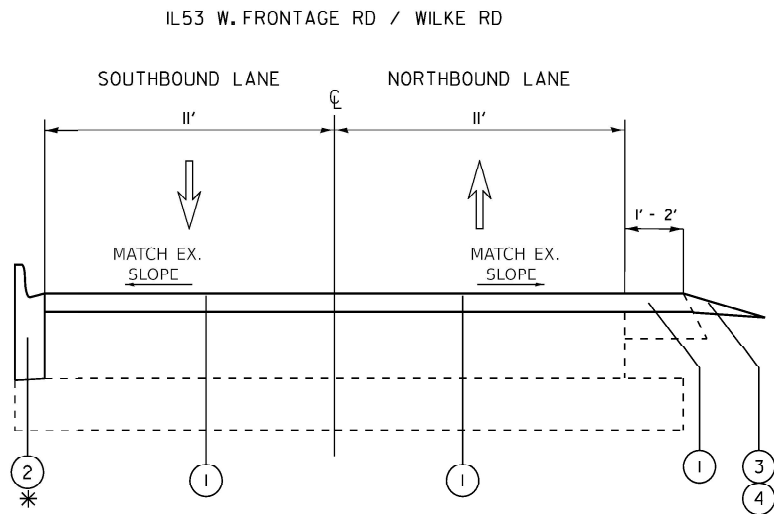

PROPOSED TYPICAL
STA 86+29 - STA 91+94

* LOCATIONS TO BE DETERMINED IN THE FIELD BY THE ENGINEER

MODEL: TYP4 [Sheet]
FILE NAME: c:\pw\work\pwid\qarum\0940243D\13424-sht\typical.dgn

	USER NAME = Nedaf.Qarut	DESIGNED -	REVISED -	STATE OF ILLINOIS DEPARTMENT OF TRANSPORTATION	TYPICAL SECTION IL 53 W FRONTAGE RD (US 12 / RAND RD TO ALISON DR)			F.A.P. RTE.	SECTION	COUNTY	TOTAL SHEETS	SHEET NO.
		DRAWN -	REVISED -					342	2023-928-RS.SW	COOK	23	8A
		CHECKED -	REVISED -					CONTRACT NO. 62W50				
	PLOT DATE = 2/25/2025	DATE -	REVISED -		SCALE:	SHEET 000	OF	SHEETS	STA.	TO STA.	ILLINOIS FED. AID PROJECT	

MODEL: \\ILKE - Rdw\Plan01 [Sheet]
FILE NAME: c:\pw\work\pwl04\plan01\13424-shr-plan.dgn

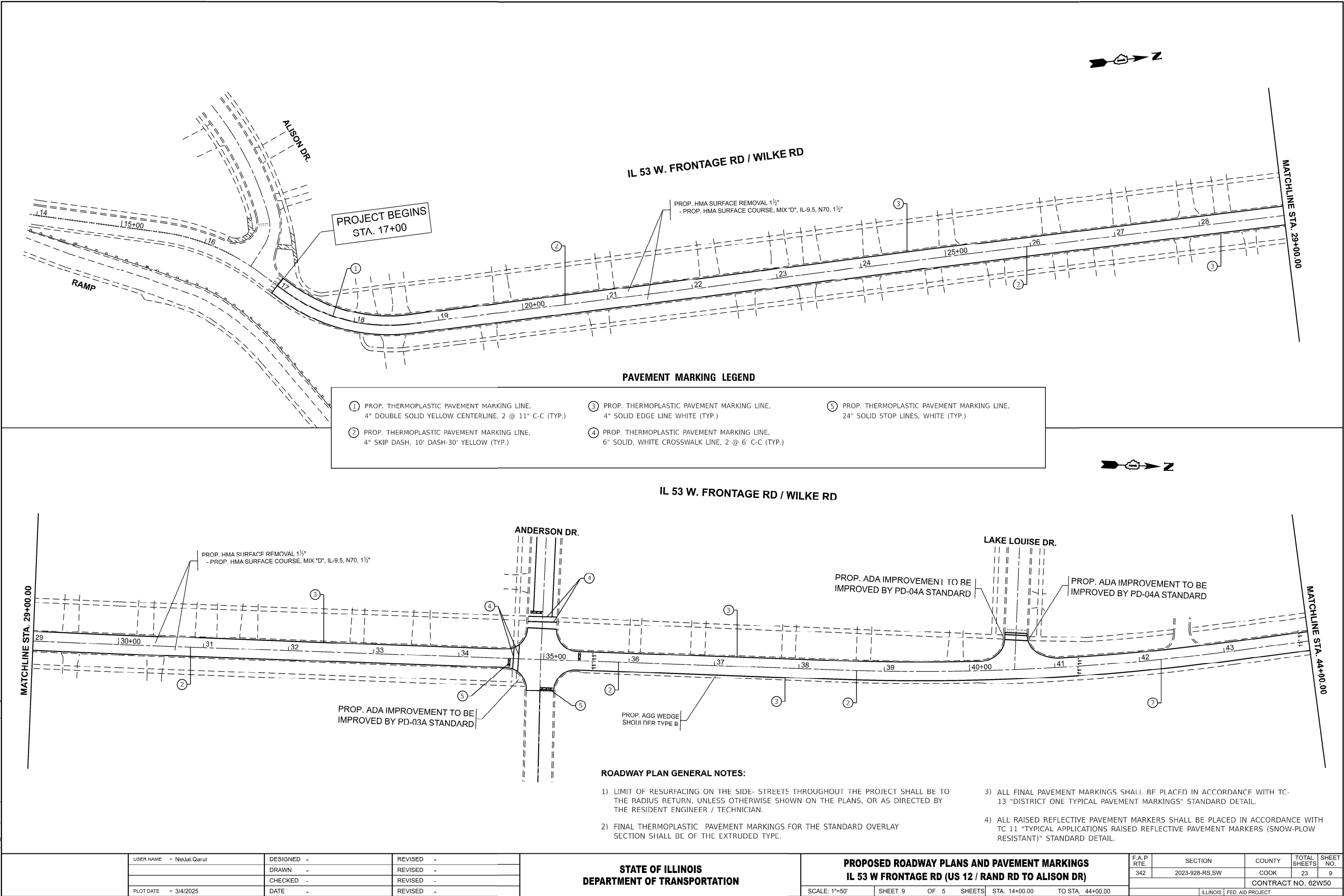

IL 53 W. FRONTAGE RD / WILKE RD

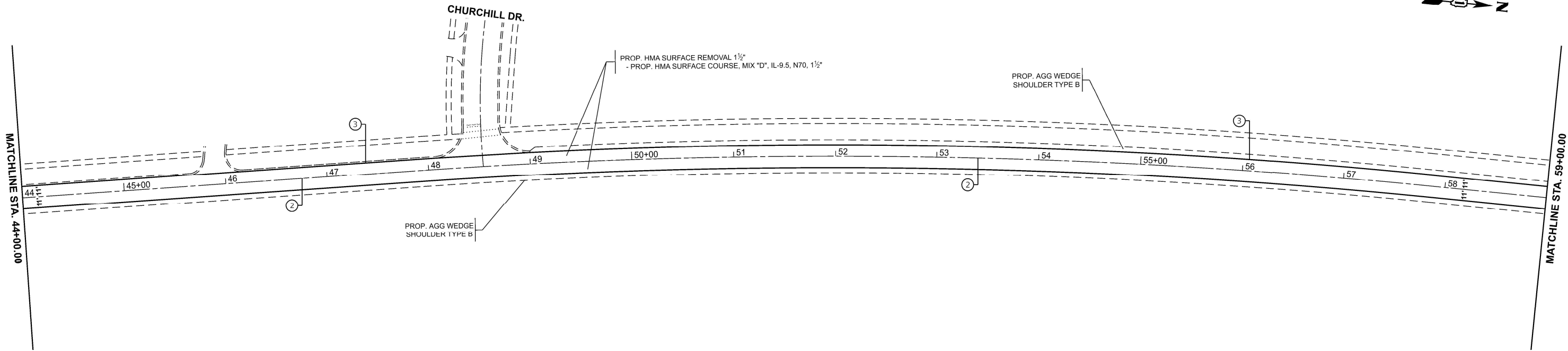

PAVEMENT MARKING LEGEND

- ① PROP. THERMOPLASTIC PAVEMENT MARKING LINE,
4" DOUBLE SOLID YELLOW CENTERLINE, 2 @ 11" C-C (TYP.)

② PROP. THERMOPLASTIC PAVEMENT MARKING LINE,
4" SKIP DASH, 10' DASH-30' YELLOW (TYP.)
- ③ PROP. THERMOPLASTIC PAVEMENT MARKING LINE,
4" SOLID EDGE LINE WHITE (TYP.)

④ PROP. THERMOPLASTIC PAVEMENT MARKING LINE,
6" SOLID, WHITE CROSSWALK LINE, 2 @ 6' C-C (TYP.)
- ⑤ PROP. THERMOPLASTIC PAVEMENT MARKING LINE,
24" SOLID STOP LINES, WHITE (TYP.)

IL 53 W. FRONTAGE RD / WILKE RD

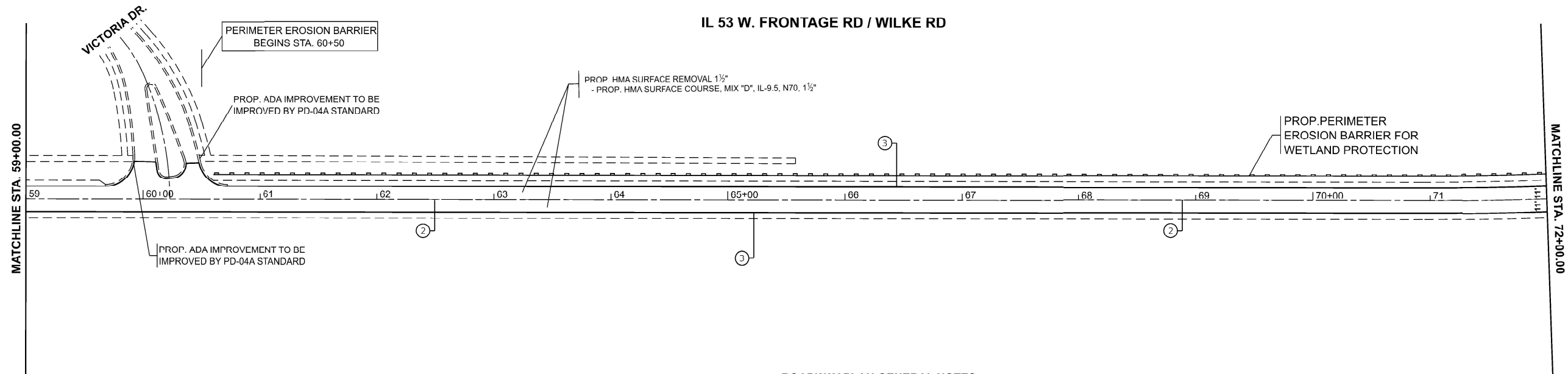

ROADWAY PLAN GENERAL NOTES:

- 1) LIMIT OF RESURFACING ON THE SIDE- STREETS THROUGHOUT THE PROJECT SHALL BE TO THE RADIUS RETURN, UNLESS OTHERWISE SHOWN ON THE PLANS, OR AS DIRECTED BY THE RESIDENT ENGINEER / TECHNICIAN.

2) FINAL THERMOPLASTIC PAVEMENT MARKINGS FOR THE STANDARD OVERLAY SECTION SHALL BE OF THE EXTRUDED TYPE.
- 3) ALL FINAL PAVEMENT MARKINGS SHALL BE PLACED IN ACCORDANCE WITH TC-13 "DISTRICT ONE TYPICAL PAVEMENT MARKINGS" STANDARD DETAIL.

4) ALL RAISED REFLECTIVE PAVEMENT MARKERS SHALL BE PLACED IN ACCORDANCE WITH TC-11 "TYPICAL APPLICATIONS RAISED REFLECTIVE PAVEMENT MARKERS (SNOW-PLOW RESISTANT)" STANDARD DETAIL.

MODEL: \\ILKE - Rdw\Plan03 [Sheet]
FILE NAME: c:\pwworking\dwg\plan\03\13424-sht-plan.dgn

	USER NAME = Nedal.Qarut	DESIGNED -	REVISED -	STATE OF ILLINOIS DEPARTMENT OF TRANSPORTATION	PROPOSED ROADWAY PLANS AND PAVEMENT MARKINGS IL 53 W FRONTAGE RD (US 12 / RAND RD TO ALISON DR)	F.A.P RTE.	SECTION	COUNTY	TOTAL SHEETS	SHEET NO.
		DRAWN -	REVISED -			342	2023-928-RS,SW	COOK	23	10
		CHECKED -	REVISED -			CONTRACT NO. 62W50				
	PLOT DATE = 3/4/2025	DATE -	REVISED -			ILLINOIS FED. AID PROJECT				
						SCALE: 1"=50'	SHEET 10	OF 5	SHEETS	STA. 44+00.00 TO STA. 72+00.00

MODEL: \\ILKE - Rdw\Plan05 [Sheet]
FILE NAME: c:\pw\work\pilot\plan\05\04243D\13424-sht-plan.dgn

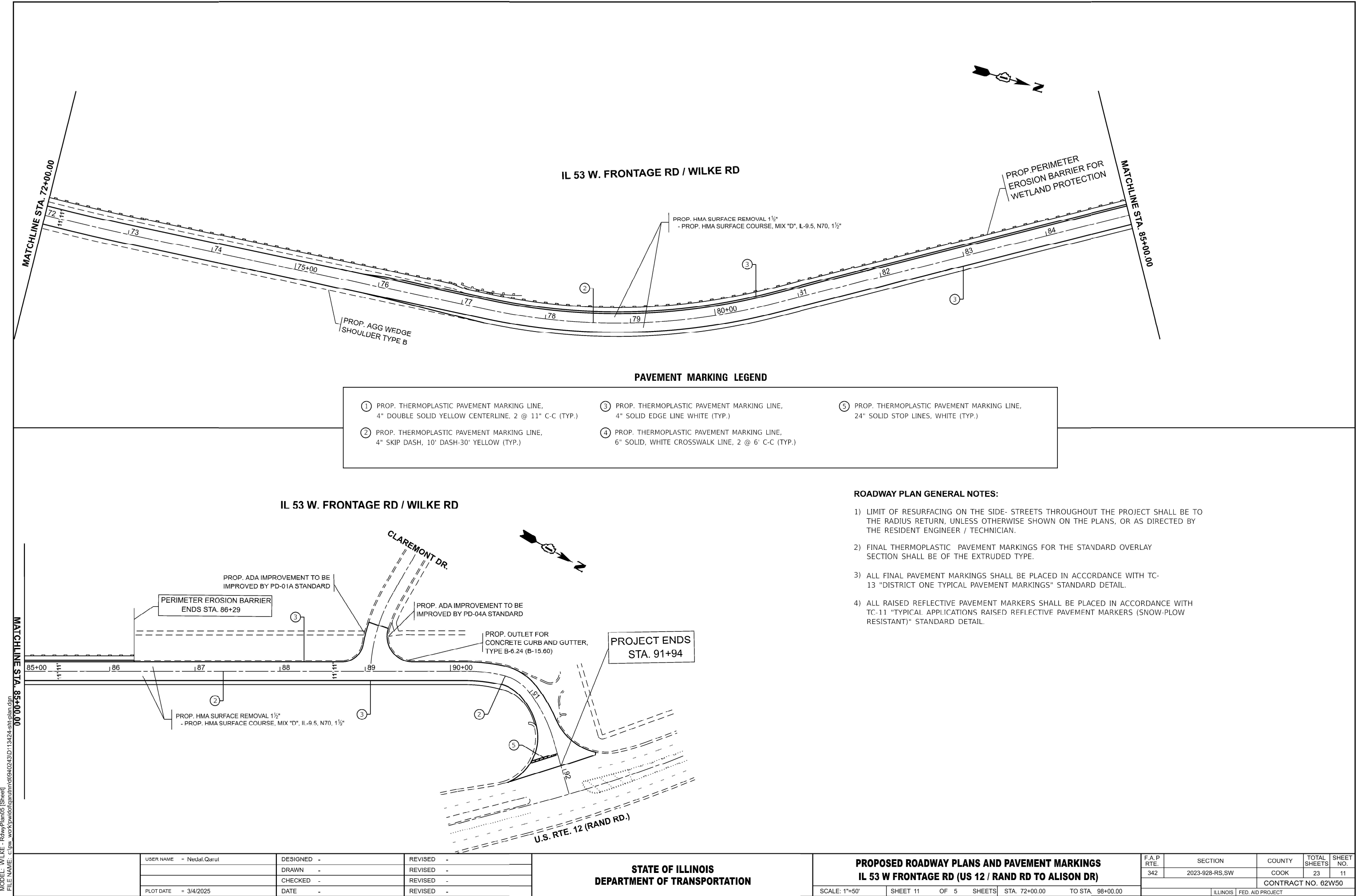

	USER NAME	= Nedaf.Qarut	DESIGNED	-	REVISED	-
	DRAWN	-	CHECKED	-	REVISED	-
	DATE	-	DATE	-	REVISED	-
	PLOT DATE	= 3/4/2025				

STATE OF ILLINOIS
DEPARTMENT OF TRANSPORTATION

PROPOSED ROADWAY PLANS AND PAVEMENT MARKINGS
IL 53 W FRONTAGE RD (US 12 / RAND RD TO ALISON DR)

SCALE: 1"=50'

SHEET 11 OF 5 SHEETS

STA. 72+00.00 TO STA. 98+00.00

F.A.P RTE.	SECTION	COUNTY	TOTAL SHEETS	SHEET NO.
342	2023-928-RS,SW	COOK	23	11
CONTRACT NO. 62W50				
ILLINOIS FED. AID PROJECT				

ADA DETAIL FOR SINGLE PERPENDICULAR CURB RAMPS W/ EXIST. 5% OR LESS RUN. SLOPE

PD-01A

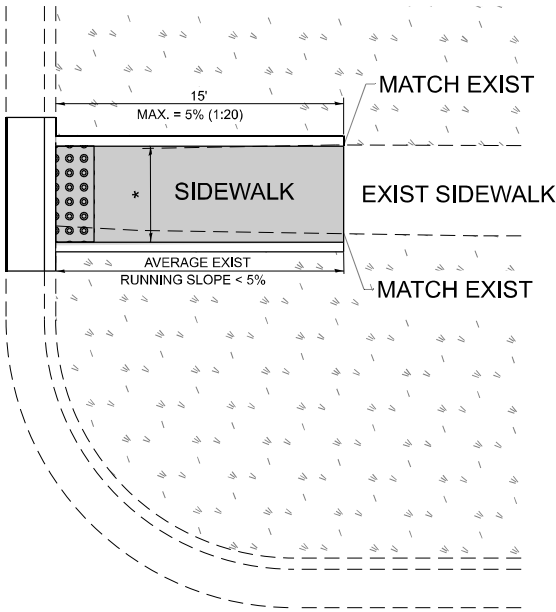

PD-01B

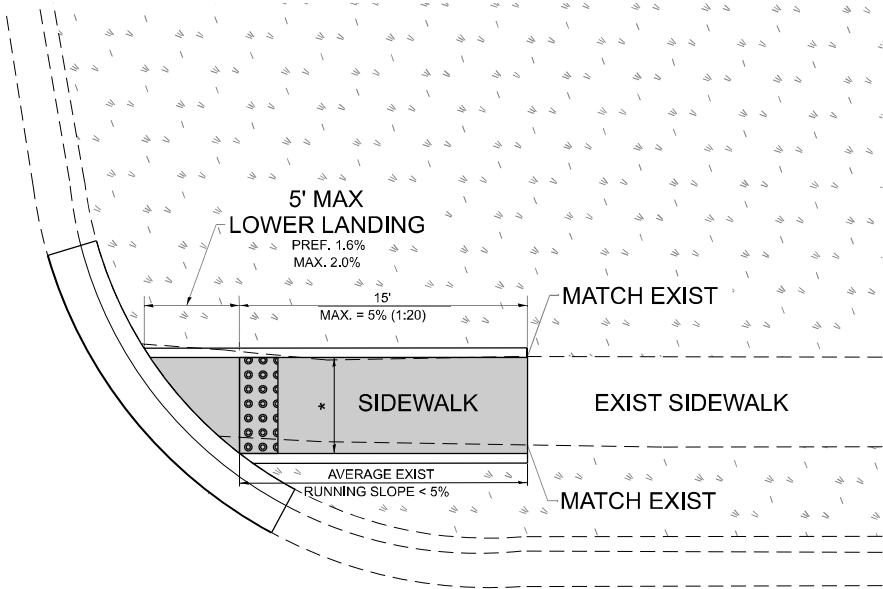

PD-01C

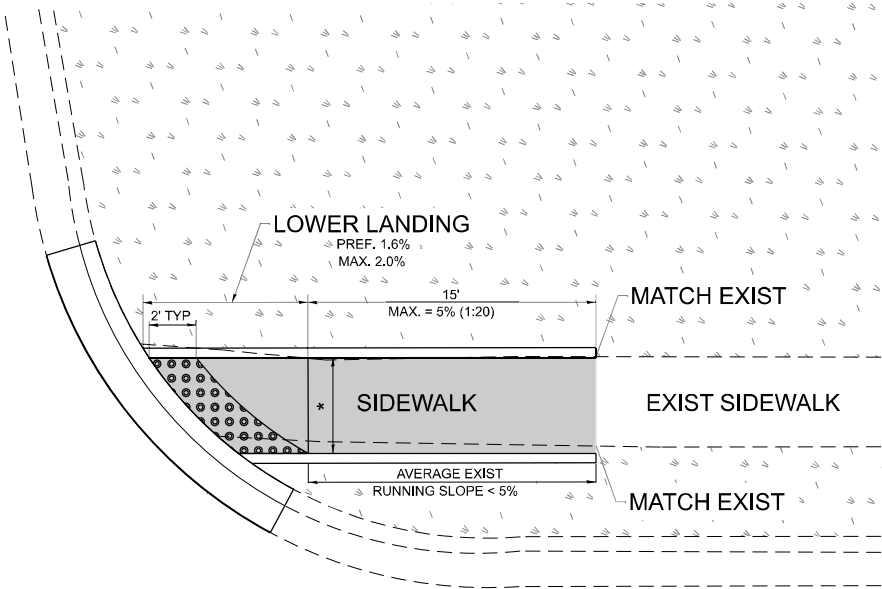

LEGEND

- 

EXIST. GRASS
- 

PROPOSED SIDEWALK
- 

DETECTABLE WARNINGS
- 

PROPOSED SIDE CURB

CONSTRUCTION NOTES:

- 1) ALL CROSS SLOPES ARE PREFERRED 1.6% (1:64), MAXIMUM 2% (1:50) EXCEPT WHEN TRANSITIONING TO EXISTING SIDEWALK
- * MATCH EXISTING SIDEWALK WIDTH

MODEL: PD-01 (Sheet)
FILE NAME: c:\p\work\pd01garum\pd01garum.dgn

	USER NAME = Nedat.Qarut	DESIGNED -	REVISED -
		DRAWN - R. LEDEZMA	REVISED -
		CHECKED -	REVISED -
	PLOT DATE = 1/7/2025	DATE - 10/02/2019	REVISED -

STATE OF ILLINOIS
DEPARTMENT OF TRANSPORTATION

PROJECT DETAIL FOR SINGLE PERPENDICULAR CURB RAMPS
(PD-01)

SCALE: NONE SHEET 1 OF 1 SHEETS STA. TO STA.

F.A.P RTE.	SECTION	COUNTY	TOTAL SHEETS	SHEET NO.
342	2023-928-RS,SW	COOK	23	12
PD-01		CONTRACT NO. 62W50		
ILLINOIS		FED. AID PROJECT		



1. EXISTING BROKEN FRAMES AND LIDS SHALL BE REMOVED AND DISPOSED OF BY THE CONTRACTOR AND SHALL BE REPLACED AS DIRECTED BY THE ENGINEER. REPLACEMENT FRAMES AND LIDS WILL BE PAID FOR IN ACCORDANCE WITH ARTICLE 109.04 OF THE STANDARD SPECIFICATIONS UNLESS A SEPARATE PAY ITEM HAS BEEN PROVIDED.
2. IF THE EXISTING LIDS ARE OPEN, THE FRAME WILL BE ADJUSTED TO THE ELEVATION OF THE MILLED PAVEMENT SURFACE PRIOR TO THE MILLING OPERATION. THE FRAME WILL NOT BE REMOVED AND COVERED BY THE METAL PLATE
3. CITY OF CHICAGO CASTINGS ARE THE PROPERTY OF THE CITY AND THE CONTRACTOR SHALL NOTIFY THE CITY FOR REMOVAL AND DISPOSITION OF THE CASTINGS.
4. THE METAL PLATE USED TO COVER THE STRUCTURE SHALL REMAIN THE PROPERTY OF THE CONTRACTOR.
5. THE CONTRACTOR SHALL REMOVE ALL TRAFFIC CONTROL DEVICES BY THE END OF EACH WORK SHIFT.

STAGE 1 (BEFORE PAVEMENT MILLING)

- A) REMOVE A MINIMUM OF 12 (300) OF THE PAVEMENT FROM AROUND THE STRUCTURE.
- B) REMOVE THE EXISTING FRAME AND LID FROM THE STRUCTURE.
- C) COVER THE STRUCTURE OPENING WITH A 36 (900) DIAMETER METAL PLATE.
- D) BACKFILL WITH CRUSHED STONE AND HMA SURFACE MIX APPROVED BY THE ENGINEER. (MIN. 3 (80) HMA TO REMAIN AFTER MILLING).

***UNLESS OTHERWISE SPECIFIED IN THE PLANS.**

THE PROCEDURE EXPLAINED ABOVE SHALL CONFORM TO THE APPLICABLE PORTIONS OF SECTIONS 353, 406, 602, AND 603 OF THE STANDARD SPECIFICATIONS EXCEPT THAT "THE CONTRACTOR SHALL ADJUST THE STRUCTURES TO THE FINISHED PAVEMENT ELEVATION NO MORE THAN 5 CALENDAR DAYS PRIOR TO PLACEMENT OF THE FINAL LIFT OF SURFACE UNLESS APPROVED BY THE ENGINEER."

① SUB-BASE GRANULAR MATERIAL	⑥ FRAME AND LID (SEE NOTES)
② EXISTING PAVEMENT	⑦ CLASS PP-2* CONCRETE
③ 36 (900) DIAMETER METAL PLATE	⑧ PROPOSED HMA SURFACE COURSE
④ PROPOSED CRUSHED STONE AND HMA SURFACE MIX	⑨ PROPOSED HMA BINDER COURSE
⑤ EXISTING STRUCTURE	

THE CONTRACTOR WILL BE REQUIRED TO KEEP A RECORD OF THE LOCATIONS OF THE BURIED STRUCTURES ACCORDING TO THE STATION AND DISTANCE LEFT OR RIGHT OF THE CENTERLINE OF PAVEMENT. UPON COMPLETION OF THE WORK, THE CONTRACTOR WILL DELIVER THE RECORD TO THE ENGINEER.

1. REMOVING FRAMES AND LIDS ON DRAINAGE AND UTILITY STRUCTURES IN THE PAVEMENT PRIOR TO MILLING, AND ADJUSTING TO FINAL GRADE PRIOR TO PLACING THE SURFACE COURSE, WILL BE PAID FOR AT THE CONTRACT UNIT PRICE EACH FOR "FRAMES AND LIDS TO BE ADJUSTED (SPECIAL)."
2. THIS WORK WILL NOT BE PAID FOR WHEN DRAINAGE AND UTILITY STRUCTURES ARE SPECIFIED FOR PAYMENT AS STRUCTURE RECONSTRUCTION.
3. NEW FRAMES AND LIDS, WHEN SPECIFIED, WILL BE PAID FOR SEPARATELY.
4. WHEN STRUCTURES ARE TO BE ADJUSTED OR RECONSTRUCTED, THE LOWERING AND RAISING OF THE FRAMES AND LIDS WILL NOT BE PAID FOR SEPARATELY BUT WILL BE INCLUDED IN THE COST OF THE CORRESPONDING PAY ITEM.

	USER NAME = Nedal.Qarut	DESIGNED - R. SHAH	REVISED - R. BORO 03-09-11	STATE OF ILLINOIS DEPARTMENT OF TRANSPORTATION	DETAILS FOR FRAMES AND LIDS ADJUSTMENT WITH MILLING				F.A.P RTE.	SECTION	COUNTY	TOTAL SHEETS	SHEET NO.
		DRAWN -	REVISED - R. BORO 12-06-11						342	2023-028-RS.SW	COOK	23	14
		CHECKED -	REVISED - K. SMITH 11-18-22		BD600-03 (BD-08)				CONTRACT NO. 62W50				
	PLOT DATE = 1/7/2025	DATE - 10-25-94	REVISED - K. SMITH 09-15-23		SCALE: NONE	SHEET 1	OF 1	SHEETS	STA.	TO STA.			

METHOD OF MEASUREMENT

REFER TO SECTION 442 OF THE STANDARD SPECIFICATIONS FOR ROAD AND BRIDGE CONSTRUCTION AND THE RECURRING SPECIAL PROVISION "PATCHING WITH HOT-MIX ASPHALT OVERLAY REMOVAL."

BASIS OF PAYMENT

- 1. REFER TO SECTION 442 OF THE STANDARD SPECIFICATIONS FOR ROAD AND BRIDGE CONSTRUCTION AND THE RECURRING SPECIAL PROVISION "PATCHING WITH HOT-MIX ASPHALT OVERLAY REMOVAL."
- 2. SAW CUT/SCORING OF EXISTING HMA OVERLAY IS INCLUDED IN THE COST OF PAVEMENT PATCHING.
- 3. SAW CUT/SCORING OF EXISTING PAVEMENT IS INCLUDED IN THE COST OF PAVEMENT PATCHING.

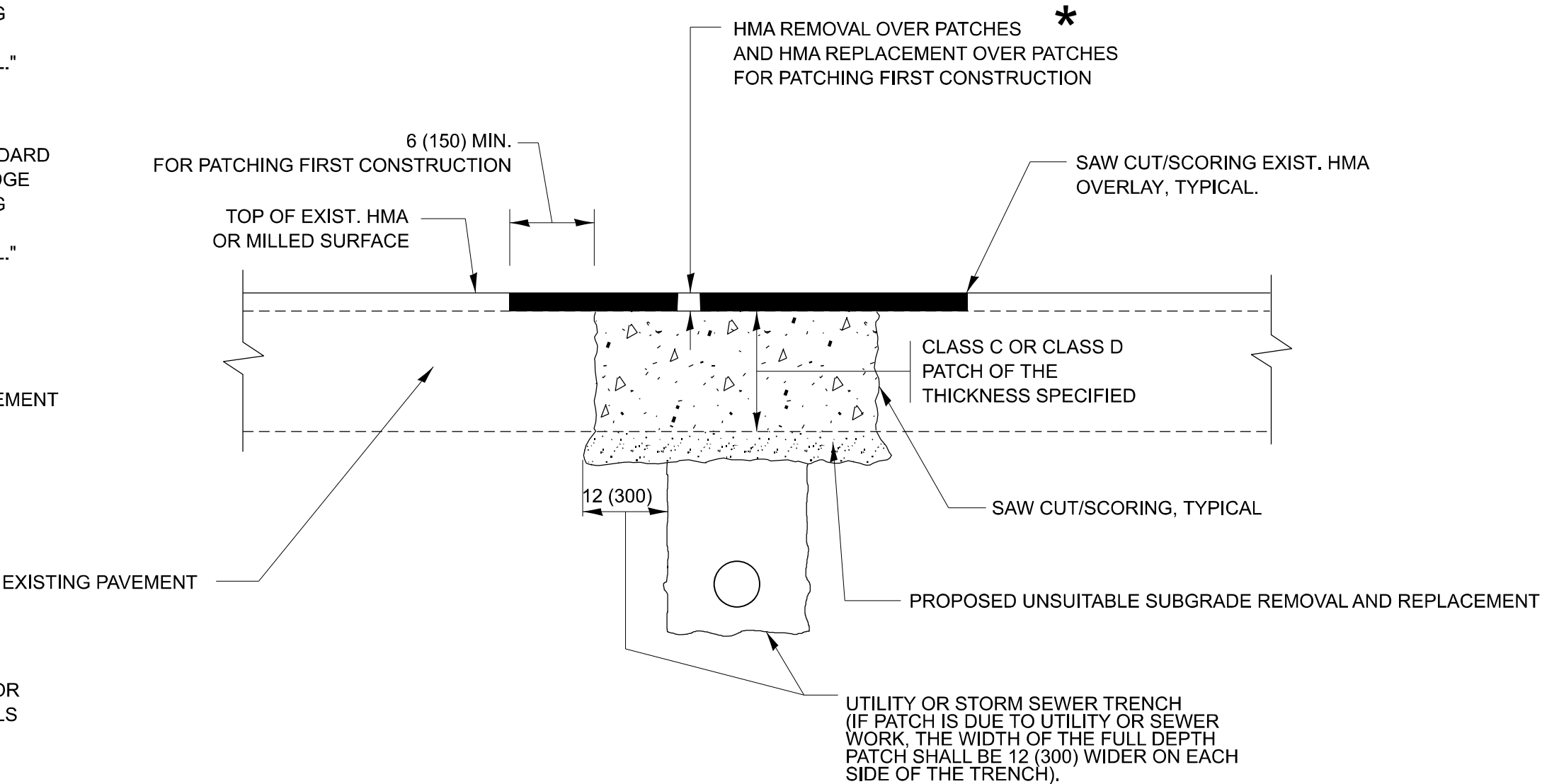

* SEE TYPICAL SECTIONS FOR THICKNESS AND MATERIALS

SEQUENCE OF CONSTRUCTION (PATCHING FIRST)

- 1. REMOVE THE EXISTING HMA MATERIAL OVER THE AREA TO BE PATCHED.
- 2. REMOVE AND REPLACE WITH CLASS C OR D PATCH.
- 3. REPLACE HMA MATERIAL OVER THE AREA TO BE PATCHED.

SEQUENCE OF CONSTRUCTION (MILLING FIRST)

- 1. MILL HMA FIRST IF THERE IS AT LEAST 4 1/2 INCHES OR MORE OF HMA MATERIAL ON TOP OF THE EXISTING PAVEMENT OR IF THE PAVEMENT IS FULL DEPTH HMA. A MINIMUM OF 2 INCHES OF HMA MATERIAL SHALL BE IN PLACE AFTER MILLING.
- 2. REMOVE AND REPLACE WITH FULL DEPTH CLASS D PATCHES TO TOP OF MILLED SURFACE.

ALL DIMENSIONS ARE IN INCHES (MILLIMETERS) UNLESS OTHERWISE SHOWN.

MODEL: BD10 (Sheet)
FILE NAME: c:\p\work\pav\garum\bd940243\13424-sh-DistSds.dgn

	USER NAME = Nedal.Qarut	DESIGNED - R. SHAH	REVISED - R. BORO 01-01-07	STATE OF ILLINOIS DEPARTMENT OF TRANSPORTATION	PAVEMENT PATCHING FOR HMA SURFACED PAVEMENT				F.A.P RTE.	SECTION	COUNTY	TOTAL SHEETS	SHEET NO.
		DRAWN -	REVISED - R. BORO 09-04-07						342	2023-928-RS.SW	COOK	23	15
		CHECKED -	REVISED - K. ENG 10-27-08						BD400-04 (BD-22) CONTRACT NO. 62W50				
	PLOT DATE = 1/7/2025	DATE - 10-25-94	REVISED - K. SMITH 11-18-22		ILLINOIS FED. AID PROJECT								
					SCALE: NONE	SHEET 1	OF 1	SHEETS	STA.	TO STA.			

MODEL: BD11 [Sheet]
FILE NAME: c:\p\work\qarut\qarut\0940243\013424-sh-DistSds.dgn

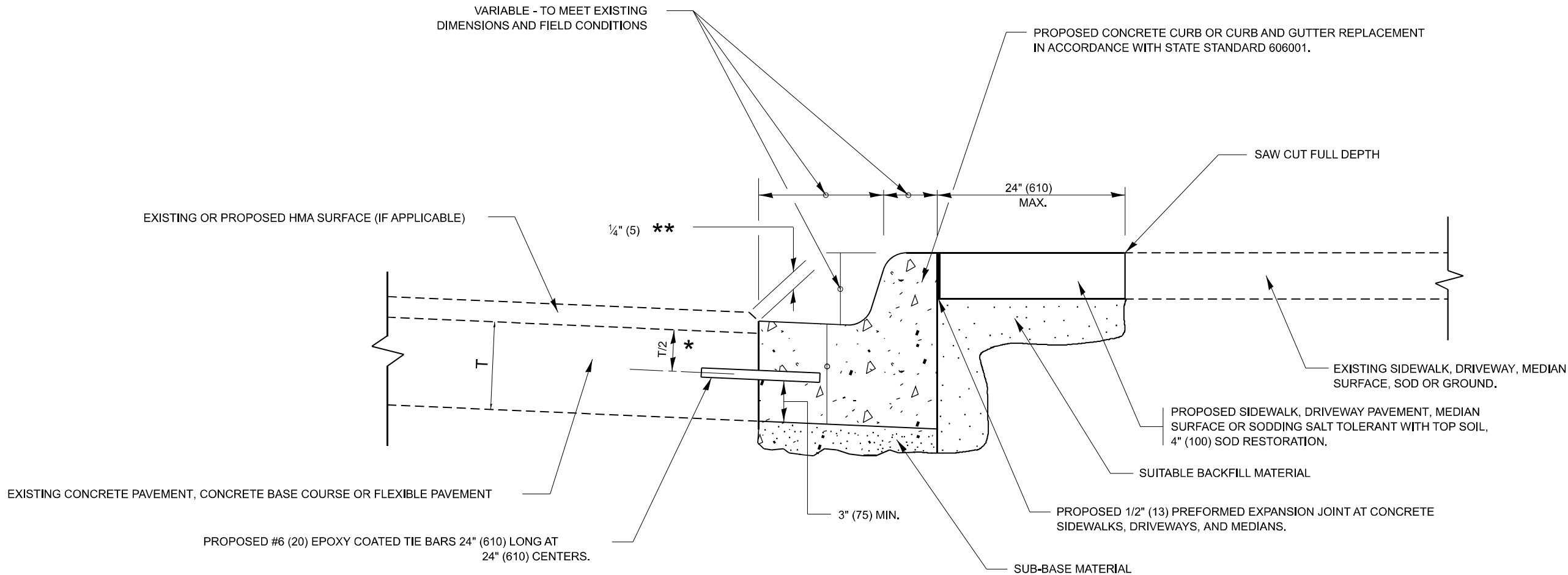

- * 3" (75) MINIMUM FROM TOP AND BOTTOM OF THE CONCRETE PAVEMENT OR BASE COURSE.
- ** IF THE FINAL SURFACE OF THE PAVEMENT IS CONCRETE, THE GUTTER IS TO BE FLUSH WITH THE PAVEMENT.

CURB OR CURB AND GUTTER REMOVAL AND REPLACEMENT

ALL DIMENSIONS ARE IN INCHES (MILLIMETERS)
UNLESS OTHERWISE SHOWN.

	USER NAME = Nedal.Qarut	DESIGNED - A. HOUSEH	REVISED - A. ABBAS 03-21-97	STATE OF ILLINOIS DEPARTMENT OF TRANSPORTATION	CURB OR CURB AND GUTTER REMOVAL AND REPLACEMENT				F.A.P RTE.	SECTION	COUNTY	TOTAL SHEETS	SHEET NO.
		DRAWN -	REVISED - M. GOMEZ 01-22-01						342	2023-928-RS,SW	COOK	23	16
		CHECKED -	REVISED - R. BORO 12-15-09						BD600-06 (BD-24)				
	PLOT DATE = 1/7/2025	DATE - 03-11-94	REVISED - K. SMITH 07-11-19		SCALE: NONE		SHEET 1	OF 1	SHEETS	STA.	TO STA.		
							ILLINOIS FED. AID PROJECT						

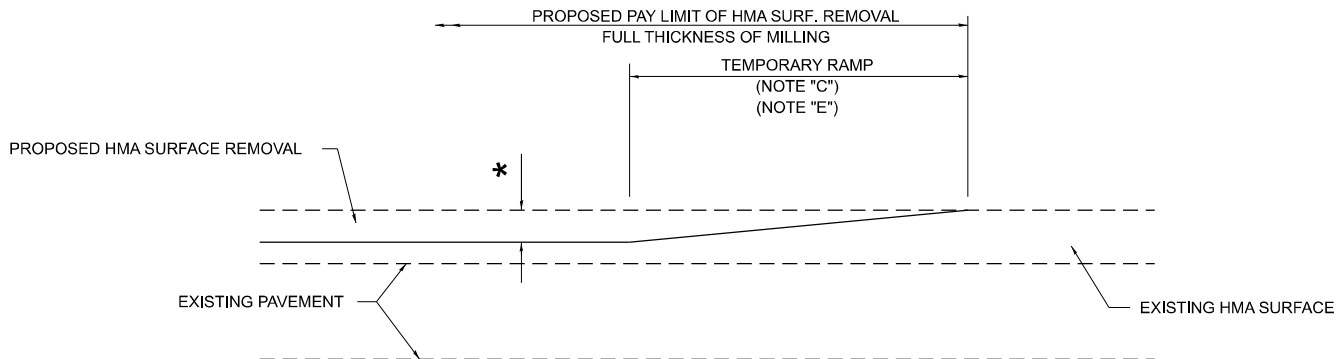

MILLED TEMPORARY RAMP
(FOR BUTT JOINT AND HMA TAPER SEE DETAIL BELOW)

OPTION 1

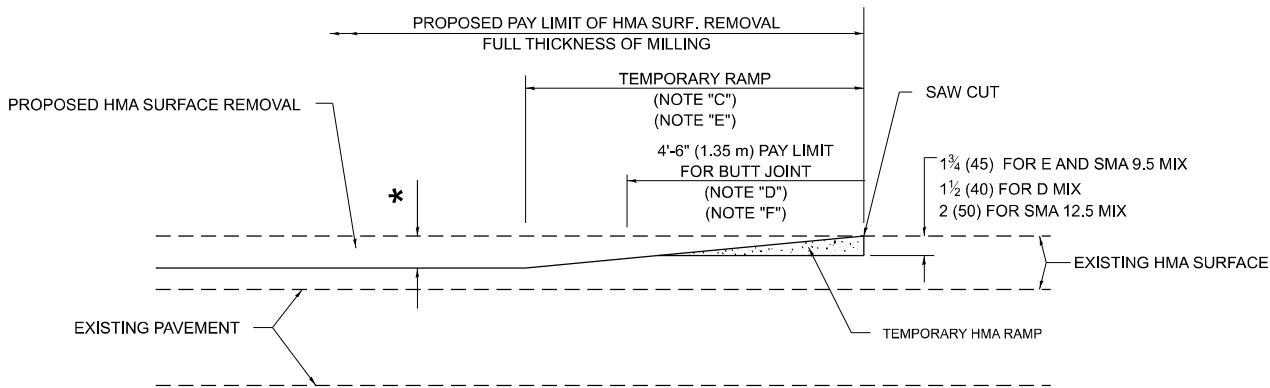

HMA CONSTRUCTED TEMPORARY RAMP
(FOR BUTT JOINT AND HMA TAPER SEE DETAIL BELOW)

OPTION 2

TYPICAL TEMPORARY RAMP

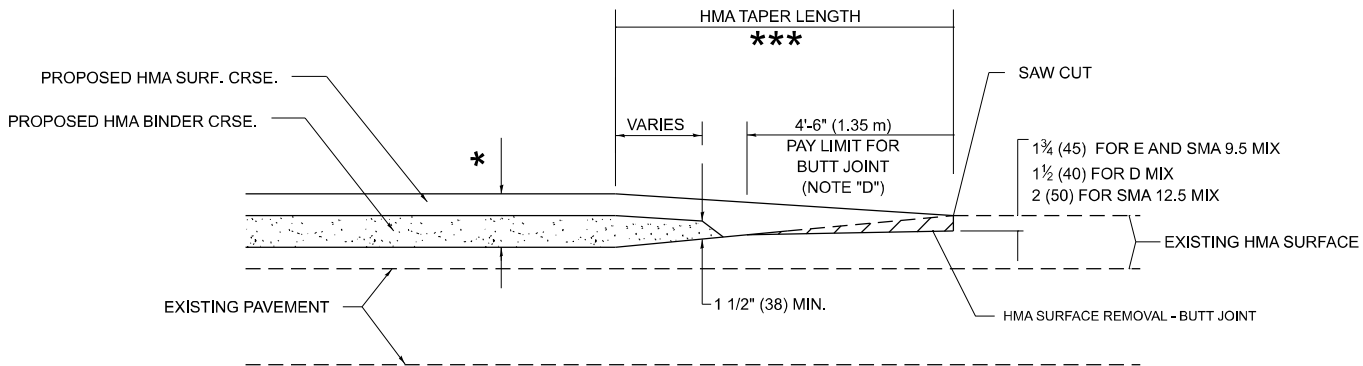

**BUTT JOINT AND
HMA TAPER**

**TYPICAL BUTT JOINT AND HMA TAPER
FOR MILLING AND RESURFACING**

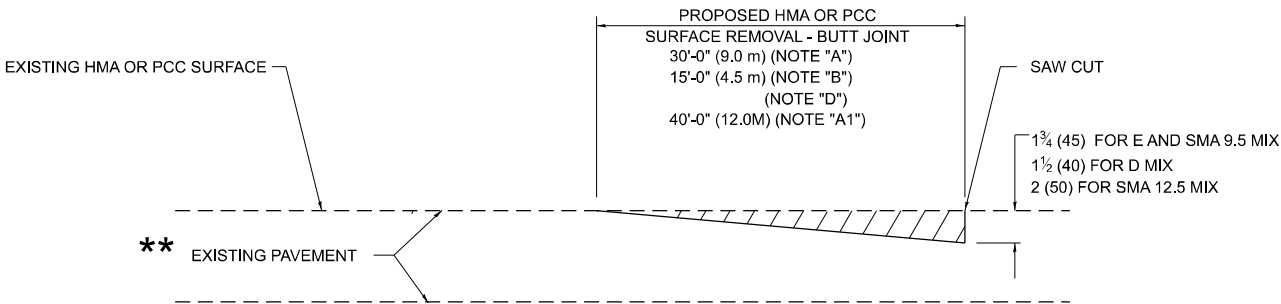

BUTT JOINT DETAIL

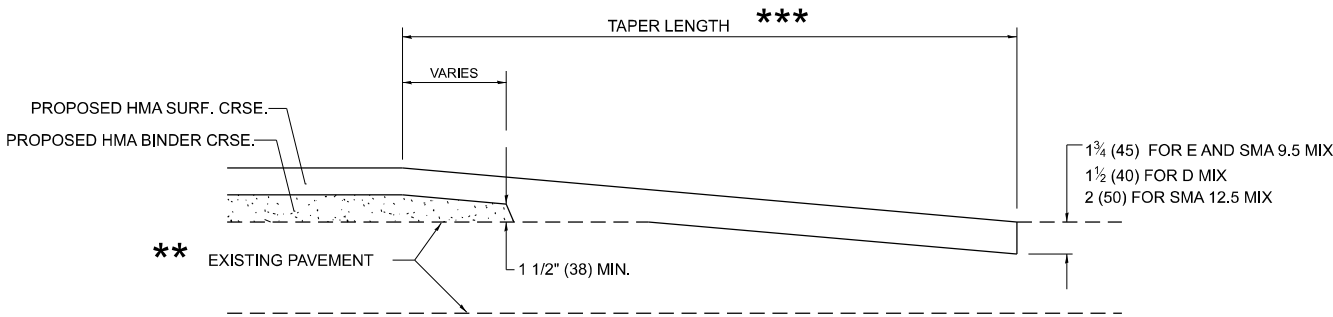

HMA TAPER DETAIL

**TYPICAL BUTT JOINT AND HMA TAPER
FOR RESURFACING ONLY**

****** PC CONCRETE, HMA OR HMA RESURFACED PAVEMENT.

GENERAL NOTES

- A. MAINLINE ARTERIAL ROADWAYS AND MAJOR SIDE ROADS.
- A1. INTERSTATES
- B. MINOR SIDE ROADS.
- C. THE TEMP. RAMP SHALL BE CONSTRUCTED IMMEDIATELY UPON REMOVAL OF THE EXISTING HMA SURFACE.
- D. THE BUTT JOINT SHALL BE CONSTRUCTED IMMEDIATELY PRIOR TO PLACING THE PROPOSED HMA COURSES.
- E. TAPER THE TEMP. RAMP AT A RATE OF 3' - 4" (1.02m) PER 1 INCH (25 mm) OF MILLING THICKNESS.
***** SEE TYPICAL SECTIONS FOR MILLING THICKNESS.
- F. SEE ARTICLE 406.08 AND 406.14 OF THE STANDARD SPECIFICATIONS FOR "HMA AND/OR PCC SURFACE REMOVAL, BUTT JOINT".

20'-0" (6.1 m) PER 1 (25) RESURFACING (NOTE "A")
10'-0" (3.0 m) PER 1 (25) RESURFACING (NOTE "B")

BASIS OF PAYMENT

- 1. THE BUTT JOINT WILL BE PAID FOR AT THE CONTRACT UNIT PRICE PER SQUARE YARD (SQUARE METER) FOR "HOT-MIX ASPHALT SURFACE REMOVAL - BUTT JOINT" OR FOR "PORTLAND CEMENT CONCRETE SURFACE REMOVAL- BUTT JOINT".
- 2. THE TEMPORARY RAMP AND SAW CUT SHALL BE INCLUDED IN THE UNIT COST FOR HMA OR PCC SURFACE REMOVAL-BUTT JOINT.

ALL DIMENSIONS ARE IN INCHES (MILLIMETERS) UNLESS OTHERWISE SHOWN.

MODEL: BD12 (Sheet)
FILE NAME: c:\p\work\p\work\garum\0940243\0113424-sh-DistSds.dgn

USER NAME = Nedat.Qarut	DESIGNED - M. DE YONG	REVISED - A. ABBAS 03-21-97
	DRAWN - M. GOMEZ 04-06-01	REVISED - M. GOMEZ 04-06-01
	CHECKED - R. BORO 01-01-07	REVISED - R. BORO 01-01-07
PLOT DATE = 1/7/2025	DATE - 06-13-90	REVISED - K. SMITH 11-18-22

STATE OF ILLINOIS
DEPARTMENT OF TRANSPORTATION

**BUTT JOINT AND
HMA TAPER DETAILS**

SCALE: NONE SHEET 1 OF 1 SHEETS STA. TO STA.

F.A.P RTE.	SECTION	COUNTY	TOTAL SHEETS	SHEET NO.
342	2023-928-RS.SW	COOK	23	17
BD400-05 BD-32		CONTRACT NO. 62W50		
		ILLINOIS FED. AID PROJECT		

MODEL: 8015 (Sheet)
FILE NAME: c:\pw\work\pwid\qarum\0940243D\13424-sht-Dist\Std.s.dgn

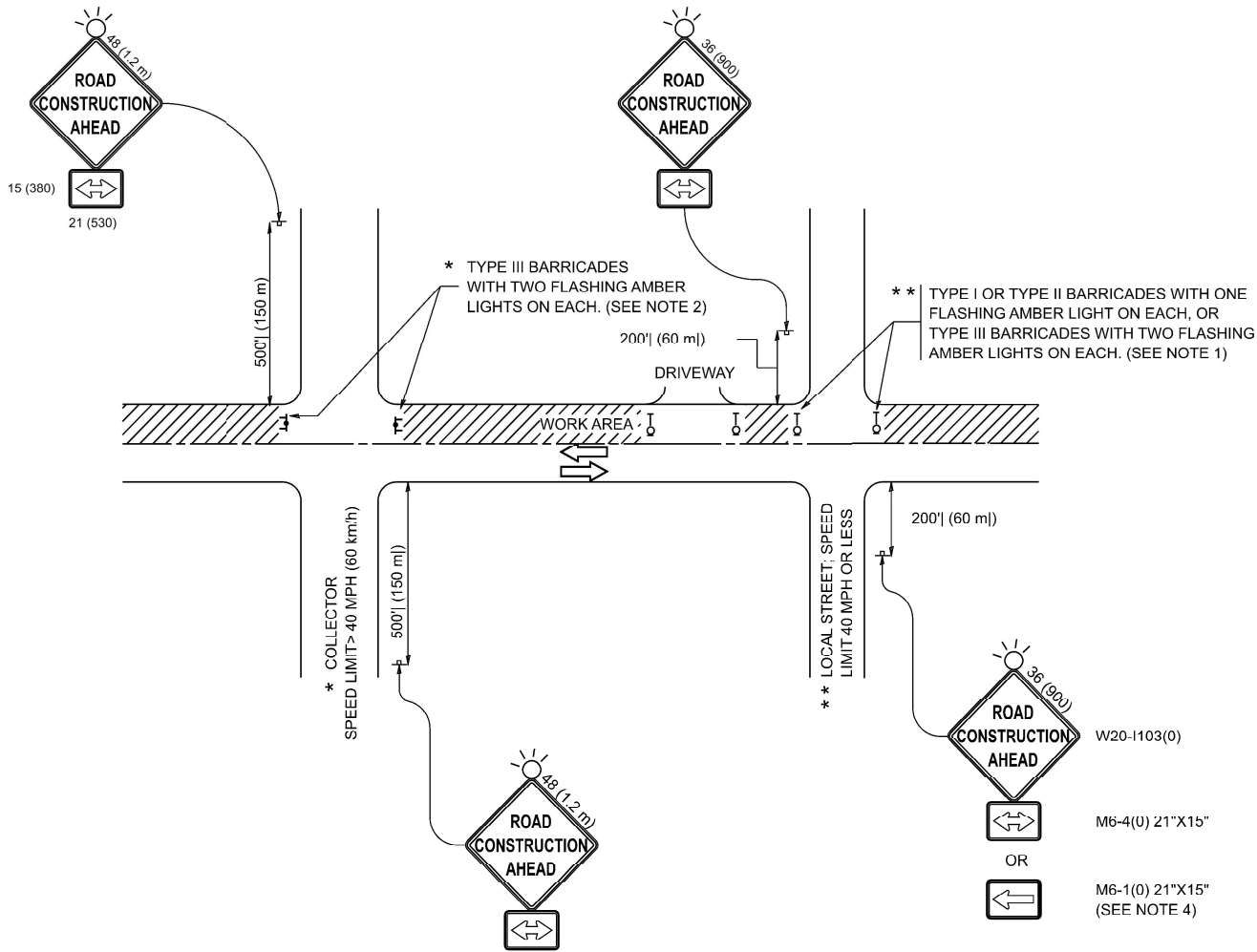

NOTES:

- SIDE ROAD WITH A SPEED LIMIT OF 40 MPH (60 km/h) OR LESS AS SHOWN ON THE DRAWING AND AS DIRECTED BY THE ENGINEER:
 - ONE "ROAD CONSTRUCTION AHEAD" SIGN 36 x 36 (900x900) WITH A FLASHER MOUNTED ON IT APPROXIMATELY 200' (60 m) IN ADVANCE OF THE MAIN ROUTE.
 - THE CLOSED PORTION OF THE MAIN ROUTE SHALL BE PROTECTED BY BLOCKING WITH TYPE I, TYPE II OR TYPE III BARRICADES, 1/3 OF THE CROSS SECTION OF THE CLOSED PORTION.
- SIDE ROAD WITH A SPEED LIMIT GREATER THAN 40 MPH (60 km/h) AS SHOWN ON THE DRAWING AND AS DIRECTED BY THE ENGINEER:
 - ONE "ROAD CONSTRUCTION AHEAD" SIGN 48 x 48 (1.2 m x 1.2 m) WITH A FLASHER MOUNTED ON IT APPROXIMATELY 500' (150 m) IN ADVANCE OF THE MAIN ROUTE.
 - THE CLOSED PORTION OF THE MAIN ROUTE SHALL BE PROTECTED BY BLOCKING WITH TYPE III BARRICADES, 1/2 OF THE CROSS SECTION OF THE CLOSED PORTION.
- CONES MAY BE SUBSTITUTED FOR BARRICADES OR DRUMS AT HALF THE SPACING DURING DAY OPERATIONS. CONES SHALL BE A MINIMUM OF 28 (710) IN HEIGHT.
- WHEN THE SIDE ROAD LIES BETWEEN THE BEGINNING OF THE MAINLINE SIGNING AND THE WORK ZONE, A SINGLE HEADED ARROW (M6-1) SHALL BE USED IN LIEU OF THE DOUBLE HEADED ARROW (M6-4).
- WHEN WORK IS BEING PERFORMED ON A SIDE ROAD OR DRIVEWAY, FOLLOW THE APPLICABLE STANDARD(S). THE DIRECTIONAL ARROW (M6-1 OR M6-4) SHALL BE COVERED OR REMOVED WHEN NO LONGER CONSISTENT WITH THE TRAFFIC CONTROL SET-UP.
- ADVANCE WARNING SIGNS ARE TO BE OMITTED ON DRIVEWAYS UNLESS OTHERWISE SPECIFIED IN THE PLANS OR BY THE ENGINEER.
- THE TRAFFIC CONTROL AND PROTECTION FOR SIDE ROADS, INTERSECTIONS, AND DRIVEWAYS SHALL BE INCLUDED IN THE COST OF SPECIFIED TRAFFIC CONTROL STANDARDS OR ITEMS.

All dimensions are in inches (millimeters)
unless otherwise shown.

	USER NAME = Nedal.Qarut	DESIGNED - L.H.A.	REVISED - T. RAMMACHER 01-06-00	STATE OF ILLINOIS DEPARTMENT OF TRANSPORTATION	TRAFFIC CONTROL AND PROTECTION FOR SIDE ROADS, INTERSECTIONS, AND DRIVEWAYS	F.A.P RTE.	SECTION	COUNTY	TOTAL SHEETS	SHEET NO.
		DRAWN -	REVISED - A. SCHUETZE 07-01-13			342	2023-928-RS,SW	COOK	23	18
		CHECKED -	REVISED - A. SCHUETZE 09-15-06			TC-10		CONTRACT NO. 62W50		
	PLOT DATE = 1/7/2025	DATE - 06-89	REVISED - D. SENDERAK 05-03-24			SCALE:	SHEET	OF	SHEETS	STA.

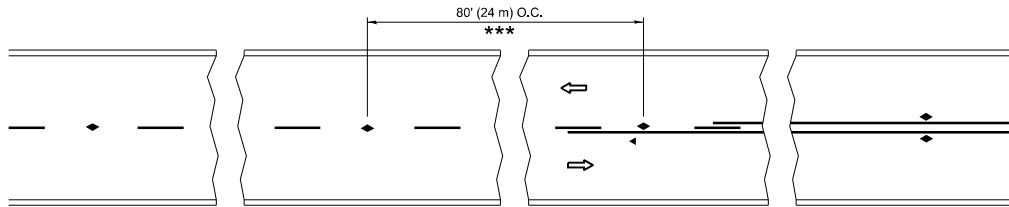

*** REDUCE TO 40' (12 m) O.C. ON CURVES WITH POSTED OR ADVISORY SPEED 45 M.P.H. (70 km/h) OR LESS.

TWO-LANE/TWO-WAY

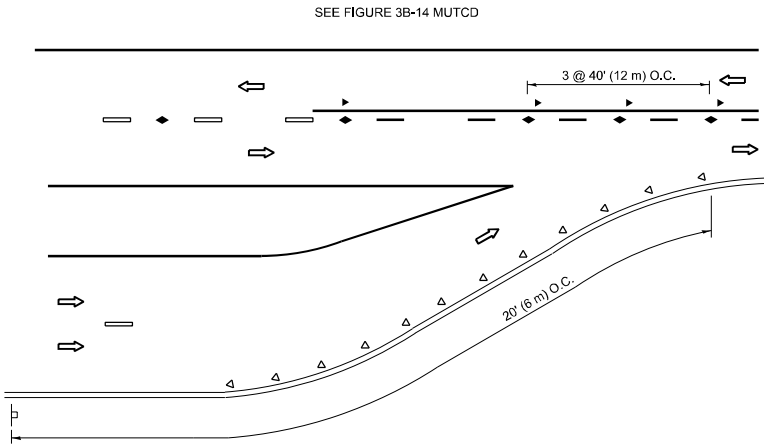

LANE REDUCTION TRANSITION

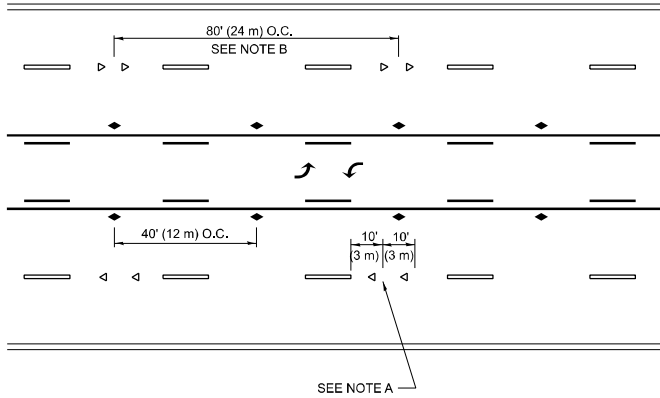

TWO-WAY LEFT TURN

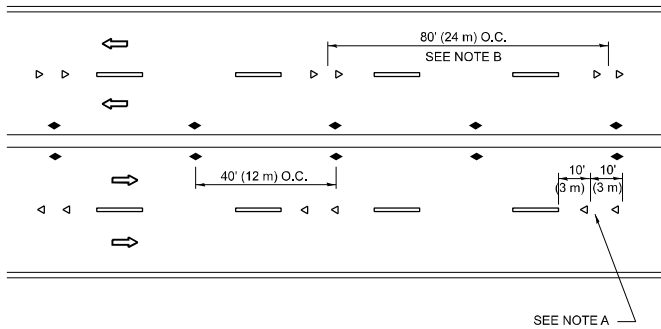

MULTI-LANE/UNDIVIDED

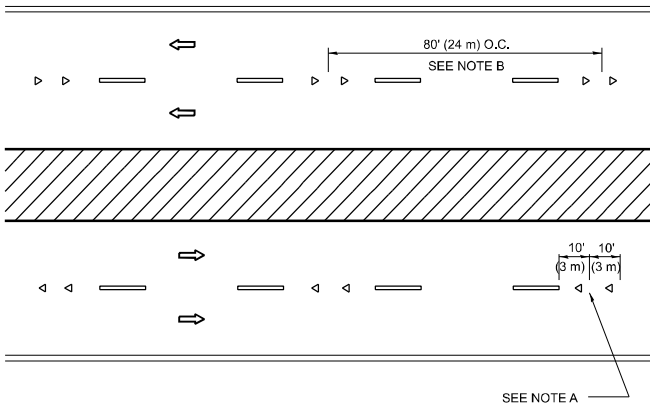

MULTI-LANE/DIVIDED

GENERAL NOTES

- MARKERS USED WITH DASHED LINES SHALL BE CENTERED IN THE GAP BETWEEN SEGMENTS.
- MARKERS USED ADJACENT TO SOLID LINES SHALL BE OFFSET 2 TO 3 (50 TO 75) TOWARD TRAFFIC AS SHOWN.
- MARKERS THROUGH TANGENTS LESS THAN 500' (150 m) IN LENGTH BETWEEN CURVES SHALL BE INSTALLED AT THE LESSER OF THE TWO CURVE SPACINGS.
- MARKERS ARE TO BE USED ADJACENT TO BOTH SOLID WHITE LINES IN DUAL LEFT TURN LANES

SYMBOLS

- YELLOW STRIPE
- WHITE STRIPE
- ONE-WAY AMBER MARKER
- ONE-WAY CRYSTAL MARKER (W/O)
- TWO-WAY AMBER MARKER

LANE MARKER NOTES

- A. USE DOUBLE LANE LINE MARKERS SPACED AS SHOWN.
- B. REDUCE TO 40' (12 m) O.C. ON CURVES WHERE ADVISORY SPEEDS ARE 10 M.P.H (20 km/h) LOWER THAN POSTED SPEEDS.

DESIGN NOTES

- DOUBLE LANE LINE MARKERS SHALL BE USED UNLESS SPECIFIED OTHERWISE.
- EXCEPT AS SHOWN ON THE LANE REDUCTION TRANSITION AND FREEWAY EXIT RAMP DETAIL, MARKERS ARE NOT TO BE SPECIFIED ON RIGHT EDGE LINES.
- THE EXACT MARKER LIMITS, SPACING, AND COLOR SHALL BE INCLUDED IN THE PLANS WHEN STANDARD SPECIFICATIONS ARE NOT BEING USED.
- MARKERS SHOULD NOT BE USED ALONGSIDE CURBS EXCEPT FOR EXTREMELY SHORT SECTIONS OF CURBS WHERE NOT MORE THAN TWO MARKERS WOULD BE INVOLVED.

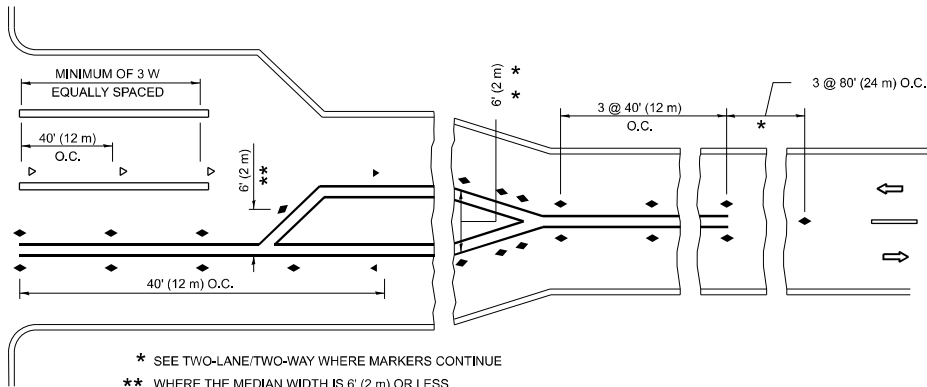
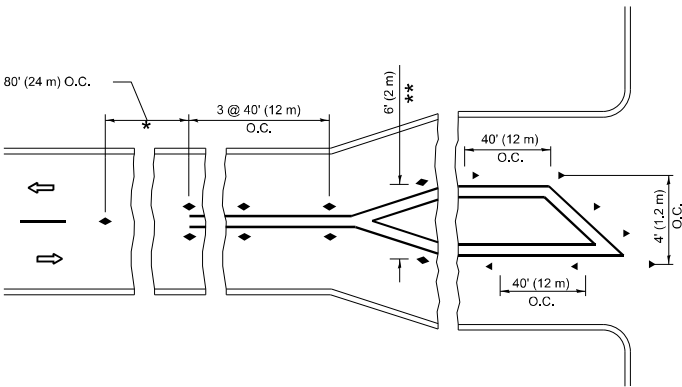

TURN LANES

All dimensions are in inches (millimeters) unless otherwise shown.

MODEL: BD16 (Sheet)
FILE NAME: c:\p\work\pwork\garum\ud940243\D113424-sh-DistSds.dgn

USER NAME = Nedat.Qarut	DESIGNED -	REVISED - T. RAMMACHER 03-12-99
	DRAWN -	REVISED - T. RAMMACHER 01-06-00
	CHECKED -	REVISED - C. JUCIUS 09-09-09
PLOT DATE = 1/7/2025	DATE -	REVISED - C. JUCIUS 07-01-13

STATE OF ILLINOIS
DEPARTMENT OF TRANSPORTATION

TYPICAL APPLICATIONS
RAISED REFLECTIVE PAVEMENT MARKERS (SNOW-PLOW RESISTANT)

SCALE: NONE SHEET 1 OF 1 SHEETS STA. TO STA.

F.A.P RTE.	SECTION	COUNTY	TOTAL SHEETS	SHEET NO.
342	2023-928-RS.SW	COOK	23	19
TC-11		CONTRACT NO. 62W50		
ILLINOIS		FED. AID PROJECT		

MODEL: BD17 (Sheet)
FILE NAME: c:\p\work\pav\pavmark.dgn

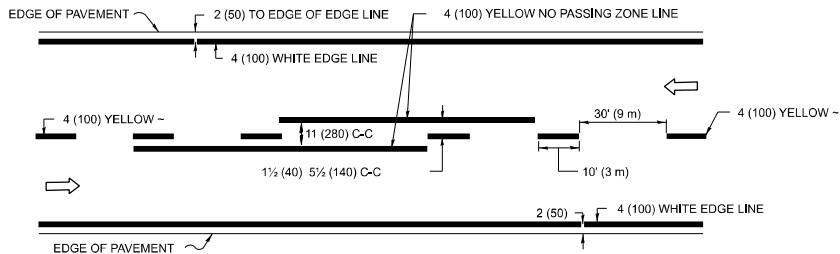

2-LANE ROADWAY

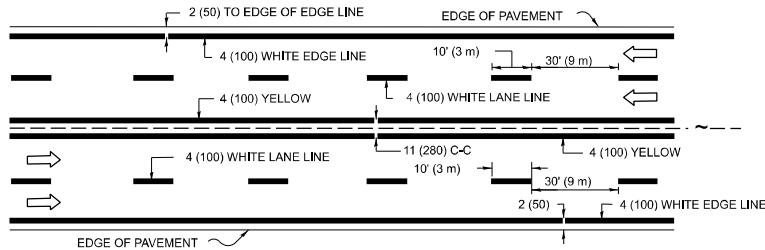

MULTI-LANE UNDIVIDED

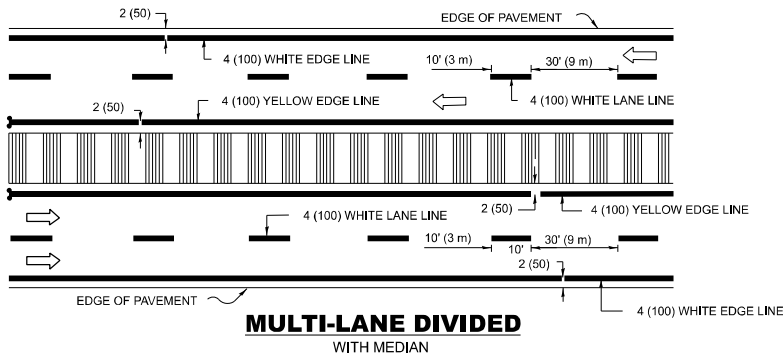

MULTI-LANE DIVIDED WITH MEDIAN

TYPICAL LANE AND EDGE LINE MARKING

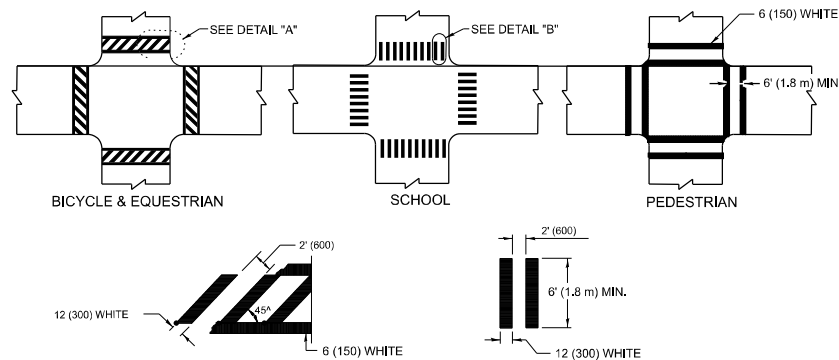

DETAIL "A"

DETAIL "B"

TYPICAL CROSSWALK MARKING

* MARKINGS SHALL BE INSTALLED PARALLEL TO THE CENTERLINE OF THE ROAD WHICH IT CROSSES

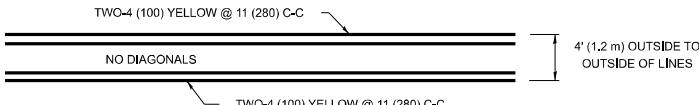

4' (1.2 m) WIDE MEDIANS ONLY

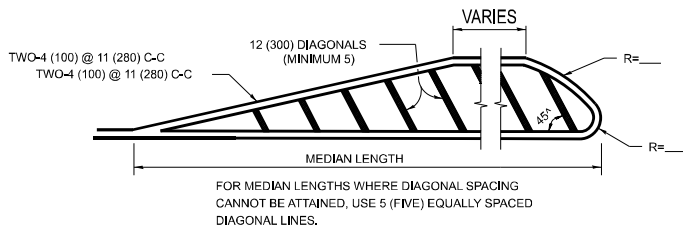

DIAGONAL LINE SPACING: 50' (15 m) C-C (LESS THAN 30MPH (50 km/h))
75' (25 m) C-C 30MPH (50 km/h) TO 45MPH (70 km/h)
150' (45 m) C-C (MORE THAN 45MPH (70 km/h))

MEDIANS OVER 4' (1.2 m) WIDE

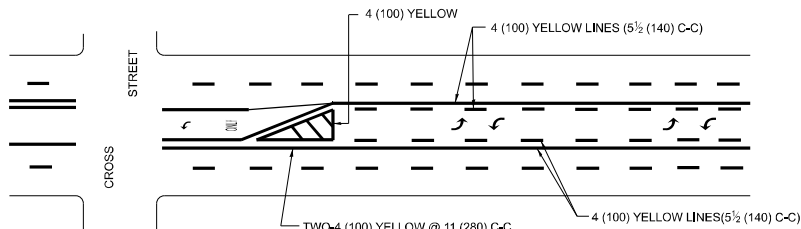

A MINIMUM OF TWO PAIRS OF TURN ARROWS SHALL BE USED, WHITE IN COLOR. ADDITIONAL PAIRS SHALL BE PLACED AT 200' (60 m) TO 300' (90 m) INTERVALS.

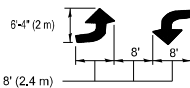

MEDIAN WITH TWO-WAY LEFT TURN LANE

TYPICAL PAINTED MEDIAN MARKING

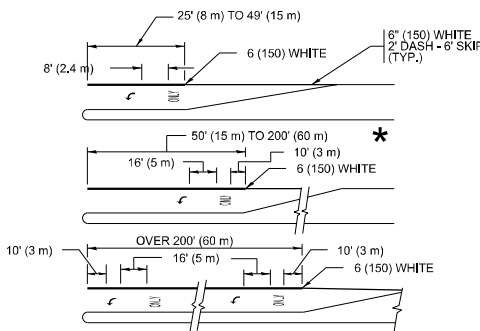

FULL SIZE LETTERS 8' (2.4 m) AND ARROWS SHALL BE USED.
AREA = 15.6 SQ. FT. (1.5 m²) ONLY AREA = 20.8 SQ. FT. (1.9 m²)

* TURN LANES IN EXCESS OF 400' (120 m) IN LENGTH MAY HAVE AN ADDITIONAL SET OF ARROW - "ONLY" INSTALLED MIDWAY BETWEEN THE OTHER TWO SETS OF ARROW - "ONLY".

TYPICAL LEFT (OR RIGHT) TURN LANE

TYPICAL TURN LANE MARKING

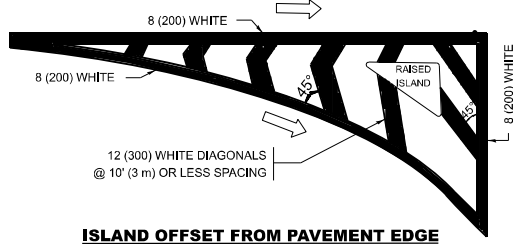

ISLAND OFFSET FROM PAVEMENT EDGE

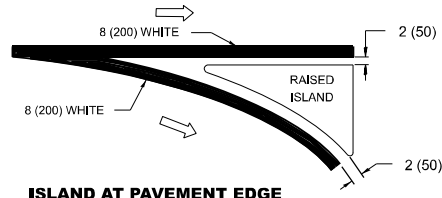

ISLAND AT PAVEMENT EDGE

TYPICAL ISLAND MARKING

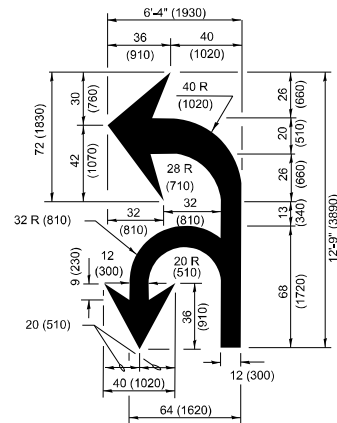

COMBINATION LEFT AND U-TURN

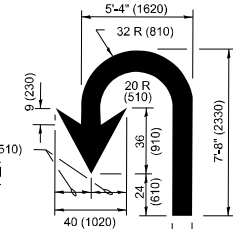

U-TURN

LANE REDUCTION TRANSITION

* LANE REDUCTION ARROWS REQUIRED AT SPEEDS OF 45 MPH OR GREATER OR WHEN SPECIFIED IN PLANS.

TYPE OF MARKING	WIDTH OF LINE	PATTERN	COLOR	SPACING / REMARKS
CENTERLINE ON 2 LANE PAVEMENT	4 (100)	SKIP-DASH	YELLOW	10' (3 m) LINE WITH 30' (9 m) SPACE
CENTERLINE ON MULTI-LANE UNDIVIDED PAVEMENT	2 @ 4 (100)	SOLID	YELLOW	11 (280) C-C
NO PASSING ZONE LINES: FOR ONE DIRECTION FOR BOTH DIRECTIONS	4 (100) 2 @ 4 (100)	SOLID SOLID	YELLOW YELLOW	5 1/2 (140) C-C FROM SKIP-DASH CENTERLINE 11 (280) C-C OMIT SKIP-DASH CENTERLINE BETWEEN
LANE LINES	4 (100) 5 (125) ON FREEWAYS	SKIP-DASH SKIP-DASH	WHITE WHITE	10' (3 m) LINE WITH 30' (9 m) SPACE
DOTTED LINES (EXTENSIONS OF CENTER, LANE OR TURN LANE MARKINGS)	SAME AS LINE BEING EXTENDED	SKIP-DASH	SAME AS LINE BEING EXTENDED	2' (600) LINE WITH 6' (1.8 m) SPACE
EDGE LINES	4 (100)	SOLID	YELLOW-LEFT WHITE-RIGHT	OUTLINE MEDIANS IN YELLOW
TURN LANE MARKINGS	6 (150) LINE: FULL SIZE LETTERS & SYMBOLS (8' (2.4m))	SOLID	WHITE	SEE TYPICAL TURN LANE MARKING DETAIL
TWO WAY LEFT TURN MARKING	2 @ 4 (100) EACH DIRECTION 8' (2.4m) LEFT ARROW	SKIP-DASH AND SOLID IN PAIRS	YELLOW WHITE	10' (3 m) LINE WITH 30' (9 m) SPACE FOR SKIP-DASH: 5 1/2 (140) C-C BETWEEN SOLID LINE AND SKIP-DASH LINE SEE TYPICAL TWO-WAY LEFT TURN MARKING DETAIL
CROSSWALK LINES (PEDESTRIAN) A. DIAGONALS (BIKE & EQUESTRIAN) B. LONGITUDINAL BARS (SCHOOL)	2 @ 6 (150) 12 (300) @ 45° 12 (300) @ 90°	SOLID SOLID SOLID	WHITE WHITE WHITE	NOT LESS THAN 6' (1.8 m) APART 2' (600) APART 2' (600) APART SEE TYPICAL CROSSWALK MARKING DETAILS.
STOP LINES	24 (600)	SOLID	WHITE	PLACE 4' (1.2 m) IN ADVANCE OF AND PARALLEL TO CROSSWALK, IF PRESENT. OTHERWISE, PLACE AT DESIRED STOPPING POINT, PARALLEL TO CROSSROAD CENTERLINE, WHERE POSSIBLE
PAINTED MEDIANS	2 @ 4 (100) WITH 12 (300) DIAGONALS @ 45° NO DIAGONALS USED FOR 4' (1.2 m) WIDE MEDIANS	SOLID	YELLOW: TWO WAY TRAFFIC WHITE: ONE WAY TRAFFIC	11 (280) C-C FOR THE DOUBLE LINE SEE TYPICAL PAINTED MEDIAN MARKING.
GORE MARKING AND CHANNELIZING LINES	8 (200) WITH 12 (300) DIAGONALS @ 45°	SOLID	WHITE	DIAGONALS: 15' (4.5 m) C-C (LESS THAN 30MPH (50 km/h)) 20' (6 m) C-C 30MPH (50 km/h) TO 45MPH (70 km/h) 30' (9 m) C-C (OVER 45MPH (70 km/h))
RAILROAD CROSSING	24 (600) TRANSVERSE LINES: "RR" IS 8' (1.8 m) LETTERS: 16 (400) LINE FOR "X"	SOLID	WHITE	SEE STATE STANDARD 780001 AREA OF: "R"=3.6 SQ. FT. (0.33 m ²) EACH "X"=54.0 SQ. FT. (5.0 m ²)
SHOULDER DIAGONALS (REQUIRED FOR SHOULDERS ≥ 8')	12 (300) @ 45°	SOLID	WHITE - RIGHT YELLOW - LEFT	50' (15 m) C-C (LESS THAN 30MPH (50 km/h)) 75' (25 m) C-C (30 MPH (50 km/h) TO 45MPH (70 km/h)) 150' (45 m) C-C (OVER 45MPH (70 km/h))
U TURN ARROW	SEE DETAIL	SOLID	WHITE	16.3 SF
2 ARROW COMBINATION LEFT AND U TURN	SEE DETAIL	SOLID	WHITE	30.4 SF

FOR FURTHER DETAILS ON PAVEMENT MARKING REFER TO
STANDARD SPECIFICATIONS FOR ROAD AND BRIDGE
CONSTRUCTION AND STATE STANDARD 780001.

All dimensions are in inches (millimeters)
unless otherwise shown.

USER NAME = Nedat.Qarut	DESIGNED - EVERS	REVISED - C. JUCIUS 09-09-09
	DRAWN -	REVISED - C. JUCIUS 07-01-13
	CHECKED -	REVISED - C. JUCIUS 12-21-15
PLOT DATE = 1/7/2025	DATE - 03-19-90	REVISED - C. JUCIUS 04-12-16

STATE OF ILLINOIS DEPARTMENT OF TRANSPORTATION

DISTRICT ONE TYPICAL PAVEMENT MARKINGS

SCALE: NONE SHEET 1 OF 1 SHEETS STA. TO STA.

F.A.P RTE.	SECTION	COUNTY	TOTAL SHEETS	SHEET NO.
342	2023-928-RS,SW	COOK	23	20
TC-13		CONTRACT NO. 62W50		
ILLINOIS		FED. AID PROJECT		

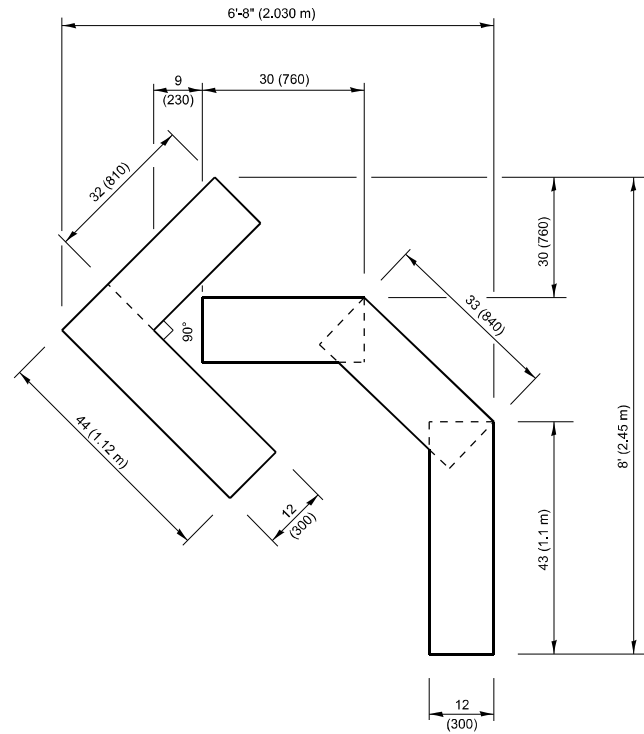

QUANTITY

4 (100) LINE = 45.5 ft. (13.9 m)
15.2 sq. ft. (1.41 sq. m)

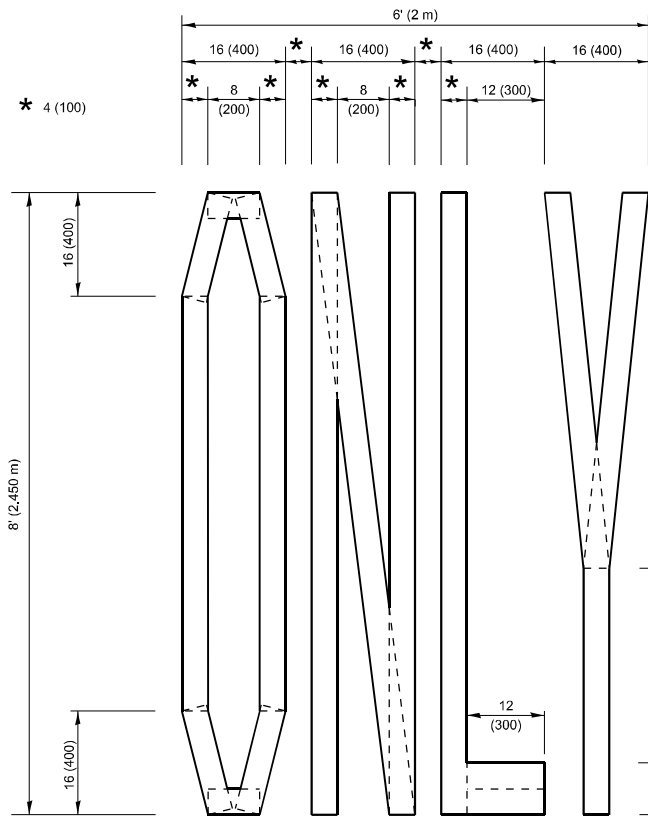

QUANTITY

4 (100) LINE = 64.1 ft. (19.5 m)
21.4 sq. ft. (1.99 sq. m)

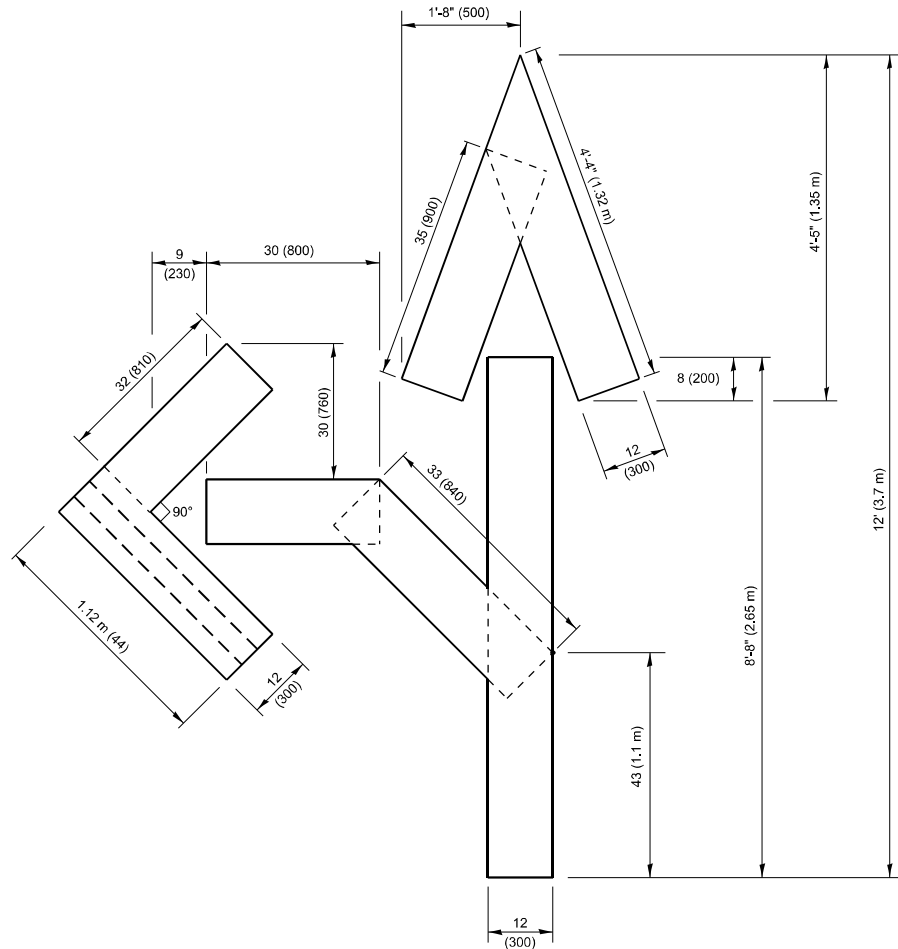

QUANTITY

4 (100) LINE = 82.5 ft. (25.1 m)
27.5 sq. ft. (2.53 sq. m)

NOTE:

ALL QUANTITIES OF PLACEMENT ARE REPRESENTED
IN LINEAR FEET OF 4" LINES TO MATCH THE
4" TEMPORARY TAPE PAY ITEM AND REPRESENTS
THE TOTAL QUANTITY OF 4" TAPE REQUIRED.

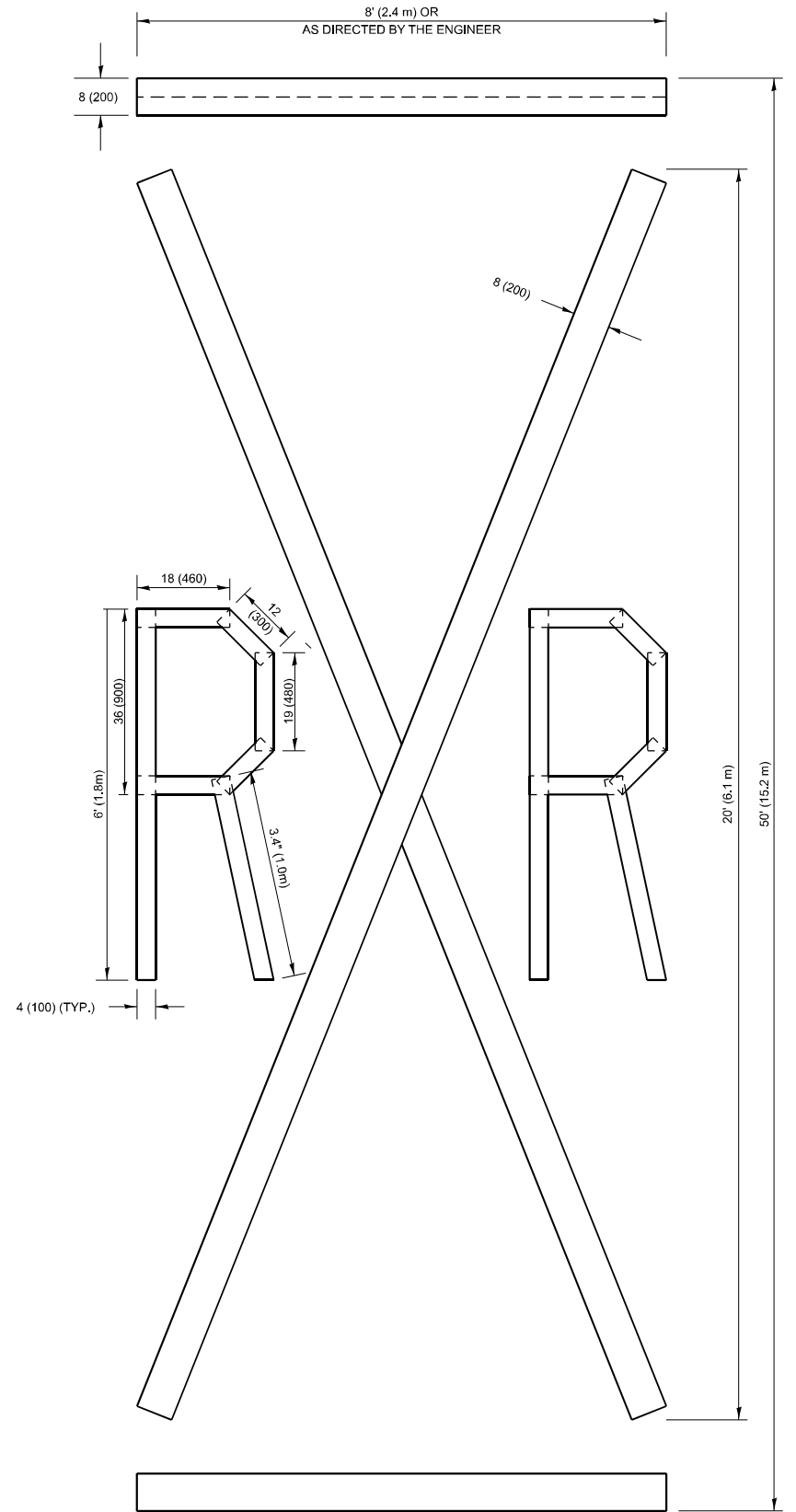

QUANTITY

4 (100) LINE = 225.9 ft. (68.9 m)
75.3 sq. ft. (6.99 sq. m)

All dimensions are in inches (millimeters)
unless otherwise shown.

MODEL: BD18 (Sheet)
FILE NAME: c:\p\work\pwork\garum\0940243D113424-sh-DistSds.dgn

PLOT DATE = 1/7/2025	USER NAME = Nedat.Qarut	DESIGNED -	REVISED - T. RAMMACHER 03-02-98
		DRAWN -	REVISED - E. GOMEZ 08-28-00
		CHECKED -	REVISED - E. GOMEZ 08-28-00
	DATE - 09-18-94		REVISED - A. SCHUETZE 09-15-16

STATE OF ILLINOIS
DEPARTMENT OF TRANSPORTATION

SHORT TERM PAVEMENT MARKING LETTERS AND SYMBOLS

SCALE: NONE SHEET 1 OF 1 SHEETS STA. TO STA.

F.A.P RTE.	SECTION	COUNTY	TOTAL SHEETS	SHEET NO.
342	2023-028-RS.SW	COOK	23	21
TC-16		CONTRACT NO. 62W50		
		ILLINOIS	FED. AID PROJECT	

MODEL: RD19 (Sheet)
FILE NAME: c:\p\work\pwork\garum\0940243\0113424-sh-DistSds.dgn

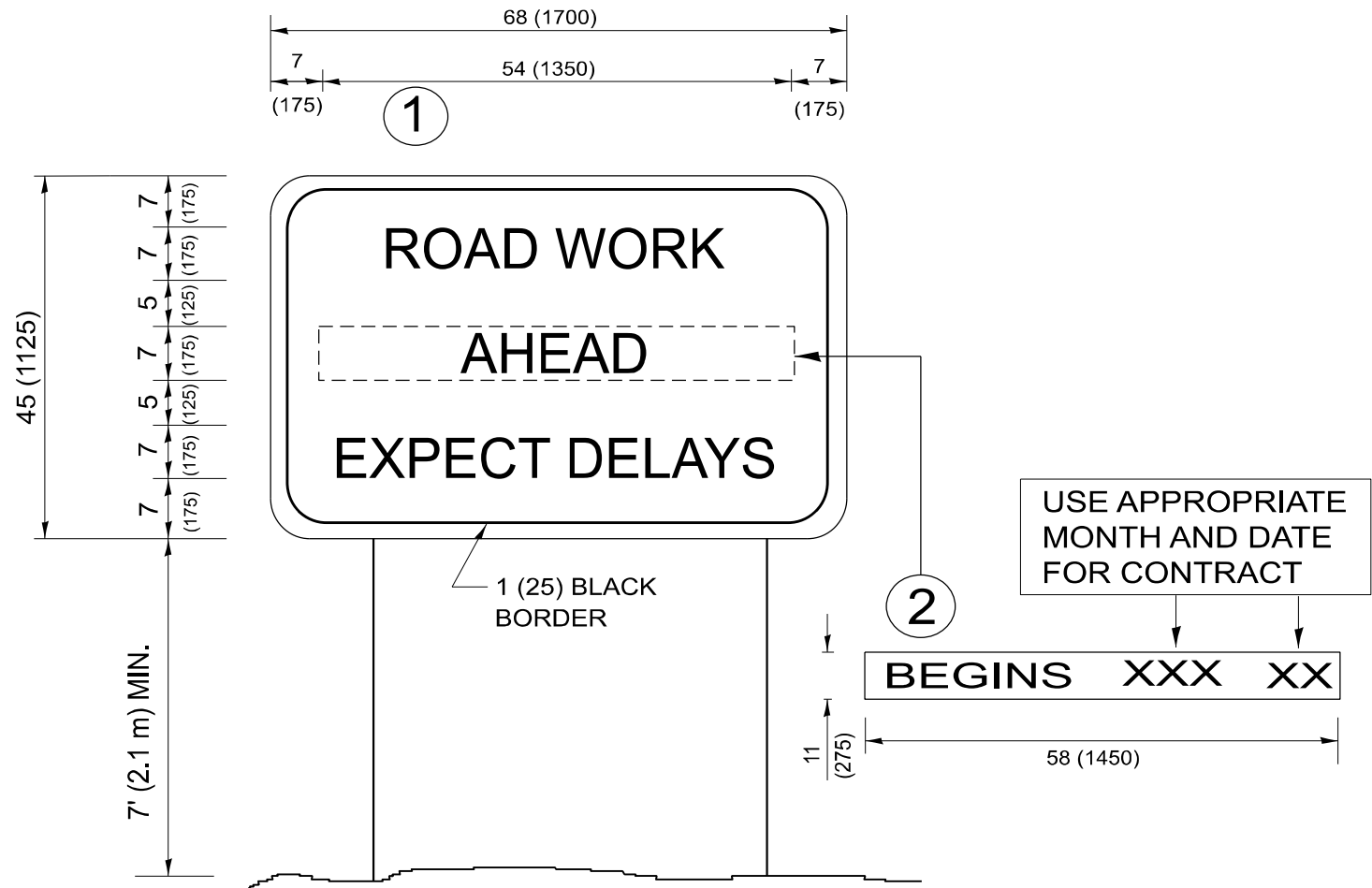

NOTES:

1. USE BLACK LETTERING ON ORANGE BACKGROUND.
2. ERECT SIGNS IN ADVANCE OF THE LOCATION FOR THE "ROAD CONSTRUCTION AHEAD" SIGN AT LOCATIONS AS DIRECTED BY THE ENGINEER.
3. ERECT SIGN ① WITH INSTALLED PANEL ② ONE WEEK PRIOR TO THE START OF CONSTRUCTION.
4. REMOVE PANEL ② SOON AFTER THE START OF CONSTRUCTION.
5. SEE SPECIAL PROVISION FOR "TEMPORARY INFORMATION SIGNING" FOR ADDITIONAL INFORMATION.
6. ONE SIGN ASSEMBLY EQUALS 25.70 SQ. FT. (2.3 SQ. M.)
7. SHALL BE PAID FOR AS TEMPORARY INFORMATION SIGNING.

ALL DIMENSIONS ARE IN INCHES (MILLIMETERS)
UNLESS OTHERWISE SHOWN.

	USER NAME = Nedat.Qarut	DESIGNED -	REVISED - R. MIRS 09-15-97	STATE OF ILLINOIS DEPARTMENT OF TRANSPORTATION	ARTERIAL ROAD INFORMATION SIGN				F.A.P RTE.	SECTION	COUNTY	TOTAL SHEETS	SHEET NO.			
		DRAWN -	REVISED - R. MIRS 12-11-97						342	2023-928-RS,SW	COOK	23	22			
		CHECKED -	REVISED - T. RAMMACHER 02-02-99						TC-22					CONTRACT NO. 62W50		
	PLOT DATE = 1/7/2025	DATE -	REVISED - C. JUCIUS 01-31-07						ILLINOIS FED. AID PROJECT							
						SCALE: NONE	SHEET 1	OF 1 SHEETS	STA.	TO STA.						

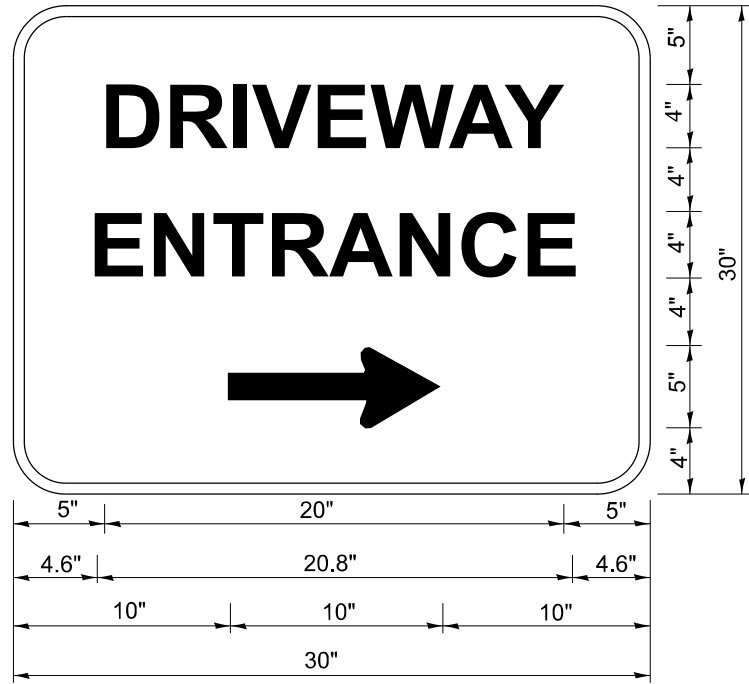

3.0" RADIUS, 0.5" BORDER, WHITE ON GREEN; REFLECTORIZED
"DRIVEWAY" D; "ENTRANCE" D; STANDARD ARROW CUSTOM 12.0" x 5.0"

- NOTES:**
1. HALF OF THE SIGNS WILL REQUIRE A LEFT HAND FACING ARROW.
 2. TWO SIGNS SHALL BE USED AT EACH COMMERCIAL ENTRANCE
PLACED BACK-TO-BACK: ONE WITH A RIGHT HAND ARROW (SHOWN)
SHALL BE PLACED ON THE NEAR RIGHT SIDE THE DRIVEWAY
AND ONE WITH A LEFT HAND ARROW SHALL BE PLACED ON THE
FAR LEFT SIDE OF THE DRIVEWAY.
 3. SIGNS TO BE PAID FOR AS ITEM "TEMPORARY INFORMATION SIGNING".

MODEL: RD 20 [Sheet]
FILE NAME: c:\p\work\p\work\garum\0940243\013424-sh-Dist\Std.dgn

	USER NAME = Nedat.Qarut	DESIGNED -	REVISED - C. JUCIUS 02-15-07	STATE OF ILLINOIS DEPARTMENT OF TRANSPORTATION	DRIVEWAY ENTRANCE SIGNING			F.A.P RTE.	SECTION	COUNTY	TOTAL SHEETS	SHEET NO.
		DRAWN -	REVISED -					342	2023-028-RS.SW	COOK	23	23
		CHECKED -	REVISED -		TC-26			CONTRACT NO. 62W50				
	PLOT DATE = 1/7/2025	DATE -	REVISED -		SCALE: NONE	SHEET 1	OF 1	SHEETS	STA.	TO STA.	ILLINOIS FED. AID PROJECT	