

**PTZ CAMERA INSTALLATION &
FIBER OPTIC CONNECTION**

**UNIVERSITY AVE.
&
CUNNINGHAM AVE.**

(NOT TO SCALE)

CAMERA & CONDUIT /CABLE LAYOUT

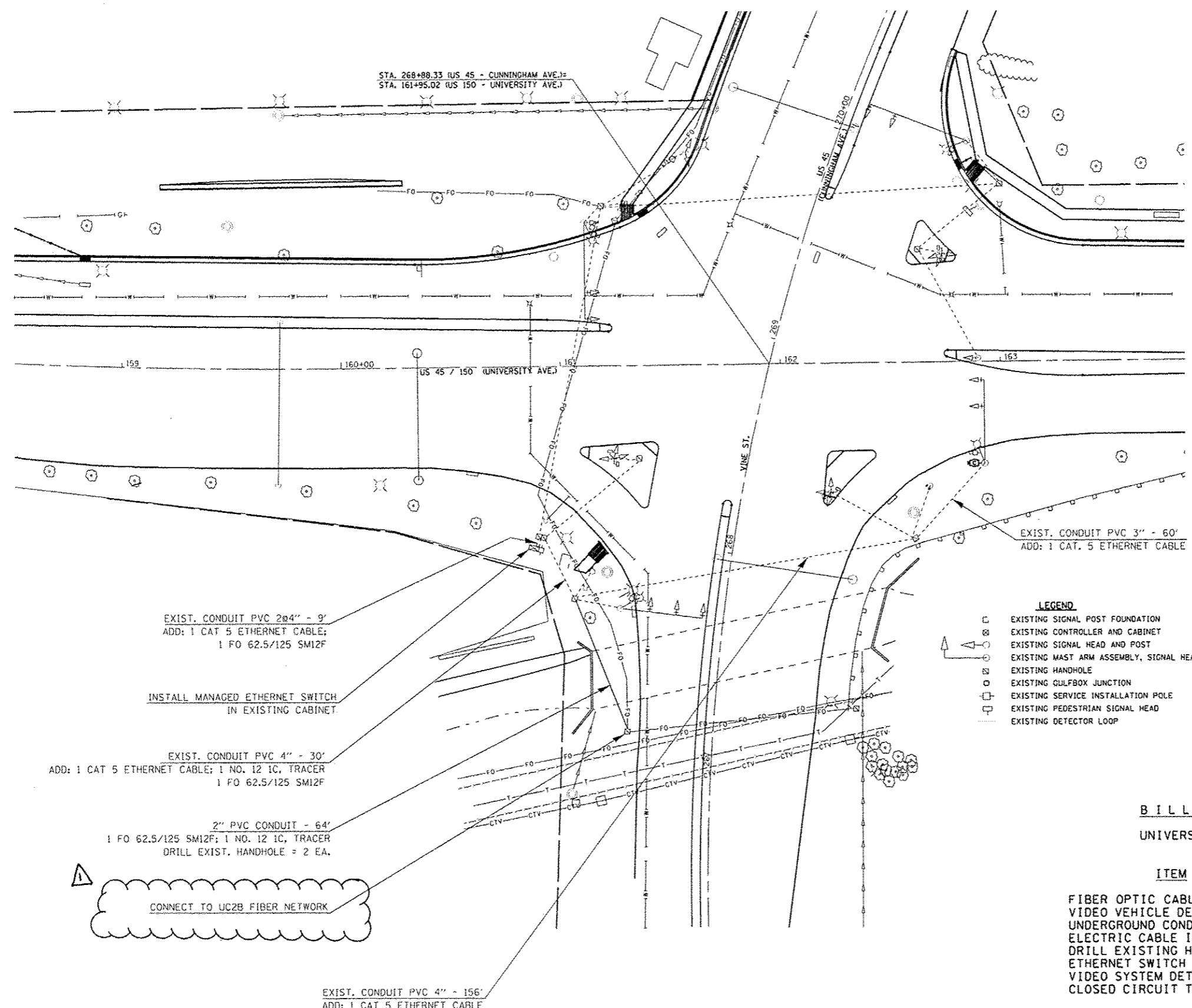

- LEGEND**
- ⊠ EXISTING SIGNAL POST FOUNDATION
 - ⊞ EXISTING CONTROLLER AND CABINET
 - ⊡ EXISTING SIGNAL HEAD AND POST
 - ⊣ EXISTING MAST ARM ASSEMBLY, SIGNAL HEAD
 - ⊢ EXISTING HANDHOLE
 - ⊤ EXISTING GULFBOX JUNCTION
 - ⊥ EXISTING SERVICE INSTALLATION POLE
 - ⊦ EXISTING PEDESTRIAN SIGNAL HEAD
 - ⊧ EXISTING DETECTOR LOOP

BILL OF MATERIALS

UNIVERSITY AVE. & CUNNINGHMA AVE.

ITEM	UNIT	QUANTITY
FIBER OPTIC CABLE 12 FIBERS, SINGLE MODE	FOOT	135
VIDEO VEHICLE DETECTION, 4 CAMERAS	EACH	1
UNDERGROUND CONDUIT, PVC, 2" DIA.	FOOT	64
ELECTRIC CABLE IN CONDUIT, TRACER, NO. 12 1C	FOOT	94
DRILL EXISTING HANDHOLE	EACH	2
ETHERNET SWITCH	EACH	1
VIDEO SYSTEM DETECTION PROCESSOR	EACH	1
CLOSED CIRCUIT TELEVISION CAMERA	EACH	1

EXIST. CONDUIT PVC 2 1/4" - 9'
ADD: 1 CAT 5 ETHERNET CABLE;
1 FO 62.5/125 SM12F

INSTALL MANAGED ETHERNET SWITCH
IN EXISTING CABINET.

EXIST. CONDUIT PVC 4" - 30'
ADD: 1 CAT 5 ETHERNET CABLE; 1 NO. 12 1C, TRACER
1 FO 62.5/125 SM12F

2" PVC CONDUIT - 64'
1 FO 62.5/125 SM12F; 1 NO. 12 1C, TRACER
DRILL EXIST. HANDHOLE = 2 EA.

CONNECT TO UC2B FIBER NETWORK

EXIST. CONDUIT PVC 4" - 156'
ADD: 1 CAT 5 ETHERNET CABLE

FO EXIST. UC2B FIBER OPTIC
CABLE IN CONDUIT

FILE NAME =	USER NAME = biggsrd	DESIGNED -	REVISED -
citywork\p\eidot\biggsrd\0348453\PTZ	camera plans.dgn	DRAWN -	REVISED -
	PLOT SCALE = 3/32"=1' / 1" = 100'	CHECKED -	REVISED -
MODELNAME	PLOT DATE = 4/5/2014	DATE -	REVISED -

**STATE OF ILLINOIS
DEPARTMENT OF TRANSPORTATION**

SCALE:	SHEET	OF	SHEETS	STA.	TO STA.
--------	-------	----	--------	------	---------

F.A.P. RTE.	SECTION	COUNTY	TOTAL SHEETS	SHEET NO.
VAR.	FY2014 ITS-1	CHAMPAIGN	74	68
			CONTRACT NO. 70A26	
ILLINOIS FED. AID PROJECT				

REV. 4-10-14