

STATE OF ILLINOIS
DEPARTMENT OF TRANSPORTATION

EAST CURB LINE

Location	Station	Offset	Theoretical Grade Elevations
End at S Abut	572+76.52	57.58	624.28
A	572+86.52	57.58	624.23
B	572+96.52	57.58	624.17
End of South appr pavement	573+06.52	57.58	624.10

EAST MEDIAN CURB LINE

Location	Station	Offset	Theoretical Grade Elevations
End at S Abut	572+45.91	1.50	624.80
A	572+55.91	1.50	624.75
B	572+65.91	1.50	624.70
End of South appr pavement	572+75.91	1.50	624.64

PG EASTBOUND LANES

Location	Station	Offset	Theoretical Grade Elevations
End at S Abut	572+33.63	-21.00	625.26
A	572+43.63	-21.00	625.21
B	572+53.63	-21.00	625.17
End of South appr pavement	572+63.63	-21.00	625.12

PG WESTBOUND LANES

Location	Station	Offset	Theoretical Grade Elevations
End at S Abut	572+56.55	21.00	625.15
A	572+66.55	21.00	625.10
B	572+76.55	21.00	625.05
End of South appr pavement	572+86.55	21.00	624.99

WEST MEDIAN CURB LINE

Location	Station	Offset	Theoretical Grade Elevations
End at S Abut	572+44.27	-1.50	624.81
A	572+54.27	-1.50	624.76
B	572+64.27	-1.50	624.71
End of South appr pavement	572+74.27	-1.50	624.65

WEST CURB LINE

Location	Station	Offset	Theoretical Grade Elevations
End at S Abut	572+13.66	-57.58	624.58
A	572+23.66	-57.58	624.54
B	572+33.66	-57.58	624.50
End of South appr pavement	572+43.66	-57.58	624.45

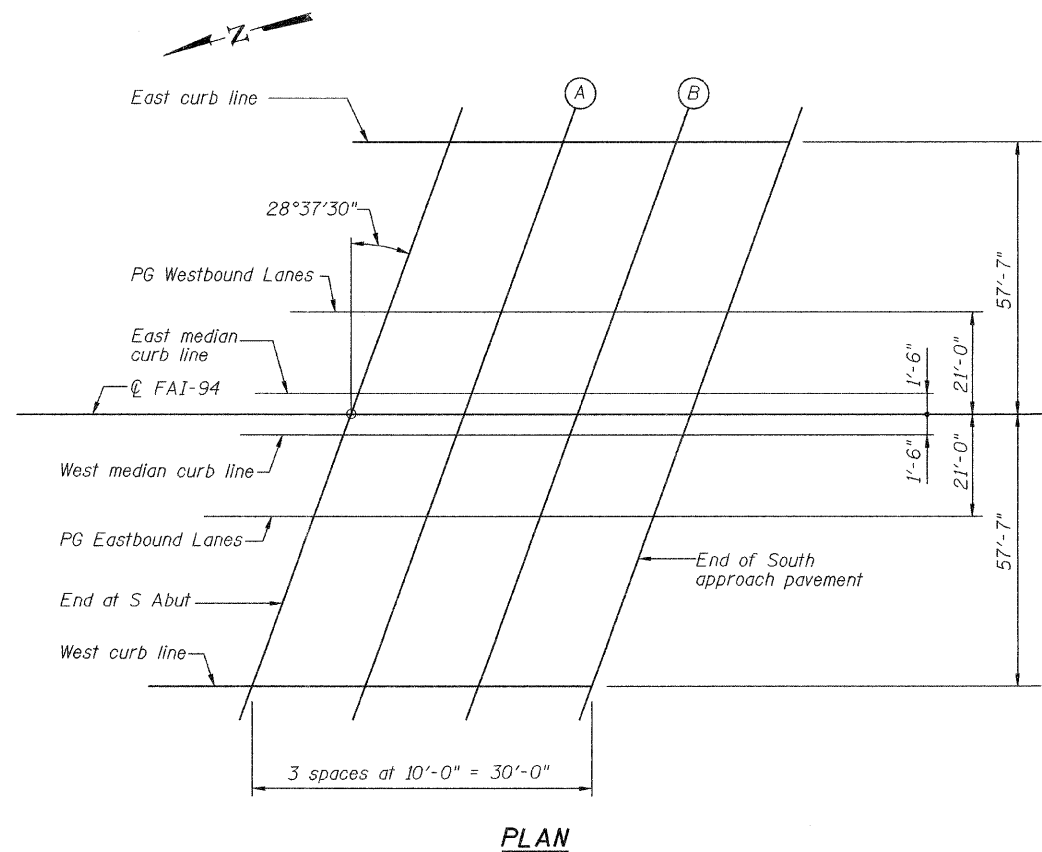

**TOP OF SOUTH APPROACH
SLAB ELEVATIONS
BISHOP FORD EXPRESSWAY (I-94)
GREENWOOD AVENUE
COOK COUNTY
STATION
STRUCTURE NUMBER 016-0162**

DESIGNED -	
CHECKED -	
DRAWN -	R KING
CHECKED -	
E-AS	

5-16-08

**HOMER L.
CHASTAIN
& ASSOCIATES, LLP**
CONSULTING ENGINEERS
DECATUR (217) 422-8544
CHICAGO (773) 714-0050
ROCKFORD (815) 489-0050
184-001397

SHEET NO. 15	F.A.I. RTE.	SECTION	COUNTY	TOTAL SHEETS	SHEET NO.
OF 17 SHEETS	94	(0405,ETC,42-7&0707)RS-11	COOK	133	84
BISHOP FORD EXPRESSWAY (I-94)			CONTRACT NO. 60D21		
FED. ROAD DIST. NO. - [ILLINOIS] FED. AID PROJECT					