

CONTRACT 62829	F.A.P. RTE.	SECTION	COUNTY	TOTAL SHEETS	SHEET NO.
	305	2004-088B	COOK	145	50
	STA.	TO STA.			

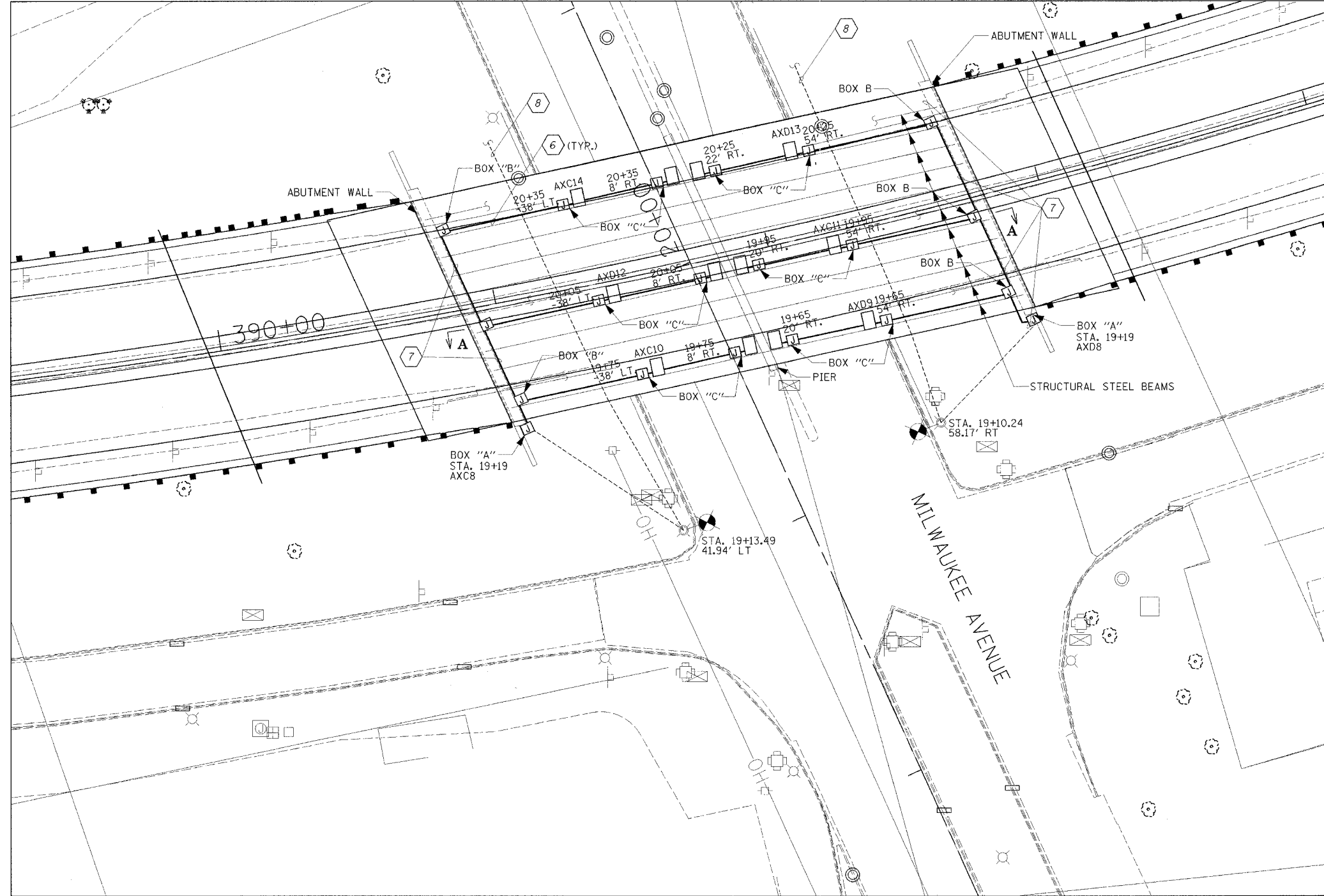

- NOTES:
- SEE DWG. NO. LTG-1 FOR ELECTRICAL DRAWING INDEX AND GENERAL NOTES.
  - SEE DWG. LTG-2 FOR ELECTRICAL LEGEND AND ABBREVIATIONS.
  - ALL CABLE RUN FOR THE ROADWAY LIGHTING SHALL BE UNIT DUCT 3-1/2" X 4-1/2" X 6" GND IN 1/4" DIA. POLYETHYLENE UNIT DUCT WITH IN TRENCH.
  - SEE DWG. NO. LTG-8 FOR UNDERPASS LIGHT MOUNTING DETAIL.
  - SEE DWG. NO. LTG-5 FOR WIRING DIAGRAM.
  - WIRE FOR UNDERPASS LUMINAIRES SHALL BE 3-1/2" X 10, 1/2" X 12 GND. IN 1" PVC COATED RIGID GALVANIZED STEEL CONDUIT.
  - 2" DIA. PVC COATED RGS CONDUIT ATTACHED TO STRUCTURE W/3-1/2" X 4, 1/2" X 6 GND.
  - RE-CONNECT TO EXISTING ROADWAY LIGHTING.
  - NOT USED
  - SEE SHEET LTC-8 FOR MILWAUKEE AVENUE UNDERPASS LIGHT MOUNTING DETAIL ENLARGMENT.
  - SEE SHEET LTC-8 FOR ENLARGEMENT OF SECTION VIEW A-A.

LTG-6

<b>Edwards AND Kelcey</b>	
REVISIONS	
NAME	DATE

ILLINOIS DEPARTMENT OF TRANSPORTATION  
 MILWAUKEE AVE. & WILLOW RD.  
 UNDERPASS  
 WILLOW ROAD  
 OVER US 45/IL 21 (MILWAUKEE AVE)  
 AND OVER DES PLAINES RIVER  
 SCALE 1"=20'  
 DATE JANUARY 2005  
 DRAWN BY CADD SC  
 CHECKED BY CDS

12/28/2004 01:02:21 PM