

F.A.I. RTE.	SECTION	COUNTY	TOTAL SHEETS	SHEET NO.
90/94	2003-0311	COOK	976	663
STA. 1458+50.00		TO STA. 1471+00.00		
FED. ROAD DIST. NO. 1		ILLINOIS		FED. AID PROJECT

62583

NOTES:

- SEE DRAWINGS ME-01 AND ME-02 FOR ELECTRICAL SYMBOLS AND ABBREVIATIONS.
- NOTED CONDUITS AND HANDHOLES ARE FURNISHED AND INSTALLED BY OTHERS UNDER A SEPARATE CONTRACT. ALL CABLES ARE TO BE FURNISHED AND INSTALLED UNDER THIS CONTRACT.
- NEW ELECTRIC SERVICE TO BE INSTALLED ON EXISTING UTILITY POLE. CONDUIT UP THE POLE, WEATHERHEAD, AND COILED CABLE TO BE PROVIDED ACCORDING TO UTILITY COMPANY REQUIREMENTS.
- SIGN TRUSS TO BE FURNISHED AND INSTALLED AT STATION NUMBER 4455+50 BY OTHERS IN CONTRACT NUMBER 62301.
- SEE DRAWING DT-04 FOR SIGN INSTALLATION DETAILS.
- CONTRACTOR MUST INTERCEPT CONDUIT STUBS AND MAKE CONNECTIONS TO THE NEW HANDHOLES INSTALLED UNDER THIS CONTRACT.
- SEE DRAWING DT-06 FOR UPS EQUIPMENT DETAILS. SEE DRAWINGS DT-36 AND DT-47 FOR CABINET AND FOUNDATION DETAILS.
- JUNCTION BOX IN MEDIAN BARRIER WALL FURNISHED AND INSTALLED BY OTHERS UNDER A SEPARATE CONTRACT. SEE DRAWING DT-02 FOR INSTALLATION DETAILS.
- COORDINATE INSTALLATION OF ALL ITEMS SHOWN ON THIS SHEET WITH CONTRACT NUMBERS 62301 AND 62586.
- NEW METER PEDESTAL TO BE FURNISHED AT APPROXIMATE LOCATION SHOWN ON THIS DRAWING SUCH THAT METER CAN BE READ FROM THE FRONTAGE ROAD. FINAL LOCATION TO BE APPROVED BY THE ENGINEER. SEE DRAWING DT-06A FOR METER PEDESTAL DETAILS.
- SEE DRAWING COMM-31 FOR ADDITIONAL CONDUIT AND FIBER OPTIC CABLE CONNECTIONS TO THE CONTROLLER. SEE DRAWING DT-05 FOR CONTROLLER EQUIPMENT DETAILS. SEE DRAWINGS DT-36 AND DT-47 FOR CABINET AND FOUNDATION DETAILS.
- SIGN TRUSS TO BE FURNISHED AND INSTALLED AT STATION NUMBER 4461+50 BY OTHERS IN CONTRACT NUMBER 62300.
- TEMPORARY LEASED COMMUNICATION LINE CONNECTION TO BE INSTALLED FOR TEMPORARY COMMUNICATION BETWEEN THE SIGN AND IDOT TRAFFIC SYSTEMS CENTER. UTILIZE SPARE CONDUIT SYSTEM BETWEEN HH3205 AND UTILITY POLE TO INSTALL (1) 6/C #19 TELEPHONE CABLE FOR THIS TEMPORARY CONNECTION. CABLES TO BE REMOVED AFTER PERMANENT INSTALLATION IS COMPLETE.
- POWER CABLES FOR TEMPORARY POWER FEED TO BE INSTALLED AS SHOWN BETWEEN UTILITY POLE AND METER PEDESTAL; AND (1) 3/C #2 & 1/C #6 GND BETWEEN METER PEDESTAL AND HH3205. ONCE PERMANENT CABINET INSTALLATION IS COMPLETED, CABLES ARE TO BE PULLED BACK TO METER PEDESTAL AND REMOVED. PERMANENT CABLES ARE TO BE INSTALLED WITH SIZES AS INDICATED ON THE PLANS.
- SIGN CONTROLLER SHALL BE TEMPORARILY MOUNTED INSIDE SIGN HOUSING UNTIL THE PERMANENT CABINETS ARE INSTALLED.
- AERIAL CABLES AND WOOD POLES TO BE REMOVED ONCE PERMANENT INSTALLATION IS COMPLETE.
- SIGN MAY BE OUT OF SERVICE FOR A MAXIMUM OF 48 HOURS TO FACILITATE CHANGE FROM TEMPORARY TO PERMANENT CONNECTIONS.

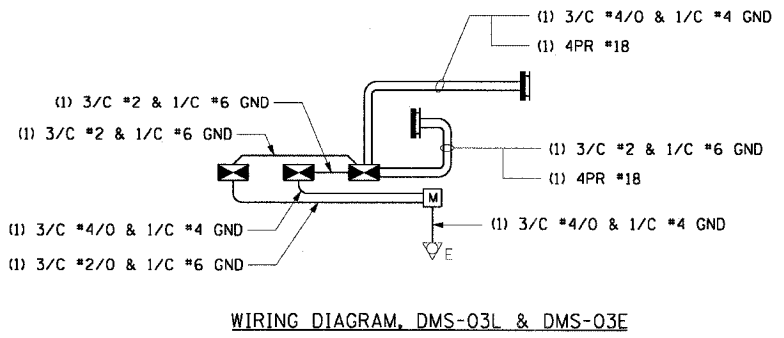

WIRING DIAGRAM, DMS-03L & DMS-03E

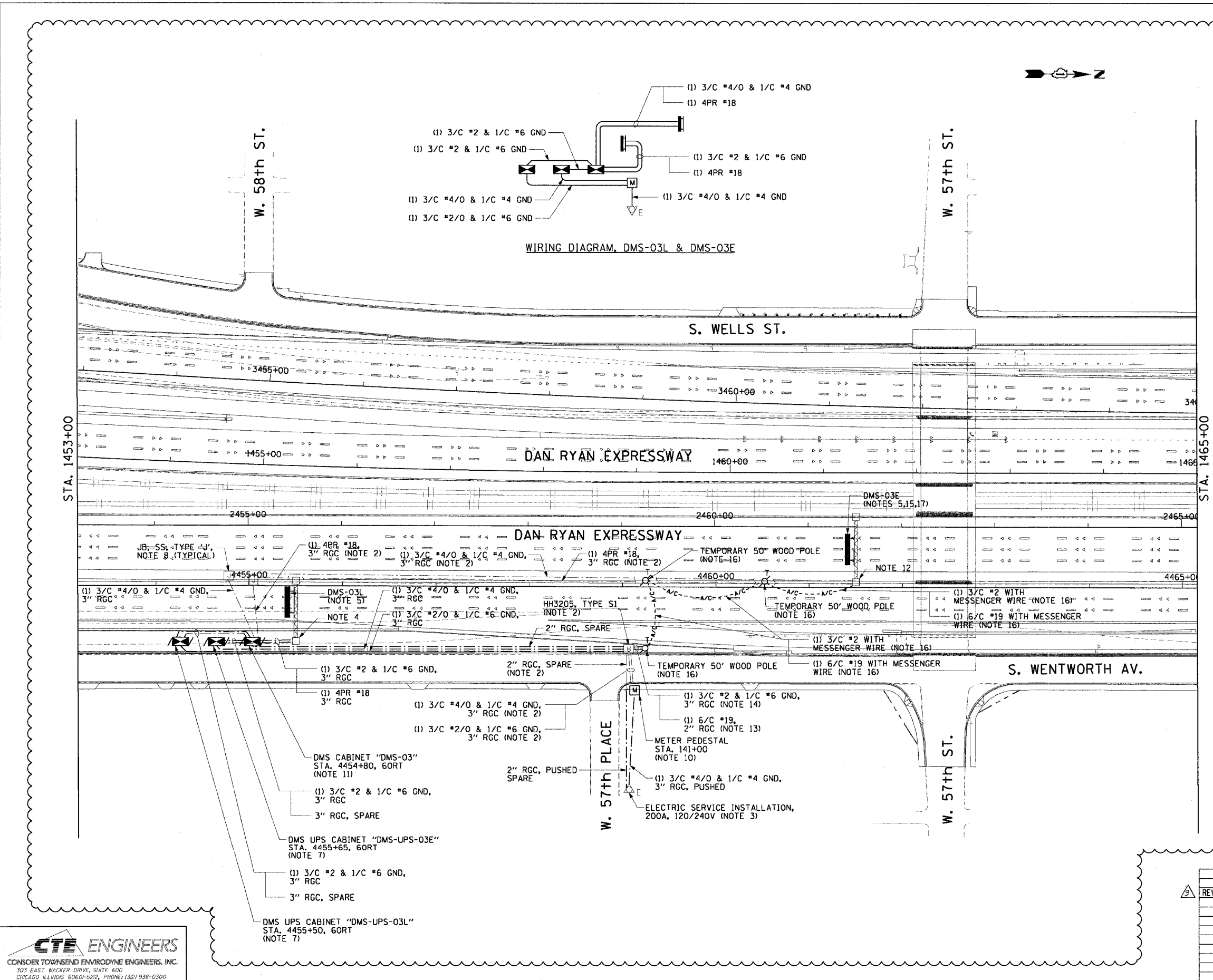

DMS-04

REVISIONS		
REVISION	NAME	DATE
1		2/11/05

ILLINOIS DEPARTMENT OF TRANSPORTATION
 F.A.I. 90/94 (DAN RYAN EXPRESSWAY)
 31st STREET TO I-57
 DYNAMIC MESSAGE SIGN
 NB 57TH ST. SITE LAYOUT
 SIGNS DMS-03L & DMS-03E
 SCALE: 1"=50'
 DATE: October 29, 2004
 DRAWN BY: HAR
 CHECKED BY: BMW

02/10/2005 05:07:53 PM
 Mr. VP-40468/CE/let/19/IT SYSTEMS/Contract 2/DMS020042A/1