

F.A. RTE.	SECTION	COUNTY	TOTAL SHEETS	SHEET NO.
698	1 VBR	BUREAU	72	16
STA.		TO STA.		
FED. ROAD DIST. NO.		ILLINOIS FED. AID PROJECT		

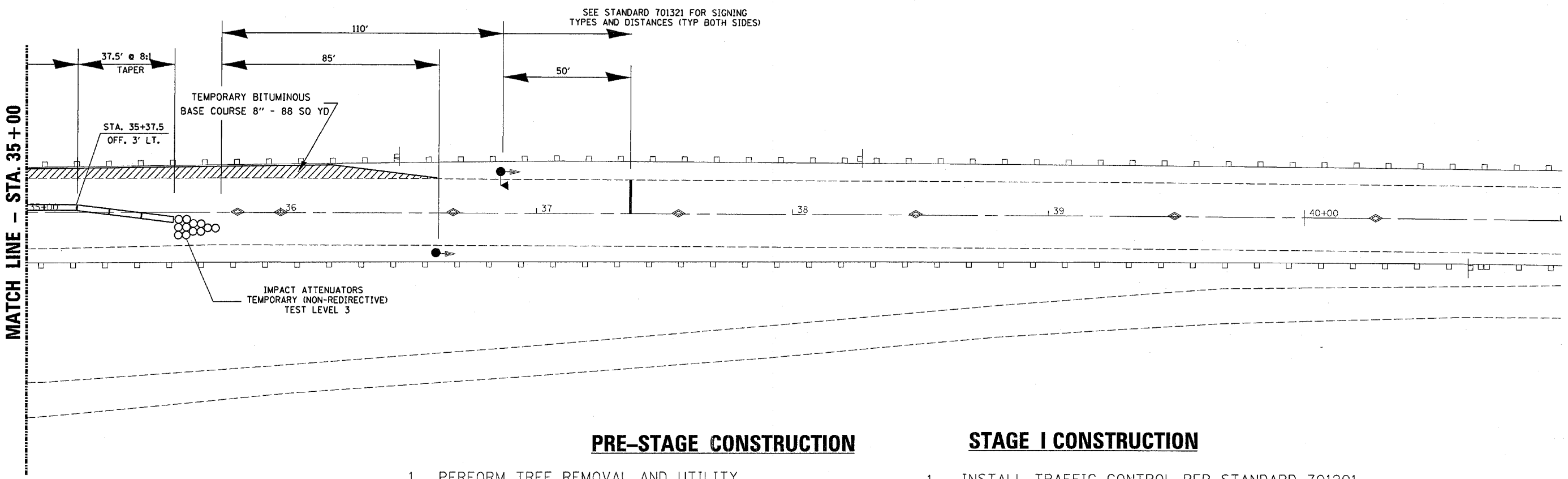

PRE-STAGE CONSTRUCTION

1. PERFORM TREE REMOVAL AND UTILITY WORK ACCORDING TO STANDARD 701006
2. CONSTRUCT CONCRETE SIDEROAD, ENTRANCE, AND SHOULDER ACCORDING TO TRAFFIC STANDARD 701501

STAGE I CONSTRUCTION

1. INSTALL TRAFFIC CONTROL PER STANDARD 701201
2. INSTALL TEMPORARY TRAFFIC SIGNALS
3. INSTALL TRAFFIC CONTROL PER STANDARD 701321 AND AS DETAILED IN THESE PLANS.
4. REMOVE SOUTHBOUND PORTION OF EXISTING STRUCTURE
5. CONSTRUCT SOUTHBOUND PORTION OF STRUCTURE
6. CONSTRUCT SOUTHBOUND SHOULDER
7. MILL AND PLACE LEVELING BINDER ON SOUTHBOUND PAVEMENT
8. INSTALL GUARDRAIL

SYMBOLS

- WORK AREA
- DRUM WITH STEADY BURNING LIGHT
- TRAFFIC SIGNAL
- TYPE C BIDIRECTIONAL REFLECTOR
- TEMPORARY CONCRETE BARRIER
- IMPACT ATTENUATOR (NON-REDIRECTIVE) TEST LEVEL 3
- STEADY BURNING LIGHTS AND DOUBLE VERTICAL PANELS
- TRAFFIC SIGNAL WITH MICROWAVE DETECTOR

REVISIONS	
NAME	DATE

ILLINOIS DEPARTMENT OF TRANSPORTATION

**STAGE 1
CONSTRUCTION**

SCALE: VERT.
DATE

DRAWN BY
CHECKED BY