

# INDEX OF SHEETS

- 1 COVER SHEET
- 2 GENERAL NOTES, STANDARDS, INDEX OF SHEETS
- 3-6. SUMMARY OF QUANTITIES
- 7 TYPICAL SECTIONS
- 8-11. SCHEDULES
- 12-13. PLAN AND PROFILE SHEETS
- 14-16. STAGE I TRAFFIC CONTROL
- 17-19. STAGE II TRAFFIC CONTROL
- 20 EROSION CONTROL PLAN SHEET
- 21-22. DRAINAGE AND UTILITY SHEETS
- 23 RIGHT-OF-WAY SHEET
- 24 INTERSECTION DETAIL SHEET
- 25 GUARDRAIL AND PAVEMENT MARKING DETAIL
- 26 REMOVAL PLAN SHEET
- 27 TREE REMOVAL PLAN SHEET
- 28-50B BRIDGE PLAN SHEETS
- 51-62. FOR INFORMATION ONLY EXISTING BRIDGE PLANS
- 63-65. DETAILS
- 66-72. CROSS-SECTIONS

## HIGHWAY STANDARDS

SEE PAGE 2 FOR LIST OF STANDARDS

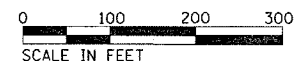

FULL SIZE PLANS HAVE BEEN PREPARED USING STANDARD ENGINEERING SCALES, REDUCED SIZED PLANS WILL NOT CONFORM TO STANDARD SCALES, IN MAKING MEASUREMENTS ON REDUCED PLANS, THE ABOVE SCALES MAY BE USED.

MICROFILMED \_\_\_\_\_  
REEL NUMBER \_\_\_\_\_  
AWARDED \_\_\_\_\_  
RESIDENT ENGINEER \_\_\_\_\_  
AS BUILT CHANGES WERE MADE  
ON THE FOLLOWING SHEETS \_\_\_\_\_

JULIE 1-800-892-0123

DISTRICT 3 NO. (815) 434-6131

PROJECT ENGINEER: DAVE BROVIK  
UNIT CHIEF: SCOTT A. FERGUSON

CONTRACT NO. 66361

# STATE OF ILLINOIS DEPARTMENT OF TRANSPORTATION DIVISION OF HIGHWAYS PROPOSED HIGHWAY PLAN F.A.P. ROUTE 698 (IL 89) SECTION 1 VBR PROJECT BRF-0698(023) BUREAU COUNTY

C - 93 - 130 - 03

REMOVAL AND REPLACEMENT OF S.N 006-0110  
CARRYING IL 89 OVER THE CSX RAILROAD

PROJECT BEGINS  
STA. 28+10

PROJECT ENDS  
STA. 35+00

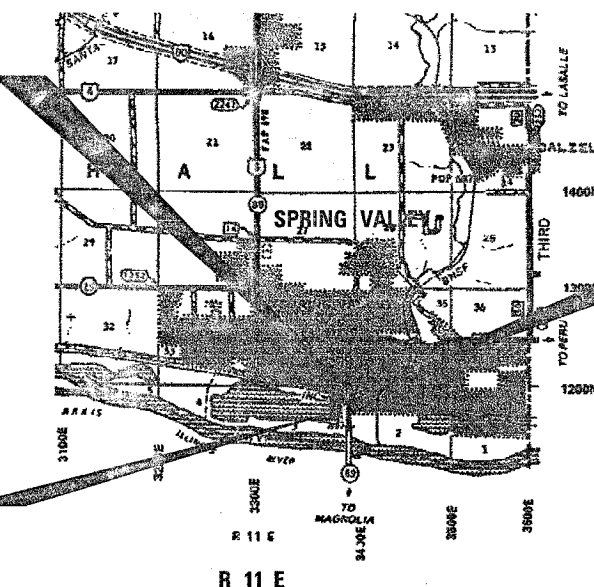

LOCATION MAP  
NOT TO SCALE

GROSS AND NET LENGTH = 750FT. = .14 MI.

CONTRACT NO. 66361				
F.A.P. RTE.	SECTION	COUNTY	TOTAL SHEETS	NO.
698	1 VBR	BUREAU	72+	1
ILLINOIS PROJECT				

P-93-068-02  
D-93-046-02

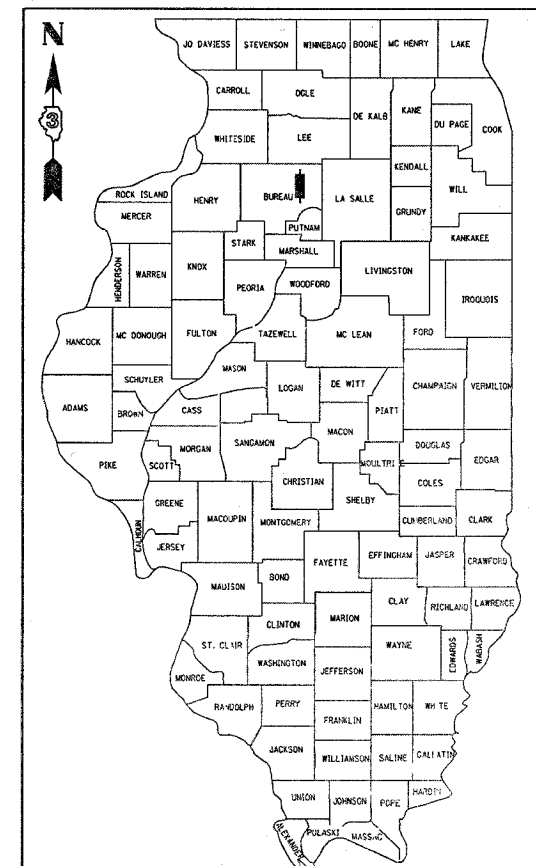

LOCATION OF SECTION INDICATED THUS: ———

FUNCTION CLASSIFICATION  
OTHER PRINCIPAL ARTERIAL

2005 ADT = 6000

P.V. = 91.8% S.U. = 5.0% M.U. = 3.2%

STATE OF ILLINOIS  
DEPARTMENT OF TRANSPORTATION  
DIVISION OF HIGHWAYS

SUBMITTED \_\_\_\_\_  
DEPUTY DIRECTOR OF HIGHWAYS, REGION ENGINEER  
February 2, 2007  
Eric E. Hamm/D  
ENGINEER OF DESIGN AND ENVIRONMENT  
February 2, 2007  
Michael R. Seer, P.E./D  
DIRECTOR OF HIGHWAYS, CHIEF ENGINEER

PRINTED BY THE AUTHORITY  
OF THE STATE OF ILLINOIS