

INDEX OF SHEETS

SHEET NO.	TITLE
1	COVER SHEET
2	INDEX OF SHEETS, STATE STANDARDS, AND GENERAL NOTES
3-5	SUMMARY OF QUANTITIES
6-11	TRAFFIC CONTROL PLANS
12-13	ROADWAY PLAN
14	INSIDE SHOULDER SLOPE CORRECTION DETAIL S.N. 022-0081
15-31	STRUCTURAL DRAWINGS - S.N. 022-0078(NB) & S.N. 022-0079(SB)
32-37	STRUCTURAL DRAWINGS - S.N. 022-0080(NB) & S.N. 022-0081(SB)
38	BUTT JOINT AND HMA TAPER DETAILS (BD-32)
39	TRAFFIC CONTROL AND PROTECTION FOR SIDE ROADS, INTERSECTIONS, AND DRIVEWAYS (TC-10)
40	TYPICAL APPLICATIONS RAISED REFLECTIVE PAVEMENT MARKERS (SNOW-PLOW RESISTANT) (TC-11)
41	TYPICAL PAVEMENT MARKINGS (TC-13)
42	TRAFFIC CONTROL AND PROTECTION AT TURN BAYS (TO REMAIN OPEN TO TRAFFIC) (TC-14)
43	SHORT TERM PAVEMENT MARKING LETTERS AND SYMBOLS (TC-16)
44	ARTERIAL ROAD INFORMATION SIGN (TC-22)

STATE STANDARDS

STANDARD NO.	DRAWING NAME
000001-08	STANDARD SYMBOLS, ABBREVIATIONS AND PATTERNS
630001-12	STEEL PLATE BEAM GUARDRAIL
701101-04	OFF-RD MOVING OPERATION, 2L, 2W, DAY ONLY
701106-02	OFF-RD OPERATIONS, MULTILANE, MORE THAN 15' (4.5 m) AWAY
701423-10	LANE CLOSURE, MULTILANE, WITH BARRIER, FOR SPEEDS ≥ 45 MPH TO 55 MPH
701426-09	LANE CLOSURE, MULTILANE, INTERMITTENT OR MOVING OPER., FOR SPEEDS ≥ 45 MPH
701428-01	TRAFFIC CONTROL SETUP AND REMOVAL FREEWAY/EXPRESSWAY
701501-06	URBAN LANE CLOSURE, 2L, 2W, UNDIVIDED
701601-09	URBAN LANE CLOSURE MULTILANE, 1W OR 2W WITH NONTRAVERSABLE MEDIAN
701701-10	URBAN LANE CLOSURE MULTILANE INTERSECTION
701901-10	TRAFFIC CONTROL DEVICES
704001-08	TEMPORARY CONCRETE BARRIER

HMA TABLE

HOT-MIX ASPHALT MIXTURE REQUIRMENTS		QUALITY MANAGEMENT PROGRAM (QMP)
MIXTURE TYPE	AIR VOIDS @ Noles	
HMA OVERLAY ON APPROACH		
POLYMERIZED HOT-MIX ASPHALT SURFACE COURSE, MIX "E", IL-9.5, N70, 2"	4% @ 70 Gyr	QC/QA
BUTT JOINT & SHOULDERS		
POLYMERIZED HOT-MIX ASPHALT SURFACE COURSE, MIX "E", IL-9.5, N70, 1-3/4"	4% @ 70 Gyr	QC/QA
QMP DESIGNATION: QUALITY CONTROL/ QUALITY ASSURANCE (QC/QA); QUALITY CONTROL FOR PERFORMANCE (QCP); PAY FOR PERFORMANCE (PFP)		

MIXTURE REQUIREMENT NOTES:

1. THE UNIT WEIGHT USED TO CALCULATE ALL HMA SURFACE MIXTURE QUANTITIES IS 112 LBS/SQ YD/IN.
2. THE "AC TYPE" FOR POLYMERIZED HMA MIXES SHALL BE "SBS/SBR PG 76 -22" AND FOR NON-POLYMERIZED HMA THE "AC TYPE" SHALL BE "PG 64 -22" UNLESS MODIFIED BY RECLAIMED MATERIALS SPECIFICATIONS.

GENERAL NOTES

1. THE EXACT LOCATION OF ALL UTILITIES SHALL BE FIELD VERIFIED BY THE CONTRACTOR BEFORE ORDERING ANY MATERIALS AND STARTING ANY WORK. FOR LOCATIONS OF UTILITIES, LOCALLY OWNED EQUIPMENT, LEASED ENFORCEMENT CAMERA SYSTEM FACILITIES AND IDOT UNDERGROUND FACILITIES, CONTACT THE LOCAL COUNTIES, MUNICIPALITIES AND IDOT FOR LOCATES.
2. MEADE ELECTRIC COMPANY, THE IDOT DISTRICT ONE ELECTRICAL MAINTENANCE CONTRACTOR, LOCATES IDOT ELECTRICAL EQUIPMENT AND UNDERGROUND CABLES. CALL 773-287-7672 FOR THE INITIAL LOCATE. REQUEST FOR LOCATES OF PREVIOUSLY MARKED FACILITIES MAY BE AT THE CONTRACTOR'S EXPENSE.
3. IN ADDITION TO FIELD REVIEW AND AERIAL DATA, PLAN DIMENSIONS AND DETAILS RELATIVE TO THE EXISTING FACILITIES HAVE BEEN TAKEN FROM EXISTING PLANS AND ARE SUBJECT TO CONSTRUCTION VARIATIONS. PLAN DIMENSIONS AND DETAILS RELATIVE TO EXISTING PLANS ARE SUBJECT TO ROUTINE VARIATIONS. IT SHALL BE THE CONTRACTOR'S RESPONSIBILITY TO VERIFY EXISTING DIMENSIONS AND DETAILS AFFECTING NEW CONSTRUCTION AND MAKE NECESSARY APPROVED ADJUSTMENTS PRIOR TO CONSTRUCTION OR ORDERING MATERIALS. SUCH VARIATIONS SHALL NOT BE CAUSE FOR ADDITIONAL COMPENSATION FOR A CHANGE IN THE SCOPE OF WORK. HOWEVER, THE CONTRACTOR WILL BE PAID FOR THE QUANTITY ACTUALLY FURNISHED AT THE BID PRICE FOR THE WORK.
4. THE CONTRACTOR WILL NOT BE ALLOWED TO SET UP A YARD OR FIELD OFFICE ON STATE PROPERTY WITHOUT WRITTEN PERMISSION FROM THE DEPARTMENT.
5. IT SHALL BE THE CONTRACTOR'S RESPONSIBILITY TO VERIFY ALL DIMENSIONS AND CONDITIONS EXISTING IN THE FIELD PRIOR TO BEGINNING CONSTRUCTION AND ORDERING MATERIALS.
6. THE CONTRACTOR SHALL TAKE ALL NECESSARY PRECAUTIONS FOR THE PROTECTION OF EXISTING PLANT MATERIAL FOR WHICH THE CONTRACT DOES NOT PROVIDE REMOVAL. THE PROTECTION OF EXISTING PLANT MATERIAL AND THE REPAIR OR REPLACEMENT OF EXISTING PLANT MATERIAL DAMAGED BY THE CONTRACTOR SHALL BE DONE IN ACCORDANCE WITH THE REQUIREMENTS OF SECTION 201 OF THE STANDARD SPECIFICATIONS.
7. THE DEPARTMENT HAS NOT OBTAINED ANY PERMITS FOR OFFSITE BORROW, WASTE, USE (BWU) AREAS. PRIOR TO WORKING IN BWU AREAS, IF THE CONTRACTOR CHOOSES TO USE ACTIVITIES REQUIRING PERMITS IT IS THE CONTRACTOR'S RESPONSIBILITY TO SECURE THE PROPER PERMITS. IN ADDITION TO THE BORROW REVIEW (BDE 2289) AND USE/WASTE REVIEW (BDE 2290) SUBMITTALS, THE CONTRACTOR SHALL SUBMIT AN EROSION AND SEDIMENT CONTROL (ESC) PLAN FOR EVERY BWU SITE TO THE DEPARTMENT FOR ACCEPTANCE. GUIDELINES FOR ACCEPTABLE BWU PRACTICES CAN BE FOUND IN SECTION 11.G.1. THE COST OF ALL MATERIALS AND LABOR NECESSARY TO COMPLY WITH THE ABOVE PROVISIONS TO PREPARE AND IMLEMENT ESC PLANS WILL NOT BE PAID FOR SEPARATELY, BUT SHALL BE CONSIDERED AS INCLUDED IN THE CONTRACT UNIT PRICES AND NO ADDITIONAL COMPENSATION WILL BE ALLOWED.
8. THE RESIDENT ENGINEER SHALL CONTACT EMAD ALHUSSEINI, AREA TRAFFIC FIELD TECHNICIAN, AT EMAD.ALHUSSEINI@ILLINOIS.GOV A MINIMUM OF TWO (2) WEEKS PRIOR TO THE PLACEMENT OF PERMANENT PAVEMENT MARKINGS.
9. THE DEPARTMENT HAS DETERMINED THAT IN STREAM WORK IS NOT REQUIRED FOR THE WORK SPECIFIED IN THIS CONTRACT. THE DEPARTMENT HAS NOT OBTAINED A USACE PERMIT. IF THE CONTRACTOR CHOOSES TO USE ACTIVITIES REQUIRING AN USACE PERMIT, IT IS THE CONTRACTOR'S RESPONSIBILITY TO SECURE THE PROPER USACE PERMITS. THE COST OF ALL MATERIALS AND LABOR NECESSARY TO SECURE AND COMPLY WITH A USACE PERMIT FOR CONTRACTOR'S ACTIVITIES WILL NOT BE PAID FOR SEPARATELY, BUT SHALL BE CONSIDERED AS INCLUDED IN THE UNIT BID PRICES OF THE CONTRACT AND NO ADDITIONAL COMPENSATION WILL BE ALLOWED.
10. THESE PLANS HAVE BEEN PREPARED FROM NOTES RECEIVED FROM I.D.O.T. FIELD MAINTENANCE ENGINEERS.
11. THE CONTRACTOR SHALL USE CARE IN REMOVING OR EXCAVATING NEAR ALL EXISTING ITEMS WHICH WILL REMAIN. ANY DAMAGE DONE TO EXISTING ITEMS BY THE CONTRACTOR SHALL BE REPAIRED AT THE CONTRACTOR'S EXPENSE.
12. SAW CUTTING PRIOR TO ANY REMOVAL ITEMS NOTED ON THE PLANS OR DIRECTED BY THE ENGINEER SHALL BE CONSIDERED INCLUDED IN THE COST OF THE ITEMS BEING REMOVED.
13. FOR WORK OUTSIDE THE LIMITS OF BRIDGE APPROACH PAVEMENT. ALL REFERENCES IN THE HIGHWAY STANDARDS AND STANDARD SPECIFICATIONS FOR REINFORCEMENT, DOWEL BARS AND TIE BARS IN PAVEMENT SHALL BE EPOXY COATED UNLESS NOTED ON THE PLANS.
14. DOUBLE LANE MARKERS ARE TO BE USED AS SHOWN ON THE DISTRICT ONE DETAIL "TYPICAL APPLICATIONS-RAISED REFLECTIVE PAVEMENT MARKERS (SNOW-PLOW RESISTENT)" SHOWN IN PLANS.
15. THE CENTERLINE IS FOR INFORMATION ONLY.
16. THE CONTRACTOR SHALL NOTIFY VINCE GORTNER, SENIOR DIRECTOR OF GUEST EXPERIENCE & SAFETY, THE MORTON ARBORETUM, AT 630-725-2099 OR VGORTNER@MORTONARB.ORG A MINIMUM OF TWO (2) WEEKS PRIOR TO BEGINNING CONSTRUCTION.
17. THE PROJECT HAS A PERMIT FOR SECTION 404 OF THE CLEAN WATER ACT AND SHALL FOLLOW THE CONDITIONS OF THE PERMIT PROGRAM.
18. BEFORE BEGINNING ANY WORK, THE CONTRACTOR SHALL RETAIN AND RECORD FOR FUTURE REFERENCE, ALL EXISTING PAVEMENT MARKING LINES (AND RAISED REFLECTIVE PAVEMENT MARKERS) IN ORDER THAT THESE LOCATIONS CAN BE RE-ESTABLISHED FOR STRIPING. EXACT LOCATIONS OF ALL PAVEMENT MARKINGS SHALL BE AS DIRECTED BY THE ENGINEER.



1 REVISED SHEET 2/21/2025

MODEL: Default  
FILE NAME: I:\P\2020-2020-4094-100 IDOT Various Phase 2 (P78 196 Item 16)WDG 36 62T31 C:\esd\IDOT\CODD\_Sheets\62T31-sh-GEN-01.dgn

 <b>INFRASTRUCTURE ENGINEERING</b>   INCORPORATED 1 South Wacker   Suite 2650   Chicago, IL 60606 P 312.425.9560   F 312.425.9564   www.infrastructure-eng.com	USER NAME = ALane	DESIGNED - ACL	REVISED -  AMT 1/30/2025	<b>STATE OF ILLINOIS DEPARTMENT OF TRANSPORTATION</b>	<b>INDEX OF SHEETS, STATE STANDARDS, AND GENERAL NOTES IL-53 OVER MORTON ARBORETUM &amp; EAST BRANCH DUPAGE RIVER</b>	F.A.P. RTE.	SECTION	COUNTY	TOTAL SHEETS	SHEET NO.
	PLOT SCALE = 20.0000 ' / in.	DRAWN - ACL	REVISED -			870	FAP 0870 22 BJ2	DUPAGE	44	2
	PLOT DATE = 2/14/2025	CHECKED -	REVISED +			CONTRACT NO. 62T31				
		DATE - 07/28/2023	REVISED +			ILLINOIS FED. AID PROJECT				
SCALE: SHEET OF SHEETS STA. TO STA.										



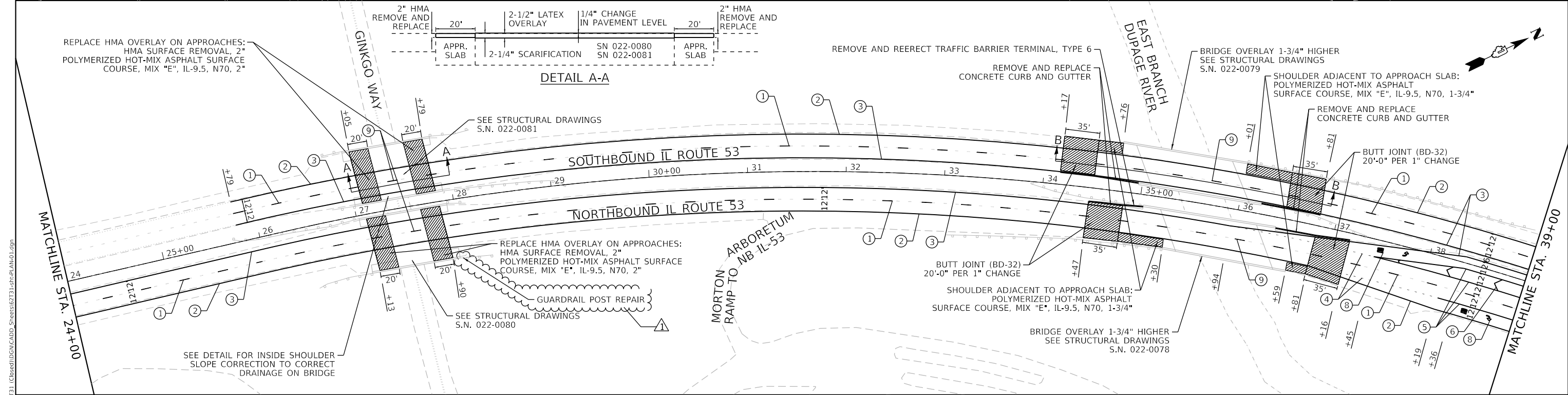
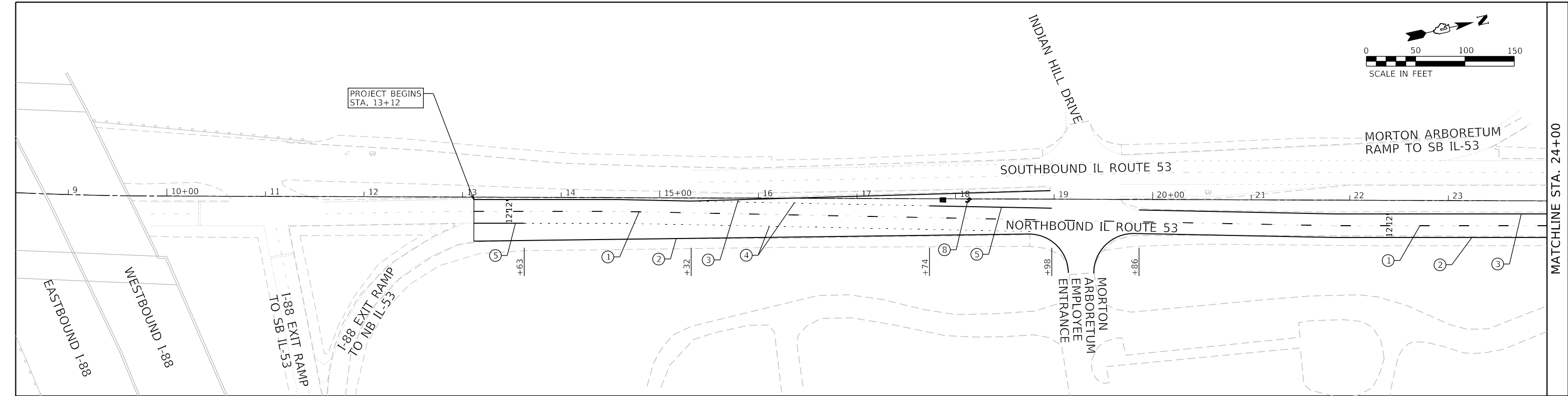

**PAVEMENT MARKING LEGEND**

- ① LINE 4", SKIP-DASH, WHITE (10' LINE - 30" SPACE) - LANE LINE
- ② LINE 4", SOLID, WHITE - EDGE LINE
- ③ LINE 4", SOLID, YELLOW - EDGE LINE
- ④ LINE 6", SKIP-DASH, WHITE (2" LINE - 6' SPACE) - DOTTED LINES
- ⑤ LINE 6", SOLID, WHITE - TURN LINE
- ⑥ LINE 12", SOLID, WHITE - PAINTED MEDIANS DIAGONALS (SEE DISTRICT DETAIL TC-13 FOR SPACING)
- ⑦ LINE 24", SOLID, WHITE - STOP LINE
- ⑧ LETTERS & SYMBOLS, SOLID, WHITE - TURN LANE MARKINGS
- ⑨ PREFORMED PLASTIC PAVEMENT MARKING, TYPE D, LINE 7", SKIP-DASH, (10' LINE - 30" SPACE), (1.5" BLACK, 4" WHITE, 1.5" BLACK) ON GROOVING FOR RECESSED PAVEMENT MARKING 8"

**LEGEND**

- HMA OVERLAY

**NOTES**

- ALL FINAL PAVEMENT MARKINGS SHALL BE THERMOPLASTIC PAVEMENT MARKINGS (OF THE EXTRUDED TYPE) ON HMA PAVEMENT AND MODIFIED URETHANE ON CONCRETE PAVEMENT UNLESS OTHERWISE NOTED.
- ALL FINAL PAVEMENT MARKINGS SHALL BE PLACED IN ACCORDANCE WITH TC-13 "DISTRICT ONE TYPICAL PAVEMENT MARKINGS" STANDARD DETAIL.
- ALL RAISED REFLECTIVE PAVEMENT MARKERS SHALL BE PLACED IN ACCORDANCE WITH TC-11 "TYPICAL APPLICATIONS RAISED REFLECTIVE PAVEMENT MARKERS (SNOW-PLOW RESISTANT)" STANDARD DETAIL.

**DETAIL B-B**

**STATE OF ILLINOIS  
DEPARTMENT OF TRANSPORTATION**

**ROADWAY AND PAVEMENT MARKING PLANS**

SCALE: 1" = 50'    SHEET    OF    SHEETS    STA.    TO STA.

F.A.P. RTE.	SECTION	COUNTY	TOTAL SHEETS	SHEET NO.
870	FAP 0870 22 BJ2	DUPAGE	44	12
CONTRACT NO. 62T31				
ILLINOIS    FED. AID PROJECT				

MODEL: Default  
FILE: I:\Projects\2020\2020-4094-00 IDOT Various Phase 2 (PBE 196 Item 16)W0 36 62T31 (Closed)DGN\CADD\_Sheets\62T31-shp-PLAN.dgn

USER NAME = ALane  
DESIGNED - ACL  
DRAWN - ACL  
CHECKED -  
DATE - 07/28/2023

PLOT SCALE = 100.0000 ' / in.  
PLOT DATE = 2/14/2025

REVISD - AMT 1/30/2025  
REVISD -  
REVISD -  
REVISD -

MODEL Default  
FILE C:\Users\jw20\OneDrive\Documents\DOT Various Phase 2\TBE 106 Item 16\W0 36 62T31 - Closed\DWG\CADD\_Sheets\62T31-sh-PLAN-02.dgn

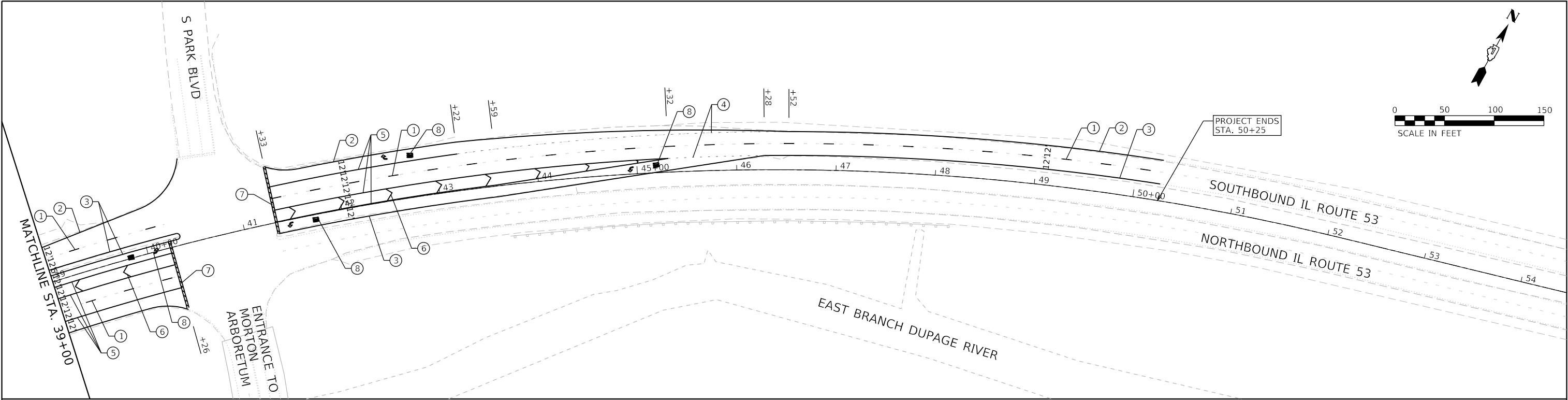

PAVEMENT MARKING LEGEND

- ① LINE 4", SKIP-DASH, WHITE (10' LINE - 30' SPACE) - LANE LINE  
② LINE 4", SOLID, WHITE - EDGE LINE  
③ LINE 4", SOLID, YELLOW - EDGE LINE  
④ LINE 6", SKIP-DASH, WHITE (2' LINE - 6' SPACE) - DOTTED LINES  
⑤ LINE 6", SOLID, WHITE - TURN LINE  
⑥ LINE 12", SOLID, WHITE - PAINTED MEDIANS DIAGONALS  
(SEE DISTRICT DETAIL TC-13 FOR SPACING)  
⑦ LINE 24", SOLID, WHITE - STOP LINE  
⑧ LETTERS & SYMBOLS, SOLID, WHITE - TURN LANE MARKINGS  
⑨ PREFORMED PLASTIC PAVEMENT MARKING, TYPE D, LINE 7", SKIP-DASH,  
(10' LINE - 30' SPACE), (1.5" BLACK, 4" WHITE, 1.5" BLACK) ON  
GROOVING FOR RECESSED PAVEMENT MARKING 8"

LEGEND

■ HMA OVERLAY

NOTES

1. ALL FINAL PAVEMENT MARKINGS SHALL BE THERMOPLASTIC PAVEMENT MARKINGS (OF THE EXTRUDED TYPE) ON HMA PAVEMENT AND MODIFIED URETHANE ON CONCRETE PAVEMENT UNLESS OTHERWISE NOTED.
2. ALL FINAL PAVEMENT MARKINGS SHALL BE PLACED IN ACCORDANCE WITH TC-13 "DISTRICT ONE TYPICAL PAVEMENT MARKINGS" STANDARD DETAIL.
3. ALL RAISED REFLECTIVE PAVEMENT MARKERS SHALL BE PLACED IN ACCORDANCE WITH TC-11 "TYPICAL APPLICATIONS RAISED REFLECTIVE PAVEMENT MARKERS (SNOW-PLOW RESISTANT)" STANDARD DETAIL.

△ REVISED SHEET 2/21/2025

 <b>INFRASTRUCTURE ENGINEERING</b>   INCORPORATED 1 South Wacker   Suite 2650   Chicago, IL 60606 P 312.425.9569   F 312.425.9568   www.infrastructure-eng.com	USER NAME = ALane	DESIGNED - ACL	REVISED - △ AMT 1/30/2025	<b>STATE OF ILLINOIS DEPARTMENT OF TRANSPORTATION</b>	<b>ROADWAY AND PAVEMENT MARKING PLANS</b>			F.A.P. RTE.	SECTION	COUNTY	TOTAL SHEETS	SHEET NO.
	PLOT SCALE = 100.0000 ' / in.	DRAWN - ACL	REVISED -					870	FAP 0870 22 BJ2	DUPAGE	44	13
	PLOT DATE = 2/14/2025	CHECKED -	REVISED -		SCALE: 1" = 50'			SHEET OF SHEETS			CONTRACT NO. 62T31	
		DATE - 07/28/2023	REVISED -		STA. TO STA.			ILLINOIS FED. AID PROJECT				